



ATTACHMENT B.3: PLANNING DOCUMENTATION



ATTACHMENT B.3.1

PART 8 PLANNING APPROVAL, MAY 2010

Comhairle Contae Chorcaí Cork County Council

Halla an Chontae,
Corcaigh, Éire.
Fón: (021) 4276891 • Fais: (021) 4276321
Suíomh Gréasáin: www.corkcoco.ie
County Hall,
Cork, Ireland.
Tel: (021) 4276891 • Fax: (021) 4276321
Web: www.corkcoco.ie

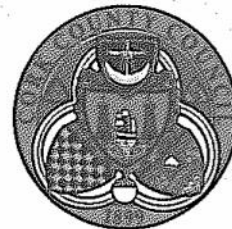

Claire Foley,
Senior Staff Officer,
Water Services Investment Programme,
Model Business Park.



Direct Tel. No. (021) 4285143
Direct Fax No. (021) 4343255
e-mail: mary.banks@corkcoco.ie

26th May, 2010.

Re; Report under Article 179(3)(b) of the Planning & Development Act, 2000.
Report under Article 81 of the Planning & Development Regulations, 2001.
Proposed construction of a 1600pe Wastewater Treatment Plant at
Coachford.

At the meeting of the Council held on the 24th May, 2010 the recommendation of the Southern Committee was approved in respect of the above.

I attach letter dated 25th May, 2010 from the Senior Executive Officer, Corporate, Community & Economic Development.

MARY BANKS,
Clerical Officer,
Area Operations South,
Floor 5.

Comhairle Contae Chorcaí Cork County Council

Halla an Chontae,
Corcaigh, Éire.
Fón: (021) 4276891 • Faics: (021) 4276321
Suíomh Gréasáin: www.corkcoco.ie
County Hall,
Cork, Ireland.
Tel: (021) 4276891 • Fax: (021) 4276321
Web: www.corkcoco.ie



Ms. Mary Banks,
Area Operations South,
Floor 5.

25th May, 2010.

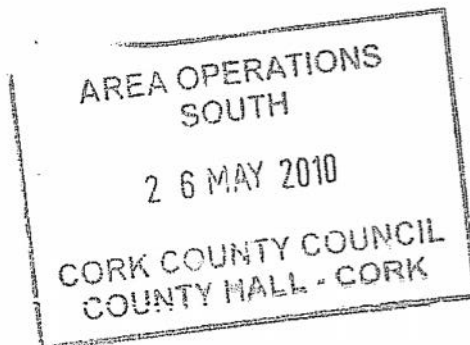

**Re: Report under Article 179(3)(b) of the Planning & Development Act, 2000
Proposed Waste Water Treatment Plant at Coachford**

I refer to your email dated 17th May, 2010, in connection with the above.

At their meeting held on 24th May, 2010, the recommendation of the Southern Committee was approved.

A handwritten signature in cursive script, appearing to read 'Maurice Manning'.

**MAURICE MANNING
SENIOR EXECUTIVE OFFICER**



ATTACHMENT B.3.2

PART 8 SOUTHERN COMMITTEE REPORT, MAY 2010

Cork County Council

**Report under Section 179 of the
Local Government (Planning and Development) Act, 2000**

**Proposed Construction of a 1600PE Wastewater Treatment Plant at Coachford ,
Co. Cork**

Notice in respect of the above was published in the Irish Examiner dated 22/01/2010 in accordance with article 81 of the Local Government (Planning and Development) Regulations, 2001. The closing date for the receipt of submissions and observations was 19th March 2010.

(i) Nature and Extent of the Proposed Development.

The construction of a new 1600 PE Wastewater Treatment Plant and associated works at Coachford, Co. Cork. Site layout plan and site location maps, as submitted with the Part 8 application, are attached.

(ii) Implications with respect to Planning and Development of the area.

The proposal is in accordance with the proper planning and development of the area.

(iii) Persons or bodies who made submissions or observations.

The South Western Regional Fisheries Board.
Cork County Council, Planning Department.

(iv) Issues raised in Submissions/Observations and Manager's response.

Issues Raised	Response
1. To ensure that the development does not cause a deterioration in the receiving water with regard to Phosphorus Concentrations and Tropic Status (The South Western Fisheries Board)	The proposed construction of the WWTP to replace the existing Septic Tank will significantly improve the quality of the effluent which is currently being discharged into the receiving waters. Significant attention will be paid to the phosphorus levels in the treated effluent at the various stages of operation of the plant due to the sensitive nature of the receiving waters. The final effluent will be treated to meet the following; 1. Orthophosphates (PO ₄) 1.0 mg/l - P 2. Total Phosphorus 2.0 mg/l - P
2. To ensure that the proposed odour concentration limits (as set out in the Part VIII application) are achieved. (CCC, Planning Department which referred to CCC Environmental Department)	(Conditions proposed by Cork County Council, Environmental Department) Minimum buffer zones are maintained A full list of malodorous compounds likely to be produced is prepared with target concentration limits. The odour control system is capable of achieving the specified concentration

	limits in normal operation. A monitoring programme put into place prior to the facility accepting waste. Procedures put into place to adequately deal with non-compliances. The facility to operate in accordance with S.I. No 787/2005 – EC (WWTP) (Prevention of Odour and Noise) Regulations 2005 and all other relevant legislation.
--	---

(v) It is proposed to proceed with the above development with the following conditions.

Phosphorous Conditions

1. Significant attention will be paid to the phosphorus levels in the treated effluent at the various stages of operation of the plant due to the sensitive nature of the receiving waters. The final effluent will be treated to meet the following;
 - Orthophosphates (PO₄) 1.0 mg/l - P
 - Total Phosphorus 2.0 mg/l – P

Odour Conditions

1. Minimum buffer zones are maintained
2. A full list of malodorous compounds likely to be produced is prepared with target concentration limits.
3. The odour control system is capable of achieving the specified concentration limits in normal operation.
4. A monitoring programme put into place prior to the facility accepting waste.
5. Procedures put into place to adequately deal with non-compliances.
6. The facility to operate in accordance with S.I. No 787/2005 – EC (WWTP) (Prevention of Odour and Noise) Regulations 2005 and all other relevant legislation.

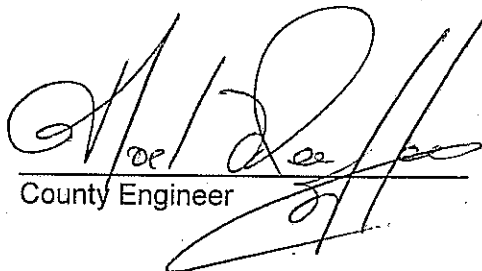
County Engineer

7th May 2010



- Notes :**
- All drawings are to be read in conjunction with all relevant specifications, services and engineering drawings.
 - Any discrepancies between these drawings and the documents should be brought to the attention of the engineer.
 - All dimensions are as noted.
 - All levels are in metres related to ordnance datum, Mean Sea.
 - Drawings are not to be scaled.
 - Ordnance Survey Ireland Licence No En 0015703
© Ordnance Survey Ireland and Government of Ireland.
 - Location and levels of existing utility services to be confirmed on site by contractor.

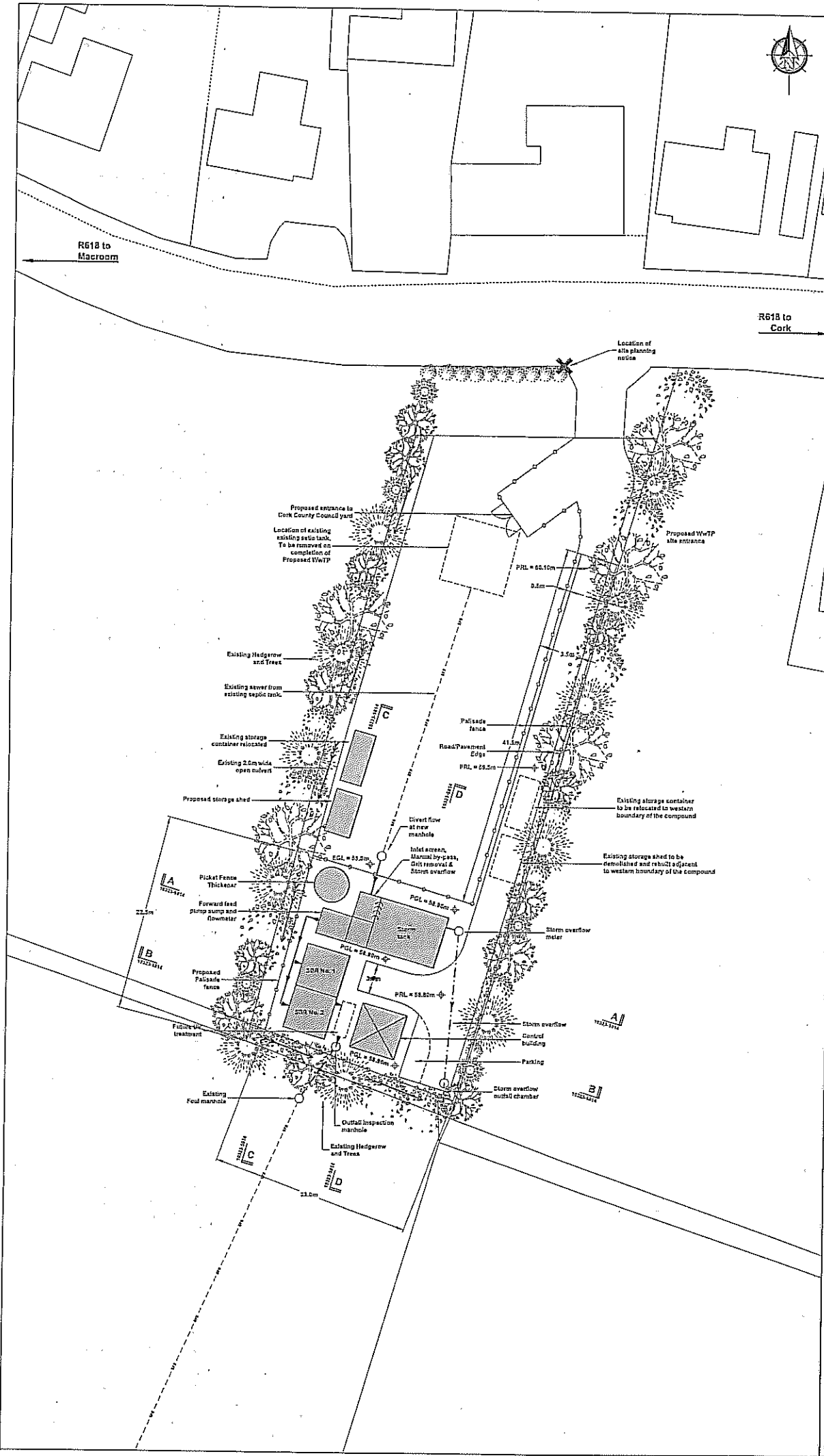

Rev	Code	Description	By	Check	Date
A	10/01/13	Issued For Part A Planning	ECC	MC	10/01/13
<p>Project: Corkford Sewerage Scheme Waste Water Treatment Plant</p> <p>Title: Proposed Wastewater Treatment Plant Site Layout Plan</p> <p>Client: Mr. N. O'Keefe M.E., C.Eng., F.E.I. County Engineer Cork County Council</p> <p>Malachy Walsh and Partners Consulting Engineers Cork Tralee Limerick Limerick</p> <p>Plot No: 10323-5013</p> <p>Scale: 1:500</p> <p>Drawn: ECC Date: 10/01/13 Checked: MC Date: 10/01/13 Approved: MC Date: 10/01/13</p>					