

AMENDED SITE DRAINAGE & LAYOUT MAP

SITE AREA = 1.198 HECTARES

PLANTING SCHEDULE
 FOUR NUMBER FRAXINUS EXCELOIR (D)
 FOUR NUMBER FAGUS SYVALTICA (E)
 FIVE NUMBER BETULA PENDULA (F)
 FIVE ACER CAMPESTRE (G)
 TWO STAGGERED ROW OF PRUNUS SPINOSA (128 IN TOTAL) AS PER B ON LAYOUT. SHRUBS AT 1.5M CENTRES
 ALL PLANTING TO BE CARRIED OUT DURING FIRST PLANTING SEASON AFTER COMMENCEMENT OF WORK
 TREES TO HAVE 14 - 16 CM GIRTH

DO NOT PLANT WHEN PERSISTANT COLD OR DRYING WINDS ARE LIKELY TO OCCUR OR SOIL IS FROST BOUND EXCESSIVELY DRY OR WATERLOGGED
 PROTECT SIDES OF PITS FROM FREEZING AND DO NOT USE FROZEN BACKFILLING MATERIAL.

PLANTS SHOULD CONFORM TO THE SPECIFICATION ON SITE LANDSCAPE MAP. PLANT SHOULD BE FREE OF DISEASE OR PESTS AND SHOULD BE PROTECTED DURING DELIVERY. ALL TREE PITS SHOULD BE FREE DRAINING AND EXCAVATED TO A MIN DEPTH OF 800MM OR AT LEAST 150MM DEEPER THAT THE ROOTS SYSTEM. SHAMROCK POTTING COMPOST SHOULD BE USED WITH ALL TREES. ALL TREES OVER 1.5M SHOULD BE STAKED AND SECURED WITH RAINBOW TREE TIES.

SHRUBS AND HEDGE PLANTING SHOULD BE IN PITS AT LEAST 200MM DEEP WITH POTTING COMPOST AROUND EACH SHRUB.

FOUL WATER
 SITE BOUNDARY
 STORM WATER

EXISTING POULTRY UNIT
 PROPOSED POULTRY UNIT
 CONCRETE STREET

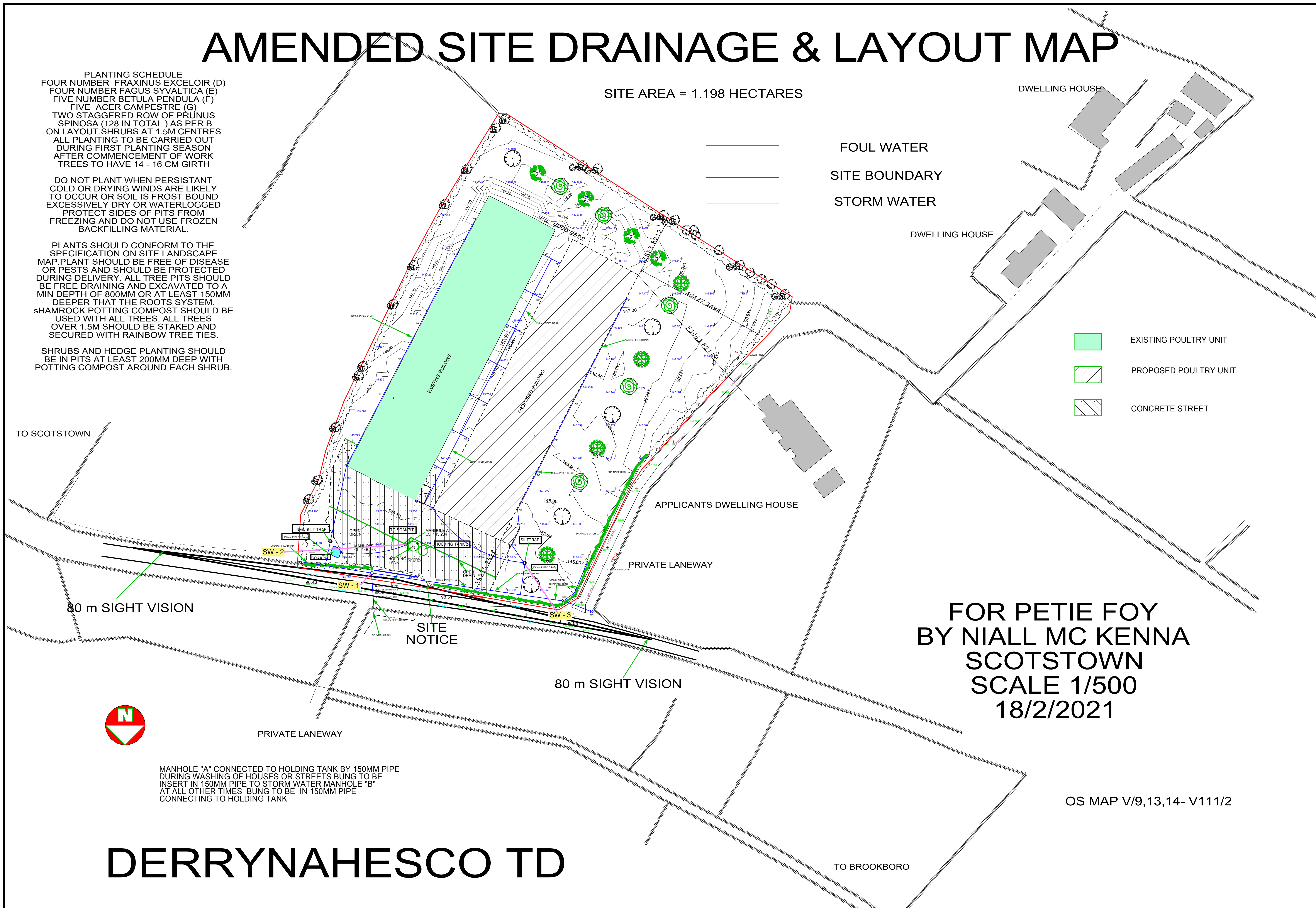

FOR PETIE FOY
 BY NIAL MC KENNA
 SCOTSTOWN
 SCALE 1/500
 18/2/2021

OS MAP V/9,13,14- V111/2

MANHOLE "A" CONNECTED TO HOLDING TANK BY 150MM PIPE
 DURING WASHING OF HOUSES OR STREETS BUNG TO BE
 INSERT IN 150MM PIPE TO STORM WATER MANHOLE "B"
 AT ALL OTHER TIMES BUNG TO BE IN 150MM PIPE
 CONNECTING TO HOLDING TANK

DERRYNAHESCO TD