

- LEGEND**
- SITE BOUNDARY
 - LANDS UNDER THE CONTROL OF THE LANDOWNER
 - ESB WAYLEAVES
 - CRUISERATH 220KV SUB STATION
 - CAMPUS BOUNDARY FENCE

ORDNANCE SURVEY MAP DETAILS:

Publication / Source: Ordnance Survey Ireland (OSI)

OSI Eire / Area of Interest (AOI):

LLA.LLV: 707160.5076 741383.2995
 LRX.LRY: 708091.0984 741383.2995
 LLA.LLV: 707160.5076 742168.2019
 LRX.LRY: 708091.0984 742168.2019

Projection / Spatial Reference:
 Projection: IRENET95_ Irish_Transverse_Mercator

Centre Point Coordinates:
 X,Y: 707596.0130 741775.7507

Reference Frame:
 Map Series / Map Sheets:
 1:1,000 / 3051-C
 1:1,000 / 3051-D
 1:1,000 / 3051-E

License / Copyright:
 Ordnance Survey Ireland Terms of Use apply.
 Please visit www.osi.ie/about/terms-conditions.

© Ordnance Survey Ireland, 2021

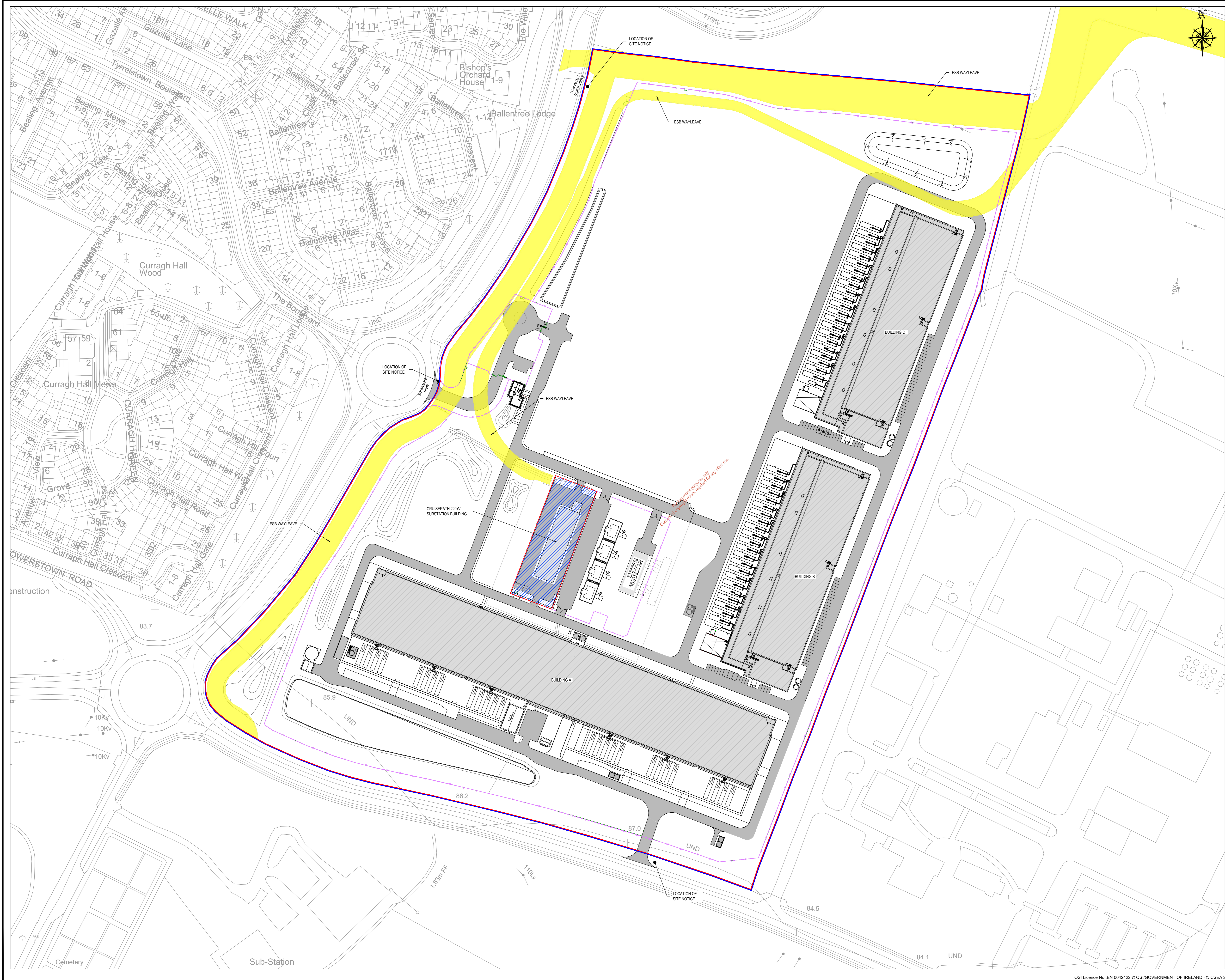

NOTE:
 DRAWINGS ARE NOT TO BE SCALE
 DRAWINGS ARE FOR THE PROPOSED EPA LICENCE
 NOT FOR CONSTRUCTION

Rev	Description	Drawn	Checked	Date
C01	EPA-ISSUE	DM	PM	14.04.2022
P01	FOR COMMENT	DM	PM	08.04.2022

Clifton Scannell Emerson Associates

Clifton Scannell Emerson Associates Limited
 Consulting Engineers,
 3rd Floor The Applegreen,
 Bishops Point, Parnley Road,
 Don Laoghaire, Co. Dublin,
 Ireland. A68 0028

T: +353 1 288 5000
 F: +353 1 283 3465
 E: info@csesa.ie
 W: www.csesa.ie

ADSIL

Client: **CRUISERATH DC CAMPUS**

Project: **SITE LOCATION PLAN**

Drawn By: **DM** Date: **APRIL 2022** Scale: **1:1000 @ A0** **21_123**

Checked By: **PM** Scale: **1:1000 @ A0** **CSEA Job No.**

Project Code	Originator	Scale	Phase	Level	Type	Rev	Desc. No.
21_123H - CSE - 00 - XX - DR - C - 0001							

S2 FOR INFORMATION
 Status Code: **S2** Submittal Description

C01 EPA-LICENCE
 Revision: **C01** Project Status