

"APPLICATION TO THE ENVIRONMENTAL PROTECTION AGENCY FOR A LICENCE"

Site Notice

Notice is hereby given in accordance with the E.P.A. Acts 1992 to 2013, as amended that Mr. Jerry McAuliffe, Appletown, Feohanagh, Co. Limerick intends to apply to the Environmental Protection Agency (E.P.A.) for a Licence for his poultry farm at Appletown, Feohanagh, Co. Limerick.

This enterprise is classed as:

Activity Class 6.1 (a) 'The rearing of poultry in installations where the capacity exceeds 40,000 places.'

An Environmental Impact Assessment Report relating to this activity, which has previously been submitted to Limerick County Council, will be submitted to the Agency as part of this application.

The environmental impact assessment report submitted to the Agency in accordance with section 83(2A)(d) of the Act of 1992, any information provided to the Agency under paragraph (e) or (f)(ii)(II) of section 83(2A) of the Act of 1992, any opinion issued by the Agency under section 83(2A)(de) of the Act of 1992 on the scope of the environmental impact statement, and any further information, including reports and advice relating to the environmental impact assessment as may be furnished to the Agency in the course of the Agency's consideration of the application, shall each be made available on the Agency's website and at the headquarters of the Agency.

Submissions may be made in writing to the Agency in relation to the likely effects on the environment of the proposed activity within the period specified by the Agency on its website under Regulation 4(2)(c), and in accordance with section 87(2) of the Act of 1992, a proposed determination shall be published by the Agency on its website.

A copy of the application for the licence may be inspected on the Agency's website or inspected at or obtained from the headquarters of the Agency as soon as is practicable after the receipt by the Agency of the application for the licence.

Signed:  (on behalf of applicant)

Signed: Paraic Fay B.Agr.Sc.,

CLW

Environmental Planners Ltd.,

The Mews,

23 Farnham St.,

Cavan.

Date of erection of Site Notice: 7th April 2022

CLW Environmental Planners Ltd.

The Mews,
23 Farnham Street,
Cavan,
Co. Cavan

Phone: 049-4371447/9

Fax: 049-437 1451

E-mail: info@clw.ie

Planning Dept.,
Floor 1
Limerick City and County Council
Dooradoyle Road
Dooradoyle
Limerick
V94 WV78

7th April 2022

Re: APPLICATION TO THE ENVIRONMENTAL PROTECTION AGENCY FOR A LICENCE

Dear Sir/Madame,

Notice is hereby given in accordance with the E.P.A. Acts 1992 to 2013, as amended that Mr. Jerry McAuliffe, Appletown, Feohanagh, Co. Limerick intends to apply to the Environmental Protection Agency (E.P.A.) for a Licence for his poultry farm at Appletown, Feohanagh, Co. Limerick.

This enterprise is classed as: Activity Class 6.1 (a) 'The rearing of poultry in installations where the capacity exceeds 40,000 places.'

An Environmental Impact Statement relating to this activity, which has previously been submitted to Limerick County Council, will be submitted to the Agency as part of this application.

The environmental impact statement submitted to the Agency in accordance with section 83(2A)(d) of the Act of 1992, any information provided to the Agency under paragraph (e) or (f)(ii)(II) of section 83(2A) of the Act of 1992, any opinion issued by the Agency under section 83(2A)(de) of the Act of 1992 on the scope of the environmental impact statement, and any further information, including reports and advice, relating to the environmental impact assessment as may be furnished to the Agency in the course of the Agency's consideration of the application, shall each be made available on the Agency's website and at the headquarters of the Agency.

Submissions may be made in writing to the Agency in relation to the likely effects on the environment of the proposed activity within the period specified by the Agency on its website under Regulation 4(2)(c), and in accordance with section 87(2) of the Act of 1992, a proposed determination shall be published by the Agency on its website.

A copy of the application for the licence may be inspected on the Agency's website or inspected at or obtained from the headquarters of the Agency as soon as is practicable after the receipt by the Agency of the application for the licence.

Should you have any queries in relation to this, or, require any further information please do not hesitate to contact me at the above number.

Yours faithfully,

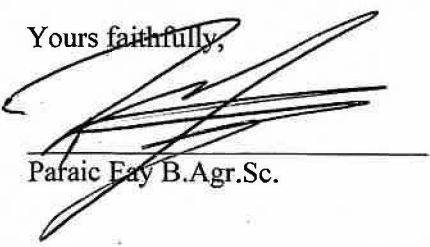
Páraic Fay B.Agr.Sc.

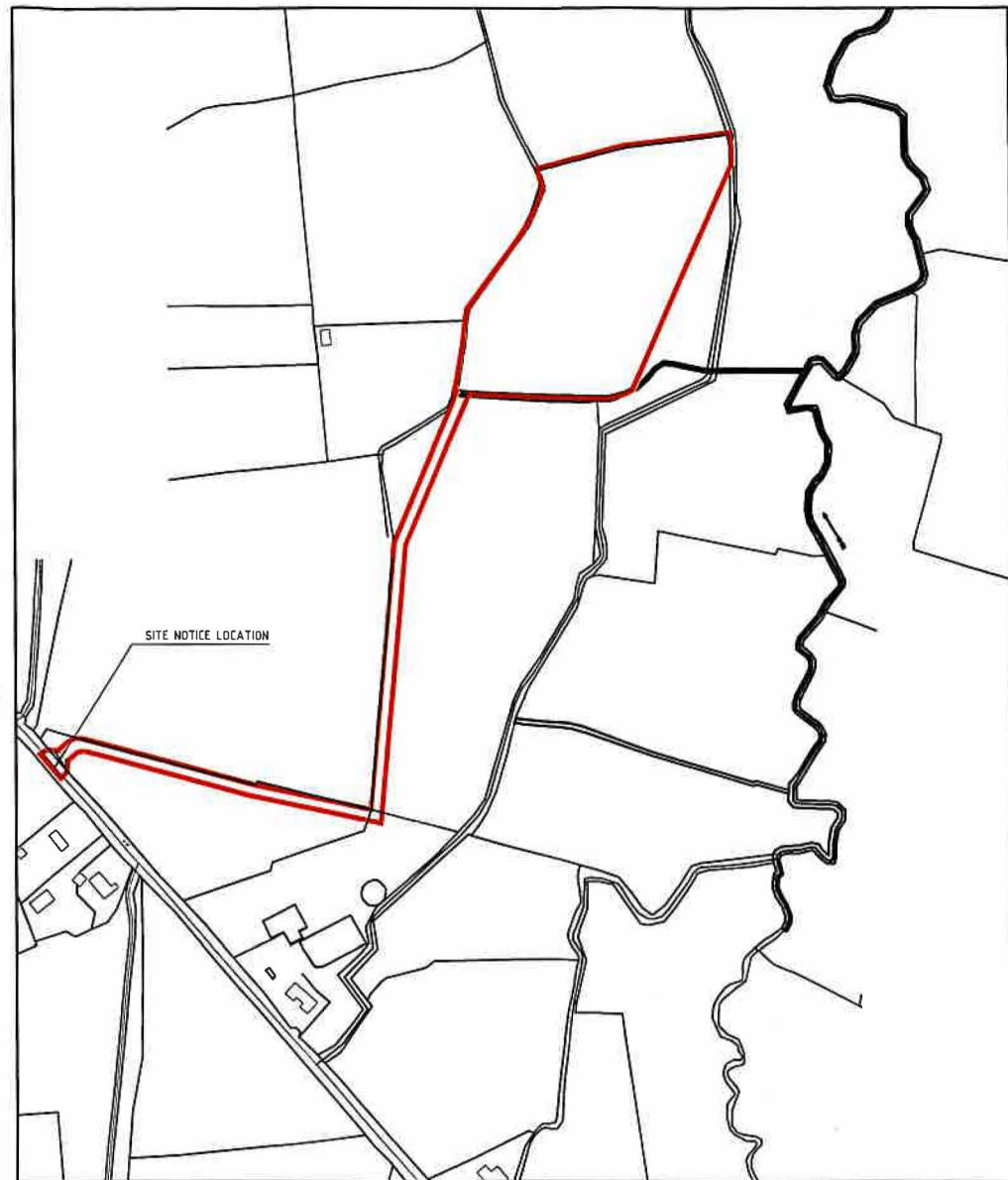

SITE LOCATION MAP
Scale 1:2,500

Output Format:
DWG_35_LEVEL

Output File:
V_00_25312041_00000001.DWG

Map Series:
1:5000

5287
REVISION DATE = 27-Mar-2015
SURVEY DATE = 31-Jul-2000

5347
REVISION DATE = 27-Mar-2015
SURVEY DATE = 31-Jul-2000

Clip Extent:
LLX,LLY = 533390,627020
LRX,LRY = 533972,627020
ULX,ULY = 533390,627450
URX,URY = 533972,627450

Projection:
ITM

ITM Centre Point Co-ordinate:
X,Y = 533681,627235

Extraction Date:
03-Nov-2017

Copyright:
© Suirbhéireacht Ordoánais Éireann, 2017
© Ordnance Survey Ireland, 2017

Copyright:
© Suirbhéireacht Ordoánais Éireann, 2010
© Ordnance Survey Ireland, 2010

Arna thiomáil agus arna thaisiú ag Suirbhéireacht Ordoánais Éireann, Péirc on Fhionnuisce, Baile Átha Cliath 8, Éire. Compiled and published by Ordnance Survey Ireland, Phoenix Park, Dublin 8, Ireland.

Sráiríonn aldigeodh neamhdáraithe cúlpeacht Shuirbhéireacht Ordoánais Éireann agus Rialtas na hÉireann. Unauthorised reproduction infringes Ordnance Survey Ireland and Government of Ireland copyright.

Gach ceod ar cosnamh. Ní ceadmhach oon chuid den fhaisicéadán seo a chloipeáil, a aldigeodh nó a tharchur in oon fhaírm nó ar oon bhealach gan cead i scríbhinn roimh ré ó áineisí an chloipeáir.

All rights reserved. No part of this publication may be copied, reproduced or transmitted in any form or by any means without the prior written permission of the copyright owners.

Ní hionann béithir, bealach nó cosán a bheith ar an léarscáil seo agus fianaise ar chuid sli. The representation on this map of a road, track or footpath is not evidence of the existence of a right of way.

Ní thaispeánann léarscáil de chúid Ordoánais Shuirbhéireacht na hÉireann taobann phointí deacthúil de mháin riabh, nó áineireacht de ghnéithe thaiscúla. Ordnance Survey maps never show legal property boundaries, nor do they show ownership of physical features.

Output Format:
DWG_35_LEVEL

Output File:
V_00_25316218_00000001.DWG

Map Series:
1:5000

5287
REVISION DATE = 27-Mar-2015
SURVEY DATE = 31-Jul-2000

5347
REVISION DATE = 27-Mar-2015
SURVEY DATE = 31-Jul-2000

Clip Extent:
LLX,LLY = 533283,626639
LRX,LRY = 533865,626639
ULX,ULY = 533283,627069
URX,URY = 533865,627069

Projection:
ITM

ITM Centre Point Co-ordinate:
X,Y = 533574,626854

Extraction Date:
20-Dec-2017

Copyright:
© Suirbhéireacht Ordoánais Éireann, 2017
© Ordnance Survey Ireland, 2017

Copyright:
© Suirbhéireacht Ordoánais Éireann, 2010
© Ordnance Survey Ireland, 2010

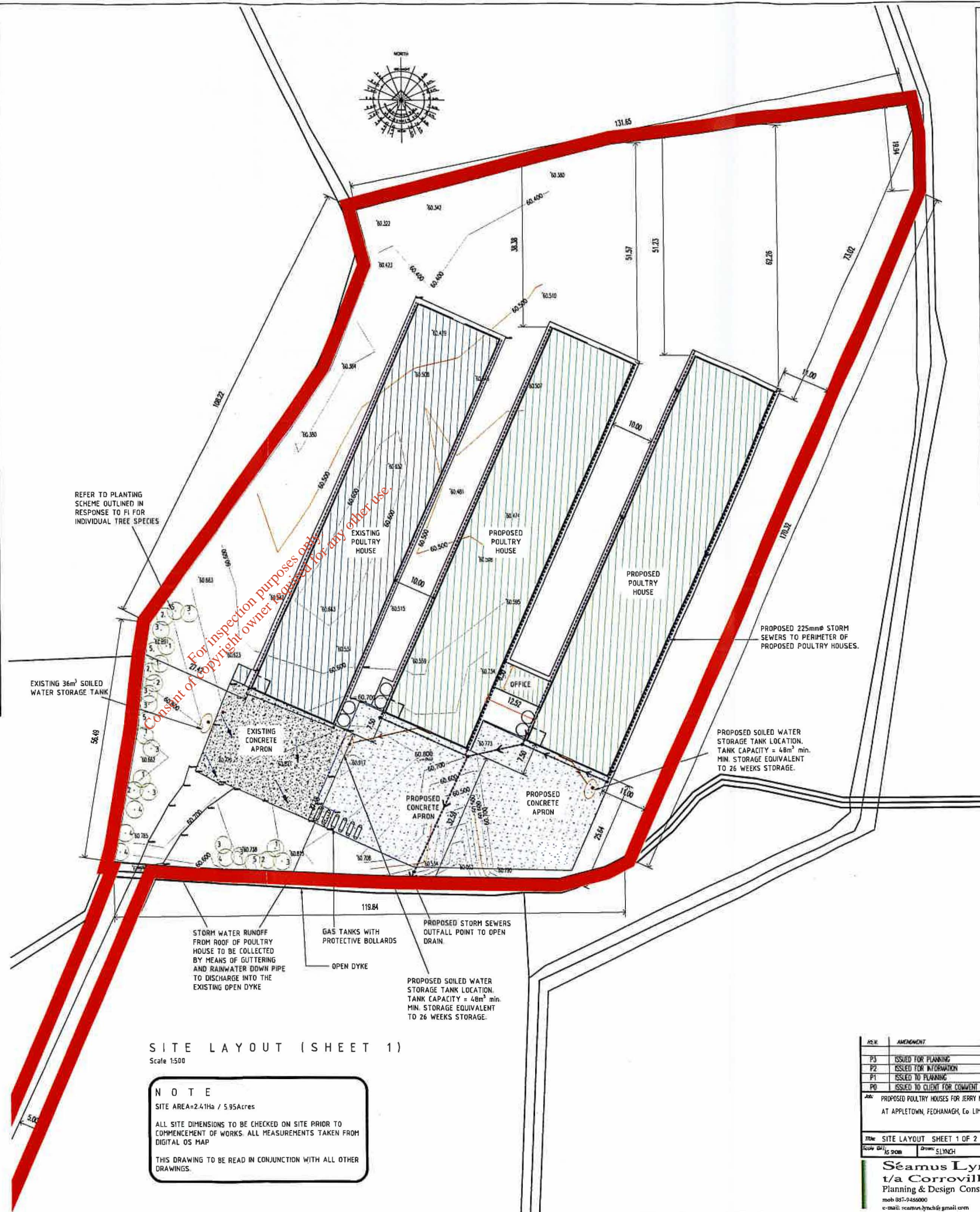

SITE LAYOUT (SHEET 1)
Scale 1:500

NOTE
SITE AREA=2.41Ha / 5.95Acres
ALL SITE DIMENSIONS TO BE CHECKED ON SITE PRIOR TO COMMENCEMENT OF WORKS. ALL MEASUREMENTS TAKEN FROM DIGITAL OS MAP
THIS DRAWING TO BE READ IN CONJUNCTION WITH ALL OTHER DRAWINGS.

- notes
1. This drawing and any design hereon is the copyright of the consultant and must not be reproduced without his/her written consent. All drawings remain the property of the consultant.
 2. Figured dimensions only to be taken from this drawing. All dimensions to be checked on site.
 3. Consultant to be informed immediately of any discrepancies before work proceeds.
 4. The builder must be registered with the national house building guarantee scheme and willing to be built under some n.h.b.g.s. hq guarantee certificate to be issued to client upon completion. All work to be supervised and passed by site engineer appointed by client.
 5. All building construction, materials and specifications to comply with the current building regulations and the department of the environmental recommendations.
 6. These drawings are to be used as planning drawings only.
 7. Electrical installation as per electrical sub-contractor's drawings and specifications.
 8. Plumbing and heating installation as per plumbing & heating sub-contractor's drawings and specifications.
 9. Fire detection and alarm system type kit to be installed in accordance with BS58: part 5: 1995.
 10. All internal & external doorways to comply with the current building regulations part m access for people with disabilities.
 11. Location of bathroom ware within dimensions to comply with the current building regulations part m access for people with disabilities.
 12. All window openings to comply with part m of current building regulations-Fire safety.
 13. All insulation in floors,walls, ceiling & roof to comply with part l of the current building regulations.
- NOTE
All construction & workmanship to comply with current building regulations compliance with these regulations will be the responsibility of the engineer appointed by the client for the supervision of the works during construction and the nominated building contractor.
- NOTE
These drawings are issued for the purpose of a planning application only and may not contain all of the information and specifications necessary for construction.

REV	AMENDMENT	BY	DATE
P3	ISSUED FOR PLANNING	SL	18-03-2021
P2	ISSUED FOR INFORMATION	SL	15-02-2021
P1	ISSUED TO PLANNING	SL	16-06-2018
P0	ISSUED TO CLIENT FOR COMMENT	SL	30-12-2017

JOB: PROPOSED POULTRY HOUSES FOR JERRY KEALIFFE AT APPLETON, FECHANAGH, Co LIMERICK

Scale: 1:5000
Date: 15/08/2017
Drawn: LYNCH
Sheet No: 001
Rev: P3

Séamus Lynch
t/a Corroville Designs.
Planning & Design Consultant
mob: 087-9456900
e-mail: seamus.lynch@icloud.com

Bhailé Killeeshil Co. Limerick

"APPLICATION TO THE ENVIRONMENTAL PROTECTION AGENCY FOR A LICENCE"

Notice is hereby given in accordance with the E.P.A. Acts 1992 to 2013, as amended that Mr. Jerry McAuliffe, Appletown, Feohanagh, Co. Limerick intends to apply to the Environmental Protection Agency (E.P.A.) for a Licence for his poultry farm at Appletown, Feohanagh, Co. Limerick.

This enterprise is classed as:
Activity Class 6.1 (a) "The rearing of poultry in installations where the capacity exceeds 40,000 places."

An Environmental Impact Assessment Report relating to this activity, which has previously been submitted to Limerick County Council, will be submitted to the Agency as part of this application.

The environmental impact assessment report submitted to the Agency in accordance with section 83(2A)(d) of the Act of 1992, any information provided to the Agency under paragraph (e) or (f)(ii)(II) of section 83(2A) of the Act of 1992, any opinion issued by the Agency under section 83(2A)(de) of the Act of 1992 on the scope of the environmental impact statement, and any further information, including reports and advice, relating to the environmental impact assessment as may be furnished to the Agency in the course of the Agency's consideration of the application, shall each be made available on the Agency's website and at the headquarters of the Agency.

Submissions may be made in writing to the Agency in relation to the likely effects on the environment of the proposed activity within the period specified by the Agency on its website under Regulation 4(2)(c), and in accordance with section 87(2) of the Act of 1992, a proposed determination shall be published by the Agency on its website.

A copy of the application for the licence may be inspected on the Agency's website or inspected at or obtained from the headquarters of the Agency as soon as is practicable after the receipt by the Agency of the application for the licence.

Signed: Paraic Fay B.Agr.Sc.,



Environmental Planners Ltd.,
The Mews,
23 Farnham St.,
Cavan.

*For inspection purposes only.
Consent of copyright owner required for any other use.*