

This Report has been cleared for submission to the Board by Programme Manager: Marie O'Connor

Signed: Gráinne Dgleasby Date: 2nd September 2021

	OFFICE OF ENVIRONMENTAL SUSTAINABILITY
INSPECTOR'S REPORT ON AN WASTE LICENCE APPLICATION, LICENCE REGISTER NUMBER W0303-01	
TO: DIRECTOR	
FROM: JIM JOHNSON	DATE: 08 OCTOBER 2021
Applicant:	Dublin City Council
CRO number:	Not applicable
Location/address:	Ballymun Recycling Centre, St. Margaret's Road, Ballymun, Dublin 11
Application date:	19 June 2019
Classes of Activity (under Waste Management Act 1996 as amended):	<p>D13 Blending or mixing prior to submission to any of the operations numbered D 1 to D 12 (if there is no other D code appropriate, this can include preliminary operations prior to disposal including pre-processing such as, amongst others, sorting, crushing, compacting, pelletising, drying, shredding, conditioning or separating prior to submission to any of the operations numbered D1 to D12)</p> <p>D14 Repackaging prior to submission to any of the operations numbered D 1 to D 13</p> <p>D15 Storage pending any of the operations numbered D 1 to D 14 (excluding temporary storage (being preliminary storage according to the definition of 'collection' in section 5(1)), pending collection, on the site where the waste is produced).</p> <p>R03 Recycling/reclamation of organic substances which are not used as solvents (including composting and other biological transformation processes), which includes gasification and pyrolysis using the components as chemicals</p> <p>R04 Recycling/reclamation of metals and metal compounds</p> <p>R05 Recycling/reclamation of other inorganic materials, which includes soil cleaning resulting in recovery of the soil and recycling of inorganic construction materials</p>

<p>R12 Exchange of waste for submission to any of the operations numbered R 1 to R 11 (if there is no other R code appropriate, this can include preliminary operations prior to recovery including pre-processing such as, amongst others, dismantling, sorting, crushing, compacting, pelletising, drying, shredding, conditioning, repackaging, separating, blending or mixing prior to submission to any of the operations numbered R1 to R11)</p> <p>R13 Storage of waste pending any of the operations numbered R 1 to R 12 (excluding temporary storage (being preliminary storage according to the definition of 'collection' in section 5(1)), pending collection, on the site where the waste is produced)". [Principal Activity]</p>	
Main BAT Note:	Final Draft BAT Guidance Note on Best Available Techniques for the Waste Sector: Waste Transfer and Materials Recovery December 2011
Activity description/background:	Operation of a civic amenity for the reception and temporary storage of household waste for recovery.
Additional information received:	Yes (22 June 2021, 13 July 2021)
No of submissions received:	1
Environmental Impact Assessment required: No	Stage 2 Appropriate Assessment required: No
Site visit: None	Site notice check: 13 August 2019

1. Introduction

Dublin City Council (DCC) has applied to the Agency for a Waste licence to operate a civic amenity (Ballymun Recycling Centre) that will be open to the public for the reception of household waste for recycling. The civic amenity will be located within a new operations depot being developed by DCC, at St. Margaret's Road, Ballymun, to consolidate its operations for the north of the city (Site Layout Appendix 1).

The depot will include a second waste facility to handle waste from DCC daily operations such as litter bin collection, street cleaning road and housing maintenance. This facility will be authorised and operated separately to the civic amenity and is subject to a separate waste licence application, Register Number: W0302-01.

In determining the appropriate authorisation for the civic amenity, reference was made to the Waste Management (Facility Permit and Registration) Regulations 2007, as amended. Part II of the Third Schedule of the Regulations lists the classes of activity subject to a registration with local authority or the Agency provided that – '(1) the activity is not an activity which is carried on adjacent to, a facility at which a licensable activity is being carried on by the same legal entity'. Having regard to the above, it was determined that the civic amenity be submitted for a waste licence authorisation.

2. Description of activity

The facility will occupy an area of 0.45 ha at the western end of the operations depot at St. Margaret's Road, Ballymun, Dublin 11 (Site Location Appendix 1). The site is a greenfield site owned by Dublin City Council but within Fingal County Council administrative area. The depot site is bounded to the north and east by St. Margaret's Road – an urban dual carriageway. The IKEA retail store and car park are across the road to the north. There is a mixture of residential development (Carton Way/Drive/Close, St. Margaret's halting site) and industrial development (Ballymun Industrial Estate) to the south. The facility will be surrounded by a 3m high wall, rising to 5m at the civic amenity office.

The civic amenity site will be open to the public for reception of household waste for recovery — commercial waste or mixed municipal (black-bag) waste will not be accepted. A list of waste types to be accepted is given in Appendix 2. The facility will accept food and green waste to be transferred off site for composting and/or anaerobic digestion. Staff will be present at a facility office near the entrance to inspect incoming waste.

The original application was for a maximum waste acceptance of 5,000 tonnes per year, which was the amount considered in the EIA screening. This amount was subsequently revised to 3,000 tonnes per year. The 3,000 tonnes will include up to 300 tonnes of hazardous waste. Hazardous waste includes batteries, waste electronic and electrical equipment (WEEE), paint, aerosols and household chemicals. The waste amounts are based on similar civic amenities run by DCC.

The facility will consist of storage receptacles which - mainly open and enclosed skips and closed drums and containers for liquids. Parking bays are provided for members of the public while depositing waste in the appropriate receptacles. A quarantine area will be used for temporary storage of unsuitable waste. Waste operations will include basic sorting and compaction. The skips and containers storing waste will be removed off site by authorised waste contractors.

There will be separate entrances for the public and operational vehicles. The public will access the civic amenity via Carton Way to the southwest. Operational vehicles removing waste from the civic amenity, will leave the civic amenity via an internal gate connecting to the main part of the depot. These vehicles will then exit the depot to the north onto St. Margaret's Road (Site Layout Appendix 1).

It is anticipated that the majority of waste will be suitable for recycling off-site; however, in the event that this is not possible it will be sent for disposal. The applicant has requested disposal activities (D13, D14, D15) to allow for the temporary storage and handling of waste in this instance.

Proposed hours of operation are 09:00 to 17:00 (Monday to Wednesday), 09:00 to 18:00 (Thursday to Friday) and 09:00 to 16:00 (Saturdays and Bank Holidays).

3. Planning Status

Planning permission was granted by Fingal County Council (FCC) on 10th January 2018 (Reg. Ref. F17A/0686) for the development of an operations depot at St. Margaret's Road, Ballymun, Dublin 11, including a civic amenity. Details of the planning application and permission have been provided in the application form. Fingal County Council has confirmed that EIA has not been carried out by them for any part of the area within the facility boundary.

4. EIA Screening

In accordance with Section 40(2A) of the Waste Management Act 1996 as amended, the Agency must ensure that before a licence or revised licence is granted, that the application is made subject to an environmental impact assessment (EIA), where the activity meets the criteria outlined in Section 40(2A)(b) and 40(2A)(c).

In accordance with the EIA Screening Determination, the Agency has determined that the activities are not likely to have a significant effect on the environment, and accordingly an EIA is not required.

The activity is below the specified threshold of project type 11(b) in Part 2 of Schedule 5 of the Planning and Development Regulations 2001 as amended: *Installations for the disposal of waste with an annual intake greater than 25,000 tonnes not included in Part 1 of this Schedule.*

Having considered the information provided by the applicant, which satisfies the requirements of Annex II A of the EIA Directive, and the mitigation measures proposed by the applicant, it has been determined that the activity is not likely to give rise to significant effects on the environment by virtue of its nature, size and location. This determination has been made having regard to the following:

- The scale of the activity; permission is sought to accept up to 5,000 tonnes of waste per annum which is significantly below the EIA threshold of 25,000 tonnes for waste disposal/recovery (Part 2 of Schedule 5 of the Planning and Development Regulations 2001, as amended).

- The potential risk to the environment from an incident at the site is low. The civic amenity facility will receive household recyclable waste for onward transfer and recovery – there will be no waste processing operations on site.
- The activity will not generate significant dust, noise or odour emissions.
- There will be no discharges to surface waters – storm water will discharge to a storm water drain via a silt trap and fuel/oil bypass separator.
- There are no environmentally sensitive areas in the vicinity likely to be affected.
- The cumulative effect with other existing and/or approved projects will not be significant.

5. Best Available Techniques

I consider that the applicable BAT requirements are addressed through the technologies and techniques as described in the application, as well as the conditions and limits specified in the RD.

6. Emissions

There are no channelled emissions to air or process emissions to surface water, groundwater or foul sewer. This section addresses dust, odour and noise emissions and the discharge of storm water from the site.

6.1 Emissions to Air

This section addresses emissions to air from the facility and the environmental impact of those emissions.

6.1.1 Channelled Emissions to Air

There are no channelled emissions to air.

6.1.2 Fugitive Emissions

Fugitive emissions are unlikely to be significant given the nature of the activity and the quantity and type of waste accepted.

6.1.3 Dust

Dust generation is associated mainly with vehicle movements within the facility during dry weather. The waste itself will not be dusty and minimising dust formation is mainly a function of good housekeeping at the facility and keeping the concrete surface in a clean condition. The applicant proposes regular cleaning of the facility to mitigate dust arising.

The RD specifies the following conditions related to dust prevention and control:

Condition 5.3 of requires that no emissions, including odours and dust, from the activities carried on at the site shall result in an impairment of, or an interference with amenities or the environment beyond the facility boundary or any other legitimate uses of the environment beyond the facility boundary.

Condition 6.15 requires that in dry weather site roads and any other areas used by vehicles be sprayed with water as and when required to minimise dust nuisance.

Condition 6.16 requires that the licensee shall, at a minimum of one-week intervals, inspect the facility and its immediate surrounds for nuisances caused by litter, vermin, birds, flies, wasps, mud, dust and odours and maintain a record of all such inspections.

6.1.4 Odour

Odour is not likely to be a significant issue as the facility will mainly accept dry mixed recyclable waste which is not odorous. No odour complaints have been recorded for a similar facility at Ringsend (Certificate of Registration R02651-01). Odour will be controlled by appropriate procedures for waste acceptance, storage and handling.

The RD specifies the following control conditions related to odour:

Condition 2.2.2 requires the licensee as part of the Environmental Management System (EMS) to include an evaluation of practicable options for odour and noise management.

Condition 5.3 specifies that no emissions, including odours and dust, from the activities carried on at the site shall result in an impairment of, or an interference with amenities or the environment beyond the facility boundary or any other legitimate uses of the environment beyond the facility boundary.

Condition 6.16 specifies that the licensee shall, at a minimum of one-week intervals, inspect the facility and its immediate surrounds for nuisances caused by litter, vermin, birds, flies, wasps, mud, dust and odours. The licensee shall maintain a record of all such inspections.

Condition 8.10 specifies waste acceptance and characterisation procedures that need to be in place and that only household recyclable waste shall be accepted at the facility.

Condition 8.12 requires the licensee to implement a Waste Storage Plan to include limitations, as may be necessary, on waste storage arrangements to be used to prevent odours arising.

6.2 Emissions to Water/Ground

6.2.1 Emissions to Surface Waters

There are no process emissions to waters at the facility.

6.2.2 Emissions to ground/groundwater

There are no process emissions to ground/groundwater at the facility.

6.2.3 Other emissions to ground/groundwater

There are no other process emissions to ground or groundwater.

6.3 Storm water discharges

The table below gives details on the facility's storm water discharges to waters; the sources of potential contamination of these discharges, the type of on-site abatement as well as details of the receiving water.

Stormwater discharge point details					
Emission Reference	Monitored parameters (monitoring frequency)	Abatement	Drainage areas	Discharging to	Trigger levels established (Y/N)
SWM1 (Proposed)	Visual Inspection/Odour (Weekly); Suspended solids, Total Organic Carbon (TOC) (Biannually). (RD Schedule C.2.3)	Class I by-pass oil interceptor Silt trap (required by RD)	Roadways, footpaths, buildings, yards, car parks.	Storm sewer	N
Automatic diversion in place:		No			

The RD requires the applicant to maintain the storm water/drainage system and silt traps and oil separators. The RD also requires that the storm water discharge is visually inspected weekly and monitored for Suspended Solids and Total Organic Carbon and that suitable trigger levels are established for these parameters.

The RD contains standard conditions in relation to the storage and management of materials and wastes. The RD also requires that accident and emergency response procedures are put in place. The controls pertaining to accidents and emergencies are addressed in Prevention of Accidents section later in this report.

6.4 Noise

The main sources of noise at the proposed facility are traffic movements and waste operations on site e.g. use of compaction equipment, loading/unloading waste.

Noise modelling was used by the applicant to predict worst-case impacts of noise sources from the proposed facility at nearby sensitive locations. Noise levels for operational activities (compactors, vehicle movements, unloading of materials etc) were obtained from measurements at an existing depot as well as from published data. The results indicated that the potential impact is low, and within the standard noise emission limit values in the RD.

The applicant has proposed standard noise limit criteria for day, evening and night time hours. Standard, noise conditions and emission limit values, which apply at noise sensitive locations, have been included in the RD.

7. Waste generation

A small quantity of waste materials will be generated from operations and welfare activities. This will be managed in accordance with Section 21A of the Waste Management Act 1996, as amended. Condition 11.12 of the RD requires the licensee to maintain a record of waste management operations and practices at the site.

8. Energy Efficiency and Resource Use

The operation of the facility involves the consumption of fuel, water and electricity. Energy consumed at the facility will be from compaction equipment and the facility office. The estimated annual quantities are specified below.

Resource	Quantity per annum
Electricity	4000 kWh
Natural Gas	590 m ³
Water (public water supply)	543 m ³

The applicant will employ a number of measures to maximise the efficient use of energy within the facility; waste compaction equipment will be maintained in good working order and serviced on a regular basis to ensure it is operating efficiently. Energy efficiency was incorporated in the design of the civic amenity office e.g. by including insulation.

In the application of BAT, Condition 7 of the licence provides for the efficient use of resources and energy in all site operations. It requires an energy audit to be carried out and repeated at intervals as required by the Agency and the recommendations of the audit to be incorporated into the Schedule of Environmental Objectives and Targets as outlined in Condition 2 of the licence.

Condition 3.2 of the RD requires that the applicant shall have regard to energy efficiency when choosing and/or designing any new plant/infrastructure.

9. Prevention of Accidents

A certain amount of accident risk is associated with the licensable activities. Details of potential accidents and measures for their prevention are outlined below.

Potential accidents & measures for prevention/limitation of consequences	
Potential for an accident or hazardous/emergency situation to arise from activities at the facility	<p>Potential for fire due to the quantity and characteristics of the waste stored at the facility.</p> <p>Accidental spillage/leakage of fuels, oil or other liquids from waste stored or vehicles at the facility.</p> <p>Infiltration to ground in the event of accidental leakages of waste liquids (oils, household chemicals).</p>
Preventative/Mitigation measures to reduce the likelihood of accidents and mitigate the effects of the consequences of an accident at the facility	<p>All areas of the site will be within 46m of a fire hydrant</p> <p>Limit on the quantity of waste stored at the facility.</p> <p>Waste acceptance procedure to reject unacceptable waste.</p> <p>Provision of spill kits to include absorbent material to protect surface water drains.</p> <p>Staff training in the appropriate use of spill kits and management of contaminated absorbents.</p> <p>Facility access roads and operational waste areas will be constructed of impervious materials.</p> <p>Storage of liquid wastes on hardstanding areas and in bunded containers.</p>

	<p>Provision of bypass fuel/oil separator in the stormwater drainage network.</p> <p>The provision and maintenance of hardstanding areas where waste is handled.</p>
Additional measures provided for in the RD	<p>Requirement for an independent fire risk assessment to be carried out (Condition 9.5).</p> <p>Integrity of tanks to be assessed every 3 years and maintenance carried out as required (Condition 6.8)</p> <p>Storm water discharge points to be visually monitored weekly (Condition 6.11).</p>

Condition 9 of the RD requires procedures to be put in place to prevent accidents with a possible impact on the environment and to respond to emergencies so as to minimise the impact on the environment.

10. Cessation of Activity

A certain amount of environmental risk is associated with the cessation of any licensable activity (site closure). The applicant has provided a list of measures to be taken in the event of site closure/cessation of activity. These measures are listed in Attachment 9-3 ELRA CRAMP Requirements of the application form. Upon closure/cessation waste materials will no longer be accepted and all waste stored within skips and containers will be removed from the site by authorised waste contractors. Surface water and foul water drains will be cleaned, and residues removed from drainage channels, screens and interceptors. Upon completion of these activities there will be no materials at the facility with the potential for environmental pollution.

Condition 10 of the RD requires the proper closure of the activity with the aim of protecting the environment.

11. Fit & Proper Person

Technical Ability

The applicant has provided details of the qualifications, technical knowledge and experience of key personnel. The licence application also includes information on the on-site management structure. It is considered that the applicant has demonstrated the technical knowledge required.

Legal Standing

Neither the applicant nor any relevant person has relevant convictions under the Waste Management Act 1996, as amended, or under any other relevant environmental legislation.

ELRA, CRAMP and Financial Provision

The proposed facility was assessed for the requirements of Environmental Liabilities Risk Assessment (ELRA), Closure, Restoration and Aftercare Management Plan (CRAMP) and Financial Provision (FP), in accordance with Agency guidance. Under this assessment it has been determined that ELRA, CRAMP and FP were not required.

Fit & Proper Conclusion

It is my view that the applicant can be deemed a Fit & Proper Person for the purpose of this application.

12. Submission

There was one submission on this application. The main points raised in the submission are briefly summarised in the table below. The original submission should be referred to at all times for detail. The issues raised in the submission are noted and addressed in this Inspector's Report and the submission was taken into consideration during the preparation of the Recommended Decision (RD).

Submission		
1. Name & Position Mr Thomas Boland Environmental Health Officer	Organisation: HSE	Date received: 25 July 2019
Issues raised:	Agency response:	
Impact of noise during construction Impact of noise from facility operation	Condition 4.3 of the RD sets noise limits for the operation of the facility. Condition 6.12 requires noise surveys at a sensitive location as required by the Agency.	
Pest disturbance prior to construction and during facility operations Odour nuisance	Condition 5.5 of the RD requires the licensee to ensure that there are no impacts from vermin, birds, flies, mud or litter on the environment beyond the facility boundary. Condition 6.16 requires weekly inspections for nuisances caused by litter, vermin, birds, flies, wasps, mud, dust and odours. Condition 5.3 requires that no emissions, including odours and dust, from the activities impair amenities or the environment beyond the facility boundary. Waste accepted at the facility shall be for the purposes of recovery only (Condition 8).	
Air quality and road safety issues due to increased traffic into the site	Traffic is the remit of the Planning Authority.	
Risk of fire	Mitigation measures in relation to fire prevention are outlined in Section 9. Measures include limiting the amount and types of waste stored on site, provision of fire hydrants and training of staff in emergency response. The RD requires an independent fire risk assessment of the facility be carried out (Condition 9.5)	

13. Consultations

13.1 Cross Office Consultation

I consulted Mr. Larry Kavanagh, (Office of Environmental Enforcement) in relation to financial charges and Mr. Stuart Huskisson, (Office of Environmental Enforcement) in relation to financial provision for ELRA/CRAMP.

13.2 Transboundary Consultations

There were no transboundary consultations undertaken as there were no transboundary impacts identified.

14. Appropriate Assessment

Appendix 3 lists the European Sites assessed, their associated qualifying interests and conservation objectives.

A screening for Appropriate Assessment was undertaken to assess, in view of best scientific knowledge and the conservation objectives of the site, if the activities, individually or in combination with other plans or projects are likely to have a significant effect on any European Site. In this context, particular attention was paid to the European Sites at North Bull Island SPA (Site Code: 004006); South Dublin Bay and River Tolka Estuary SPA (Site Code: 004024); North Dublin Bay SAC (Site Code: 000206) and South Dublin Bay SAC (Site Code: 000210).

The activities are not directly connected with or necessary to the management of any European Site and the Agency considered, for the reasons set out below, that it can be excluded, on the basis of objective information, that the activities, individually or in combination with other plans or projects, will have a significant effect on any European Site and accordingly determined that an Appropriate Assessment of the activities was not required.

The reasons for this determination are as follows:

- The proposed facility is not located within or directly adjacent to any designated European Site; the nearest site is approximately 5.5 km away. As such, direct impacts on qualifying interests do not arise.
- There are no point emissions to air, ground, groundwater, surface water or foul sewer from the facility. Storm water is discharged to a storm water drain. As such there is unlikely to be significant impacts on air and marine water quality upon which the qualifying interests depend.
- There is no direct hydrological connection between the facility and European sites. The nearest surface water (Santry River) is 500m to the north, there are no surface waters at the site; all drains in the vicinity of the site are culverted. Groundwater percolation at the site is poor.
- The risk of environmental pollution arising from the facility is low due to the small scale of the activity, the type of waste to be accepted, the impermeable surfaces

where waste handling will take place, the sealed containers within which waste will be contained and the regular removal of waste off site.

15. EPA Charges

The annual enforcement charge recommended in the RD is €5,088, which reflects the anticipated enforcement effort required and the cost of monitoring.

16. Recommendation

The Agency, in considering an application for a licence or the review of a licence, shall have regard to Section 40 of the Waste Management Act 1996, as amended. The Agency shall not grant a licence or revised licence unless it is satisfied that emissions comply with relevant emission limit values and standards prescribed under regulation. In setting such limits and standards, the Agency must ensure they are established based on the stricter of both the limits and controls required under BAT, and those required to comply with any relevant environmental quality standard.

The RD specifies the necessary measures to provide that the facility shall be operated in accordance with the requirements of Section 40(4) of the Waste Management Act 1996 as amended and has regard to the AA Screening and EIA Screening. The RD gives effect to the requirements of the Management Act 1996, as amended and has regard to submissions made.

I recommend that a Proposed Determination be issued subject to the conditions and for the reasons as drafted in the RD.

Signed



Jim Johnson

Procedural Note

In the event that no objections are received to the Proposed Decision on the application, a licence will be granted in accordance with Section 43(1) of the Waste Management Act 1996 as amended, as soon as may be after the expiration of the appropriate period.

Appendices

Appendix 1 Site Layout

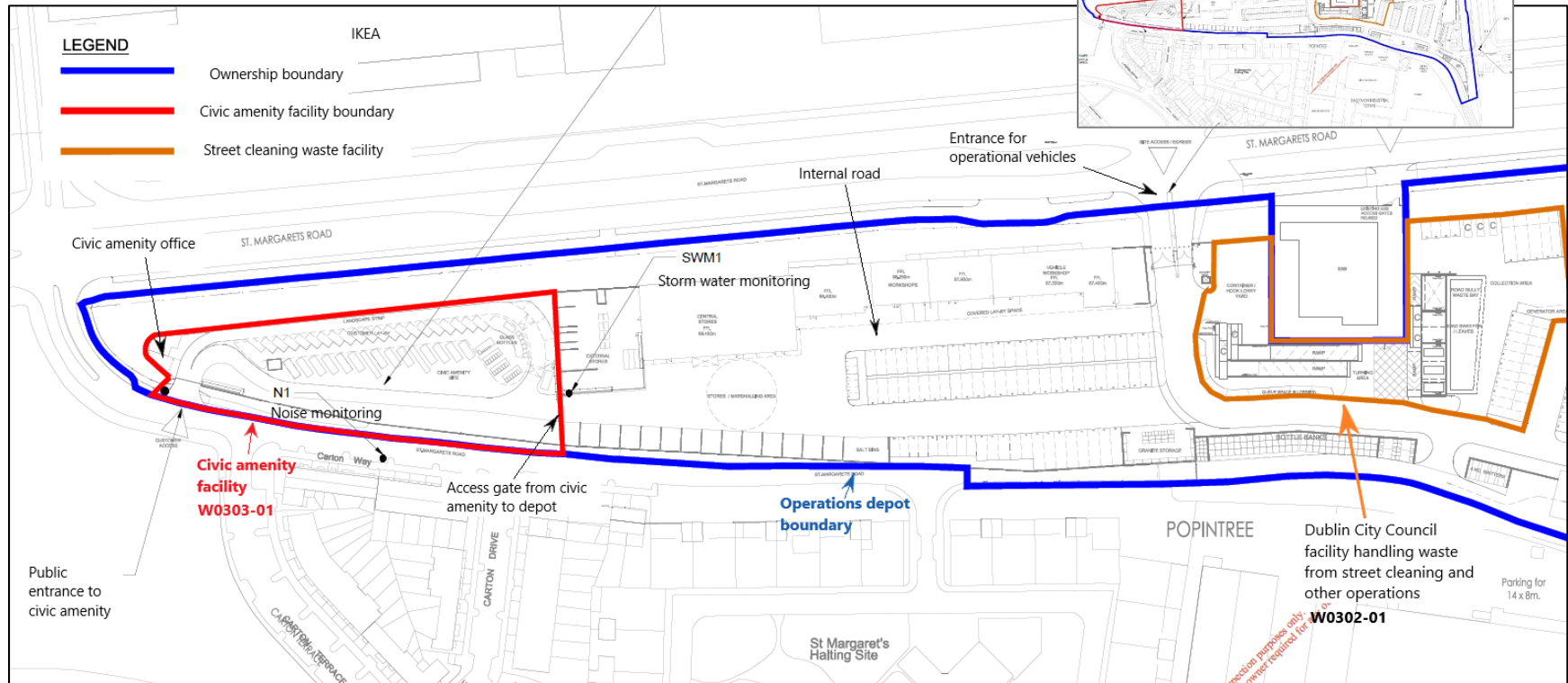

Site layout



Site location

Appendix 2 List of Waste codes included in the RD

Non-hazardous 'List of Waste' (LoW) Code and Description

LoW Codes	'List of Waste' Description
16 02 14	discarded equipment other than those mentioned in 16 02 09 to 16 02 13
16 05 05	gases in pressure containers other than those mentioned in 16 05 04
16 06 04	alkaline batteries (except 16 06 03)
16 06 05	other batteries and accumulators
17 01 01	concrete
17 01 02	bricks
17 01 03	tiles and ceramics
17 01 07	mixtures of concrete, bricks, tiles and ceramics other than those mentioned in 17 01 06
20 01 01	paper and cardboard
20 01 02	glass
20 01 08	biodegradable kitchen and canteen waste
20 01 10	clothes
20 01 11	textiles
20 01 25	edible oil and fat
20 01 28	paint, inks, adhesives and resins other than those mentioned in 20 01 27
20 01 30	detergents other than those mentioned in 20 01 29
20 01 34	batteries and accumulators other than those mentioned in 20 01 33
20 01 36	discarded electrical and electronic equipment other than those mentioned in 20 01 21, 20 01 23 and 20 01 35
20 01 38	wood other than that mentioned in 20 01 37
20 01 39	plastics
20 01 40	metals
20 02 01	biodegradable waste
20 02 02	soil and stones
20 02 03	other non-biodegradable wastes
20 03 07	bulky waste

Hazardous 'List of Waste' (LoW) Code and Description

LoW Codes	'List of Waste' Description
16 01 07*	oil filters
16 02 13*	discarded equipment containing hazardous components (3) other than those mentioned in 16 02 09 to 16 02 12
16 05 04*	gases in pressure containers (including halons) containing hazardous substances
16 06 01*	lead batteries
16 06 02*	Ni-Cd batteries
16 06 03*	mercury-containing batteries
20 01 14*	acids

20 01 15*	alkalines
20 01 19*	pesticides
20 01 21*	household waste fluorescent lamps and other mercury containing waste
20 01 23*	household waste fridges and freezers and other devices containing HCFC, HFC
20 01 26*	oil and fat other than those mentioned in 20 01 25
20 01 27*	paint, inks, adhesives and resins containing hazardous substances
20 01 29*	detergents containing hazardous substances
20 01 33*	batteries and accumulators included in 16 06 01, 16 06 02 or 16 06 03 and unsorted batteries and accumulators containing these batteries
20 01 35*	discarded electrical and electronic equipment other than those mentioned in 20 01 21 and 20 01 23 containing hazardous components (3)
20 01 37*	wood containing hazardous substances

Appendix 3 Appropriate Assessment

List of European Sites assessed, their associated qualifying interests and conservation objectives.

Site Code	Site Name	Qualifying Interests (* denotes priority habitat)	Conservation Objectives
000206	North Dublin Bay SAC	Habitats 1140 Mudflats and sandflats not covered by seawater at low tide 1210 Annual vegetation of drift lines 1310 Salicornia and other annuals colonising mud and sand 1330 Atlantic salt meadows (<i>Glauco-Puccinellietalia maritimae</i>) 1410 Mediterranean salt meadows (<i>Juncetalia maritimi</i>) 2110 Embryonic shifting dunes 2120 Shifting dunes along the shoreline with <i>Ammophila arenaria</i> (white dunes) 2130 Fixed coastal dunes with herbaceous vegetation (grey dunes)* 2190 Humid dune slacks Species 1395 Petalwort (<i>Petalophyllum ralfsii</i>)	NPWS (2013) Conservation Objectives: North Dublin Bay SAC 000206. Version 1. National Parks and Wildlife Service, Department of Arts, Heritage and the Gaeltacht.
000210	South Dublin Bay SAC	Habitats 1140 Mudflats and sandflats not covered by seawater at low tide 1210 Annual vegetation of drift lines 1310 Salicornia and other annuals colonising mud and sand 2110 Embryonic shifting dunes	NPWS (2013) Conservation Objectives: South Dublin Bay SAC 000210. Version 1. National Parks and Wildlife Service, Department of Arts, Heritage and the Gaeltacht.
004024	South Dublin Bay and River Tolka Estuary SPA	Birds A144 Sanderling (<i>Calidris alba</i>) A157 Bar-tailed Godwit (<i>Limosa lapponica</i>) A149 Dunlin (<i>Calidris alpina</i>) A162 Redshank (<i>Tringa totanus</i>) A179 Black-headed Gull (<i>Chroicocephalus ridibundus</i>) A143 Knot (<i>Calidris canutus</i>) A192 Roseate Tern (<i>Sterna dougallii</i>) A046 Light-bellied Brent Goose (<i>Branta bernicla hrota</i>) A141 Grey Plover (<i>Pluvialis squatarola</i>) A130 Oystercatcher (<i>Haematopus ostralegus</i>) A194 Arctic Tern (<i>Sterna paradisaea</i>) A193 Common Tern (<i>Sterna hirundo</i>) A137 Ringed Plover (<i>Charadrius hiaticula</i>) Habitats Wetlands	NPWS (2010) Conservation Objectives: South Dublin Bay and River Tolka Estuary SPA 004024. Version 1. National Parks and Wildlife Service, Department of Arts, Heritage and the Gaeltacht.
004006	North Bull Island SPA	Birds A160 Curlew (<i>Numenius arquata</i>) A149 Dunlin (<i>Calidris alpina</i>) A157 Bar-tailed Godwit (<i>Limosa lapponica</i>) A162 Redshank (<i>Tringa totanus</i>) A179 Black-headed Gull (<i>Chroicocephalus ridibundus</i>) A144 Sanderling (<i>Calidris alba</i>) A156 Black-tailed Godwit (<i>Limosa limosa</i>) A143 Knot (<i>Calidris canutus</i>) A169 Turnstone (<i>Arenaria interpres</i>) A054 Pintail (<i>Anas acuta</i>) A046 Light-bellied Brent Goose (<i>Branta bernicla hrota</i>) A048 Shelduck (<i>Tadorna tadorna</i>) A052 Teal (<i>Anas crecca</i>) A141 Grey Plover (<i>Pluvialis squatarola</i>) A056 Shoveler (<i>Anas clypeata</i>) A130 Oystercatcher (<i>Haematopus ostralegus</i>) A140 Golden Plover (<i>Pluvialis apricaria</i>) Habitats Wetlands	NPWS (2010) Conservation Objectives: North Bull Island SPA 004006. Version 1. National Parks and Wildlife Service, Department of Arts, Heritage and the Gaeltacht.

Appendix 4 Relevant Legislation

The following European instruments are regarded as relevant to this application assessment and have been considered in the drafting of the Recommended Decision.
Environmental Impact Assessment (EIA) Directive (2011/92/EU as amended by 2014/52/EU)
Habitats Directive (92/43/EEC) & Birds Directive (79/409/EC)
Water Framework Directive [2000/60/EC]
Waste Framework Directive (2008/98/EC)
Regulation (EC) No 1907/2006 (REACH Regulation)
Environmental Liability Directive (2004/35/CE)