



**FEHILY
TIMONEY**

CONSULTANTS IN ENGINEERING,
ENVIRONMENTAL SCIENCE & PLANNING

APPENDIX 5

Site Walkover Checklist and
Photographic Log

*For inspection purposes only.
Consent of copyright owner required for any other use.*



Walkover Survey Checklist

Historic Kerry Landfills - Ahascra

Walkover Survey Checklist		
Information	Checked	Comment (include distances from Site Boundary)
1. What is the current land use?	✓	Agricultural land
2. What are the neighbouring land uses?	✓	Agricultural land and bog land. Residential dwellings 50m west of site
3. What is the size of the site?	✓	Circa 2.65 ha
4. What is the topography?	✓	Site is generally flat, slight slope
5. Are there potential receptors (if yes, give details)?	✓	Nearby residences, groundwater
Houses		
Surface water features (if yes, distance and direction of flow)?	✓	Small stream with very low flow rate located along north-eastern boundary of site.
Any wetland or protected areas?	✓	Bog located directly east of site boundary
Public water supplies?	✓	Not identified
Private wells?	✓	Possible local usage
Services?	✓	None
Other buildings?	✓	None on-site
Other?	✓	No
6. Are there any potential sources of contamination (if yes, give details)?	✓	Buried waste
Surface waste (if yes, what type)?	✓	None noted
Surface ponding of leachate	✓	None present
Leachate seepage	✓	None noted
Landfill gas odours	✓	None noted
7. Are there any outfalls to surface water? (If yes, are there discharges and what is the nature of the discharge?)	✓	No evidence
8. Are there any signs of impact on the environment? (if yes, take photographic evidence)	✓	None noted.
Vegetation die off, bare ground	✓	None noted
Leachate seepages	✓	None noted
Odours	✓	None Noted
Litter	✓	None
Gas bubbling through water	✓	None noted
Signs of settlement	✓	No
Subsidence, water logged areas	✓	No evidence

Walkover Survey Checklist

Historic Kerry Landfills - Ahascra

Walkover Survey Checklist		
Information	Checked	Comment (include distances from Site Boundary)
Drainage or hydraulic issues	✓	None noted
Downstream water quality appears poorer than upstream water quality	✓	No
9. Are there any indications of remedial measures? (Provide details)	✓	No
Capping	✓	No waste evident
Landfill gas collection	✓	No
Leachate collection	✓	No
10. Describe fences and security features (if any)	✓	Site is fenced with wooden posts and wire and access is through metal farm gates
Any other relevant information?		

*For inspection purposes only.
Consent of copyright owner required for any other use.*

PHOTOGRAPHIC LOG



Client Name: Kerry County Council

Site Location: Ahascra

Project Number: P1766

Photo No.

Date:

1

14/02/19

Description:

Main site entrance along south-eastern side of landfill.



Photo No.

Date:

2

14/02/19

Description:

View showing raised mounded profile of the landfill.



PHOTOGRAPHIC LOG



Client Name: Kerry County Council

Site Location: Ahascra

Project Number: P1766

Photo No.

Date:

3

23/10/19

Description:

Several deep depressions with surface water pools were identified across the landfill cap.



For inspection purposes only.
Consent of copyright owner required for any other use.

Photo No.

Date:

4

23/10/19

Description:

Possible leachate seepage identified within perimeter drain along western side of landfill.



PHOTOGRAPHIC LOG



Client Name: Kerry County Council

Site Location: Ahascra

Project Number: P1766

Photo No.

Date:

5

23/10/19

Description:

Surface water (SW01) located north-east of old landfill. Ponded water.



Photo No.

Date:

6

23/10/19

Description:

Surface water (SW02) located south-east of old landfill. Ponded water.



PHOTOGRAPHIC LOG



Client Name: Kerry County Council

Site Location: Ahascra

Project Number: P1766

Photo No.

Date:

7

23/10/19

Description:

Surface water (SW01) located north-east of old landfill. Ponded water.



Photo No.

Date:

8

23/10/19

Description:

Surface water (SW02) located south-east of old landfill. Ponded water.





**FEHILY
TIMONEY**

**CONSULTANTS IN ENGINEERING,
ENVIRONMENTAL SCIENCE & PLANNING**

APPENDIX 6

**Control Surveys Topographical
Mapping**

*For inspection purposes only.
Consent of copyright owner required for any other use.*

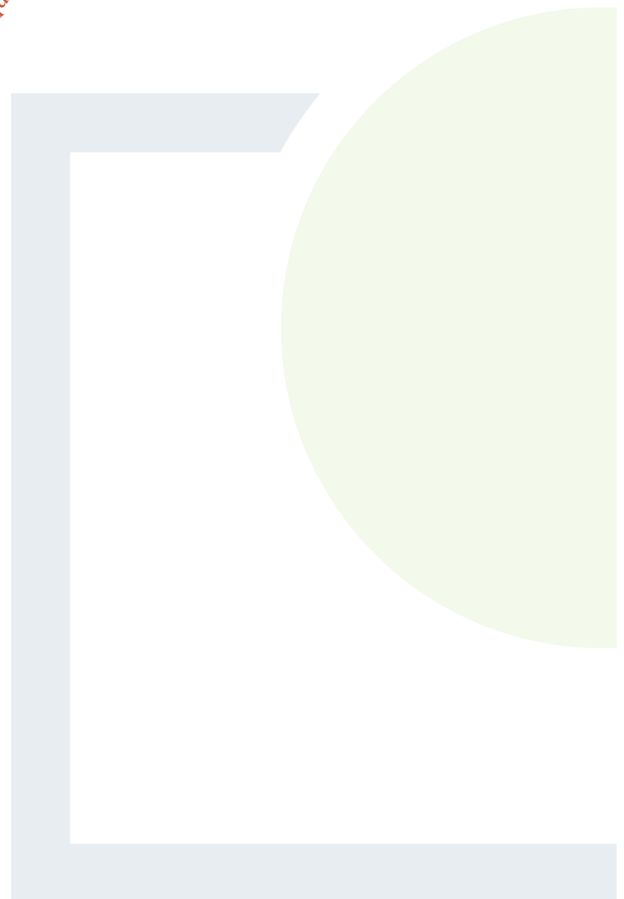

- NOTES:
- All levels are relative to Ordnance Datum Malin Head
 - 50m sq grid relative to Irish Transverse Mercator Co-ordinate reference system
 - Contours are at .25m intervals

SYMBOL LEGEND			
○AV	Air Valve	○SV	Sluice Valve
●V	Valve	●WV	Water Valve
■FH	Fire Hydrant	■WM	Water Meter
□IC	Inspection Chamber	□Post	Post
—	Telecom Duct	—	ESB Duct
□TB	Telecom Box	□EBB	ESB Box
○T	Tree	○EP	ESB Pole
○TS	Tree Spread	○TP	Telecom Pole
●BS	Bush/Shrub	○LS	Lamp Standard
○S	Sign	○T.S	Traffic Sign
●AJ	Armstrong Junction	■GY	Gully
○ER	Earth Rod	■G	Gas
○TL	Traffic Light	●B	Bollard
■CATV	Cable TV Duct	○Bin	Bin
—	Gate	○Sty	Sty
○M	Manhole & Cover Level	○Sers	Service
○S	Survey Station	○Pipe	Pipe
○R	Ridge Height	○CH	Coping Height
○FFL	Finished Floor Level	○GH	Gutter Height
○EH	Eaves Height	○RH	Roof Height
○BH	Boundary Height	○SH	Spot Height

LINE TYPE LEGEND			
—	Wall	—	Concrete Edge
—	Fence	—	Centerline of Trees
—	Footpath	—	Hedge
—	Drain/River	—	Step
—	Flower Bed	—	Plinth
—	ESB Line	—	Telecom Line
—	Mound	—	Building
—	Kerb	—	Road
—	Contour Major	—	Contour Minor
—	Bottom of Bank	—	Top of Bank
—	Yellow Line	—	White Line

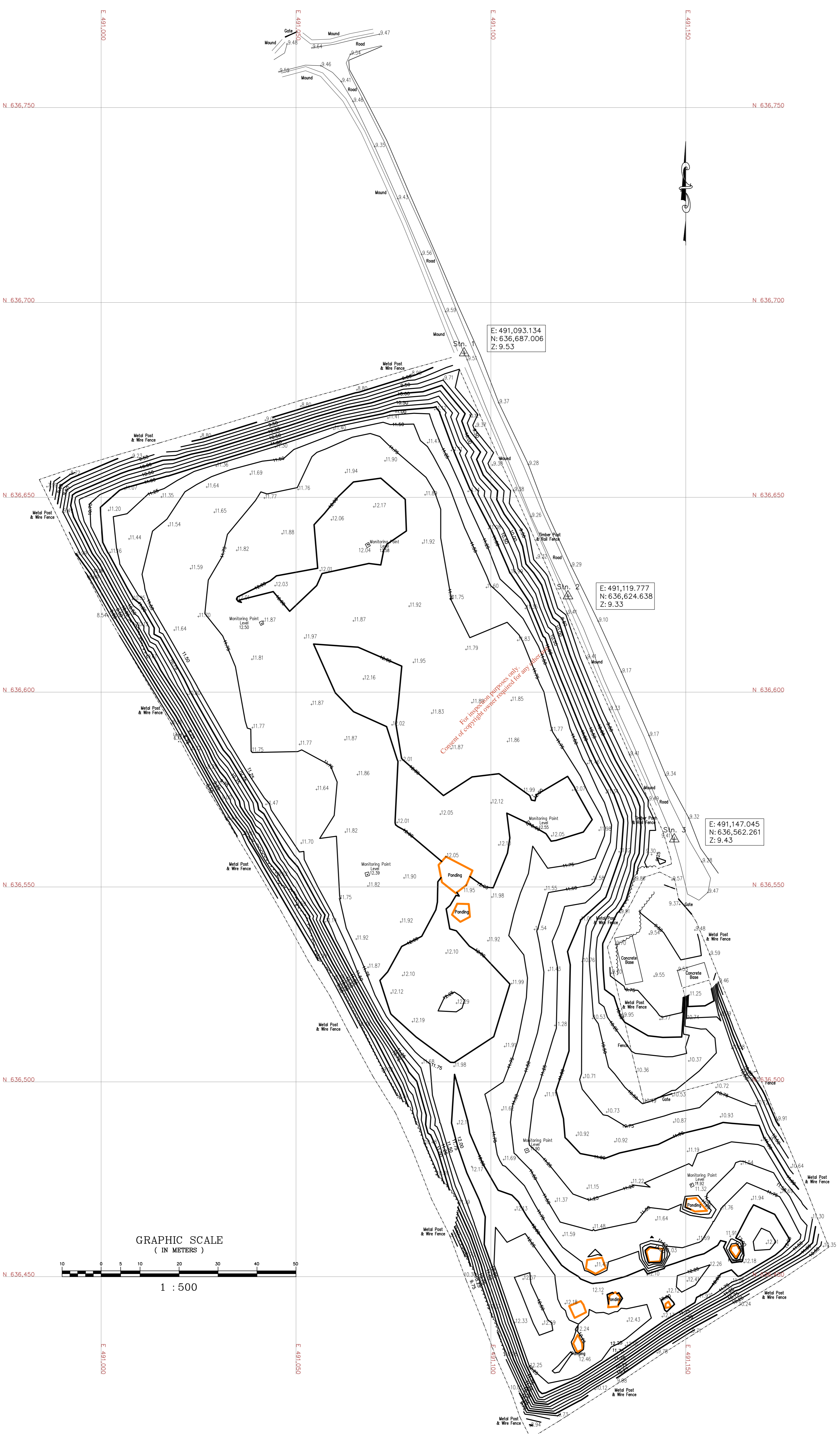

REVISIONS		
No.	Date	Description

Control Surveys
land and building surveys

6 Crestwood, Kiltarragh, Doora Doyle, Limerick.
Tel: 087 2659112 email: cian@controlsurveys.ie
website: www.controlsurveys.ie

- Topographical Surveys
- Measured Building Surveys
- Legal Mapping
- As Built Surveys
- GPS Surveys
- Setting Out

Client:

Professional:
Fehily Timoney & Co

Project Title:
Topographical Survey of Historical Landfill
Ahasra, Lisselton, Co. Kerry

Drawn: J.D. **Dwg No:** 19-159-01
Scale: 1:500 **Date:** 13-03-19



FEHILY TIMONEY

CONSULTANTS IN ENGINEERING,
ENVIRONMENTAL SCIENCE & PLANNING

www.fehilytimoney.ie

For inspection purposes only.
Consent of copyright owner required for any other use.

CORK OFFICE

Core House
Pouladuff Road,
Cork, T12 D773,
Ireland
+353 21 496 4133

Dublin Office

J5 Plaza,
North Park Business Park,
North Road, Dublin 11, D11 PXT0,
Ireland
+353 1 658 3500

Carlow Office

Unit 6,
Bagenalstown Industrial Park,
Royal Oak Road, Muine Bheag,
Co. Carlow,
R21 XW81, Ireland
+353 59 972 3800

