

Eve O'Sullivan

Subject: EPA Technical Amendment for WO-257-01 Country Clean Recycling
Attachments: 12-139-120-0.pdf; 12-139-121-0.pdf; Planning_Premision_Grant_2013.pdf

From: Flor Crowley [<mailto:flor@corkminiskips.ie>]
Sent: 26 June 2020 18:36
To: Roisin Griffin <R.Griffin@epa.ie>
Subject: EPA Technical Amendment for WO-257-01 Country Clean Recycling

Hi Róisín,

Flor Crowley here in Country Clean Recycling, following up on our phone call yesterday please see attached;

- Planning granted by Cork County Council – reference 13/04463
- Drawings submitted with the planning which show the existing layout of the site and the area that received planning for.

I trust all is on order.

If you require any additional information please do not hesitate to contact me.

Kind Regards,

Flor Crowley

|Environmental Health & Safety Manager|

Country Clean Recycling T/A Cork Mini Skips | [Churchfield Ind Est](#), Cork|

Office: 021 731 8165 Mobile: 086 026 52 75

Email flor@corkminiskips.ie

Waste Collection Permit: NWCPO-13-11220

 please consider the environment before printing this email

This electronic message, including all contents and attachments, contains information that may be privileged, confidential or otherwise protected from disclosure. The information is intended for the addressee only. If you are not the addressee, then any disclosure, copying, distribution or use of this message or any of its contents or attachments is prohibited. If you have received this message in error, please notify the sender immediately and destroy the original message and all copies. Country Clean Recycling accepts no liability for any loss, damage or consequence, whether caused by our own negligence or not, resulting directly or indirectly from the use of any attached files.

CORK COUNTY COUNCIL
Planning & Development Acts 2000-2010

| | |
|-------------------------------|-------------|
| OES CONSULTING | |
| Project No.:- <u>RECEIVED</u> | |
| 19 JUN 2013 | |
| Initials:- | |
| Action By:- | Completed:- |
| | |
| | |

Country Clean Recycling Ltd.
C/O OES Consulting
FBD House
Tralee
Co.Kerry

Planning Register No: 13/04463

Application by: Country Clean Recycling Ltd.

Of: C/O OES Consulting, FBD House, Tralee, Co.Kerry

On: 19/03/2013

For: Construction of a retaining wall varying in height to a maximum of 5 metres and boundary wall of 3 metres at the northern site boundary, alteration and increase of site level, 5 no. storage bays for storage of sorted dry materials, ancillary services and relocation of stormwater attenuation tank

At: Country Clean Recycling, Churchfield Industrial Estate, John F. Connolly Road, Churchfield, Garranabraher

Further to Notice dated the 13/05/2013 Cork County Council hereby conveys a grant of **Permission** for the application described above subject to the conditions set out in the schedule attached to the said Notice dated 13/05/2013 of its intention to grant **Permission**

Signed on behalf of Cork County Council

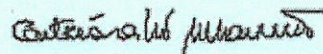

Caitriona Ni Mhainnin

DATE: 18/06/2013

NOTE FOR GUIDANCE OF DEVELOPERS

A grant of Planning Permission or Permission Consequent on the grant of Outline Permission does NOT of itself empower a person to carry out a development unless that person is otherwise legally entitled to do so. Unless otherwise stated or unless it is revoked a Permission or Permission Consequent on the Grant of Outline Permission is valid for a period of five years.

Any development which takes place prior to the payment of a financial contribution required by any of the conditions attached to a Permission or Permission Consequent on the grant of Outline Permission will be unauthorized until compliance with the condition or conditions.

Please note that there is an onus on developers to ensure that there is no danger to the public as a result of the proposed development.

Important Notice for Developers – Conditions Precedent

The enclosed grant of permission may not automatically entitle you to commence the authorised development. This is because many permissions contain “Conditions Precedent” i.e. conditions which must be complied with before development commences. (Such conditions usually contain the phrase ‘before development commences’ and may require further details to be submitted to and agreed with the Planning Authority). If there are such conditions on your permission please read on.

1) Early Submission Of Details

Where compliance proposals are required by condition you should make them as far in advance of your anticipated commencement date as possible. This is to enable adequate time for the Planning Authority to consider and, when satisfactory, agree the details. Such proposals may need to be revised before agreement can be reached or, in the absence of agreement, may need to be referred to An Bord Pleanala. These potential delays to starting a development can be mitigated by early submission of proposals in the first instance.

There is no statutory timeframe for responding to such compliance proposals and on an ongoing basis the Planning Authority will be dealing with other priorities including current Planning Applications with statutory decision deadlines. **Therefore submit as early as possible and do not commence development until agreement of the Planning Authority has issued in writing.**

2) Development Commenced In Advance of Compliance Proposals/Agreements

Any development commenced in advance of full compliance with such conditions (including conditions requiring financial contributions, bonds, securities) is unauthorised and leaves a developer liable to **enforcement proceeding and heavy penalties**. Simply submitting a proposal may not in itself be sufficient compliance if the condition also requires the Agreement/Approval of the Planning Authority. This will also apply where the Planning Authority becomes aware that a development is about to start (e.g. Commencement Notice) and conditions precedent have not been complied with.

3) Submission Should Be Addressed As Follows:

Compliance with Conditions
Planning Department, County Hall, Carrigrohane Road, Cork.

The above information is intended for your assistance and guidance in avoiding a situation of unauthorised development and the Planning Authority wishes you every success with the development.

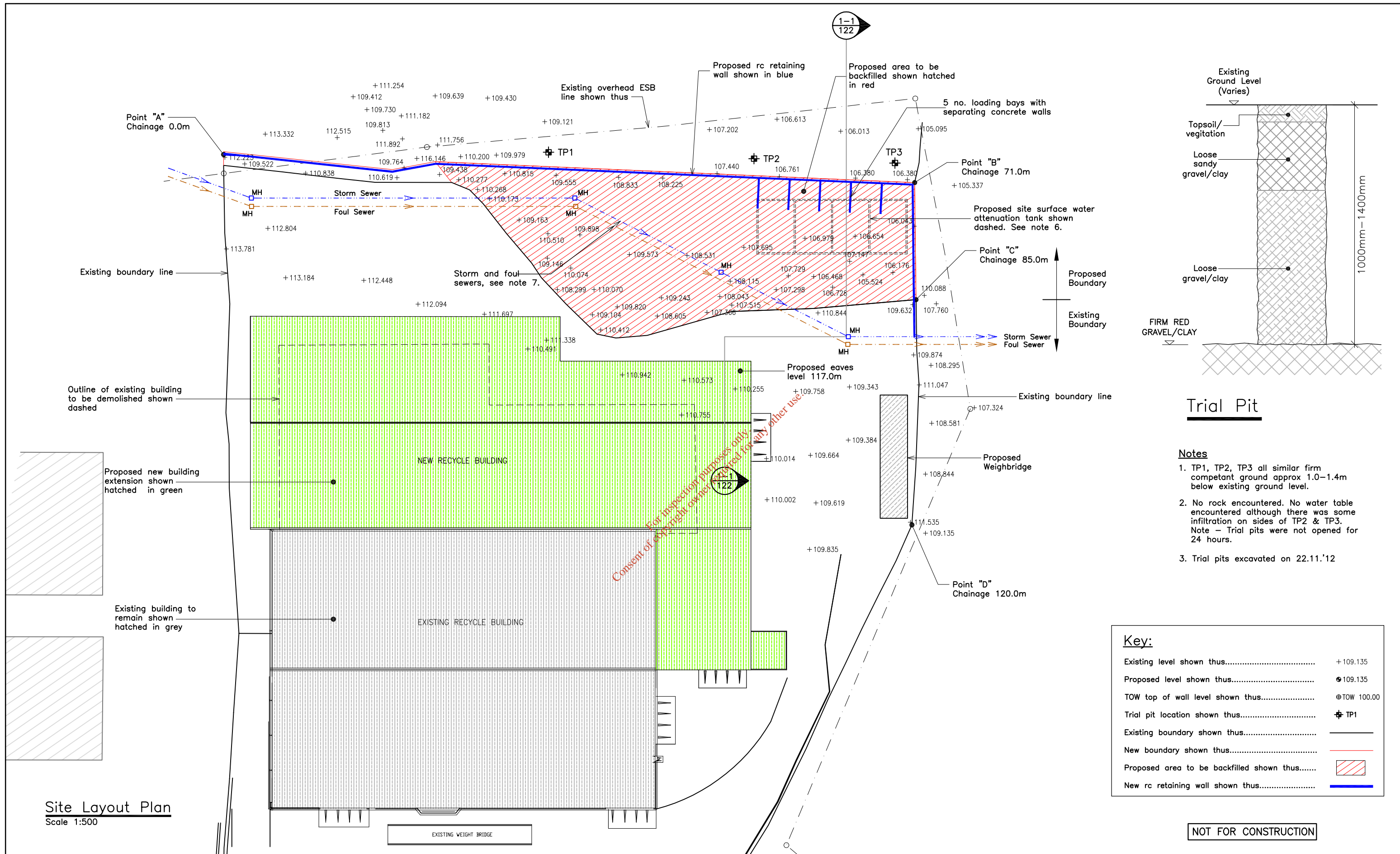

Site Layout Plan
Scale 1:500

NOT FOR CONSTRUCTION

Trial Pit

Notes

- TP1, TP2, TP3 all similar firm competent ground approx 1.0-1.4m below existing ground level.
- No rock encountered. No water table encountered although there was some infiltration on sides of TP2 & TP3. Note - Trial pits were not opened for 24 hours.
- Trial pits excavated on 22.11.'12

Key:

| | |
|--|-------------------|
| Existing level shown thus..... | +109.135 |
| Proposed level shown thus..... | ⊕109.135 |
| TOW top of wall level shown thus..... | ⊕TOW 100.00 |
| Trial pit location shown thus..... | ⊕ TP1 |
| Existing boundary shown thus..... | — |
| New boundary shown thus..... | — |
| Proposed area to be backfilled shown thus..... | [Red hatched box] |
| New rc retaining wall shown thus..... | [Blue line] |

- Notes:**
- Do not scale.
 - Drawing to be read in conjunction with KES specification and all relevant drawings.
 - All survey levels provided by other.
 - Provisionally movement joints in wall to be provided at 20m intervals. Refer to elevation drawings.
 - All general concrete to be C35/20, blinding and lean mix C10/20.
 - Surface water attenuation tank size to be confirmed by OES Consulting.
 - Proposed foul and storm sewer layouts to be confirmed by OES Consulting.

| Revision | Issue | Date | Dwg. By | Chk'd. By |
|----------|-------|-----------|---------|-----------|
| 0 | | 18.01.'13 | N.K. | N.K. |

Kenny Engineering Services
11 Quarryvale, Mounthawk, Tralee, Co. Kerry.

Nigel Kenny Chartered Engineer
B.E. M.Eng.Sc. C.Eng M.I.E.I. M.I.Struct.E.
Phone (066) 7189035
Mobile 086 3739526
E-Mail info@kennyengineering.ie
www.kennyengineering.ie

| | | |
|---|-------------------|------------------------|
| Project Country Clean Recycling Ltd. Churchfield Industrial Estate, Cork. | | |
| Drawing Site Layout Plan - Retaining Walls | | |
| Drawn: N.K. | Checked By: N.K. | Job No. 12-139 |
| Date: 23.08.'12 | Scale: 1:500 @ A3 | Drawing No. 12-139-120 |

Key:

| | |
|--|-------------|
| Existing level shown thus..... | +109.135 |
| Proposed level shown thus..... | ⊕109.135 |
| TOW top of wall level shown thus..... | ⊕TOW 100.00 |
| Trial pit location shown thus..... | ⊕ TP1 |
| Existing boundary shown thus..... | — |
| New boundary shown thus..... | — |
| Proposed area to be backfilled shown thus..... | |
| New rc retaining wall shown thus..... | |

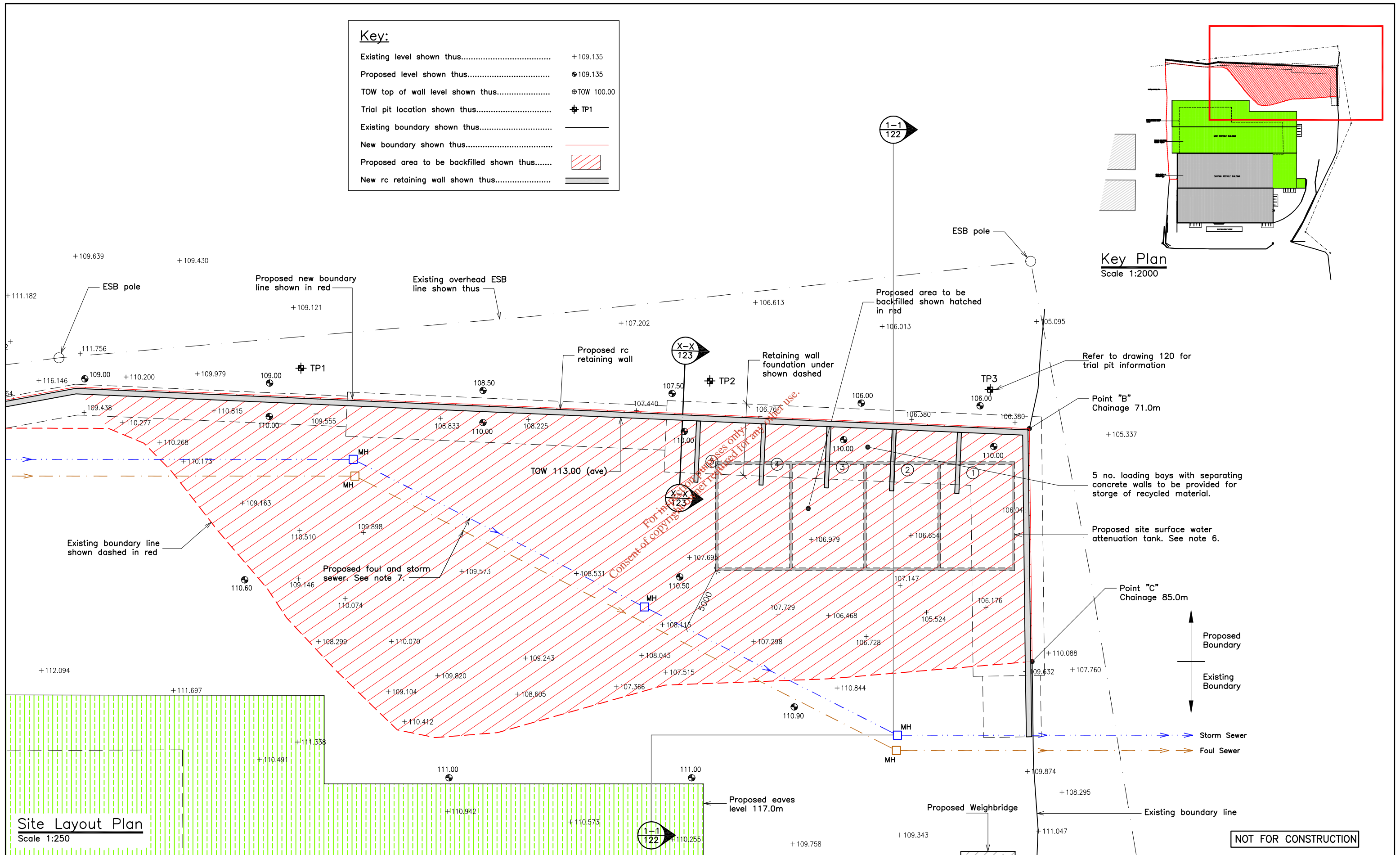
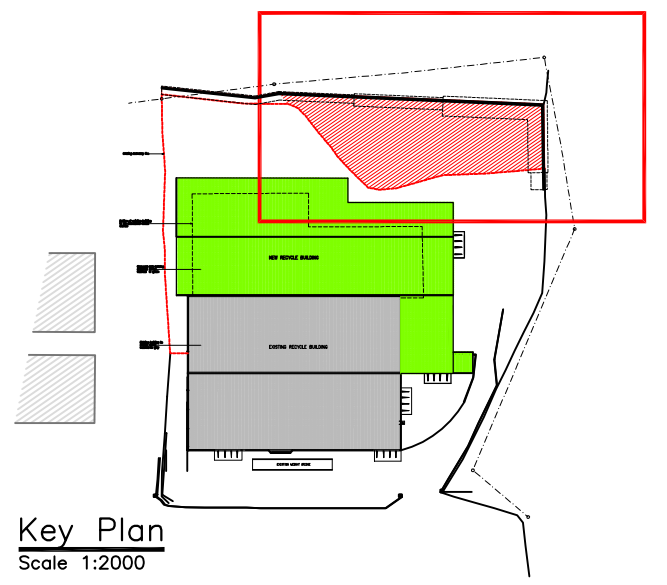

- Notes:**
1. Do not scale.
 2. Drawing to be read in conjunction with KES specification and all relevant drawings.
 3. All survey levels provided by other.
 4. Provisionally movement joints in wall to be provided at 20m intervals. Refer to elevation drawings.
 5. All general concrete to be C35/20, blinding and lean mix C10/20.
 6. Surface water attenuation tank size to be confirmed by OES Consulting.
 7. Proposed foul and storm sewer layouts to be confirmed by OES Consulting.

| | | | | |
|----------|-------|-----------|---------|-----------|
| Planning | 0 | 18.01.'13 | N.K. | N.K. |
| Revision | Issue | Date | Dwg. By | Chk'd. By |

Kenny Engineering Services

11 Quarryvale,
Mounthawk,
Tralee,
Co. Kerry.

Nigel Kenny Chartered Engineer
B.E. M.Eng.Sc. C.Eng. M.I.E.I. M.I.Struct.E.

Phone (066) 7189035
Mobile 086 3739526
E-Mail info@kennyengineering.ie
www.kennyengineering.ie

| | | |
|---|-------------------|------------------------|
| Project Country Clean Recycling Ltd. Churchfield Industrial Estate, Cork. | | |
| Drawing Part Site Layout Plan – Retaining Walls | | |
| Drawn: N.K. | Checked By: N.K. | Job No. 12-139 |
| Date: 01.12.'12 | Scale: 1:250 @ A3 | Drawing No. 12-139-121 |