



CLW Environmental Planners Ltd.

The Mews,
23 Farnham Street,
Cavan,
Co. Cavan

Phone: 049-4371447/9

Fax: 049-4371451

E-mail: info@clw.ie

Planning Dept.,
Monaghan Co. Co.
The Glen,
Monaghan,
Co. Monaghan.

27th May 2021

Re: APPLICATION TO THE ENVIRONMENTAL PROTECTION AGENCY FOR A LICENCE

Dear Sir/Madame,

Notice is hereby given in accordance with the E.P.A. Acts 1992 to 2013 that Andrew and Gladys Keating, Glear, Newbliss, Co. Monaghan intend to apply to the Environmental Protection Agency (E.P.A.) for a Licence for their poultry farm at Drumanan, Newbliss, Co. Monaghan.

This enterprise is classed as: Activity Class 6.1 (a) 'The rearing of poultry in installations where the capacity exceeds 40,000 places.'

An Environmental Impact Assessment Report relating to this activity, which has previously been submitted to Monaghan County Council, will be submitted to the Agency as part of this application.

The environmental impact assessment report submitted to the Agency in accordance with section 83(2A)(d) of the Act of 1992, any information provided to the Agency under paragraph (e) or (f)(ii)(II) of section 83(2A) of the Act of 1992, any opinion issued by the Agency under section 83(2A)(de) of the Act of 1992 on the scope of the environmental impact assessment report, and any further information, including reports and advice, relating to the environmental impact assessment as may be furnished to the Agency in the course of the Agency's consideration of the application, shall each be made available on the Agency's website and at the headquarters of the Agency.

Submissions may be made in writing to the Agency in relation to the likely effects on the environment of the proposed activity within the period specified by the Agency on its website under Regulation 4(2)(c), and in accordance with section 87(2) of the Act of 1992, a proposed determination shall be published by the Agency on its website.

A copy of the application for the licence may be inspected on the Agency's website or inspected at or obtained from the headquarters of the Agency as soon as is practicable after the receipt by the Agency of the application for the licence.

Should you have any queries in relation to this, or, require any further information please do not hesitate to contact me at the above number.

Yours faithfully,

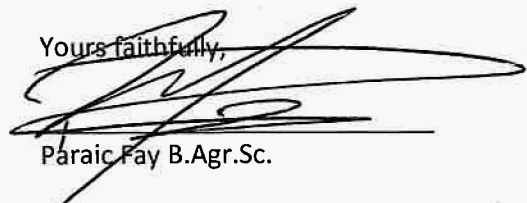

Paraic Fay B.Agr.Sc.

**" APPLICATION TO THE ENVIRONMENTAL PROTECTION AGENCY
FOR A LICENCE"**

Site Notice

Notice is hereby given in accordance with the E.P.A. Acts 1992 to 2013 that Andrew and Gladys Keating, Glear, Newbliss, Co. Monaghan intend to apply to the Environmental Protection Agency (E.P.A.) for a Licence for their poultry farm at Drumanan, Newbliss, Co. Monaghan.

This enterprise is classed as:

Activity Class 6.1 (a) 'The rearing of poultry in installations where the capacity exceeds 40,000 places.'

An Environmental Impact Assessment Report relating to this activity, which has previously been submitted to Monaghan County Council, will be submitted to the Agency as part of this application.

The environmental impact assessment report submitted to the Agency in accordance with section 83(2A)(d) of the Act of 1992, any information provided to the Agency under paragraph (e) or (f)(ii)(II) of section 83(2A) of the Act of 1992, any opinion issued by the Agency under section 83(2A)(de) of the Act of 1992 on the scope of the environmental impact assessment report, and any further information, including reports and advice, relating to the environmental impact assessment as may be furnished to the Agency in the course of the Agency's consideration of the application, shall each be made available on the Agency's website and at the headquarters of the Agency.

Submissions may be made in writing to the Agency in relation to the likely effects on the environment of the proposed activity within the period specified by the Agency on its website under Regulation 4(2)(c), and in accordance with section 87(2) of the Act of 1992, a proposed determination shall be published by the Agency on its website.

A copy of the application for the licence may be inspected on the Agency's website or inspected at or obtained from the headquarters of the Agency as soon as is practicable after the receipt by the Agency of the application for the licence.

Signed:  (on behalf of applicant)

Signed: Paraic Fay B.Agr.Sc.,

CLW

Environmental Planners Ltd.,

The Mews,

23 Farnham St.,

Cavan.

Date of erection of Site Notice: 27th May 2021

Planning Pack Map

820512 855142 854559 820512

CENTRE COORDINATES:
ITM 954851,820287

PUBLISHED: ORDER NO.: 50118188_1
07/05/2020

MAP SERIES: MAP SHEETS: 1349
1:5,000

COMPILED AND PUBLISHED BY:
Ordnance Survey Ireland;
Phoenix Park,
Dublin 8,
Ireland.

Unauthorized reproduction
infringes Ordnance Survey Ireland
and Government of Ireland
copyright.

All rights reserved.
No part of this publication may
be copied, reproduced
or transmitted in any form
or by any means without the prior
written permission of
the copyright owners.

The representation on this map
of a road, track or footpath
is not evidence of the existence
of a right of way.

Ordnance Survey maps
never show legal property
boundaries, nor do they
show ownership of
physical features.

© Suirbhéireacht Ordánála Éireann,
2020
© Ordnance Survey Ireland, 2020
www.osi.ie/copyright

LEGEND:
<http://www.osi.ie>;
search 'Large Scale Legend'

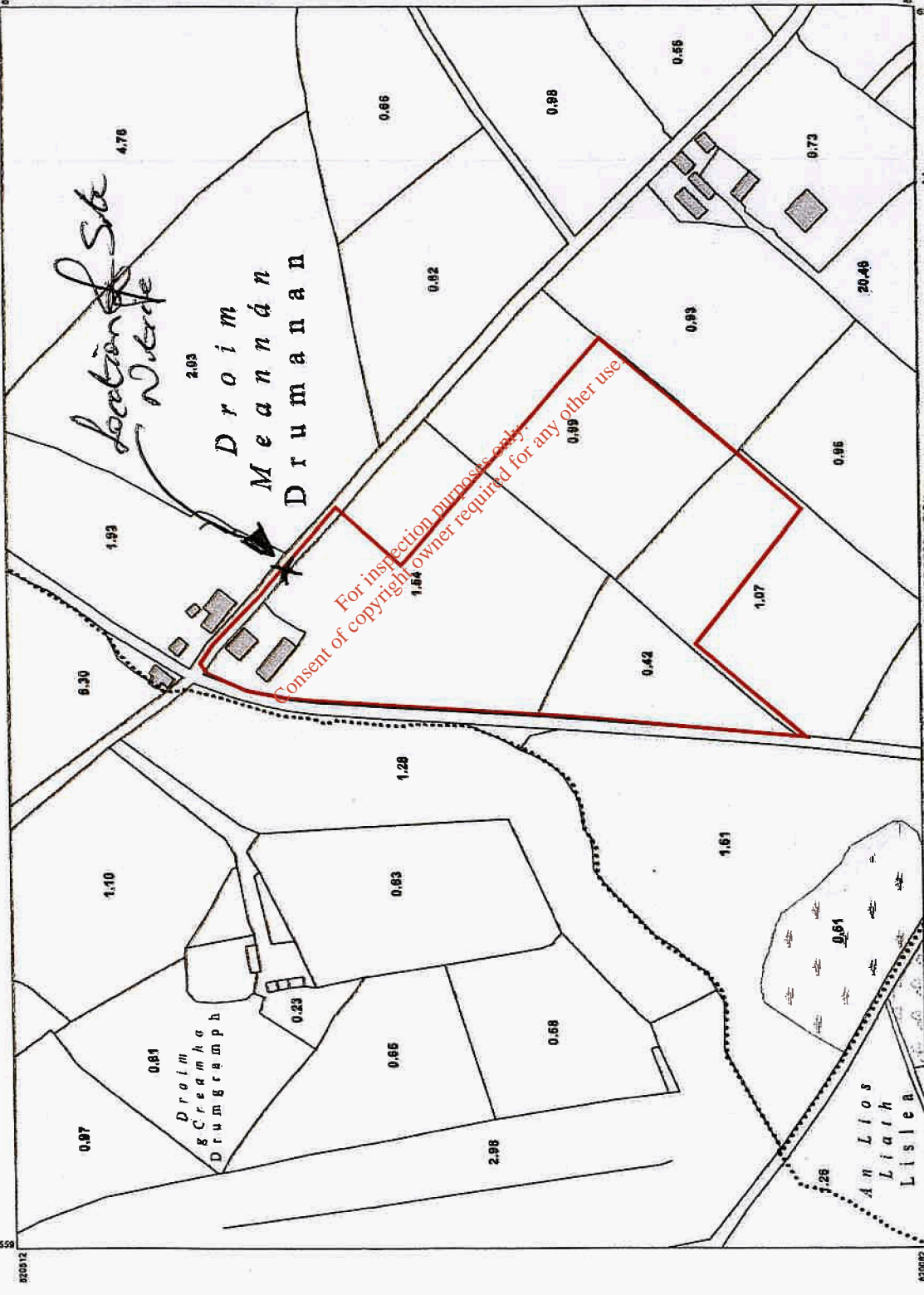

CAPTURE RESOLUTION:
This map output is only accurate to the
resolution at which they were captured.
Output scale is not indicative of data capture scale.
Further information is available at:
<http://www.osi.ie>; search 'Capture Resolution'

OUTPUT SCALE: 1:2,500

