

# AMENDED SITE DRAINAGE & LAYOUT MAP

SITE AREA = 1.198 HECTARES

PLANTING SCHEDULE  
 FOUR NUMBER FRAXINUS EXCELOIR (D)  
 FOUR NUMBER FAGUS SYVALTICA (E)  
 FIVE NUMBER BETULA PENDULA (F)  
 FIVE ACER CAMPESTRE (G)  
 TWO STAGGERED ROW OF PRUNUS SPINOSA (128 IN TOTAL ) AS PER B ON LAYOUT. SHRUBS AT 1.5M CENTRES  
 ALL PLANTING TO BE CARRIED OUT DURING FIRST PLANTING SEASON AFTER COMMENCEMENT OF WORK  
 TREES TO HAVE 14 - 16 CM GIRTH

DO NOT PLANT WHEN PERSISTANT COLD OR DRYING WINDS ARE LIKELY TO OCCUR OR SOIL IS FROST BOUND EXCESSIVELY DRY OR WATERLOGGED  
 PROTECT SIDES OF PITS FROM FREEZING AND DO NOT USE FROZEN BACKFILLING MATERIAL.

PLANTS SHOULD CONFORM TO THE SPECIFICATION ON SITE LANDSCAPE MAP. PLANT SHOULD BE FREE OF DISEASE OR PESTS AND SHOULD BE PROTECTED DURING DELIVERY. ALL TREE PITS SHOULD BE FREE DRAINING AND EXCAVATED TO A MIN DEPTH OF 800MM OR AT LEAST 150MM DEEPER THAT THE ROOTS SYSTEM. SHAMROCK POTTING COMPOST SHOULD BE USED WITH ALL TREES. ALL TREES OVER 1.5M SHOULD BE STAKED AND SECURED WITH RAINBOW TREE TIES.

SHRUBS AND HEDGE PLANTING SHOULD BE IN PITS AT LEAST 200MM DEEP WITH POTTING COMPOST AROUND EACH SHRUB.

FOUL WATER  
 SITE BOUNDARY  
 STORM WATER

EXISTING POULTRY UNIT  
 PROPOSED POULTRY UNIT  
 CONCRETE STREET

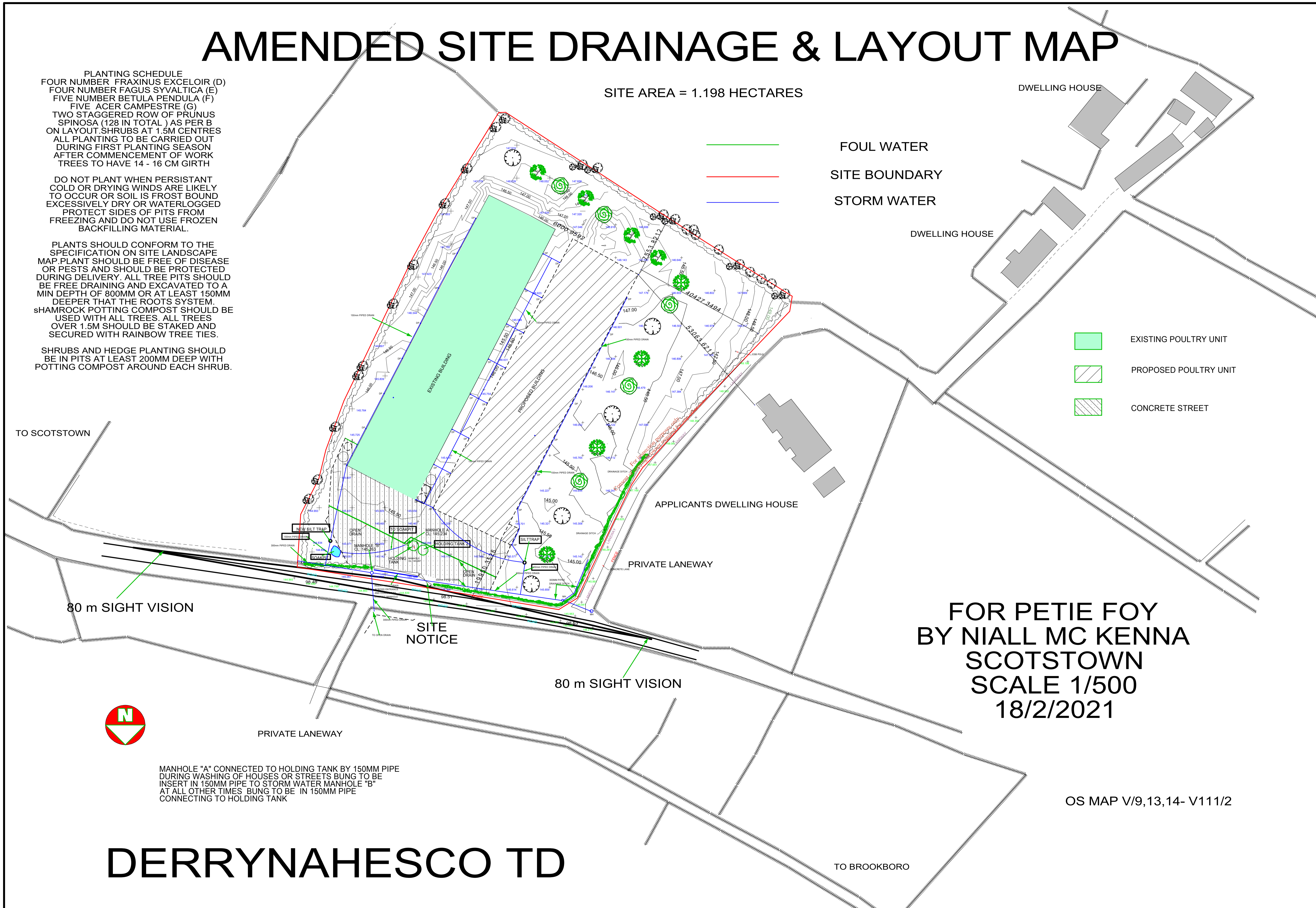

FOR PETIE FOY  
 BY NIAL MC KENNA  
 SCOTSTOWN  
 SCALE 1/500  
 18/2/2021

80 m SIGHT VISION

SITE NOTICE

80 m SIGHT VISION

MANHOLE "A" CONNECTED TO HOLDING TANK BY 150MM PIPE  
 DURING WASHING OF HOUSES OR STREETS BUNG TO BE  
 INSERT IN 150MM PIPE TO STORM WATER MANHOLE "B"  
 AT ALL OTHER TIMES BUNG TO BE IN 150MM PIPE  
 CONNECTING TO HOLDING TANK

OS MAP V/9,13,14- V111/2

DERRYNAHESCO TD