



CLW Environmental Planners Ltd.

The Mews,
23 Farnham Street,
Cavan,
Co. Cavan

Phone: 049-4371447/9
Fax: 049-4371451
E-mail: info@clw.ie

Planning Dept.,
Monaghan Co. Co.
The Glen,
Monaghan,
Co. Monaghan.

29th April 2021

Re: APPLICATION TO THE ENVIRONMENTAL PROTECTION AGENCY FOR A LICENCE

Dear Sir/Madame,

Notice is hereby given in accordance with the E.P.A. Act 1992, as amended, that Mr. Stephen Moffett, Corlea (DED Tullycorbet), Ballybay, Co. Monaghan intends to apply to the Environmental Protection Agency (E.P.A.) for a Licence for his poultry farm at Corlea (DED Tullycorbet), Ballybay, Co. Monaghan.

This enterprise is classed as:

Activity Class 6.1 (a) "The rearing of poultry in installations where the capacity exceeds 40,000 places."

An Environmental Impact Assessment Report relating to this activity, which has previously been submitted to Monaghan County Council, will be submitted to the Agency as part of this application.

The environmental impact assessment report submitted to the Agency in accordance with section 83(2A)(d) of the Act of 1992, any information provided to the Agency under paragraph (e) or (f)(ii)(II) of section 83(2A) of the Act of 1992, any opinion issued by the Agency under section 83(2A)(de) of the Act of 1992 on the scope of the environmental impact assessment report, and any further information, including reports and advice, relating to the environmental impact assessment as may be furnished to the Agency in the course of the Agency's consideration of the application, shall each be made available on the Agency's website and at the headquarters of the Agency.

Submissions may be made in writing to the Agency in relation to the likely effects on the environment of the proposed activity within the period specified by the Agency on its website under Regulation 4(2)(c), and in accordance with section 87(2) of the Act of 1992, a proposed determination shall be published by the Agency on its website.

A copy of the application for the licence may be inspected on the Agency's website or inspected at or obtained from the headquarters of the Agency as soon as is practicable after the receipt by the Agency of the application for the licence.

Should you have any queries in relation to this, or, require any further information please do not hesitate to contact me at the above number.

Yours faithfully,

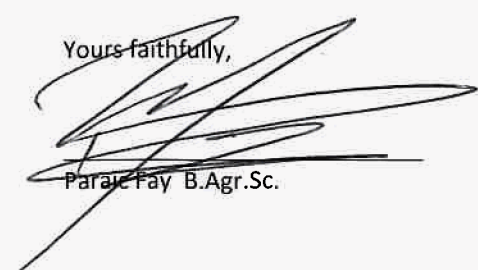

Parait Fay B.Agr.Sc.

**" APPLICATION TO THE ENVIRONMENTAL PROTECTION AGENCY
FOR A LICENCE"**

Site Notice

Notice is hereby given in accordance with the E.P.A. Act 1992, as amended, that Mr. Stephen Moffett, Corlea (DED Tullycorbet), Ballybay, Co. Monaghan intends to apply to the Environmental Protection Agency (E.P.A.) for a Licence for his poultry farm at Corlea (DED Tullycorbet), Ballybay, Co. Monaghan.

This enterprise is classed as:

Activity Class 6.1 (a) 'The rearing of poultry in installations where the capacity exceeds 40,000 places.'

An Environmental Impact Assessment Report relating to this activity, which has previously been submitted to Monaghan County Council, will be submitted to the Agency as part of this application.

The environmental impact assessment report submitted to the Agency in accordance with section 83(2A)(d) of the Act of 1992, any information provided to the Agency under paragraph (e) or (f)(ii)(II) of section 83(2A) of the Act of 1992, any opinion issued by the Agency under section 83(2A)(de) of the Act of 1992 on the scope of the environmental impact assessment report, and any further information, including reports and advice, relating to the environmental impact assessment as may be furnished to the Agency in the course of the Agency's consideration of the application, shall each be made available on the Agency's website and at the headquarters of the Agency.

Submissions may be made in writing to the Agency in relation to the likely effects on the environment of the proposed activity within the period specified by the Agency on its website under Regulation 4(2)(c), and in accordance with section 87(2) of the Act of 1992, a proposed determination shall be published by the Agency on its website.

A copy of the application for the licence may be inspected on the Agency's website or inspected at or obtained from the headquarters of the Agency as soon as is practicable after the receipt by the Agency of the application for the licence.

Signed:  (on behalf of applicant)

Signed: Paraic Fay B.Agr.Sc.,

CLW

Environmental Planners Ltd.,

The Mews,

23 Farnham St.,

Cavan.

Date of erection of Site Notice: 29th April 2021

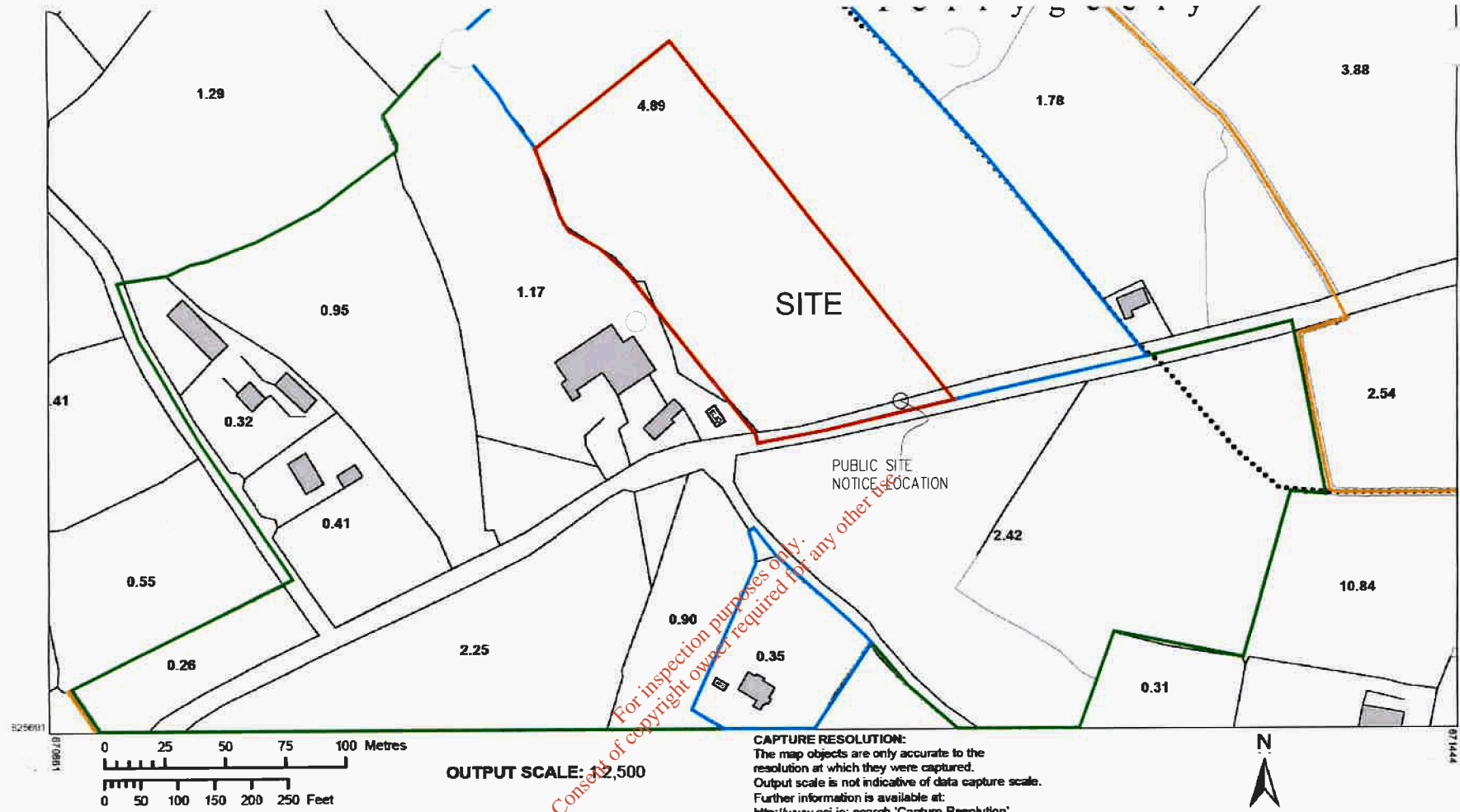

COMPILED AND FROM Ordnance Survey 1:50,000 Phoenix Park, Dublin 8, Ireland.

Unauthorised reproduction infringes Ordnance Survey and Government of Ireland copyright.

All rights reserved. No part of this publication may be copied, reproduced or transmitted in any form or by any means without written permission of the copyright owner.

The representation of a road, track or railway is not evidence of title or of a right of way.

Ordnance Survey 1:50,000 never show legal property boundaries, nor do they show ownership of physical features.

© Suirbhéireacht C 2018
© Ordnance Survey 2018
www.osi.ie/copyright

LEGEND:
<http://www.osi.ie>;
search 'Large Scale'

SITE LOCATION MAP

SCALE 1:2500

OUTPUT SCALE: 1:2,500

CAPTURE RESOLUTION:
The map objects are only accurate to the resolution at which they were captured. Output scale is not indicative of data capture scale. Further information is available at: <http://www.osi.ie>; search 'Capture Resolution'

- SITE BOUNDARIES OUTLINED IN RED ———
- LAND IN OWNERSHIP IN BLUE ———
- LAND IN APPLICANT FAMILY OWNERSHIP ———
- WATERCOURSES ———

SITE AREA =
12,710 sq.m.
Or 3.14 Acres
Or 1.271 Ha

TENDER DRAWING