

Our ref: MDR1499A

West Pier Business Campus
Dun Laoghaire, Co. Dublin
A96 N6T7
T +353 1 488 2900

Date: 08 October 2020

Ms. Michelle Reddy,
Environmental Licensing Programme,
Office of Environmental Sustainability,
EPA.

Dear Michelle,

RE: Article 14(2)(b)(ii) of the Waste Management (Licensing) Regulations, in respect of a licence application from Glv Bay Lane Limited for a facility located at GLV Bay Lane Limited, Bay Lane Quarry, Bay Lane, St. Margaret's, Dublin, D15 P924 – W0301-01

Further to your request for further information with regards to the exploration boreholes referred to in the application, please find this information below

(a) Provide coordinates and a map showing the location of the six exploration wells (coordinates should be expressed as six-digit easting and northing GPS Irish National Grid references);

Borehole number	Easting	Northing
DA01/99	309601	243205
DA02/99	309647	243075
DA03/99	309689	242940
DA04/99	309521	243071
DA05/99	309747	243046
DA06/99	309840	243232

These locations are mapped in the new drawing (Drawing number 17 – Borehole locations (1999)) which is submitted separately to this document as a PDF and is also copied into page 3 of this document.

Our ref: MDR1499A

(b) Provide any groundwater monitoring results from the six exploration wells;

These six exploration boreholes were installed in 1999 when the site was in greenfield condition. Extraction work and quarrying by the previous site owners since then – between 2000 and 2008 approximately - has disturbed ground conditions at all six locations. The boreholes are now underwater (DA01, DA02, DA03, DA04, DA05) or are buried under the overburden material (DA06). The boreholes cannot now be accessed. There is therefore no current groundwater monitoring data from these boreholes.

(c) State the direction of the groundwater flow and which of the six exploration wells can or will be used to represent the up-gradient and down gradient water quality.

The water levels in the boreholes from 1999 displayed limited fluctuation and were inconclusive as to direction of flow. Further, the previous quarrying works at the site will have altered groundwater conditions from those seen in 1999. Therefore, GLV Bay Lane Limited cannot be conclusive as to groundwater flow direction using the historical data.

Given the activities undertaken around the existing boreholes since their installation in 1999, the boreholes may be unusable. Borehole condition will be determined when the site has been fully dewatered, and when access will again be possible to the DA01 to DA05 locations.

GLV Bay Lane Limited understands that the EPA may wish to apply a waste licence condition that the up-gradient and down-gradient water quality be established before works commence under waste licence. GLV Bay Lane Limited will undertake groundwater monitoring on site to establish the direction of the groundwater flow before works commence. Groundwater monitoring will be undertaken using existing and or new boreholes as appropriate. This process will identify the borehole locations most appropriate to represent the up-gradient and down-gradient water quality.

I trust this response is satisfactory.

Yours sincerely,
for RPS Group Limited



Conor McGovern
Associate - Resource Management
conor.mcgovern@rpsgroup.com
+353 1 523 9231

For inspection purposes only.
Consent of copyright owner required for any other use.

cc: Richard Carey, GLV Bay Lane Limited

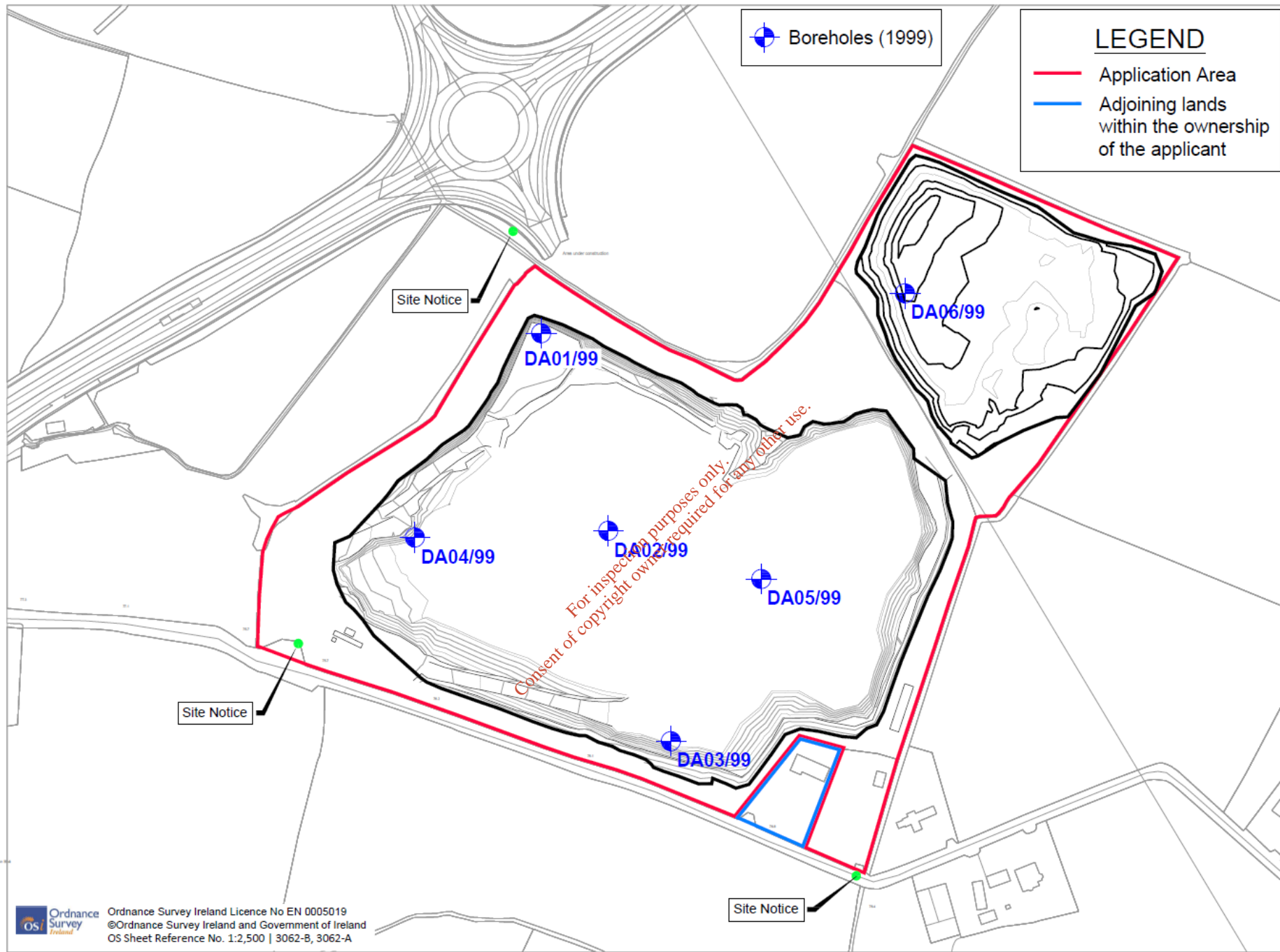

Client

General Notes

- (i) This drawing is the property of RPS Consulting Engineers. It is a confidential document and must not be copied, used, or its content divulged without prior written consent.
- (ii) All Levels refer to Ordnance Survey Datum, Malin Head.
- (iii) DO NOT SCALE, use figured dimensions only, if in doubt ask.
- (iv) Hard copies, dwf and pdf will form a controlled issue of the drawing. All other formats (dwg etc) are deemed to be an uncontrolled issue and any work carried out based on these files is at the recipients own risk. RPS will not accept any responsibility for any errors from the use of these files, either by human error by the recipient, listing of the un-dimensioned measurements, compatibility with the recipients software, and any errors arising when these files are used to aid the recipients drawing production, or setting out on site.

No.	Date	By	App	Amendment / Issue
F01	Oct 20	RH	CMG	FINAL ISSUE



West Pier
Business Campus
Dun Laoghaire
Co Dublin

T +353 1 4882900
F +353 1 2835676
W www.rpsgroup.com/ireland
E Ireland@rpsgroup.com

Drawn	RH
Checked	CMG
Approved	CMG
Date	Oct. 2020
Scale	NTS @ A1 1:2500 @ A3
Job No.	MDR1499

Project	BAY LANE SOIL RECOVERY FACILITY		
Title	DRAWING 17 BOREHOLE LOCATIONS (1999)		
File Ref.	MDR1499-017	Dwg. No.	17
Rev.	01	Issue Date	10-20-2020 14:29:26