

## SECTION C. SITE DETAILS

*For inspection purposes only.  
Consent of copyright owner required for any other use.*

For inspection purposes only.  
Consent of copyright owner required for any other use.

## SECTION C: SITE DETAILS

### C.1. Site Location

Name:	Galway C.C. Roads Depot
Address*:	Tullyvogheen
	Clifden
	Co. Galway
Tel:	
Fax:	
e-mail:	

\* Include any townland

**Attachment C.1.** should contain appropriately scaled drawings or maps ( $\leq A3$ ) showing the site location in the context of its surroundings and clearly highlighting the site boundary.

### C.2. Unauthorised Waste Sites Register (Section 22) – Site Boundary and Site Code

State that the site has been recorded on the online Section 22 Register at [www.epa.ie/uwsr](http://www.epa.ie/uwsr) and that the boundary drawn of the site represents the full extent of the site.

**Following the Tier 2 and Tier 3 site investigations, if the extent of the site is determined to be greater or less than that initially recorded in the Section 22 Register, then the boundary must be amended accordingly.**

**Finalised boundary entered in Section 22 Register?**

Provide the unique code assigned to the site in the Section 22 Register

<b>Site Code</b>	<b>S22-02237</b>
------------------	------------------

Provide a six-digit National Grid Reference for the site location

<b>Grid Reference</b>	67631.14	<b>E</b>	251185.815	<b>N</b>
-----------------------	----------	----------	------------	----------

Confirm the following waste details entered on the Section 22 Register:

- State which type of waste activity was carried out at the site (please check):

<b>Disposal</b>	<input checked="" type="checkbox"/>
<b>Recovery</b>	<input type="checkbox"/>

- State the principal waste type at the site (please check):

<b>C&amp;D</b>	<input type="checkbox"/>
<b>Industrial</b>	<input type="checkbox"/>
<b>Municipal</b>	<input checked="" type="checkbox"/>
<b>Pre 1977</b>	<input type="checkbox"/>
<b>Unknown</b>	<input type="checkbox"/>

- State any additional waste types at the site (please check):

<b>Agriculture</b>	<input type="checkbox"/>
<b>C&amp;D</b>	<input checked="" type="checkbox"/>
<b>Dredged Soil</b>	<input type="checkbox"/>
<b>ELV/Scrap Metal</b>	<input type="checkbox"/>
<b>Hazardous</b>	<input type="checkbox"/>
<b>Industrial</b>	<input type="checkbox"/>
<b>Mining</b>	<input type="checkbox"/>
<b>Municipal</b>	<input type="checkbox"/>
<b>Municipal Sludge</b>	<input type="checkbox"/>
<b>Other</b>	<input type="checkbox"/>

- State whether or not hazardous waste is present at the site (please check):

<b>Present on site</b>	<input type="checkbox"/>
<b>Not present on site</b>	<input checked="" type="checkbox"/>

- Estimate the total quantity of waste at the site (tonnes):

<b>Total waste quantity at the site:</b>	<b>205,000 TONNES</b>
--	-----------------------

- Provide the start date and end date of waste activities at the site:

<b>Start date</b>	1984
<b>End date</b>	1999

### C.3. Risk Category



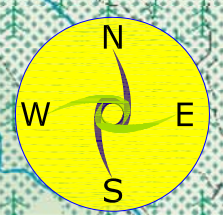
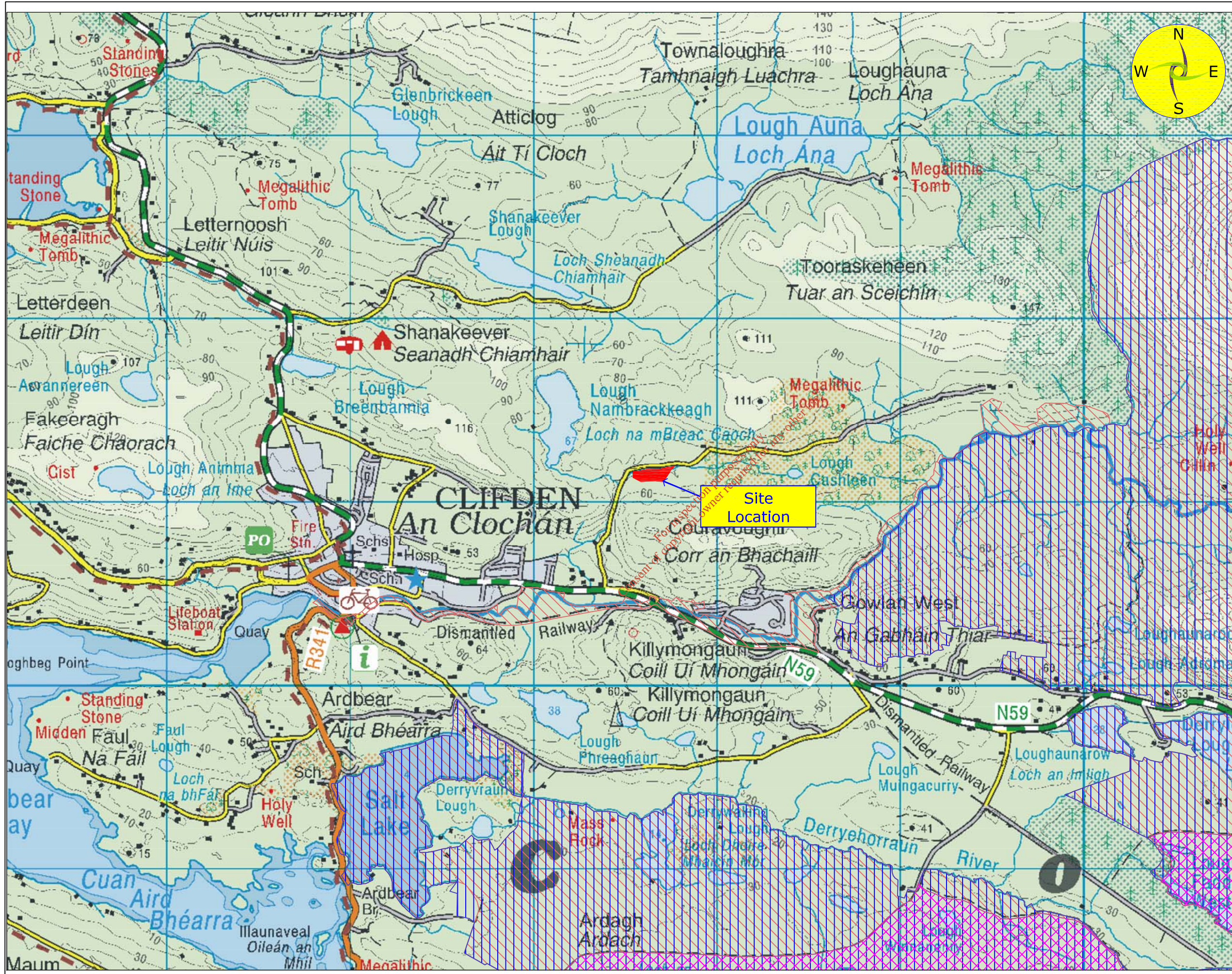

State which Risk Category\* the site belongs to (please check):

<b>Class A (High)</b>	<input checked="" type="checkbox"/>
<b>Class B (Moderate)</b>	<input type="checkbox"/>
<b>Class C (Low)</b>	<input type="checkbox"/>

\*See Chapter 4, Code of Practice (as required under Section 6(2) of the Regulations)



**LEGEND**

-  Site Boundary
-  Special Area of Conservation (SAC)
-  Special Protected Area (SPA)
-  Proposed Natural Heritage Area (pNHA)

**NOTES**

1. FIGURED DIMENSIONS ONLY TO BE TAKEN FROM THIS DRAWING
2. ALL LEVELS SHOWN RELATE TO ORDNANCE SURVEY DATUM AT MALIN HEAD

Issue	Date	Description	By	Chkd.

Client:  
Galway County Council

Project:  
Tier 2 Site Investigation & Tier 3 GQRA Assessment of Former Tullyvogheen Landfill

Title:  
Site Location & Proximity of SACs, pNHAs & SPAs

Scale:  
1:20,000@A3

Prepared by: C.D.  
Checked: P.M.  
Date: 08-04-14

Project Director: P.MULROY





No part of this document may be reproduced or transmitted in any form or stored in any retrieval system of any nature without the written permission of the Consulting Engineering as copyright holder except as agreed for use on the project for which the document was originally issued.

Drawing No.: Figure 1

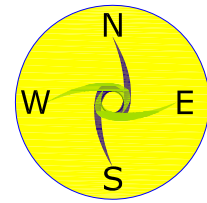
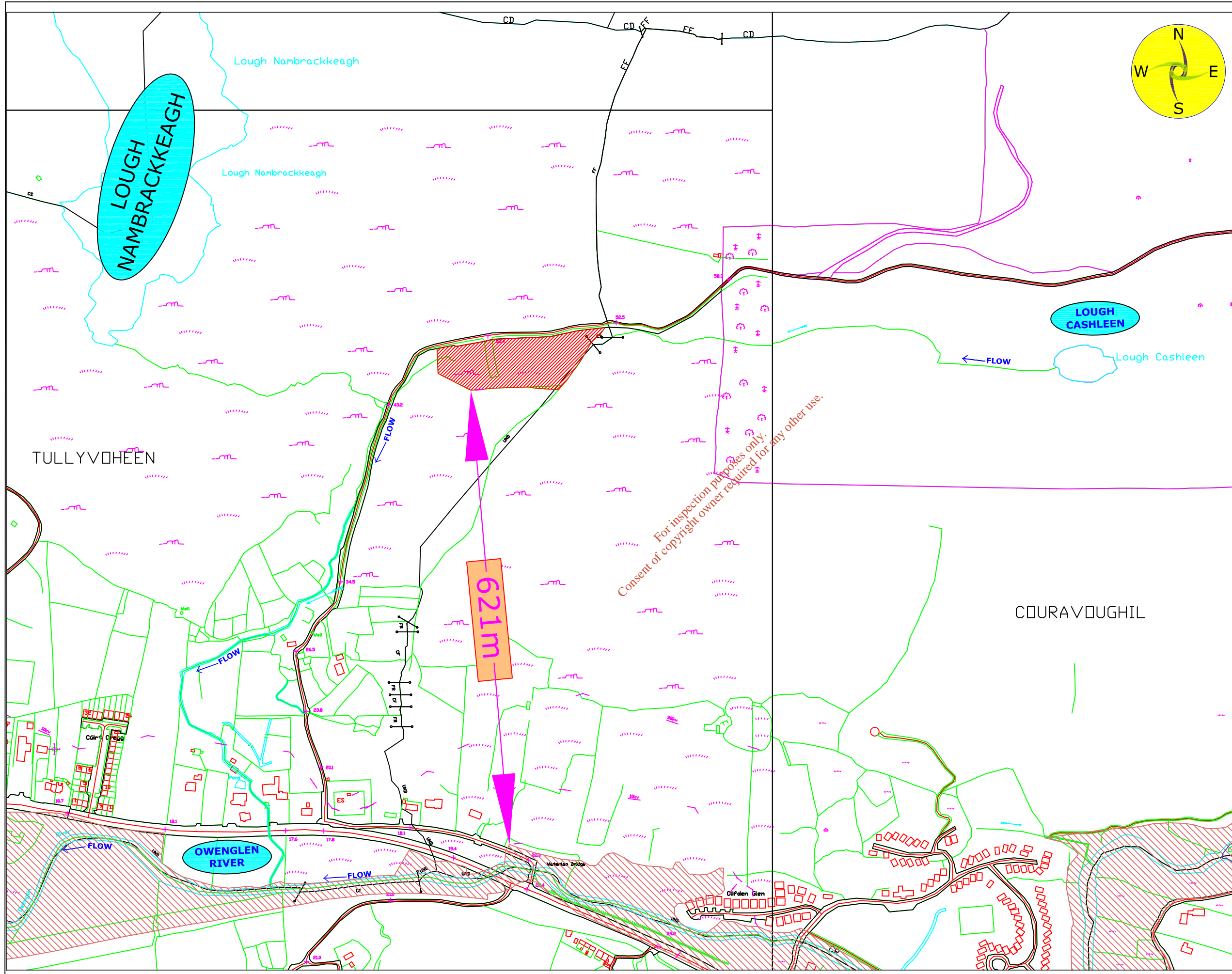
Issue: 0



**LEGEND**

-  Site Boundary
-  Special Area of Conservation  
SAC No. 002031  
The Twelve Bens/  
Garaun Complex

**NOTES**

1. FIGURED DIMENSIONS ONLY TO BE TAKEN FROM THIS DRAWING
2. ALL LEVELS SHOWN RELATE TO ORDNANCE SURVEY DATUM AT MALIN HEAD

Issue	Date	Description	By	Chkd.

Client:  
Galway County Council

Project:  
Tier 2 Site Investigation &  
Tier 3 GQRA Assessment  
of Former Tullyvogheen Landfill

Title:  
Site Location  
&  
Proximity of SAC No. 002031,  
The Twelve Bens/Garaun Complex

Scale:  
1:5,000@A3

Prepared by: C.D.  
Checked: P.M.  
Date: 08-04-14

Project Director: P.MULROY





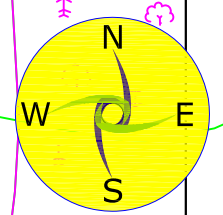
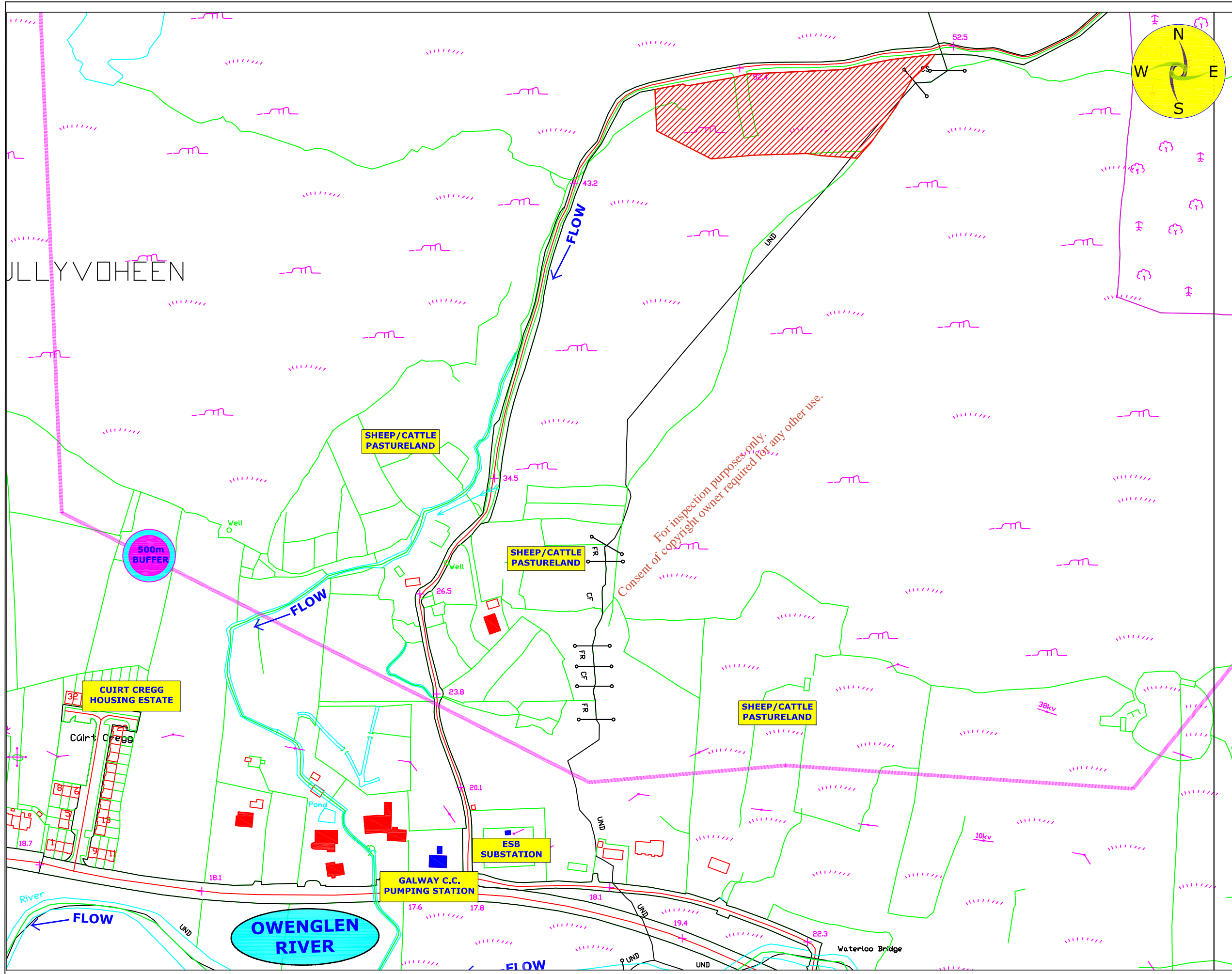

No part of this document may be reproduced or transmitted in any form or stored in any retrieval system of any nature without the written permission of the Consulting Engineering as copyright holder except as agreed for use on the project for which the document was originally issued.

Drawing No.: Figure 2

Issue: 0



- ### LEGEND
-  Site Boundary
  -  Residential Property
  -  Public Property
  -  500m Buffer

- ### NOTES
- FIGURED DIMENSIONS ONLY TO BE TAKEN FROM THIS DRAWING
  - ALL LEVELS SHOWN RELATE TO ORDNANCE SURVEY DATUM AT MALIN HEAD

Issue	Date	Description	By	Chkd.

Client:  
Galway County Council

Project:  
Tier 2 Site Investigation & Tier 3 GQRA Assessment of Former Tullyvogheen Landfill

Title:  
Site Location & Surrounding Property

Scale:  
1:3,000@A3

Prepared by: C.D.  
Checked: P.M.  
Date: 08-04-14

Project Director: P.MULROY



No part of this document may be reproduced or transmitted in any form or stored in any retrieval system of any nature without the written permission of the Consulting Engineering as copyright holder except as agreed for use on the project for which the document was originally issued.

Drawing No.: Figure 3

Issue: 0

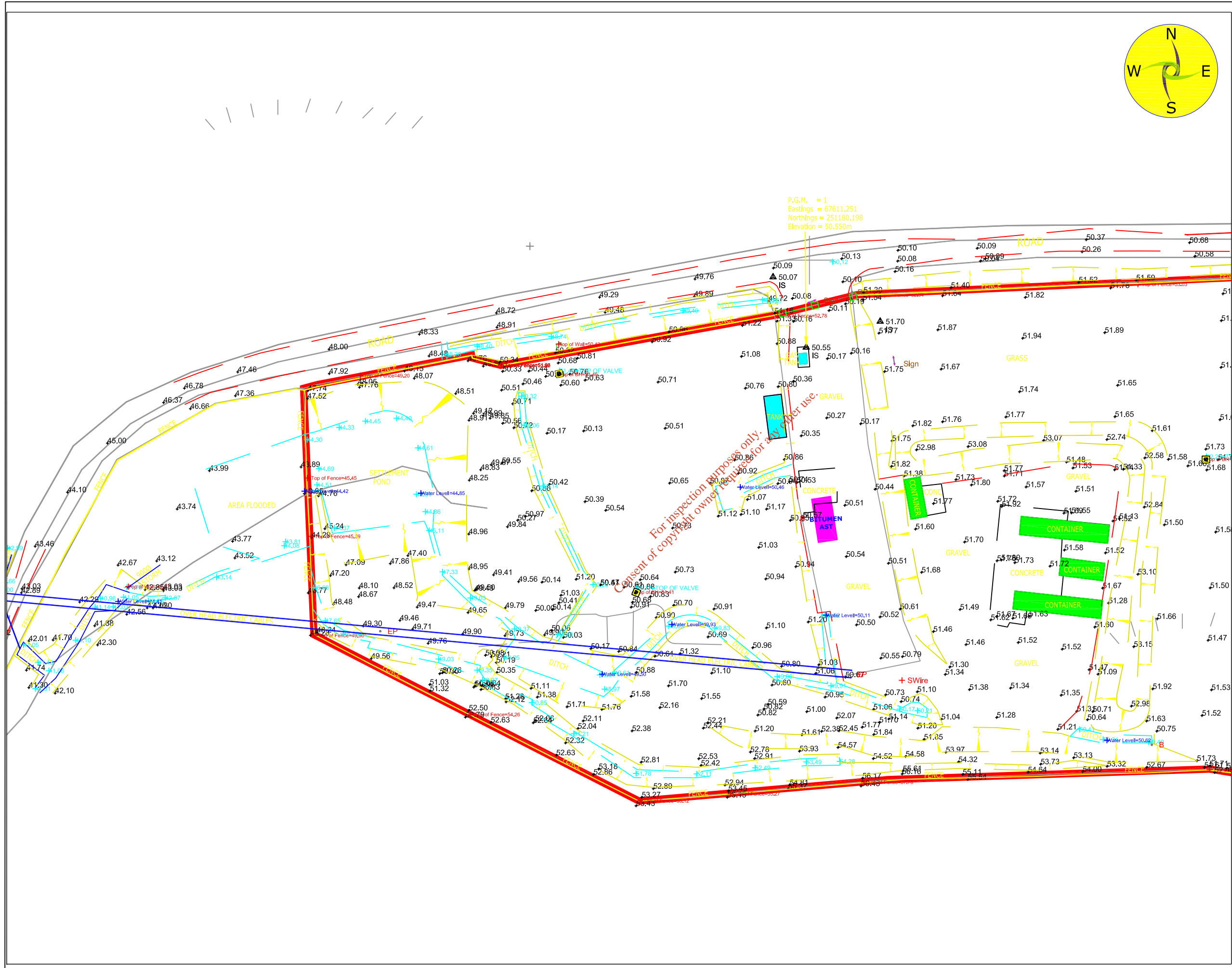

**LEGEND**



- NOTES**
1. FIGURED DIMENSIONS ONLY TO BE TAKEN FROM THIS DRAWING
  2. ALL LEVELS SHOWN RELATE TO ORDNANCE SURVEY DATUM AT MALIN HEAD

Issue	Date	Description	By	Chkd.

Client:  
Galway County Council

Project:  
Tier 2 Site Investigation & Tier 3 GQRA Assessment of Former Tullyvogheen Landfill

Title:  
Site Layout & Topographical Survey (Western Half)

Scale:  
1:500@A3

Prepared by: G.F.      Checked: P.M.      Date: 08-04-14

Project Director: P.MULROY

No part of this document may be reproduced or transmitted in any form or stored in any retrieval system of any nature without the written permission of the Consulting Engineering as copyright holder except as agreed for use on the project for which the document was originally issued.

Drawing No.: Figure 4      Issue: 0



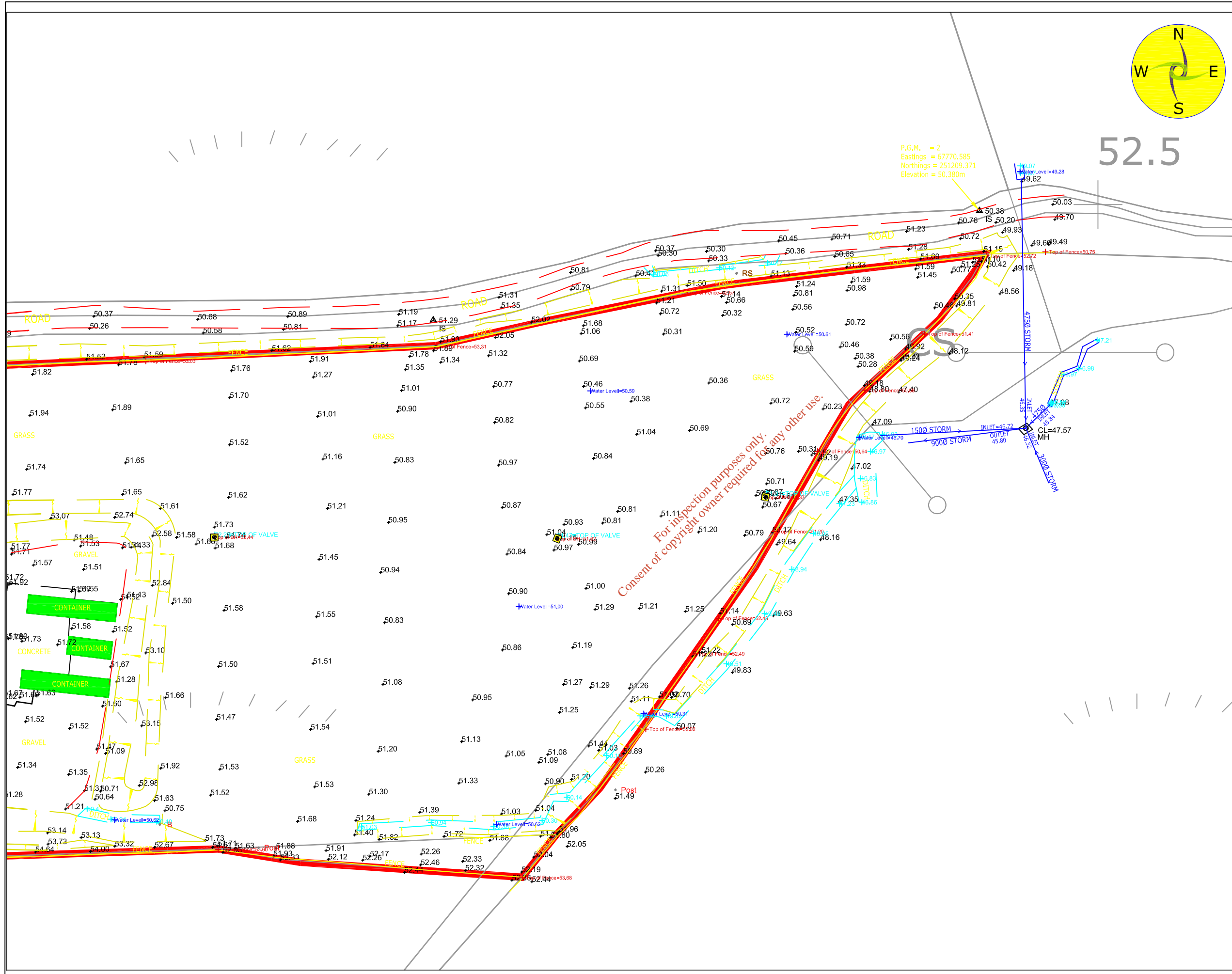

LEGEND



- NOTES
- FIGURED DIMENSIONS ONLY TO BE TAKEN FROM THIS DRAWING
  - ALL LEVELS SHOWN RELATE TO ORDNANCE SURVEY DATUM AT MALIN HEAD

Issue	Date	Description	By	Chkd.

Client:	Galway County Council		
Project:	Tier 2 Site Investigation & Tier 3 GQRA Assessment of Former Tullyvogheen Landfill		
Title:	Site Layout & Topographical Survey (Eastern Half)		
Scale:	1:500@A3		
Prepared by:	G.F.	Checked:	P.M.
Date:	08-04-14		
Project Director:	P.MULROY		



No part of this document may be reproduced or transmitted in any form or stored in any retrieval system of any nature without the written permission of the Consulting Engineering as copyright holder except as agreed for use on the project for which the document was originally issued.

Drawing No.: Figure 5

Issue: 0

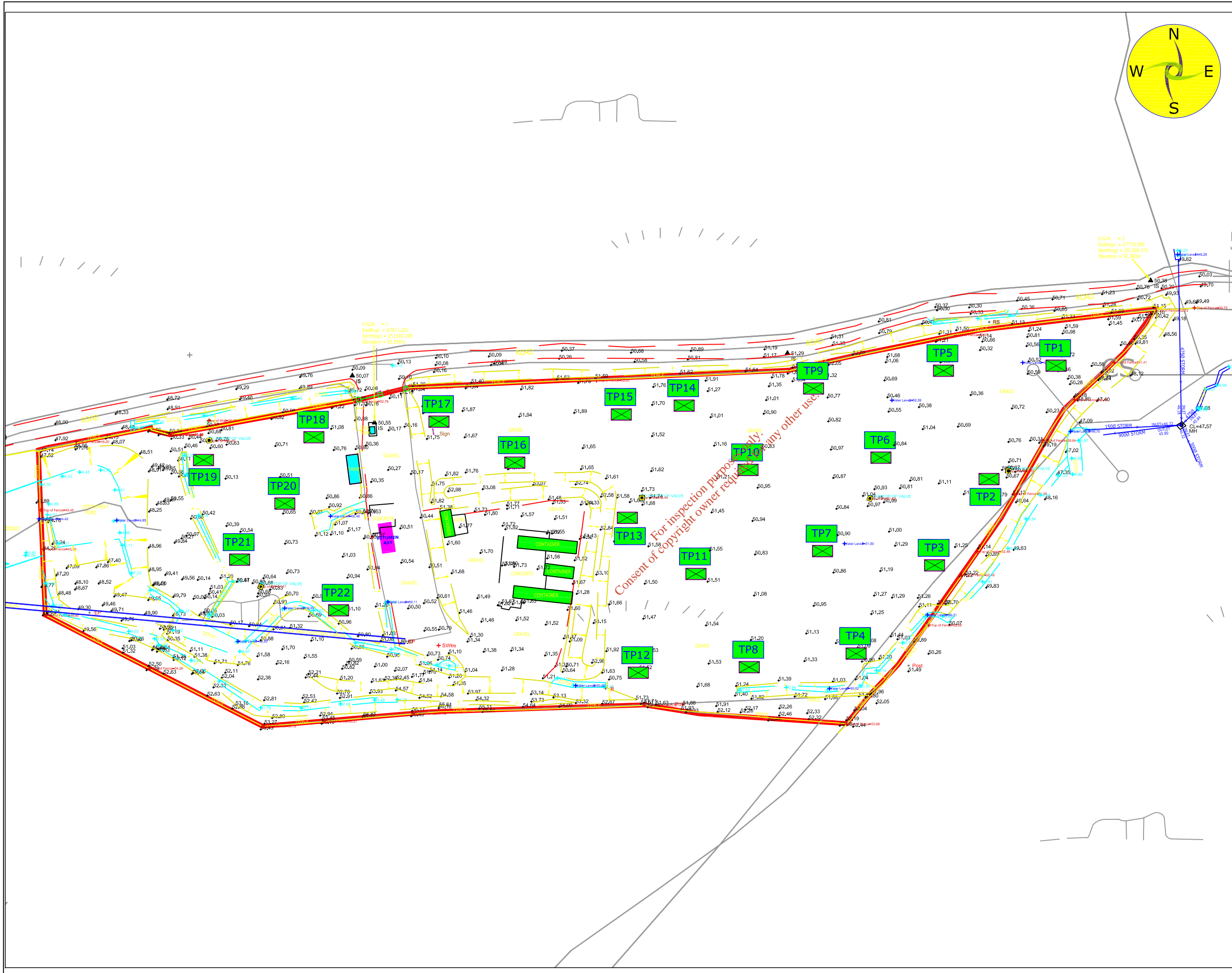

**LEGEND**

Site Boundary

Trialpit Location

**NOTES**

1. FIGURED DIMENSIONS ONLY TO BE TAKEN FROM THIS DRAWING
2. ALL LEVELS SHOWN RELATE TO ORDNANCE SURVEY DATUM AT MALIN HEAD

Issue	Date	Description	By	Chkd.

Client:  
Galway County Council

Project:  
Tier 2 Site Investigation & Tier 3 GQRA Assessment of Former Tullyvogheen Landfill

Title:  
Trialpit Locations

Scale:  
1:750@A3

Prepared by: G.F.      Checked: P.M.      Date: 29-05-14

Project Director: P.MULROY





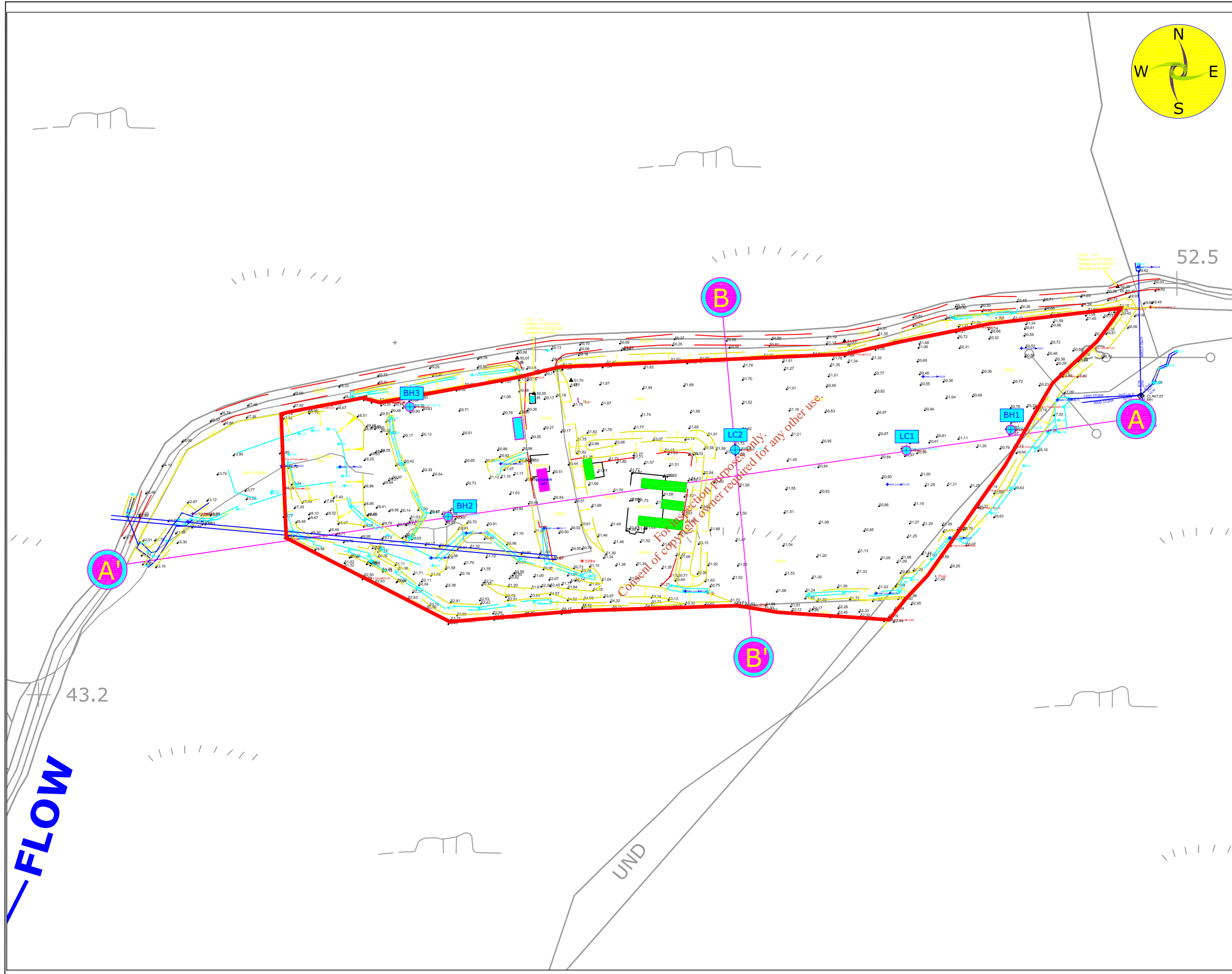

No part of this document may be reproduced or transmitted in any form or stored in any retrieval system of any nature without the written permission of the Consulting Engineering as copyright holder except as agreed for use on the project for which the document was originally issued.

Drawing No.: Figure 6

Issue:  
0



**LEGEND**

-  Site Boundary
-  Groundwater Monitoring Borehole Location
-  Leachate Monitoring Well Location
-  Section Line Location

- NOTES**
1. FIGURED DIMENSIONS ONLY TO BE TAKEN FROM THIS DRAWING
  2. ALL LEVELS SHOWN RELATE TO ORDNANCE SURVEY DATUM AT MALIN HEAD

Issue	Date	Description	By	Chkd.

Client:  
Galway County Council

Project:  
Tier 2 Site Investigation & Tier 3 GQRA Assessment of Former Tullyvogheen Landfill

Title:  
Groundwater Monitoring Well, Leachate Well Locations & Section Locations

Scale:  
1:1,000@A3

Prepared by: G.F.      Checked: P.M.      Date: 29-05-14

Project Director: P.MULROY



No part of this document may be reproduced or transmitted in any form or stored in any retrieval system of any nature without the written permission of the Consulting Engineering as copyright holder except as agreed for use on the project for which the document was originally issued.

Drawing No.: Figure 7      Issue: 0

For inspection purposes only.  
Consent of copyright owner required for any other use.

## C.4. Land Use

Provide details of the current use of the land on which the closed landfill is situate.

**Attachment C.4.** should detail this information or refer to the specific section of the risk assessment documentation where this information is contained.

See attached Plate C4.1 which shows an aerial photograph taken on 29<sup>th</sup> September, 2019 of the Former Tullyvogheen Landfill taken at 30m elevation from the northwest of the site facing southwest showing Galway C.C. roads depot area to the west of the site and grassed/capped area to the middle and east of the site. Please note that the site is no longer used for fire drill training by Galway Fire Brigade.

## C.5. Types and quantities of waste deposited

Provide details of the types and estimated quantities of waste deposited at the site.

**Attachment C.5.** should detail this information or refer to the specific section of the risk assessment documentation where this information is contained.

In addition, state whether the types and quantities of waste which have been recorded on the online Section 22 Register at [www.epa.ie/uwsr](http://www.epa.ie/uwsr) represent the final estimated quantities at the site.

**Following the Tier 2 and Tier 3 site investigations, if the type and quantities of waste are determined to be greater or less than that initially recorded in the Section 22 Register, then these quantities must be amended accordingly.**

**Finalised estimate of waste types and quantities entered in Section 22 Register**



See Section 1.2 of *Tier 2 Site Investigation & Tier 3 GQRA Assessment of Tullyvogheen Landfill Report*.

For inspection purposes only.  
Consent of copyright owner required for any other use.



**Plate C4.1. Aerial photograph taken on 29<sup>th</sup> September, 2019 of Former Tullyvogheen Landfill taken at 30m elevation from the northwest of the site facing southwest showing Galway C.C. roads depot area to the west of the site and grassed/capped area to the middle and east of the site**

For inspection purposes only.  
Consent of copyright owner required for any other use.