

## SECTION B – GENERAL

### Attachment B8: Storm Water Overflow Point(s)

- Attachment B.8: Youghal Storm Water Overflow Locations SW002, SW005, SW006, SW007, SW010, SW011

*For inspection purposes only.  
Consent of copyright owner required for any other use.*

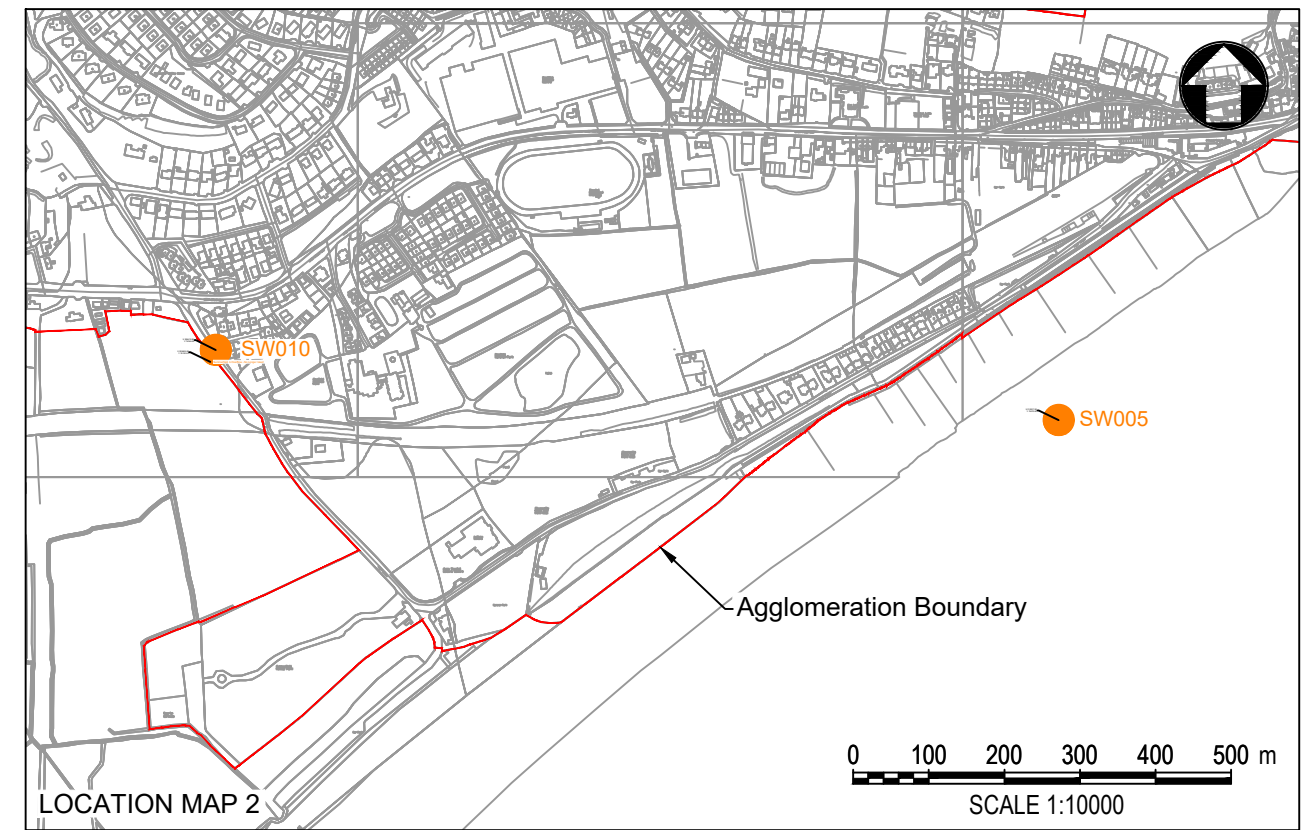
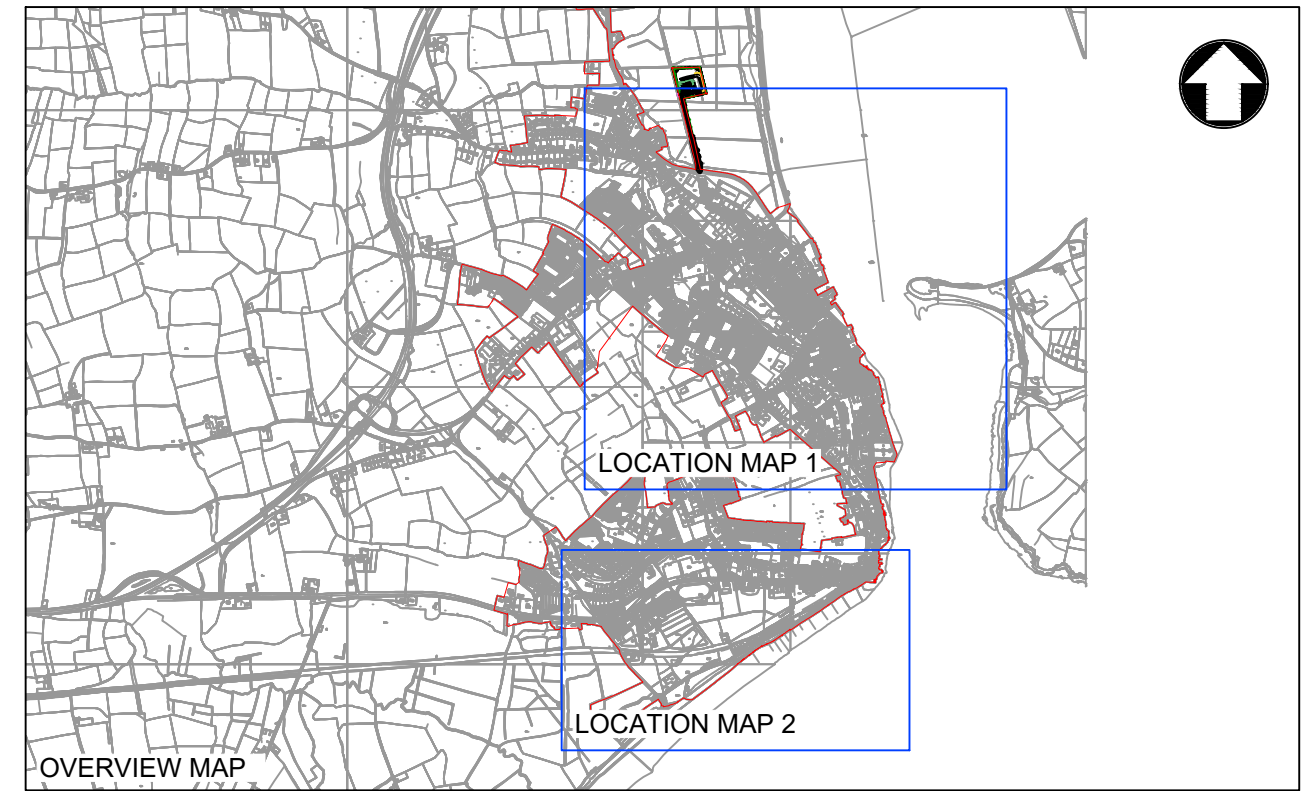
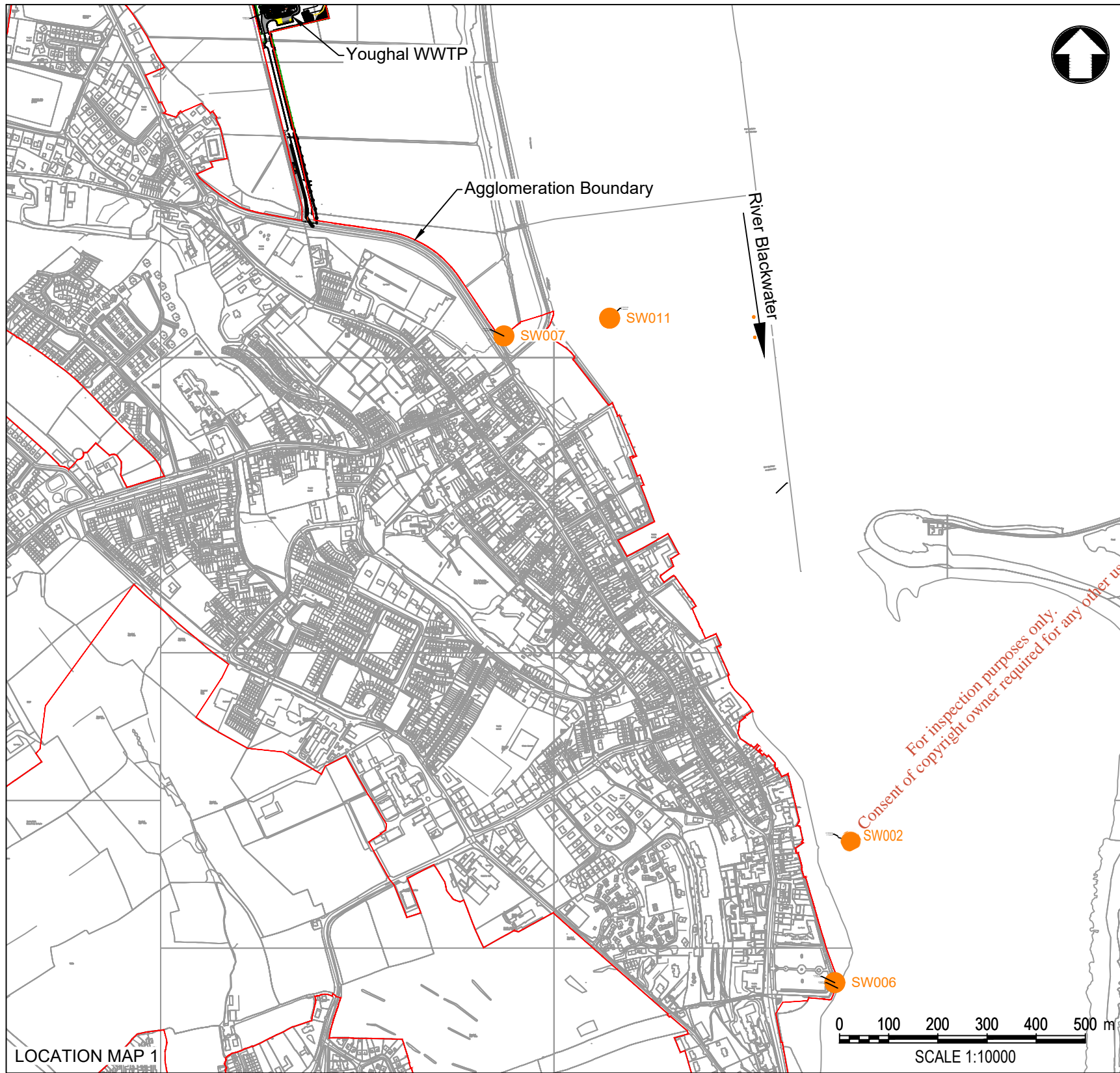

© Mott MacDonald Ireland  
 This document is issued for the party which commissioned it and for specific purposes connected with the captioned project only. It should not be relied upon by any other party or used for any other purpose.  
 We accept no responsibility for the consequences of this document being relied upon by any other party, or being used for any other purpose, or containing any error or omission which is due to an error or omission in data supplied to us by other parties.

	5 Eastgate Avenue Eastgate Little Island Cork Ireland T +353 (0) 21 4809800 F +353 (0) 21 4809801 W www.mottmac.com	Client 	Rev	Date	Drawn	Description	Ch'k'd	App'd	Title	Drawn	D Gallagher			
										Youghal WWDL Review	Checked	P Chambers		
										Storm Water Overflow Location Attachment B.8 Map 4	Approved	R Mansfield		
										Drawing Number 229379472-MMD-00-XX-DR-C-0104	Scale at A3 1:5,000	Security	Status	Rev
			P1	10.03.20	DGal	Issued for Information	PCha	RMan		STD	INF	P01		