

**GENERAL LEGEND**

BORD NA MÓNA OWNERSHIP BOUNDARY	APPLICATION BOUNDARY
PROPOSED SURFACE WATER SWALE	PROPOSED LEACHATE COLLECTION NETWORK
PROPOSED FOUL GRAVITY MAIN	PROPOSED FOUL RISING MAIN
PROPOSED SURFACE WATER NETWORK	PROPOSED SURFACE WATER FILTER DRAIN
PROPOSED WATERMAIN	PROPOSED FIREMAIN
PROPOSED 6 WAY ESB & COMMS DUCT	PROPOSED HYDRANT

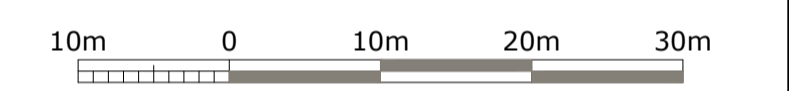
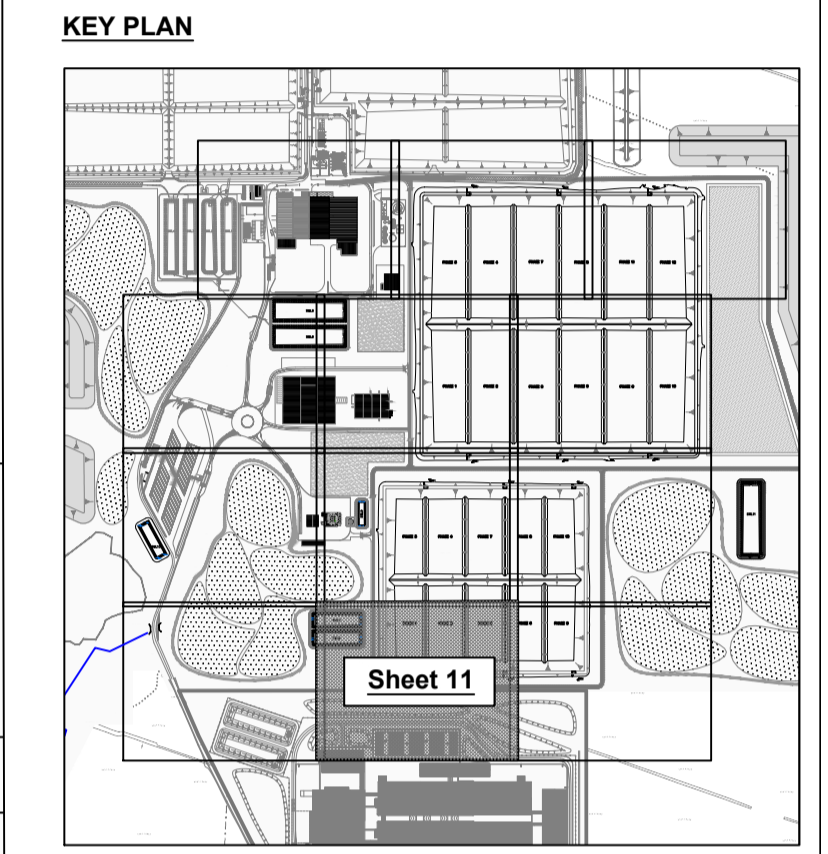

Rev	Date	Description	By	Chkd.
A	Dec. '17	PLANNING ISSUE	EW	DC

Client: **BORD NA MÓNA**  
Naturally Driven

Project: **PROPOSED DEVELOPMENT AT DREHID WASTE MANAGEMENT FACILITY**

Title: **DRAINAGE & UTILITIES LAYOUT PLAN - Sheet 11 of 12 -**

Scale @ A1: **1:500**

Prepared by: **M. Nolan**      Checked: **A. Austin**      Date: **December 2017**

Project Director: **D. Grehan**

Drawing Status: **Planning**

**TOBIN**  
Patrick J. Tobin & Co. Ltd.

TOBIN Consulting Engineers,  
Block 10-4, Blanchardstown Corporate Park,  
Dublin 15, Ireland.  
tel: +353-(0)1-8030406  
fax: +353-(0)1-8030409  
e-mail: dublin@tobin.ie  
www.tobin.ie

**NOTES:**

- FIGURED DIMENSIONS ONLY TO BE TAKEN FROM THIS DRAWING.
- ALL DRAWINGS TO BE CHECKED BY THE CONTRACTOR ON SITE
- ENGINEER/EMPLOYERS REPRESENTATIVE, AS APPROPRIATE, TO BE INFORMED BY THE CONTRACTOR OF ANY DISCREPANCIES BEFORE ANY WORK COMMENCES
- THE CONTRACTOR SHALL UNDERTAKE A THOROUGH CHECK FOR THE ACTUAL LOCATION OF ALL SERVICES/UTILITIES, ABOVE AND BELOW GROUND, BEFORE ANY WORK COMMENCES
- ALL LEVELS SHOWN RELATE TO ORDNANCE SURVEY DATUM AT MALIN HEAD

OSI 1:5,000 SERIES SHEET NO'S:  
3187, 3188, 3253, 3254, 3318, 3319, 3381, 3382.

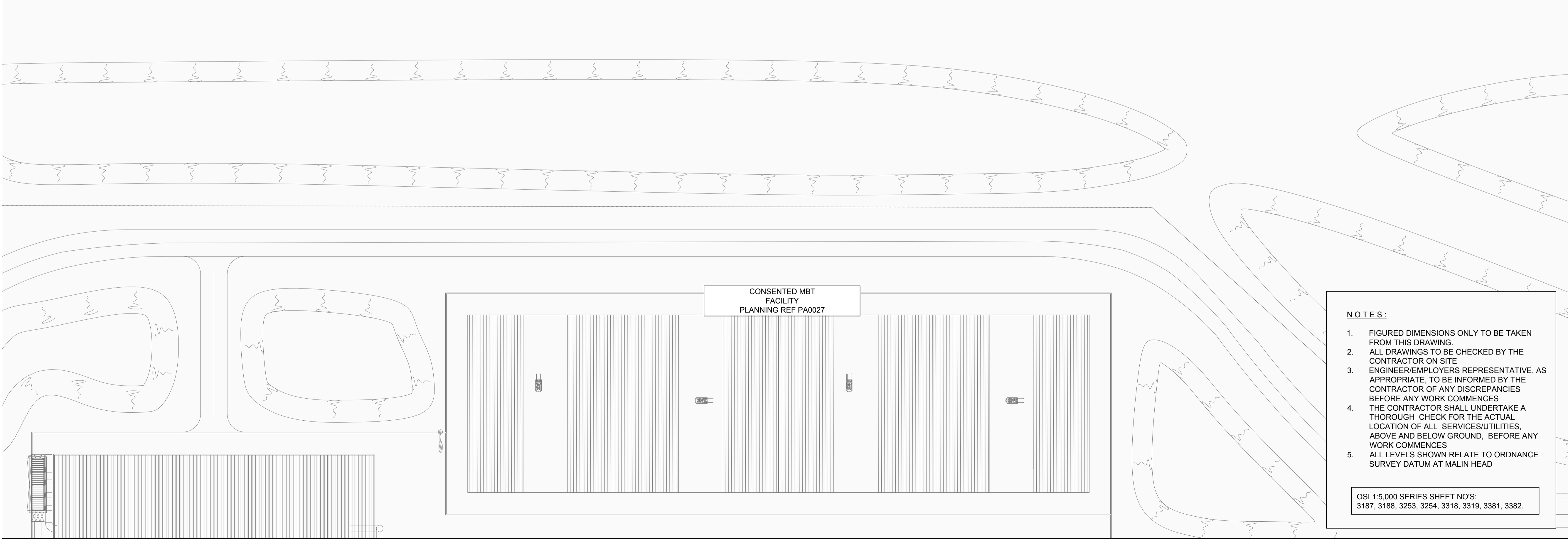

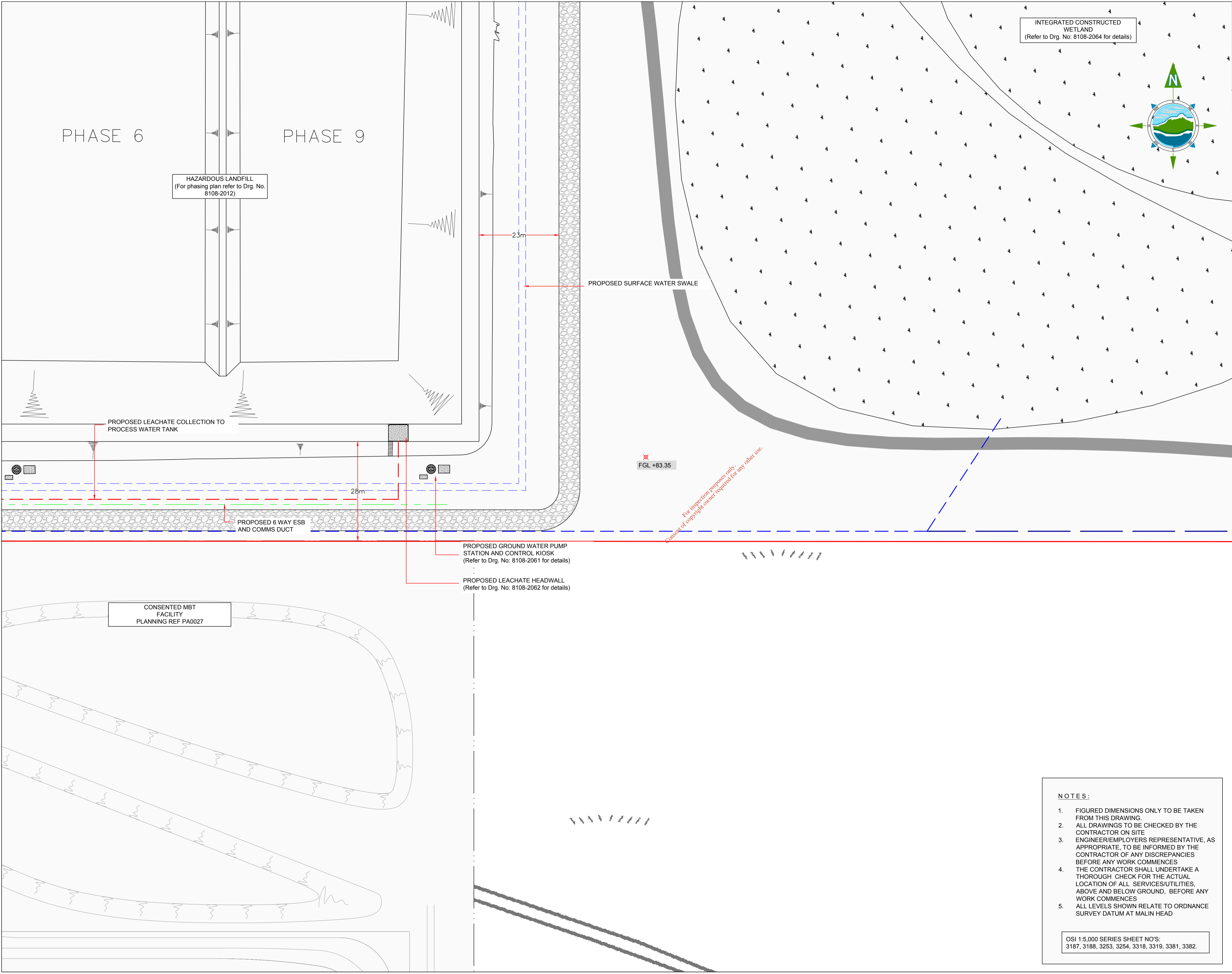

INTEGRATED CONSTRUCTED WETLAND  
(Refer to Drg. No. 8108-2064 for details)

HAZARDOUS LANDFILL  
(For phasing plan refer to Drg. No. 8108-2012)

CONSENTED MBT FACILITY  
PLANNING REF PA0027

FGL +83.35

*For connection purposes only.  
Consent of copyright owner required for any other use.*

**GENERAL LEGEND**

BORD NA MÓNA OWNERSHIP BOUNDARY	APPLICATION BOUNDARY
PROPOSED SURFACE WATER SWALE	PROPOSED LEACHATE COLLECTION NETWORK
PROPOSED FOUL GRAVITY MAIN	PROPOSED FOUL RISING MAIN
PROPOSED SURFACE WATER NETWORK	PROPOSED SURFACE WATER FILTER DRAIN
PROPOSED WATERMAIN	PROPOSED FIREMAIN
PROPOSED 6 WAY ESB & COMMS DUCT	PROPOSED HYDRANT

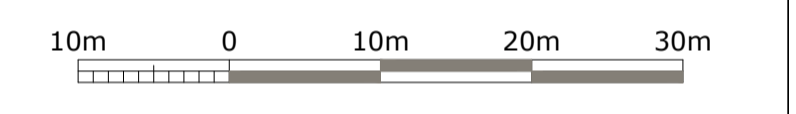
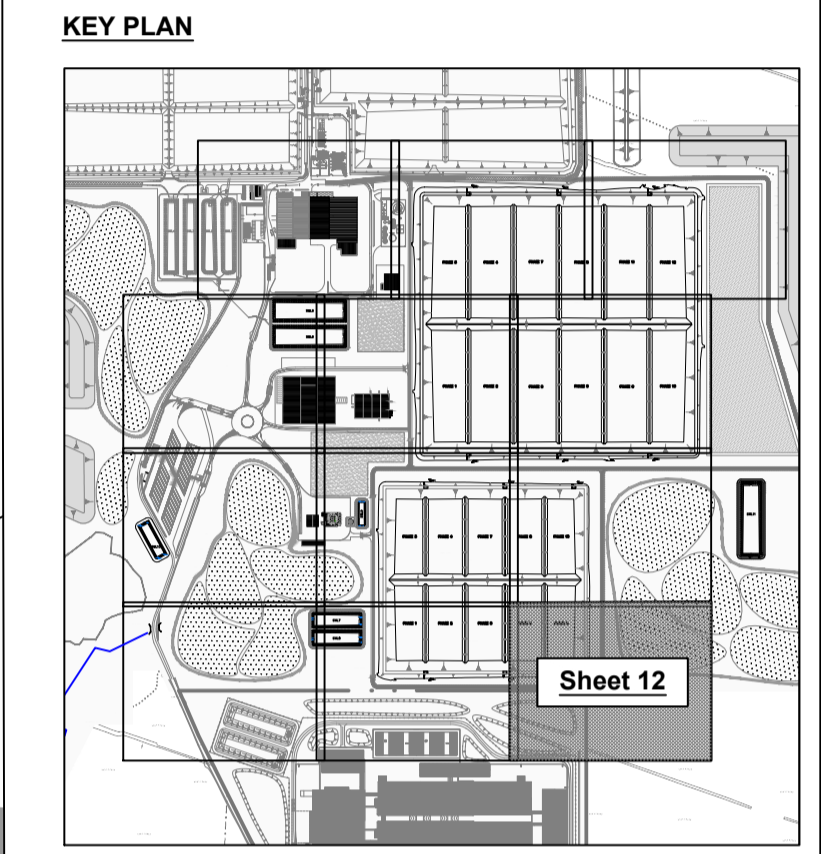

Rev	Date	Description	By	Chkd.
A	Dec. '17	PLANNING ISSUE	EW	DC

Client: **BORD NA MÓNA**  
Naturally Driven

Project: **PROPOSED DEVELOPMENT AT DREHID WASTE MANAGEMENT FACILITY**

Title: **DRAINAGE & UTILITIES LAYOUT PLAN - Sheet 12 of 12 -**

Scale @ A1: **1:500**  
Prepared by: M. Nolan  
Checked: A. Austin  
Date: December 2017  
Project Director: D. Grehan  
Drawing Status: Planning

**TOBIN**  
Patrick J. Tobin & Co. Ltd.  
TOBIN Consulting Engineers,  
Block 10-4, Blanchardstown Corporate Park,  
Dublin 15, Ireland.  
tel: +353-(0)1-8030406  
fax: +353-(0)1-8030409  
e-mail: dublin@tobin.ie  
www.tobin.ie

- NOTES:**
- FIGURED DIMENSIONS ONLY TO BE TAKEN FROM THIS DRAWING.
  - ALL DRAWINGS TO BE CHECKED BY THE CONTRACTOR ON SITE
  - ENGINEER/EMPLOYERS REPRESENTATIVE, AS APPROPRIATE, TO BE INFORMED BY THE CONTRACTOR OF ANY DISCREPANCIES BEFORE ANY WORK COMMENCES
  - THE CONTRACTOR SHALL UNDERTAKE A THOROUGH CHECK FOR THE ACTUAL LOCATION OF ALL SERVICES/UTILITIES, ABOVE AND BELOW GROUND, BEFORE ANY WORK COMMENCES
  - ALL LEVELS SHOWN RELATE TO ORDNANCE SURVEY DATUM AT MALIN HEAD

OSI 1:5,000 SERIES SHEET NO'S:  
3187, 3188, 3253, 3254, 3318, 3319, 3381, 3382.

Revision: **8108-2028 A**



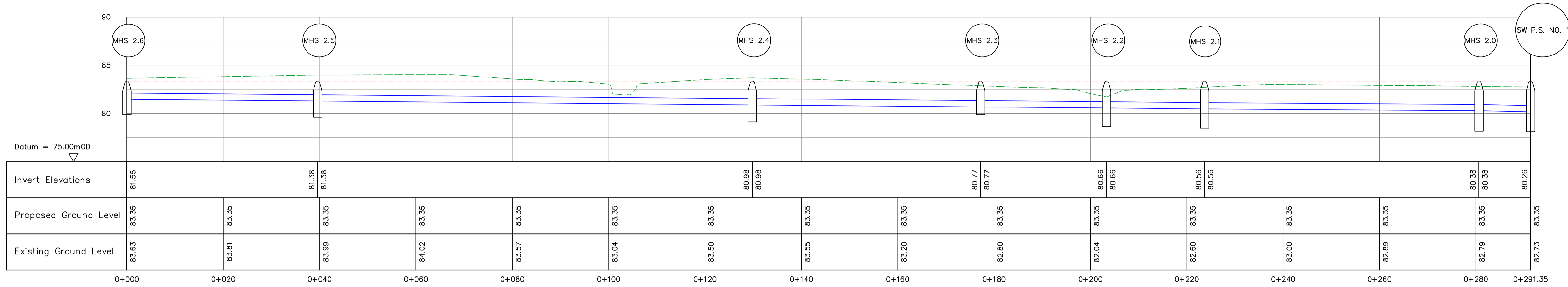

**SURFACE WATER NETWORK NO. 2**  
- LONGITUDINAL SECTION MHS 2.6 TO SW P.S. NO. 1

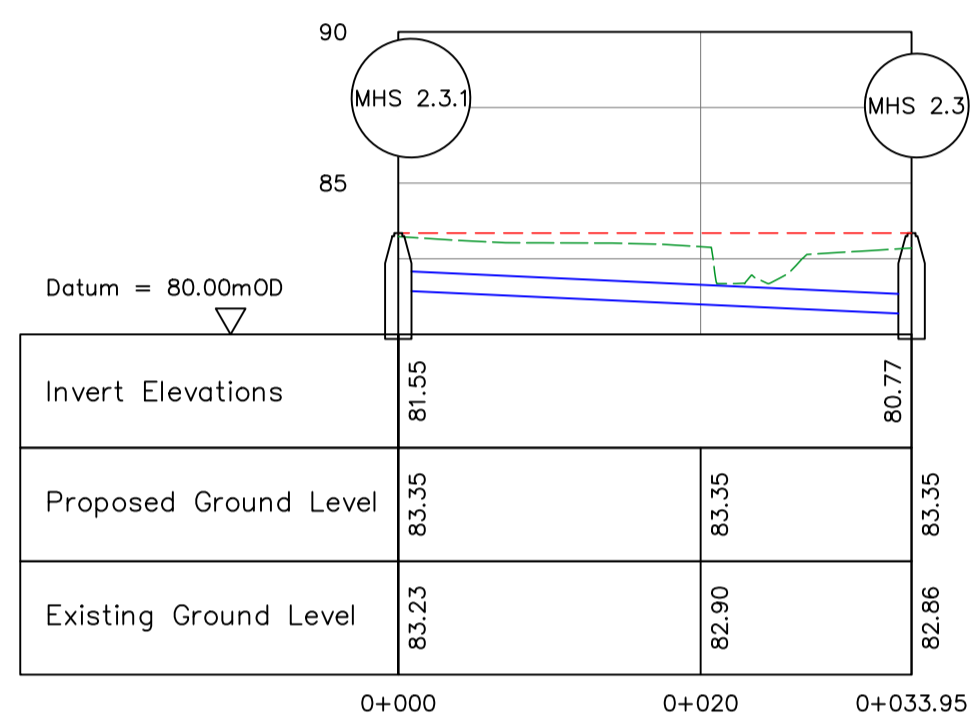

**SURFACE WATER NETWORK NO. 2**  
- LONGITUDINAL SECTION MHS 2.3.1 TO MHS 2.3

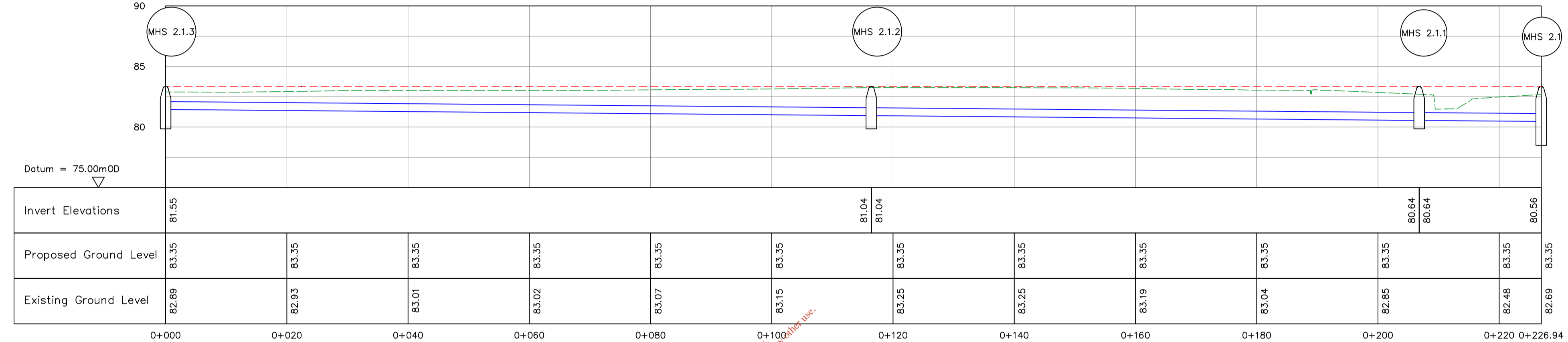

**SURFACE WATER NETWORK NO. 2**  
- LONGITUDINAL SECTION MHS 2.1.3 TO MHS 2.1

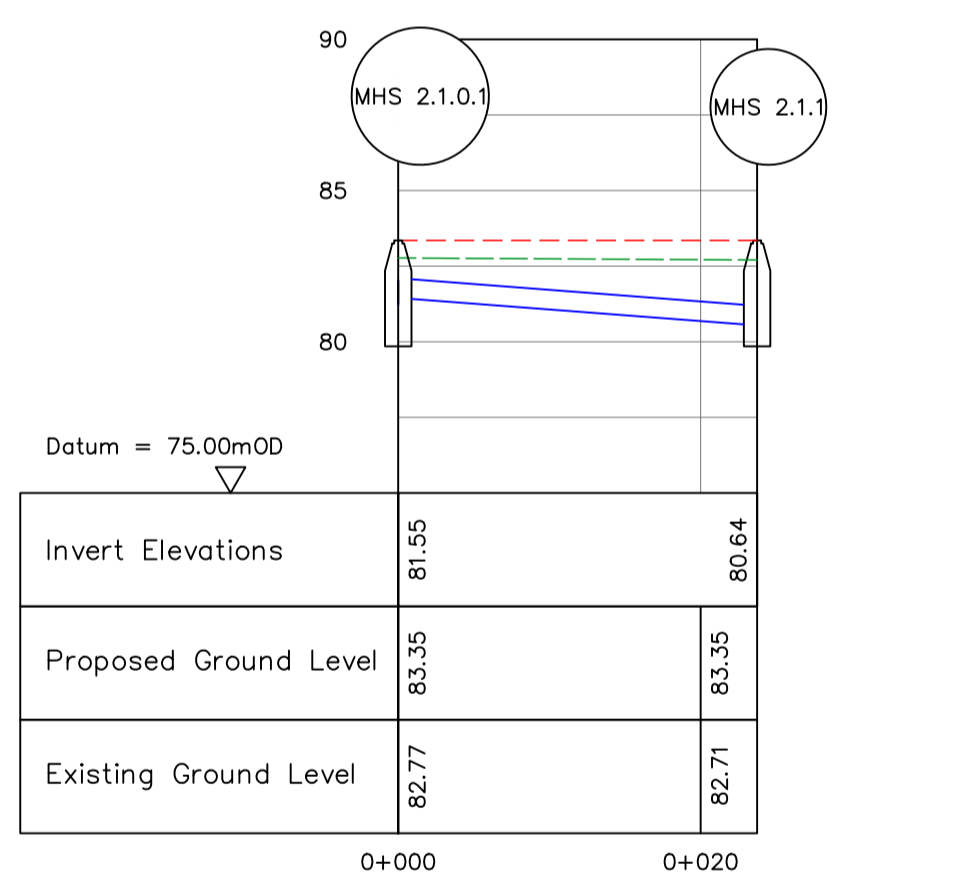

**SURFACE WATER NETWORK NO. 2**  
- LONGITUDINAL SECTION MHS 2.1.0.1 TO MHS 2.1.1

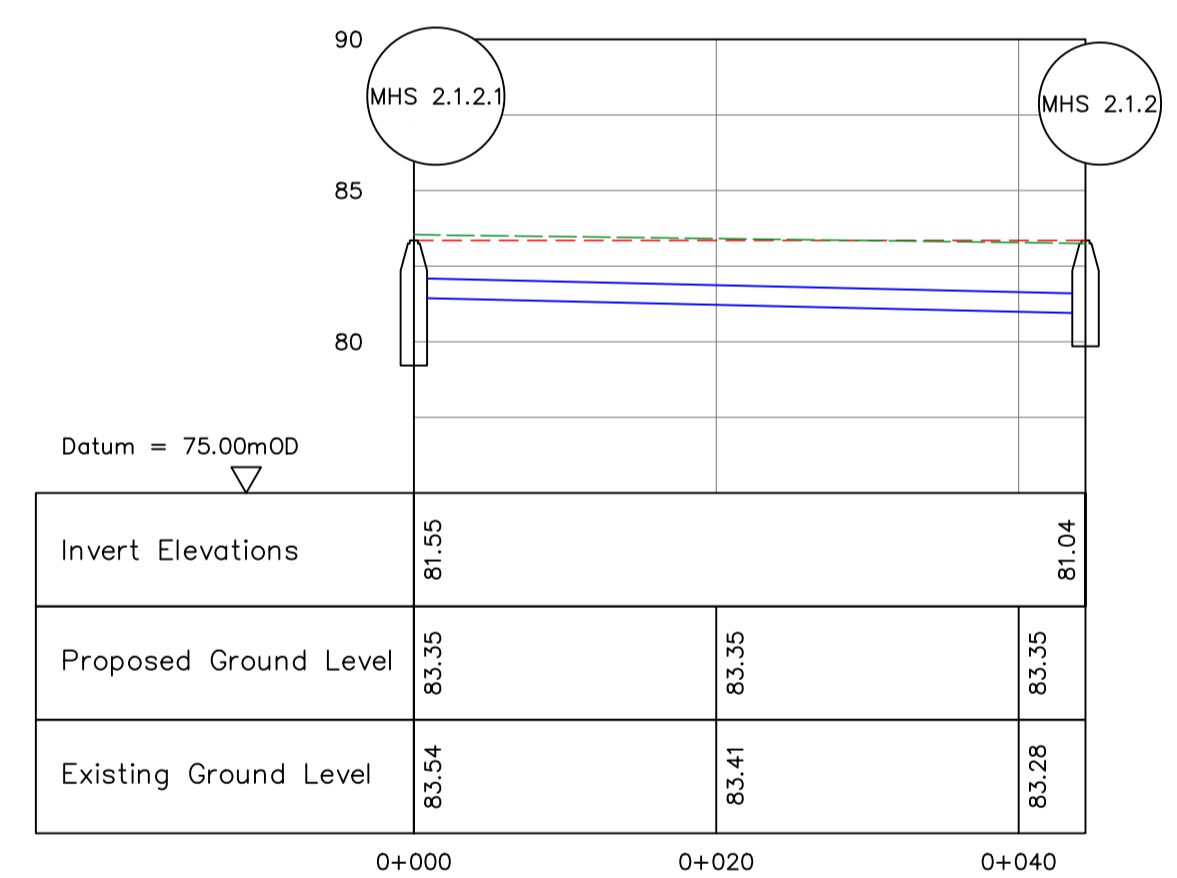

**SURFACE WATER NETWORK NO. 2**  
- LONGITUDINAL SECTION MHS 2.1.2.1 TO MHS 2.1.2

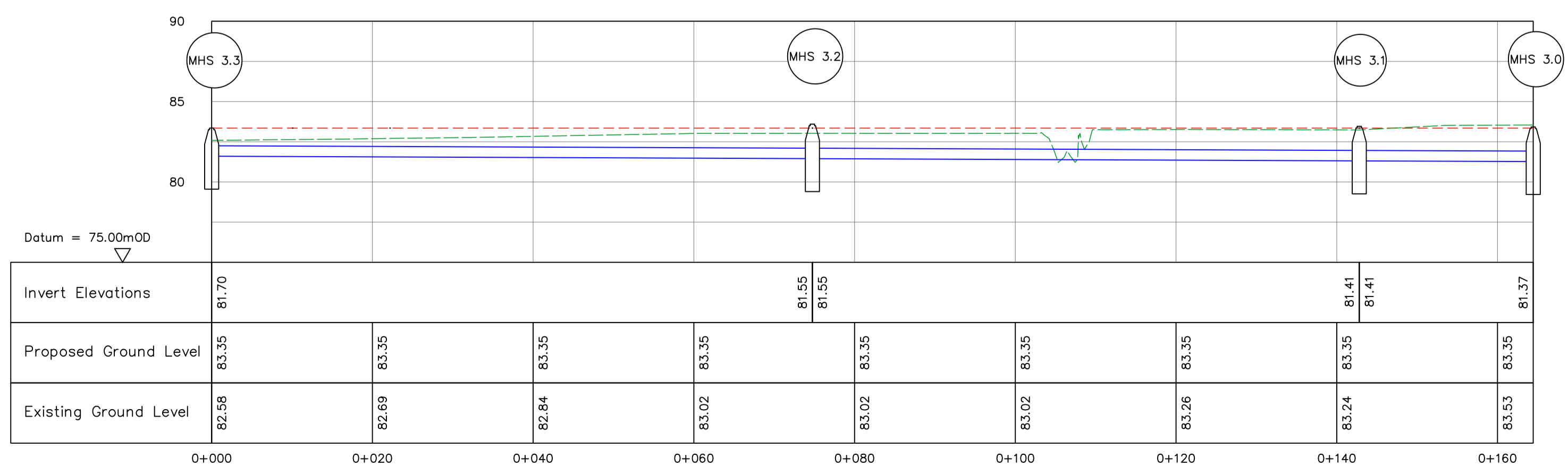

**SURFACE WATER NETWORK NO. 3**  
- LONGITUDINAL SECTION MHS 3.3 TO MHS 3.0

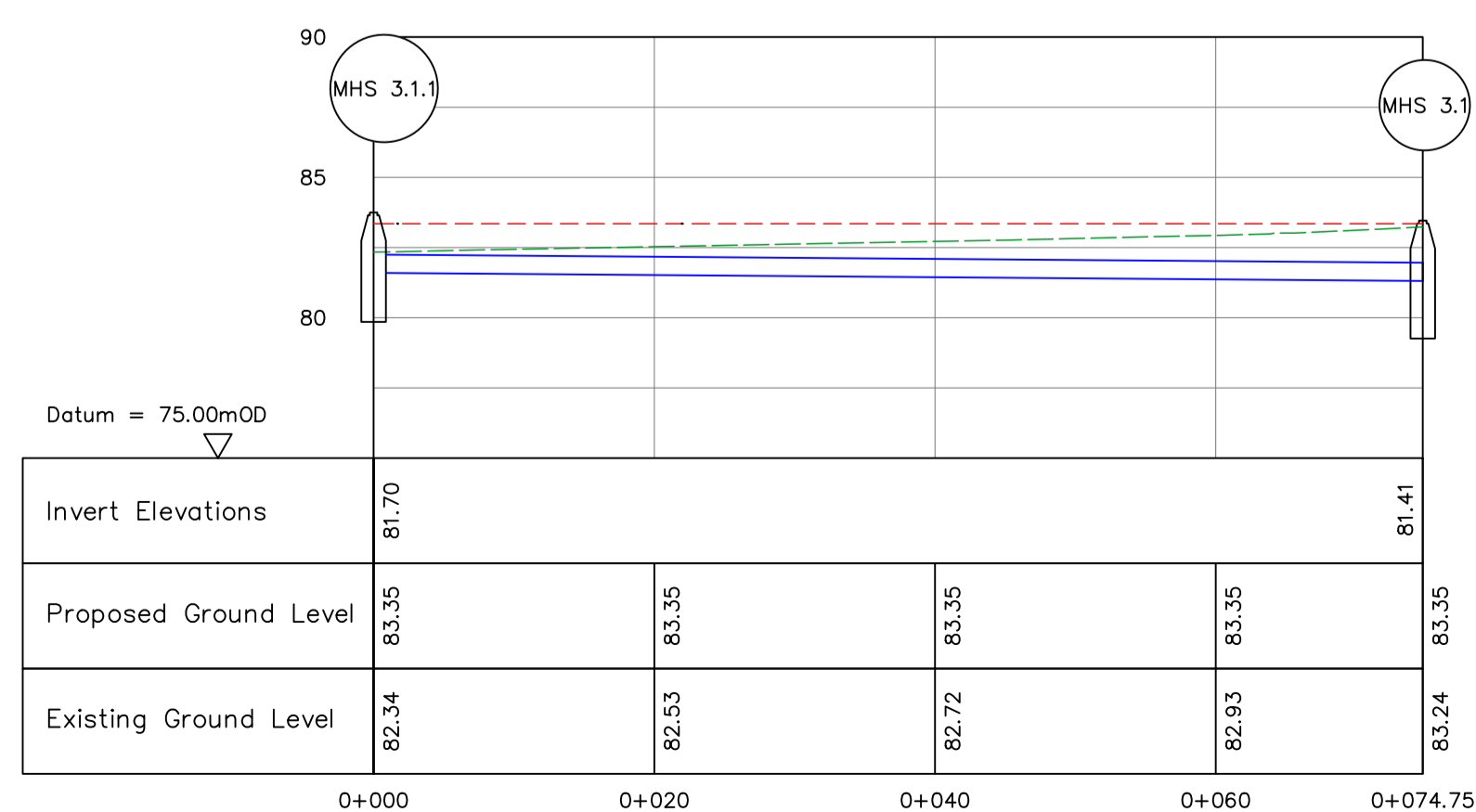

**SURFACE WATER NETWORK NO. 3**  
- LONGITUDINAL SECTION MHS 3.1.1 TO MHS 3.1

**LEGEND:**  
 EXISTING GROUND PROFILE  
 PROPOSED GROUND PROFILE  
 PROPOSED SURFACE WATER PIPE

For information purposes only  
 Consent of copyright owner required for any other use.

Rev	Date	Description	By	Chkd.
A	Dec. '17	PLANNING ISSUE	MN	DC

Client: **BORD NA MÓNA**  
Naturally Driven

Project: **PROPOSED DEVELOPMENT AT DREHID WASTE MANAGEMENT FACILITY**

Title: **SURFACE WATER DRAINAGE LONGITUDINAL SECTIONS - Sheet 2 of 3 -**

Scale @ A1: H = 1:500 / V = 1:250  
 Prepared by: M. Nolan  
 Checked: A. Austin  
 Date: December 2017  
 Project Director: D. Grehan  
 Drawing Status:

**TOBIN**  
Patrick J. Tobin & Co. Ltd.  
 TOBIN Consulting Engineers,  
 Block 10-4, Blanchardstown Corporate Park,  
 Dublin 15, Ireland.  
 tel: +353-(0)1-8030406  
 fax: +353-(0)1-8030409  
 e-mail: dublin@tobin.ie  
 www.tobin.ie

Drawing No.: **8108-2030** Revision: **A**

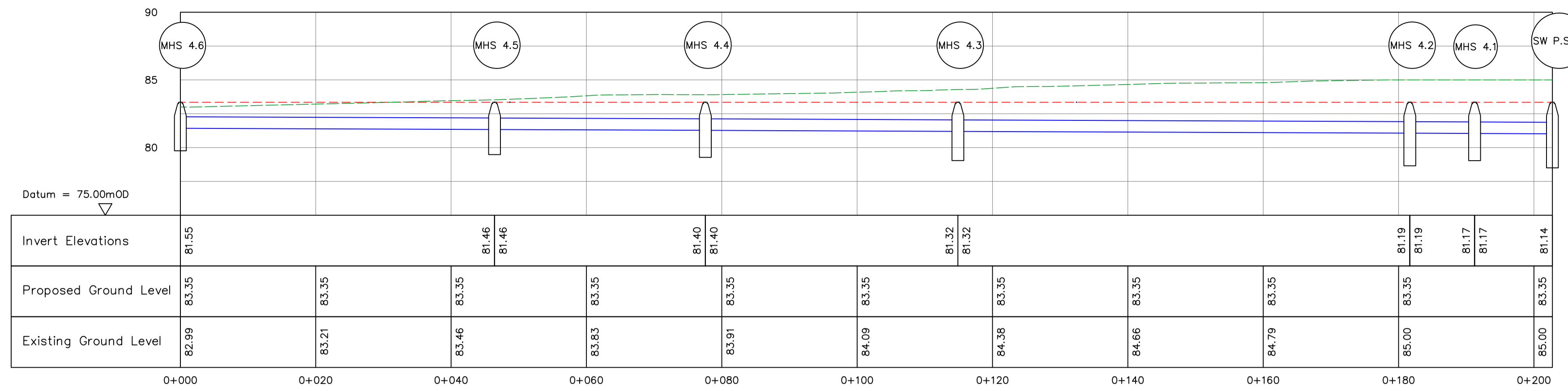

**SURFACE WATER NETWORK NO. 4**  
- LONGITUDINAL SECTION MHS 4.6 TO SW P.S. 2

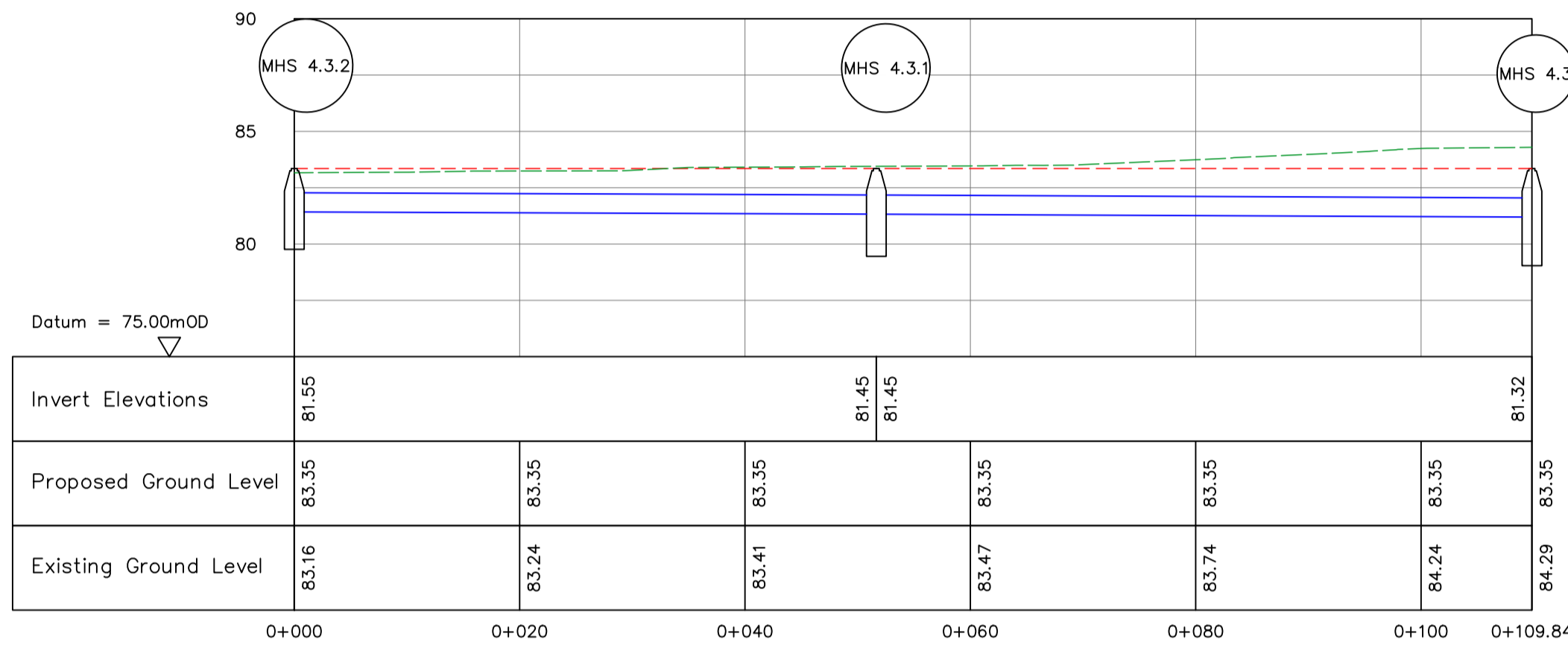

**SURFACE WATER NETWORK NO. 4**  
- LONGITUDINAL SECTION MHS 4.3.2 TO MHS 4.3

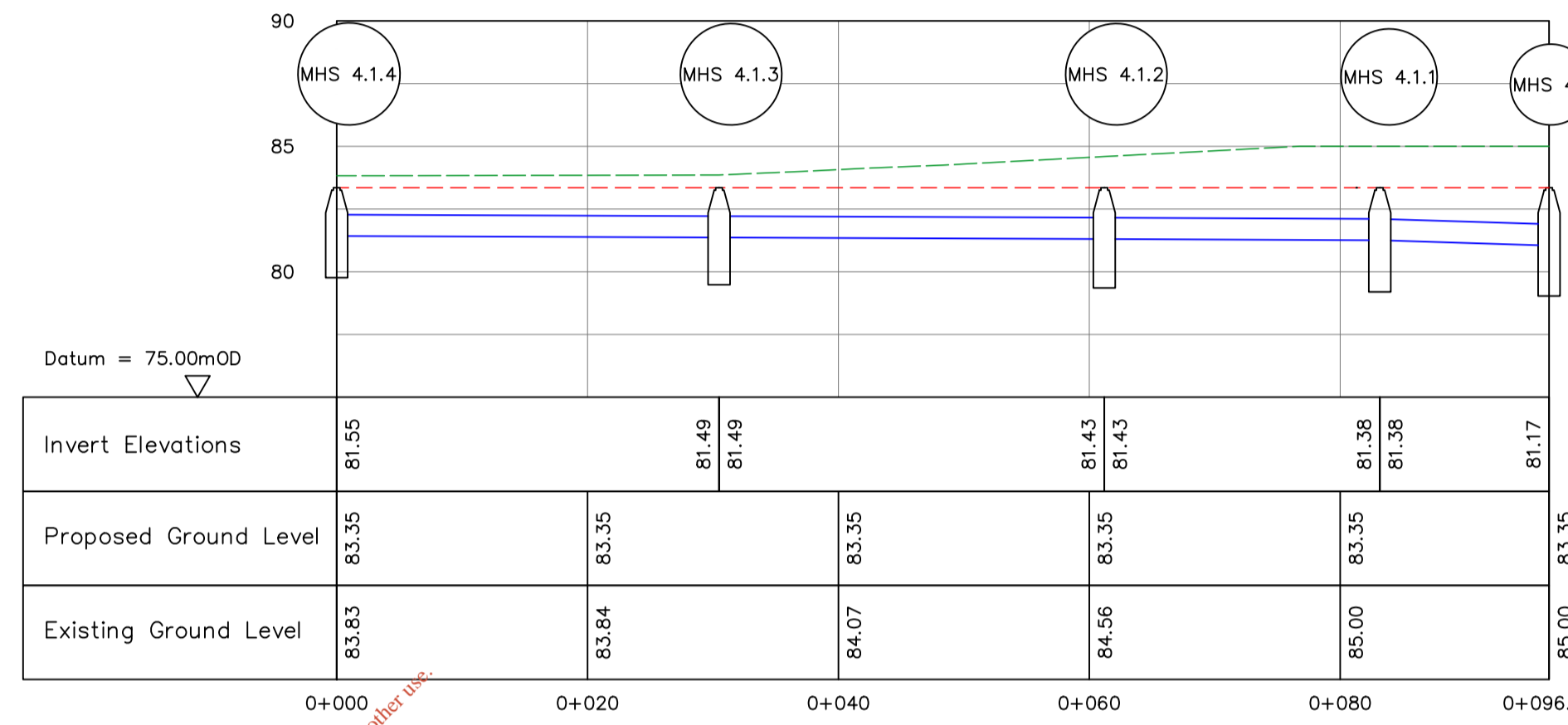

**SURFACE WATER NETWORK NO. 4**  
- LONGITUDINAL SECTION MHS 4.1.4 TO MHS 4.1

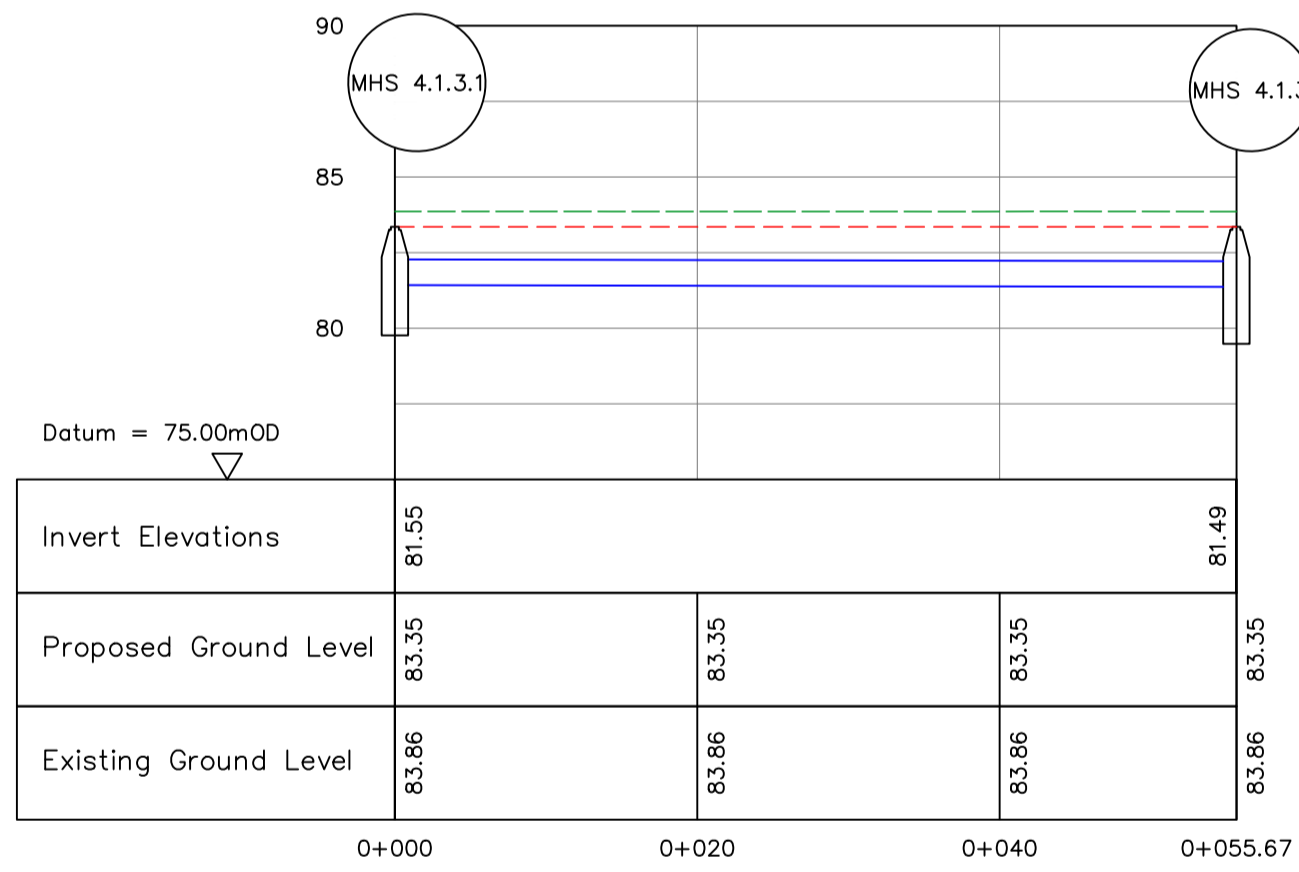

**SURFACE WATER NETWORK NO. 4**  
- LONGITUDINAL SECTION MHS 4.1.3.1 TO MHS 4.1.3

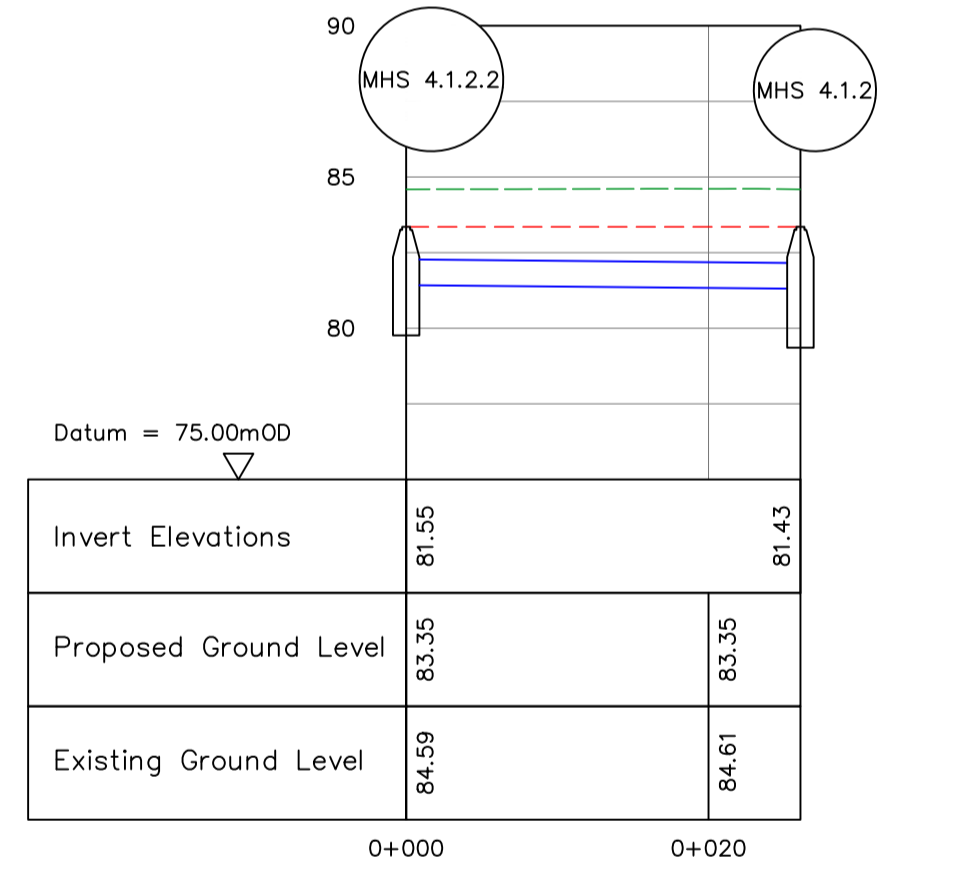

**SURFACE WATER NETWORK NO. 4**  
- LONGITUDINAL SECTION MHS 4.1.2.2 TO MHS 4.1.2

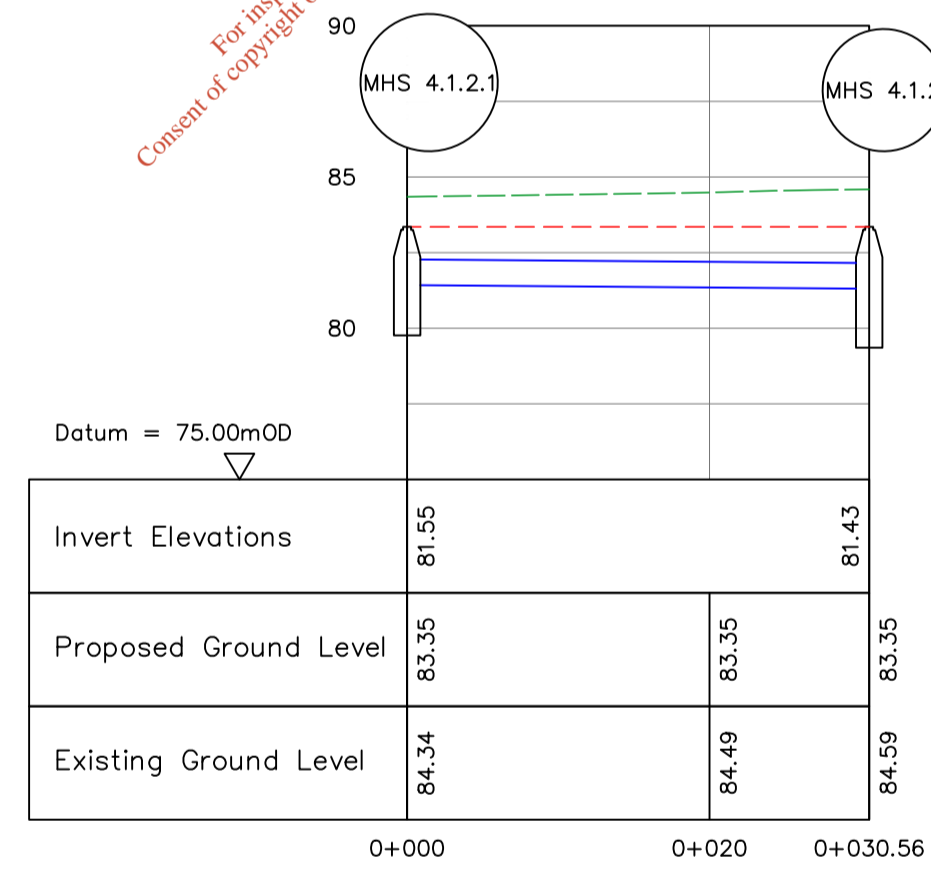

**SURFACE WATER NETWORK NO. 4**  
- LONGITUDINAL SECTION MHS 4.1.2.1 TO MHS 4.1.2

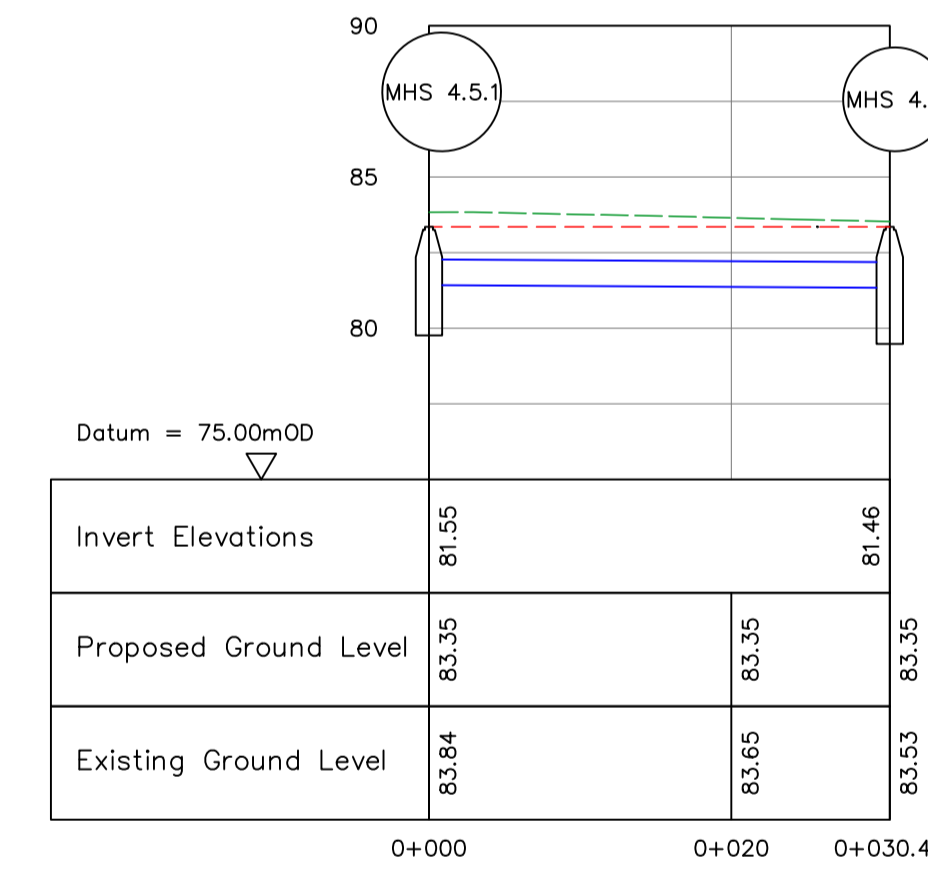

**SURFACE WATER NETWORK NO. 4**  
- LONGITUDINAL SECTION MHS 4.5.1 TO MHS 4.5

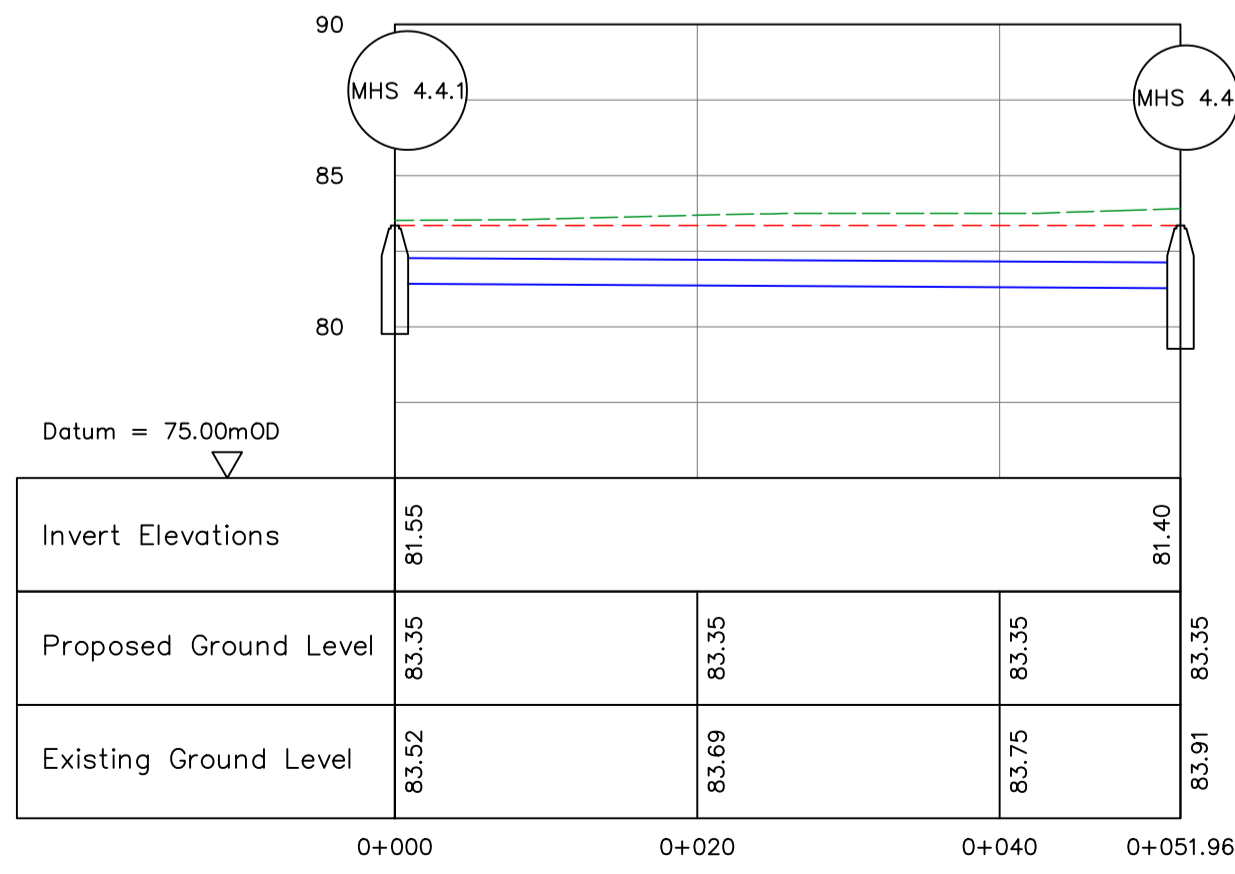

**SURFACE WATER NETWORK NO. 4**  
- LONGITUDINAL SECTION MHS 4.4.1 TO MHS 4.4

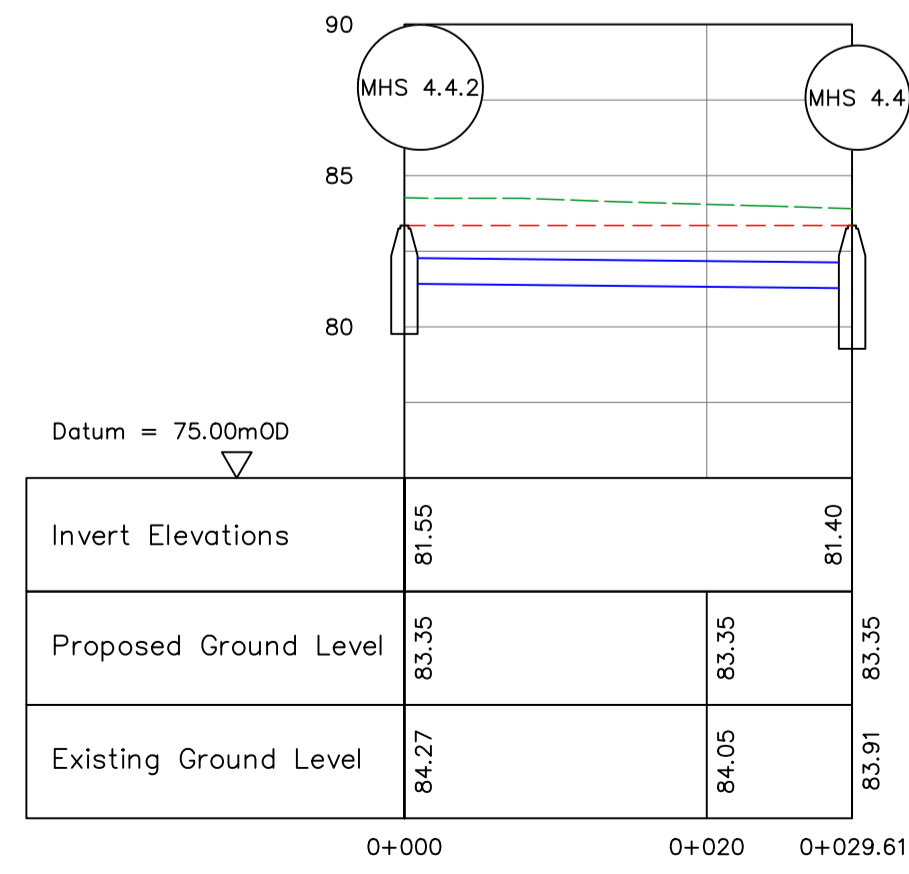

**SURFACE WATER NETWORK NO. 4**  
- LONGITUDINAL SECTION MHS 4.4.2 TO MHS 4.4

**LEGEND:**  
 EXISTING GROUND PROFILE  
 PROPOSED GROUND PROFILE  
 PROPOSED SURFACE WATER PIPE

A	Dec. '17	PLANNING ISSUE	MN	DC
Rev	Date	Description	By	Chkd.

Client: **BORD NA MÓNA**  
Naturally Driven

Project: **PROPOSED DEVELOPMENT AT DREHID WASTE MANAGEMENT FACILITY**

Title: **SURFACE WATER DRAINAGE LONGITUDINAL SECTIONS - Sheet 3 of 3 -**

Scale @ A1: H = 1:500 / V = 1:250

Prepared by: M. Nolan      Checked: A. Austin      Date: December 2017

Project Director: D. Grehan

Drawing Status:

**TOBIN**  
Patrick J. Tobin & Co. Ltd.

TOBIN Consulting Engineers,  
Block 10-4, Blanchardstown Corporate Park,  
Dublin 15, Ireland.  
tel: +353-(0)1-8030406  
fax: +353-(0)1-8030409  
e-mail: dublin@tobin.ie  
www.tobin.ie

Drawing No.: **8108-2031**      Revision: **A**

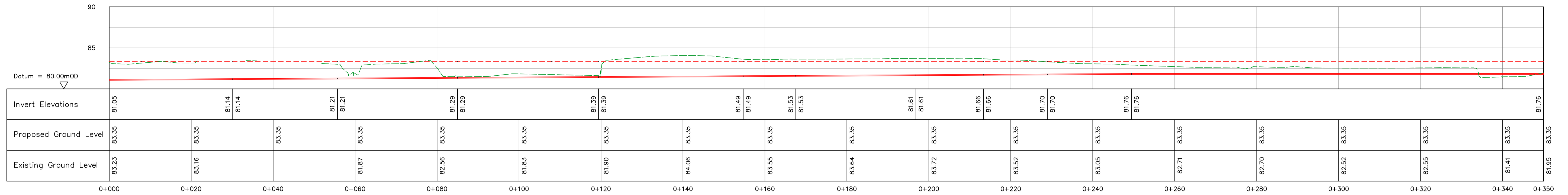

**FOUL WATER RISING MAIN NO. 1**  
- LONGITUDINAL SECTION PUMP STATION NO. 1 TO ScV

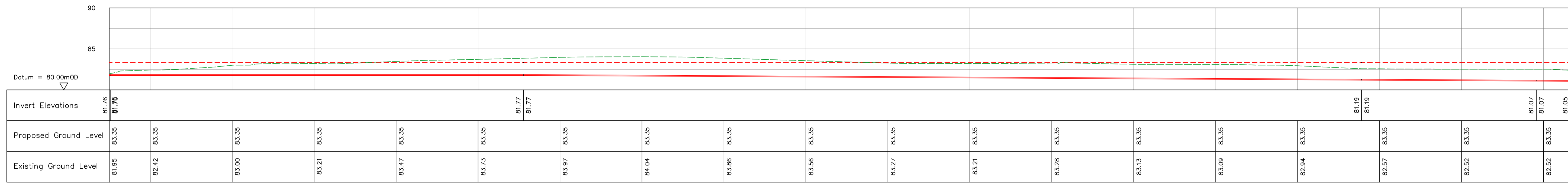

**FOUL WATER RISING MAIN NO. 1**  
- LONGITUDINAL SECTION ScV. TO LEACHATE TREATMENT FACILITY

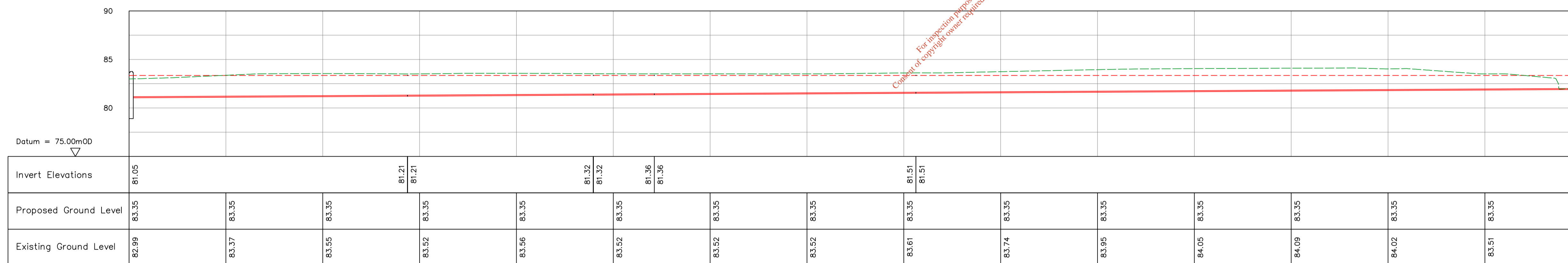

**FOUL WATER RISING MAIN NO. 2**  
- LONGITUDINAL SECTION PUMP STATION NO. 2 TO ScV

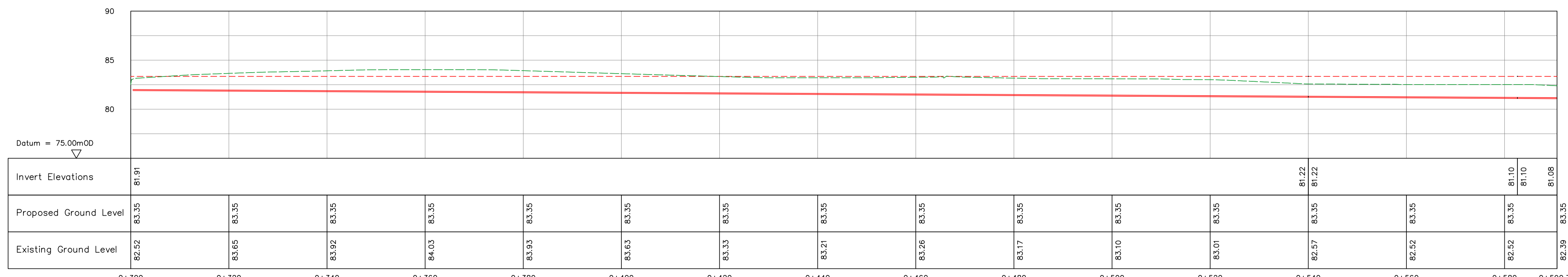

**FOUL WATER RISING MAIN NO. 2**  
- LONGITUDINAL SECTION ScV. TO LEACHATE TREATMENT FACILITY

**LEGEND:**  
 EXISTING GROUND PROFILE  
 PROPOSED GROUND PROFILE  
 PROPOSED FOUL WATER PIPE

Rev	Date	Description	By	Chkd.
A	Dec. '17	PLANNING ISSUE	MN	DC

Client: **BORD NA MÓNA**  
Naturally Driven

Project: **PROPOSED DEVELOPMENT AT DREHID WASTE MANAGEMENT FACILITY**

Title: **FOUL WATER DRAINAGE LONGITUDINAL SECTIONS - Sheet 1 of 2 -**

Scale @ A1: H = 1:500 / V = 1:250  
 Prepared by: M. Nolan  
 Checked: A. Austin  
 Date: December 2017  
 Project Director: D. Grehan  
 Drawing Status:

**TOBIN**  
Patrick J. Tobin & Co. Ltd.  
 TOBIN Consulting Engineers,  
 Block 10-4, Blanchardstown Corporate Park,  
 Dublin 15, Ireland.  
 tel: +353-(0)1-8030406  
 fax: +353-(0)1-8030409  
 e-mail: dublin@tobin.ie  
 www.tobin.ie

TOBIN Consulting Engineers will not be liable for any use of this document for any purpose other than that for which it was originally prepared.  
 Except where specifically and explicitly agreed in writing by TOBIN Consulting Engineers, copyright holder, the rest of this document may be reproduced or transmitted in any form and this document shall not be relied upon by any third party for any purpose.

Drawing No.: **8108-2032** Revision: **A**

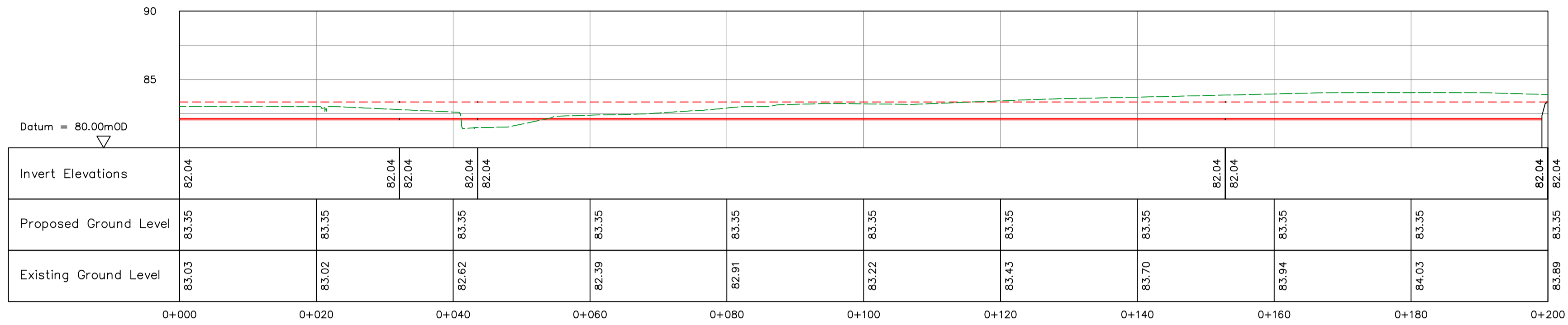

**FOUL WATER RISING MAIN NO. 3**  
**- LONGITUDINAL SECTION PUMP STATION NO. 3 TO ScV**

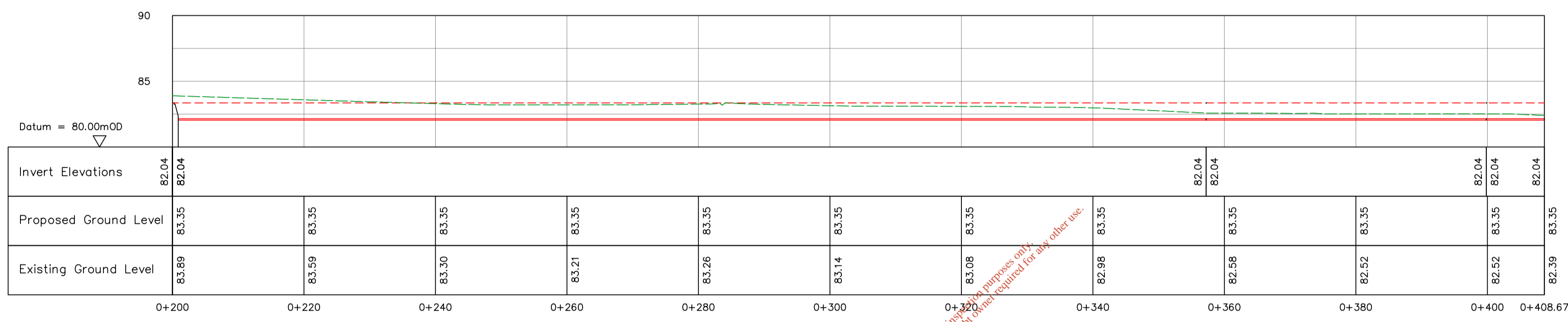

**FOUL WATER RISING MAIN NO. 3**  
**- LONGITUDINAL SECTION ScV. TO LEACHATE TREATMENT FACILITY**

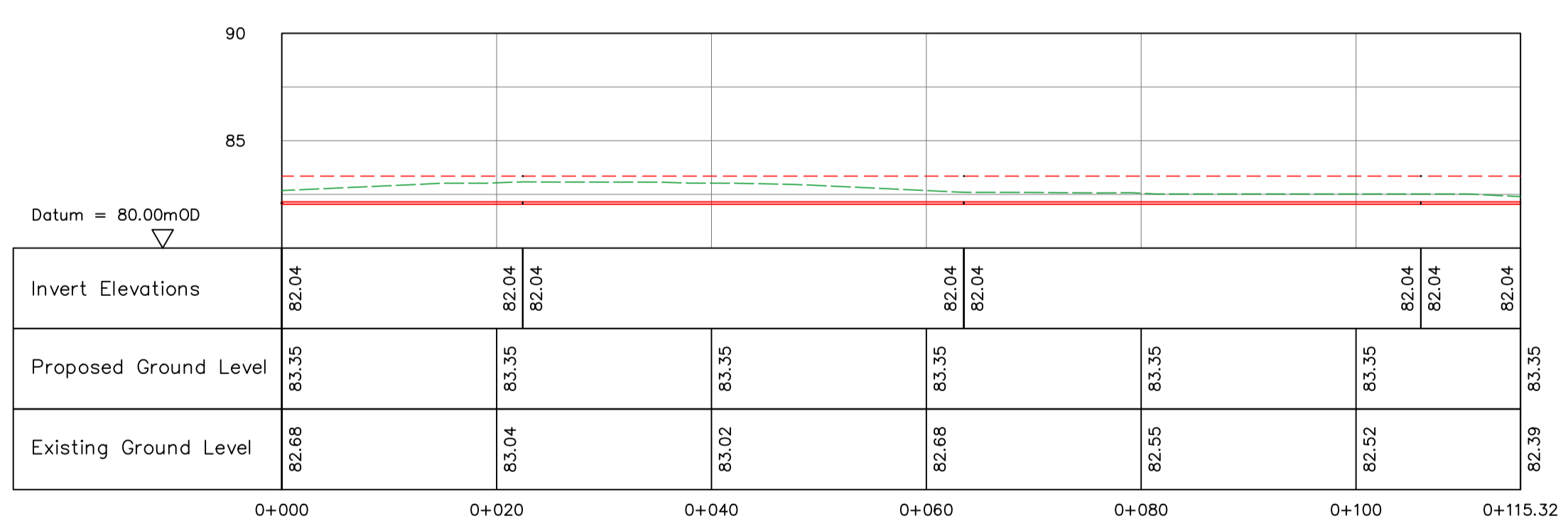

**FOUL WATER RISING MAIN NO. 4**  
**- LONGITUDINAL SECTION PUMP STATION NO. 4 TO LEACHATE TREATMENT FACILITY**

**LEGEND:**  
 EXISTING GROUND PROFILE  
 PROPOSED GROUND PROFILE  
 PROPOSED FOUL WATER PIPE

Rev	Date	Description	By	Chkd.
A	Dec. '17	PLANNING ISSUE	MN	DC

Client: **BORD NA MÓNA**  
 Naturally Driven

Project:  
**PROPOSED DEVELOPMENT AT DREHID WASTE MANAGEMENT FACILITY**

Title:  
**FOUL WATER DRAINAGE LONGITUDINAL SECTIONS - Sheet 2 of 2 -**

Scale @ A1: H = 1:500 / V = 1:250

Prepared by: M. Nolan      Checked: A. Austin      Date: December 2017

Project Director: D. Grehan

Drawing Status:

**TOBIN**  
 Patrick J. Tobin & Co. Ltd.

TOBIN Consulting Engineers,  
 Block 10-4, Blanchardstown Corporate Park,  
 Dublin 15, Ireland.  
 tel: +353-(0)1-8030406  
 fax: +353-(0)1-8030409  
 e-mail: dublin@tobin.ie  
 www.tobin.ie

Drawing No.: **8108-2033**      Revision: **A**

For use as a reference only.  
 Consent of copyright owner required for any other use.

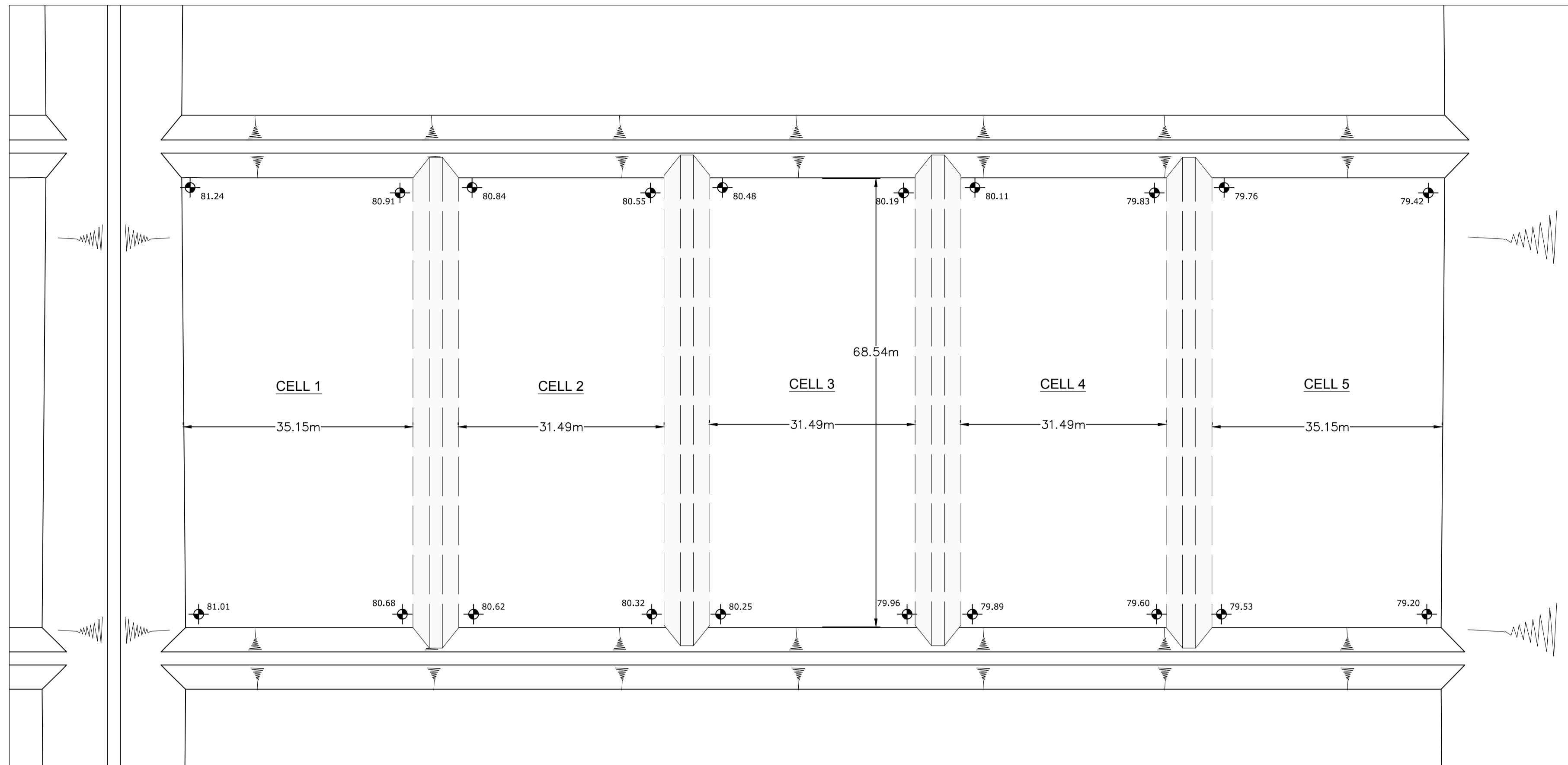

**TYPICAL NON HAZARDOUS LANDFILL CELL LAYOUT**  
Scale 1:500

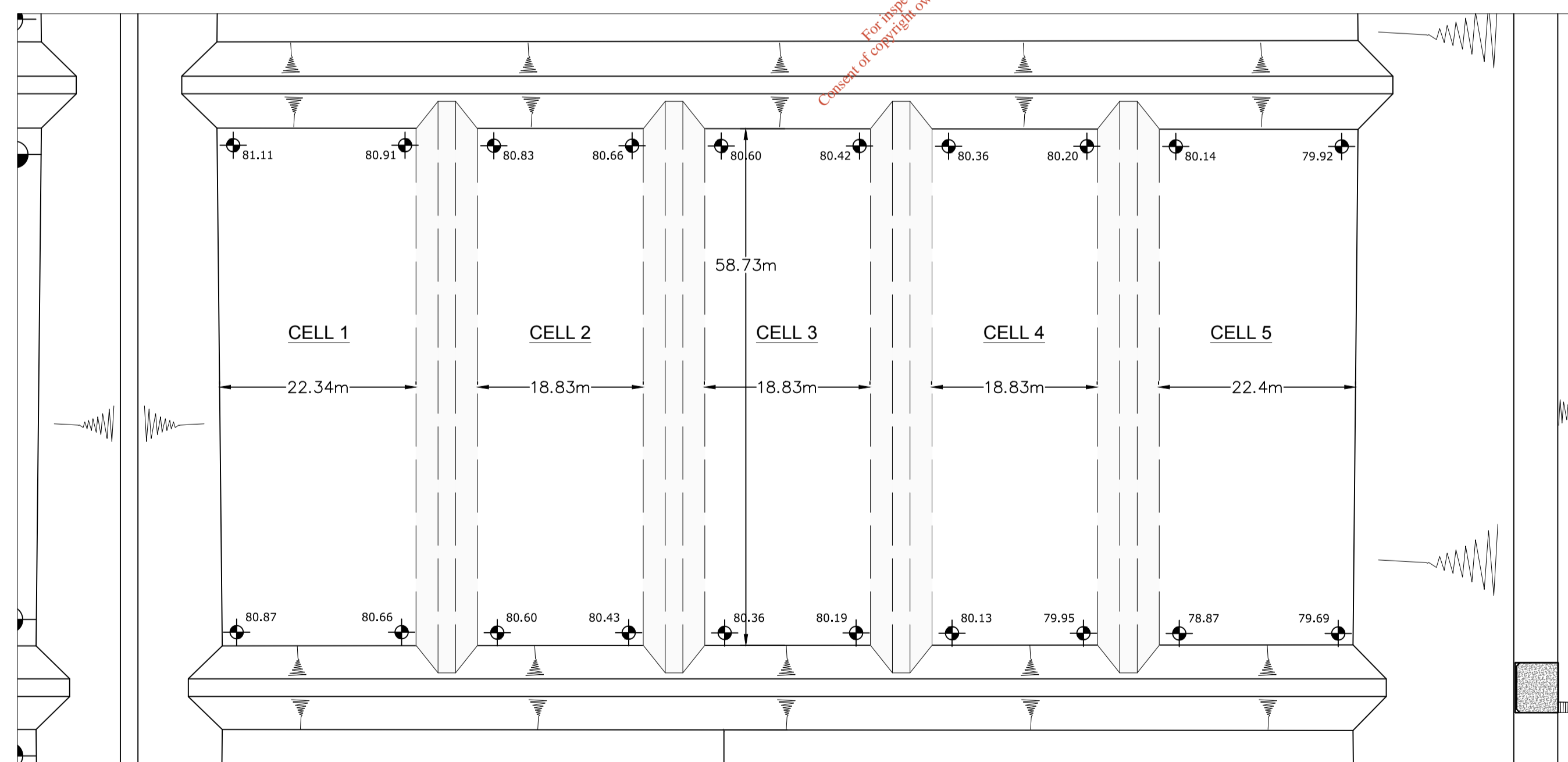

**TYPICAL HAZARDOUS LANDFILL CELL LAYOUT**  
Scale 1:500

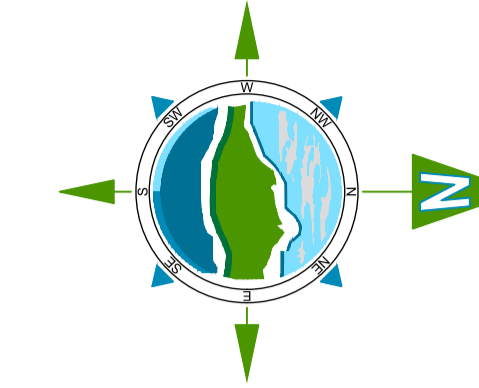

**NOTES:**

1. FIGURED DIMENSIONS ONLY TO BE TAKEN FROM THIS DRAWING.
2. ALL DRAWINGS TO BE CHECKED BY THE CONTRACTOR ON SITE.
3. ENGINEER/EMPLOYERS REPRESENTATIVE, AS APPROPRIATE, TO BE INFORMED BY THE CONTRACTOR OF ANY DISCREPANCIES BEFORE ANY WORK COMMENCES.
4. THE CONTRACTOR SHALL UNDERTAKE A THOROUGH CHECK FOR THE ACTUAL LOCATION OF ALL SERVICES/UTILITIES, ABOVE AND BELOW GROUND, BEFORE ANY WORK COMMENCES.
5. ALL LEVELS SHOWN RELATE TO ORDINANCE SURVEY DATUM AT MALIN HEAD.

Rev	Date	Description	By	Chkd.
A	Dec. '17	PLANNING ISSUE	MN	DC

Client: **BORD NA MÓNA**  
Naturally Driven

Project:  
**PROPOSED DEVELOPMENT AT DREHID WASTE MANAGEMENT FACILITY**

Title:  
**TYPICAL CELL LAYOUT**

Scale @ A1: **As Shown**

Prepared by:	Checked:	Date:
M. Nolan	A. Austin	December 2017
Project Director:	D. Grehan	
Drawing Status:	Planning	

**TOBIN**  
Patrick J. Tobin & Co. Ltd.  
TOBIN Consulting Engineers,  
Block 10-4, Blanchardstown Corporate Park,  
Dublin 15, Ireland.  
tel: +353-(0)1-8030406  
fax: +353-(0)1-8030409  
e-mail: dublin@tobin.ie  
www.tobin.ie

TOBIN Consulting Engineers will not be liable for any use of this document for any purpose other than that for which it was originally prepared and provided. Except where specifically and explicitly agreed in writing by TOBIN Consulting Engineers, no copyright holder, the part of this document may be reproduced or transmitted in any form and this document shall not be relied upon by any third party for any purpose.

Drawing No.: **8108-2034**      Revision: **A**



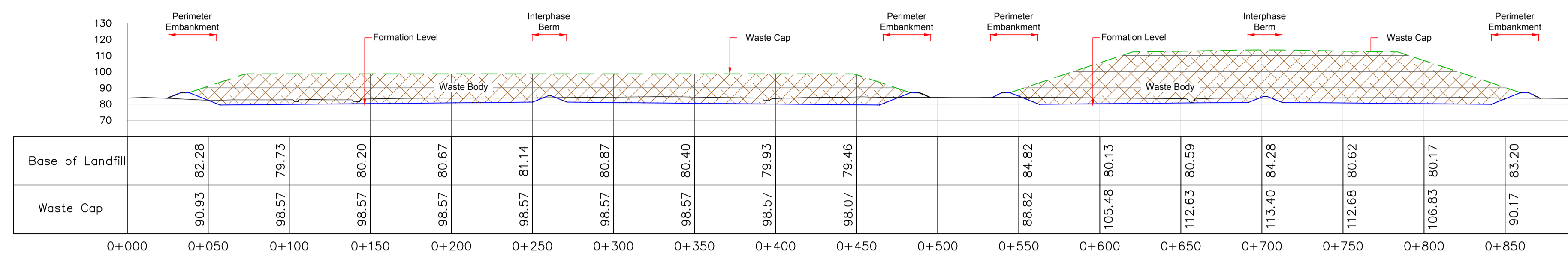

LONGITUDINAL SECTION 1 - 1

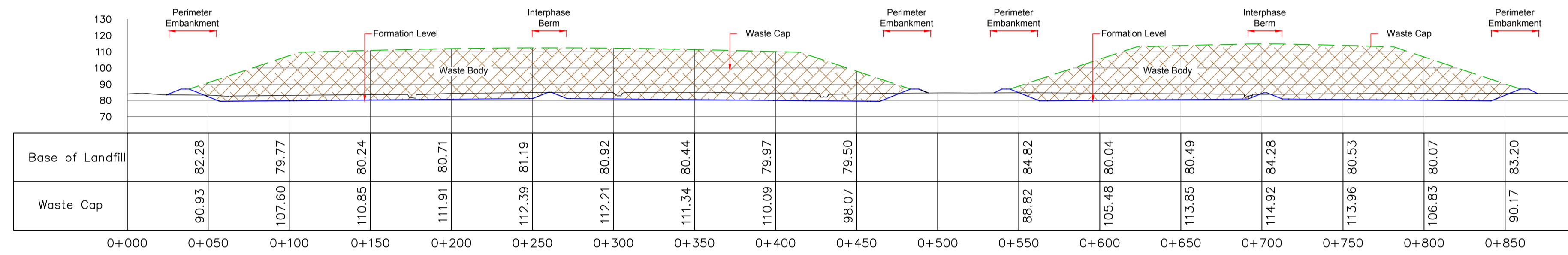

LONGITUDINAL SECTION 2 - 2

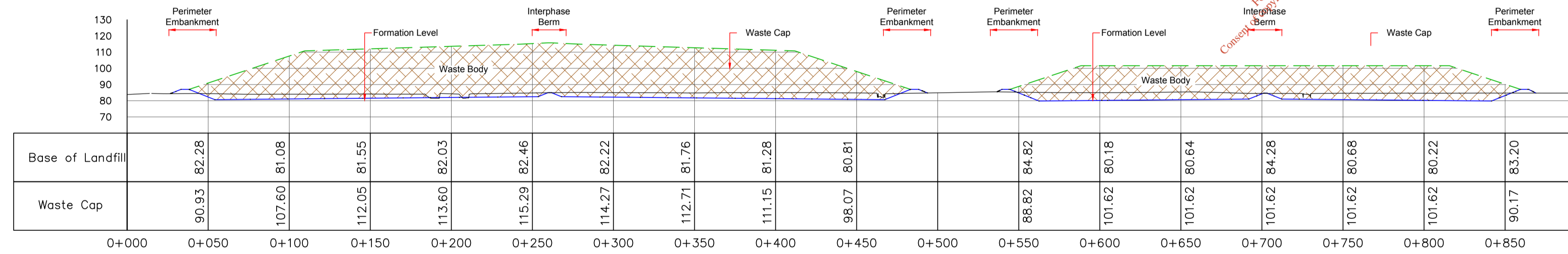

LONGITUDINAL SECTION 3 - 3

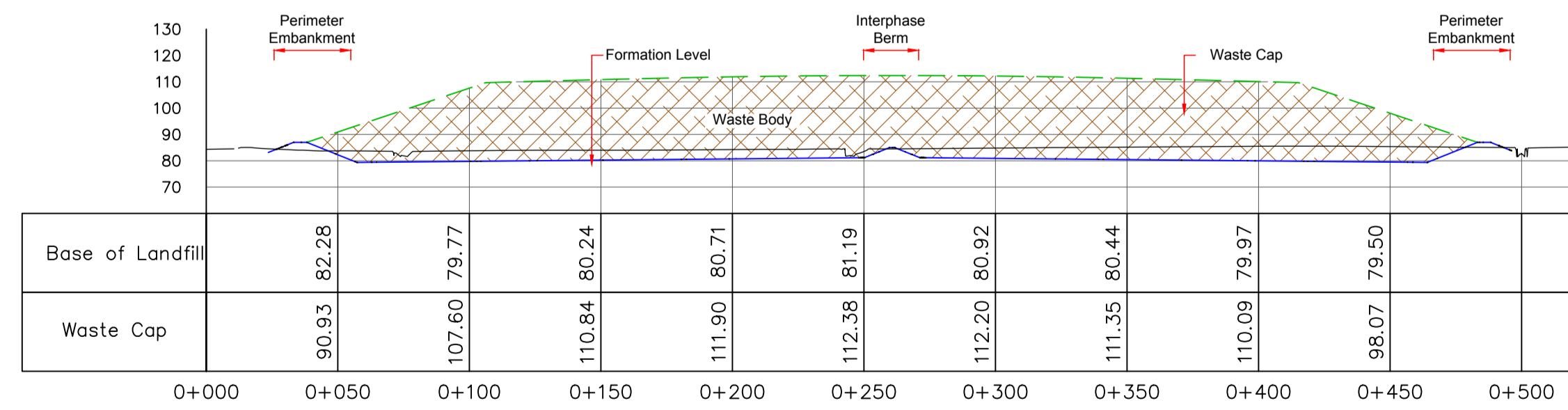

LONGITUDINAL SECTION 4 - 4

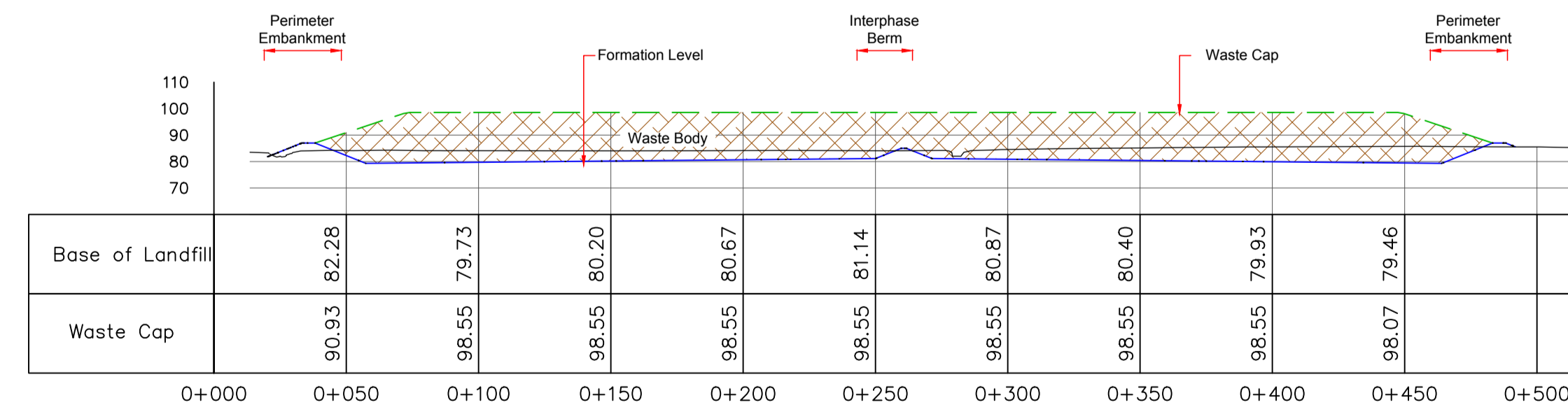

LONGITUDINAL SECTION 5 - 5

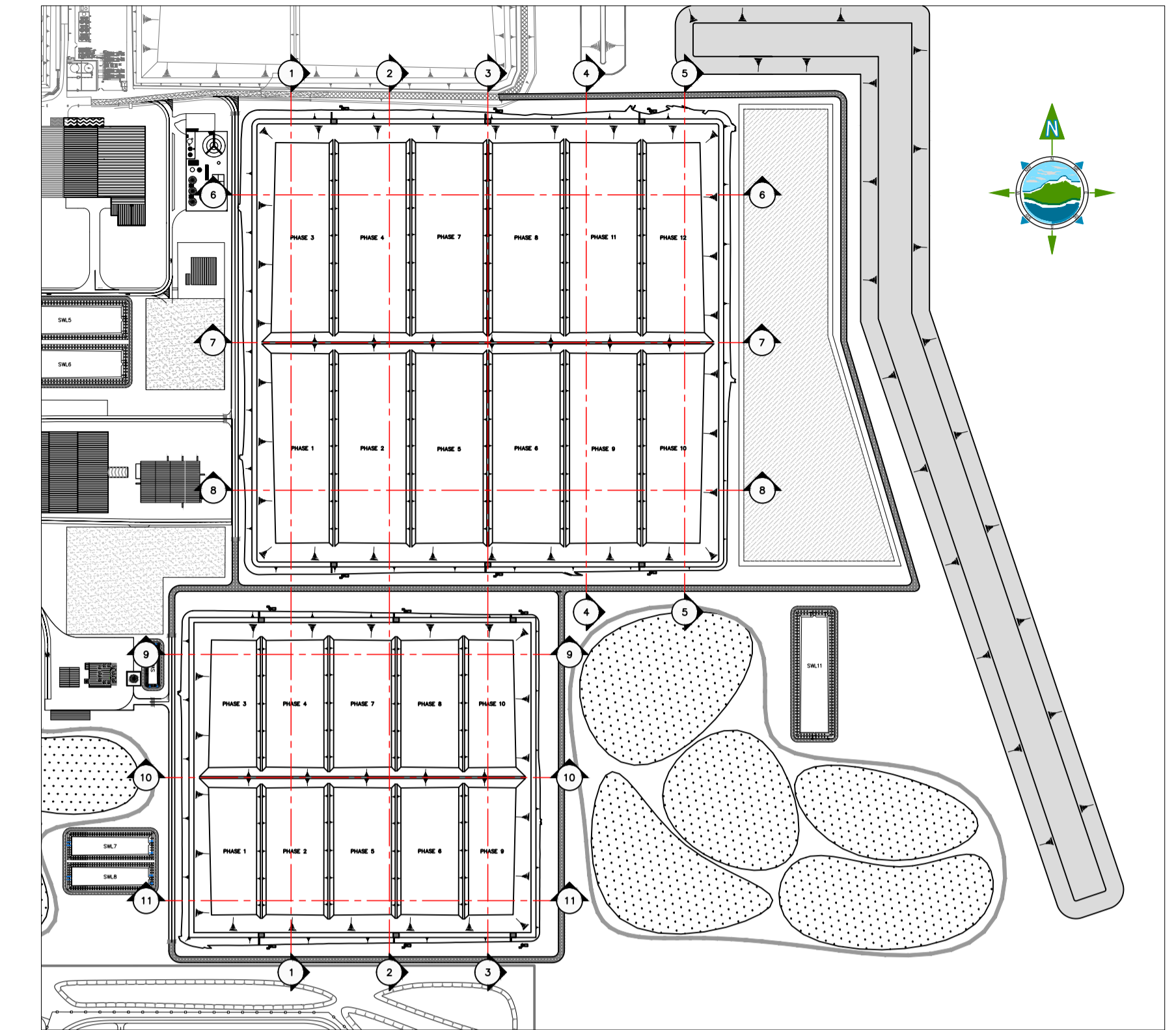

KEY PLAN -1:500



Rev	Date	Description	By	Chkd.
A	Dec. '17	PLANNING ISSUE	MN	DC

Client: **BORD NA MÓNA**  
Naturally Driven

Project: **PROPOSED DEVELOPMENT AT DREHID WASTE MANAGEMENT FACILITY**

Title: **HAZARDOUS & NON HAZARDOUS LANDFILL LONGITUDINAL SECTIONS**

Scale @ A1: **1:2,000**  
Prepared by: M. Nolan, Checked by: A. Austin, Date: December 2017  
Project Director: D. Grehan  
Drawing Status: **Planning**

**TOBIN**  
Patrick J. Tobin & Co. Ltd.  
TOBIN Consulting Engineers,  
Block 10-4, Blanchardstown Corporate Park,  
Dublin 15, Ireland.  
tel: +353-(0)1-8030406  
fax: +353-(0)1-8030409  
e-mail: dublin@tobin.ie  
www.tobin.ie

Drawing No.: **8108-2035** Revision: **A**

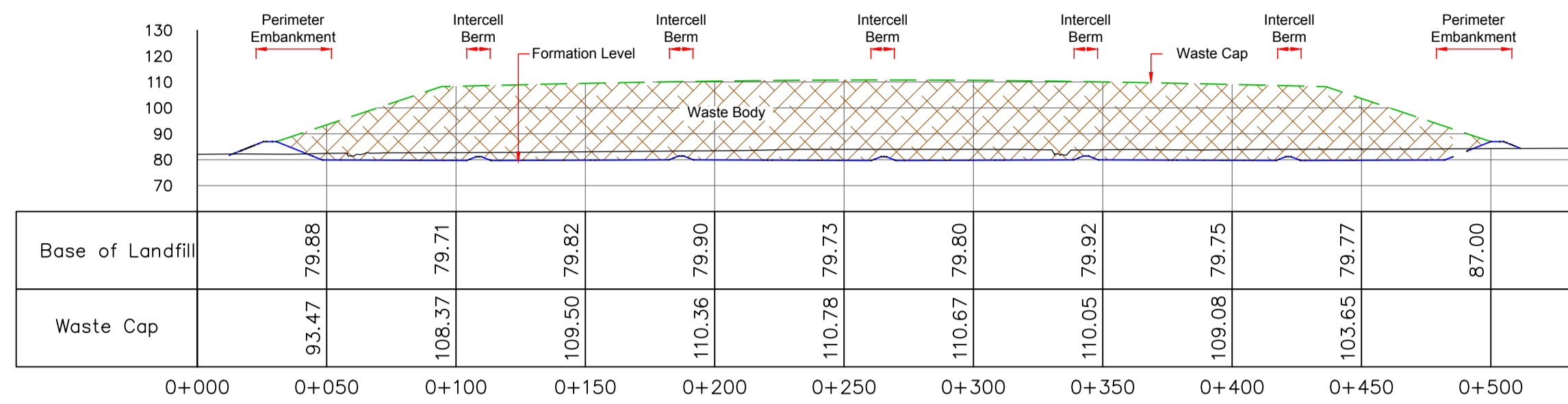

CROSS SECTION 6 - 6

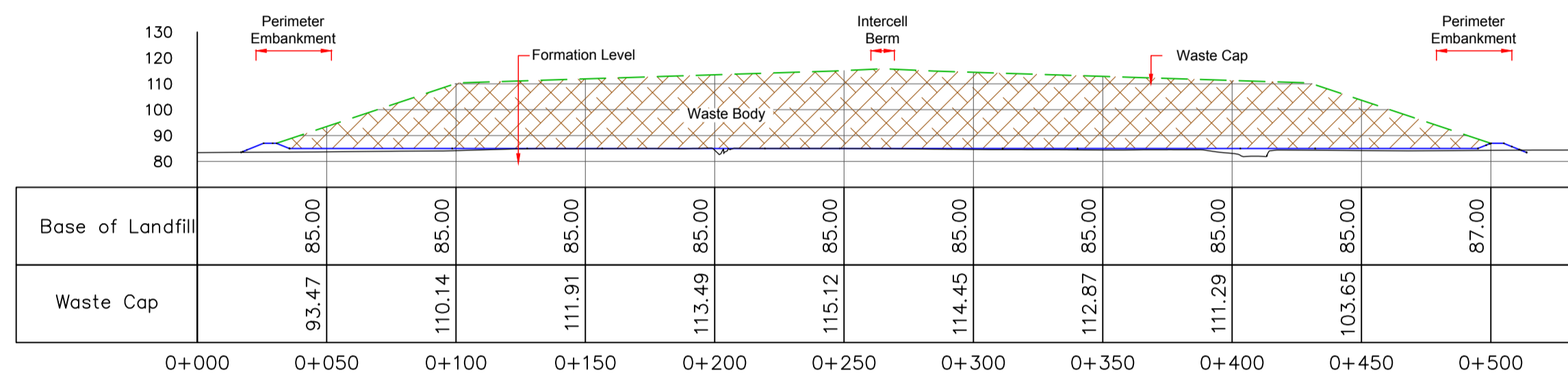

CROSS SECTION 7 - 7

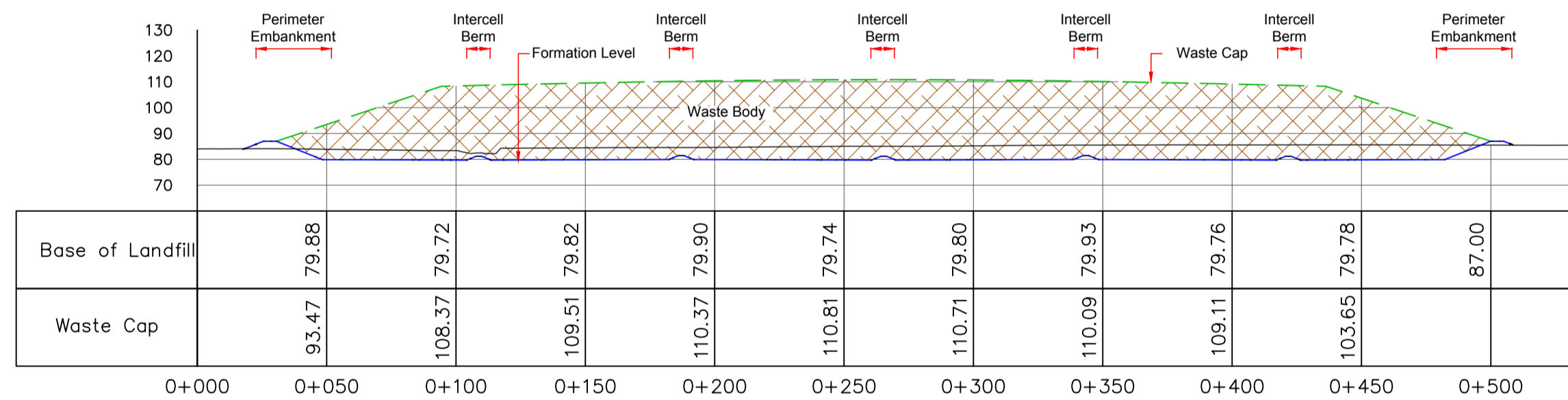

CROSS SECTION 8 - 8

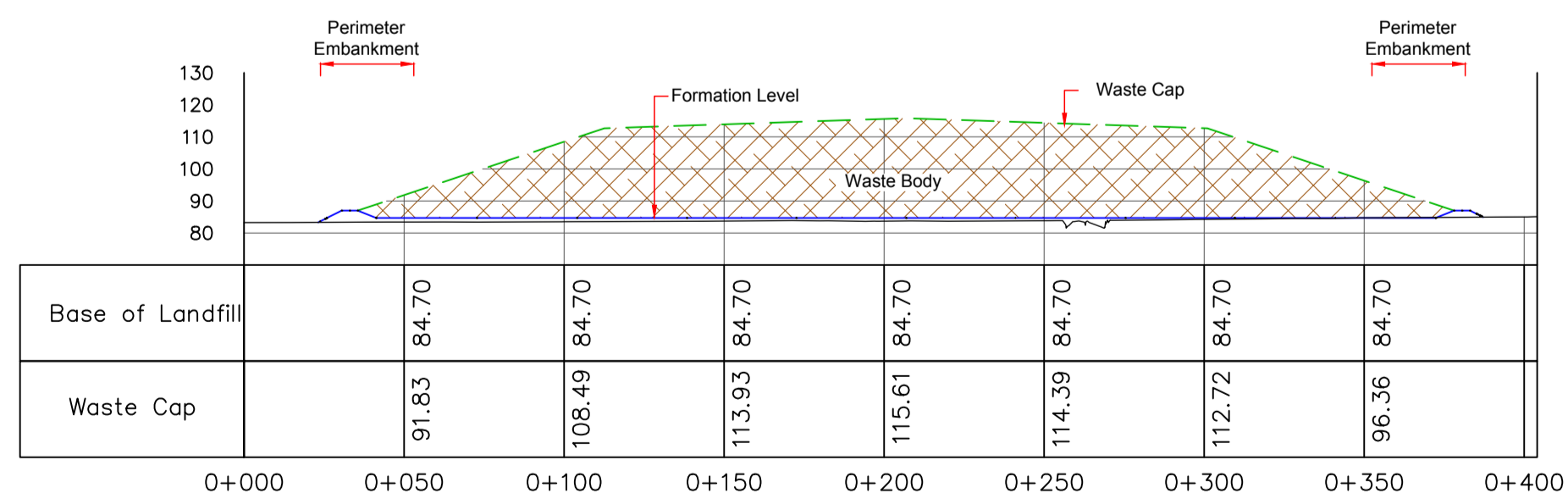

CROSS SECTION 10 - 10

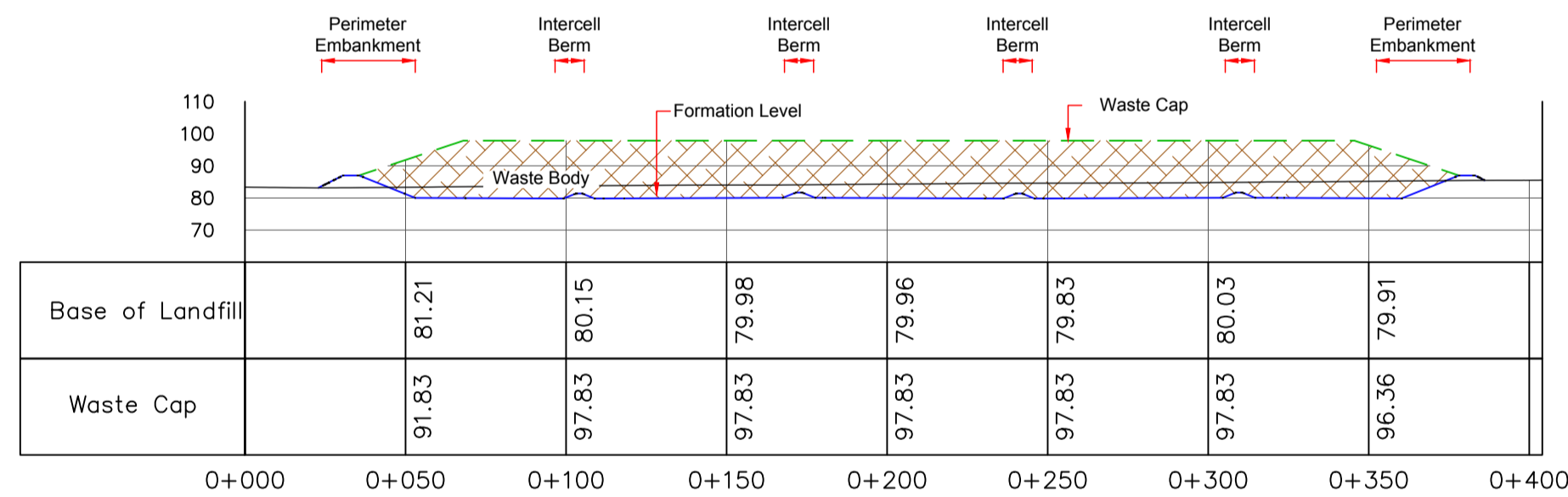

CROSS SECTION 9 - 9

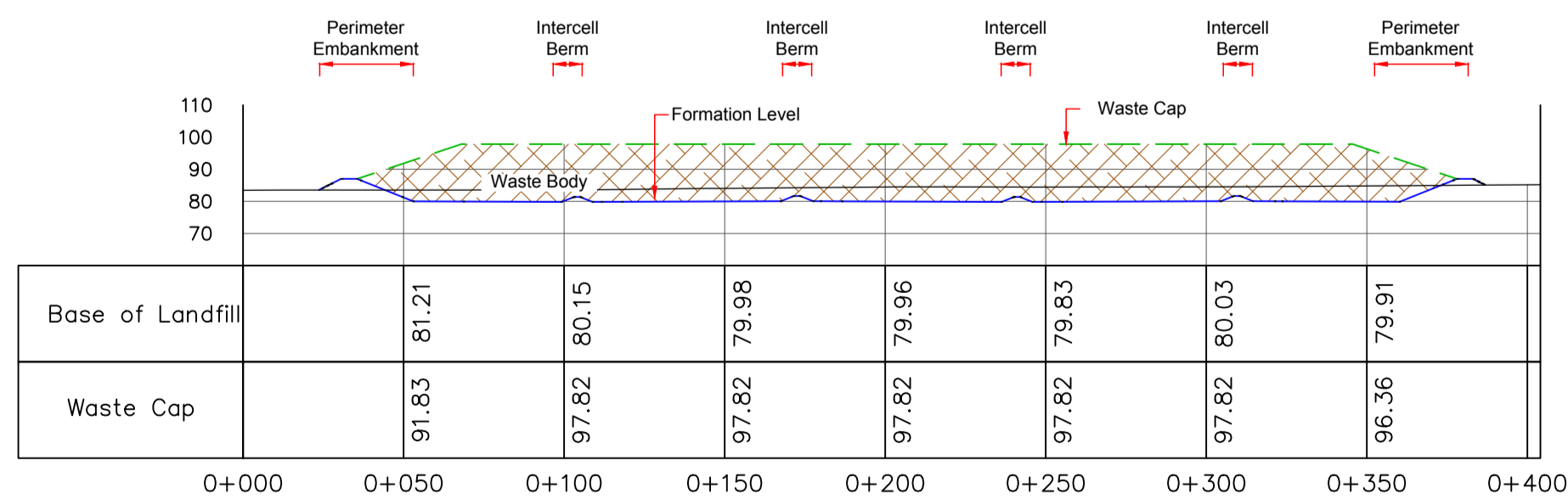

CROSS SECTION 11 - 11

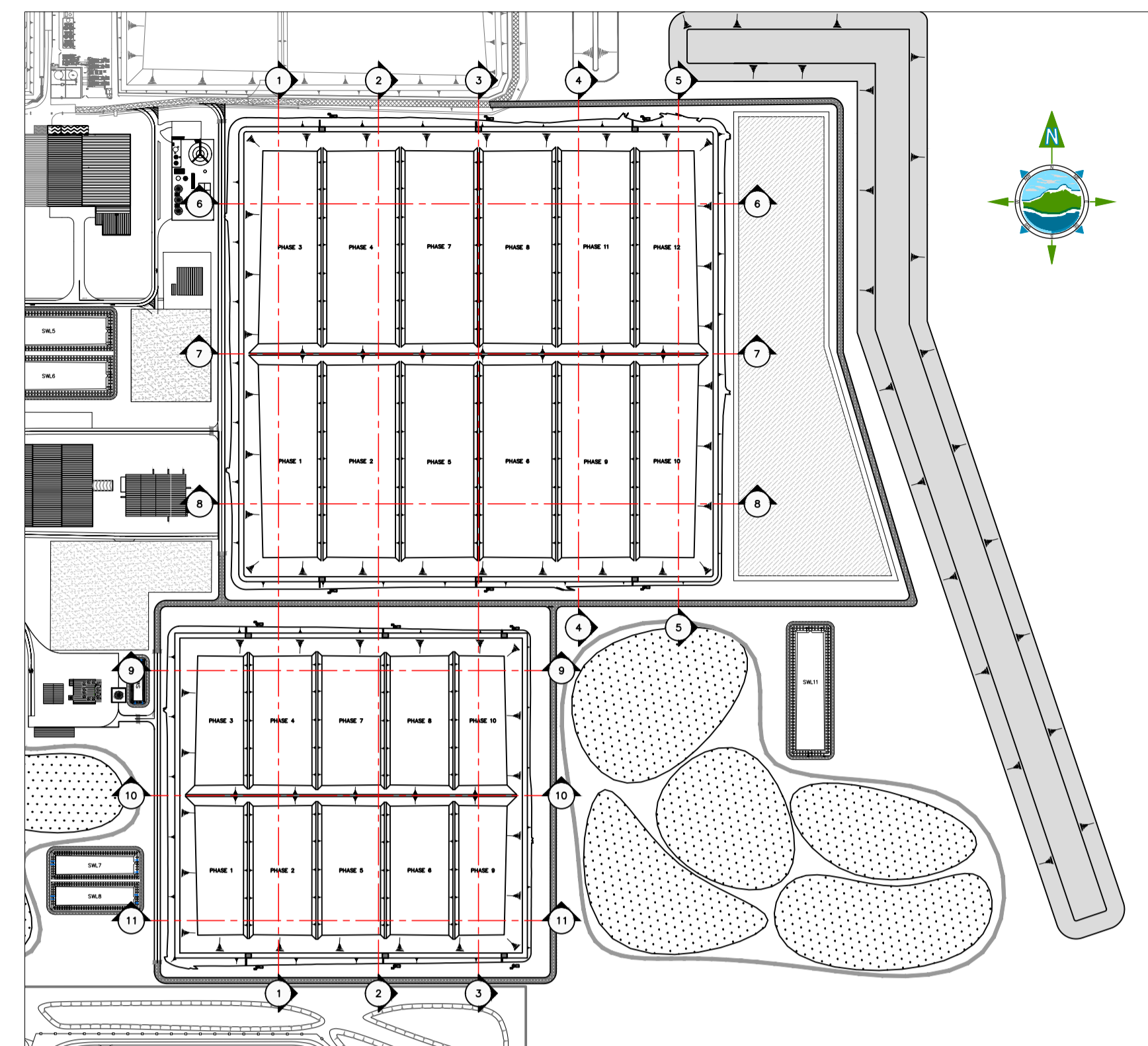

KEY PLAN -1:500

For information purposes only.  
Consent of copyright owner required for any other use.

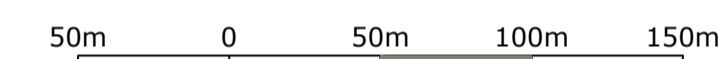

Rev	Date	Description	By	Chkd.
A	Dec. '17	PLANNING ISSUE	MN	DC

Client: **BORD NA MÓNA**  
Naturally Driven

Project: **PROPOSED DEVELOPMENT AT DREHID WASTE MANAGEMENT FACILITY**

Title: **HAZARDOUS & NON HAZARDOUS LANDFILL CROSS SECTIONS**

Scale @ A1: **1:2,000**  
Prepared by: M. Nolan  
Checked: A. Austin  
Date: December 2017  
Project Director: D. Grehan  
Drawing Status: **Planning**

**TOBIN**  
Patrick J. Tobin & Co. Ltd.  
TOBIN Consulting Engineers,  
Block 10-4, Blanchardstown Corporate Park,  
Dublin 15, Ireland.  
tel: +353-(0)1-8030406  
fax: +353-(0)1-8030409  
e-mail: dublin@tobin.ie  
www.tobin.ie

Drawing No.: **8108-2036**  
Revision: **A**