

12.0 ARCHAEOLOGICAL, ARCHITECTURAL AND CULTURAL HERITAGE

12.1 INTRODUCTION

The following chapter assesses the predicted impacts of the proposed development on archaeological, architectural and cultural heritage. The development is located in the townlands of Ballymanaggin, Gallanstown and Yellowmeadows, Dublin 22 (ITM 707785, 732380). The development will involve the construction of a data centre and additional ancillary infrastructure including a gas-powered energy centre.

12.2 METHODOLOGY

The Record of Monuments and Places (RMP), comprising the results of the Archaeological Survey of Ireland, is a statutory list of all recorded archaeological monuments known to the National Monuments Service. The relevant files for these sites contain details of documentary sources and aerial photographs, early maps, OS memoirs, the field notes of the Archaeological Survey of Ireland and other relevant publications. Sites recorded on the Record of Monuments and Places all receive statutory protection under the National Monuments Act 1994. The information contained within the RMP is derived from the earlier non-statutory Sites and Monuments Record (SMR); some entries, however, were not transferred to the statutory record as they refer to features that on inspection by the Archaeological Survey were found not to merit inclusion in that record or could not be located with sufficient accuracy to be included. Such sites however remain part of the SMR. The record is a dynamic one and is updated so as to take account of on-going research. The Record of Monuments and Places was consulted in the Archives of the Department of Culture, Heritage and the Gaeltacht (see Appendix 12.1). There are no recorded archaeological monuments located within the site boundary. There are 16 recorded archaeological monuments within the study area which comprises a distance of c. 1.5km from the proposed development (see Figure 12.1 and Appendix 12.1). The round tower and cross at Clondalkin is a National Monument in State Ownership (National Monument Ref. No. 32'O'), there is no intervisibility between the site and the round tower and cross at ground level due to intervening vegetation and commercial, residential and industrial development.

The National Museum of Ireland's topographical files are a national archive of all known archaeological finds from Ireland. They relate primarily to artefacts but also include references to monuments and contain a unique archive of records of previous excavations. The topographical files were consulted to determine if any archaeological artefacts had been recorded from the area. Other published catalogues of prehistoric material were also studied: Raftery (1983 - Iron Age antiquities), Eogan (1965; 1993; 1994 - bronze swords, Bronze Age hoards and goldwork), Harbison (1968; 1969a; 1969b - bronze axes, halberds and daggers). The townlands within the study area were assessed (See Appendix 12.2).

Cartographic sources were used to identify additional potential archaeological and cultural heritage constraints. Primary cartographic sources consulted consisted of the Down Survey 'Barony Map of Newcastle and Uppercrosse' 1655-6 (see Figure 12.2, Rocque's Map of the County of Dublin, 1760, and the Ordnance Survey 6" and 25" maps, first and subsequent editions (T.C.D. Map Library, www.osi.ie). Modern Ordnance Survey aerial photographic coverage dating from 1999, 2000 and 2005 available on the Ordnance Survey of Ireland (www.osi.ie) were assessed. The Down Survey map indicates a group of structures including a castle in the townland of Gallanstown and a significant settlement on the River Cammock at Clondalkin (see Figure 12.2) The first edition Ordnance Survey map of the site shows it laid out in

small fields. The line of the boundary between the townlands of Ballymanaggin, Gallanstown and Yellowmeadows runs through the western portion of the site. A significant curving section is indicated in the townland boundary and it is possible that the line of the boundary accommodation an archaeological feature such as an enclosure (see Figure 12.3).

The excavation bulletin website (www.excavations.ie) was consulted to identify previous excavations that have been carried out within the study area. This database contains summary accounts of excavations carried out in Ireland from 1970 to 2017. The townlands within the study area were assessed (see Appendix 12.3).

The South Dublin County Council Development Plan 2016-2022 was also consulted. The plan includes policy objectives for the protection of the County’s archaeological, architectural and cultural heritage. The Record of Protected Structures (RPS) contained within the plan includes every structure which is of special architectural, archaeological, artistic, cultural, scientific, social or technical interest within the county boundaries. There are 10 structures included in the RPS within c. 1km of the proposed development (see Table 12.1). The closest of these is a group of structures located c. 350m to the west of the site at the junction of the Grand Canal and Ninth Lock Road. None of the structures will be directly impacted by the proposed development and none are visible from the site due to intervening vegetation and commercial, residential and industrial development.

The National Inventory of Architectural Heritage (NIAH) is a systematic programme of identification, classification and evaluation of the architectural heritage of the State. The Minister for Arts, Heritage and the Gaeltacht is currently using the Inventory as the basis for making recommendations for the NIAH. There are 19 structures included in the NIAH within c. 1km of the proposed development (see Table 12.1). The closest of these is a group of structures located c. 350m to the west of the site at the junction of the Grand Canal and Ninth Lock Road. None of the structures will be directly impacted by the proposed development and none are visible from the site due to intervening vegetation and commercial, residential and industrial development.

NIAH Reg. No	RPS Reg. No.	Name	Townland
11205014	129	9th Lock, Grand Canal	Ballymanaggin, Clonburris Great
11205015	130	Lock keeper's house, 9th Lock	Clonburris Great
11205016	124	1, 9th Lock Road	Ballymannaggin
11205017	124	2, 9th Lock Road	Ballymannaggin
11205018	126	3, Ballymanaggin Lane	Ballymannaggin
11205019	126	4, Ballymanaggin Lane	Ballymannaggin
11205020	117	5, Ballymanaggin Lane	Ballymannaggin
11205021	117	6, Ballymanaggin Lane	Ballymannaggin
11205022	121	7, Ballymanaggin Lane	Ballymannaggin
11205023	121	Anne's Brook Cottage, 8 Ballymanaggin Lane	Ballymannaggin
11205024	N/A	6, Station Road	Ballymannaggin
11205025	N/A	5, Station Road	Ballymannaggin
11205026	N/A	4, Station Road	Ballymannaggin
11205027	N/A	3, Station Road	Ballymannaggin
11205028	N/A	House, 9th Lock Road	Ballymannaggin

NIAH Reg. No	RPS Reg. No.	Name	Townland
11205037	N/A	Station building, Cloverhill Road	Raheen (NE. BY.)
11205038	N/A	Railway bridge, Cloverhill Road	Ballymanaggin, Raheen (NE. BY.)
11205039	N/A	House, Cloverhill Road	Raheen (NE. BY.)
50080429	N/A	8th Lock, Grand Canal	Gallanstown

Table 12.1 Features of architectural heritage interest

The baseline historical research utilised sources including Lewis' Topographical Dictionary of Ireland (Lewis 1837), the Urban Archaeological Survey Part VIII: County Dublin (Bradley and King, unpublished), the Proceedings of the Royal Irish Academy and the Journal of the Royal Society of Antiquaries. See Bibliography for full list of references used.

12.3 RECEIVING ENVIRONMENT

12.3.1 Archaeological, Architectural and Cultural Background

There are no upstanding prehistoric monuments within the study area, however placename evidence and the recovery of stray archaeological finds indicate that prehistoric people may have occupied or moved through the landscape during this period. The site of the proposed development is located within the townland of Gallanstown. The placename element 'gallán' often signifies the location of a standing stone though topographical records indicate it may refer in this case to a family name 'Gallen' or 'Gallan' (<https://www.logainm.ie/ga/17245>). Standing stones were erected in groups or singly in the Bronze and Iron ages to mark significant locations in the local landscape. Stray archaeological finds including a two flanged bronze axeheads (NMI 1911:242 and NMI 1963:65) dating to the Middle Bronze Age have also been recorded from the townland of Clondalkin to the south-west of the proposed development.

The proposed development is located c. 1.2km to the northeast of the historic town of Clondalkin (DU017-041----). The monastic site of Cluain Dolcáin, which translates as 'Dolcáin Meadow', was founded in the 7th century by St. Mochua. The monastic site served as the focus of a significant urban centre with market, education and religious functions and contains the wall fragments of a medieval parish church (DU017-041002-), parts of two granite crosses (DU017-041003- and DU017-041004-), a dressed granite font (DU017-041007-) and round tower (DU017-041006-). The settlement would have been enclosed within an earthen or stone-built enclosure (DU017-041001-) measuring over 300m in diameter, elements of which are maintained in the layout of the street pattern to the current day.

The Vikings attacked the settlement in the early 9th century and had established a settlement near Clondalkin by 867. In this year records indicated that the Viking settlement was attacked and burned by two Leinster chieftains. The round tower is located on the main road through the town opposite the Church of Ireland church. It is constructed of calp limestone and measures 26m from the base of the tower to the apex of the cap. The tower dates to the 10th or 11th century (Barrow 1979, 80).

The site of a second church (DU017-042----) was discovered to the north-east of the village during excavations in the 1960s. The site was located outside the main monastic enclosure and may have been an independent parish church. The church had a nave and chancel and was constructed of unmortared stones. It was found to overlie human burials that may point to the presence of an earlier timber church on

the site. Other finds included a bronze ring pin (NMI 1964:21) that can be dated to the 10th century AD. The field in which the church was located is marked as Chapel Field on various 18th century maps (Rynne 1967, 28).

A burial mound covering human burials (DU017-083----) was uncovered during pre-development testing in the townland of Gallanstown to the east of the proposed development (See Excavation no. 1999:246 and 2000:0229). The remains of a number of skeletons were uncovered oriented east-west indicating a likely early medieval date for the cemetery. The remains of a backfilled ditch measure 2.5m wide and 0.6m deep was also uncovered, pre-dating the burials. Subsequent archaeological excavation at the site revealed the remains of a stone-lined well and further human remains.

Secular settlement in the study area is represented by the remains of an enclosure (DU017-043----), likely a levelled ringfort. The enclosure is located in the townland of Knockmitten c. 700m to the south of the proposed site. The area has been subjected to intensive agricultural development and the site was located as a cropmark during an aerial photographic survey (Fairey Survey of Ireland 227/8). The enclosure was sub-circular in shape and measured c. 38m in diameter. The site, which functioned as an enclosed farmstead, took advantage of fertile land near the bank of the Cammock River. The site has since been covered by a modern housing development.

After the Anglo-Norman invasion, the monastic estate at Clondalkin passed into the possession of the Archbishop of Dublin and the town became the centre of a large Episcopal manor. Evidence for the granting of a borough charter to Clondalkin appears in an extent of the manor in 1326, though it may have already been established in the 13th century. The extent mentions that the burgesses of Clondalkin held thirty-two and two-thirds burgages (McNeill 1950, 187). The extent also mentions that there were cottagers at Clondalkin some of whose cottages were then vacant and ruined (MacNeill 1950, 186). The borough was ruled by a corporation and bailiff and by the close of the 14th century there were at least five streets in the borough, known as Mill Street, Steeple Street, Pope Lane, New Street, and Mahow Street. A water-mill (DU017-041009-) was associated with the manor of Clondalkin from at least the 13th century and it was valued at 38s. 10d. in 1326 (MacNeill 1950, 187). The site of the mill is now occupied by the Mill Street Shopping Centre, and it is presumably the castellated mill which was visited by the antiquarian Austin Cooper in the late eighteenth century (Bradley 1998, 131).

In the Description of Ireland in 1598, Clondalkin is classed as a substantial village. No mention is made of its borough status at this time and it is unclear when exactly the borough ceased to function. In 1642, during the Confederate Wars, the village was burned by a troop of horse sent from Dublin (Ball 1902-20, iv, 117). According to the Down Survey of 1657 there stood 'at Clondalkin a stump of a castle, some thatched houses with a high watchtower' (possibly the round tower); at Neillstown there was 'the ruins of an old castle and 3 or 4 cabins' and at Gallanstown there was 'a castle like house, habitable and the ruins of a gate house' (Simington 1945, 292'; see Figure 12.2).

In the mid-eighteenth century a group of noblemen and merchants decided to form a company to undertake the construction of a canal aimed initially at providing fresh water for Dublin City and a water-borne transport system to the countryside west of Dublin. Construction of the eastern portion of the canal was completed in 1779, and the Shannon had been reached by 1803. The Grand Canal forms the southern

boundary of the site which is located between the 8th Lock at Park West Avenue and the 9th Locks to the north of Clondalkin village.

12.4 CHARACTERISTICS OF THE PROPOSED DEVELOPMENT

CRAG Digital Ltd. intends to develop two-storey Data Centre, in two phases, to provide data storage solutions for its customers. The facility will facilitate the secure storage, and distribution of information to individuals, businesses and organisations. The data centre will include 4 data halls, associated generator and battery plant rooms, and an administration building.

The development incorporates an 84MW natural gas-powered Energy Centre so that the Data Centre is fully self-sufficient in terms of its power and cooling requirements. The Energy Centre is to be connected to the national gas network via an AGI installation in the south-eastern corner of the site.

Ancillary infrastructure will include the construction of a security hut and substation, the provision of gas supply and underground electricity lines to the site, internal road network and parking, drainage infrastructure including a retention pond, and bunded fuel storage tanks (for further details refer to Chapter 2 of this Environmental Impact Assessment Report).

12.5 POTENTIAL IMPACTS OF THE PROPOSED DEVELOPMENT

12.5.1 Construction Phase

Potential impacts on archaeological, architectural and cultural heritage associated with the proposed development includes ground disturbance associated with the construction of the proposed data halls, energy centre, security hut and electricity substation and ground disturbance associated within the provision of ancillary infrastructure including gas and electrical connections, the internal road network, retention pond, fuel storage and landscaping.

The construction phase of the proposed development will not impact directly on any sites included in the Record of Monuments and Places. However, an area of archaeological potential comprising a curving townland boundary was noted in the north-western portion of the site. It is possible that the boundary curved to accommodate an archaeological feature and that ground disturbance may impact on sub-surface archaeological features within the site.

12.5.2 Operational Phase

No impacts on archaeological, architectural and cultural heritage are expected as a result of the operational phase of the proposed development.

12.6 DO NOTHING SCENARIO

The Do-Nothing scenario includes either 1) No development occurs and the site remains unused with existing unused buildings and infrastructure remaining in place, or 2) development of the site in accordance with the previously approved data centre and associated energy centre.

In the first scenario, any unrecorded sub-surface archaeological features within the site will remain in-situ. Without ground disturbance there will be no impact on any existing, un-identified archaeological remains; although archaeological remains (if

present) may further deteriorate over time. If the site is developed as per the approved application, the impacts on archaeological and cultural heritage will be as described in the Environmental Impact Statement for that development.

12.7 REMEDIAL AND MITIGATION MEASURES

12.7.1 Construction Phase

While the site has been subject to impacts associated with the construction of the M50 motorway and a light industrial unit there is still the possibility of sub-surface archaeological features surviving within the site boundary.

Limited pre-development archaeological testing is recommended for the site. This should be undertaken at the curve in the boundary between the townlands of Gallanstown, Ballymanaggin and Yellowmeadows and at the site of the proposed data centre and energy centre.

Should archaeological features or material be uncovered during archaeological testing or any phase of construction, ground works should cease immediately and the National Monuments Service of the Department of Culture, Heritage and the Gaeltacht should be informed. Time must be allowed for a suitably qualified archaeologist to inspect and assess any material. If it is established that archaeologically significant material is present, the National Monuments Service may require that further archaeological mitigation be undertaken.

Please note that the recommendations given here are subject to the approval of the National Monuments Service, Department of the Culture, Heritage and the Gaeltacht.

12.7.2 Operational Phase

No mitigation measures are required for archaeological, architectural and cultural heritage during the operational phase of the proposed development.

12.8 PREDICTED IMPACT OF THE DEVELOPMENT

12.8.1 Construction Phase

Supposing the mitigation measures outlined above are conducted as recommended, the construction phase of the proposed development is not predicted to have any impact on archaeological and cultural heritage.

12.8.2 Operational Phase

The operational phase of the proposed development is not predicted to have any impact on archaeological and cultural heritage.

12.8.3 Cumulative Impact

No cumulative impacts on archaeological heritage will result from the proposed development.

12.9 RESIDUAL IMPACTS

Subject to the implementation of appropriate archaeological mitigation measures, no residual impacts on archaeological, architectural and cultural heritage are predicted.

12.10 REFERENCES

- Ball, F. E., 1902-1920. A history of the County Dublin, Part IV, HSP Library.
- Bence-Jones, M 1978. Burke's Guide to Country Houses, Vol. 1: Ireland. London: Burke's Peerage Ltd.
- Bradley J. 1998. The Medieval Boroughs of County Dublin. Dublin and beyond the Pale: studies in honour of Patrick Healy. Bray.
- Bradley, J. and King, H. Unpublished. Urban Archaeological Survey, Part VIII (IV) County Dublin.
- Cooney, G. and Grogan, E. 1994. Irish Prehistory – A Social Perspective. Dublin: Wordwell.
- Eogan, G. 1965. A catalogue of Irish Bronze swords. Dublin: Stationery Office.
- Eogan, G. 1983. Hoards of the Irish Later Bronze Age. Dublin: University College Dublin.
- Eogan, G. 1994. The Accomplished Art, Gold and Gold working in Britain and Ireland during the Bronze Age. Oxford: Oxbrow Books.
- Gwynn, A. & Hadcock, R.N. 1970. Medieval religious houses: Ireland. London: Longmans.
- Harbison, P. 1968. Catalogue of Irish Early Bronze Age associated finds containing copper or bronze. Proceedings of the Royal Irish Academy 67C, 35-91.
- Harbison, P. 1969a. The daggers and the halberds of the Early Bronze Age in Ireland. Prähistorische Bronzefunde, Abteilung VI, Band 1. C.H. Muich: Beck.
- Harbison, P. 1969b. The axes of the Early Bronze Age in Ireland. Prähistorische Bronzefunde, Abteilung IX, Band 1. Munich.
- Lewis, S. 1837. Topographical Dictionary of Ireland, 2 vols. London: S. Lewis & Co.
- McNeill, C. 1950. Calendar of Archbishop Aen's Register c 1172-1534. Dublin
- O'Keefe, T. 2000. Medieval Ireland: An Archaeology.
- Otway-Ruthven, A. J., 1961. The medieval church land of County Dublin in J.A Watt, Morall, J.B. & Martin, F.X. (eds.) Medieval Studied present to Aubrey Gwynn, 54-73. Dublin
- Pender, S. (ed) 1939. A census of Ireland, circa 1659: with supplementary material from the poll money ordinances (1660-1661). Dublin: Stationery Office.
- Rafferty, B., 1983. A catalogue of Irish iron age antiquities. Marburg.
- Roque, J., 1760. An Actual Survey of the county of Dublin. Dublin
- Simmington, Robert, 1945. The Civil Survey, 1654-1656, Volume VII County Of Dublin.
- Stout, G. & Stout M., 1992. Patterns in the past: county Dublin 5000BC – 1000AD in Aalen F.H.A. & K. Whelan (eds) Dublin City and County: From Prehistory to Present. Dublin
- Stout, M. 1997. The Irish Ringfort. Dublin: Four Courts Press.
- Taylor, J. 1816. Map of the Environs of Dublin.
- Ua Broin, Liam, 1944. Clondalkin, Co. Dublin and its neighbourhood, JRSAI Vol. LXXIV.

APPENDIX 12.1 RECORDED ARCHAEOLOGICAL MONUMENTS

Recorded Archaeological Monuments located within c. 1.5km of the proposed development are listed below (source Record of Monuments and Places for Co. Dublin, www.archaeology.ie).

RMP No.	DU017-032001-
Site Type	Castle - unclassified
Townland	NEILLSTOWN
ITM	706498, 732931
Description	The castle was marked on the Down Survey (1655-6) map, approximately on the site of Neillstown House which was formerly located N of the present 9th lock on the Grand Canal. Described in the Civil survey (1654-6) as 'the ruins of an old castle', (Simington 1945, 292). The site has been built on. Not visible at ground level. Healy, P. 1974, Report on Monuments and Sites of Archaeological Interest in Co. Dublin, p.22. Neillstown House, a house on the site of a castle. Ball, E. F. 1906, Parish of Clondalkin in Vol. 4, p. 118.

RMP No.	DU017-032002-
Site Type	House - 16th/17th century
Townland	NEILLSTOWN
ITM	706498, 732931
Description	Ball (1906,118) mentions three or four cottages associated with the castle (DU017-032001-). These may be the 'three or four cabins' which are mentioned in the Civil Survey (1654-6). The area has been built on. Not visible at ground level. Healy, P. 1974, Report on Monuments and Sites of Archaeological Interest in Co. Dublin, p.22. Neillstown House, a house on the site of a castle. Ball, E. F. 1906, Parish of Clondalkin in Vol. 4, p. 118.

RMP No.	DU017-041----
Site Type	Historic town
Townland	CLONDALKIN
ITM	706944, 731398
Description	In the 13th century the archbishop of Dublin established a borough on the site of an Early medieval monastery associated with St Mochua (Gwynn & Hadcock 1970, 31). An extent of 1326 mentions that the burgesses of Clondalkin held thirty-two and two-thirds burgages (Mc Neill 1950, 187). The borough was ruled by a corporation and bailiff, an office held in 1276 by one Robert Beg (Ball 1902-20, IV, 108). By the close of the 14th century there were at least five streets in the borough, known as Mill Street, Steeple Street, Pope Lane, New Street and Mahow Street. This appears from an inquisition about property assigned in 1393 to the church of Clondalkin by one John Shillingford (Ball 1902-20, IV, 111). The identification of the five streets documented in the 14th century sources with the streets of today is difficult. Mill Street may be identified with the street leading to the mills, now the eastern part of the Newcastle Road. Steeple Street is presumably Tower Road, and New Street may be new Road, but the identification of Pope lane and Mayhow Street is unclear.

	<p>Harbison, P. 1970. Guide to the National Monuments of Ireland, p. 71.</p> <p>Sherlock, C. 1906. Clondalkin. Journal of the Archaeological Society of the County of Kildare and Surrounding Districts, Vol. 5, p.1-11</p> <p>Leask, H. G. 1914. Clondalkin. Proceedings of the Royal Society of Antiquaries in Ireland, Vol. 44, p. 272-273</p> <p>Cooper, A. 1780. Austin Coopers Notes, 54-6</p> <p>Martin, G. 1981 Plantation Boroughs in Medieval Ireland with a handlist of Boroughs c. 1500 in The town in Ireland, Harkness and O'Dowd, p. 38.</p> <p>Ua Broin, L. 1944. Clondalkin, Co. Dublin, and its neighbourhood JRSAL, Vo. 74, 1944, 212</p> <p>Ball, F. E. 1899 Descriptive sketch of Clondalkin, Tallaght and other places in west county Dublin, JRSAL, Vol. 29, 1899, p. 121-4.</p> <p>Bradley, J. and King, H. Urban Archaeological Survey Part VIII (iv) County Dublin, p. 215-28.</p>
--	--

RMP No.	DU017-041001-
Site Type	Ecclesiastical enclosure
Townland	CLONDALKIN
ITM	707040, 731471
Description	<p>There was a pre-Norman monastic foundation here associated with St. Mochua (Gwynn & Hadcock 1970, 31). A number of early features are contained within the curving boundary of the former monastic enclosure, which is preserved in Orchard Lane and its continuation S and in Main Street to the junction of Boot Road (diameter c. 310m).</p> <p>Sherlock, C. 1906. Clondalkin. Journal of the Archaeological Society of the County of Kildare and Surrounding Districts, Vol. 5, p.1-11</p> <p>Leask, H. G. 1914. Clondalkin. Proceedings of the Royal Society of Antiquaries in Ireland, Vol. 44, p. 272-273</p>

RMP No.	DU017-041002-
Site Type	Church
Townland	CLONDALKIN
ITM	706941, 731410
Description	<p>Southeast of St. John's church of Ireland (1840) is a wall fragment of the medieval parish church. This is orientated north-south, (dimensions - length 2.80m, width 0.90m). Eighteenth-century drawings of the church show a graded triple lancet in east wall, an aisled chancel and a two-light belfry (Ball 1906, 109).</p> <p>Ball, F. E. 1899 Descriptive sketch of Clondalkin, Tallaght and other places in west county Dublin, JRSAL, Vol. 29, 1899, p. 121-4.</p> <p>Sherlock, C. 1906. Clondalkin. Journal of the Archaeological Society of the County of Kildare and Surrounding Districts, Vol. 5, p.1-11</p> <p>Bradley. 215-228.</p> <p>Cooper, A. 1780. Austin Coopers Notes, 54-6</p> <p>Harbison, P. 1970. Guide to the National Monuments of Ireland, p. 71.</p> <p>Ua Broin, L. 1944. Clondalkin, Co. Dublin, and its neighbourhood JRSAL, Vo. 74, 1944, 212</p>

RMP No.	DU017-041003-
Site Type	Cross
Townland	CLONDALKIN
ITM	706962, 731404
Description	North of the medieval church fragment (DU017-041002-) stands a low

	<p>granite cross with damaged head (Ball 1899, 97, Healy 1974, 22). It has a raised ringed cross on the W face, the S face has a raised Latin cross (dimensions H 0.78m, maximum width 0.57m, thickness 0.18-25).</p> <p>Harbison, P. 1970. Guide to the National Monuments of Ireland, p. 71.</p> <p>Cooper, A. 1780. Austin Coopers Notes, 54-6</p> <p>Bradley, J. 215-28.</p> <p>Ua Broin, L. 1944. Clondalkin, Co. Dublin, and its neighbourhood JRSAI, Vo. 74, 1944, 212-3.</p> <p>Ball, F. E. 1899 Descriptive sketch of Clondalkin, Tallaght and other places in west county Dublin, JRSAI, Vol. 29, 1899, p. 121-4.</p>
--	---

RMP No.	DU017-041004-
Site Type	Cross
Townland	CLONDALKIN
ITM	706963, 731419
Description	<p>Northeast of the medieval church fragment is a tall plain granite cross. The arms are asymmetrical (Height 1.75m, width 0.80m, thickness 0.30m; see</p> <p>Harbison, P. 1970. Guide to the National Monuments of Ireland, p. 71.</p> <p>Sherlock, C. 1906. Clondalkin. Journal of the Archaeological Society of the County of Kildare and Surrounding Districts, Vol. 5, p.1-11</p> <p>Cooper, A. 1780. Austin Coopers Notes, 54-6</p> <p>Ball, F. E. 1899 Descriptive sketch of Clondalkin, Tallaght and other places in west county Dublin, JRSAI, Vol. 29, 1899, p.97.</p> <p>Bradley, J. and King, H. Urban Archaeological Survey Part VIII (iv) County Dublin, p. 215-28.</p>

RMP No.	DU017-041005-
Site Type	Castle - hall-house
Townland	CLONDALKIN
ITM	707263, 731270
Description	<p>Located on the S side of Monastery Road where the land falls away to the west and northwest. The remains comprise a well preserved, square tower which is offset off the corner of a hall house. This service tower rises to three storeys with crenellations and is attached to the northeast corner of the two-storey dwelling. At the parapet level of the tower there are stepped crenellations with a drip-stone ledge and gutter. Its interior is not accessible, the south face has been rebuilt to secure the building. It is built of coursed stonework with hammer dressing on the quoins (ext. dimensions 3.3m northwest-southeast; 3.45m southwest-northeast). Lit by plain rectangular opes, some with dressed jambs all on the roadside frontage. On the upper storey is a projecting boulder which is probably the 'carved head' identified by Ball (1899, 97). Access to the tower was originally from the S side. There are two large rectangular openings on this side, the upper is a doorway. A gable scar on the S side indicates the presence of a later building up against this side. Attached to W wall is a dwelling with remains of a stairwell in the northwest corner. Possible gun loops are present on the ground floor and a chimney breast with a flue on the first-floor level (Ua Broin 1944, 212; MC Dix 1898, XXXX, 57).</p> <p>Tully's Castle</p> <p>Harbison, P. 1970. Guide to the National Monuments of Ireland, p. 71.</p> <p>Cooper, A. 1780. Austin Coopers Notes, 54-6</p>

	<p>Ua Broin, L. 1944. Clondalkin, Co. Dublin, and its neighbourhood JRSAI, Vo. 74, 1944, 211-2</p> <p>Ball, F. E. 1899 Descriptive sketch of Clondalkin, Tallaght and other places in west county Dublin, JRSAI, Vol. 29, 1899, p. 96-7.</p> <p>Bradley, J. and King, H. Urban Archaeological Survey Part VIII (iv) County Dublin, p. 215-28.</p>
--	---

RMP No.	DU017-041006-
Site Type	Round tower
Townland	CLONDALKIN
ITM	706903, 731400
Description	<p>On the west side of Tower Road opposite St. John's Church is a round tower. Originally it stood five storeys high with a conical cap (dimensions H 26m, int. diameter 2.20m, wall width 0.86m). Built of coursed calp limestone with a granite finish on the door and window jambs. The base of tower was cased in the 18th-century (Sherlock 1906, 10; Barrow 1975, 61-64). Access to first floor is from external steps through a lintelled doorway in the E face. Floors are lit by small square-headed opes and four larger rectangular windows facing the cardinal points on the top floor. Pre-development testing near the round tower in 2003 produced one sherd of medieval cooking ware in a disturbed context (Opie, H 2006, 113).</p> <p>Harbison, P. 1970. Guide to the National Monuments of Ireland, p. 71.</p> <p>Cooper, A. 1780. Austin Coopers Notes, 54-6</p> <p>Ball, F. E. 1899 Descriptive sketch of Clondalkin, Tallaght and other places in west county Dublin, JRSAI, Vol. 29, 1899, p. 96-7.</p> <p>Bradley, J. and King, H. Urban Archaeological Survey Part VIII (iv) County Dublin, p. 215-28.</p> <p>Sherlock, C. 1906. Clondalkin. Journal of the Archaeological Society of the County of Kildare and Surrounding Districts, Vol. 5, p.1-11</p> <p>Barrow, G. L. 1975 Round towers of Dublin in DHR, Vol. 28, No. 2, p. 61-3, 66-7.</p>

RMP No.	DU017-041007-
Site Type	Font
Townland	CLONDALKIN
ITM	707201, 731535
Description	<p>South of St. John's church is a rectangular granite font (dimensions length 1.20m, width 0.95m, D 0.60m) with a dressed N face and an irregular S face with a channel inside the rim (Ball 1899, 98).</p> <p>Cooper, A. 1780. Austin Coopers Notes, 54-6</p> <p>Ball, F. E. 1899 Descriptive sketch of Clondalkin, Tallaght and other places in west county Dublin, JRSAI, Vol. 29, 1899, p. 96-7.</p> <p>Bradley, J. and King, H. Urban Archaeological Survey Part VIII (iv) County Dublin, p. 215-28.</p>

RMP No.	DU017-041008-
Site Type	Castle - unclassified
Townland	CLONDALKIN
ITM	706940, 731173
Description	<p>The exact location of this monument is not known with certainty. Ua Broin (1944, 212) has suggested that it was located on the site of the gate lodge into the college (Moyle Castle Park). There are no visible surface remains. Ua Broin, L. 1944. Clondalkin, Co. Dublin, and its</p>

	neighbourhood JRSAI, Vo. 74, 1944, 212-3. Bradley, J. and King, H. Urban Archaeological Survey Part VIII (iv) County Dublin, p. 215-28.
--	--

RMP No.	DU017-041009-
Site Type	Water mill - unclassified
Townland	CLONDALKIN
ITM	706856, 731576
Description	The Mill Centre Shopping complex northwest of Clondalkin Village occupies the site of a medieval mill. This mill is mentioned in Archbishop Alen's Register 1326 (McNeill 1950, 187; Ua Broin 1944, 210-211) and is presumably the castellated mill described by Austin Cooper in 1780 (Price ed. 1942, 56). Not visible at ground level. Cooper, A. 1780. Austin Coopers Notes, 54-6 Bradley, J. and King, H. Urban Archaeological Survey Part VIII (iv) County Dublin, p. 215-28. Ua Broin, L. 1944. Clondalkin, Co. Dublin, and its neighbourhood JRSAI, Vo. 74, 1944, 210-211.

RMP No.	DU017-041012-
Site Type	Graveyard
Townland	CLONDALKIN
ITM	706941, 731410
Description	The present church (C of I) was built in 1790 near the site of an earlier church (DU017-041002-) fragments of which are enclosed in the walled in graveyard. This wall was considered 'very old' by Austin Cooper who mentioned it in his diary in 1780 (Price, L. ed. 1942, 54-6). Within the graveyard there is a cross (DU017-041003-). There are 17th-19th century memorials in the graveyard. Ball, F. E. 1899 Descriptive sketch of Clondalkin, Tallaght and other places in west county Dublin, JRSAI, Vol. 29, 1899, p. 96-7. Barrow, G. L. 1975 Round towers of Dublin in DHR, Vol. 28, No. 2, p. 61-3, 66-7. Cooper, A. 1780. Austin Coopers Notes, 54-6

RMP No.	DU017-042----
Site Type	Church
Townland	CLONDALKIN
ITM	707062, 731405
Description	Foundations of a stone church were exposed during rescue excavations in 1964 (Rynne 1967, 29-37). This was located within an ecclesiastical enclosure (DU017-042001-) which was an irregular oval in plan (dimensions length 48m, width 40m). It was defined by a low earthen bank (width 4m, height 0.8m). The church was of nave and chancel type (dimensions Nave length 8.80m, width 6.80m; chancel length 5.30m, width 3.00m). It was entered through diametrically opposed entrances in W end of the nave. An altar which was square in plan (dimensions 1.40m x 1.30m) and built in two levels survived in the chancel. A small housing estate southeast of Watery Lane occupies the site. Not visible at ground level. Bradley Rynne, R. Excavation of a church site at Clondalkin, JRSAI, Vol 97, 1967 p. 29-37

RMP No.	DU017-043----
Site Type	Enclosure
Townland	KNOCKMITTEN
ITM	707972, 731483
Description	Situated on a northeast facing slope close to the Camock River. An aerial photograph taken in 1971 (FSI 227/8) shows cropmark evidence for a sub-circular enclosure (diameter c. 38m). Possibly a levelled ringfort. There is a housing estate on the site. Not visible at ground level. AP – Fairey Survey of Ireland 1971, 227/8 Housing estate on site in 1994, no visible surface trace.

RMP No.	DU017-083----
Site Type	Burial ground
Townland	GALLANSTOWN (Castleknock By.)
ITM	708085, 732612
Description	Pre-development testing in 1999 revealed a very low mound which covered three east-west oriented skeletons (Purcell 2000, 83). The remains were those of two adult males and one adolescent aged 12-16 years. The site is thought to be an Early Christian burial mound. Excavations.ie Ref. No.: 1999:246

For inspection purposes only.
Consent of copyright owner required for any other use.

APPENDIX 12.2 ARCHAEOLOGICAL FINDS

The recorded archaeological finds from the study area are listed below, all noted in the National Museum of Ireland files, Kildare Street, Dublin 2, in local journals, or in other published catalogues of prehistoric material: Raftery (1983), Eogan (1965; 1983; 1994), Harbison (1968; 1969a; 1969b) and the Irish Stone Axe Project Database. The following townlands were assessed: Ballyfermot Upper, Ballymanaggin, Blackditch, Clonburriss Great, Clondalkin, Collinstown, Fox and Geese, Fox and Geese Common, Gallanstown, Knockmitten, Neillstown, Raheen, Red Cow and Yellowmeadows.

List of Finds:

NMI 1911:242	Clondalkin
Flanged axe Dryland find. (ref. Mount 2001, 21)	
NMI 1932:5609	Clondalkin
Stone Muller Found beside a 'cromlech'.	
NMI 1963:65	Clondalkin
Flanged Bronze axehead Bronze axehead. With flanges and slight stop-ridge. The butt is sharp and slightly convex in outline; the cutting edge is deeply convex. The flanges are cut deep and are pointed oval on their external aspect. On them is an ornamental pattern which is somewhat worn: it appears to be a series of parallel zigzag lines hammered along the longitudinal axis. The stop-ridge is parallel to the convex curve of the cutting-edge and where the flanges end between stop-ridge and cutting edge, there is another slight ridge across each face of the axehead. (Dims.: L 12.6; W at butt 2.2, at cutting edge 6.35; max W of flange 1.6cm)	
NMI 1964:21	Clondalkin
Decorated bronze ring pin Undecorated shank tapers to a point capped by a ring. Ring decorated with lines of dots forming a symmetrical geometrical pattern (JRSAI, Vol 97, 1967, 32-34).	
NMI 1964:22 and 1964:23	Clondalkin
Possible tile fragments Narrow strip-like objects of rectangular cross-section made of a very heavy and hard plaster or ceramic. One piece is short and straight and the other is slightly curved. They may be narrow tiles used decoratively in a mosaic or the surround of a window (JRSAI, Vol 97, 1967, 32-34).	
NMI 1976:24	Clondalkin
Barbed flint arrowhead Found in the surface soil of a garden at Monastery Drive.	
NMI 1997:13	Clondalkin
Iron Blade Short double-edged iron blade, probably tanged, with straight sides and straight base, of flattened oval section; point broken. Only fragment of tang (or possibly socket) survives, apparently of roughly round section. (Dims.: L 10.10; L of blade 8.70; W 2.50; T 0.80 cms) Found in the Green at Boot Road Inner.	

APPENDIX 12.3 EXCAVATIONS

The excavation bulletin website (www.excavations.ie) was consulted to identify previous excavations that have been carried out within the study area. This database contains summary accounts of excavations carried out in Ireland from 1970 to 2016. The following townlands were assessed - Ballyfermot Upper, Ballymanaggin, Blackditch, Clonburris Great, Clondalkin, Collinstown, Fox and Geese, Fox and Geese Common, Gallanstown, Knockmitten, Neillstown, Raheen, Red Cow and Yellowmeadows.

Excavations.ie Ref. No.: 1997:178

Site name: UNIT 10, PARK WEST INDUSTRIAL ESTATE, GALLANSTOWN

Sites and Monuments Record No.: N/A Licence number: —

Author: Deirdre Murphy, Archaeological Consultancy Services Ltd, 5 Trinity Street, Drogheda, Co. Louth.

Site type: No archaeological significance

ITM: E 708228m, N 732927m

Latitude, Longitude (decimal degrees): 53.335500, -6.374988

Archaeological monitoring of a proposed warehouse development at Unit 10, Park West Industrial Estate, Dublin 10, was undertaken over a four-week period from 9 December 1996 to 15 January 1997. The site lies in Gallanstown townland, an area known to have been inhabited in the Early Christian period and close to the monastic site at Clondalkin. No archaeological stratigraphy was evident and no artefacts were recovered.

Excavations.ie Ref. No.: 1998:120

Site name: BALLYFERMOT UPPER, Dublin.

Sites and Monuments Record No.: SMR 18:31:04

Licence number: 98E0367

Author: Edmond O

Site type: Graveyard

ITM: E 709586m, N 733218m

Archaeological test excavation was carried during October 1998 at the corner of Le Fanu Road and Raheen Road, Ballyfermot, Co. Dublin. The site lies in the townland of Ballyfermot Upper, within the registered area of three archaeological sites (SMR 18:31-01/03/04). These sites include Ballyfermot Castle, and Ballyfermot Church and Graveyard.

The castle, church and graveyard lie within Le Fanu Park. The park has been landscaped, and no standing remains of any of the monuments survive above ground, with the exception of a rectangular mound at the site of Ballyfermot Church. The foundation of the church dates to the 13th century, and it appears to have gone out of use in 1660 (Ball, A history of County Dublin, vol. 4, 101-6. 1906).

The test excavation was carried out in response to a proposed development that partially overlies the eastern fringes of Ballyfermot Graveyard. It uncovered the graveyard wall and articulated and disarticulated human remains within the boundary of the graveyard, which was used from the medieval period through to the beginning of this century (Johnston, The ruins of the Church of St Laurence, unpublished report held in the Ballyfermot Public Library, 1974), but no clear date was established for the burials uncovered. A wall was identified in Trench 1. Its location corresponds to the graveyard wall that surrounded the church. It appears that this boundary (the graveyard wall) turns sharply to the west between Trenches 1 and 2 and defines the extent of the burials on site. Trenches 2 and 3 appear to lie on the eastern side (outside) the graveyard wall. The deposits identified in Trench 3 record the landscaping of the graveyard in the 1970s.

Excavations.ie Ref. No.: 1999:246

Site name: PARKWEST, GALLANSTOWN

Sites and Monuments Record No.: N/A

Licence number: 99E0108

Author: Avril Purcell, Margaret Gowen & Co. Ltd, 2 Killiney View, Albert Road Lower, Glenageary, Co. Dublin.

Site type: Early Christian cemetery

ITM: E 708097m, N 732596m

Latitude, Longitude (decimal degrees): 53.332553, -6.377066

During topsoil-stripping before the development of a business park, human remains were revealed on a very low mound towards the north-west of this development in February 1999. A rescue excavation was carried out by Cólín Ó Drisceoil (Archaeological Consultancy Services), which revealed three east-west-oriented skeletons and disarticulated bone. Two other trenches were opened, and four other individuals were exposed in these. It was thus concluded that the site represented an Early Christian cemetery.

An assessment of the extent of the site was required, and eight trenches were opened encircling the area of the known burials. Six burials were partially exposed but, as agreed with Dúchas, were not excavated.

In several trenches a wide, shallow ditch was revealed. Two sections were opened through the ditch in two trenches. It was c. 2.5m wide and 0.6m deep as revealed in the trench to the north-west of the first burials found. The other section, opened to the south-east, could not be fully excavated as five burials were revealed that were to remain in situ. This feature appears to have been backfilled in antiquity, and subsequently burials were inserted into it, suggesting that the cemetery extended beyond this ditch on the south-eastern side.

Excavations.ie Ref. No.: 1999:247

Site name: 37 PARK WEST INDUSTRIAL PARK, GALLANSTOWN

Sites and Monuments Record No.: N/A Licence number: 309640 233060

Author: Donald Murphy, Archaeological Consultancy Services Ltd, 15 Trinity Street, Drogheda, Co. Louth.

Site type: Close to cemetery

ITM: E 706570m, N 732088m

Latitude, Longitude (decimal degrees): 53.328304, -6.400153

Monitoring of the excavation of the foundations of an ESB transformer room and site security office was carried out at Site 37, Park West Retail and Industrial Park, Gallanstown, Dublin. Construction work has been ongoing at this site since October 1997, and therefore the site has been very much disturbed. Early in 1999 skeletal remains were excavated by Margaret Gowen & Co. Ltd from the same townland (No. 246 above).

Monitoring revealed that the topsoil in this area had already been stripped down to the natural boulder clay as part of the previous development and a layer of hardcore had been laid over most of the site. The foundation trenches, which were excavated to a depth of c. 6m, revealed no archaeological deposits or stratigraphy.

Excavations.ie Ref. No.: 2000:0299

Site name: PARKWEST, GALLANSTOWN

Sites and Monuments Record No.: N/A Licence number: 00E0267

Author: Avril Purcell, Margaret Gowen & Co. Ltd, 2 Killiney View, Albert Road Lower, Glenageary, Co. Dublin.

Site type: Vicinity of cemetery

ITM: E 708194m, N 732447m

Latitude, Longitude (decimal degrees): 53.331195, -6.375662

Human remains, probably of Early Christian date, were revealed on this site during groundworks in advance of a business park development in 1999. This was partially excavated by Cólín Ó Drisceoil, revealing three east-west-orientated burials and disarticulated bone (Excavations 1999, 83). An archaeological assessment by the writer (Excavations 1999, 83, 99E0108), followed by a geophysical survey, was then undertaken to reveal the extent of the cemetery.

A second assessment was carried out on the larger area surrounding the cemetery. This involved the excavation of 24 test-trenches across an area of the business park known as Sector Two, an area of c. 320,000m². Of the 24 test-trenches opened, two revealed features of archaeological significance—Trenches 18 and 22.

Trench 18 was located in the south-west of the area assessed. A stone-lined well was revealed in this trench. The well had an internal diameter of 0.95m and was excavated to a depth of 1.4m, but water was not reached at this depth. The well appears to have been backfilled in the 18th century, but its construction date remains uncertain. The ground immediately surrounding the well was made up, presumably to provide a level surface. Macro-fossil remains were recovered from the well backfill and the surrounding make-up layer. Remains of oats, wheat, barley and small amounts of rye were identified in these deposits. Given that the macro-fossil remains were recovered from backfill and make-up layers, it appears that these were derived from earlier deposits, which appear to have been redeposited within these later features (Penny Johnston, pers. comm.). The well is to be preserved in situ.

Archaeological remains were also recovered from Trench 22, which was located directly south-east of the cemetery. Human remains in very poor condition were revealed in the trench. They appear to be the partial remains of a young child, with some animal bone found with the burial. This probably represents an outlier to the Early Christian cemetery, deposited while the cemetery was still in use or shortly after. Two relatively shallow pits were also revealed in Trench 22. Feature 53 measured 2.5m x 1.7m and was 0.32m deep; it contained very compact, macro-fossil-rich clay laid down in thin lenses. Feature 58 measured 1.3m x 2.05m and was 0.25m deep; similar clay fill with humic material through it was revealed. A significant volume of macro-fossil remains was recovered from these pits, including oats, barley, wheat and small amounts of rye, as well as high quantities of legumes. Feature 53 was also rich in chaff fragments and weed seeds (Penny Johnston, pers. comm.) The macro-fossil remains are similar to those that would be cleared out of a corn-drying kiln. However, in this instance the kiln rubbish would have had to be deliberately deposited within these pits rather than just cleaned out and scattered over the surrounding area, as is more likely. It is possible that this is ritual activity associated with the nearby cemetery (Penny Johnston, pers. comm.) Similar evidence for ritual activity has been located at other Early Christian sites in Dublin (Margaret Gowen, pers. comm.)

Excavations.ie Ref. No.: 2003:0603

Site name: Sector 2A, Parkwest, Gallanstown

Sites and Monuments Record No.: N/A Licence number: 03E1393

Author: Christine Baker, Margaret Gowen & Co. Ltd, 2 Killiney View, Albert Road Lower, Glengageary, Co. Dublin.

Site type: No archaeological significance

ITM: E 707908m, N 732594m

Latitude, Longitude (decimal degrees): 53.332574, -6.379903

The monitoring programme constituted the latest phase of investigation at the site following the discovery of human remains by Avril Purcell during topsoil-stripping in 1999 (Excavations 1999, No. 246, 99E0108). Several assessments were undertaken to identify the extent of the cemetery, which has been preserved under a large landscaped mound and by a buffer zone. This current phase had previously been subject to some limited ground reduction supervised by Avril Purcell (Excavations 2000, No. 299, 00E0267). The current phase confirmed the natural clay horizon. No archaeological features or artefacts were identified.

Excavations.ie Ref. No.: 2004:0601

Site name: SECTOR 2A, PARKWEST, GALLANSTOWN

Sites and Monuments Record No.: N/A Licence number: 03E1393 ext.

Author: Christine Baker, Margaret Gowen & Co. Ltd, 27 Merrion Square, Dublin 2.

Site type: No archaeological significance

ITM: E 707908m, N 732594m

Latitude, Longitude (decimal degrees): 53.332574, -6.379903

This monitoring programme constituted the latest phase of archaeological investigation at the site. This current phase consisted of the location and removal of a well identified in the 2000 assessment by Avril Purcell (Excavations 2000, No. 299, 00E0267) and a general reduction in ground levels. No features or artefacts of archaeological significance were identified.

Excavations.ie Ref. No.: 2005:385

Site name: TESTING AREA 16, BALLYMANAGGIN, Dublin

Sites and Monuments Record No.: N/A

Licence number: 05E0067

Author: Linda Clarke, Archaeological Consultancy Services Ltd, Unit 21, Boyne Business Park, Greenhills, Drogheda, Co. Louth.

Site type: No archaeological significance

ITM: E 707440m, N 733536m

An assessment was carried out in advance of the planned M50 upgrade. Testing Area 16 was located in the townland of Ballymanaggin. The testing methodology, where possible, generally consisted of mechanically excavating 2.3m-wide test-trenches down the centre of the testing area, with offsets every 15m. A single field was located within Testing Area 16. The northern portion was utilised as a fill site and was significantly raised above the existing road level, so was not assessed. The southern extent was a greenfield site. Service pipes transected the southern extent, so excavation of trenches within this area was limited. Spoil heaps and modern rubbish (including burnt-out cars) were also located within the southern extent of this testing area. The combined area of test-trenches excavated in Testing Area 16 was 865.83m².

No features of archaeological significance were identified and no finds were recovered.

Excavations.ie Ref. No.: 2005:488

Site name: GALLANSTOWN

Sites and Monuments Record No.: N/A Licence number: 03E1393

Author: Teresa Bolger, for Margaret Gowen & Co. Ltd, 27 Merrion Square, Dublin 2.

Site type: No archaeological significance

ITM: E 708449m, N 732120m

Latitude, Longitude (decimal degrees): 53.328206, -6.371948

Monitoring was undertaken at the site of Building 49, which forms part of Sector 2 of the Parkwest Business Park, Gallanstown, Dublin 10. Monitoring of groundworks associated with Sector 2 was undertaken by Christine Baker in 2003 and 2004 (Excavations 2003, No. 603; Excavations 2004, No. 601, 03E1393 ext.). No archaeological features or deposits were identified during this phase of works.

Excavations.ie Ref. No.: 2005:489

Site name: PARKWEST, GALLANSTOWN

Sites and Monuments Record No.: N/A Licence number: 04E0107

Author: Alan Hayden, Archaeological Projects Ltd, 27 Coulson Avenue, Rathgar, Dublin 6.

Site type: No archaeological significance

ITM: E 630745m, N 832006m

Latitude, Longitude (decimal degrees): 54.235992, -7.528399

Three trenches opened as part of an archaeological assessment at Parkwest, Gallanstown, Clondalkin, in July 2005 revealed nothing of archaeological significance.

Excavations.ie Ref. No.: 2009:292

Site name: ELMDALE CRESCENT, BLACKDITCH, Dublin

Sites and Monuments Record No.: N/A

Licence number: 09E0320

Author: Melanie McQuade, Margaret Gowen & Co. Ltd, 27 Merrion Square, Dublin 2.

Site type: No archaeological significance

ITM: E 708123m, N 733365m

Blackditch was an old landholding which belonged to the see of Dublin. One of the fields mentioned in a lease dated 1432 was 'Baron's Meade' which had a boundary described as 'The Trench'. It is from this 'trench' or 'ditch' that the placename Blackditch is derived.

Test excavations were carried out on an area of greenfield, covering 5.8ha within a housing estate, where further development was planned. A total of six trenches were mechanically excavated on site, including one through a crescent-shaped mound of earth on the east of the site. The mound proved to be a modern landscaping feature. No archaeological features or artefacts were uncovered during test excavations and the results indicate that the site was landscaped with imported fill and topsoil during the modern period, most probably when the surrounding houses were constructed.

Excavations.ie Ref. No.: 2011:176

Site name: ASTAGOB (CASTLEKNOCK BY, CASTLEKNOCK ED)/CAPPAGH/CAPPOGE/CLONBURRIS GREAT/COOLMINE (CASTLEKNOCK BY)/CORDUFF (CASTLEKNOCK BY.)/DARDISTOWN/IRISHTOWN (CASTLEKNOCK BY.)/MERRYFALLS/RONANSTOWN/SILLOGE/SNUGBOROUGH (CASTLEKNOCK BY.)

Sites and Monuments Record No.: N/A

Licence number: 10E0410

Author: Kara Ward

Site type: Monitoring

ITM: E 706763m, N 735822m

Monitoring of preliminary ground investigations was undertaken for the route of Metro West, a twin-track light rail system which will serve a 25km corridor from the junction of Belgard Road/Old Blessington Road in Tallaght to Dardistown. It will link Tallaght, Clondalkin, Liffey Valley and Blanchardstown and will provide a fast commuter service to the city centre, Swords and the airport via Metro North.

Geotechnical investigations were required in order to provide factual data for use in the design and construction of Metro West. It was proposed to undertake cable percussion and rotary cored boreholes, together with trial pits, to determine the nature and thickness of the underlying soils, and also to ascertain the level and nature of the underlying rock as well as infiltration rates.

Monitoring of boreholes and trial pits was carried out in those areas deemed to be within or adjacent to the zones of archaeological potential for a number of sites, including DU017-005 (ringfort, unclassified), DU014-027 (castle-tower-house), DU014-021 (field system, possible) and DU013-019 (church and graveyard, National Monument). In addition, a number of boreholes/trial pits were within or adjacent to a number of areas of archaeological potential as identified by the Metro West Environmental Impact Statement (EIS).

The locations of these works were geographically dispersed along the proposed route and within the townlands of Astagob (Castleknock By, Castleknock ED), Cappagh, Cappoge, Clonburris Great, Coolmine (Castleknock By), Corduff (Castleknock By), Dardistown, Irishtown (Castleknock By), Merryfalls, Ronanstown, Silloge and Snugborough (Castleknock By).

The excavations of a total of twelve trial pits and thirteen boreholes were subject to monitoring along the route of Metro West. A further ten trial pits, five boreholes and five infiltration test pits were monitored at the location of the Metro North depot in Dardistown. Nothing of apparent archaeological significance was located in any of the pits or boreholes.

Archaeological Development Services Ltd, 96 University Street, Belfast BT7 1HE

Excavations.ie Ref. No.: 2010:235

Site name: Astagob (Castleknock By., Castleknock ED)/Cappagh/Cappoge/Clonburris Great/Coolmine (Castleknock By.)/Corduff (Castleknock By.)/Dardistown/Irishtown

Sites and Monuments Record No.: N/A

Licence number: 10E0410

Author: Jane Whitaker and Kara Ward, Archaeological Development Services Ltd, Unit 6, Channel Wharf, 21 Old Channel Road, Belfast, BT3 9DE.

Site type: No archaeological significance

ITM: E 706763m, N 735822m

Monitoring of preliminary ground investigations was undertaken for the route of Metro West, a twin-track light rail system which will serve approximately a 25km corridor from the junction of Belgard Road/Old Blessington Road in Tallaght to Dardistown.

Geotechnical investigations were required in order to provide factual data for use in the design and construction. It was proposed to undertake cable percussion and rotary cored boreholes, together with trial-pits to determine the nature and thickness of the underlying soils, and also to ascertain the level and nature of the underlying rock as well as infiltration rates.

Monitoring of boreholes and trial-pits was carried out in those areas deemed to be within or adjacent to the zones of archaeological potential for a number of RMP sites including DU017-005 (ringfort – unclassified); DU014-027 (castle/tower-house); DU014-021 (field system, possible); DU013-019 (church and graveyard; national monument). In addition, a number of boreholes/trial-pits were within or adjacent to a number of areas of archaeological potential as identified by the Metro West environmental impact statement (EIS).

The locations of these works were geographically dispersed along the proposed route and within the townlands of Astagob (Castleknock By., Castleknock ED), Cappagh, Cappoge, Clonburris Great, Coolmine (Castleknock By.), Corduff (Castleknock By.), Dardistown, Irishtown (Castleknock By.), Merryfalls, Ronanstown, Silloge, Snugborough (Castleknock By.).

The excavation of a total of twelve trial-pits and thirteen boreholes was subject to monitoring along the route. A further ten trial-pits, five boreholes and five infiltration test-pits were monitored at the location of the Metro North depot in Dardistown. Nothing of apparent archaeological significance was located in any of the pits or boreholes.

Excavations.ie Ref. No.: 2006:584

Site name: DUBLIN AIRPORT, COLLINSTOWN, Dublin

Sites and Monuments Record No.: DU014-011, DU014-023

Licence number: 06E0545

Author: Niall Gregory, Gregory Consultant Archaeology Ltd, Dunburbeg, Clonmel Road, Cashel, Co. Tipperary.

Site type: Monitoring

ITM: E 716271m, N 743162m

Between May 2006 and August 2007 intermittent monitoring of groundworks associated with the proposed extension of the airport terminal building were undertaken. In conjunction with the Department of the Environment, and based on health and safety considerations, an investigative testing excavation was considered unsuitable and potentially hazardous, thus a programme of intensive monitoring of groundworks was implemented in its stead.

An area comprising 7838m² was monitored and the results were determined to be not of archaeological significance, as no remains of cultural or heritage value were recovered. The stratigraphic matrix consisted of 0.6m of reinforced concrete where the aircraft runways exist, which was underlain by up to 0.4m of hardcore. The underlying natural subsoil was a very compacted silty clay, with a high volume of decayed and undecayed limestone present. The majority of the construction had little or no impact on to the subsoils, but the laying of service lines and utility plants did have deeper impacts, ranging from 1.4 to 4m. In places, depths of up to 6m were recorded as having been achieved. Fragments of early 20th-century clay drainage pipes associated with the previous use of the area by the Royal Air Force (pre-1920) and one piece of oyster shell were recovered.

Excavations.ie Ref. No.: 2009:AD4

Site name: DUBLIN AIRPORT TERMINAL II, COLLINSTOWN, Dublin

Sites and Monuments Record No.: N/A

Licence number: 06E0440 ext.

Author: William O. Frazer, Skeyelarque2@fastmail.fm.

Site type: Monitoring

ITM: E 716942m, N 743178m

Monitoring of groundworks on the South Apron at Dublin Airport Terminal II was undertaken from April to July 2008, with the assistance of Carina Eriksson. Particular attention was paid to the former location of Collinstown House.

No archaeology was identified. Notably, no demolition rubble or building debris of any type was identified, suggesting that Collinstown House may have been quite thoroughly removed during the initial levelling of the area (by hand, by a large team of workmen) in the 1930s or during subsequent construction phases of airport tarmac and the underground access tunnel in the vicinity.

Excavations.ie Ref. No.: 2011:183

Site name: COLLINSTOWN, Dublin

Sites and Monuments Record No.: N/A

Licence number: 11E0431

Author: Gerry Mullins

Site type: Dumb-bell kiln

ITM: E 706881m, N 733493m

At the request of Fingal County Council, monitoring was undertaken in June 2011 at Collinstown, Lusk, Co. Dublin, owing to a planning application involving proposed land improvements and the installation of a percolation area. The development area is near DU008-002. This monument is not perceptible above ground.

During the course of the soil-stripping the probable edge of a curvilinear ditch was barely exposed, along with a dumb-bell-type kiln. The kiln was approximately 30m east of the proposed ditch. Soil-stripping was therefore discontinued and both supposed archaeological features were re-covered with topsoil pending the outcome of the planning application.

Following discussions between the developer and the planning authorities it was decided that all further developments within the area should be monitored. Two archaeologists were present on site on 15 November 2011. The area (611m²) beneath the footprint of a proposed dwelling some 10m east of the kiln and a further 700m² extending approximately 140m northwards from the proposed dwelling were stripped of topsoil by a 360-degree tracked machine using a 0.9m toothless bucket. Topsoil depth averaged 0.4m and was notably clean. The absence of artefacts was particularly noted. Yellow boulder clay was revealed beneath. Apart from a number of modern land drains, this too was devoid of archaeological features.

A request by the developer to excavate the kiln was accommodated by the granting of an extension to the excavation licence. This work was undertaken during the week ending 20 January 2012. The figure-of-eight or dumb-bell kiln was aligned north-south and measured a maximum of 2.4m x 1.25m. It was 0.85m in maximum depth. Several layers of redeposited natural soil and charcoal-rich layers were revealed. The base was stone-lined. It occurs at approximately 34.5m OD. Environmental samples were taken, including some charcoal which may be suitable for radiocarbon dating. These samples have yet to be processed. It is proposed that the feature might be medieval in date and is potentially associated with the nearby enclosure.

Clone East, Monamolin, Gorey, Co. Wexford

Excavations.ie Ref. No.: 2005:521

Site name: TESTING AREA 17, REDCOW, Dublin

Sites and Monuments Record No.: N/A

Licence number: 05E0068

Author: Linda Clarke, Archaeological Consultancy Services Ltd, Unit 21, Boyne Business Park, Greenhills, Drogheda, Co. Louth.

Site type: No archaeological significance

ITM: E 708379m, N 731214m

An assessment was carried out in advance of the planned M50 upgrade. Testing Area 17 was located in the townland of Redcow. The testing methodology, where possible, generally consisted of mechanically excavating 2.3m-wide test-trenches along the centre of the testing area and offsets across the testing area every 15m. A single field was located within Testing Area 17. Ten test-trenches were excavated within this field. A stony natural subsoil was exposed at certain locations throughout the site, but the majority of the field was used as a landfill site and modern rubbish was visible throughout. The combined area of test-trenches excavated in Testing Area 17 was 1723m². No features of archaeological significance were identified and no finds were recovered.

*For inspection purposes only.
Consent of copyright owner required for any other use.*

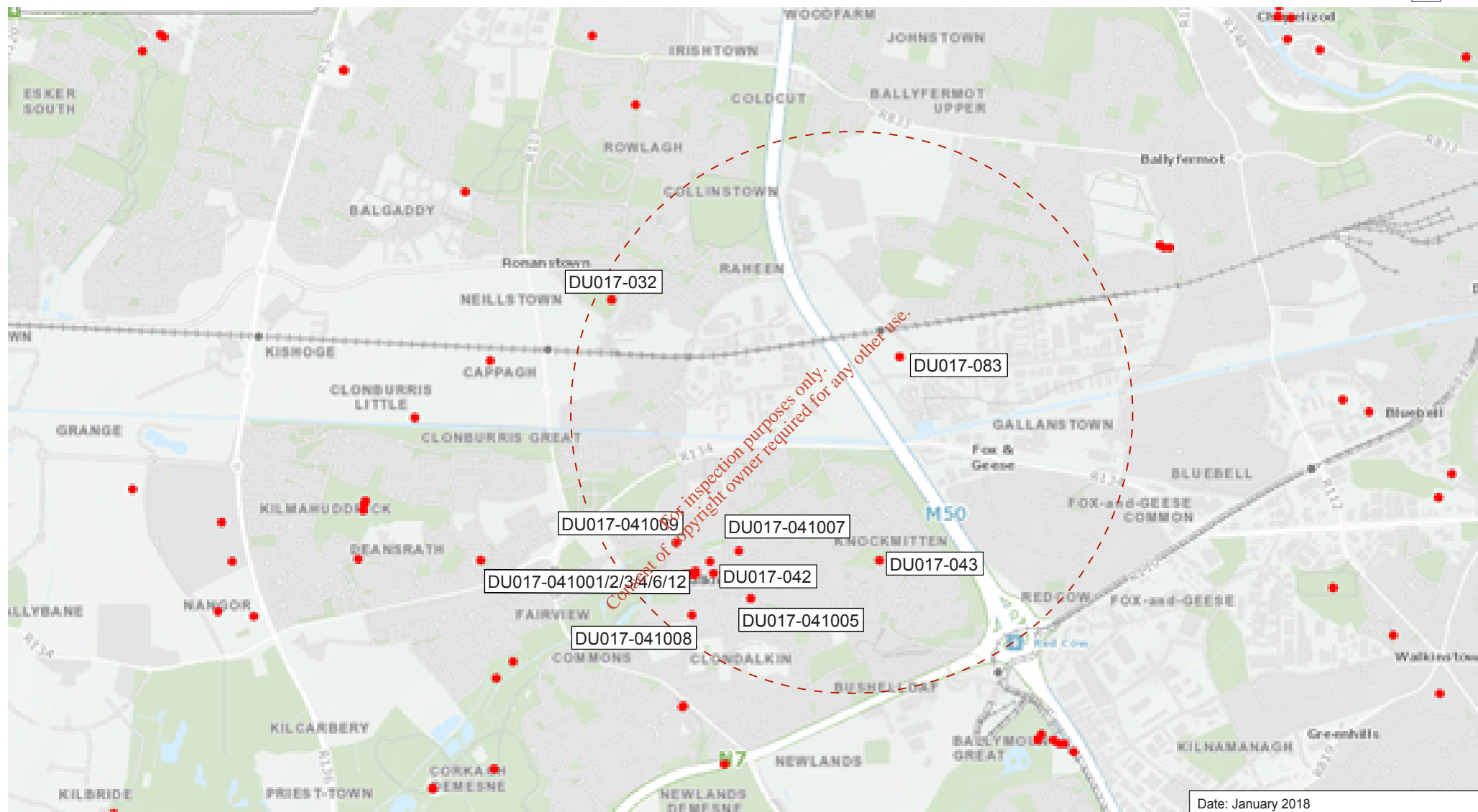

Date: January 2018
 Client: Awn Consulting
 Drawn by: AnC



CRDS Ltd.
 2 Grosvenor Terrace,
 Monkstown,
 Co. Dublin.
 Tel: +353 1 2968190

Figure 8.1: Recorded archaeological monuments within c. 1.5km of the proposed development (source www.archaeology.ie).

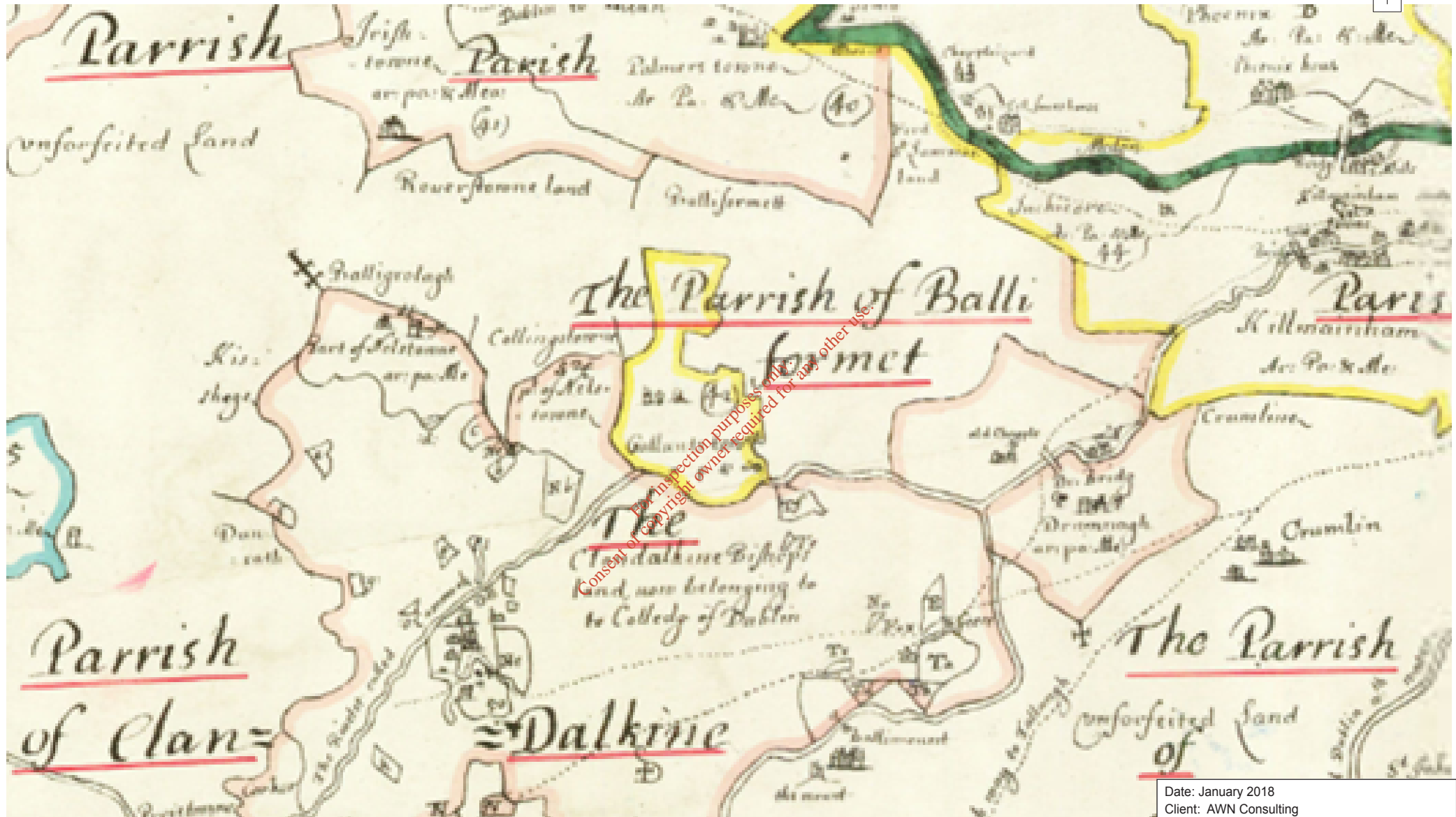

Date: January 2018
 Client: AWN Consulting
 Drawn by: ANC



CRDS Ltd.
 2 Grosvenor Terrace,
 Monkstown,
 Co. Dublin.
 Tel: +353 1 2968190

Figure 12.2: Extract from the Down Survey 'Barony of Newcastle and Uppercrosse' showing Gallanstown and Clondalkin.

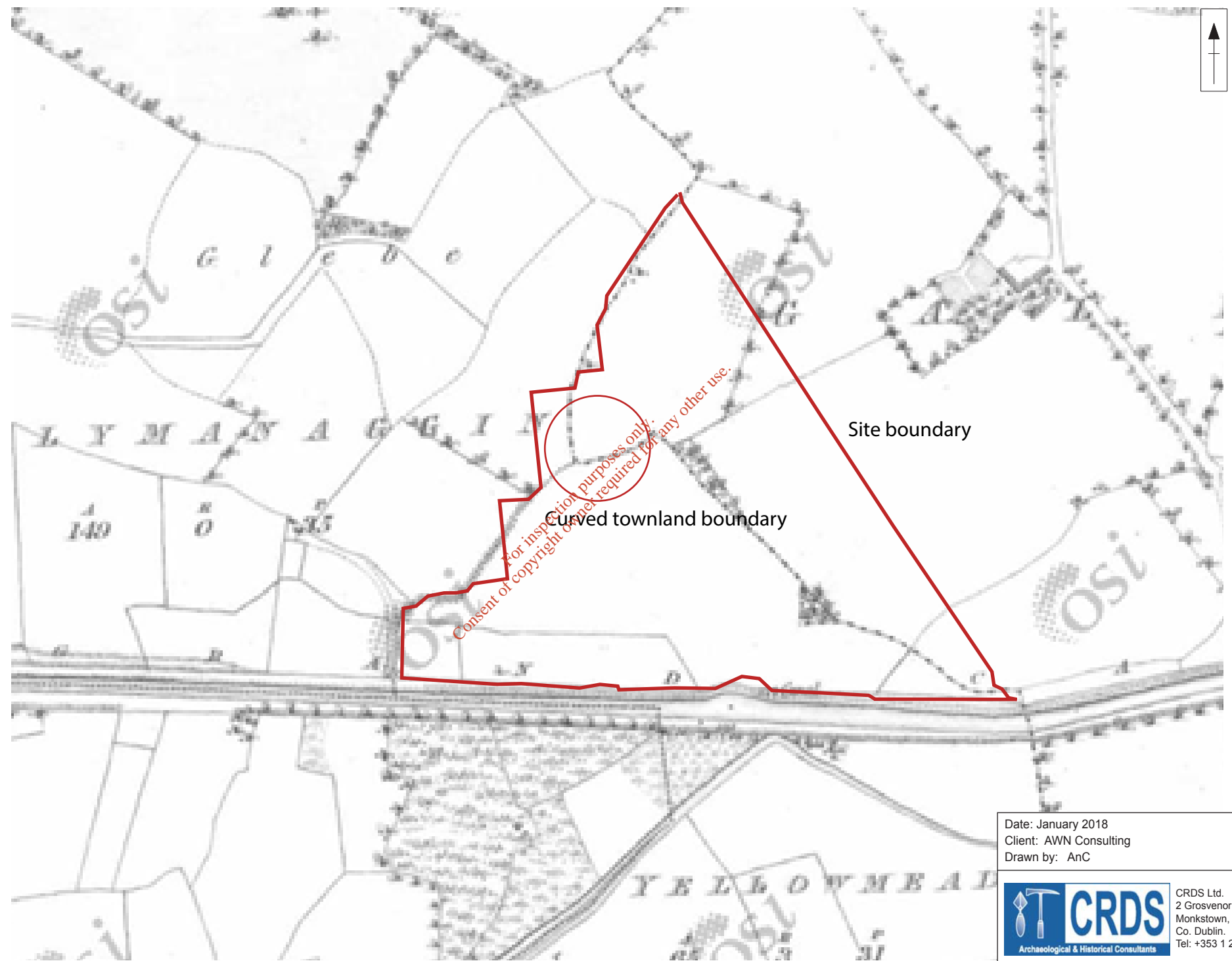

Date: January 2018
 Client: AWN Consulting
 Drawn by: AnC



CRDS Ltd.
 2 Grosvenor Terrace,
 Monkstown,
 Co. Dublin.
 Tel: +353 1 2968190

Figure 12.3: Extract from the Ordnance Survey 1st edition map, Dublin Sheet 17, showing site of proposed development.