

Attachment B.2.

Location Maps

*For inspection purposes only.
Consent of copyright owner required for any other use.*

Surveyed 1841
 Revised 1979
 Levelled 1898

Rural PLACE Map



Land owned by Patrick J. O'Connor
 at Rathcarrill West, Templeglantine,
 Co. Limerick.
 Drawn by William O'Regan,
 Droimrahee, Ardagh, Co. Limerick.
 Phone- 087-9796914

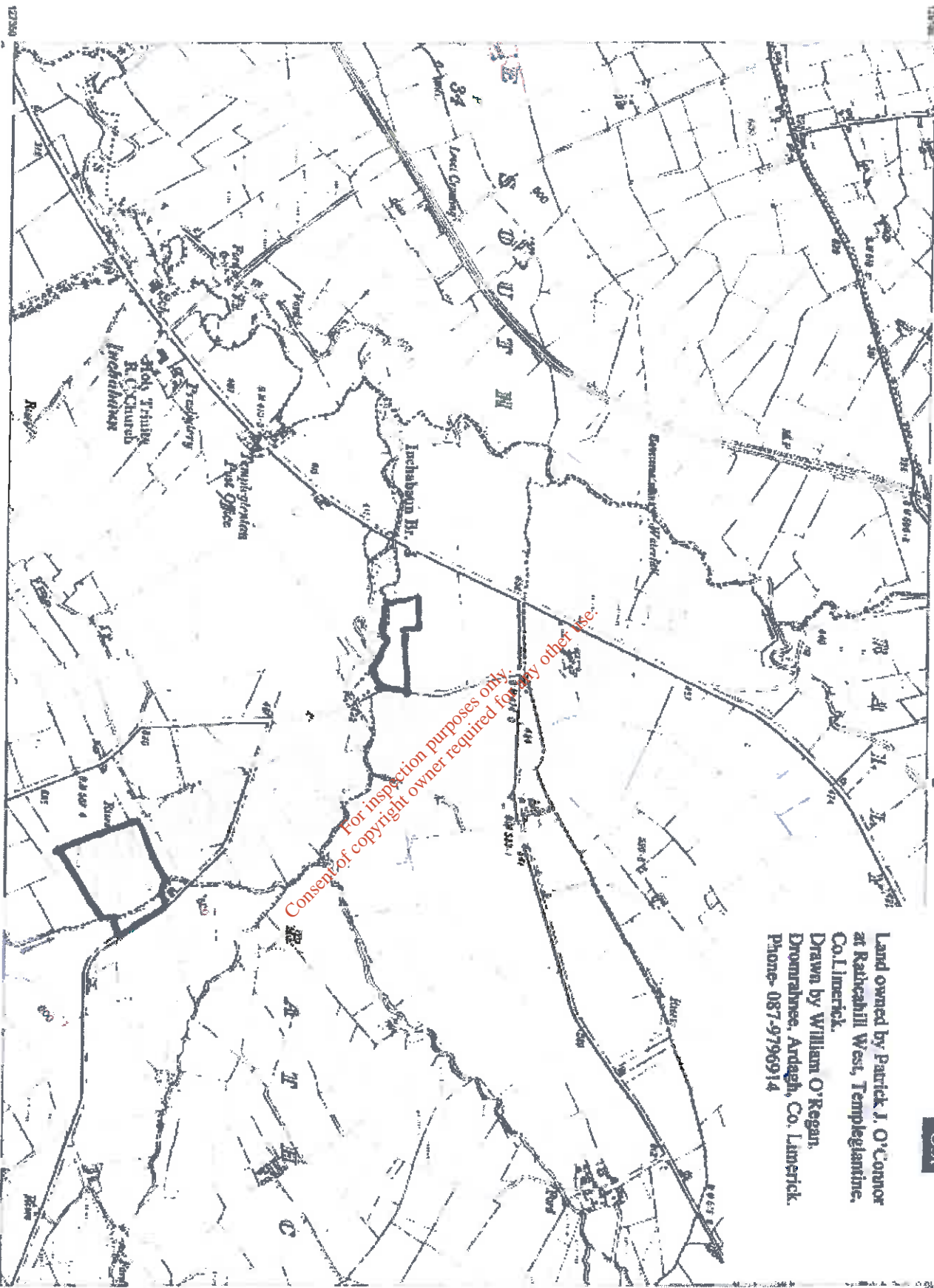

For inspection purposes only.
 Consent of copyright owner required for any other use.

Scale: 1:10,560
 Scale: 1:10,560



Plot Ref. No. 25161797_1_1
 Plot Date 04-JUN-2013

ITM CENTRE PT COORDS
 520454.628308

DESCRIPTION

MAP SHEETS

6 inch
 1:4043



Ordnance Survey Ireland

OSI
 Ordnance Survey Ireland

OSI is the national mapping agency for Ireland. It is responsible for the production and distribution of maps and other geospatial information. OSI also provides a range of services to its customers, including the provision of data and software. OSI is a member of the International Geographical Institute (IGI) and the International Geographical Union (IGU).



Rural PLACE Map

Surveyed 2013
 Revised 2015
 Levelling

11M CENTRE PT COORDS
 520454.628308

DESCRIPTION

MAP SHEETS

Digital Map
 52264



OSI
 Ordnance Survey
 Ireland

OSI is the national mapping agency for Ireland. It is responsible for the production and maintenance of the Ordnance Survey of Ireland, which includes the Ordnance Survey of the Republic of Ireland and the Ordnance Survey of Northern Ireland. OSI also provides a range of geospatial data and services to the public and private sectors.

© Surbhairéacht Ordnála Éireann, 2015
 © Ordnance Survey Ireland, 2015

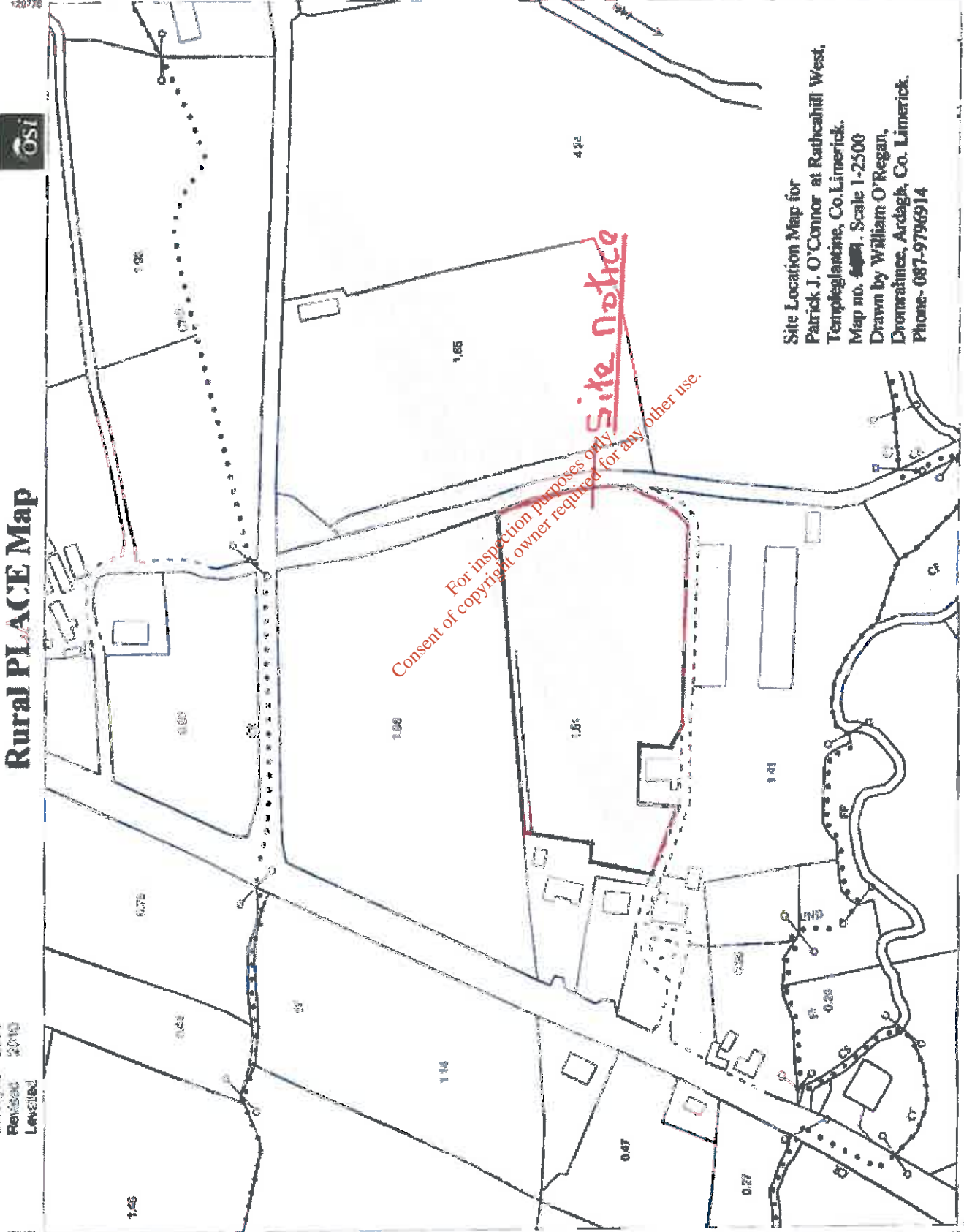

For inspection purposes only
 Consent of copyright owner required for any other use.
Site Notice

Site Location Map for
 Patrick J. O'Connor at Rathcahill West,
 Templeglantine, Co. Limerick.
 Map no. 40091, Scale 1:2500
 Drawn by William O'Regan,
 Dromraimes, Ardagh, Co. Limerick.
 Phone- 087-9796914

Plot Ref. No. 25167801_1_1
 Plot Date 04-JUN-2013

Scale- 1:2,500
 Scale- 1:2,500