

Mr Patrick Geoghean,  
Senior Inspector,  
c/o Administration,  
Environmental Licensing Programme,  
Office of Climate, Licensing & Resource Use  
Environmental Protection Agency  
Headquarters, PO Box 3000  
Johnstown Castle Estate  
Co. Wexford

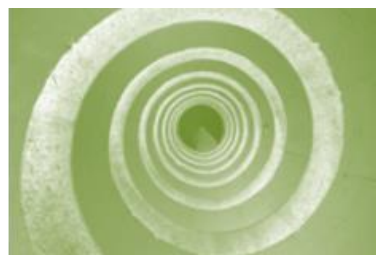

JSPE

J Sheils Planning & Environmental Ltd

31 Athlumney Castle, Navan, Co Meath

Phone/Fax: Ireland +353 46 9073997

Mobile: John Sheils +353 87 2730087

Email: johnsheils@jspe.ie

Date: 10<sup>th</sup> October, 2014

Our Ref: JSPE 173\_L10

Your Ref: W0265-01

**Re: Notice in accordance with Section 42 (1)(b) of the Waste Management Act 1996-2013 as inserted by SI No. 505 of 2013**

**Waste Licence Application by CLASHFORD RECOVERY FACILITY LTD for the continued operation of its existing Waste Recovery Facility on lands at Naul townland, Naul, Co. Meath (National Grid Reference 285633E 253005N).**

Dear Sir,

On behalf of Clashford Recovery Facility Ltd, we have prepared the following response to your notice issued on 28/02/2014 in accordance with Section 42 (1)(b) of the Waste Management Act 1996-2013 as inserted by SI No. 505 of 2013. An extension of time was subsequently granted by the EPA up to 10<sup>th</sup> October 2014 with respect to submission of the EIS for the above application.

The EPA has determined that "*In accordance with Section 40 (2A)(C) of the Waste Management Acts (1996-2013), the Agency has assessed the information submitted and considers that the application must be made subject to an environmental impact assessment (EIA)*".

The Following documentation has been included with our submission:

- Site Notice
- Newspaper Notice
- Site Notice Location Plan (*Drawing B 6.1 – Rev A*)
- Copy of Notification to Planning Authority (*JSPE\_173\_L09*)
- Environmental Impact Statement (EIS) and Non-Technical Summary

As requested, please find attached one (1) original plus one (1) copy in hardcopy format. In addition please find enclosed (2) copies of the requested information in electronic searchable PDF format on a CD-ROM.

We declare that the content of the electronic files on the accompanying CD-ROM's is a true copy of the original documentation.

We trust that our submission addresses your requirements under Article 42 Section 42 (1)(b) with respect to submission of an Environmental Impact Statement (EIS).

Please do not hesitate to contact us if you wish to discuss any aspect of this submission.

Yours Sincerely,

For J Sheils Planning & Environmental Ltd,

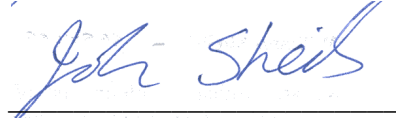

John Sheils MSCS MRICS

For inspection purposes only.  
Consent of copyright owner required for any other use.

Meath County Council  
Planning Department,  
Buvinda House,  
Dublin Road,  
Navan,  
County Meath.



JSPE

Date: 10<sup>th</sup> October, 2014  
Our Ref: JSPE 173\_L09  
EPA Ref: W0265-01

J Sheils Planning & Environmental Ltd

31 Athlumney Castle, Navan, Co Meath

Phone/Fax: Ireland +353 46 9073997

Mobile: John Sheils +353 87 2730087

Email: johnsheils@jspe.ie

**Re: Waste Licence Application by CLASHFORD RECOVERY FACILITY LTD for the continued operation of its existing Waste Recovery Facility on lands at Naul townland, Naul, Co. Meath (National Grid Reference 285633E 253005N).**

To whom it may concern:

In accordance with Article 9 (1) of the Waste Management (Licensing) Regulations 2004 (S.I. No. 395 of 2004), we wish to give written notice of the following application for a Waste License Application to the Environmental Protection Agency, on behalf of Clashford Recovery Facility Ltd, Ring Commons, Balbriggan, County Dublin. i.e.

**APPLICATION TO THE ENVIRONMENTAL PROTECTION AGENCY FOR A WASTE LICENCE**

Clashford Recovery Facility Ltd., Ring Commons, Balbriggan, County Dublin intend to apply to the Environmental Protection Agency for a waste licence for the continued operation of its existing waste recovery facility on lands at Naul, Naul Townland, Co. Meath (National Grid Reference 313399E 261545N). The nature of the development is the continued phased restoration of a sand and gravel pit using imported inert soils, stone, and recovery of inert construction and demolition waste. Up to circa 90,000 cubic metres per annum of inert materials is being accepted to site.

The principal activity is Class R5 (recycling/reclamation of other inorganic materials, which includes soil cleaning resulting in recovery of the soil and recycling of inorganic construction materials) of the Fourth Schedule of the Waste Management Act 1996, as amended. Other activities include Class R13 of the Fourth Schedule (storage of waste pending any of the operations numbered R 1 to R 12).

The waste licence application (W0265-01) was submitted on 13/02/2009. In accordance with Section 40 (2A)(C) of the Waste Management Acts (1996-2013), the Agency has assessed the information submitted and considers that the application must be made subject to an environmental impact assessment (EIA).

An environmental impact statement will be submitted to the Agency with the application.

A copy of the application for a waste licence, environmental impact statement and such further information relating to the application as may be furnished to the Agency in the course of the Agency's consideration of the application, will, as soon as practicable after receipt by the Agency, be available for inspection or purchase at the headquarters of the Agency.

Yours Sincerely,  
For J Sheils Planning & Environmental Ltd,



John Sheils  
Director

---

John Sheils MSCSI MRICS

For inspection purposes only.  
Consent of copyright owner required for any other use.

# **SITE NOTICE**

## **APPLICATION TO THE ENVIRONMENTAL PROTECTION AGENCY FOR A WASTE LICENCE**

Clashford Recovery Facility Ltd., Ring Commons, Balbriggan, County Dublin intend to apply to the Environmental Protection Agency for a waste licence for the continued operation of its existing waste recovery facility on lands at Naul, Naul Townland, Co. Meath (National Grid Reference 313399E 261545N).

The nature of the development is the continued phased restoration of a sand and gravel pit using imported inert soils, stone, and recovery of inert construction and demolition waste. Up to circa 90,000 cubic metres per annum of inert materials is being accepted to site.

The principal activity is Class R5 (recycling/reclamation of other inorganic materials, which includes soil cleaning resulting in recovery of the soil and recycling of inorganic construction materials) of the Fourth Schedule of the Waste Management Act 1996, as amended. Other activities include Class R13 of the Fourth Schedule (storage of waste pending any of the operations numbered R 1 to R 12).

The waste licence application (W0265-01) was submitted on 13/02/2009. In accordance with Section 40 (2A)(C) of the Waste Management Acts (1996-2013), the Agency has assessed the information submitted and considers that the application must be made subject to an environmental impact assessment (EIA).

An environmental impact statement will be submitted to the Agency with the application.

A copy of the application for a waste licence, environmental impact statement and such further information relating to the application as may be furnished to the Agency in the course of the Agency's consideration of the application, will, as soon as practicable after receipt by the Agency, be available for inspection or purchase at the headquarters of the Agency.



# CLASSIFIEDS

**Lineage Advertising and Family Notices Contact: 046-9079662 email: info@meathchronicle.ie Deadline for Lineage: 5 pm Monday • Deadline for Family Notices: Thursday 5pm**  
**Boxed Advertising Contact: 046-9079656 email: advertising@meathchronicle.ie - Deadline: 5.00 pm Monday**

**ARTICLES FOR SALE**

**DRY SEASONED HARDWOOD LOGS**  
CUT AND SPLIT TO SIZE  
LARGE OR SMALL LOADS  
DELIVERED  
BEST VALUE IN COUNTY MEATH  
TEL 046-9052248

**Jim Tallon**  
Curragestown, Drumree, Co. Meath  
01-8259749 087-6955365  
FOR YOUR **Stihl** POWER TOOLS

**CARS FOR SALE**  
(B) Denotes Trade/Business Sale

**NAVAN FAST FIT**  
MULLAGHBOY INDUSTRIAL ESTATE  
FOR WHEEL ALIGNMENT • LIGHT FOCUS • NEW AND PART WORN TYRES • CAR SERVICING • REPAIRS • EXHAUSTS FITTED • NEW CLUTCHES FITTED • CV JOINTS FITTED • TIMING BELT • WATER PUMP REPLACEMENT • ALL NCT WORK CARRIED OUT!  
OPEN 6 DAYS  
WE CAN COLLECT AND RETURN YOUR VEHICLE!  
PHONE 046-9072828

**CLASSES/COURSES**

**FRENCH** for Leaving Cert., Junior Cert., 1st, 2nd, 4th or 5th years at Navan School of Languages Tel. 046-90 29526.

**GERMAN** for Leaving Cert., Junior Cert., 1st, 2nd, 4th or 5th years at Navan School of Languages Tel. 046-90 29526.

**SPANISH** for adults, secondary students or children at Navan School of Languages Tel. 046-90 29526.

**French, German or Spanish for Adults** - Beginners or Improvers at Navan School of Languages Tel. 046-90 29526.

**Russian, Italian or Chinese for Adults** at Navan School of Languages Tel. 046-90 29526.

**Children's classes in French, German or Spanish** at Navan School of Languages Tel. 046-90 29526.

**French grinds with fluent, experienced and registered teacher** in Dunshaughlin, Certificate. Excellent results. Garda vetted. Limited. www.bsfrench.com. 087-6262424.

**CLASSES & COURSES**

**OPEN NIGHT**  
**Beaufort College**  
Navan  
**Monday 29th**  
**September 2014**  
**7pm to 9pm**  
Tel: 046 9028915  
Website: www.beaufortcollege.ie  
Email: beaufortcollege@metb.ie

**Saturday Classes in Creative Writing for Children.** Venue: Ashbourne. Commencement Date: 27th September. Duration 10 Weeks. Fee: €85.00. Contact Sinead at 087-2737577

**Social Dance & Fitness Classes** Diocesan Hall - St. Loman Street, Trim every Wednesday 8.30pm - 10.30pm. The Barbican, Drogheda every Friday 8pm - 10pm. Contact Marie on 086-3573271 or Michael on 087-2404119 www.peacockdance.ie

**CLEANING & MAINTENANCE**

**Septic Tanks**  
**Bicycles Empaired**  
**& Drain Cleaning**  
Permit Holder  
Tel: 086-8459027

**COMMERCIAL PROPERTY**

**Oldcraic, shop unit** to lease. Phone 087-9121265. Rent reasonable

**COUNSELLING**

**Computer Repairs**  
Computer Repair Shop on Railway Street, Navan, Opening Hours Mon-Fri, 8am-7.00pm. Saturday 11am - 6pm. Also Laptops and PC for sale new and refurbished, from €120. Advanced Technology for you. 046-9060418/085-752-22-22. Opposite motor tax office

**DRIVING SCHOOLS**

**AIRPORT**  
1800 82 99 99  
IRELAND'S MOST SUCCESSFUL DRIVING SCHOOL  
Tuition in Cars, Jeep & Trailer, Rigids, Artics, Coaches, Motor Bikes  
Forklift Training  
GIFT TOKENS AVAILABLE  
**1890 82 9999**  
Get your licence first time

**FOR HIRE**

**Diggers For Hire**  
From 3 Ton - 21 Ton  
Also Dumpers, Rock Breakers and Jaw Crusher.  
All grades of crushed stone.  
087-2582371  
087-9963690

**PETS**

**Last Hope Animal Charity CHY 17190**  
Join us for a Ramble in the Ramparts on Sunday 21st September at 2.30pm. All donations welcome on the day. Goody bags for the first ten people to register on the day.  
A.G.M Will take place on Friday 26th of September in The Newgrange Hotel, Navan at 8pm.  
See www.lasthope.ie

**PROFESSIONAL SERVICES**

**Piano Man**  
• Piano tuning and repair service.  
• Climate control units fitted.  
• New key covers supplied and fitted.  
• New & used pianos for sale.  
• Very keenly priced and delivered.  
• Stools supplied.  
Contact **046-9025310**  
**086-8283339**

**SITES & LAND**

**TILLAGE LAND WANTED**  
**LOUTH - MEATH - DUBLIN KILDARE AREAS**  
Any acreage. Rent/Lease Up Front Payments (can Reclaim)  
Phone **087-2578229**

**Site for Sale.** Serviced site for sale at Athboy. Contact 046-9435118

**Site Wanted.** Must be Dunsany, Kilmessan, Kiltalee area. Contact James 087-6549950

**TUITION/ EDUCATION**

**Piano lessons** available in your home from very experienced (18 years) teacher and RIAM examiner. Contact John 086-2019912 or 046-9091795.

**TURF & FIREWOOD**

**Large lorry loads** of turf for sale, screened and delivered. Phone 086-7236301.  
**Quality Black Hopper Turf** lorry loads €520 per load, seasoned split firewood lorry loads €496 per load, delivered or collected. Tel: 086-2799649

**To advertise in the Meath Chronicle**

Telephone **046-9079600**



**PUBLIC NOTICES**

**Teresa Daly (75).** Seeking Teresa Daly or relevant information. Aged 75. Moved to Birmingham area, England 1956. Please contact 0044 (0) 1740 652004 or francis.barnish@outlook.com

**PUBLIC NOTICES**

**APPLICATION TO MEATH COUNTY COUNCIL FOR A WASTE FACILITY PERMIT**

Notice is hereby given in accordance with Articles 7 and 8 of the Waste Management (Facility Permit and Registration) Regulations 2007 that Carbon From Tyres Ireland (CFTI) Limited with an address at 107 Ferndale, Navan, Co. Meath intends to apply for a Waste Facility Permit for the operation of a waste tyre recovery facility including using Thermolysis technology to recover carbon black, fuel oil and metal from waste tyres at premises located at Sites 1, 2 & 3, Eamon Duggan Industrial Estate, Athboy Road, Trim, Co. Meath. The application for a waste facility permit will be made to Meath County Council within 10 working days of the date of this notice.

The classes of activity, in accordance with the Fourth schedule of the waste Management Act 1996, to be carried out at the facility is/are as follows:

**Class (es) R3** (Principle Activity) Recycling/ Reclamation of organic substances which are not used as solvents (including composting and other biological transformation processes), which includes gasification and pyrolysis using the components as chemicals.

**Class (es) R11** Use of waste obtained from any of the components numbered R1 to R10.

**Class (es) R12** Exchange of waste for submission to any of the operations numbered R1 to R11 (if there is no other R code appropriate, this can include preliminary operations prior to recovery including pre-processing such as, amongst others, dismantling, sorting, crushing, compacting, pelleting, drying, shredding, conditioning, repackaging, separating, blending or mixing prior to submission to any of the operations numbered R1 to R11).

**Class (es) R13** Storage of waste pending any of the operations numbered R1 to R12 (excluding temporary storage [being preliminary storage according to the definition of 'collection' in section 5 (1)], pending collection, on the site where the waste is produced).

The Class of Activity in accordance with Part 1 of the Third Schedule of the Waste Management (Facility Permit and Registration) Regulations 2007, to be carried out at the facility is as follows:

**Class 10** The recovery of waste (not mentioned elsewhere in this part of the third schedule), other than hazardous waste or an activity specified in Category 5 of Annex 1 of Council Directive 96/61/EC, where, - (a) the annual intake does not exceed 50,000 tonnes, and (b) the maximum quantity of residual waste consigned from the facility for onward transport and submission to disposal at an authorised facility shall not exceed 15% of the annual intake.

A copy of the application for the waste facility permit will be available for inspection or purchase, as soon as is practicable after receipt by Meath County Council, at the principal offices of the Waste Management Section of Meath County Council, County Hall, Navan, Co. Meath.

Nevin Traynor,  
Traynor Environmental Ltd, Belturbet Business Park,  
Creeny, Belturbet, Co. Cavan | www.traynorenvironmental.com

**APPLICATION TO THE ENVIRONMENTAL PROTECTION AGENCY FOR A WASTE LICENCE**

Clashford Recovery Facility Ltd., Ring Commons, Balbriggan, County Dublin intend to apply to the Environmental Protection Agency for a waste licence for the continued operation of its existing waste recovery facility on lands at Naul, Naul Townland, Co. Meath (National Grid Reference 26154510). The nature of the development is the continued phased restoration of a sand and gravel pit using imported inert soils, stone, and recovery of inert construction and demolition waste. Up to circa 90,000 cubic metres per annum of inert materials is being accepted to site. The principal activity is Class R5 (recycling/reclamation of other inorganic materials, which includes soil cleaning resulting in recovery of the soil and recycling of inorganic construction materials) of the Fourth Schedule of the Waste Management Act 1996, as amended. Other activities include Class R13 of the Fourth Schedule (storage of waste pending any of the operations numbered R1 to R12). The waste licence application (W0262-01) was submitted on 13/02/2009. In accordance with Section 40 (2A)(C) of the Waste Management Acts (1996-2013), the Agency has assessed the information submitted and considers that the application must be made subject to an environmental impact assessment (EIA). An environmental impact statement will be submitted to the Agency with the application. A copy of the application for a waste licence, environmental impact statement and such further information relating to the application as may be furnished to the Agency in the course of the Agency's consideration of the application, will, as soon as practicable after receipt by the Agency, be available for inspection or purchase at the headquarters of the Agency.

**APPLICATION TO THE ENVIRONMENTAL PROTECTION AGENCY FOR A WASTE LICENCE**

Kierman Sand and Gravel Ltd, Foxtown Townland, Summerhill, County Meath intends to apply to the Environmental Protection Agency for a waste licence for the continued operation of a waste recovery facility on lands at Foxtown Townland, Summerhill, County Meath (National Grid Reference 285633E 253005N). The nature of the development is the continued phased restoration of a sand and gravel pit using imported inert soils, stone, and recovery of inert construction and demolition waste. Up to circa 40,000 cubic metres per annum of inert materials is being accepted to site. The principal activity is Class R5 (recycling/reclamation of other inorganic materials, which includes soil cleaning resulting in recovery of the soil and recycling of inorganic construction materials) of the Fourth Schedule of the Waste Management Act 1996, as amended. Other activities include Class R13 of the Fourth Schedule (storage of waste pending any of the operations numbered R1 to R12). The waste licence application (W0262-01) was submitted on 13/02/2009. In accordance with Section 40 (2A)(C) of the Waste Management Acts (1996-2013), the Agency has assessed the information submitted and considers that the application must be made subject to an environmental impact assessment (EIA). An environmental impact statement will be submitted to the Agency with the application. A copy of the application for a waste licence, environmental impact statement and such further information relating to the application as may be furnished to the Agency in the course of the Agency's consideration of the application, will, as soon as practicable after receipt by the Agency, be available for inspection or purchase at the headquarters of the Agency.

**BUILDING SERVICES**

**Celtic Surveys Ltd**  
We Sell, Service, Repair and Calibrate all types of survey instruments  
Shop online at: www.celticsurveys.ie  
Phone Sales at: 01-8011335  
Visit our Shop at Dunshaughlin Business Park

**D. Fitzsimons & Daughter**

**Sand & Gravel Supplies**  
**Top Soil, All grades of Washed Pebble, All types of road making materials, Crushed Filling, Site Clearance, Waste Collection Permit, Land Fill Facility, Truck & Plant Hire.**  
087-2246949/046-9060026

**McDermott**

• Plaster Mouldings  
• Coving - Centre Pieces  
• Arches etc  
**SPECIALIST FITTING**  
**087 2374828**

**PADRAIC GAUGHAN BUILDING CONTRACTOR**

New Houses, Extensions, Renovations, Groundwork, 30 years in business. Fully insured, keen rates. Member of Homebond & SEAL  
Tel: 046-9243957  
087-2450351

**CRUSHED FILLING**

**€90 PER LOAD**  
**NAVAN AREA**  
**CONTACT**  
**087-2246949**  
ALSO FINEST QUALITY TOP SOIL

**LEAKING ROOFS**

We Repair or Replace All Types Of Leaking Roofs Also House Renovations  
Ph. 086-3973234

Carpenter Available for 1st and 2nd fix, doors, floors, wardrobes etc. Tel: 086-3613561

Ceramic Tiling and Flooring, fitting services, floors, walls, mosaics, marble, porcelain, repairs, timberfloors, reasonable rates, free estimates. Phone 086-2759645

**Flat Roofs**  
Flat Roofs done to last. No felt Roofing Membrane, System Guaranteed  
Free quotations  
043-3329829 087-2791458

Painting, interior, exterior, sash window painting, roof power washing and painting, floor tiling. Fully insured, quality work. Free estimates. Tel: 085-1592942 victormavan@gmail.com

**CLASSES & COURSES**

**LEARNING STARTS HERE**  
AUTUMN INTAKE INCLUDES:  
• BA (Hons) Early Years  
• Montessori (Level 3)  
• Special Needs (Levels 3 & 4)  
• ECCE (Level 5)  
PROGRAMMES IN YOUR LOCAL AREA ENROLLING NOW  
(01) 892 0040  
www.portobelloinstitute.ie  
info@portobelloinstitute.ie  
OPEN DAY  
Wed 24th Sept 5-7pm  
Navan Education Centre, Navan

**Invitation to Eureka Secondary School, Kells Open Evening**  
Thursday 9th October 2014  
4.30pm to 6.30pm

Teaching Staff will be available to meet fifth and sixth class students and their parents. There will be an opportunity to view the educational facilities of the school followed by Principal's Address @ 6.15pm

Prospectus & Registration Forms available at Open Evening

For further information, telephone 046 9240132 or visit our website www.eurekasecondaryschool.ie

**SAFE PASS**  
SCURLOCKSTOWN, TRIM  
EVERY TUESDAY & SATURDAY €100  
ph: 086-8306852  
email: tomhkelly@yahoo.ie

Childrens Irish Dancing Classes, Navan Community Centre, 8th September and every Saturday thereafter. All ages welcome from 4yrs upwards 2-3pm. €5-per/pupil perclass. Under the direction of Linda McInerney T.C.R.G. Enquiries 086-1583811



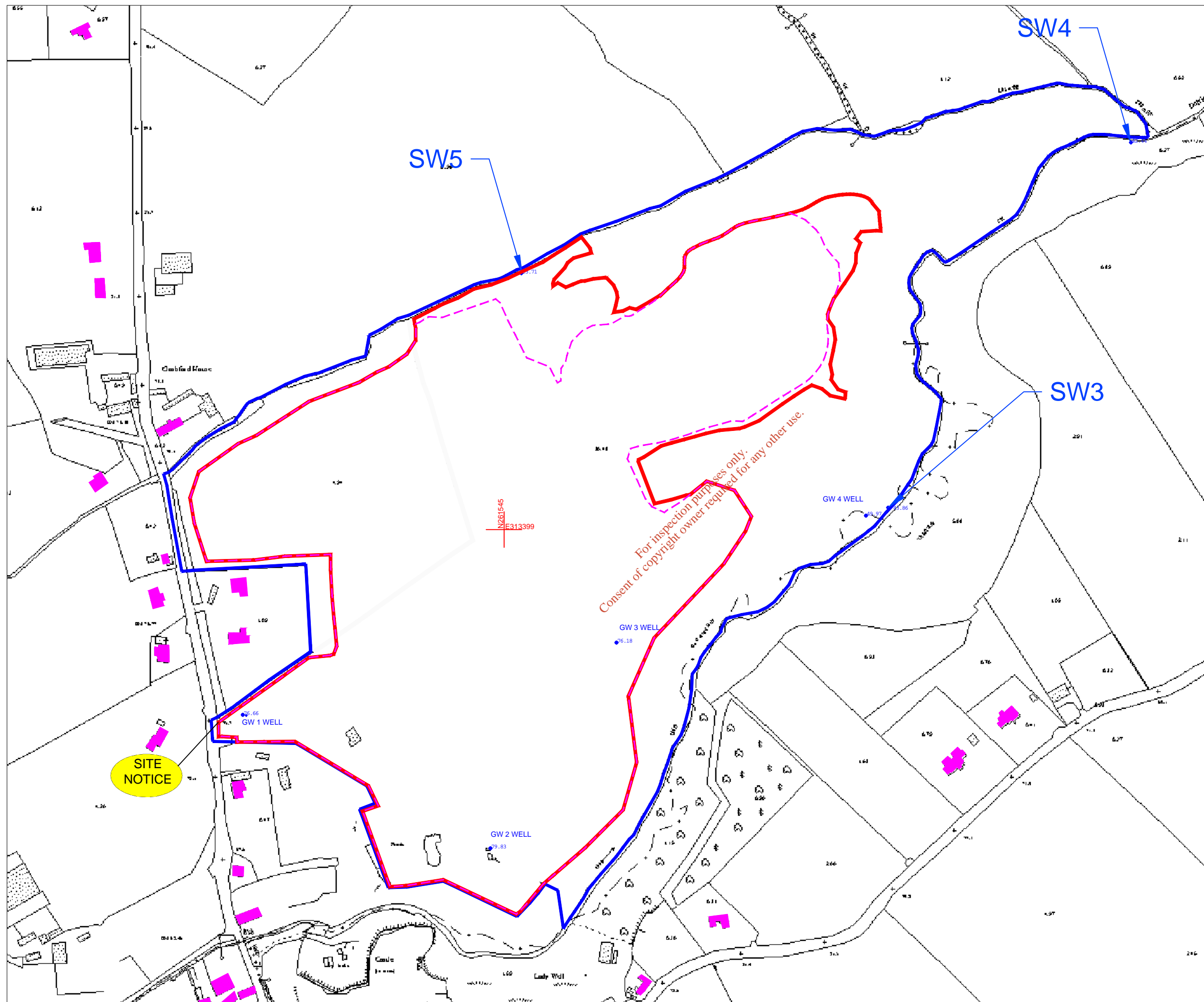

- Application Area(c.22.3 ha)
- 2009 Application Area (c. 20.8 ha)
- Applicants Ownership(c.33.4 ha)
- Residences
- SITE NOTICE

Ordnance Survey Ireland Licence No. AR 0071914  
 © Ordnance Survey Ireland and Government of Ireland  
 Digital Raster Extract Ordnance Survey Data 2500 mapping  
 OS Sheets 2649 - A & B, 2582 - C & D  
 NG Centre Point Coords X, Y = 313399, 261545

**Scale 1:3500**



31 Athlumney Castle,  
 Navan, Co Meath  
 Phone/Fax: 046 9073997  
 Mobile: John Sheils 087/ 273 0087  
 Email: john.sheils@jspe.ie

J SHEILS PLANNING & ENVIRONMENTAL LTD

CLIENT	<b>Clashford Recovery Facility Ltd</b>	
DRAWING	<b>SITE NOTICE LOCATION</b>	
LOCATION	<b>NAUL TOWNLAND Naul, Co. Meath.</b>	

Drawn by	<b>John Sheils</b>	Scale	<b>1 /3500</b>
Checked by	<b>John Sheils</b>	Job No.	<b>JSPE 173</b>
Date	<b>22/09/14</b>	Figure No.	<b>B 6.1</b>
		Rev.	<b>A</b>

For inspection purposes only.  
 Consent of copyright owner required for any other use.