

Enterprise House, Centre Park Road, Cork, Ireland.

Tel: 021-4314388 Fax: 021-4314369

E-mail: mescal@indigo.ie



mescaL &
associates

C O N S U L T I N G
E N V I R O N M E N T A L &
P O L L U T I O N C O N T R O L
E N G I N E E R S

Licensing Unit,
Office of Climate ,Licensing and Resource Use ,
Environmental protection Agency,
Headquarters,
PO Box 3000,
Johnstown Castle Estate,
Co Wexford.

08/04/2014

Dear Sirs

Re: W0251-01 - Mallow Contracts Ltd

In response to yours of 28/02/2014 , attached please find :

- Screening for Appropriate Assessment
(prepared by Mary O'Connor, Consultant Ecologist and Mescal & Associates)
- Non Technical Summary

The activity individually , or in combination with other plans or projects is not likely to have significant effect on European Sites in view of best scientific knowledge and conservation objective of the sites.

Faithfully Yours

Michael Mescal

-original ,copy + 2 CD ROMS

Screening for Appropriate Assessment - Mallow Contracts Ltd Project.

EPA Ref: W0266-01

Location	Lissard, Ballyhillloge, Mourneabbey, Co. Cork
Brief Description	<p>The site is located between the railway line and the N20 Cork/Limerick road. It has been in operation since 2007.</p> <p>The site consisted of marshy ground towards the roadway and slightly firmer ground toward the railway line. The marshy ground was very soft and waterlogged during winter months, with the summer months being slightly more passable. The principle benefit to be obtained in reclaiming this wet land is for agricultural uses.</p> <p>The site is located in the area where the Peastinagh River and the River Martin rise. The Peastinagh River rises and flows north from the site, approx. 1km downstream it joins the River Clyda which eventually joins the River Blackwater. The River Martin rises and flows south from the site eventually joining the River Bride.</p> <p>The project would be completed in 3 phases working from the north. Ground would be made good, topsoiled and grassed at the end of each phase. Each phase involves the following steps:</p> <ul style="list-style-type: none"> – Strip topsoil and store – Import material and then place, compacting in layers – On achievement of elevation clear any top stone – Allow to rest/consolidate – Re-spread topsoil over the surface and rake – Grassed at next suitable time of year – Available for normal agricultural use <p>Prior to filling across the channel the bed of the channel was open piped and stoned with a protective Terram on top to ensure no sediment/debris entered the channel.</p> <p>Two soil water containments were placed on the northern end of the site on the Peastinagh River and on the new constructed drainage ditch which links to the River Martin which runs south from the site. A bund was constructed at the southern end to ensure all run-off goes to the soiled water containment.</p> <p>The entrance at the north end of the site is equipped with a wheelwash and spray. This is for vehicles exiting the site to ensure cleanliness upon re-entering the public road.</p> <p>The site is compliant with all permit/license requirements. Permission was sought for from the Cork County Council Environmental Department, the ESB, Iarnród Éireann, and the Southern Regional Fisheries Boards, before sending applications to the EPA.</p>

Identify Natura 2000 site:	The only Natura 2000 site within a 15km radius from the site is the Blackwater cSAC 002170. See attached Map 1.
----------------------------	---

Stage 1 – Screening											
<p>Assess the likely impacts on the Natura site including;</p> <p>Reduction in the area of an Annex 1 habitat or the habitat area of an Annex II species within the Natura site;</p>	<p>The qualifying interests & conservation objectives for the site.</p> <p>The Blackwater River SAC Site Code 002170 comprises the Blackwater River and several of its major tributaries.</p> <p>The Blackwater River is one of the largest rivers in Ireland, draining a major part of Co. Cork and parts of Cos. Kerry, Limerick, Tipperary and Waterford. The site consists of most of the freshwater stretches of the system as well as the estuarine component at Youghal. Tidal influence extends almost to Cappoquin. The Blackwater rises in the east Kerry uplands where Namurian grits and shales build the low heather covered plateaux. In the lowlands in the Mallow district it passes over limestone and later cuts through ridges of old red sandstone to the south of Cappoquin. The main tributaries include the Rivers Lickey, Bride, Allow and Araglin. A wide range of habitats are included within the sites, the habitats for which the river system is protected are thus;</p> <p>Habitats</p> <ul style="list-style-type: none"> Estuaries [1130] Mudflats and sandflats not covered by seawater at low tide [1140] Perennial vegetation of stony banks [1220] Salicornia and other annuals colonizing mud and sand [1310] Atlantic salt meadows (<i>Glaucopuccinellietalia maritima</i>) [1330] Mediterranean salt meadows (<i>Juncetalia maritimi</i>) [1410] Water courses of plain to montane levels with the <i>Ranunculion fluitantis</i> and <i>Callitriche-Batrachion</i> vegetation [3260] Old sessile oak woods with <i>Ilex</i> and <i>Blechnum</i> in British Isles [91A0] Alluvial housings with <i>Alnus glutinosa</i> and <i>Fraxinus excelsior</i> (<i>Alno-Padion</i>, <i>Alnion incanae</i>, <i>Salicion albae</i>) [91E0] <i>Taxus baccata</i> woods of the British Isles [91J0] <p>Likely Impact</p> <p>The development site is located in the catchment of the the Peastinagh River and the River Martin at a remove of 15Km from the Blackwater River SA, the nearest Natura Site. The development has incorporated all best practise measures to limit any input of fines, oils or nutrients into the nearby watercourses, see detailed site description above. No habitat or species for which the SAC is directly impacted by the development, indirect impact has been adequately dealt with by the incorporation of design features to limit any potential run-off of fines, oils or nutrients into the nearby watercourses.</p> <table border="1" style="width: 100%; border-collapse: collapse;"> <thead> <tr> <th>Qualifying Interest</th> <th>Level of Protection</th> <th>Relevant</th> <th>Likelihood of Impact</th> <th>Cause of Impact</th> </tr> </thead> <tbody> <tr> <td>Alluvial wet woodland (code: 91E0)</td> <td>Habitats Directive Annex 1</td> <td>no</td> <td>none</td> <td>N/A</td> </tr> </tbody> </table>	Qualifying Interest	Level of Protection	Relevant	Likelihood of Impact	Cause of Impact	Alluvial wet woodland (code: 91E0)	Habitats Directive Annex 1	no	none	N/A
Qualifying Interest	Level of Protection	Relevant	Likelihood of Impact	Cause of Impact							
Alluvial wet woodland (code: 91E0)	Habitats Directive Annex 1	no	none	N/A							

	Priority			
Old sessile oak woods with Ilex and Blechnum in British Isles [91A0]	Habitats Directive Annex 1	no	none	N/A
Floating river vegetation (code: 3260)	Habitats Directive Annex 1	possible	Insignificant due to environmental design measures in the project to limit any run-off from development site	N/A
Estuary (code: 1130)	Habitats Directive Annex 1	no	none	N/A
Salicornia mudflats (code: 1310)	Habitats Directive Annex 1	no	none	N/A
Spartina swards (Spartinion maritimae) [1320]	Habitats Directive Annex 1	no	none	N/A
Mudflats and sandflats not covered by seawater at low tide [1140]	Habitats Directive Annex 1	no	none	N/A
Atlantic salt meadows (code: 1330)	Habitats Directive Annex 1	no	none	N/A
Mediterranean salt meadows (code: 1410)	Habitats Directive Annex 1	no	none	N/A
Killarney Fern (Trichomanes speciosum)	Habitats Directive Annex 2 and 4 and Flora protection Order 1999	no	none	N/A
Freshwater pearl mussel (Margaritifera margaritifera) [1029]	Habitats Directive Annex 2	No juvenile mussel beds occur within 10km downstream of site	Insignificant due to environmental design measures in the project to limit any run-off from development site	N/A

	White-clawed crayfish (Austropotamobius pallipes) [1092]	Habitats Directive Annex 2 and 5	no	none	N/A
	Sea lamprey (Petromyzon marinus) [1095]	Habitats Directive Annex 2	no	none	N/A
	Brook lamprey (Lampetra planeri) [1096]	Habitats Directive Annex 2	possible	Insignificant due to environmental design measures in the project to limit any run-off from development site	Potential run-off of fines
	River lamprey (Lampetra fluviatilis) [1099]	Habitats Directive Annex 2 and 5	no	none	N/A
	Allis shad (Alosa alosa) [1102]	Habitats Directive Annex 2 and 5	no	none	N/A
	Twaite shad (Alosa fallax fallax) [1103]	Habitats Directive Annex 2 and 5	no	none	N/A
	Salmon (Salmo salar) [1106]	Habitats Directive Annex 2 and 5	possible	Insignificant due to environmental design measures in the project to limit any run-off from development site	Potential run-off of fines
	Otter (Lutra lutra) [1355]	Habitats Directive Annex 4	no	no	N/A
Damage to the physical quality of the environment in a Natura Site, e.g. eutrophication of water, soil compaction;	<p>No contaminated surface water runs off the site into either the Peastinagh River or the River Martin. This has been ensured by the Soil Water Containment Measures which prevent soiled runoff going to the rivers..</p> <p>The EPA has no data (Q-values, chemical or biological) on the Peastinagh River. The Peastinagh is approx 3km long, joining the River Clyda at EPA St. Jordan's Bridge. This is the beginning of the Blackwater cSAC.</p>				

	<p>The EPA has no chemical or biological data on the Clyda River. The most recent EPA water quality sampling data from May 2012, indicates that the Clyda River shows a high (Q=4-5, 5) ecological conditions downstream of the Lissard site, at Jordan's Bridge. This high status is continued downstream until EPA St. Clyda Bridge Upper where the water quality drops to moderate (Q=3-4). The Clyda River is at a good (Q=4) status when it joins the Blackwater River.</p> <p>The most recent EPA water quality sampling data from June 2011, indicates that the River Martin shows a good (Q=4) ecological condition downstream of the Lissard site, at Bridge W. of Lissavoura. The River Martin fluctuates between a good and high status throughout its duration downstream upon joining the Shournagh River, approx. 0.5km downstream of Bawnafinny Bridge.</p> <p>The physical quality of the environment of the Natura Site is not impacted</p>
<p>Serious or ongoing disturbance to those species of habitats for which the Natura site has been designated, e.g. increased noise, human activity;</p>	<p>None</p>
<p>Direct or indirect damage to the size, characteristics or reproductive ability of populations in the Natura site;</p>	<p>None</p>
<p>Interference with mitigation measure put in place for other plans or projects;</p>	<p>None</p>
<p>Cumulative or 'in combination' effects, when combined with other plans and projects</p>	<p>None</p>
<p>Screening Statement; assess whether or not there is a possibility of the project, individually or in combination with other plans</p>	<p>The site is located within a rural area of north cork which is for the most part zoned agricultural. Farming activities can of course leads to potential run-off of silt and fertiliers into local watercourses.</p> <p>However, stringent Environmental design feature measures were incorporated into this project, to avoid the risk of any potential significant run-off which may impact the downstream European Site.</p>

For inspection purposes only.
Consent of copyright owner required for any other use.

and projects, having a significant impact on the Natura Site.	It is therefore very improbable that this project will cause a significant impact to the downstream Natura Site either by itself or in combination with other local activities.
Conclusion	In summary it is adjudged that as a result of the stringent design features incorporated into this project that no significant impact will accrue to the Blackwater River SAC Site Code 002170 individually or in combination with other plans and projects in this area.

*For inspection purposes only.
Consent of copyright owner required for any other use.*

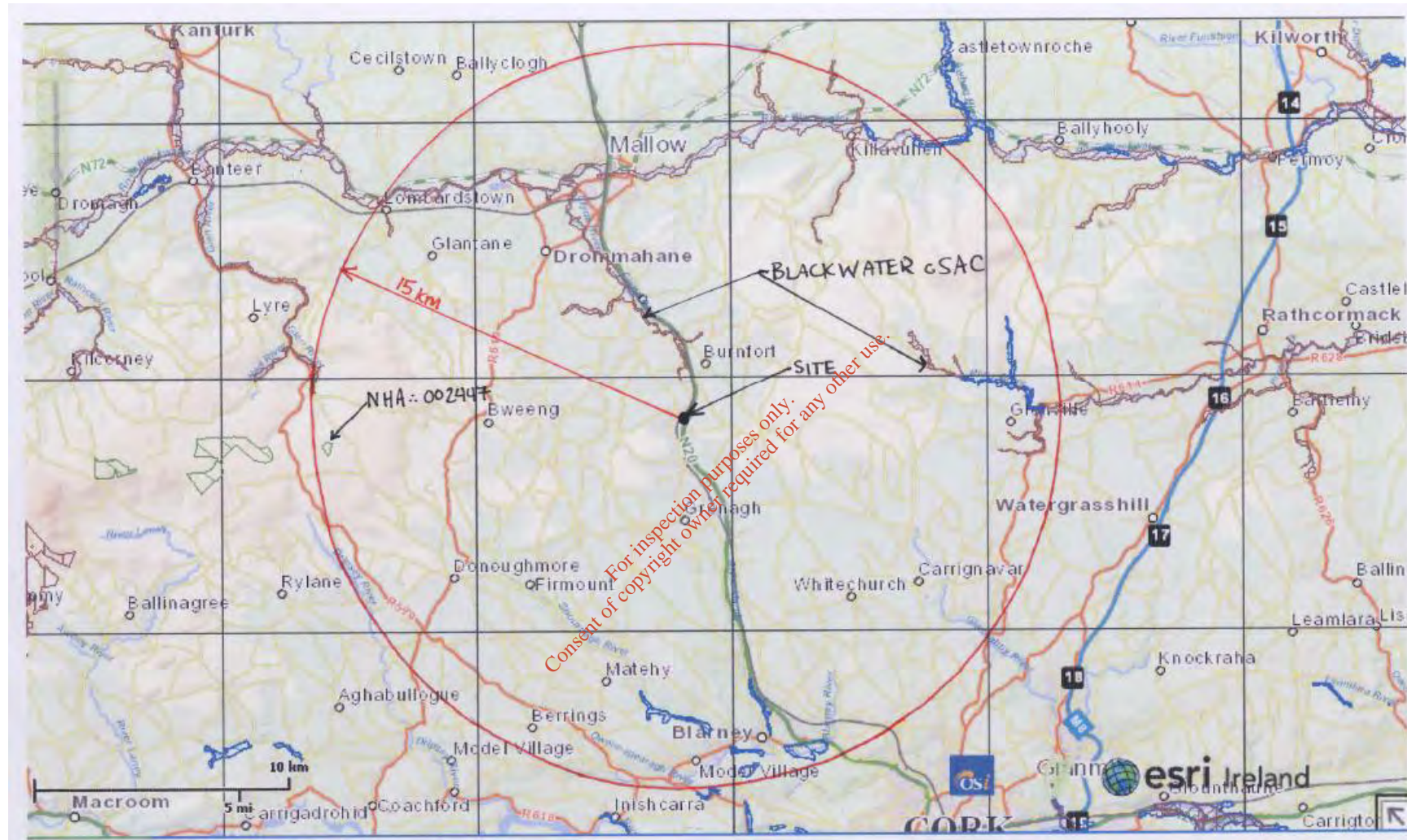

The only Natura Site within the 15km radius of the site is the Blackwater SAC 002170. It is noted that one Natural Heritage Area marked in Green (Boggeragh Mts – 002447) and several Proposed Natural Heritage Areas marked in Blue are within the 15km, but are not included in the Appropriate Assessment screening.

W0251-01 – MALLOW CONTRACTS LTD

NON-TECHNICAL SUMMARY

For inspection purposes only.
Consent of copyright owner required for any other use.

NON-TECHNICAL SUMMARY

DESCRIPTION OF PROJECT

The site is 2.8 hectares and was 70% marshy unproductive land, 30% grassland. It is alongside the N20 main Cork/Mallow Road and is accessed from the county road to Mourneabbey. The impacts are summarized on the attached chart. It is located in a narrow strip of land between the N20 and the railway line.

The project is to bring material from building and development activity in the region onto the site, to raise the level and make it usable for agriculture.

The works were granted planning permission in 2007 and commenced in the same year. Currently, it is approximately 60% completed.

The work takes place in 3 sections. Initially the northern section is done to completion, followed successively by the middle section and finally the southern section.

Each section is carried out as follows:

- strip topsoil
- introduce fill in layers
- clear out stone
- reintroduce topsoil
- fine rake
- grass seed

The channel running through the site is maintained by an open joint piping in part and large stone fill in the remainder. Both are covered with a layer of material allowing drainage through and stopping soil from dropping down into the channel.

Throughout the works interceptors are constructed and maintained to intercept any soil in the runoff from going into the rivers. The Peastinagh River flows north and the River Martin flows south from the site. The quality and flow in these rivers is not impacted by the project.

Trucks exiting the site are put through a wheelwash and cleaned prior to entering the public road.

The site was selected because of its location between Cork and Mallow. It was an accessible site and it offered significant agricultural improvement to it.

For inspection purposes only.
Consent of copyright owner required for any other use.

EXISTING ENVIRONMENT

The area is agricultural. The site is bound by the N20 Cork/Mallow Road and by the railway line. There are few dwellings in the vicinity.

The original ground was largely unproductive marshy land and the remaining strip near the railway side was rough grassland which was used very little.

The River Blackwater and its tributary the River Clyda are the only Natura Sites within a 15km radius. The River Clyda takes in the Peastinagh River some 3km north of the site. The River Peastinagh rises in the vicinity of the site.

IMPACTS

The main impacts are of moderate significance:

The project improves the agricultural use of a small area of land and it changes its appearance. It was originally low lying unproductive marshy land.

The earthworks are being carried out over a long period in full view of the N20 main Cork/Mallow Road and in full view of a number of fairly distant residential holdings.

Due to the downturn in the general construction industry the material was not available to meet the initial schedule. The work was initially to be completed over 3 years. It is now in its 7th year and is over 60% complete.

Visually the overall site on completion will look similar to the attached picture of the completed portion. The access shown on the access road picture will remain.

There are no significant impacts from the project.

Attachments:

- Site Location
- Rural Place Map
- Phased Filling
- Completed Part Photograph
- Access Road Photograph



Site Location Map

Scale 1:250,000

For inspection purposes only. Consent of copyright owner required for any other use.

Surveyed 1842
 Revised 1932-1933
 Levelled 1933

Rural PLACE Map

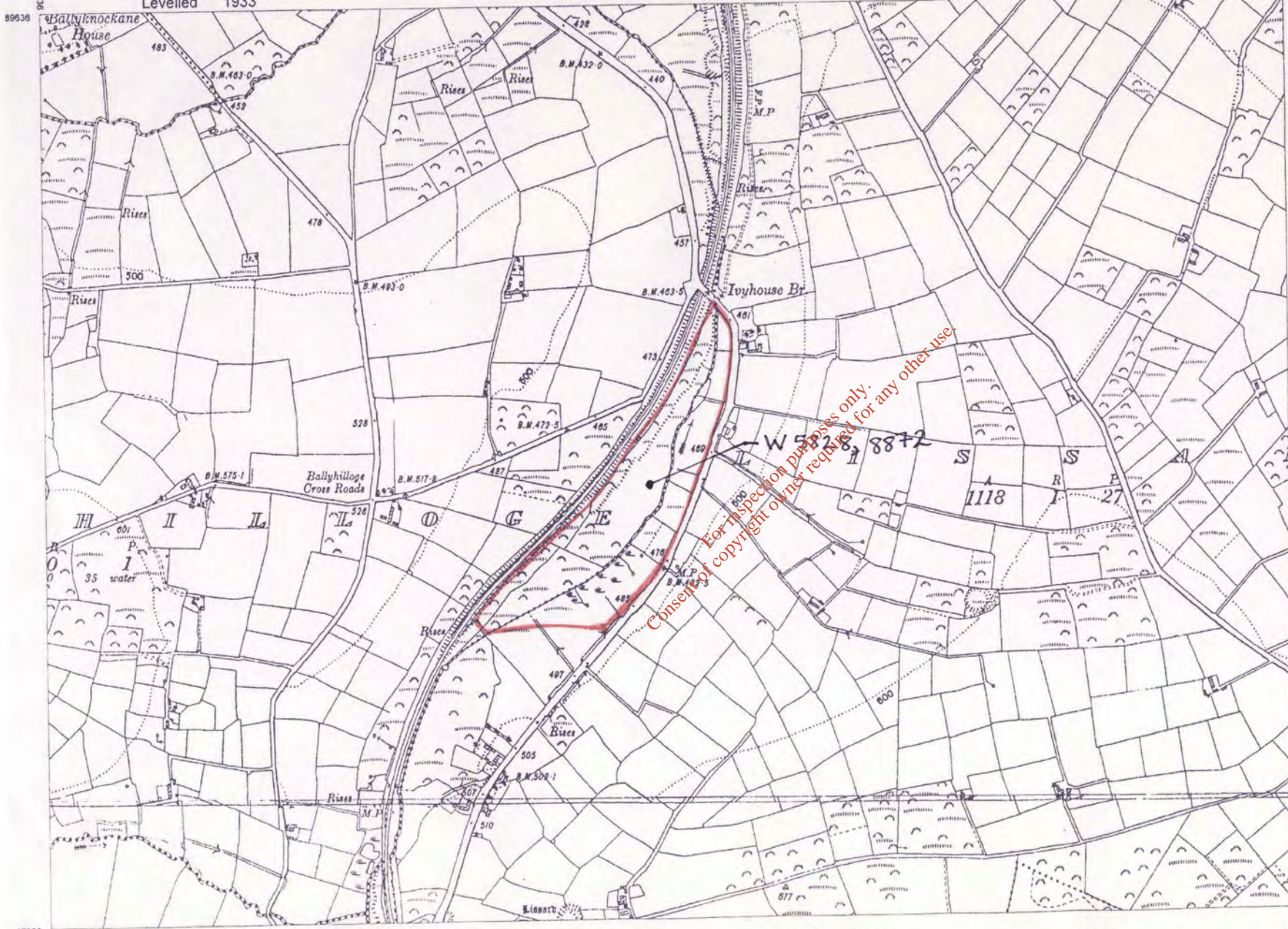

ITM CENTRE PT. COORDS
 558326,588787

DESCRIPTION

MAP SHEETS

6 inch
 CK042 CK051



Produced by National Map Services,
 The Court House Chambers,
 27/29 Washington Street,
 Cork City, Co. Cork
 On behalf of Ordnance Survey Ireland,
 Phoenix Park, Dublin 8.

Sáralonn atáirgeadh neamhúdaraithe cóipcheat Shuirbhíreacht Ordánáis Éireann agus Rialtas na hÉireann.
 Unauthorised reproduction infringes Ordnance Survey Ireland and Government of Ireland copyright.

Gach cead cosnaimh. Ní ceadmhach aon chuid den fhóilseachán seo a chóipeáil, a atáirgeadh nó a tharchur in aon fhóirm ná ar aon bhealach gan cead i scríobhinn roimh ré ó úinéir an chóipchirt. All rights reserved. No part of this publication may be copied, reproduced or transmitted in any form or by any means without the prior written permission of the copyright owners.

© Suirbhíreacht Ordánáis Éireann, 2006
 © Ordnance Survey Ireland, 2006

For inspection purposes only.
 Consent of copyright owner required for any other use.

W 528 8872
 S A S A
 1118 R P 27

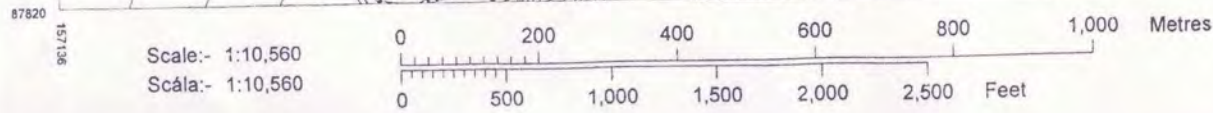

Plot Ref. No. 1143958_1_1
 Plot Date 07-SEP-2006



CONSTRUCTION OF ROAD AT LARGEST POINT TO BE COMPLETED IN ADVANCE OF PERMITTING OF FILLING AND CONSTRUCTION OF CHANNEL. ROAD TO BE CONSTRUCTED AT ORIGINAL ELEVATION WITH ORIGINAL ANCHORS. LEVELS INDICATED ARE CORRECT.

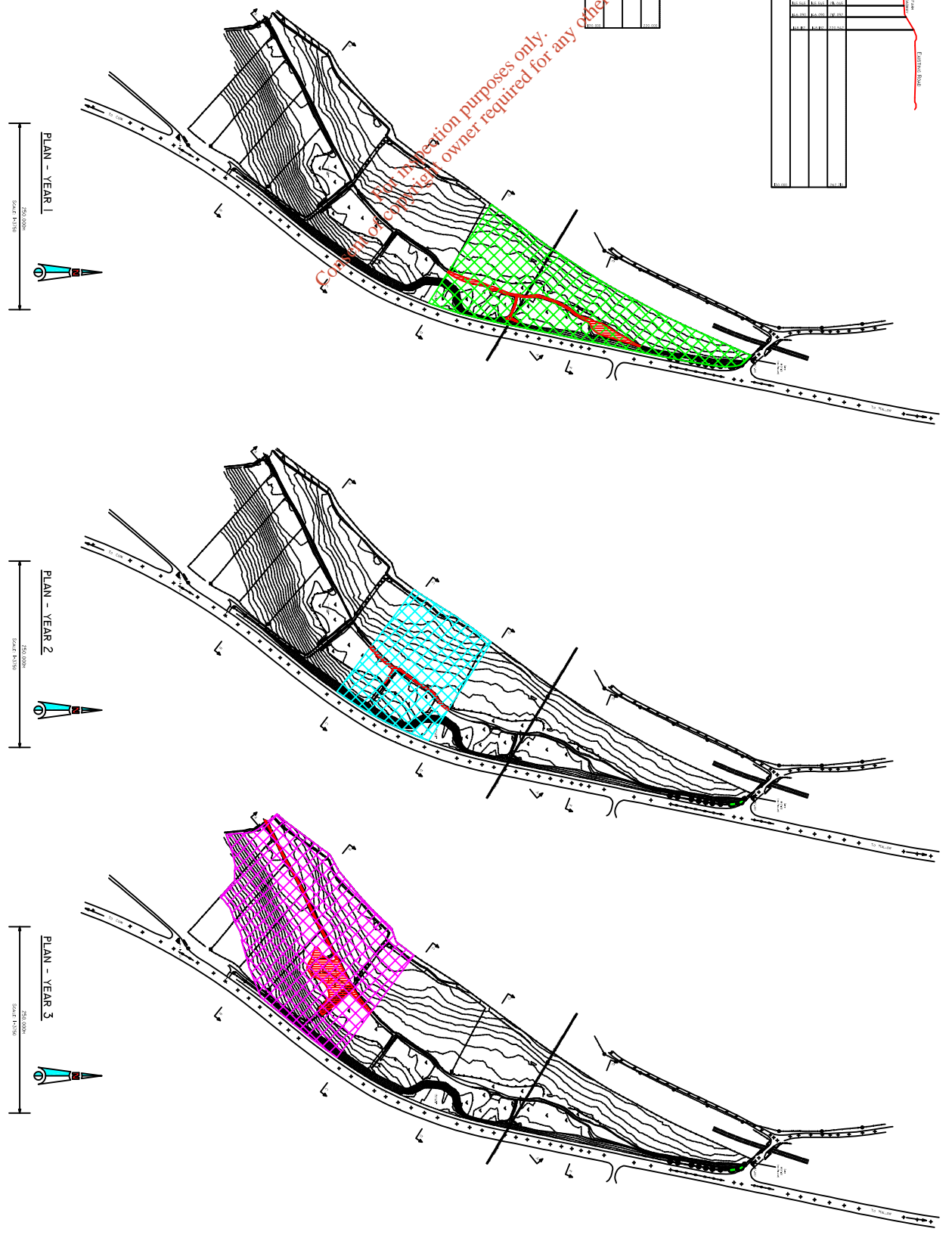
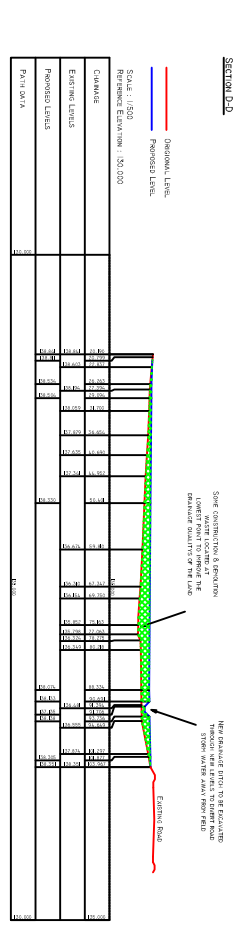
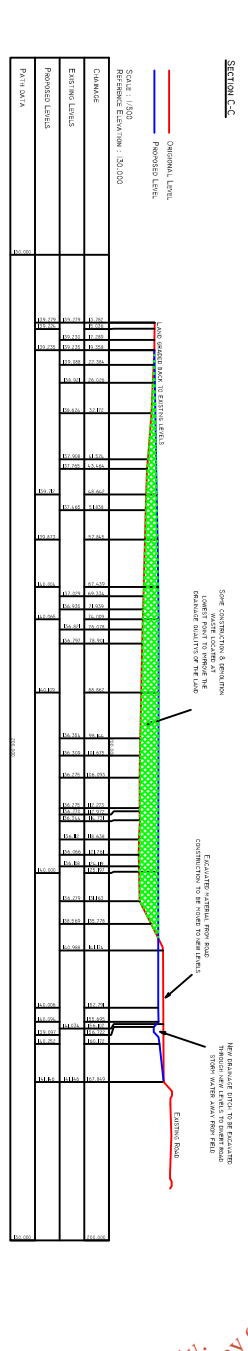
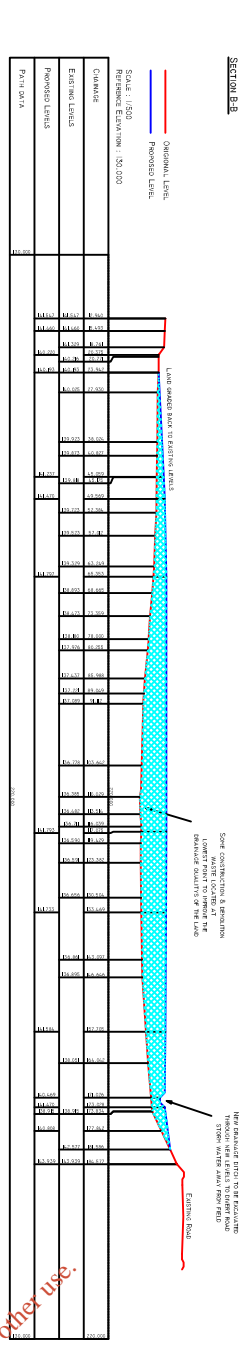
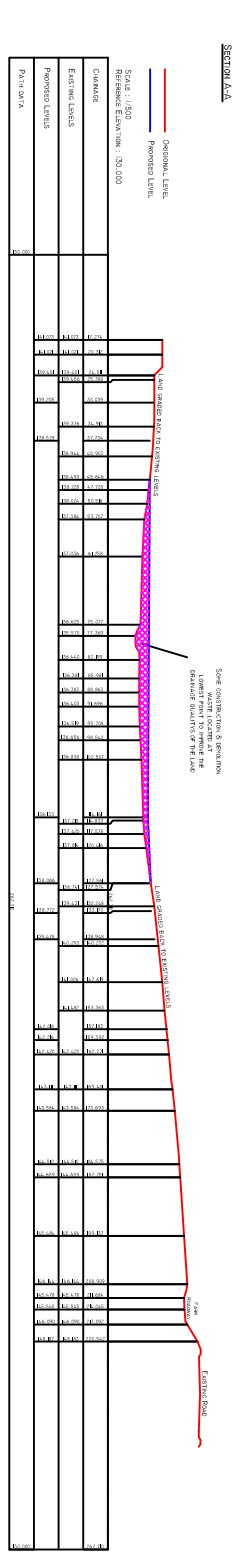
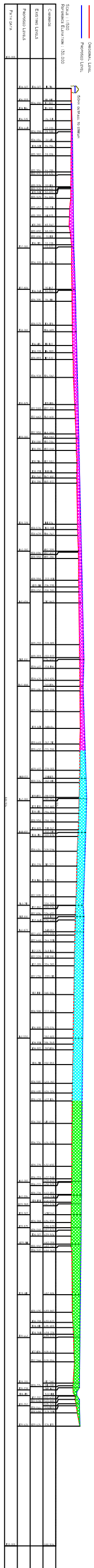

- YEAR ONE - APPX. 37,000 M³
- YEAR TWO - APPX. 37,000 M³
- YEAR THREE - APPX. 37,000 M³
- C & D CHANNEL WORK

NOTE :- EXISTING TOPSOIL STRIPPED IN ADVANCE OF FILLING AND REPLACED AFTER CONSOLIDATION OF FILL AT NEW ELEVATION

1	FOR PRC APPLICATION	12/01/06
0	INITIAL ISSUE	16/10/06
NO	REVISION	

client	MALLOWS CONTRACTS LTD.
project	APPLICATION FOR WASTE MANAGEMENT PERMIT
drawing	ANNUAL WORK SCHEDULE OUTLINE

date	12/01/06
scale	AS SHOWN
job no	
date	OCTOBER 2006
job no	
date	
job no	
date	
job no	

m **mesccal & associates**
 CONSULTING ENGINEERS
 Enterprise House,
 Centre Park Road, Cork, Ireland.
 Tel: 021-4314388
 Fax: 021-4314395



Completed Part Photograph

Consent of copyright owner required for any other use.



Access Road Photograph

For inspection purposes only.
Consent of copyright owner required for any other use.