

# T.J. LENNON QUARRIES LTD.

## TALLAGHT SOIL & STONE RECOVERY FACILITY

### APPLICATION FOR TECHNICAL REVIEW OF WASTE LICENCE W0256-01

DRAWINGS  
AUGUST 2012



LENNON QUARRIES LTD.

WASTE LICENCE REVIEW APPLICATION DRAWINGS

DWG. NO. ....	DWG. TITLE .....	DWG. NO. ....	DWG. TITLE .....
2084-2600	INDEX SHEET	2084-2611	CROSS SECTION E-E
2084-2601	SITE LOCATION MAP 1	2084-2612	EXISTING & PROPOSED SITE INFRASTRUCTURE (AS BUILT)
2084-2602	SITE LOCATION MAP 2	2084-2613	EMISSION POINTS
2084-2603	SITE OWNERSHIP MAP	2084-2614	SURFACE WATER DRAINAGE SYSTEM INCLUDING TREATMENT / ABATEMENT SYSTEM (AS BUILT)
2084-2604	SITE LAYOUT PLAN	2084-2615	PHASING SEQUENCE FOR DEPOSITION
2084-2605	SERVICES PLAN		
2084-2606	LOCATION OF SITE NOTICE		
2084-2607	ENVIRONMENTAL MONITORING LOCATIONS		
2084-2608	TOPOGRAPHIC MAP OF SITE - DECEMBER 2008		
2084-2609	TOPOGRAPHIC MAP OF APPLICATION SITE SHOWING FINAL GROUND LEVELS		
2084-2610	CROSS SECTIONS A-A & B-B		
	CROSS SECTIONS C-C & D-D		

For inspection purposes only.  
 Consent of copyright owner required for any other use.





LEGEND

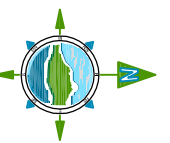

WASTE LICENCE  
 REVIEW  
 APPLICATION  
 SITE BOUNDARY

NOTES

1. FIGURED DIMENSIONS ONLY TO BE TAKEN FROM THIS DRAWING
2. ALL DRAWINGS TO BE CHECKED BY THE CONTRACTOR ON SITE
3. ENGINEER TO BE INFORMED BY THE CONTRACTOR OF ANY DISCREPANCIES BEFORE ANY WORK COMMENCES
4. ALL LEVELS SHOWN RELATE TO ORDNANCE SURVEY DATUM AT MALIN HEAD

Rev	Date	Description	By	CHKD
A	27/07/09	FIRST ISSUE	R.K.	E.S.
B	16/08/12	REVIEW	R.K.	O.M.

Client: **LENNON QUARRIES LTD.**

Project: **WASTE LICENCE REVIEW APPLICATION**

Title: **SITE LOCATION MAP 1**

Scale @ A3: **1 : 20,000**

Prepared by: **R.K.**      Checked: **E.S.**      Date: **17/12/08**

Project Director: **MICHAEL F. GARRICK**

**TOBIN**  
 Consulting Engineers,  
 Market Square, Castlebar,  
 Co. Mayo, Ireland, B97 1A1  
 Tel: +353-(0)94-207153  
 Fax: +353-(0)94-207154  
 e-mail: castbar@tobin.ie  
 www.tobin.ie

Drawing No: **2084-2600**      Revision: **B**



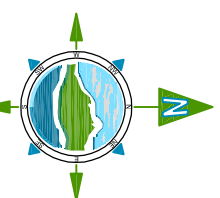

- LEGEND**
- WASTE LICENCE REVIEW APPLICATION SITE BOUNDARY
  - RIVER
  - OPEN DRAIN
  - OVERHEAD EIRCOM LINE
  - OVERHEAD ESB LINE
  - 225mm WATERMAIN

- NOTES**
1. FIGURED DIMENSIONS ONLY TO BE TAKEN FROM THIS DRAWING
  2. ALL DRAWINGS TO BE CHECKED BY THE CONTRACTOR ON SITE
  3. ENGINEER TO BE INFORMED BY THE CONTRACTOR OF ANY DISCREPANCIES BEFORE ANY WORK COMMENCES
  4. ALL LEVELS SHOWN RELATE TO ORDNANCE SURVEY DATUM AT MALIN HEAD

Rev	Date	Description	By	CHK'd
B	16/08/12	REVIEW APPLICATION	R.K.	O.M.
A	27/07/09	FIRST ISSUE	R.K.	E.S.

Client: **LENNON QUARRIES LTD.**

Project: **WASTE LICENCE REVIEW APPLICATION**

Title: **SITE LOCATION MAP 2**

Scale @ A3: **1 : 7,500**

Prepared by: **E.S.**      Checked: **17/12/08**      Date:

R.K.      M.F.G.

Project Director: **M.F.G.**

**TORIN**  
 Torin Consulting Engineers,  
 Market Square, Castlebar,  
 Co. Mayo  
 Tel: +353 (0)184 8071401  
 Fax: +353 (0)184 8071534  
 e-mail: castlbar@torin.ie  
 www.torin.ie

Drawing No: **2084-2601**      Revision: **B**

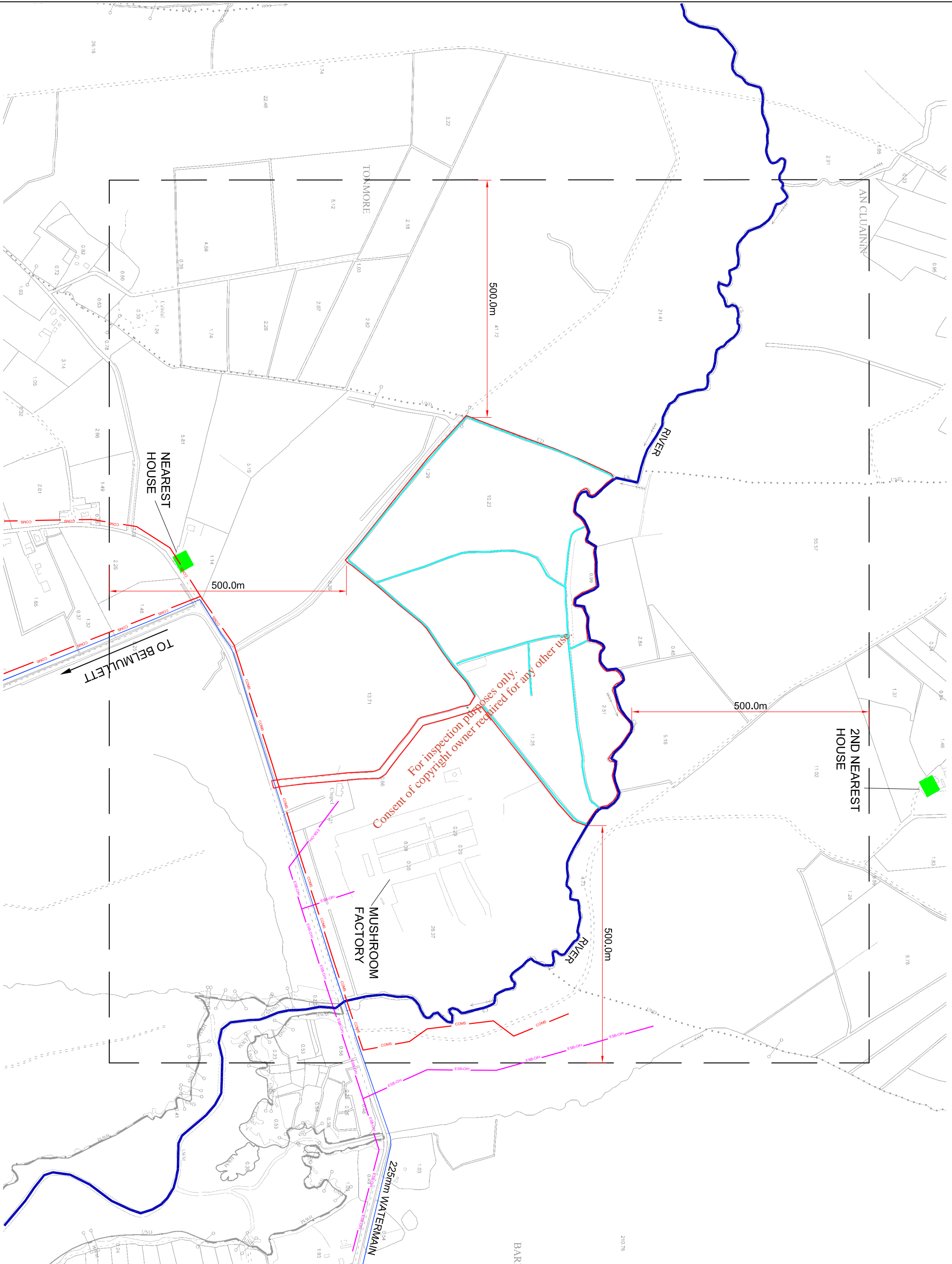

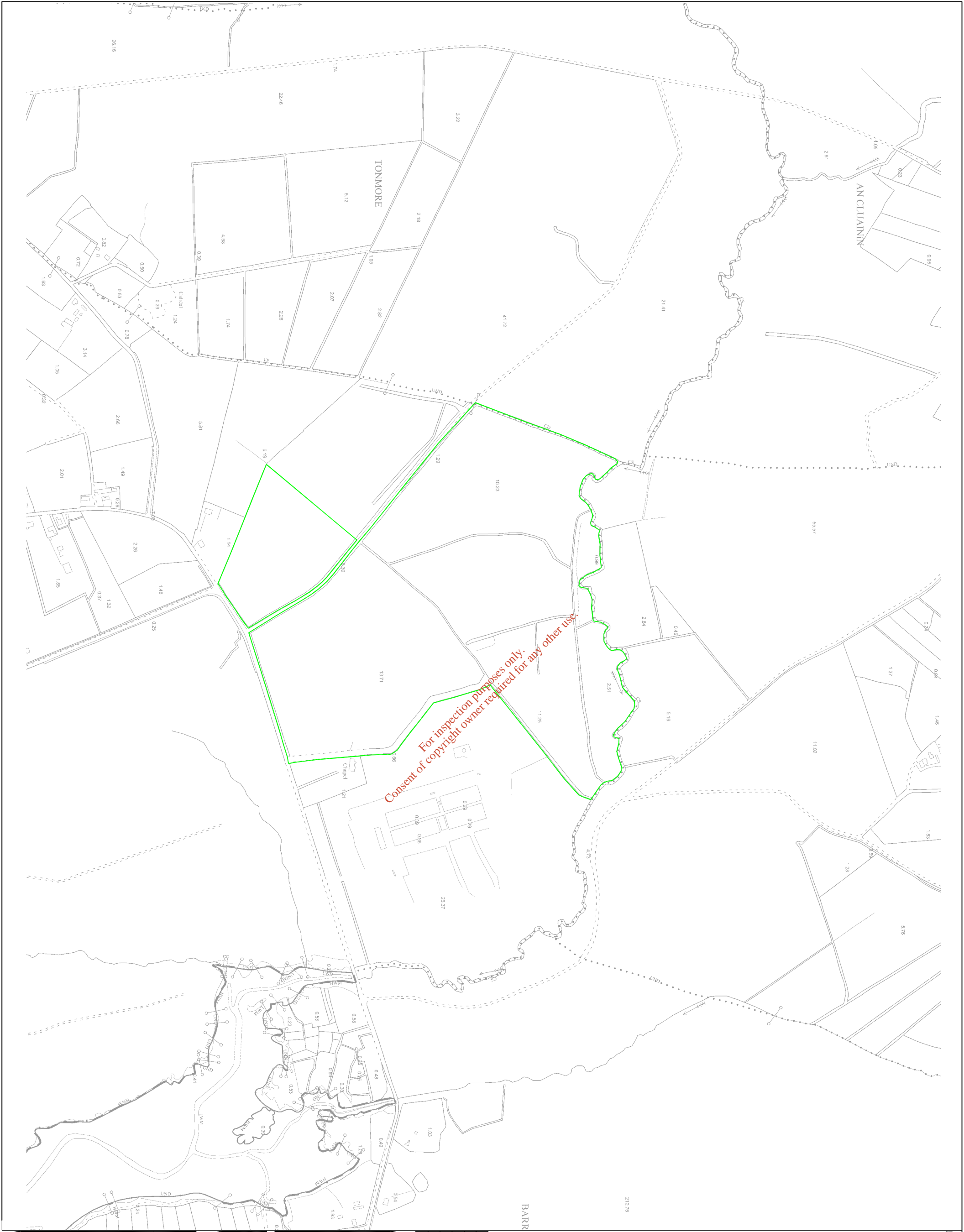

LEGEND

EXTENT OF LAND OWNERSHIP

NOTES

1. FIGURED DIMENSIONS ONLY TO BE TAKEN FROM THIS DRAWING
2. ALL DRAWINGS TO BE CHECKED BY THE CONTRACTOR ON SITE
3. ENGINEER TO BE INFORMED BY THE CONTRACTOR OF ANY DISCREPANCIES BEFORE ANY WORK COMMENCES
4. ALL LEVELS SHOWN RELATE TO ORDNANCE SURVEY DATUM AT MALIN HEAD

Row	Date	Description	By	CHK'd
C	18.08.12	REVIEW APPLICATION	R.K.	O.A.H.
B	02.11.11	BOUNDARY ALTERED	R.K.	E.S.
A	27.07.09	FIRST ISSUE	R.K.	E.S.

Client: **LENNON QUARRIES LTD.**

Project: **WASTE LICENCE REVIEW APPLICATION**

Title: **SITE OWNERSHIP MAP**

Scale @ A3: **1 : 7,500**

Prepared by: **E.S.** Date: **22.12.08**

Checked: **E.S.**

Project Director: **M.F.G.**

**TOBIN**  
Partners At Work

TOBIN Consulting Engineers,  
Market Square, Castlebar,  
Co. Mayo, Ireland. B94 0071401  
Tel: +353-(0)1845-8071401  
Fax: +353-(0)184-8071534  
e-mail: castlbar@tobin.ie  
www.tobin.ie

Drawing No: **2084-2602**

Revision: **C**

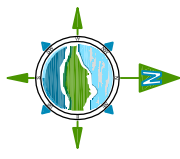

WASTE LICENCE  
REVIEW APPLICATION  
SITE BOUNDARY  
= 27.22 ha

BUFFER ZONE  
= 4.46 ha

AREA OF  
DEPOSITION  
= 20.48 ha

NOTES

1. FIGURED DIMENSIONS ONLY TO BE TAKEN FROM THIS DRAWING
2. ALL DRAWINGS TO BE CHECKED BY THE CONTRACTOR ON SITE
3. ENGINEER TO BE INFORMED BY THE CONTRACTOR OF ANY DISCREPANCIES BEFORE ANY WORK COMMENCES
4. ALL LEVELS SHOWN RELATE TO ORDNANCE SURVEY DATUM AT MALIN HEAD

Rev	Date	Description	By	CHK'd
C	18.08.12	REVIEW APPLICATION	R.K.	O.A.H.
B	15.04.10	LEVELS ALTERED	R.K.	E.S.
A	27.07.09	FIRST ISSUE	R.K.	E.S.

Client: **LENNON QUARRIES LTD.**

Project: **WASTE LICENCE REVIEW APPLICATION**

Title: **SITE LAYOUT PLAN**

Scale @ A3: **1 : 7,500**

Prepared by: **E.S.** Date: **22.12.08**

Checked: **M.F.G.**

Project Director: **M.F.G.**

**TORIN**  
Patrick J. Torin & Co. Ltd.  
TORIN Consulting Engineers,  
Market Square, Castlebar,  
Co. Mayo  
Tel: +353 (0)1854 8071401  
Fax: +353 (0)184 8071534  
e-mail: castlbar@torin.ie  
www.torin.ie

Drawing No: **2084-2603**

Revision: **C**

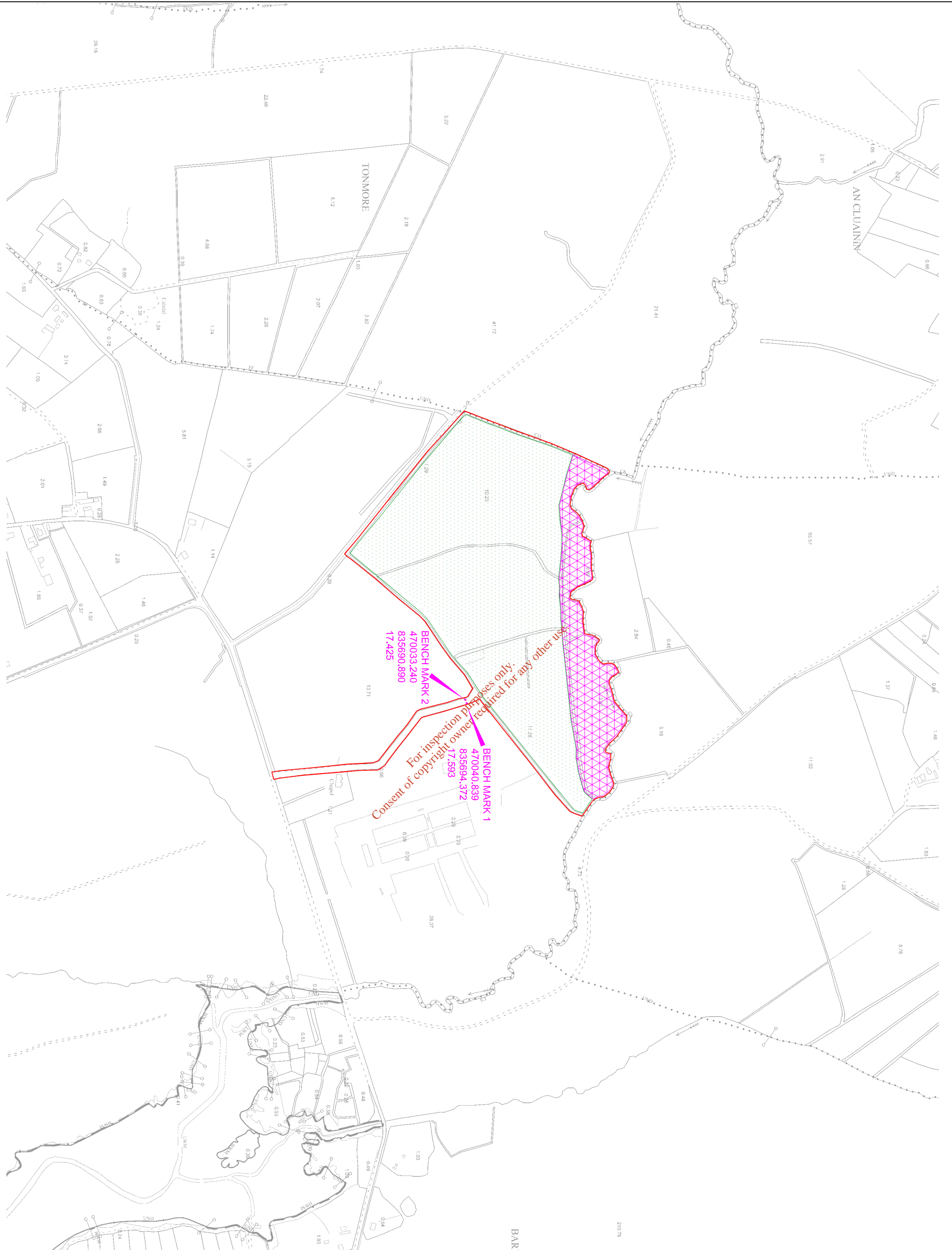



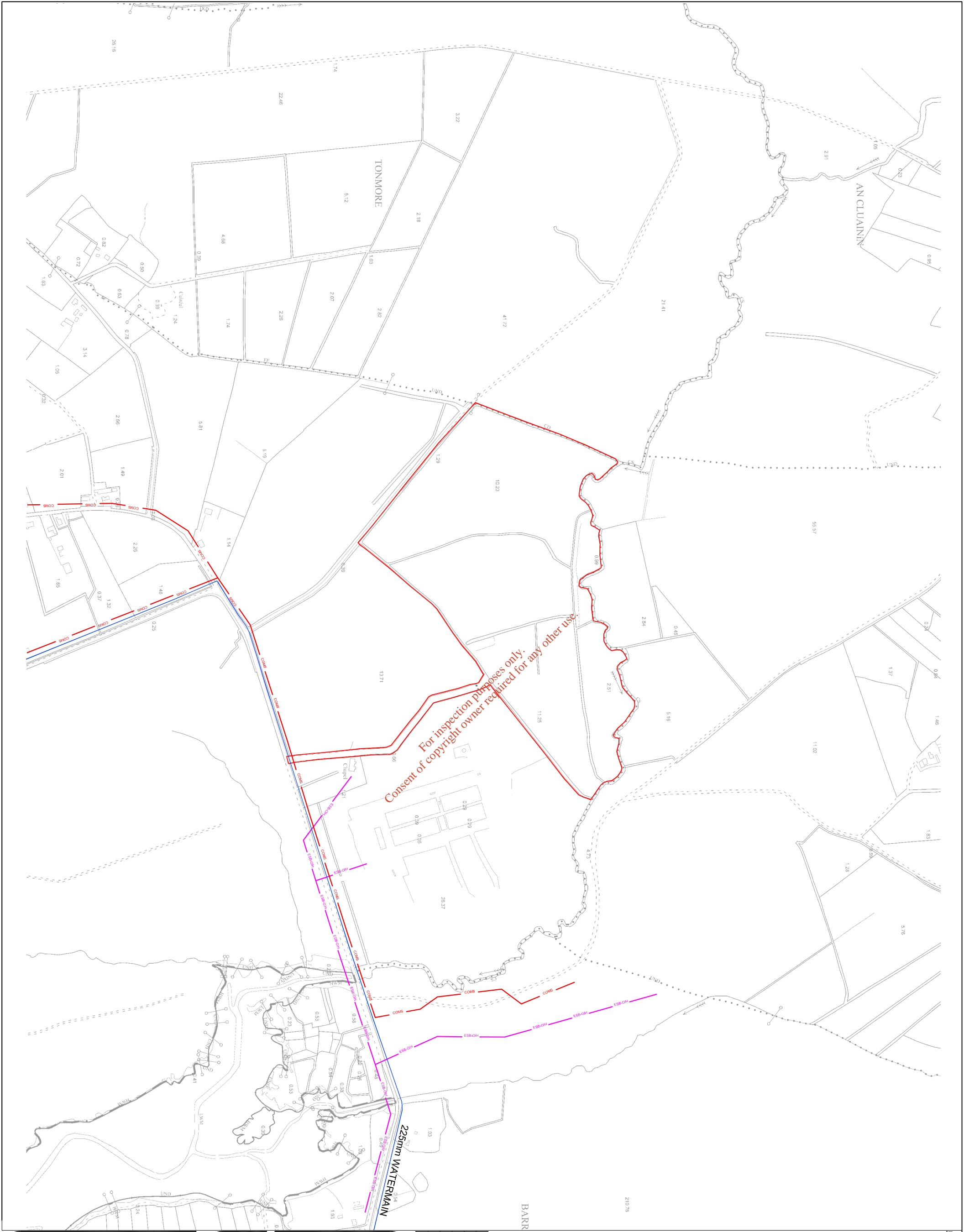

LEGEND

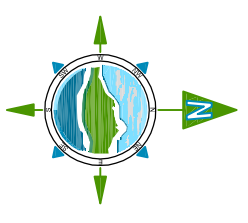

- WASTE LICENCE SITE BOUNDARY
- OVERHEAD EIRCOM LINE
- OVERHEAD ESB LINE
- 225mm WATERMAIN

NOTES

1. FIGURED DIMENSIONS ONLY TO BE TAKEN FROM THIS DRAWING
2. ALL DRAWINGS TO BE CHECKED BY THE CONTRACTOR ON SITE
3. ENGINEER TO BE INFORMED BY THE CONTRACTOR OF ANY DISCREPANCIES BEFORE ANY WORK COMMENCES
4. ALL LEVELS SHOWN RELATE TO ORDNANCE SURVEY DATUM AT MALIN HEAD

Rev	Date	Description	By	CHK'd
B	16.08.12	REVIEW APPLICATION	R.K.	O.M.
A	27.07.09	FIRST ISSUE	R.K.	E.S.

Client: **LENNON QUARRIES LTD.**

Project: **WASTE LICENCE REVIEW APPLICATION**

Title: **SERVICES PLAN**

Scale @ A3: **1 : 7,500**

Prepared by: **E.S.** Date: **22.12.08**

Checked: **E.S.**

Project Director: **M.F.G.**

**TOBIN**  
 Patrick J. Tobin & Co. Ltd.  
 Tobin Consulting Engineers,  
 Market Square, Castlebar,  
 Co. Kerry  
 Tel: +353 (0)1854 8071401  
 Fax: +353 (0)184 8071534  
 e-mail: castlbar@btbn.ie  
 www.tobin.ie

Drawing No: **2084-2604** Revision: **B**

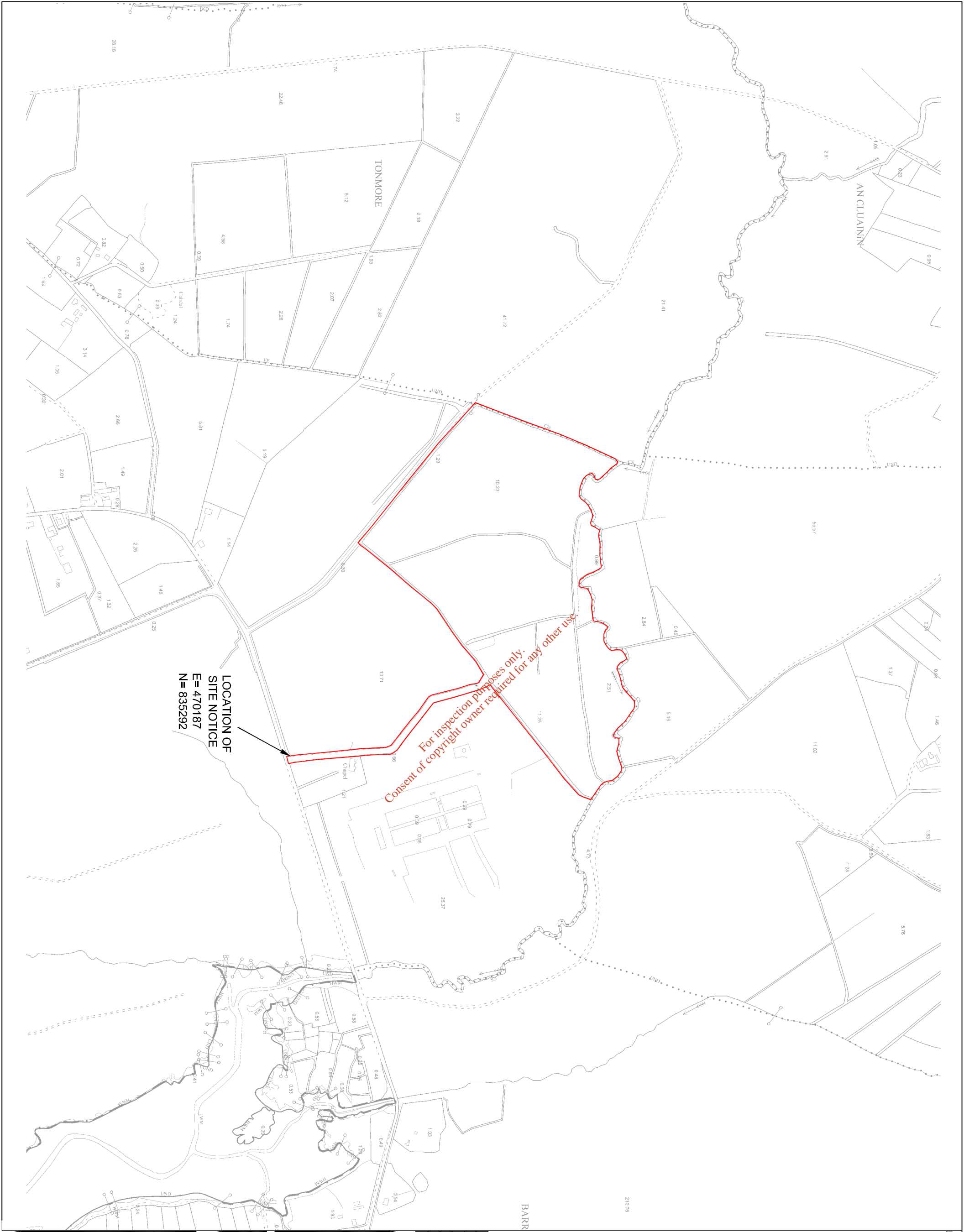

LEGEND

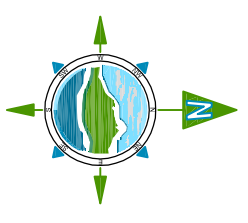

— WASTE LICENCE  
SITE BOUNDARY

NOTES

1. FIGURED DIMENSIONS ONLY TO BE TAKEN FROM THIS DRAWING
2. ALL DRAWINGS TO BE CHECKED BY THE CONTRACTOR ON SITE
3. ENGINEER TO BE INFORMED BY THE CONTRACTOR OF ANY DISCREPANCIES BEFORE ANY WORK COMMENCES
4. ALL LEVELS SHOWN RELATE TO ORDNANCE SURVEY DATUM AT MALIN HEAD

Rev	Date	Description	By	CHK'd
B	16.08.12	REVIEW APPLICATION	R.K.	O.M.
A	27.07.09	FIRST ISSUE	R.K.	E.S.

Client: **LENNON QUARRIES LTD.**

Project: **WASTE LICENCE REVIEW APPLICATION**

Title: **LOCATION OF SITE NOTICE**

Scale @ A3: **1 : 7,500**

Prepared by: **R.K.**      Checked: **E.S.**      Date: **22.12.08**

Project Director: **M.F.G.**

**TORIN**  
Patrick J. Torin & Co. Ltd.  
TORIN Consulting Engineers,  
Market Square, Castlebar,  
Co. Mayo  
Tel: +353 (0)184 8071401  
Fax: +353 (0)184 8071534  
e-mail: castlbar@torin.ie  
www.torin.ie

Drawing No: **2084-2605**      Revision: **B**



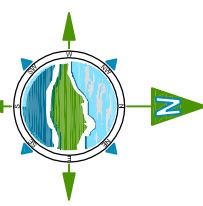

**LEGEND**

- WASTE LICENCE REVIEW APPLICATION SITE BOUNDARY
- RIVER
- OPEN DRAIN
- SURFACE WATER MONITORING LOCATIONS
- NOISE MONITORING LOCATIONS
- DUST MONITORING LOCATIONS

- NOTES:**
- FIGURED DIMENSIONS ONLY TO BE TAKEN FROM THIS DRAWING.
  - ALL DRAWINGS TO BE CHECKED BY THE CONTRACTOR ON SITE.
  - ENGINEER/EMPLOYERS REPRESENTATIVE, AS APPROPRIATE, TO BE INFORMED BY THE CONTRACTOR OF ANY DISCREPANCIES BEFORE ANY WORK COMMENCES.
  - THE CONTRACTOR SHALL UNDERTAKE A THOROUGH CHECK FOR THE ACTUAL LOCATION OF ALL SERVICES UTILITIES AND OBSTACLES (E.G. FOUND, BEFORE ANY WORK COMMENCES.
  - ALL LEVELS SHOWN RELATE TO ORDNANCE SURVEY DATUM AT WALN HEAD

Rev	Date	Description	By	CHKD
D	13.08.12	EXTRA INFORMATION ADDED	R.K.	S.T.
C	24.10.11	ALTERATIONS TO SIGHTINGS LOCATIONS AND NUMBERS	R.K.	E.S.
B	15.08.09	ADD & CHANGE SOME MONITORING LOCATIONS	R.K.	E.S.
A	22.01.09	FRESH ISSUE	R.K.	E.S.

Client: **LENNON QUARRIES LTD**

Project: **WASTE LICENCE REVIEW APPLICATION**

Title: **ENVIRONMENTAL MONITORING LOCATIONS**

Scale @ A3: **1 : 7,500**

Prepared by: **R.K.** Date: **22.12.08**

Checked: **E.S.**

Project Director: **M.F.G.**

Drawing Status: **WASTE LICENCE REVIEW**

**TOBIN**  
 Patrick J. Tobin & Co. Ltd.  
 TOBIN Consulting Engineers,  
 Market Square, Castlebar,  
 Co. Mayo, Ireland.  
 tel: +353-(0)94-9021401  
 fax: +353-(0)94-9021534  
 e-mail: castlesbar@tobin.ie  
 www.tobin.ie

Drawing No.: **2084-2606**

Revision: **D**

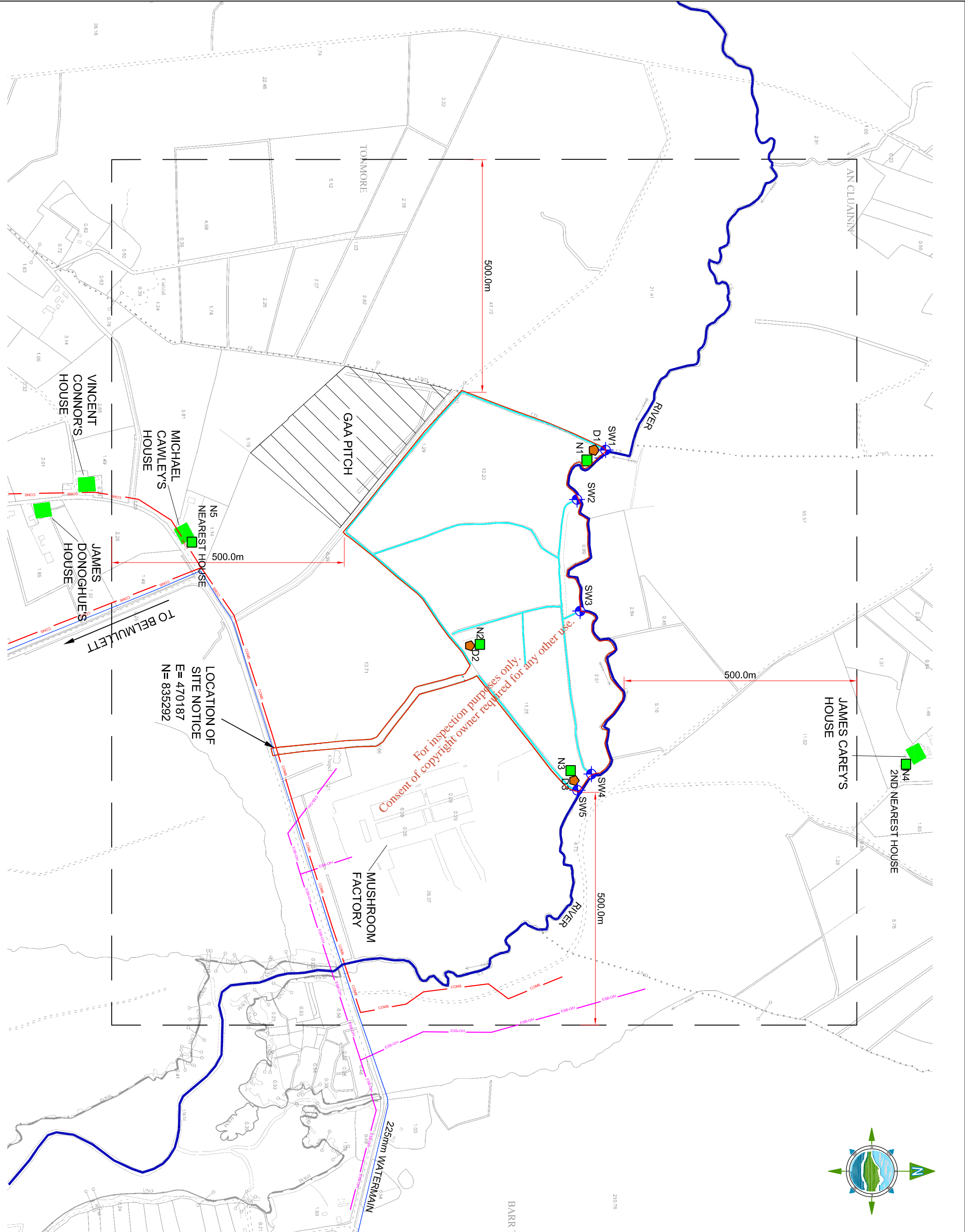

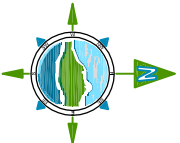
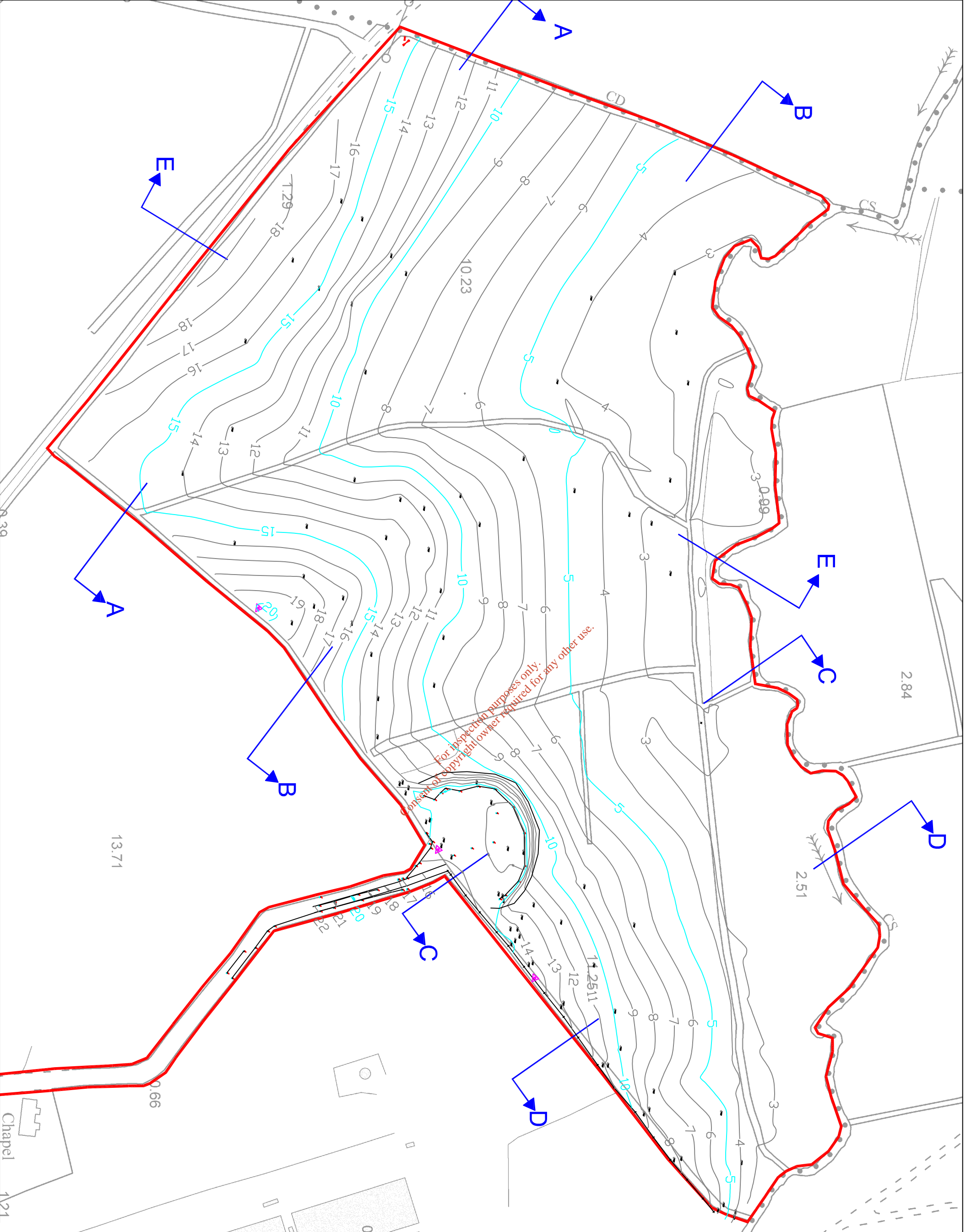

WASTE LICENCE  
REVIEW APPLICATION  
SITE BOUNDARY

CROSS SECTION  
LOCATIONS

NOTES

1. FIGURED DIMENSIONS ONLY TO BE TAKEN FROM THIS DRAWING
2. ALL DRAWINGS TO BE CHECKED BY THE CONTRACTOR ON SITE
3. ENGINEER TO BE INFORMED BY THE CONTRACTOR OF ANY DISCREPANCIES BEFORE ANY WORK COMMENCES
4. ALL LEVELS SHOWN RELATE TO ORDNANCE SURVEY DATUM AT MALJIN HEAD

Rev	Date	Description	By	CHKD
C	16.04.12	REVIEW/APPLICATION	R.K.	O.M.
B	15.04.10	LEVELS ALTERED	R.K.	E.S.
A	27.01.09	FIRST ISSUE	R.K.	E.S.

Client: **LENNON QUARRIES LTD.**

Project: **WASTE LICENCE REVIEW APPLICATION**

Title: **TOPOGRAPHIC MAP OF SITE**  
**DECEMBER 2008**

Scale @ A3: **1 : 2,500**

Prepared by: **R.K.**      Checked: **E.S.**      Date: **22.12.08**

Project Director: **M.F.G.**

**TOBIN**  
Patrick J. Tobin & Co. Ltd.  
TOBIN Consulting Engineers,  
Markea Square, Castlebar,  
Co. Mayo, Ireland.  
Tel: +353-094-8021491  
Fax: +353-094-8021491  
www.tobin.ie

Drawing No.: **2084-2607**      Revision: **C**



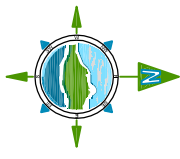
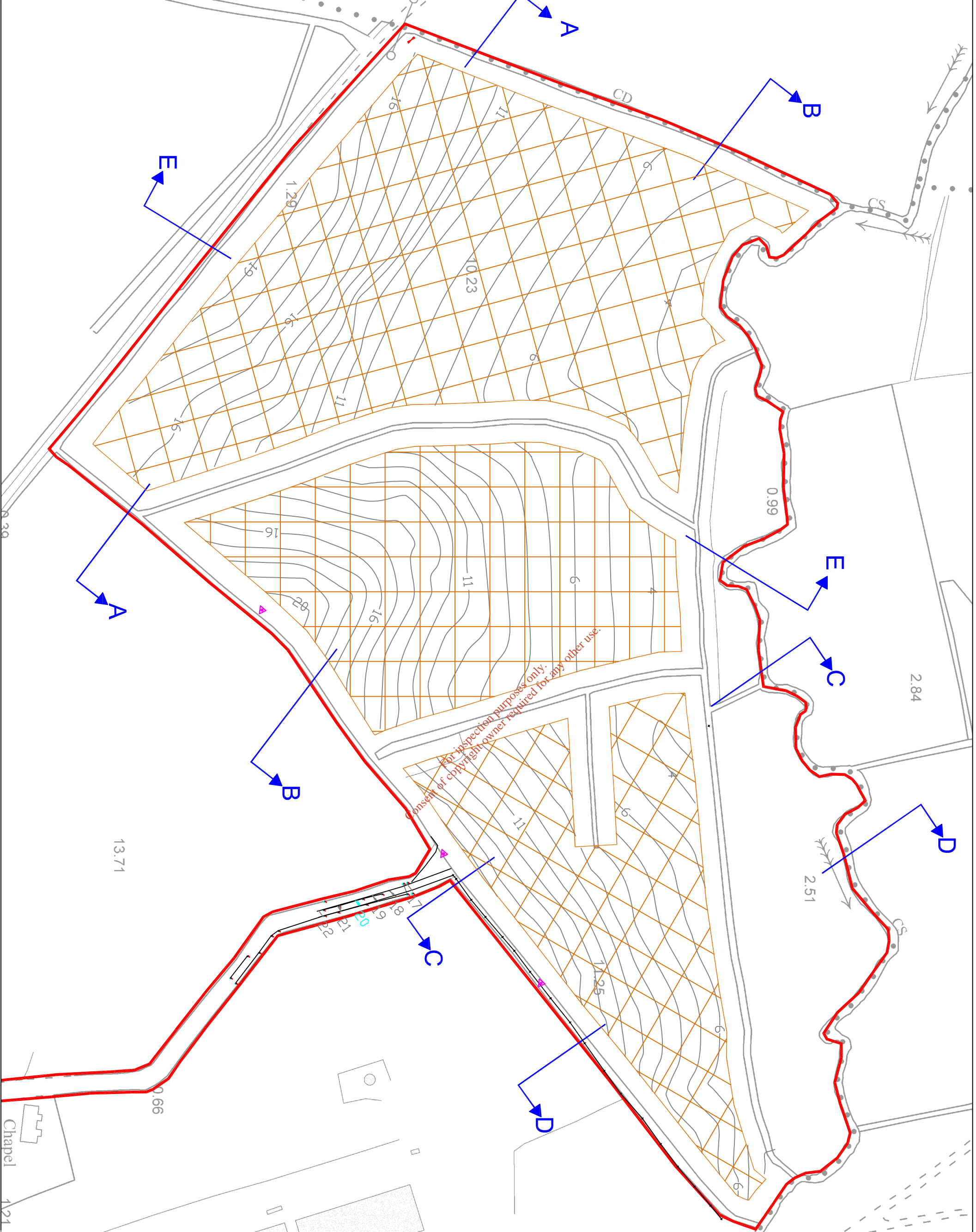

— WASTE LICENCE REVIEW APPLICATION SITE BOUNDARY

↔ CROSS SECTION LOCATIONS

▨ AREAS TO BE FILLED LEAVING 15M OFFSET FROM ALL DRAINS

**NOTES**

1. FIGURED DIMENSIONS ONLY TO BE TAKEN FROM THIS DRAWING
2. ALL DRAWINGS TO BE CHECKED BY THE CONTRACTOR ON SITE
3. ENGINEER TO BE INFORMED BY THE CONTRACTOR OF ANY DISCREPANCIES BEFORE ANY WORK COMMENCES
4. ALL LEVELS SHOWN RELATE TO ORDNANCE SURVEY DATUM AT MALIN HEAD

Rev	Date	Description	By	CHKD
D	16.06.12	REVIEW APPLICATION	R.K.	O.M.
C	27.10.11	LEVELS REVISOR & OPEN	R.K.	E.S.
B	15.04.10	LEVELS REVISOR	R.K.	E.S.
A	27.01.09	FIRST ISSUE	R.K.	E.S.

Client: **LENNON QUARRIES LTD.**

Project: **WASTE LICENCE REVIEW APPLICATION**

Title: **TOPOGRAPHIC MAP OF APPLICATION SITE SHOWING FINAL GROUND LEVELS**

Scale @ A3: **1 : 2,500**

Prepared by: **R.K.** Checked: **E.S.** Date: **22.12.08**

Project Director: **M.F.G.**

**TOBIN**  
 Patrick J. Tobin & Co. Ltd.  
 Tobin Consulting Engineers,  
 Markea Square, Castlebar,  
 Co. Mayo, Ireland.  
 Tel: +353-(0)94-8021491  
 Fax: +353-(0)94-8021491  
 Email: info@tobin.ie  
 www.tobin.ie

Drawing No.: **2084-2608** Revision: **D**

LEGEND

- DECEMBER 2008 GROUND LEVEL
- PROPOSED FINAL GROUND LEVEL

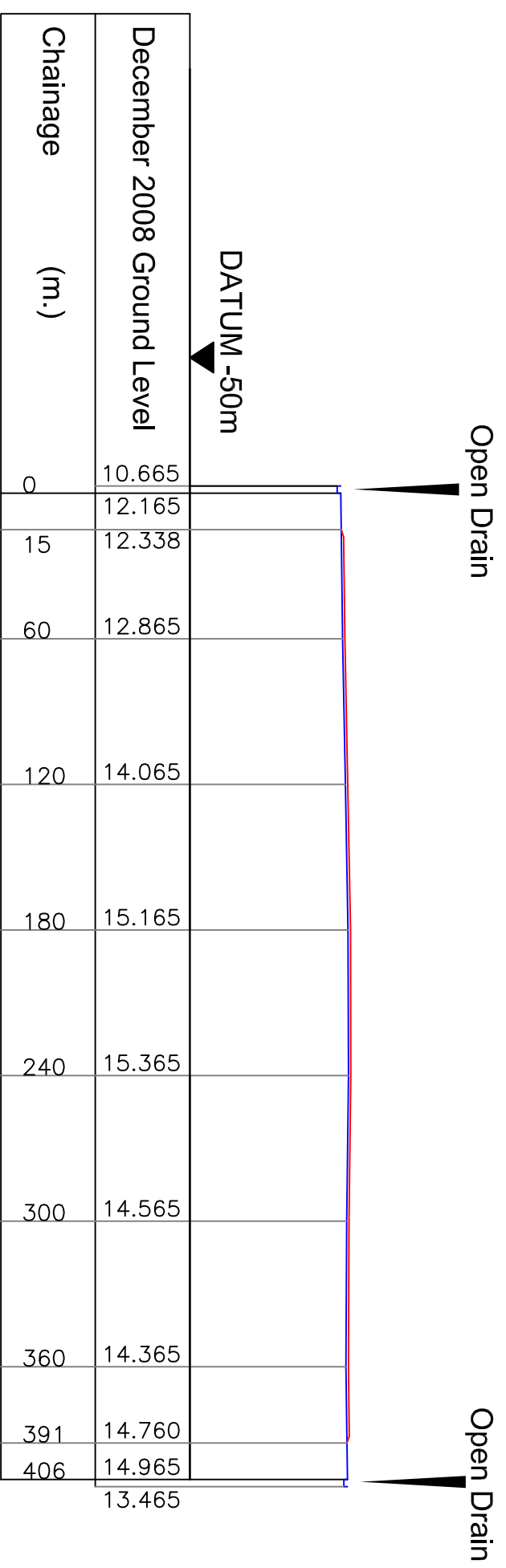

### SECTION A - A

For inspection purposes only. Consent of copyright owner required for any other use.

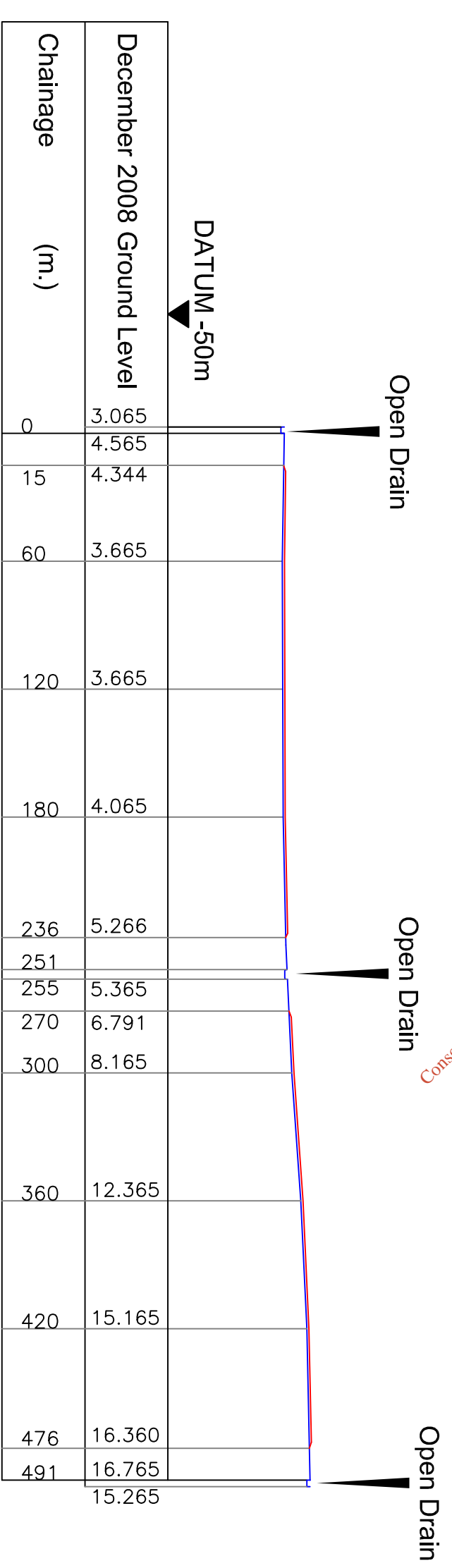

### SECTION B - B

NOTES

1. FIGURED DIMENSIONS ONLY TO BE TAKEN FROM THIS DRAWING
2. ALL DRAWINGS TO BE CHECKED BY THE CONTRACTOR ON SITE
3. ENGINEER TO BE INFORMED BY THE CONTRACTOR OF ANY DISCREPANCIES BEFORE ANY WORK COMMENCES
4. ALL LEVELS SHOWN RELATE TO ORDNANCE SURVEY DATUM AT MALJIN HEAD

Rev	Date	Description	By	CHK
D	16/08/12	REVIEW/APPLICATION	R.K.	O.M.
C	02/11/11	REVISIONS	R.K.	E.S.
B	APRIL'10	REVISIONS TO LEVELS	O.C.	E.S.
A	27/01/09	FIRST ISSUE	R.K.	E.S.

Client: **LENNON QUARRIES LTD.**

Project: **WASTE LICENCE REVIEW APPLICATION**

Title: **CROSS SECTIONS A - A & B - B DECEMBER 2008**

Scale @ As: **1 : 2,500**

Prepared by: **R.K.**      Checked: **E.S.**      Date: **15.01.09**

Project Director: **M.F.G.**

**TOBIN**  
 PARK J. TOBIN & CO. LTD.  
 TOBIN Consulting Engineers,  
 Mirika Square, Castlebar,  
 Co. Mayo, Ireland.  
 Tel: +353-(0)94-8021491  
 Fax: +353-(0)94-8021493  
 Email: info@tobin.ie  
 www.tobin.ie

Drawing No.: **2084-2609**      Revision: **D**



- DECEMBER 2008 GROUND LEVEL
- PROPOSED FINAL GROUND LEVEL

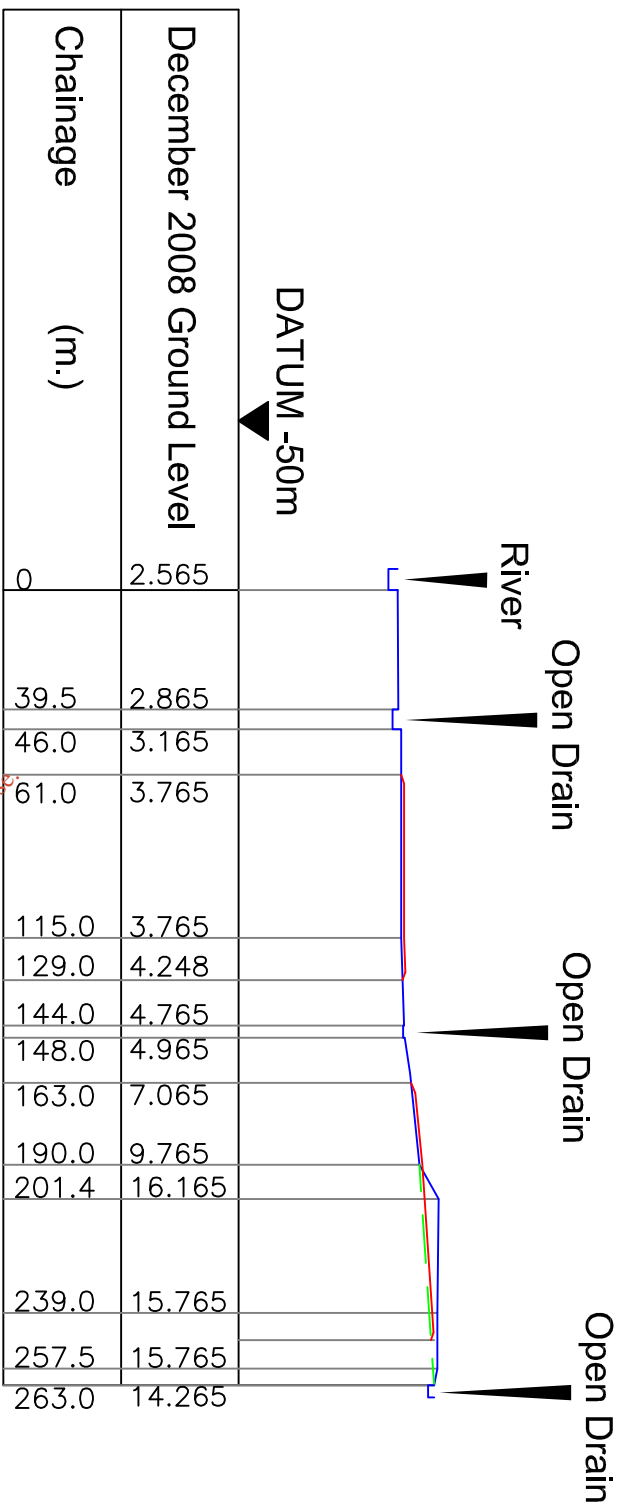

### SECTION C - C

For inspection purposes only.  
Consent of copyright owner required for any other use.

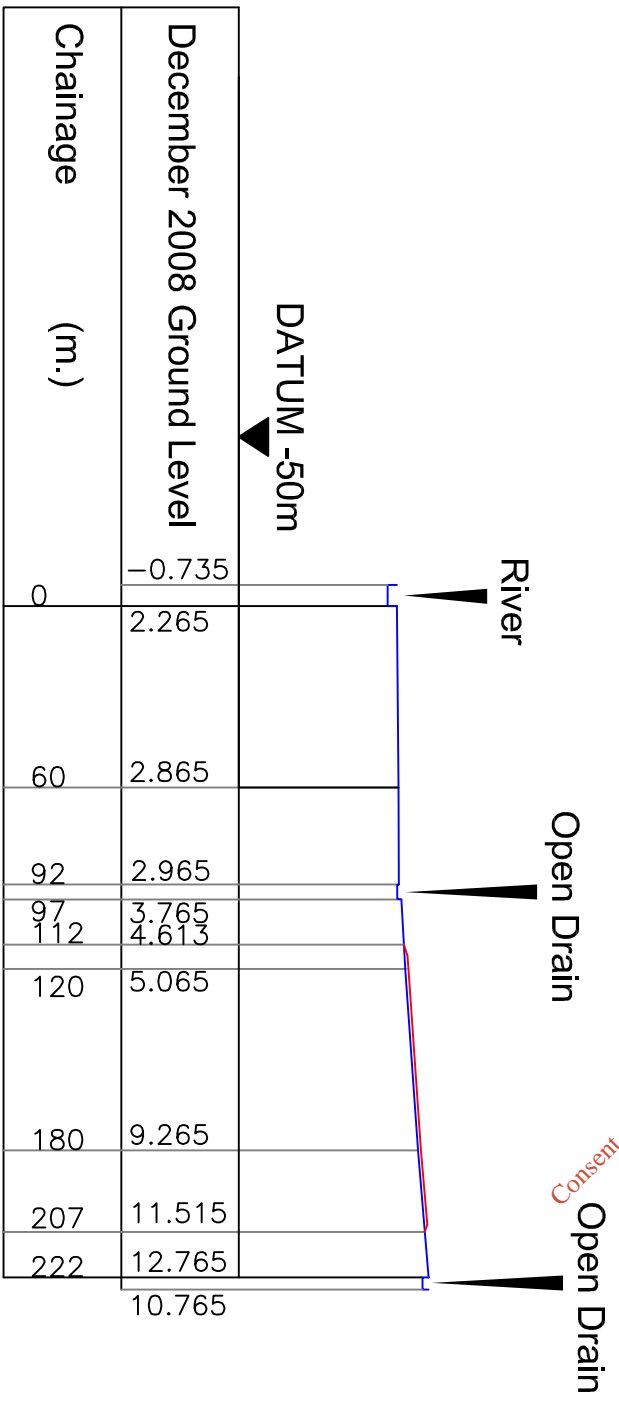

### SECTION D - D

NOTES

1. FIGURED DIMENSIONS ONLY TO BE TAKEN FROM THIS DRAWING
2. ALL DRAWINGS TO BE CHECKED BY THE CONTRACTOR ON SITE
3. ENGINEER TO BE INFORMED BY THE CONTRACTOR OF ANY DISCREPANCIES BEFORE ANY WORK COMMENCES
4. ALL LEVELS SHOWN RELATE TO ORDNANCE SURVEY DATUM AT MALIN HEAD

Rev	Date	Description	By	CHK
D	16/08/12	REVIEW/APPLICATION	R.K.	O.M.
C	02/11/11	REVISIONS	R.K.	E.S.
B	APRIL/10	REVISIONS TO LEVELS	O.C.	E.S.
A	27/01/09	FIRST ISSUE	R.K.	E.S.

Client: **LENNON QUARRIES LTD.**

Project: **WASTE LICENCE REVIEW APPLICATION**

Title: **CROSS SECTIONS C - C & D-D DECEMBER 2008**

Scale @ A3: **1 : 2,500**

Prepared by: **R.K.**      Checked: **E.S.**      Date: **15.01.09**

Project Director: **M.F.G.**

**TOBIN**  
Patrick J. Tobin & Co. Ltd.  
Tobin Consulting Engineers,  
Mirka Square, Castlebar,  
Co. Mayo, Ireland.  
Tel: +353-(0)94-8021491  
Fax: +353-(0)94-8021493  
Email: info@tobin.ie  
www.tobin.ie

Drawing No.: **2084-2610**      Revision: **D**

LEGEND	
	DECEMBER 2008 GROUND LEVEL
	PROPOSED FINAL GROUND LEVEL

NOTES

1. FIGURED DIMENSIONS ONLY TO BE TAKEN FROM THIS DRAWING
2. ALL DRAWINGS TO BE CHECKED BY THE CONTRACTOR ON SITE
3. ENGINEER TO BE INFORMED BY THE CONTRACTOR OF ANY DISCREPANCIES BEFORE ANY WORK COMMENCES
4. ALL LEVELS SHOWN RELATE TO ORDNANCE SURVEY DATUM AT MAJUN HEAD

Rev	Date	Description	By	CHKD
D	TODAY	REVIEW/APPLICATION	R.K.	O.M.
C	02.11.11	REVISIONS	R.K.	E.S.
B	APRIL '10	REVISIONS TO LEVELS	O.C.	E.S.
A	27.01.09	FIRST ISSUE	R.K.	E.S.

Client: LENNON QUARRIES LTD.

Project:

WASTE LICENCE  
REVIEW APPLICATION

Title:

CROSS SECTION  
E - E  
DECEMBER 2008

Scale @ A3: 1 : 2,500

Prepared by: R.K.      Checked: E.S.      Date: 15.01.09

Project Director: M.F.G.



TOBIN Consulting Engineers,  
Minka Square, Castlebar,  
Co. Mayo, Ireland.  
Tel: +353-(0)94-8021491  
Fax: +353-(0)94-8021494  
Email: info@tobin.ie  
www.tobin.ie

Drawing No.: 2084-2611      Revision: D

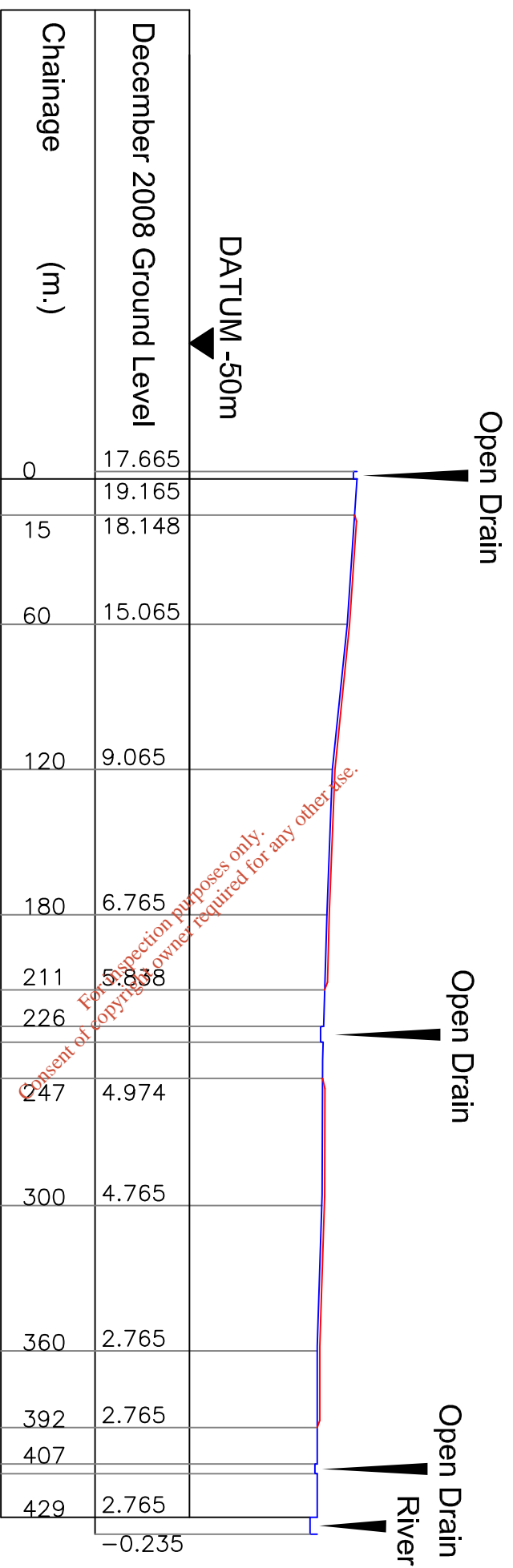

SECTION E - E



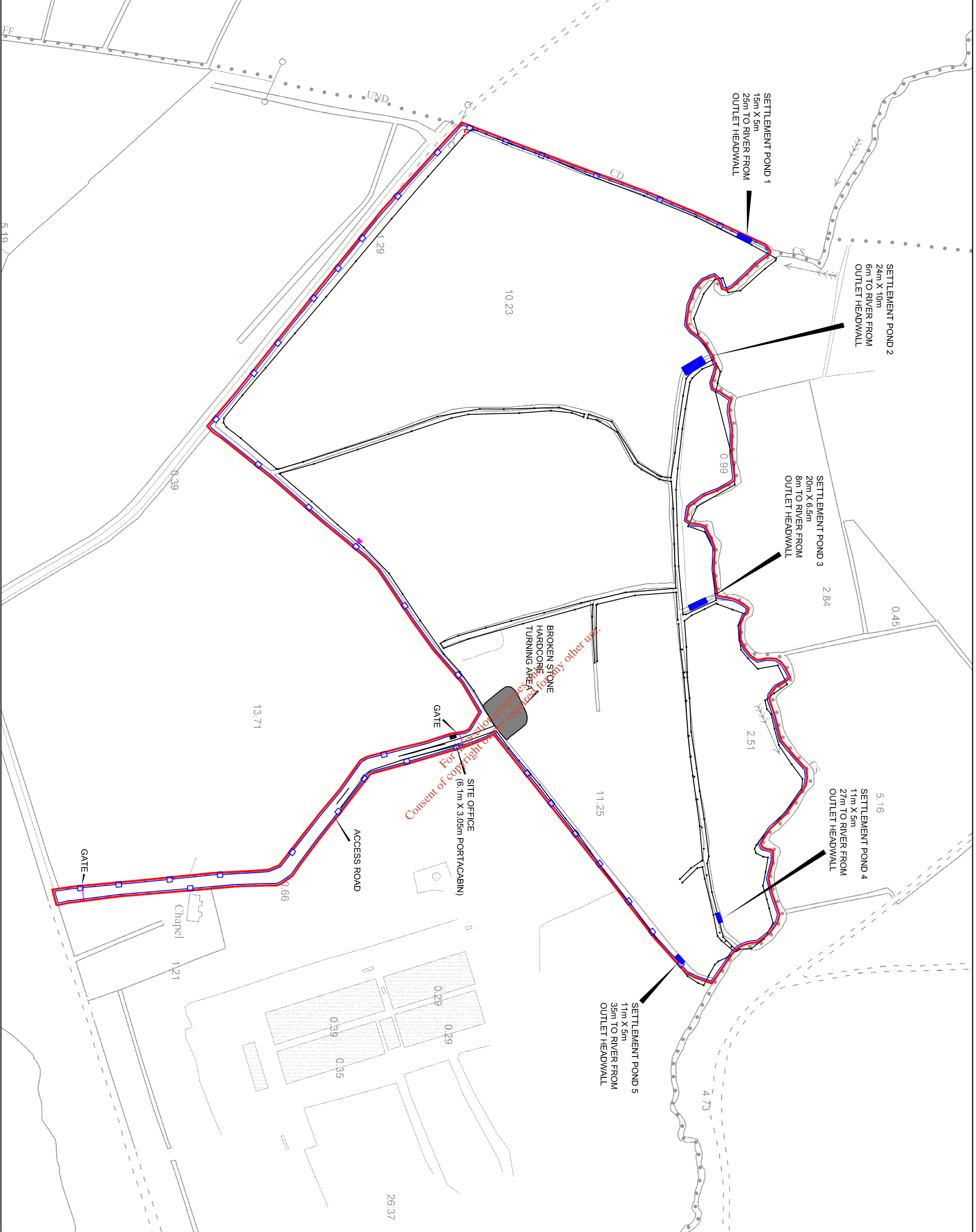

For information only. Not to be used for any other use.  
Consent of copyright owner required for any other use.

- WASTE LICENCE REVIEW APPLICATION SITE BOUNDARY
- EXISTING POST & WIRE PERIMETER FENCE
- ▶ SETTLEMENT PONDS

**NOTES**

1. FIGURED DIMENSIONS ONLY TO BE TAKEN FROM THIS DRAWING
2. ALL DRAWINGS TO BE CHECKED BY THE CONTRACTOR ON SITE
3. ENGINEER TO BE INFORMED BY THE CONTRACTOR OF ANY DISCREPANCIES BEFORE ANY WORK COMMENCES
4. ALL LEVELS SHOWN RELATE TO ORDNANCE SURVEY DATUM AT MALIN HEAD

Rev	Date	Description	By	Chkd
E	16/08/12	REVIEW APPLICATION	R.K.	O.M.
D	20/03/12	REVISIONS	R.K.	E.S.
C	02/11/11	REVISIONS	R.K.	E.S.
B	08/12/09	REMOVE CONCRETE MASSWALL	R.K.	E.S.
A	27/01/09	FIRST ISSUE	R.K.	E.S.

**Client:** LENNON QUARRIES LTD.

**Project:** WASTE LICENCE REVIEW APPLICATION

**Title:** EXISTING & PROPOSED SITE INFRASTRUCTURE (AS BUILT)

Scale @ A3: 1 : 3,500

Prepared by: R.K.      Checked: E.S.      Date: 19.01.09

Project Director: M.F.G.

**TOBIN**  
Patrick J. Tobin & Co. Ltd.  
Tobin Consulting Engineers,  
Marine Square, Castlebar,  
Co. Mayo, Ireland.  
Tel: +353 (0)94 8021491  
Fax: +353 (0)94 8021491  
Email: info@tobin.ie  
www.tobin.ie

Drawing No.: 2084-2612      Revision: E

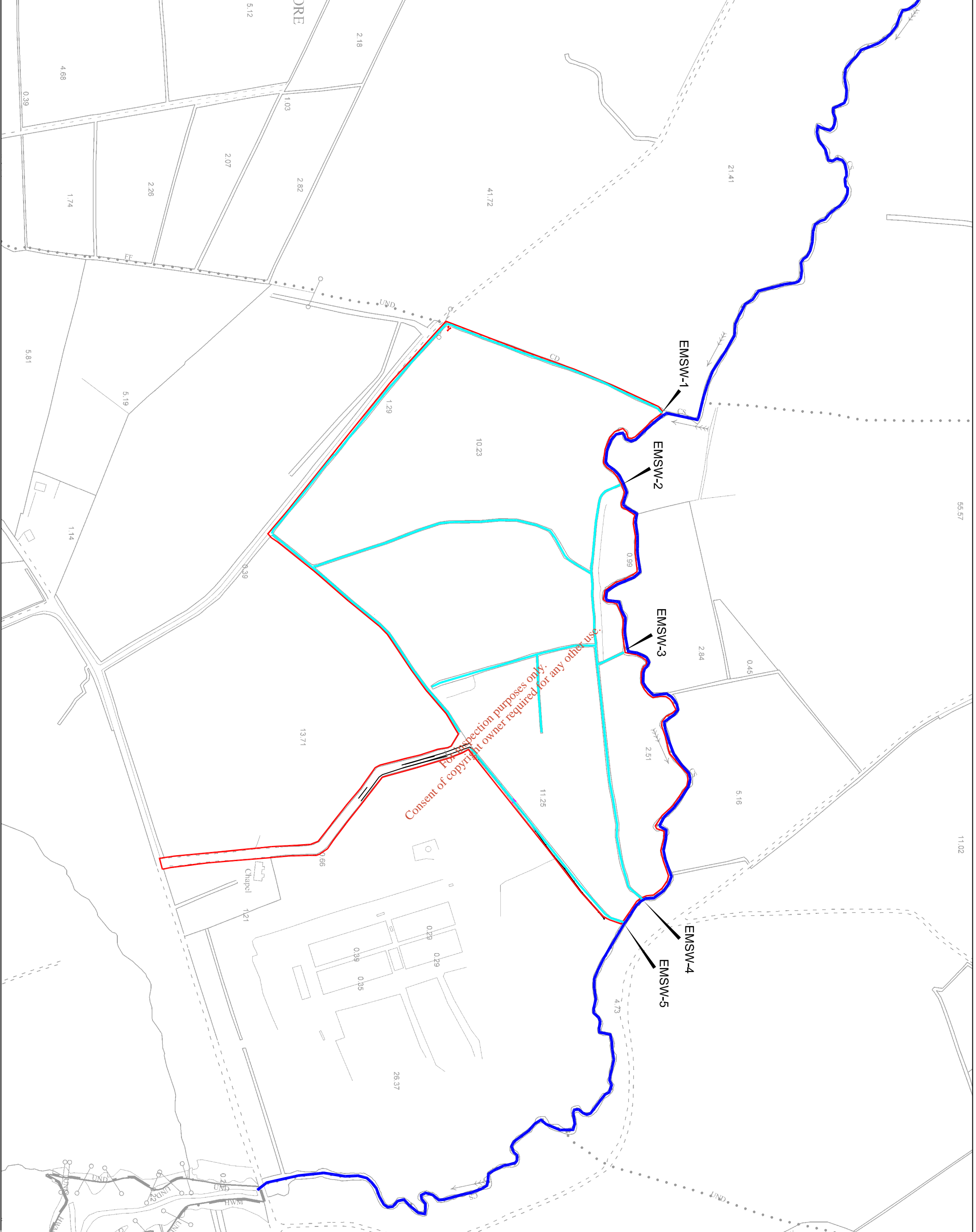

For inspection purposes only.  
Consent of copyright owner required for any other use.

— WASTE LICENCE  
— REVIEW APPLICATION  
— SITE BOUNDARY

**NOTES**

1. FIGURED DIMENSIONS ONLY TO BE TAKEN FROM THIS DRAWING
2. ALL DRAWINGS TO BE CHECKED BY THE CONTRACTOR ON SITE
3. ENGINEER TO BE INFORMED BY THE CONTRACTOR OF ANY DISCREPANCIES BEFORE ANY WORK COMMENCES
4. ALL LEVELS SHOWN RELATE TO ORDNANCE SURVEY DATUM AT MALIN HEAD

Rev	Date	Description	By	CHKD
C	16/08/12	REVIEW/APPLICATION	R.K.	O.M.
B	08/12/09	REMOVE CONCRETE MASSWALL & EMISSION POINT BMP1	R.K.	E.S.
A	27/01/09	FIRST ISSUE	R.K.	E.S.

Client: **LENNON QUARRIES LTD.**

Project: **WASTE LICENCE REVIEW APPLICATION**

Title: **EMISSION POINTS**

Scale @ A3: **1 : 5,000**

Prepared by: **R.K.**      Checked: **E.S.**      Date: **19.01.09**

Project Director: **M.F.G.**

**TOBIN**  
Patrick J. Tobin & Co. Ltd.  
TOBIN Consulting Engineers,  
Markea Square, Castlebar,  
Co. Mayo, Ireland.  
Tel: +353-(0)94-8021491  
Fax: +353-(0)94-8021534  
Email: info@tobin.ie  
www.tobin.ie

Drawing No.: **2084-2613**      Revision: **C**



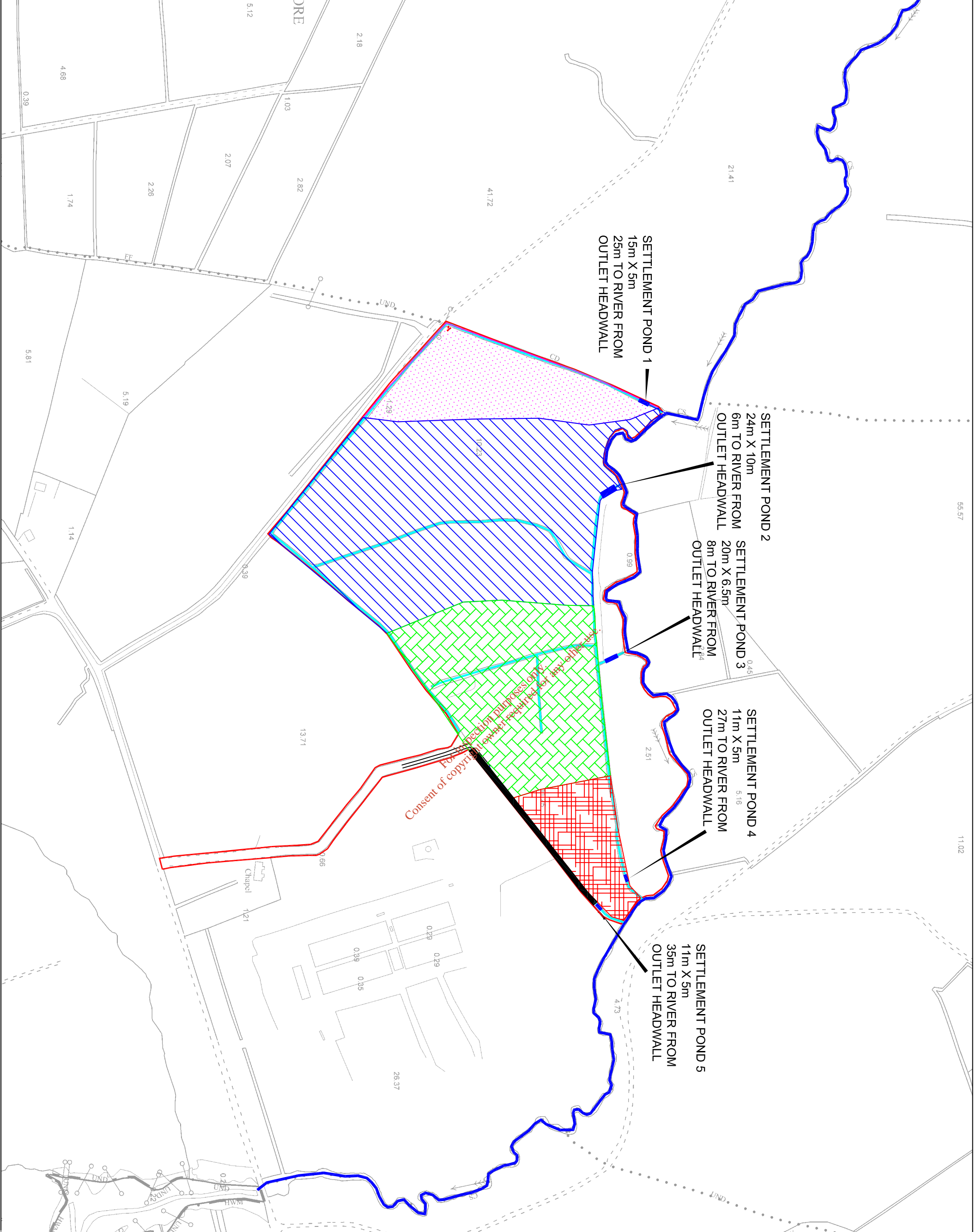

WASTE LICENCE  
REVIEW APPLICATION  
SITE BOUNDARY

SETTLEMENT PONDS

SETTLEMENT POND 1  
ZONE OF CONTRIBUTION  
33,000m<sup>2</sup>

SETTLEMENT POND 2  
ZONE OF CONTRIBUTION  
112,500m<sup>2</sup>

SETTLEMENT POND 3  
ZONE OF CONTRIBUTION  
61,000m<sup>2</sup>

SETTLEMENT POND 4  
ZONE OF CONTRIBUTION  
18,000m<sup>2</sup>

SETTLEMENT POND 5  
ZONE OF CONTRIBUTION  
2,300m<sup>2</sup>

NOTES

1. FIGURED DIMENSIONS ONLY TO BE TAKEN FROM THIS DRAWING
2. ALL DRAWINGS TO BE CHECKED BY THE CONTRACTOR ON SITE
3. ENGINEER TO BE INFORMED BY THE CONTRACTOR OF ANY DISCREPANCIES BEFORE ANY WORK COMMENCES
4. ALL LEVELS SHOWN RELATE TO ORDNANCE SURVEY DATUM AT MALIN HEAD

Rev	Date	Description	By	CHKD
D	16.06.12	REVIEW APPLICATION	R.K.	O.M.
C	26.04.12	REVISIONS	R.K.	E.S.
B	16.06.09		R.K.	E.S.
A	27.01.09	FIRST ISSUE	R.K.	E.S.

Client: **LENNON QUARRIES LTD.**

Project: **WASTE LICENCE  
REVIEW APPLICATION**

Title: **SURFACE WATER DRAINAGE  
SYSTEM INCLUDING  
TREATMENT / ABATEMENT SYSTEM  
(AS BUILT)**

Scale @ A3: **1 : 5,000**

Prepared by: **R.K.** Checked: **E.S.** Date: **19.01.09**

Project Director: **M.F.G.**

**TOBIN**  
Patrick J. Tobin & Co. Ltd.  
TOBIN Consulting Engineers,  
Markea Square, Castlebar,  
Co. Mayo, Ireland.  
Tel: +353 (0)94 8021491  
Fax: +353 (0)94 8021534  
Email: info@tobin.ie  
www.tobin.ie

Drawing No.: **2084-2614** Revision: **D**

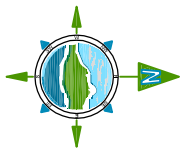
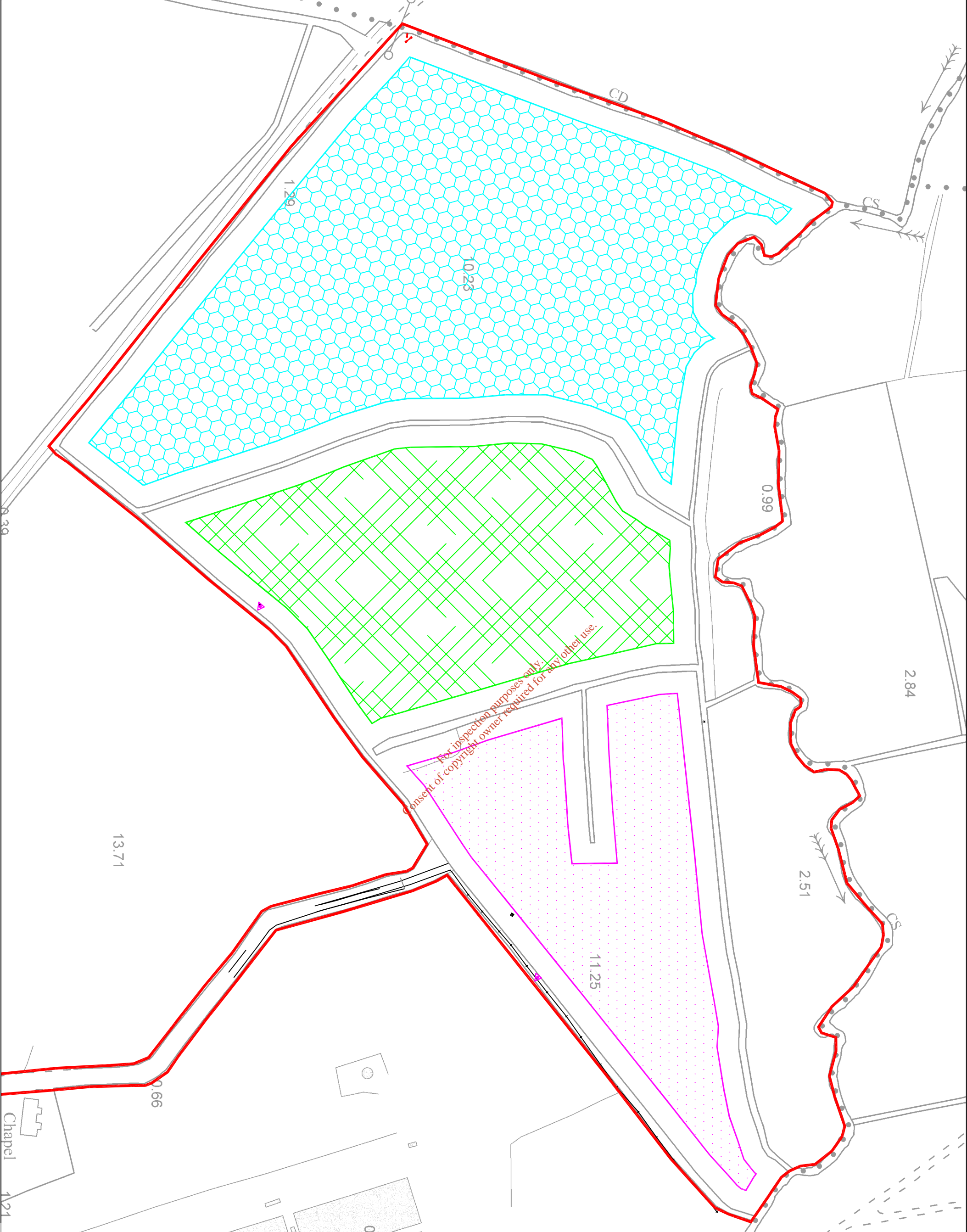

— WASTE LICENCE REVIEW APPLICATION SITE BOUNDARY

▨ PHASE 1 DEPOSITION

▨ PHASE 2 DEPOSITION

▨ PHASE 3 DEPOSITION

**NOTES**

1. FIGURED DIMENSIONS ONLY TO BE TAKEN FROM THIS DRAWING
2. ALL DRAWINGS TO BE CHECKED BY THE CONTRACTOR ON SITE
3. ENGINEER TO BE INFORMED BY THE CONTRACTOR OF ANY DISCREPANCIES BEFORE ANY WORK COMMENCES
4. ALL LEVELS SHOWN RELATE TO ORDNANCE SURVEY DATUM AT MALIN HEAD

Rev	Date	Description	By	CHKD
C	16.06.12	REVIEW APPLICATION	R.K.	O.M.
B	02.11.11	REVISIONS	R.K.	E.S.
A	16.06.09	FIRST ISSUE	R.K.	E.S.

Client: **LENNON QUARRIES LTD.**

Project: **WASTE LICENCE REVIEW APPLICATION**

Title: **PHASING SEQUENCE FOR DEPOSITION**

Scale @ A3: **1 : 2,500**

Prepared by: **R.K.** Checked: **E.S.** Date: **16.06.09**

Project Director: **M.F.G.**

**TOBIN**  
 Patrick J. Tobin & Co. Ltd.  
 Tobin Consulting Engineers,  
 Markea Square, Castlebar,  
 Co. Mayo, Ireland.  
 Tel: +353-(0)94-8021491  
 Fax: +353-(0)94-8021492  
 www.tobin.ie

Drawing No.: **2084-2615** Revision: **C**