

**ATTACHMENT D  
INFRASTRUCTURE & OPERATION**

*For inspection purposes only.  
Consent of copyright owner required for any other use.*

## D.1 Infrastructure.

*a) Security including perimeter fencing, entrance gates etc.*

The site is secured by a 2m steel fence and monitored by CCTV. The main gates to the facility are locked at night. These measures prevent unauthorised access and disposal of waste at the facility.

*b) Specifications for all access roads (main access road, haul roads and service roads).*

The site is located within a purpose built Business Park. All access roads are covered in tarmac and the site yard is concrete.

*c) Specifications for all hardstanding areas, including details of drainage.*

The site yard is covered with concrete. The yard is drained via a series of gullies that discharge to an interceptor prior to discharge to a local authority sewer off site.

*d) Weighbridge, including capacity, dimensions, record keeping system.*

There is no weighbridge at the facility. All incoming WEEE consignments are delivered in cages, containers or on pallets. All outgoing loads are baled or packaged in containers eg. IBC bags, battery boxes etc. All incoming and outgoing loads are weighed on a set of site pallet scales and recorded in paper and electronic form on a dedicated PC. The weighing scales are calibrated annually. All weight records are kept as part of the site EMS and waste permit conditions.

*e) Wheel cleaner, including construction, water supply, arrangements for drainage of contaminated water, etc.*

The site yard is covered with concrete. There are no issues with dirt or mud from deliveries and therefore there is no wheel cleaner at the site. However, The Recycling Village Ltd has a portable yard brushing machine that is used daily to sweep and clean the yard. All yard run off is diverted via a series of gullies to an interceptor prior to discharge to a local authority sewer off site.

*f) Laboratory facilities.*

There are no laboratory facilities at the site. This section is not applicable.

*g) Fuel storage, (including details of bunding etc.).*

There is no fuel stored on site. This section is not applicable.

*h) Waste quarantine areas, including location, design details, etc.*

There is a waste quarantine area (Zone G) at the site to store unacceptable waste and powder as per the sites EMS procedures. The labeled quarantine area is in an enclosed, secure location as shown on the attached Ground Floor Map Ref: 12039-LA-04.

*i) Waste inspection areas, including location, design details, etc.*

There is a waste inspection area at the site to deal with incoming waste loads as per the sites EMS procedures. The inspection area is shown on the attached Yard Management Plan Ref: 12039-LA-03.

*j) Traffic control, including location and detail of signs, barriers, parking, number of vehicles catered for, etc.*

The site is located within a purpose built Business Park with sufficient access roads and signage. Dedicated staff car parking is provided at the front of the facility. Delivery vehicles access to the site is via the rear delivery yard. Site traffic is managed in accordance with the site EMS procedures. Lorries unload/load in dedicated areas in the yard as shown on the attached Yard Management Plan Ref: 12039-LA-03.

An average of upto 3 delivery trucks visit the facility daily and an average of 1 delivery truck per day takes material from the facility. The volume of vehicles visiting the facility on a daily basis does not cause any impact on traffic in and around the Business Park.

*k) All services, including power, water, telephone, etc., and any services specific to the site location.*

The site is connected to the full range of utilities including; electricity, water, sewers, telephone, broadband etc.

*l) Sewerage and surface water drainage infrastructure, including location and sizes of pipes, outlets, invert details, treatment facilities, etc.*

The site yard is covered with concrete. The yard is drained via a series of gullies that discharge to an interceptor prior to discharge to a local authority sewer off site. The site drainage layout is shown on the attached Site Drainage Map Ref: 12039-LA-01. Details of the drainage pipes are shown in the attached drainage survey report.

*m) Plant sheds and garages, including locations, design, etc.*

There is one large building at the site measuring approximately 1,700m<sup>2</sup>. All WEEE processing takes place inside the facility building as shown on the attached map. All segregated material is securely stored under cover in accordance with the sites EMS procedures. Secure storage locations are shown on the attached map.

*n) Site accommodation and compounds, including administration area, site manager's office, staff facilities (e.g. canteen, toilets, showers etc.), equipment compound.*

The location and layout of the site processing areas, offices, staff canteens, toilets, storage areas etc are shown on the attached map.

*o) Fire control system, including details and locations of water supply, etc.*

There are 3 fire hydrants at the facility as shown on the site Drainage Map Ref: 12039-LA-01.

Fire extinguishers are located throughout the building. A site Emergency Response Plan has been developed for the site as presented in Attachment J.

*p) Civic amenity sites, including location, design, opening hours, location and number of collection receptacles, management methods for waste deposited, drainage, bunding, etc.*

There is no civic amenity at the site. This section is not applicable.

*q) Details of composting infrastructure.*

There is no composting on site. This section is not applicable.

*r) Description of Incineration infrastructure (if applicable). Provide information to fulfil Article 4 (2) & (3) of the Incineration of Waste Directive.*

There is no incineration on site. This section is not applicable.

s) *Details of any other infrastructure proposed.*

There are no infrastructure proposals for the site. This section is not applicable.

## D.2 Facility Operation

### a) *Unit Operations*

The Recycling Village Ltd provides a recycling service for WEEE including TV monitors, PC monitors, mixed WEEE, small domestic and office appliances (eg. key boards, printers, hairdryers, toaster, kettles etc), lead acid and other batteries. The above WEEE is generated at civic amenity sites and dedicated WEEE collection points as part of the WEEE compliance schemes. The company has also a number of business customers and arranges for the collection and delivery of a similar type material.

The WEEE is delivered to The Recycling Village Ltd facility by licensed third party contractors. The facility does not accept deliveries of WEEE from the general public. TV and PC monitors are manually processed and dismantled to separate the cathode ray tube (CRT) and outer unit/case. The CRTs are segregated into panel and funnel glass and processed separately through specialised glass cleaning equipment. The recovered fractions include glass, metal and plastics. The flat panel displays (FPDs) are manually dismantled and segregated into metals, plastics and glass. These materials are segregated, bulked and stored on site prior to transport off site for further processing and recycling. The Recycling Village Ltd also dismantles and shreds small domestic and office appliances (SDA) in order to recover additional recyclable materials including metals and plastics. The equipment used to segregate and recycle the SDA WEEE fraction includes a small shredder, conveyor and magnet.

Batteries are sorted, segregated and repackaged prior to transport off site for further processing and recycling. The Recycling Village Ltd also provides a secure data destruction and recycling service for hard drives, data storage & IT equipment.

The above operations increase the recycling rate of WEEE entering the facility and help to achieve National WEEE recycling targets.

The attached Ground Floor Plan Ref: 12039-LA-04 and Yard Management Plan Ref: 12039-LA-03 show the locations of all process activities, building layout and facilities.

### b) *Process Flow Diagrams.*

The Recycling Village Ltd has developed and implemented a site Environmental Management System (EMS) in accordance with ISO 14001.

As part of the site EMS, the following operating procedures and process flow diagrams have been developed;

EMS 09 01	Flat Panel Display Processing
EMS 09 02	CRT Processing
EMS 09 03	Lead Acid Battery Processing
EMS 09 04	Ni Cad Battery Processing
EMS 09 05	Primary Battery Processing
EMS 09 06	Small WEEE Processing
EMS 09 07	PC Processing

Copies of the above procedure and flow diagrams are presented in Attachment H.

*c) Environmental Emissions from the Facility Operation.*

There is no process effluent generated by the facility. Yard run off is diverted by a series of yard gullies to an interceptor prior to discharge to the local authority sewer.

During normal operations environmental emissions from the facility include;

- noise
- yard run off to sewer
- CRT dismantling area vent 1 to atmosphere
- FPD dismantling area vent 2 to atmosphere

Further details on the above emissions are provided in Section E.

In the event of a malfunction or interruption of services eg. power cut, all processes will stop and there will be no emissions to the environment.

*d) Laboratory Activities.*

There are no laboratory facilities at the site. This section is not applicable.

*e) Article 6 of the Incineration of Waste Directive.*

There is no incineration on site. This section is not applicable.

### **D.3 Liner System**

This section is not applicable.

### **D.4 Leachate Management**

This section is not applicable.

### **D 5 Landfill Gas Management**

This section is not applicable.

### **D.6 Capping System**

This section is not applicable.

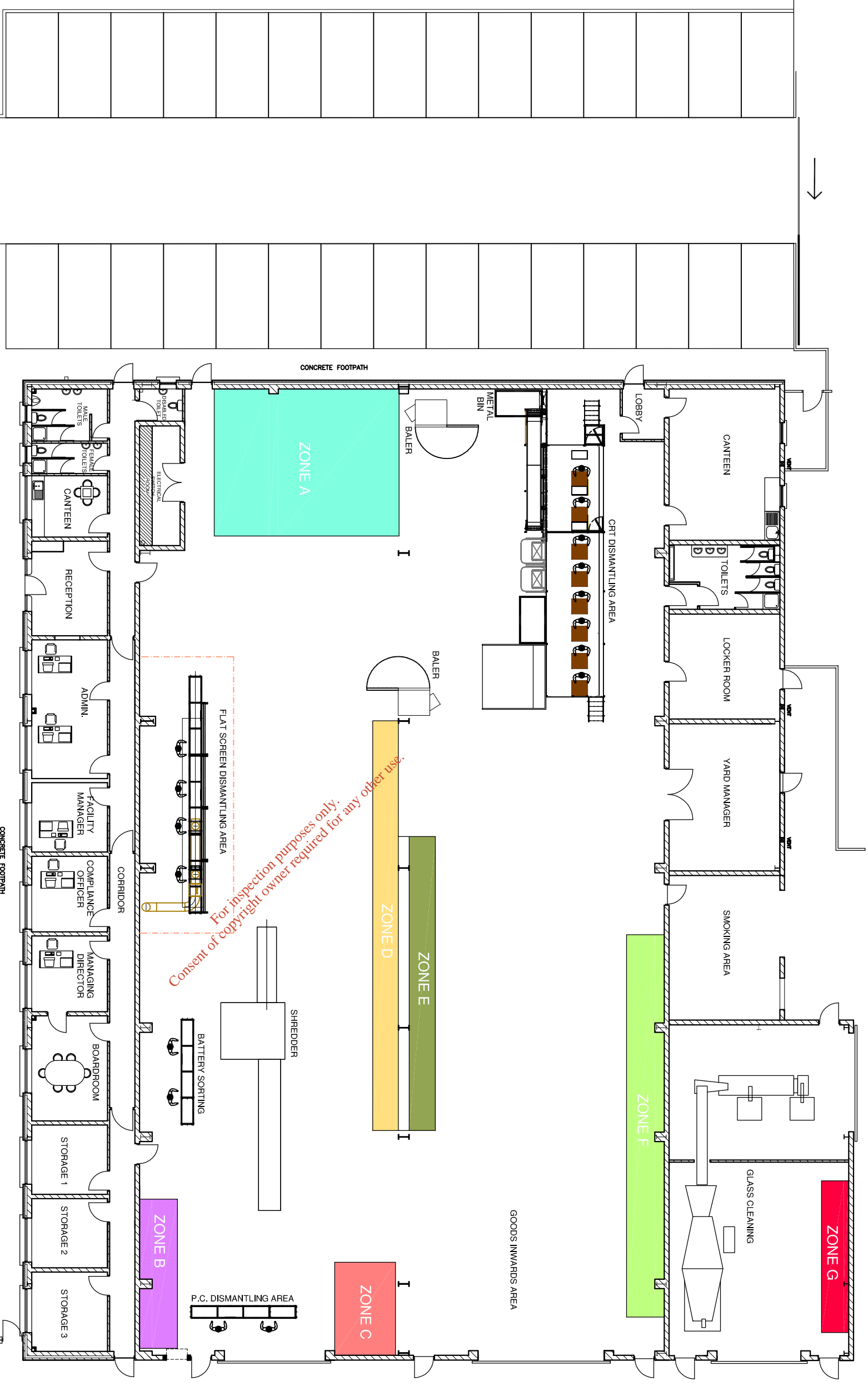

KEY PLAN	
	ZONE A - P.C. / F.P.D. STORAGE
	ZONE B - SORTED PRIMARY BATTERIES
	ZONE C - P.C. FRACTIONS
	ZONE D - NON FERROUS FRACTIONS
	ZONE E - OTHER BATTERIES
	ZONE F - CIRCUIT BOARDS
	ZONE G - QUARANTINE AND POWDER

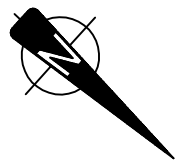

For inspection purposes only.  
Consent of copyright owner required for any other use.

# GROUND FLOOR PLAN

THIS DRAWING IS ISSUED ONLY FOR THE PURPOSE OF:

- INFORMATION
- PRELIMINARY
- PLANNING PERMISSION
- FIRE SAFETY CERTIFICATE
- DISABILITY ACCESS CERTIFICATE
- TENDER
- CONSTRUCTION

NO	REVISION	DATE

WCA Architects  
Architects  
Planners

Broadmeadow Hill  
Applewood Village  
Swords, Co. Dublin  
Ireland  
T: 01 8909550  
E: info@wcaarchitects.com  
W: www.wcaarchitects.com

CLIENT	THE RECYCLING VILLAGE LTD.
PROJECT	INDUSTRIAL UNIT, DULEEK, CO. MEATH
TITLE	GROUND FLOOR PLAN
SCALE	A3 - 1:200
DRAWN	P. Robinson
DATE	JULY '12
DRG. NO.	12039-LA-04

Copyright and ownership of this drawing is vested in WCA Architects whose prior written consent is required for its reproduction/publication in any form. No dimensions to be scaled from this drawing. Dimensions to be checked on site and any discrepancies to be notified to the Architect

Copyright WCA Architects

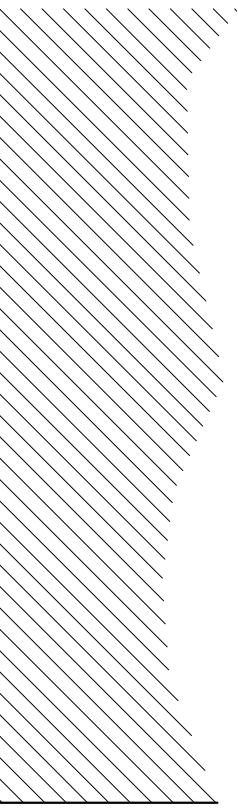

EXISTING INDUSTRIAL UNIT

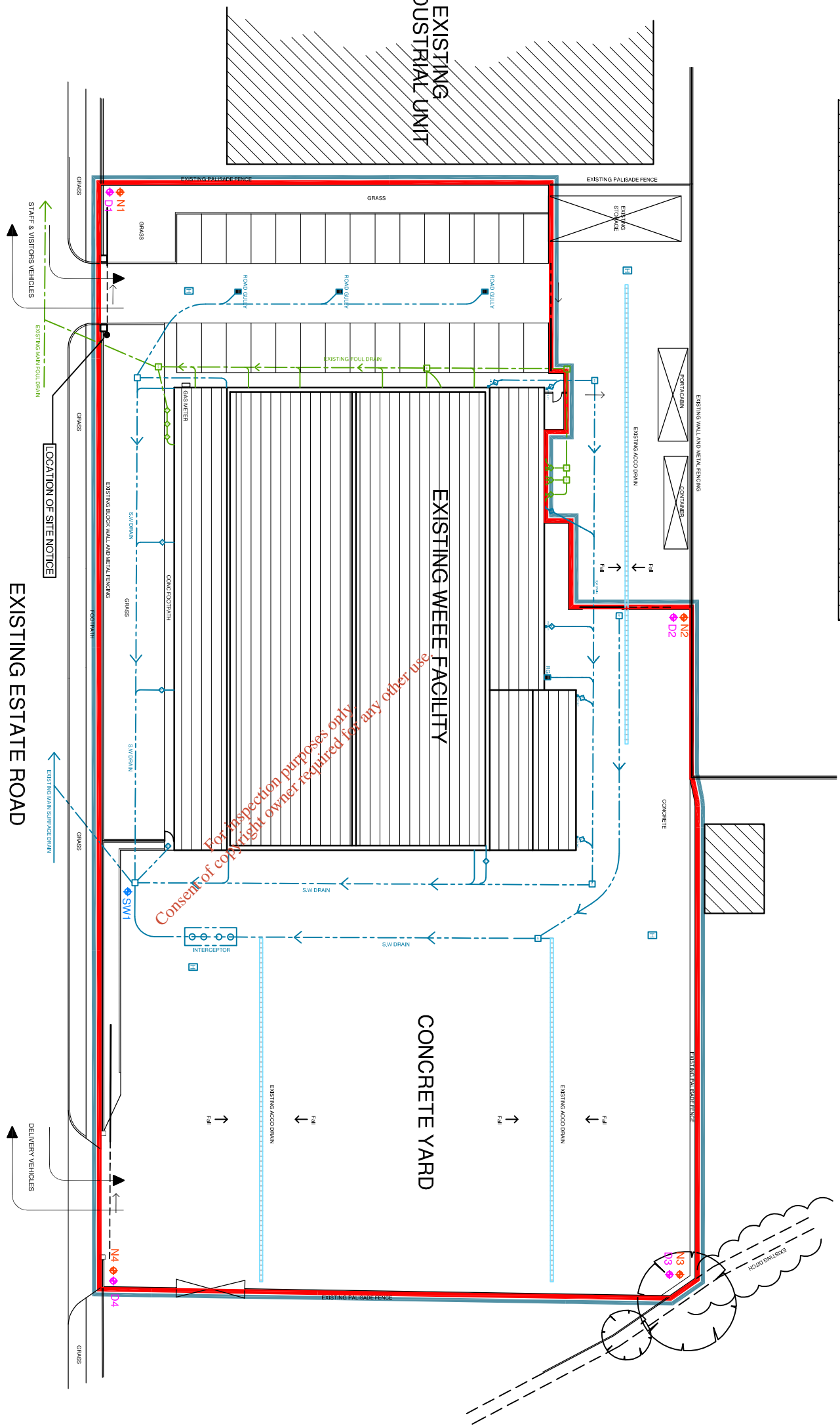

For inspection purposes only  
Consent of copyright owner required for any other use

SITE BOUNDARY OUTLINED IN RED  
 SITE OWNERSHIP OUTLINED IN BLUE  
 HYDRANTS SHOWN THUS: N1 - N4  
 NOISE MONITORING LOCATIONS SHOWN THUS: D1 - D4  
 DUST MONITORING LOCATIONS SHOWN THUS: D1 - D4  
 SURFACE WATER RUN OFF LOCATION SHOWN THUS: SW1

# SITE DRAINAGE PLAN

Copyright WCA Architects

Copyright and ownership of this drawing is vested in WCA Architects whose prior written consent is required for its reproduction/publication in any form. No dimensions to be scaled from this drawing. Dimensions to be checked on site and any discrepancies to be notified to the Architect

THIS DRAWING IS ISSUED ONLY FOR THE PURPOSE OF:-

- INFORMATION
- PRELIMINARY
- PLANNING PERMISSION
- FIRE SAFETY CERTIFICATE
- DISABILITY ACCESS CERTIFICATE
- TENDER
- CONSTRUCTION

NO	REVISION	DATE



Broadmeadow Hill  
 Applewood Village  
 Swords, Co. Dublin  
 Ireland  
 T: 01 8909550  
 E: info@wcaarchitects.com  
 W: www.wcaarchitects.com

CLIENT	THE RECYCLING VILLAGE LTD.
PROJECT	INDUSTRIAL UNIT, DULEEK, CO. MEATH
TITLE	SITE DRAINAGE PLAN
SCALE	A3 - 1:500
DRAWN	P. Robinson
DATE	JULY '12
DRG. NO.	12039-LA-01



