

For inspection purposes only.
Consent of copyright owner required for any other use.

Appendix J

Planning Drawings – A4

REVISION DATE: 27/06/09
REVISION 1
FORM NO. FRM-010



- BIO ENERGY PROCESS**
- 1 DELIVERY AREA
 - 2 WASTE RECEPTION AREA
 - 3 MIXING TANK
 - 4 HYDROLYSIS
 - 5 PRE STORAGE TANKS
 - 6 ANAEROBIC DIGESTERS
 - 7 GAS CLEANING VESSEL
 - 8 FLARE
 - 9 ENGINES
 - 10 HYGIENISATION AREA
 - 11 POST DIGESTION STORAGE
 - 12 POST DIGESTION LOADING AREA
 - 13 SILAGE STORAGE PITS
 - 14 SLURRY TANKS
 - 15 LEACHATE TANK

- FLOW OF MATERIAL**
- 2 → 3 DELIVERED WASTE MATERIAL
 - 3 → 4, 5 MIXED & HYDROLYSIS MATERIAL
 - 4 → 6 PRE DIGESTION MATERIAL
 - 5 → 6 PRE DIGESTION MATERIAL
 - 6 → 7 UNCLEANED GAS
 - 7 → 8, 9 CLEANED GAS
 - 8 → 10 POST DIGESTOR MATERIAL
 - 9 → 10 POST DIGESTOR MATERIAL
 - 10 → 11 HYGIENISED MATERIAL
 - 11 → 12 HYGIENISED POST DIGESTOR MATERIAL
 - 12 → 13 LEACHATE MATERIAL

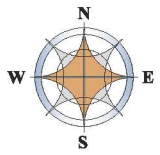

SITE NOTICE SECOND SITE NOTICE LOCATED OFF N4 AT THE ENTRANCE TO FLYNN FEEDS/ FUELS

PROPOSED HEDGEROW & TREES OF NATIVE SPECIES. PLEASE REFER TO DRAWING 111_001_209 FOR LANDSCAPE PROPOSALS

STOCK PROOF FENCING TO BOUNDARY OF SITE CONSISTING OF 2.1M EXTERNAL FENCE, 2.1M GAP AND 1.8M INTERNAL FENCE

TEMPORARY LOCATION OF WEIGHBRIDGE AND WHEEL WASH UNTIL THE CONSTRUCTION OF THE NEW N4 GRADE SEPARATION JUNCTION IS COMPLETE

GRAVELED AREA TO DIGESTERS AND STORAGE TANKS

PLEASE REFER TO CHAPTER 12 OF THE EIS FOR PROPOSED TEMPORARY ACCESS ROAD TO PROPOSED DEVELOPMENT

REV	INT	DESCRIPTION	REV	INT	DESCRIPTION	REV	INT	DESCRIPTION
D1	CS	ISSUED FOR PLANNING						

DESIGN ARCHITECTURE PLANNING PROJECT MANAGEMENT

PROJECT: PROPOSED BIOENERGY FACILITY AT NEWDOWNS, THE DOWNS, MULLINGAR, CO. WESTMEATH

CLIENT: BIO AGRIGAS LTD.

DRAWING NO: 111/001/200

AMENDMENT DATE:

DRAWING TITLE: PROPOSED SITE LAYOUT

SHEET 1 OF 2

REV: D1

DESIGN: CS

CHECKED:

APPROVED:

SCALE: 1:500

DATE: 02/04/2011

STATUS: PLANNING

REVISION DATE: 27/06/08
FORM NO: FRM-00
REVISION 1

PLANTING SCHEDULE

A COPSES ON SITE BOUNDARY
Plants at 1.5m centres as 800 - 1200mm whips

Acer campestre (Maple)	30%
Fragaria excelsior (Ash)	35%
Corylus avellana (Hazel)	15%
Ilex aquifolium (Holly)	20%

B GRASS OR GROUND COVER
Planted at 1.5m centres 900mm - 1200mm whips [trees]
800mm plants [shrubs]

Alnus glutinosa (Alder)	40%
Betula pubescens (Birch)	40%
Salix atrocinerea (Willow)	10%
Sorbus Avium (White Beam)	10%

C GRAVELED AREA

— SITE BOUNDARY
— CANAL / STREAM

① 2 rows of 2.4m high stock proof fence spaced 2 metres apart to entire site boundary
② 2.4m high security gates to main entrance

Notes:
Existing hedgerow to be cut back and trimmed. Brifers and other invasive vegetation to be eradicated. Ivy infestation to be removed from existing trees. Planting will consist of both infilling as necessary along the line of the existing hedgerows with trees and shrubs as indicated, and by widening the hedgerow to between 3 and 4m width.

All plants set in prepared pits with top soil mixed with 20 litres of moss peat and 70 g. of bone meal. Pits to be 350 wider than rootball, bottom of pits to be dug over to 300 below above pit to assist drainage.

Trees above 6 girth to have 50x50 treated timber stake, all other plants to have support cane. All plants to have rabbit protection sleeve.



REV	INT	DESCRIPTION	REV	INT	DESCRIPTION	REV	INT	DESCRIPTION
D1	CB	ISSUED FOR PLANNING						

marlin architects
DESIGN • ARCHITECTURE • PLANNING • PROJECT MANAGEMENT

PROPOSED BIOENERGY FACILITY AT NEWDOWNS, THE DOWNS, MULLINGAR, CO. WESTMEATH
CLIENT: BIO AGRIGAS LTD.

multi-hour office park, Mullingar
PROJECT NO: 111/001/209
DRAWING DATE: 02/04/2011
DRAWING BY: AT

REV: D1
CHECKED: CB
APPVED: AT

SCALE: 1:500
DATE: 02/04/2011
TYPE: PLANNING

PROPOSED SITE LAYOUT SHEET 2 OF 2		BIO AERGIAS LTD. PROJECT: ROBERTSON FACILITY A NEWDOWN, THE DOWN, MILLINGDAL CO. WESTMIDLANDS		DATE: 02/04/2011 SCALE: 1:200 & 1:2500	
DRAWN BY: AI CHECKED BY: DJ DATE: 11/01/2010	PROJECT NO: 111001/210	CLIENT: BIO AERGIAS LTD.	PROJECT: ROBERTSON FACILITY A	LOCATION: NEWDOWN, THE DOWN, MILLINGDAL CO. WESTMIDLANDS	SCALE: 1:200 & 1:2500

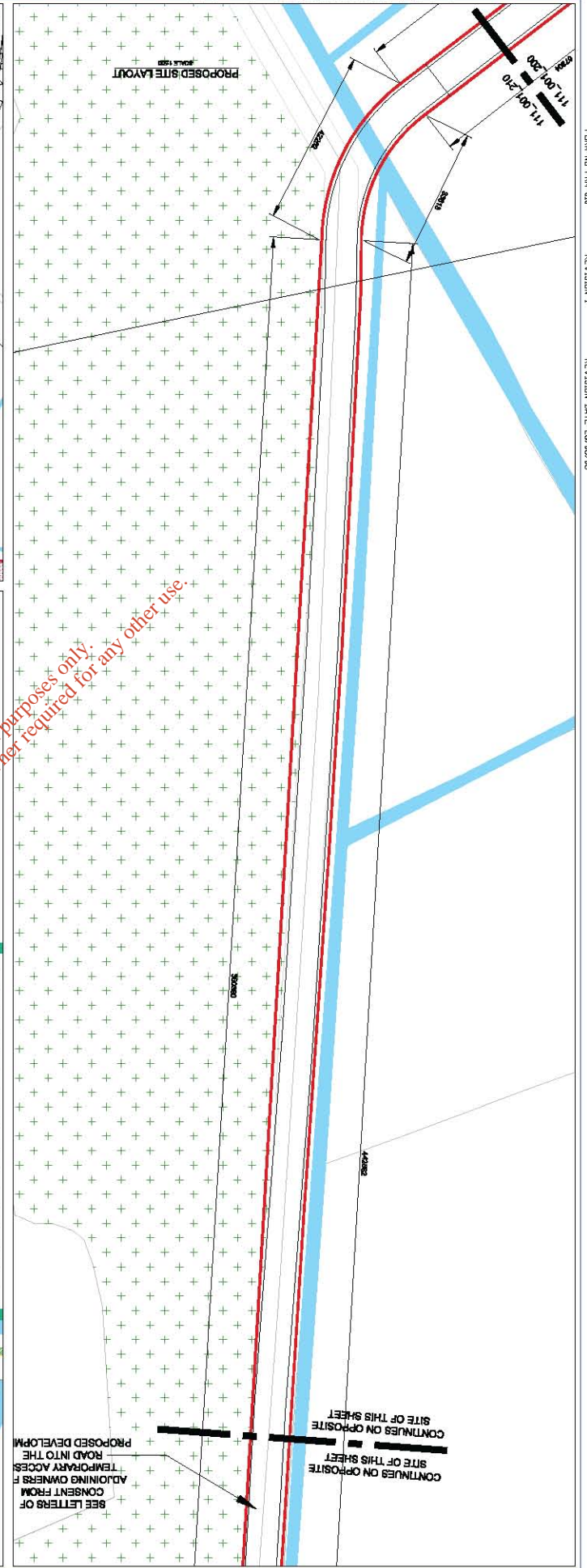
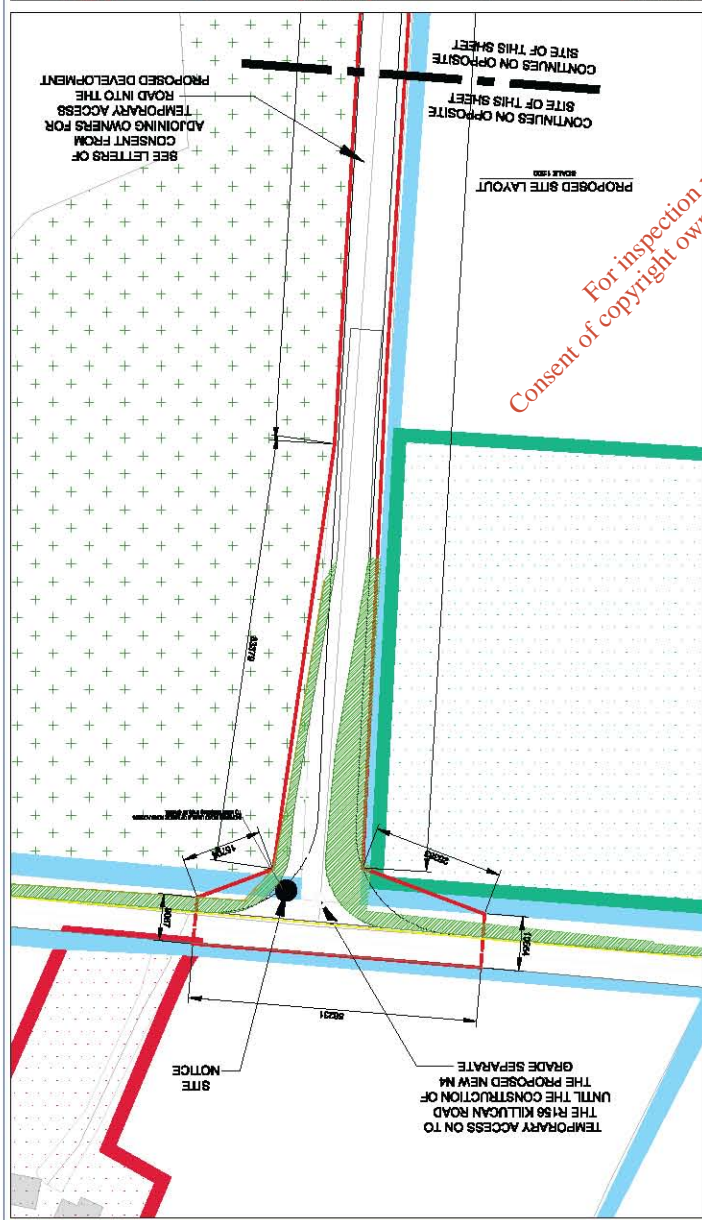
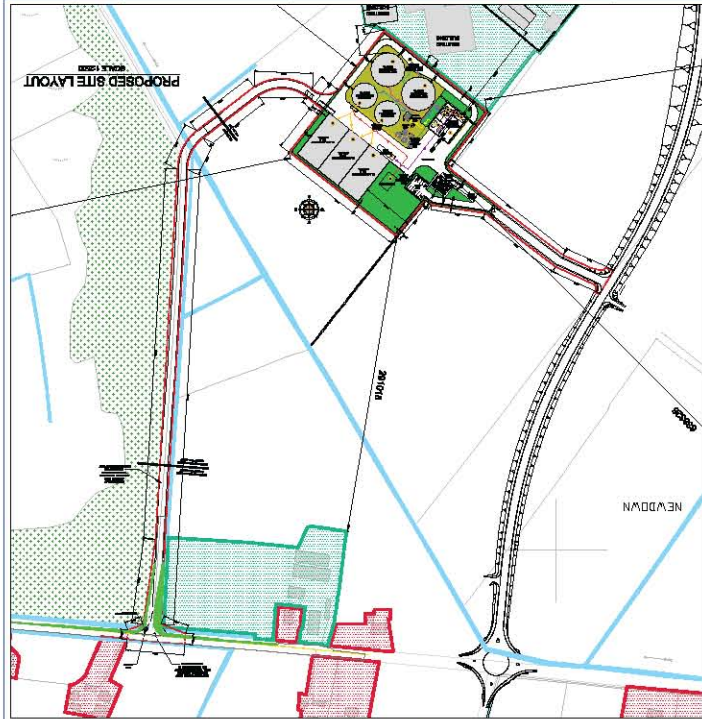

For inspection purposes only.
 Consent of copyright owner required for any other use

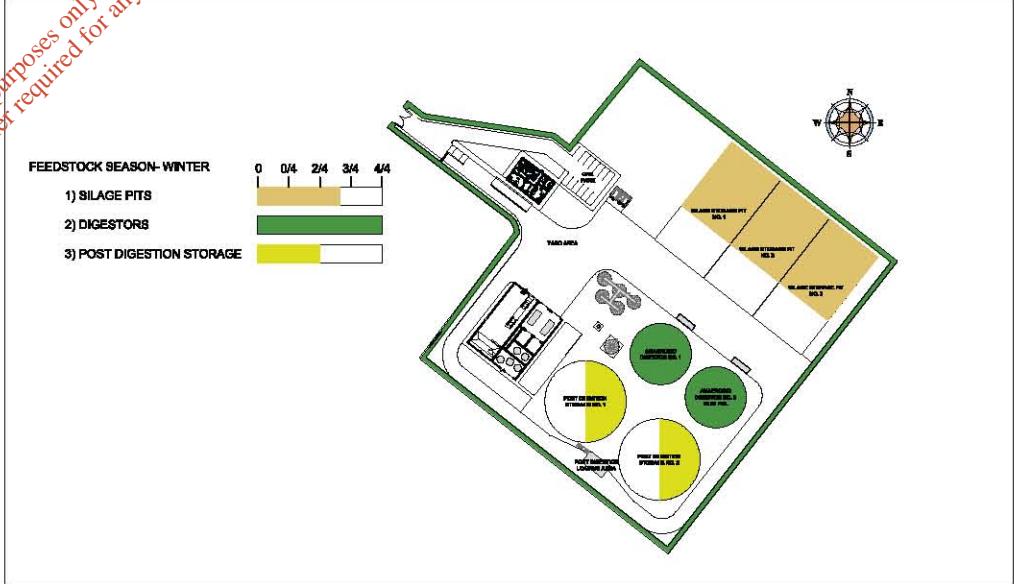
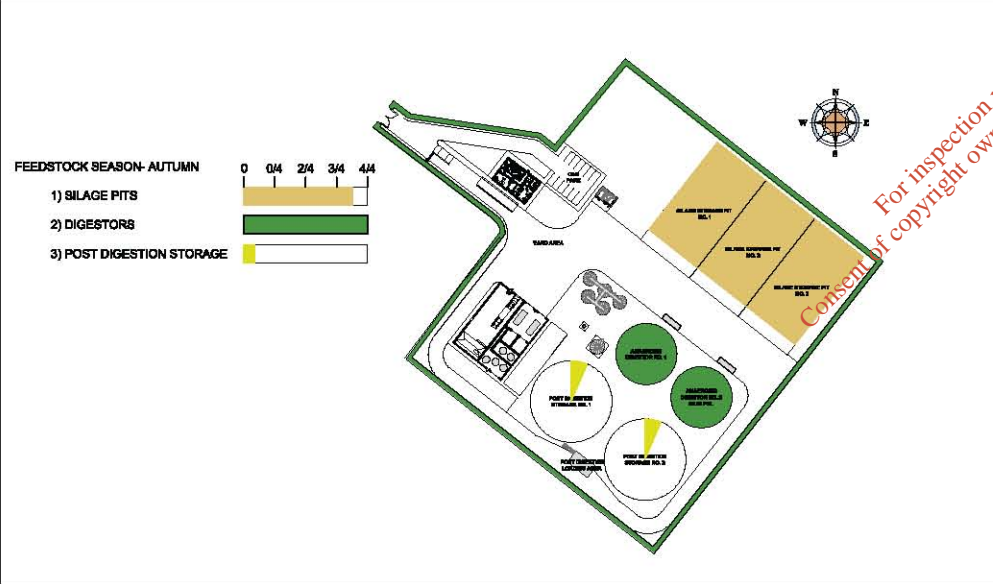
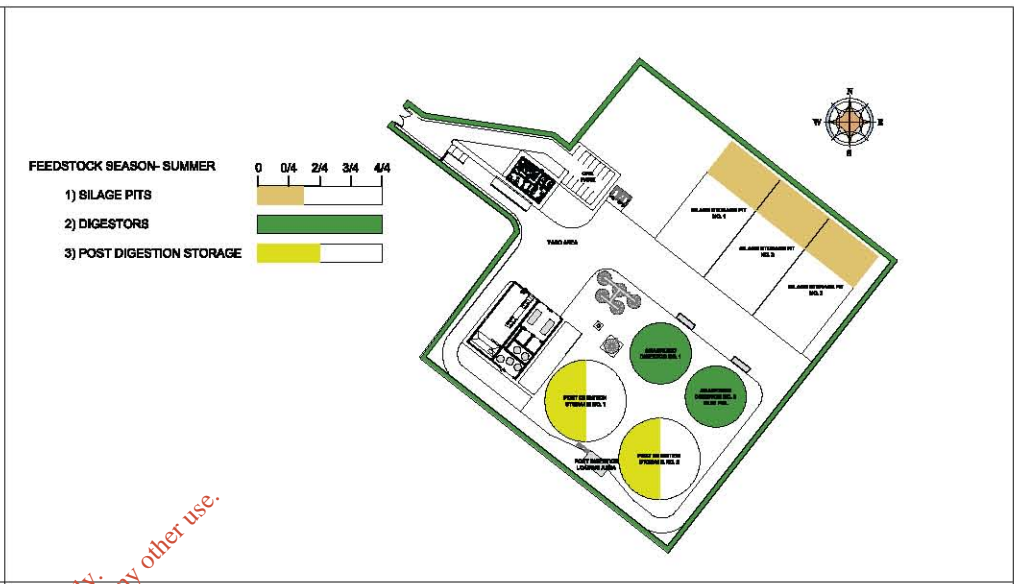
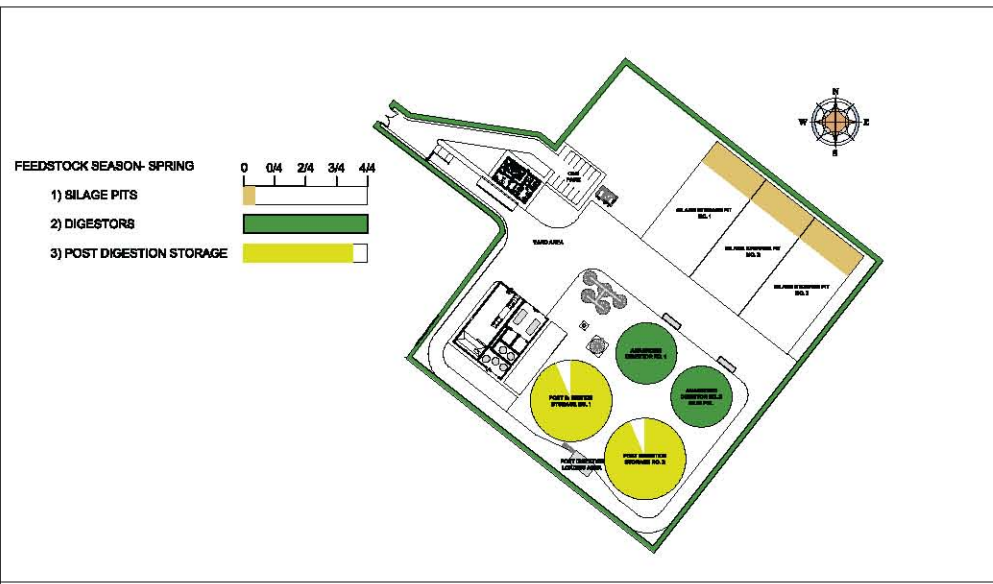

Consent of copyright owner required for any other use.
For inspection purposes only.

FOR ILLUSTRATION PURPOSES ONLY

Copyright and ownership of this drawing is vested in Marlin Architects a trading name of Orla's Build & Associate Limited, whose prior written consent is required for the reproduction or publication in any third party.
All rights reserved by the stated copyright and by the traditional copyright conventions are reserved to Marlin Architects and may be protected by court proceedings for damages and/or injunction and costs.
This drawing is liability for use for the proposed development and may not be used otherwise without consent. Do not scale, use figured dimensions only.

REV	INIT	DESCRIPTION
D1	CB	ISSUED FOR PLANNING
REV	INIT	DESCRIPTION

marlin architects
DESIGN-ARCHITECTURE-PLANNING-PROJECT MANAGEMENT

PROJECT: PROPOSED BIOENERGY FACILITY AT NEWDOWNS, THE DOWNS, MULLINGAR, CO. WESTMEATH
CLIENT: BIO AGRIGAS LTD.

marlin@marlin.ie
mullingar
100, westmeath
Tel: 044 9348200
Fax: 044 9348205
Email: info@marlin.ie

DRAWING NO.	111/001/211	REV.	D1	DESIGN	CB
AMENDMENT DATE		PAPER	A2	CHECKED	
DRAWING TITLE	PROPOSED FEEDSTOCK SEASONS	SCALE	NTS	DATE	02/04/2011
		STATE	PLANNING		

- ### BIO ENERGY PROCESS
- 1 DELIVERY AREA
 - 2 WASTE RECEPTION AREA
 - 3 MIXING TANK
 - 4 HYDROLISYS
 - 5 PRE STORAGE TANKS
 - 6 ANAEROBIC DIGESTERS
 - 7 GAS CLEANING VESSEL
 - 8 FLARE
 - 9 ENGINES
 - 10 HYGIENISATION AREA
 - 11 POST DIGESTION STORAGE
 - 12 POST DIGESTION LOADING AREA
 - 13 SILAGE STORAGE TANKS
 - 14 SLURRY TANKS
 - 15 LEACHATE TANK

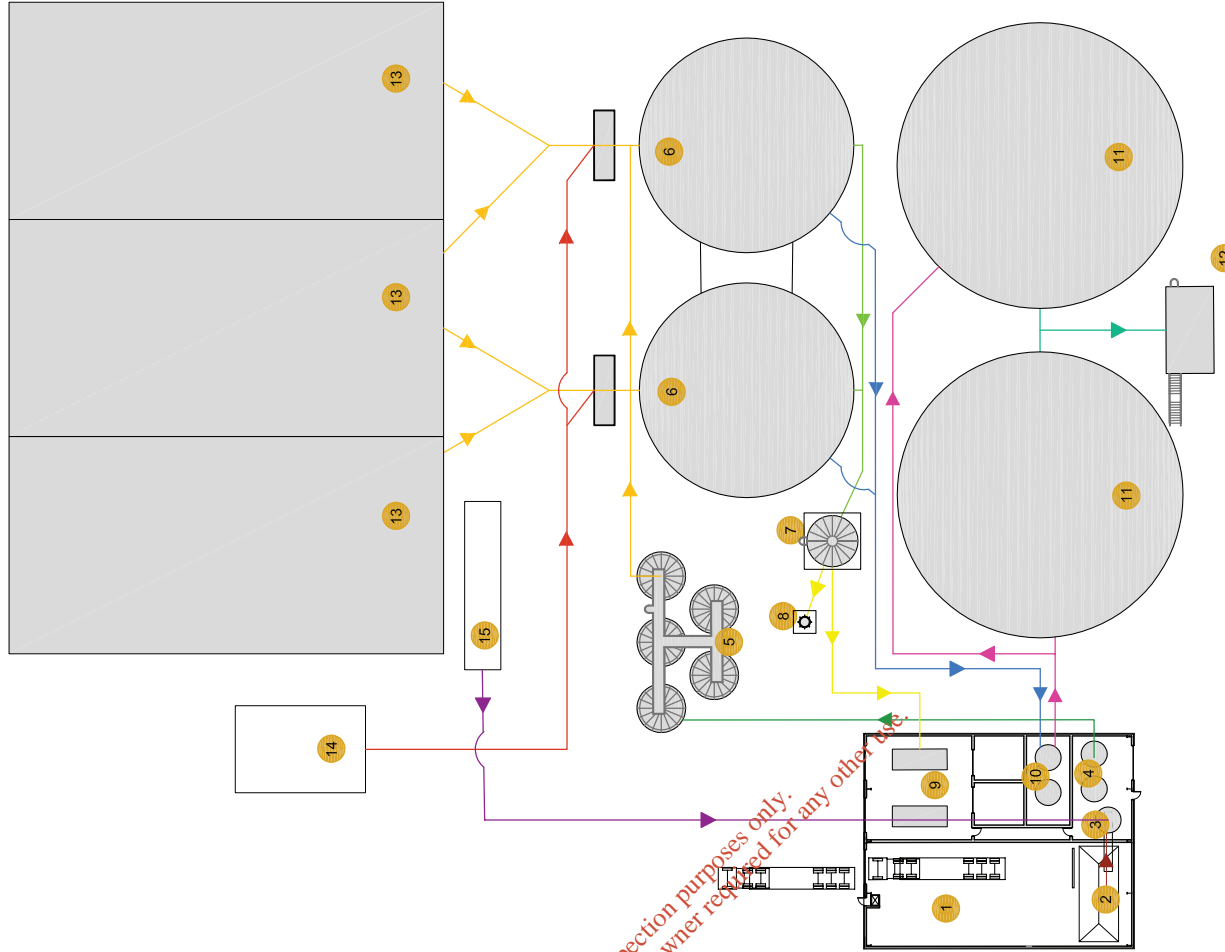
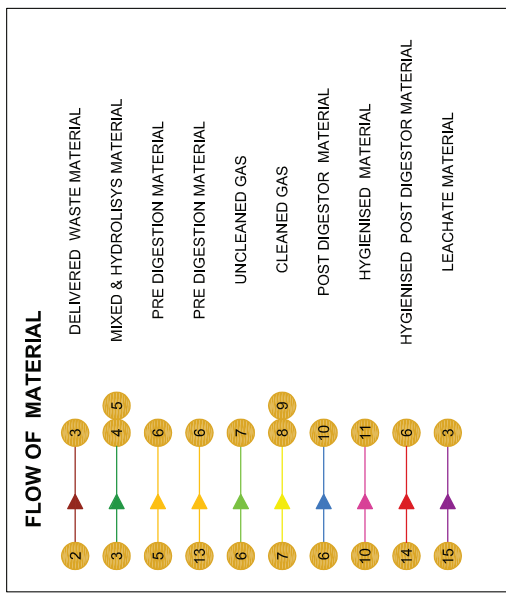

<p>   </p> <p> PROJECT TITLE: PROPOSED BIOENERGY FACILITY AT NEWDOWNS, THE DOWNS, MILLINGAR, CO. WESTMEATH CLIENT: BIO AGRIGAS LTD. </p>		<p> DRAWING NO: 111/001/214 AMENDMENT DATE: </p>	<p> REV: D1 CHECKED: AS DRAWN: CB </p>	<p> DATE: 02/04/2011 APPROVAL: NTS PLANNING </p>
<p> REV INT DESCRIPTION D1 CB ISSUED FOR PLANNING </p>		<p> REV INT DESCRIPTION PROPOSED PROCESS MAP </p>		
<p> REV INT DESCRIPTION (Empty) </p>		<p> REV INT DESCRIPTION (Empty) </p>		
<p> REV INT DESCRIPTION (Empty) </p>		<p> REV INT DESCRIPTION (Empty) </p>		
<p> REV INT DESCRIPTION (Empty) </p>		<p> REV INT DESCRIPTION (Empty) </p>		