



**ANNUAL ENVIRONMENTAL REPORT**  
**FOR GREENSTAR LTD**  
**GREENOGUE MATERIALS RECOVERY FACILITY**  
**LICENCE NO. W0188-01**  
**JANUARY 2010 – DECEMBER 2010**

**Prepared For: -**

Greenstar Ltd.,  
Unit 6,  
Ballyogan Business Park,  
Ballyogan Road,  
Sandyford,  
Dublin 18.

**Prepared By: -**

O' Callaghan Moran & Associates,  
Granary House,  
Rutland Street,  
Cork.

**30<sup>th</sup> March 2011**

Project		Annual Environmental Report 2010		
Client		Greenstar Ltd. W0188-01		
Report No	Date	Status	Prepared By	Reviewed By
0481205	22/03/2011	Draft	Martina Gleeson PhD	Michael Watson MA.
0481205	30/03/2011	Final	Martina Gleeson PhD	Michael Watson MA.

---

# TABLE OF CONTENTS

---

	<u>PAGE</u>
<b>1. INTRODUCTION.....</b>	<b>1</b>
<b>2. SITE DESCRIPTION .....</b>	<b>2</b>
2.1    SITE LOCATION & LAYOUT .....	2
2.2    WASTE MANAGEMENT ACTIVITIES .....	2
2.2.1    Waste Types & Processes.....	2
2.2.2    Plant List .....	3
<b>3. EMISSION MONITORING .....</b>	<b>4</b>
3.1    SURFACE WATER MONITORING .....	4
3.2    WASTEWATER MONITORING .....	5
3.3    NOISE SURVEY .....	6
3.4    DUST MONITORING .....	6
<b>4. SITE DEVELOPMENT WORKS .....</b>	<b>10</b>
4.1    SPECIFIED ENGINEERING WORKS .....	10
4.2    SUMMARY OF RESOURCE & ENERGY CONSUMPTION .....	10
4.3    TANK & PIPELINE INTEGRITY TESTING .....	10
<b>5. WASTE RECEIVED AND CONSIGNED FROM THE FACILITY .....</b>	<b>11</b>
<b>6. ENVIRONMENTAL INCIDENTS AND COMPLAINTS .....</b>	<b>15</b>
6.1    INCIDENTS .....	15
6.2    REGISTER OF COMPLAINTS.....	15
<b>7. ENVIRONMENTAL DEVELOPMENT .....</b>	<b>16</b>
7.1    ENVIRONMENTAL MANAGEMENT PROGRAMME REPORT .....	16
7.1.1    Site Management Structure .....	16
7.1.2    Staff Training.....	17
7.2    ENVIRONMENTAL MANAGEMENT PROGRAMME PROGRESS REPORT & PROPOSAL....	17
7.2.1    Schedule of Objectives 2010 –Progress Report .....	17
7.2.2    Schedule of Objectives 2011 – Proposal.....	19
7.3    COMMUNICATIONS PROGRAMME .....	20
7.4    NUISANCE CONTROLS .....	20
7.5    WASTE RECOVERY REPORT .....	20
7.6    REPORT FINANCIAL PROVISION.....	21
7.7    WASTEWATER VOLUME PRODUCED AND TRANSPORTED OFF-SITE .....	21
7.8    EUROPEAN POLLUTANT RELEASE AND TRANSFER REGISTER.....	21
<b>8. OTHER REPORTS.....</b>	<b>22</b>

**APPENDIX 1**                      Procedures List

**APPENDIX 2**                      European Pollutant Release and Transfer Register

---

# 1. INTRODUCTION

---

This is the 2010 Annual Environmental Report (AER) for the Greenstar Ltd. (Greenstar), Materials Recovery Facility (MRF) located at Site 14B, Phase 3, Road 3A, Greenogue Industrial Estate, Rathcoole, County Dublin.

The AER covers the period from the 1<sup>st</sup> January 2010 to the 31<sup>st</sup> December 2010. The content is based on Schedule F of the Waste Licence (W0188-01) and the format follows guidelines set in the “Guidance Note for Annual Environmental Report” issued by the Agency<sup>1</sup>.

---

<sup>1</sup> EPA (Environmental Protection Agency) 1999 Waste Licensing – Draft Guidance on Environmental Management Systems and Reporting to the Agency

---

## 2. SITE DESCRIPTION

---

### 2.1 Site Location & Layout

The site, which encompasses an area of 0.603 ha, is located within the Greenogue Industrial Estate, Rathcoole. The facility comprises one waste transfer building and ancillary infrastructure, including administration offices, weighbridge, vehicle wash and paved open yard areas.

### 2.2 Waste Management Activities

The licence allows Greenstar to accept and process 95,000 tonnes of waste per annum consisting of non-hazardous Commercial & Industrial (C&I), Construction and Demolition (C&D) and Household waste. All waste processing takes place inside the waste transfer building as specified in Condition 5.1 of the licence.

#### 2.2.1 Waste Types & Processes

The facility is licensed to accept the following waste types and quantities, as specified in Schedule A of the licence: -

- Household (15,000 tonnes),
- Commercial (37,500 tonnes),
- Industrial (5,000 tonnes),
- Construction & Demolition (37,500 tonnes).

The maximum tonnage of each waste type accepted, may be altered with the prior agreement of the Agency as long as the total maximum tonnage is not exceeded.

The key processes carried out at the facility include: -

- Segregation of C&I into different waste streams (paper, cardboard, glass, metal, green waste and wood) for further recovery at an appropriate facility
- Segregation of C&D into clean & dirty waste streams for further recovery purposes

- Bulking up of domestic wastes (mixed municipal waste & dry mixed recyclables) for further recovery or disposal at an appropriate off-site facility.

### *Household Waste*

Residual or black bin waste delivered in refuse collection vehicles is transferred to large bulk transporters and is then sent to an appropriate licensed landfill. Greenstar also provides a skip hire service to private individuals. All skips arriving at the facility are netted or covered. Recyclable material is segregated, where possible, from the waste and transferred off-site to suitable licensed or permitted recycling facilities. The remaining non-recyclable and residual material is sent to licensed landfills post processing.

### *Commercial and Industrial Waste*

Greenstar provides skips of various sizes to a wide range of commercial and industrial premises. Recyclable material (paper, cardboard, glass, metal, green waste and wood) is segregated, where possible, from the waste stream and transferred to suitable recycling facilities. The remaining non-recyclable and residual material is sent to licensed landfills. Biodegradable wastes suitable for composting which is accepted at the facility are sent to an offsite composting facility.

### *Construction and Demolition Waste*

Construction and demolition material arrives on-site in skips of varying sizes. The loads are inspected and segregated on-site. Recoverable materials are extracted and sent off-site either for re-use or recycling. The non-recyclable materials are transferred to a licensed landfill.

### *2.2.2 Plant List*

A list of the plant in use at the facility is given in Table 2.1. The plant provides 100% duty and 50% standby for waste processing.

**Table 2.1 Existing Plant**

<b>No.</b>	<b>Plant</b>	<b>Model</b>	<b>Operational Capacity</b>
1	Loading Shovel	Volvo	70t/hr
1	Fork Lift	Toyota	60 hr/wk
1	Grab	Liebherr 360	25t/hr
1	Weighbridge – 2 scales	Avery Berkel	56hr wk

---

### 3. EMISSION MONITORING

---

Greenstar implements a comprehensive environmental monitoring programme to assess the significance of emissions from site activities. The programme includes surface water, wastewater, noise and dust monitoring. The monitoring locations are shown on Figure 3.1 and 3.2. The results are reported to the Agency at quarterly intervals. An overview of the monitoring results is presented in this Section, with summary data included.

#### 3.1 Surface Water Monitoring

Surface water run-off is confined to run-off from the roofed area of the waste transfer building and run-off from the paved yards and is completely dependant on rainfall. Prior to discharge the surface water is treated by a Class 1 petrol/oil interceptor which is maintained regularly throughout the year.

The sampling and analysis was carried out in accordance with recognised quality assurance and control procedures. The range of analysis was as specified in Schedule D of the licence and included Biological Oxygen Demand (BOD), Chemical Oxygen Demand (COD), suspended solids (TSS), pH, electrical conductivity, mineral oils, total nitrogen and total ammonia. The results are presented in Table 3.1, which includes the trigger levels and Emission Limit Values (ELVs) set in the licence.

With the exception of the BOD level (28 mg/l) in the 3<sup>rd</sup> Quarter, which marginally exceeded the trigger level (25 mg/l), the discharge complied with the trigger levels and ELVs set in the licence. The other parameters were below the ELV and trigger limits. The surface water run-off discharges to the storm drain serving the industrial estate. It is considered unlikely that the slightly elevated BOD resulted in significant impact on the quality of the water in the storm drain.

**Table 3.1:** Surface Water Monitoring Results 2010

Parameter	Units	Q1	Q2	Q3	Q4	Trigger Levels	Emission Limit
pH	pH units	8.21	8.01	8.23	7.07	N/A	N/A
Temperature	°C	10.5	13.9	15	12.9	N/A	N/A
Conductivity	mS/cm	0.838	0.752	0.731	0.559	N/A	N/A
Total Ammonia	mg/l	8.9	11.6	11.4	1.3	N/A	N/A
BOD	mg/l	18	21	28	22	25	N/A
COD	mg/l	63	45	73	111	N/A	N/A
Total Suspended Solids	mg/l	30	28	29	30	35	N/A
Total Nitrogen	mg/l	62	12	12	3	N/A	N/A
Mineral Oils	mg/l	<0.01	<0.01	<0.01	<0.01	N/A	5

### 3.2 Wastewater Monitoring

Waste water is generated from vehicle washing at the facility and from the floor of the MRF building. The wash water is directed to a silt trap and then to a petrol/oil interceptor before discharging to the municipal sewer.

The sampling and analysis was carried out in accordance with recognised quality assurance and control procedures. The range of analysis was as specified in Schedule D of the Waste licence and included BOD, COD, suspended solids, pH, ammoniacal nitrogen, sulphate, fats, oils and greases and detergents. The samples were compared to the ELVs set in the licence. The results, which are presented in Table 3.2, confirmed 100% compliance with the ELVs.

**Table 3.2:** Wastewater Monitoring Results 2010

Parameter	Units	Feb '10	Apr '10	June '10	Aug '10	Nov '10	Dec '10	Emission Limit
pH	pH units	7.42	7.16	6.77	7.86	6.82	8.50	6 – 10
Temperature	°C	14.5	10.1	13.6	15.4	13.3	13.0	42
Sulphate	mg/l	3.2	<0.05	<0.05	83.78	18.48	8.78	1,000
BOD	mg/l	369	540	264	93	114	208	3,000
COD	mg/l	792	1040	616	337	372	408	6,000
Total Suspended Solids	mg/l	162	139	130	117	1515	685	2,000
Oils, Fats & Greases	mg/l	2.398	0.768	0.820	0.102	<0.01	<0.01	100
Ammoniacal Nitrogen	mg/l	7.47	12.08	15.94	11.08	39.53	2.54	100
Detergents (as MBAS)	mg/l	0.6	0.4	1.1	0.5	0.4	0.5	100



### 3.3 Noise Survey

The annual noise survey was conducted in accordance with Schedule D3 of the licence on the 10<sup>th</sup> August 2010 at the three on-site, N-1, N-2 and N-3 one off-site noise sensitive location, NSL-1. The ELV specified in the licence (55 dB(A) LA<sub>eq</sub>(30 minutes)) relates only to NSL-1.

The survey was conducted when the site was fully operational and the results confirmed that the facility was in full compliance with its licence requirements. Noise emission from the facility were not audible above 55 dB(A) LA<sub>eq 30min</sub> at the nearest noise sensitive location. The results are included on Table 3.3.

**Table 3.3:** Noise Monitoring Results 2010

Station	Time	LAeq 30 min dB	LAF10 30 min dB	LAF90 30 min dB	Specific level* dB	Noise audible
N1	1443- 1513	62	60	46	55-60	Greenstar emissions audible continuously. Truck movements through entrance dominant when present. Emissions also audible occasionally from adjacent premises. Overflights dominant when present.
N2	1417- 1447	66	69	44	<44	Site emissions (chiefly front end loader in building and manoeuvring trucks) dominant until 1420 when quietened. Thereafter noise emissions from premises and traffic across industrial estate audible. Overflights dominant when present.
N3	1407- 1437	63	63	45	45-50	Plant operating in building dominant until shut down at 1420. Thereafter air handling emissions at adjacent premises and rustling vegetation only sources audible, apart from overflights.
NSL1	1530- 1601	62	63	39	<39	No emissions audible from facility, apart from possible reversing alarm arising occasionally from commercial estate in which facility located, specific source unknown, and not significant. Intermittent local traffic and occasional overflights dominant when present. Silage cutting operation to N slightly audible continuously. Rustling vegetation & birdsong. Paused for 1 min at 1554 due to local intrusion.

\* Specific level: Sound pressure level contribution considered attributable to facility.

### 3.4 Dust Monitoring

Dust monitoring was carried out on three occasions at four on-site locations (DS-01, DS-02, DS-03 and DS-04) in April, July and August 2010. The results of the monitoring are included on Table 3.4. There was 100% compliance with the dust deposition limit set in the licence (350 mg/m<sup>2</sup>/day).

**Table 3.4:** Dust Monitoring Results 2010

	<b>April '10 mg/m<sup>2</sup>/day</b>	<b>July '10 mg/m<sup>2</sup>/day</b>	<b>August '10 mg/m<sup>2</sup>/day</b>	<b>Dust Deposition Limit mg/m<sup>2</sup>/day</b>
DS-01	131.4	55.7	38.0	350
DS-02	74.7	110.2	249.2	350
DS-03	148.3	108.5	210.6	350
DS-04	146.6	37.3	74.0	350

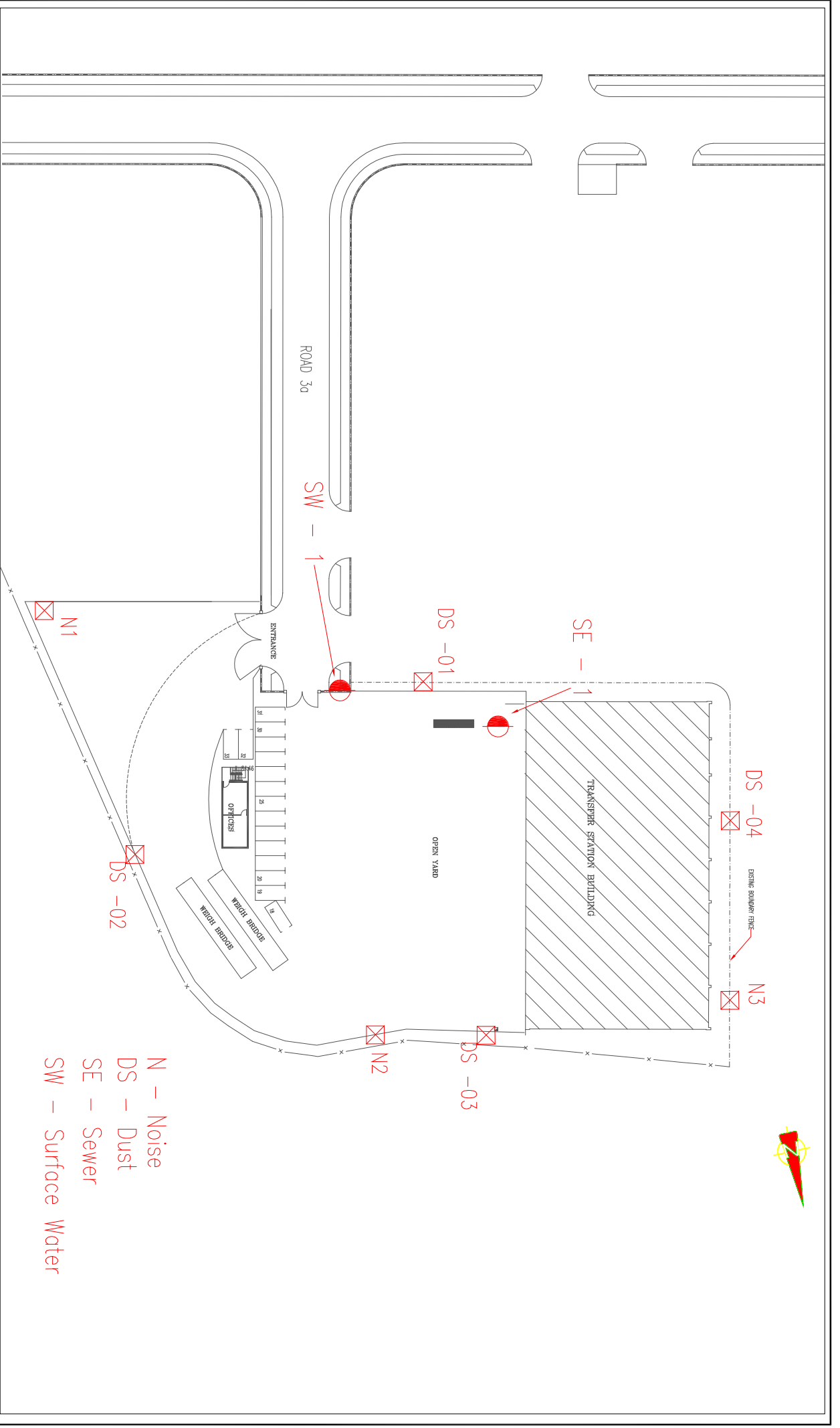

- N – Noise
- DS – Dust
- SE – Sewer
- SW – Surface Water

  
 O' Callaghan Moran & Associates.  
 Granary House, Rutland Street,  
 Cork, Ireland.  
 Tel: (021) 4321521 Fax: (021) 4321522  
 email : info@ocallaghannmoran.com

**CLIENT**  
 GREENSTAR GREENOGUE  
**TITLE**  
 Monitoring Locations

**DRAWING No.**  
 3.1  
**SCALE**  
 NTS  
 A3  
**REV.**

**NOTES**  
**Grid References:**  
 N1: E3002160, N277977  
 N2: E3002316, N229041  
 N3: E3002318, N228122  
 SW-1: E3002113, N228058  
 SE-1: E3002231, N228101  
 DS-01: E3002217, N229006  
 DS-02: E3002237, N227986  
 DS-03: E3002323, N229072  
 DS-04: E3002269, N228137

This drawing is the property of O'Callaghan Moran & Associates and shall not be used, reproduced or disclosed to anyone without the prior written permission of O'Callaghan Moran & Associates and shall be returned upon request.

Figure 3.2 – Noise Sensitive Location

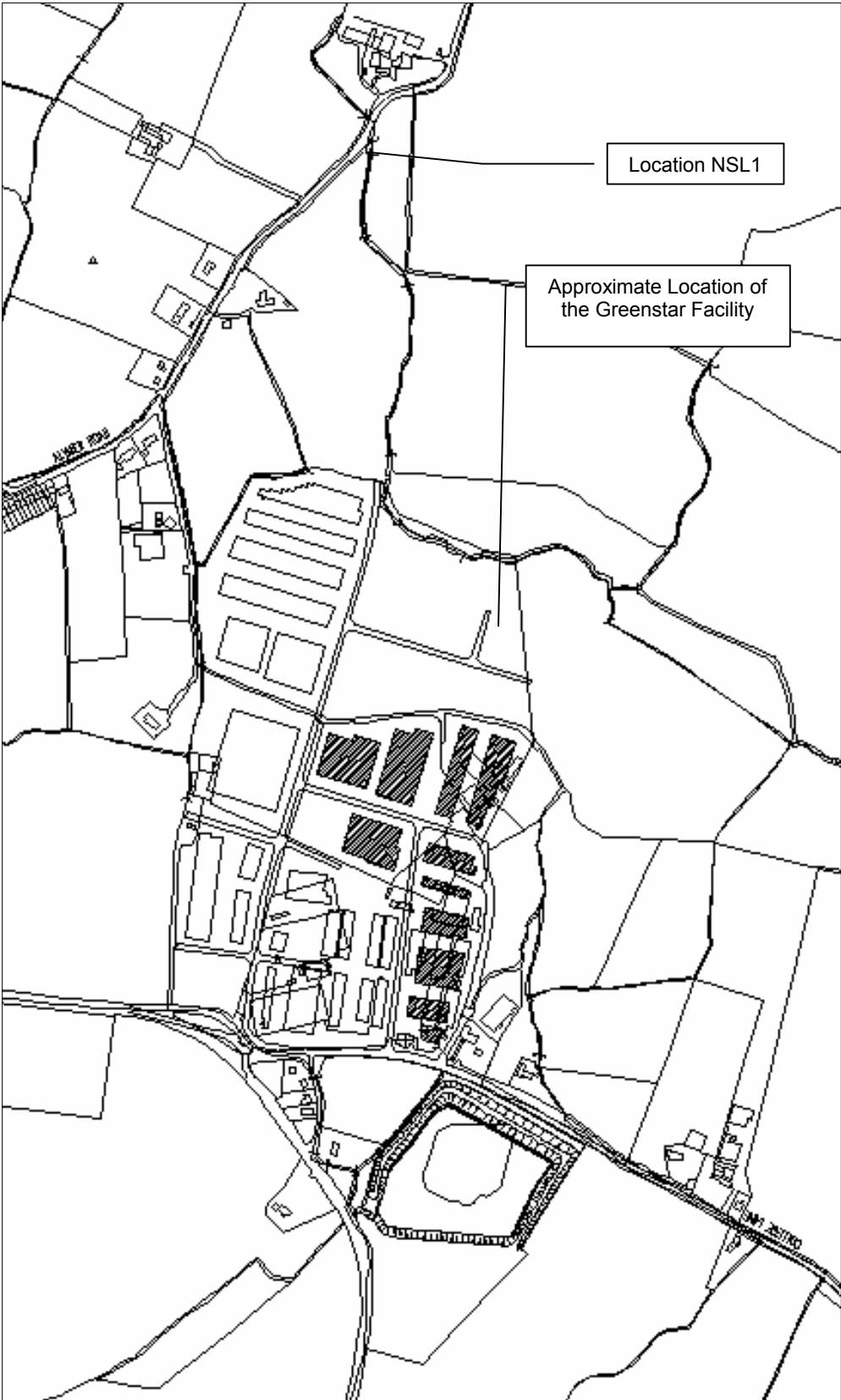

---

## 4. SITE DEVELOPMENT WORKS

---

### 4.1 Specified Engineering Works

No Specified Engineering Works (SEW) were carried out during the reporting period.

### 4.2 Summary of Resource & Energy Consumption

Table 4.1 presents an estimate of the resources used on-site during the reporting period.

**Table 4.1 Estimate of Resources Used On-Site**

<b>Resources</b>	<b>Quantities</b>
Diesel	42,000 litres
Truck Wash	190 litres
Engine Oil	50 litres
Electricity	68,300 kWh

### 4.3 Tank & Pipeline Integrity Testing

Condition 3.11.8 of the licence requires tank, drum, pipeline and bund testing to be carried out every three years. This testing was carried out in 2009 and confirmed the integrity of the infrastructure was fit for purpose. Testing was not required in the reporting period.

---

## **5. WASTE RECEIVED AND CONSIGNED FROM THE FACILITY**

---

Table 5.1 shows the total quantities of waste received and consigned from the facility in 2010 with data for 2009 and previous years presented in Tables 5.2 and 5.3. A breakdown of the waste types is provided in accordance with the European Waste Catalogue and Hazardous Waste list.

The total quantity of waste received at the facility was 50,562.66 tonnes. The total waste consigned was 49,688.29 tonnes. The difference is due to waste remaining on site at the end of 2010, which will be consigned in 2011 (approximately 150 tonnes) and the weight of rainwater present in skips arriving at the facility.

As per Condition 5.4.1 of the licence all the wastes consigned from the site went to recovery and disposal facilities and a copy of the relevant Facility Permit or Waste Licence, types and quantities retained on site for Agency inspection. The recovery rate for the facility was 56.68%.

**Table 5.1 Waste Received & Consigned 2010**

<b>EWC</b>	<b>Description</b>	<b>Waste In</b>	<b>Waste Out</b>
13 05 03*	Interceptor Sludge		24.00
15 01 01	Cardboard & Paper Packaging	2,980.00	3,262.36
15 01 02	Plastic Packaging	65.00	119.05
15 01 03	Wooden Packaging	184.00	1,467.00
15 01 04	Metallic Packaging	4.00	
15 01 06	Mixed Packaging	4,608.00	3,909.70
15 01 07	Glass Packaging	1.00	
16 05 04*	Gas Cylinders		0.34
17 01 01	Concrete from C&D Waste	8.00	
17 01 07	Mixture of concrete, bricks, tiles, ceramics from C&D Waste	2,352.00	2,561.00
17 02 01	Wood from C&D Waste	27.00	
17 04 01	Copper, brass, bronze from C&D Waste	0.20	
17 05 04	Soil & Stone from C&D Waste	1,465.00	2,244.40
17 08 02	Gypsum based construction material	4.00	
19 08 99	Bio Plant Residual Solids	11.00	
19 09 05	Resin	7.00	
19 12 07	Processed Wood	6.00	
19 12 12	Mixed Residual Waste from mechanical treatment	16,916.00	20,738.16
20 01 01	Paper & Cardboard	21.00	15.00
20 01 02	Glass	2.00	
20 01 08	Commercial Food Wastes	3,051.00	2,535.30
20 01 33*	Batteries		1.00
20 01 35*	WEEE	0.20	
20 01 38	Wood from municipal sources	1,422.00	569.00
20 01 39	Plastic from municipal sources	18.00	8.52
20 01 40	Metal from municipal sources	475.00	696.00
20 02 01	Biodegradable garden & park waste	1,535.00	1,351.00
20 03 01	Mixed Residual Waste	3,021.00	
20 03 07	Bulky Waste	12,380.00	10,184.73
	<b>Total Received</b>	<b>50,563.40</b>	
	<b>Total Consigned</b>		<b>49,686.56</b>
	<b>Total Recovered</b>		<b>28,163.80</b>
	<b>Total Disposed</b>		<b>21,522.76</b>
	<b>Recovery Rate</b>		<b>56.68%</b>

**Table 5.2 Waste Received & Consigned in 2009**

<b>EWC</b>	<b>Description</b>	<b>Waste In</b>	<b>Waste Out</b>
15 01 01	Cardboard Packaging	1,668.10	1,975.24
15 01 02	Plastic Drum Lid		2.92
	Drum Pizza Base		20.11
	Plastic Packaging	92.88	118.18
	Polystyrene	0.08	7.06
15 01 03	Pallets	138.36	103.30
	Wooden Packaging	334.13	2,009.62
15 01 04	Aluminium	3.30	
	Metal	2.87	
15 01 06	Mixed Packaging	4,210.78	3,748.61
15 01 07	Mixed Glass	9.22	
16 05 04*	Gas Cylinders		1.82
16 06 01*	Battery Lead Acid		1.06
17 01 07	C&D Inert Mixed	3,471.05	4,868.45
17 02 01	Wood		24.94
17 04 11	Cable	1.74	
17 05 04	C&D Inert Mixed	1,181.78	
	Soil & Stones	56.54	1,126.85
17 08 02	Plasterboard	41.02	32.68
19 09 05	Resin	53.66	
19 12 07	Wood		43.48
19 12 12	C&I Dry Mixed	4.92	8,720.80
	MSW Municipal Mixed	425.23	24,661.84
20 01 01	Cardboard & Paper	20.15	8.88
	Cardboard Packaging	16.68	
	Newsprint	2.68	
	Recy Confidential	8.58	
	Recy Paper	30.59	
20 01 02	Glass	6.92	
20 01 08	Kitchen and Canteen Waste	2,377.68	
	Biodegradable Waste		1,631.11
20 01 11	Textile	0.05	
20 01 33*	Batteries		1.06
20 01 38	Wood	1,880.11	440.10
20 01 39	Trays	2.51	
	Metallised CDs	2.86	
	Plastic	109.40	
	CDs for shredding		13.98
20 01 40	Metal	729.20	885.14
20 02 01	Green Biodegradable Waste	1,685.66	1,604.26
	Green Mixed	151.84	
20 03 01	MSW Municipal Mixed	20,212.32	
20 03 07	C&I Dry Mixed	13,539.58	
	<b>Total Received</b>	<b>52,472.47</b>	
	<b>Total Consigned</b>		<b>52,051.49</b>
	<b>Total Recovered</b>		<b>34,438.81</b>
	<b>Total Disposed</b>		<b>17,612.68</b>
	<b>Recovery Rate</b>		<b>66%</b>



**Table 5.3** Previous Waste Consignments

<b>Description</b>	<b>2009</b>	<b>2008</b>	<b>2007</b>	<b>2006</b>	<b>2005</b>	<b>2004</b>
<b>Total Received</b>	52,472.47	68,661.96	63,481.24	51,767.97	1,540.48	461.27
<b>Total Consigned</b>	52,051.49	66,758.24	60,776.28	51,175.53	1,400.66	411.80
<b>Total Recovered</b>	34,438.81	47,753.48	58,200.63	36,183.96	1,010.15	368.04
<b>Total Disposed</b>	17,612.68	19,004.86	2,575.65	15,093.39	390.51	43.76
<b>Recovery Rate</b>	66%	71.53%	95.76%	71%	72%	89%

---

## **6. ENVIRONMENTAL INCIDENTS AND COMPLAINTS**

---

### **6.1 Incidents**

In the third quarter, the BOD level (28 mg/l) marginally exceeded the trigger level set in Condition 6.3.2 of the licence (25 mg/l). The levels of the other parameters were below the ELV and trigger limits. The Agency, South Dublin County Council and the Eastern Region Fisheries board were notified of this incident on the 20<sup>th</sup> August 2010. There were no other incidents at the facility in 2010.

### **6.2 Register of Complaints**

Greenstar maintains a register of complaints received in accordance with Condition 10.4 of the waste licence. No complaints were received during the reporting period.

---

## 7. ENVIRONMENTAL DEVELOPMENT

---

### 7.1 Environmental Management Programme Report

In 2010, the facility attained ISO 14001/OHSAS 18001 certification. The facility is externally audited annually and internally audited twice per year. The management programme in the Environmental Management System (EMS) contains a schedule for achieving objectives and targets and designates responsibility and timeframes for achieving those targets. The EMS is reviewed annually as part of the annual management review meeting during which senior management attend.

The schedule of Objectives and Targets, including their status for 2010 (Table 7.1), as well as the proposed Objectives and Targets for 2011 (Table 7.2) are presented below. An index of procedures used at the facility is included in Appendix 1.

#### 7.1.1 Site Management Structure

Management and Staffing structure: -

**Name:** Aidan Shanahan

**Responsibility:** Head of Leinster MRF Operations; overall responsibility for the running of the business including environmental compliance

**Experience:** 8 years working in the waste management industry and 16 years operational management experience; has completed the FAS Waste Management Course

**Name:** James Sowray

**Responsibility:** Operations Manager; overall responsibility for the day to day site operations of the site including environmental compliance

**Experience:** 10 years working in operations management; has completed the FAS Management Course

**Name:** Jonathon O'Keeffe (Nominated Deputy)

**Responsibility:** Dispatch Manager

**Experience:** 8 years working in waste management; has completed the FAS Management Course

### 7.1.2 *Staff Training*

No training was required during the year.

## 7.2 **Environmental Management Programme Progress Report & Proposal**

### 7.2.1 *Schedule of Objectives 2010 –Progress Report*

The objectives that were achieved during this reporting period are outlined in Table 7.1 and the progress summarised below.

#### **Objective 1 – Awareness and Training**

Environmental training is carried out as part of the ISO 14001. This is inclusive of spill training.

#### **Objective 2 – Energy & Resource Consumption**

Electricity consumption decreased in 2010, this is mainly due to a decrease in the number of office staff at the facility and the movement of overnight security to an off-site location.

#### **Objective 3 – Review and Assess the Effectiveness of Nuisance Control Procedures**

The facility did not cause a nuisance. The nuisance control procedures are effective and routinely audited both internally and externally.

#### **Objective 4 – Pollution Prevention**

The routine environmental monitoring has confirmed that the facility is not causing pollution in the local environment.

#### **Objective 5 – ISO Certification**

An integrated management system inclusive of the environmental standard ISO 14001 and health and safety standard OHSAS 18011 was installed at the facility in 2010. This system gained certification to both standards.

#### **Objective 6 – Traffic Management**

Signage at the facility was improved in 2011. Further improvements in traffic management are planned for 2011.

#### **Objective 7 – Material Storage**

Better segregation of material is now implemented at the facility and signage has also been improved.

**Table 7.1 Schedule of Objective and Targets 2010**

<b>No</b>	<b>Objective</b>	<b>Target</b>	<b>Responsibility</b>	<b>Timescale</b>
1	Awareness and Training	Continue to ensure that appropriate training is carried out specific to all site personnel as per the Company's established Training Matrix.	Site Management	Completed
		Spill training, inclusive of a spill scenario to be carried out.		
2	Energy & Resource Consumption	Summarise energy and resource usage on a quarterly basis with a view to reducing consumption	Site Management	Completed
		Review and implement findings of Energy Audit		
3	Review and Assess the Effectiveness of Nuisance Control Procedures	Continually review and assess all nuisance control procedures to ensure minimal impact on the surrounding area.	Site Management	Completed
4	Pollution Prevention	Strive to ensure that monitoring results comply with the licence limits and investigate any exceedances of emission limit values.	Site Management	Completed
		Continue to ensure the integrity and maintenance of all drainage infrastructure.		
5	ISO Certification	Continue to maintain ISO 14001 certification.	Site Management	Completed
		Review Environmental Management Procedures		
6	Traffic Management	Assess and Improve traffic management on site	Site Management	Completed
7	Material Storage	Improve waste storage and segregation infrastructure within the MRF building and define further the various waste designated areas.	Site Management	Completed

7.2.2 *Schedule of Objectives 2011 – Proposal*

The schedule of targets and objectives for 2011 are presented in Table 7.2.

**Table 7.2 Schedule of Objective and Targets 2011**

<b>No</b>	<b>Objective</b>	<b>Target</b>	<b>Responsibility</b>	<b>Timescale</b>
<b>1</b>	<b>Awareness and Training</b>	Continue to ensure that appropriate training is carried out specific to all site personnel as per the Company’s established Training Matrix.	<b>Site Management</b>	<b>Q1 2012</b>
<b>2</b>	<b>Energy &amp; Resource Consumption</b>	Summarise energy and resource usage on a quarterly basis with a view to reducing consumption	<b>Site Management</b>	<b>Q1 2012</b>
<b>3</b>	<b>Review and Assess the Effectiveness of Nuisance Control Procedures</b>	Continually review and assess all nuisance control procedures to ensure minimal impact on the surrounding area.	<b>Site Management</b>	<b>Q1 2012</b>
<b>4</b>	<b>Pollution Prevention</b>	Strive to ensure that monitoring results comply with the licence limits and investigate any exceedances of emission limit values.	<b>Site Management</b>	<b>Q1 2012</b>
<b>5</b>	<b>ISO Certification</b>	Continue to maintain ISO 14001 certification.	<b>Site Management</b>	<b>Q1 2012</b>
<b>6</b>	<b>Traffic Management</b>	Continue to improve on traffic management within the facility.	<b>Site Management</b>	<b>Q1 2012</b>

### **7.3 Communications Programme**

Greenstar are committed to setting the standard in waste management and ensuring environmental compliance in all operations. In addition, Greenstar's Environmental Policy makes a specific commitment to make the environmental policy and records available to the public and interested parties. To this end Greenstar has drawn up a Communications Programme, which details how members of the public are facilitated in accessing environmental information at the facility.

Records available for public inspection on site include:-

- Environmental Policy,
- Waste Licence,
- Licence Application and Review documentation,
- Monitoring Records,
- Complaints File,
- EPA Correspondence File.

Opening Times for Inspection of Records are from 9 am – 4 pm.

Visits to the site should be arranged in advance by ringing the Facility Manager or Supervisor at 1890 600 900.

### **7.4 Nuisance Controls**

Greenstar has contracted a vermin control company Rentokil to carry out nuisance control at the facility. Rentokil assess vermin activity on-site, along with an inspection of the bait traps that are located throughout the facility. Records are maintained onsite.

Greenstar implemented additional bird control measures in 2010. A speaker system is in operation at the facility as is a bird repellent kite which is situated on the boundary fence and has proved effective in keeping the numbers of birds at the site to a minimum.

### **7.5 Waste Recovery Report**

The facility is designed to increase the recycling of biodegradable materials and reduce the volume of waste disposed to landfill. Of the 50,563.40 tonnes of waste accepted approximately 57% was sent for recovery.

## **7.6 Report Financial Provision**

Greenstar has accrued over €3,000,000 in funds, to provide for any potential environmental liabilities. Greenstar has adequate insurance cover for environmental liabilities to €6,350,000 for any one occurrence, which will apply to “sudden identifiable and unintended incidents”.

## **7.7 Wastewater Volume Produced and Transported Off-Site**

Wastewater (truck wash and MRF floor) is directed to a silt trap and then to a petrol/oil interceptor before discharging to the municipal sewer. It is estimated that approximately 3,000 m<sup>3</sup> of wastewater was discharged to the sewer during the reporting period. During the year 24 tonnes of waste was also removed from the facility following the cleaning out of the interceptors on site.

## **7.8 European Pollutant Release and Transfer Register**

A copy of the EPRTTR return submitted to the Agency via the web-based data reporting system is included in Appendix 2.



---

## **8. OTHER REPORTS**

---

No other reports were requested by the Agency during the reporting period.

# **APPENDIX 1**

## Procedures List



<b>Doc. No.:</b> Control	<b>Revision No.:</b> As Shown	<b>Issue Date:</b> As Shown
<b>Approved By:</b>	Malcolm Dowling – Group Environmental Manager	<b>Page 1 of 2</b>
	Oliver Callan – Group H&S Manager	

**Integrated Procedures - IP**

IP-01	Document & Record Control Procedure	Rev 02, 05/02/10
IP-02	Health & Safety Risk Assessment Procedure	Rev 03, 10/03/10
IP-03	Environmental Aspects & Impacts Procedure	Rev 03, 10/03/10
IP-04	Legal & Regulatory Requirements Procedure	Rev 03, 10/03/10
IP-05	Objectives, Targets & Management Programmes Procedure	Rev 03, 10/03/10
IP-06	Competence, Training & Awareness Procedure	Rev 03, 10/03/10
IP-07	Communication & Consultation Procedure	Rev 04, 28/04/10
IP-08	Monitoring, Measurement & Improvement Procedure	Rev 02, 05/02/10
IP-09	Evaluation of Compliance Procedure	Rev 03, 10/03/10
IP-10	Non Conformances, Corrective/Preventive Actions Procedure	Rev 03, 10/03/10
IP-11	Internal Audit Procedure	Rev 03, 10/03/10
IP-12	Management Review Procedure	Rev 02, 05/02/10
IP-13	Control of Contractors/Visitors Procedure	Rev 03, 10/03/10
IP-14	Health & Safety & Environmental Monitoring	Rev 02, 05/02/10
IP-15	Emergency Preparedness & Response Procedure	Rev 02, 10/03/10

**Safety Procedures - SP**

SP-01	Permit to Work Procedure	Rev 03, 10/03/10
SP-02	Maintenance & Calibration Procedure	Rev 03, 10/03/10
SP-03	Mobile Plant Procedure	Rev 02, 05/02/10
SP-04	Fork Truck Procedure	Rev 03, 10/03/10
SP-05	Operation of Fixed Plant Procedure	Rev 03, 10/03/10
SP-06	Lock Out / Tag Out Procedure	Rev 03, 10/03/10
SP-07	Health & Safety Notification Procedure	Rev 03, 10/03/10

**Environmental Procedures - EP**

EP-01	Office Waste & Energy Management Procedure	Rev 02, 05/02/10
EP-02	Decommissioning and Aftercare Procedure	Rev 02, 05/02/10
EP-03	EPA Communications Procedure	Rev 02, 05/02/10
EP-04	Waste Permits & Licences Procedure	Rev 01, 01/10/09
EP-05	Waste Acceptance Procedure	Rev 01, 01/10/09
EP-06	Unacceptable Waste Procedure	Rev 02, 10/03/10
EP-07	Waste & Material Storage Procedure	Rev 02, 10/03/10
EP-08	Waste Processing Procedure	Rev 01, 01/10/09
EP-09	Site Infrastructure Procedure	Rev 02, 05/02/10
EP-10	Nuisance Management Procedure	Rev 02, 05/02/10
EP-11	Civic Amenity Site Procedure	Rev 02, 05/02/10



## **APPENDIX 2**

### European Pollutant Release and Transfer Register



Environmental Protection Agency

| PRTR# : W0188 | Facility Name : Greenstar Materials Recovery Ltd | Filename : W0188\_2010.xls | Return Year : 2010 |

[Guidance to completing the PRTR workbook](#)

# AER Returns Workbook

Version 1.1.11

<b>REFERENCE YEAR</b>	2010
-----------------------	------

**1. FACILITY IDENTIFICATION**

Parent Company Name	Greenstar Materials Recovery Ltd
Facility Name	Greenstar Materials Recovery Ltd
PRTR Identification Number	W0188
Licence Number	W0188-01

Waste or IPPC Classes of Activity

No.	class name
4.2	Recycling or reclamation of organic substances which are not used as solvents (including composting and other biological transformation processes).
3.11	Blending or mixture prior to submission to any activity referred to in a preceding paragraph of this Schedule.
3.12	Repackaging prior to submission to any activity referred to in a preceding paragraph of this Schedule.
3.13	Storage prior to submission to any activity referred to in a preceding paragraph of this Schedule, other than temporary storage, pending collection, on the premises where the waste concerned is produced.
4.12	Exchange of waste for submission to any activity referred to in a preceding paragraph of this Schedule.
4.13	Storage of waste intended for submission to any activity referred to in a preceding paragraph of this Schedule, other than temporary storage, pending collection, on the premises where such waste is produced.
4.3	Recycling or reclamation of metals and metal compounds.
4.4	Recycling or reclamation of other inorganic materials.
Address 1	14B Phase 3
Address 2	Road 3A
Address 3	Greenogue Industrial Estate
Address 4	Rathcoole, Co Dublin
Country	Ireland
Coordinates of Location	-6.46619 53.2936
River Basin District	IEEA
NACE Code	3832
Main Economic Activity	Recovery of sorted materials
<b>AER Returns Contact Name</b>	Suzanne Byrne
<b>AER Returns Contact Email Address</b>	suzanne.byrne@greenstar.ie
<b>AER Returns Contact Position</b>	Environmental Executive
<b>AER Returns Contact Telephone Number</b>	01-2947949
<b>AER Returns Contact Mobile Phone Number</b>	
<b>AER Returns Contact Fax Number</b>	01-2947900
<b>Production Volume</b>	0.0
<b>Production Volume Units</b>	
<b>Number of Installations</b>	0
<b>Number of Operating Hours in Year</b>	0
<b>Number of Employees</b>	0
<b>User Feedback/Comments</b>	
<b>Web Address</b>	

**2. PRTR CLASS ACTIVITIES**

Activity Number	Activity Name
50.1	General
5(c)	Installations for the disposal of non-hazardous waste
50.1	General

**3. SOLVENTS REGULATIONS (S.I. No. 543 of 2002)**

Is it applicable?	
Have you been granted an exemption ?	
If applicable which activity class applies (as per Schedule 2 of the regulations) ?	
Is the reduction scheme compliance route being used ?	

4.1 RELEASES TO AIR

[Link to previous years emissions data](#)

| PRTR# : W0188 | Facility Name : Greenstar Materials Recovery Ltd | Filename : W0188\_2010.xls | Return Year : 2010 |

30/03/2011 10:15

**SECTION A : SECTOR SPECIFIC PRTR POLLUTANTS**

POLLUTANT		RELEASERS TO AIR			Please enter all quantities in this section in KGs			
No. Annex II	Name	M/C/E	METHOD		Emission Point 1	QUANTITY		
			Method Code	Designation or Description		T (Total) KG/Year	A (Accidental) KG/Year	F (Fugitive) KG/Year
						0.0	0.0	0.0

\* Select a row by double-clicking on the Pollutant Name (Column B) then click the delete button

**SECTION B : REMAINING PRTR POLLUTANTS**

POLLUTANT		RELEASERS TO AIR			Please enter all quantities in this section in KGs			
No. Annex II	Name	M/C/E	METHOD		Emission Point 1	QUANTITY		
			Method Code	Designation or Description		T (Total) KG/Year	A (Accidental) KG/Year	F (Fugitive) KG/Year
						0.0	0.0	0.0

\* Select a row by double-clicking on the Pollutant Name (Column B) then click the delete button

**SECTION C : REMAINING POLLUTANT EMISSIONS (As required in your Licence)**

POLLUTANT		RELEASERS TO AIR			Please enter all quantities in this section in KGs			
Pollutant No.	Name	M/C/E	METHOD		Emission Point 1	QUANTITY		
			Method Code	Designation or Description		T (Total) KG/Year	A (Accidental) KG/Year	F (Fugitive) KG/Year
						0.0	0.0	0.0

\* Select a row by double-clicking on the Pollutant Name (Column B) then click the delete button

**Additional Data Requested from Landfill operators**

For the purposes of the National Inventory on Greenhouse Gases, landfill operators are requested to provide summary data on landfill gas (Methane) flared or utilised on their facilities to accompany the figures for total methane generated. Operators should only report their Net methane (CH4) emission to the environment under T(total) KG/yr for Section A: Sector specific PRTR pollutants above. Please complete the table below:

Landfill:

Greenstar Materials Recovery Ltd

Please enter summary data on the quantities of methane flared and / or utilised

T (Total) kg/Year	M/C/E	Method Used		Facility Total Capacity m3 per hour
		Method Code	Designation or Description	
Total estimated methane generation (as per site model)	0.0			N/A
Methane flared	0.0			0.0 (Total Flaring Capacity)
Methane utilised in engine/s	0.0			0.0 (Total Utilising Capacity)
Net methane emission (as reported in Section A above)	0.0			N/A



4.2 RELEASES TO WATERS

[Link to previous years emissions data](#)

| PRTR# : W0188 | Facility Name : Greenstar Materials Recovery Ltd | Filename : W0188\_2010.xls | Return Year : 2010 |

30/03/2011 10:16

**SECTION A : SECTOR SPECIFIC PRTR POLLUTANTS**

Data on ambient monitoring of storm/surface water or groundwater, conducted as part of your licence requirements, should NOT be submitted under AER / PRTR Reporting as t

RELEASES TO WATERS					Please enter all quantities in this section in KGs			
POLLUTANT		M/C/E	Method Used		QUANTITY			
No. Annex II	Name		Method Code	Designation or Description	Emission Point 1	T (Total) KG/Year	A (Accidental) KG/Year	F (Fugitive) KG/Year
					0.0	0.0	0.0	0.0

\* Select a row by double-clicking on the Pollutant Name (Column B) then click the delete button

**SECTION B : REMAINING PRTR POLLUTANTS**

RELEASES TO WATERS					Please enter all quantities in this section in KGs			
POLLUTANT		M/C/E	Method Used		QUANTITY			
No. Annex II	Name		Method Code	Designation or Description	Emission Point 1	T (Total) KG/Year	A (Accidental) KG/Year	F (Fugitive) KG/Year
					0.0	0.0	0.0	0.0

\* Select a row by double-clicking on the Pollutant Name (Column B) then click the delete button

**SECTION C : REMAINING POLLUTANT EMISSIONS (as required in your Licence)**

RELEASES TO WATERS					Please enter all quantities in this section in KGs			
POLLUTANT		M/C/E	Method Used		QUANTITY			
Pollutant No.	Name		Method Code	Designation or Description	Emission Point 1	T (Total) KG/Year	A (Accidental) KG/Year	F (Fugitive) KG/Year
					0.0	0.0	0.0	0.0

\* Select a row by double-clicking on the Pollutant Name (Column B) then click the delete button

4.3 RELEASES TO WASTEWATER OR SEWER

[Link to previous years emissions data](#)

| PRTR# : W0188 | Facility Name : Greenstar Materials Recovery Ltd | Filename : W0188\_2010.xls | R

30/03/2011 10:17

SECTION A : PRTR POLLUTANTS

OFFSITE TRANSFER OF POLLUTANTS DESTINED FOR WASTE-WATER TREATMENT OR SEWER					Please enter all quantities in this section in KGs			
POLLUTANT		METHOD			QUANTITY			
No. Annex II	Name	M/C/E	Method Used		Emission Point 1	T (Total) KG/Year	A (Accidental) KG/Year	F (Fugitive) KG/Year
			Method Code	Designation or Description				
					0.0	0.0	0.0	0.0

\* Select a row by double-clicking on the Pollutant Name (Column B) then click the delete button

SECTION B : REMAINING POLLUTANT EMISSIONS (as required in your Licence)

OFFSITE TRANSFER OF POLLUTANTS DESTINED FOR WASTE-WATER TREATMENT OR SEWER					Please enter all quantities in this section in KGs			
POLLUTANT		METHOD			QUANTITY			
Pollutant No.	Name	M/C/E	Method Used		SE-1 Emission Point 1	T (Total) KG/Year	A (Accidental) KG/Year	F (Fugitive) KG/Year
			Method Code	Designation or Description				
238	Ammonia (as N)	E	PER	Based on an estimate of water used in the wheel wash. Analysis is ISO accredited	29.54667	29.54667	0.0	0.0
303	BOD	E	PER	Based on an estimate of water used in the wheel wash. Analysis is ISO accredited	529.3333	529.3333	0.0	0.0
306	COD	E	PER	Based on an estimate of water used in the wheel wash. Analysis is ISO accredited	1188.333	1188.333	0.0	0.0
308	Detergents (as MBAS)	E	PER	Based on an estimate of water used in the wheel wash. Analysis is ISO accredited	1.166667	1.166667	0.0	0.0
314	Fats, Oils and Greases	E	PER	Based on an estimate of water used in the wheel wash. Analysis is ISO accredited	2.044	2.044	0.0	0.0
343	Sulphate	E	PER	Based on an estimate of water used in the wheel wash. Analysis is ISO accredited	57.12	57.12	0.0	0.0
240	Suspended Solids	E	PER	Based on an estimate of water used in the wheel wash. Analysis is ISO accredited	916.0	916.0	0.0	0.0

\* Select a row by double-clicking on the Pollutant Name (Column B) then click the delete button

**4.4 RELEASES TO LAND**

[Link to previous years emissions data](#)

| PRTR# : W0188 | Facility Name : Greenstar Materials Recovery Ltd | Filename : W0188\_2010.xls | Return Year : 2010 |

30/03/2011 10:17

**SECTION A : PRTR POLLUTANTS**

POLLUTANT		RELEASERS TO LAND			Please enter all quantities in this section in KGs		
POLLUTANT		METHOD			QUANTITY		
No. Annex II	Name	M/C/E	Method Code	Designation or Description	Emission Point 1	T (Total) KG/Year	A (Accidental) KG/Year
					0.0	0.0	0.0

\* Select a row by double-clicking on the Pollutant Name (Column B) then click the delete button

**SECTION B : REMAINING POLLUTANT EMISSIONS (as required in your Licence)**

POLLUTANT		RELEASERS TO LAND			Please enter all quantities in this section in KGs		
POLLUTANT		METHOD			QUANTITY		
Pollutant No.	Name	M/C/E	Method Code	Designation or Description	Emission Point 1	T (Total) KG/Year	A (Accidental) KG/Year
					0.0	0.0	0.0

\* Select a row by double-clicking on the Pollutant Name (Column B) then click the delete button

5. ONSITE TREATMENT & OFFSITE TRANSFERS OF WASTE

| PRTR# : W0188 | Facility Name : Greenstar Materials Recovery Ltd | Filename : W0188\_2010.xls | Return Year : 2010 |

30/03/2011 10:17

Please enter all quantities on this sheet in Tonnes

39

Transfer Destination	European Waste Code	Hazardous	Quantity (Tonnes per Year)	Description of Waste	Waste Treatment Operation	Method Used		Location of Treatment	Haz Waste : Name and Licence/Permit No of Next Destination Facility	Haz Waste : Name and Licence/Permit No of Recoverer/Disposer	Haz Waste : Address of Next Destination Facility	Non Haz Waste: Address of Recoverer/Disposer	Name and License / Permit No. and Address of Final Recoverer / Disposer (HAZARDOUS WASTE ONLY)	Actual Address of Final Destination i.e. Final Recovery / Disposal Site (HAZARDOUS WASTE ONLY)
						M/C/E	Method Used		Haz Waste : Name and Licence/Permit No of Recoverer/Disposer	Non Haz Waste: Address of Recoverer/Disposer	Name and License / Permit No. and Address of Final Recoverer / Disposer (HAZARDOUS WASTE ONLY)	Actual Address of Final Destination i.e. Final Recovery / Disposal Site (HAZARDOUS WASTE ONLY)		
Within the Country	13 05 03	Yes	24.0	interceptor sludges	R13	M	Weighed	Offsite in Ireland	Horizon Environmental ,CPD 277-2	Horizon Environmental ,CPD 277-2	Unit 26 Collinstown Cross Industrial Estate,Old Airport Road,Cloghran,Co. Dublin,Ireland	Rosemount Business Park,Ballycoolin Road,Blanchardstown,Dublin 16,Ireland	Horizon Environmental ,CPD 277-2,Unit 26 Collinstown Cross Industrial Estate,Old Airport Road,Cloghran,Co. Dublin,Ireland	Unit 26 Collinstown Cross Industrial Estate,Old Airport Road,Cloghran,Co. Dublin,Ireland
Within the Country	15 01 01	No	1849.68	paper and cardboard packaging	R3	M	Weighed	Offsite in Ireland	Bailey Waste Recycling,WFP-FG-08-0002-01	Bailey Waste Recycling,WFP-FG-08-0002-01	Road,Blanchardstown,Dublin 16,Ireland	Fassaroe,Bray,Co. Wicklow,,Ireland		
Within the Country	15 01 01	No	1304.22	paper and cardboard packaging	R13	M	Weighed	Offsite in Ireland	Greenstar Limited,W0053-03	Greenstar Limited,W0053-03	Unit 2B,Kylemore Industrial Estate,Ballyfermot,Dublin 10,Ireland	Wicklow,,Ireland		
Within the Country	15 01 01	No	108.46	paper and cardboard packaging	R3	M	Weighed	Offsite in Ireland	Re-Box Recycling,N/a	Re-Box Recycling,N/a	C Green Plastic,WFP-WW-10-0019-01	The Murrough,Co. Wicklow,,Ireland	Fassaroe,Bray,Co. Wicklow,,Ireland	
Within the Country	15 01 02	No	35.52	plastic packaging	R3	M	Weighed	Offsite in Ireland	C Green Plastic,WFP-WW-10-0019-01	C Green Plastic,WFP-WW-10-0019-01	The Murrough,Co. Wicklow,,Ireland	Fassaroe,Bray,Co. Wicklow,,Ireland		
Within the Country	15 01 02	No	38.82	plastic packaging	R13	M	Weighed	Offsite in Ireland	Greenstar Limited,W0053-03	Greenstar Limited,W0053-03	Max Pallet Services Ltd.,Not Required	Wicklow,,Ireland	Colemanstown,Rathcoole,Co. Dublin,,Ireland	
Within the Country	15 01 03	No	62.0	wooden packaging	R3	M	Weighed	Offsite in Ireland	Greenstar Limited,W0053-03	Greenstar Limited,W0053-03	Max Pallet Services Ltd.,Not Required	Wicklow,,Ireland	Fassaroe,Bray,Co. Wicklow,,Ireland	
Within the Country	15 01 03	No	1405.0	wooden packaging	R13	M	Weighed	Offsite in Ireland	Greenstar Limited,W0053-03	Greenstar Limited,W0053-03	Max Pallet Services Ltd.,Not Required	Wicklow,,Ireland	Fassaroe,Bray,Co. Wicklow,,Ireland	
Within the Country	15 01 06	No	39.7	mixed packaging	R5	M	Weighed	Offsite in Ireland	Greyhound Recycling & Recovery Limited,W0205-01	Greyhound Recycling & Recovery Limited,W0205-01	Dublin 22,Ireland	Fassaroe,Bray,Co. Wicklow,,Ireland		
Within the Country	15 01 06	No	3870.0	mixed packaging	R13	M	Weighed	Offsite in Ireland	Greenstar Limited,W0053-03	Greenstar Limited,W0053-03	Dublin 22,Ireland	Fassaroe,Bray,Co. Wicklow,,Ireland		
Within the Country	16 05 04	Yes	0.34	gases in pressure containers (including halons) containing dangerous substances	R4	M	Weighed	Offsite in Ireland	Calor Gas,Not Required	Calor Gas,Not Required	Long Mile Road,Dublin 12,,Ireland	Long Mile Road,Dublin 12,,Ireland	Calor Gas,Not Required,Long Mile Road,Dublin 12,,Ireland	Long Mile Road,Dublin 12,,Ireland
Within the Country	17 01 07	No	2561.0	01 06 soil and stones other than those mentioned in 17 05 03	R13	M	Weighed	Offsite in Ireland	Greenstar Limited,W0053-03	Greenstar Limited,W0053-03	Fassaroe,Bray,Co. Wicklow,,Ireland	Fassaroe,Bray,Co. Wicklow,,Ireland		
Within the Country	17 05 04	No	24.0	soil and stones other than those mentioned in 17 05 03	R13	M	Weighed	Offsite in Ireland	Greenstar Limited,W0053-03	Greenstar Limited,W0053-03	Fassaroe,Bray,Co. Wicklow,,Ireland	Fassaroe,Bray,Co. Wicklow,,Ireland		
Within the Country	17 05 04	No	2220.4	soil and stones other than those mentioned in 17 05 03	R5	M	Weighed	Offsite in Ireland	Kingsbog,WP325/2008	Kingsbog,WP325/2008	Nurney,Co. Kildare,,Ireland	Nurney,Co. Kildare,,Ireland		
Within the Country	19 12 12	No	5565.94	11 other wastes (including mixtures of materials) from mechanical treatment of wastes other than those mentioned in 19 12 11	D5	M	Weighed	Offsite in Ireland	Bord Na Mona PLC,W0201-03	Bord Na Mona PLC,W0201-03	Drehid Landfill,Drehid ,Co. Kildare,,Ireland	Drehid Landfill,Drehid ,Co. Kildare,,Ireland		
Within the Country	19 12 12	No	152.42	11 other wastes (including mixtures of materials) from mechanical treatment of wastes other than those mentioned in 19 12 11	R5	M	Weighed	Offsite in Ireland	Greyhound Recycling & Recovery Limited,W0205-01	Greyhound Recycling & Recovery Limited,W0205-01	Dublin 22,Ireland	Crag Avenue,Clondalkin Industrial Estate,Clondalkin ,Dublin 22,Ireland		
Within the Country	19 12 12	No	10327.4	11 other wastes (including mixtures of materials) from mechanical treatment of wastes other than those mentioned in 19 12 11	D5	M	Weighed	Offsite in Ireland	Greenstar Holdings Ltd,W0146-02	Greenstar Holdings Ltd,W0146-02	Knockharley,Navan,Co. Meath,,Ireland	Knockharley,Navan,Co. Meath,,Ireland		
Within the Country	19 12 12	No	59.46	11 other wastes (including mixtures of materials) from mechanical treatment of wastes other than those mentioned in 19 12 11	R13	M	Weighed	Offsite in Ireland	Greenstar Limited,W0053-03	Greenstar Limited,W0053-03	Fassaroe,Bray,Co. Wicklow,,Ireland	Fassaroe,Bray,Co. Wicklow,,Ireland		

Transfer Destination	European Waste Code	Hazardous	Quantity (Tonnes per Year)	Description of Waste	Waste Treatment Operation	Method Used		Location of Treatment	Haz Waste : Name and Licence/Permit No of Next Destination Facility	Haz Waste : Address of Next Destination Facility	Name and License / Permit No. and Address of Final Recoverer / Disposer (HAZARDOUS WASTE ONLY)	Actual Address of Final Destination i.e. Final Recovery / Disposal Site (HAZARDOUS WASTE ONLY)
						M/C/E	Method Used		Haz Waste : Name and Licence/Permit No of Recoverer/Disposer	Non Haz Waste: Address of Recoverer/Disposer		
Within the Country	19 12 12	No	17.14	11 other wastes (including mixtures of materials) from mechanical treatment of wastes other than those mentioned in 19 12	R13	M	Weighed	Offsite in Ireland	Greenstar Limited,W0183-01	Millennium Business Park,Grange,Ballycoolin,Dublin 11,Ireland		
Within the Country	19 12 12	No	1567.0	11 other wastes (including mixtures of materials) from mechanical treatment of wastes other than those mentioned in 19 12	R13	M	Weighed	Offsite in Ireland	Panda Waste,W0140-04	Rathdrinagh,Beauparc,Navan,Co. Meath,Ireland		
Within the Country	19 12 12	No	3048.8	11 other wastes (including mixtures of materials) from mechanical treatment of wastes other than those mentioned in 19 12	D5	M	Weighed	Offsite in Ireland	Greenstar Holdings Ltd.,W0165-02	Ballynagran,Coolbeg & Kilcandra,Co. Wicklow,,Ireland		
Within the Country	20 01 01	No	15.0	paper and cardboard	R13	M	Weighed	Offsite in Ireland	Greenstar Limited,W0053-03	Fassaroe,Bray,Co. Wicklow,,Ireland		
Within the Country	20 01 08	No	22.66	biodegradable kitchen and canteen waste	R3	M	Weighed	Offsite in Ireland	McGill Environmental Systems (Ireland) Ltd,W0180-01	Coom,Carrignavar/Glenville,Co. Cork,,Ireland		
Within the Country	20 01 08	No	1726.18	biodegradable kitchen and canteen waste	R3	M	Weighed	Offsite in Ireland	Waddock Composting,WP 11/04 & WP 01/02	Killamaster,Co. Carlow,,Ireland		
Within the Country	15 01 02	No	44.71	plastic packaging	R3	M	Weighed	Offsite in Ireland	Bailey Waste Recycling,WFP-FG-08-0002-01	Rosemount Business Park,Ballycoolin Road,Blanchardstown,Dublin 16,Ireland		
Within the Country	20 01 08	No	759.46	biodegradable kitchen and canteen waste	R3	M	Weighed	Offsite in Ireland	O'Toole Composting,WP01/07	Ballintrane,Co. Carlow,,Ireland		
Within the Country	20 01 38	No	569.0	wood other than that mentioned in 20 01 37	R13	M	Weighed	Offsite in Ireland	Greenstar Limited,W0053-03	Fassaroe,Bray,Co. Wicklow,,Ireland		
Within the Country	20 01 39	No	8.52	plastics	R3	M	Weighed	Offsite in Ireland	C Green Plastic,WFP-WW-10-0019-01	The Murrough,Co. Wicklow,,Ireland		
Within the Country	20 01 40	No	696.0	metals	R4	M	Weighed	Offsite in Ireland	Davis Recycling Ltd.,W0134-01	10 The Anchorage Business Park,Charlotte Quay,Dublin 4,,Ireland		
Within the Country	20 02 01	No	533.0	biodegradable waste	R3	M	Weighed	Offsite in Ireland	Enrich Environmental ,WMP 2004/57	Kilcock,Co. Kildare,,Ireland		
Within the Country	20 02 01	No	818.0	biodegradable waste	R13	M	Weighed	Offsite in Ireland	Greenstar Limited,W0053-03	Fassaroe,Bray,Co. Wicklow,,Ireland		
Within the Country	20 03 07	No	6994.57	bulky waste	R13	M	Weighed	Offsite in Ireland	Greenstar Limited,W0183-01	Millennium Business Park,Grange,Ballycoolin,Dublin 11,Ireland		
Within the Country	20 03 07	No	14.98	bulky waste	R13	M	Weighed	Offsite in Ireland	Greenstar Limited,W0053-03	Fassaroe,Bray,Co. Wicklow,,Ireland		
Within the Country	20 03 07	No	1767.94	bulky waste	D5	M	Weighed	Offsite in Ireland	Greenstar Holdings Ltd,W0146-02	Knockharley,Navan,Co. Meath,,Ireland		
<b>Within the Country</b>	<b>20 03 07</b>	<b>No</b>	594.56	bulky waste	R13	M	Weighed	Offsite in Ireland	Greyhound Recycling & Recovery Limited,W0205-01	Industrial Estate,Clondalkin ,Dublin 22,Ireland		
Within the Country	20 03 07	No	812.68	bulky waste	D5	M	Weighed	Offsite in Ireland	Bord Na Mona PLC,W0201-03	Drehid Landfill,Drehid ,Co. Kildare,,Ireland		
Within the Country	20 01 33	Yes	1.0	batteries and accumulators included in 16 06 01, 16 06 02 or 16 06 03 and unsorted batteries and accumulators containing these	R4	M	Weighed	Offsite in Ireland	Returnbatt,W0192-03	Block 402 Grant's Drive,Greenogue Business Park,Rathcoole,Co. Dublin,Ireland	Returnbatt,W0192-03,Block 402 Grant's Drive,Greenogue Business Park,Rathcoole,Co. Dublin,Ireland	Block 402 Grant's Drive,Greenogue Business Park,Rathcoole,Co. Dublin,Ireland
Within the Country	20 01 08	No	27.0	biodegradable kitchen and canteen waste	R3	M	Weighed	Offsite in Ireland	Milltown Composting Systems,W0270-01	Milltownmore,Fethard,Co. Tipperary,,Ireland		

\* Select a row by double-clicking the Description of Waste then click the delete button