

Comhairle Contae Chorcaí Cork County Council

Annabella,
Mala,
Co. Chorcaí.

Fón: (022) 21123 • Faics: (022) 21983
R-phost: northcork@corkcoco.ie
Suíomh Gréasáin: www.corkcoco.ie

Annabella,
Mallow,
Co. Cork.

Tel: (022) 21123 • Fax: (022)21983
Email: northcork@corkcoco.ie
Web: www.corkcoco.ie



Administration,
Environmental Licensing Programme,
Office of Climate -Licensing & Resource Use,
Environmental Protection Agency,
Headquarters,
PO Box 3000,
Johnstown Castle Estate,
Co. Wexford.

24th January 2011

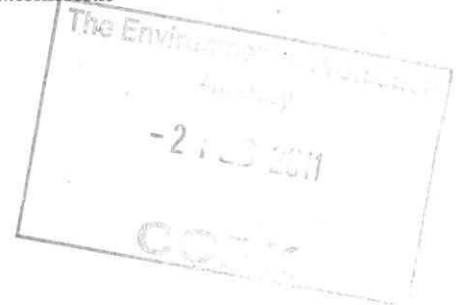

RE: Regulation 24 Compliance Requirements – Lyre & Environs A0334-01

1. Please find attached Flow diagram, which indicates that appropriate assessment is required. This Assessment is currently being undertaken.
2. Please find attached revised agglomeration drawing
3. Please find enclosed CD in PDF Format

Paddy O'Friel
S/Senior Engineer – Water Services

Email: paddy.ofriel@corkcoco.ie
Direct Line: 022-30441



**Lyre Flow Chart – A0334-01
Natura 2000 Screening Protocol**

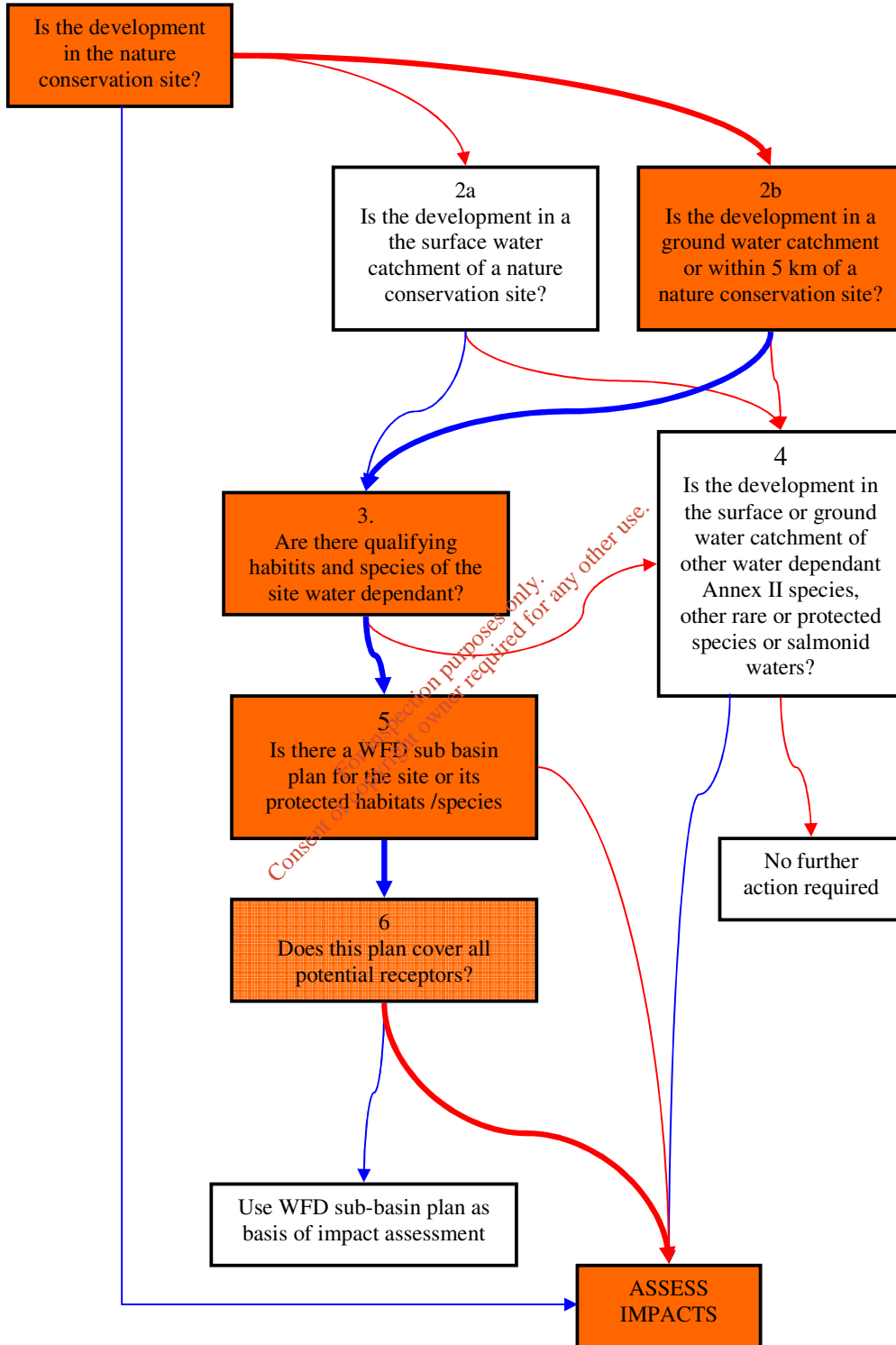

Positive response →

Negative response →

Orange boxes indicate decision flow path

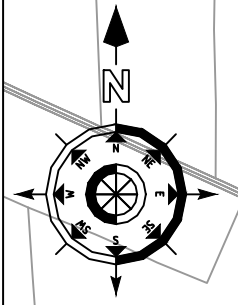
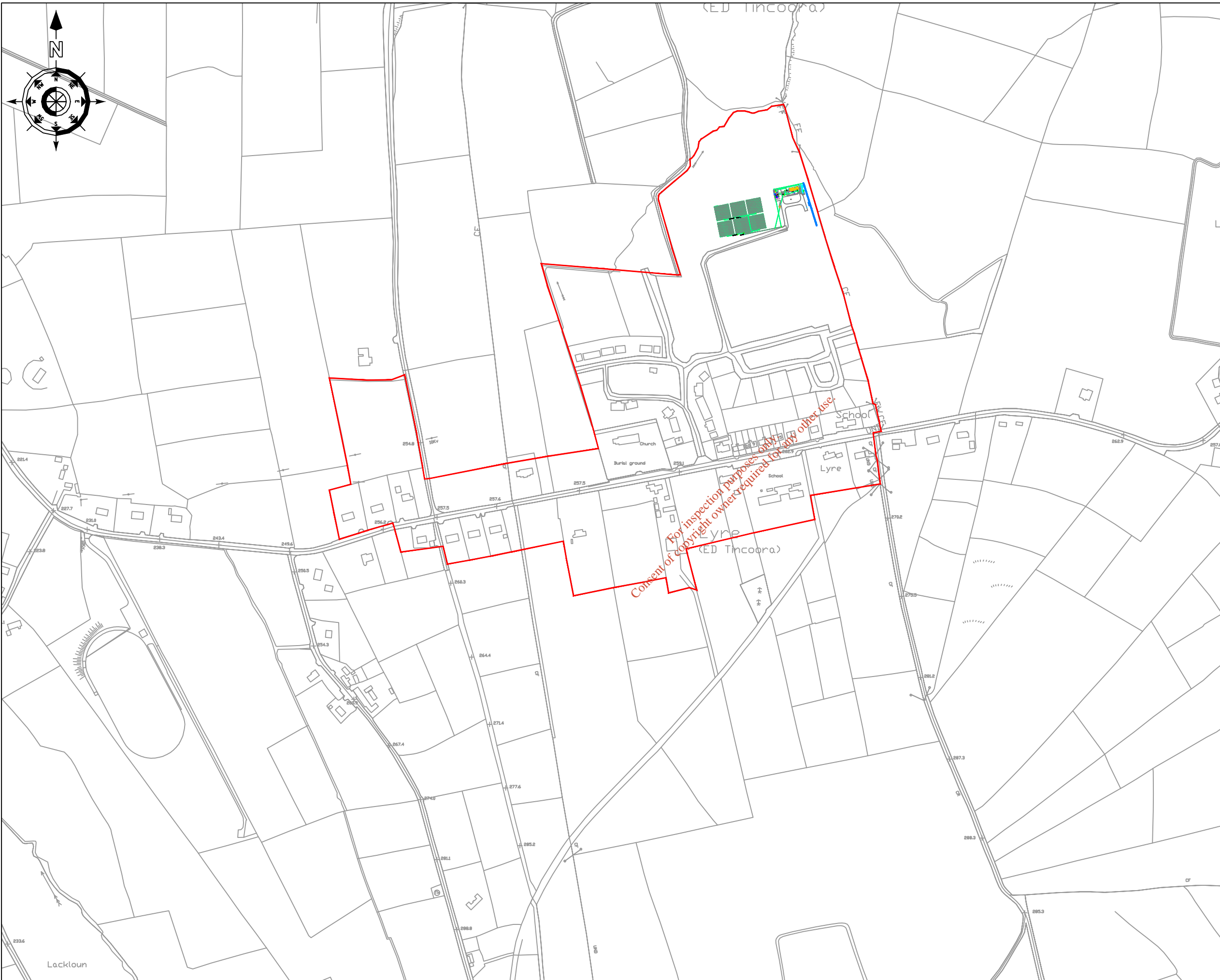

NOTES

1. Dimensions are not to be scaled from drawing. For any discrepancies found consult with the design office.
2. This drawing is to be read in conjunction with the Specification.
3. This drawing is to be read in conjunction with all other contract drawings.

No.	Date	Drawn	Surv	Chkd	Revision Description
A	12/10	DL	DL	FJ	Revision to Agglomeration Boundary

Cork County Council,
Northern Division.



N. O'KEEFE, B.E.,
COUNTY ENGINEER,
COUNTY HALL,
CORK.

Job Title:
Lyre & Environs
Waste Water Discharge
Licence Application

Drawing Title:
Agglomeration Boundary
Attachment B1 - Map 4

Scales: 1:5,000 @ A3	Surveyed by: D.L.	Drawn by: D.L.
Designed by: F.J.	Checked by: P.O.F	Date: December 2009
Drawing number: B1 - Map 4		Rev: A