

## Appendix A

*For inspection purposes only.  
Consent of copyright owner required for any other use.*

## EXISTING SCREENING SITUATION AND DETAIL RECOMMENDATIONS<sup>6</sup>

Table 1.7 Screening Recommendations

AREA	FIGURE	DESCRIPTION	EXISTING SCREENING ABILITY	PREDOMINANT EXISTING SPECIES	MAINTENANCE	PROPOSED HEDGEROW PLANTING, AS PART OF MITIGATION
<b>North-eastern boundary hedgerow</b>	Plate 1.10 and Plate 1.11	Mature hedgerow, with earth mound 2m in height along section of boundary.	Low due to deciduous vegetation and low under storey vegetation. Screening width and existing berm inadequate.	Alder	No visible maintenance	<ul style="list-style-type: none"> <li>Infill existing gaps in hedgerow with Holly and Alder species</li> <li>Extend existing berm</li> </ul>
<b>South-eastern boundary hedgerow along roadside</b>	Plate 1.12	Semi-mature hedgerow in corporation with earth mound 1m in height.	Generally good; Limited screening near material recovery facility	Alder Ash Ivy Hawthorn	Gaps have been amended with young trees.	<ul style="list-style-type: none"> <li>Infill existing gaps in hedgerow with Holly and Alder species</li> <li>Heighten and improve existing berm</li> </ul>
<b>Woodland pocket</b>	Plate 1.13	Mature native trees	Limited screening use. (Landscape and tree preservation relevance)		None	<ul style="list-style-type: none"> <li>Infill existing gaps in hedgerow with Holly and Alder species</li> </ul>
<b>South-western edge (Trees next to woodland pocket)</b>	Plate 1.14	Coniferous trees planted in row. In highly distressed state	Relatively low, compared to forest density	Alder Ash Sedges	No visible maintenance	Re-transplant forest species
<b>Internal screen on western side</b>		Trees in a highly distressed state	Extremely low	Plantation species-Conifers	None	Substitute existing conifer trees

<sup>6</sup> Refer to Section 1.5 for comprehensive list of proposed mitigation measures. Refer to Figure 1.6 for Landscape Mitigation Plan.

**Plate 1.10 North eastern boundary hedgerow**



**Plate 1.11 North eastern boundary hedgerow**



**Plate 1.12 South eastern boundary hedgerow along roadside**





Plate 1.13 Woodland pocket



Plate 1.14 South western edge (Trees next to woodland pocket)





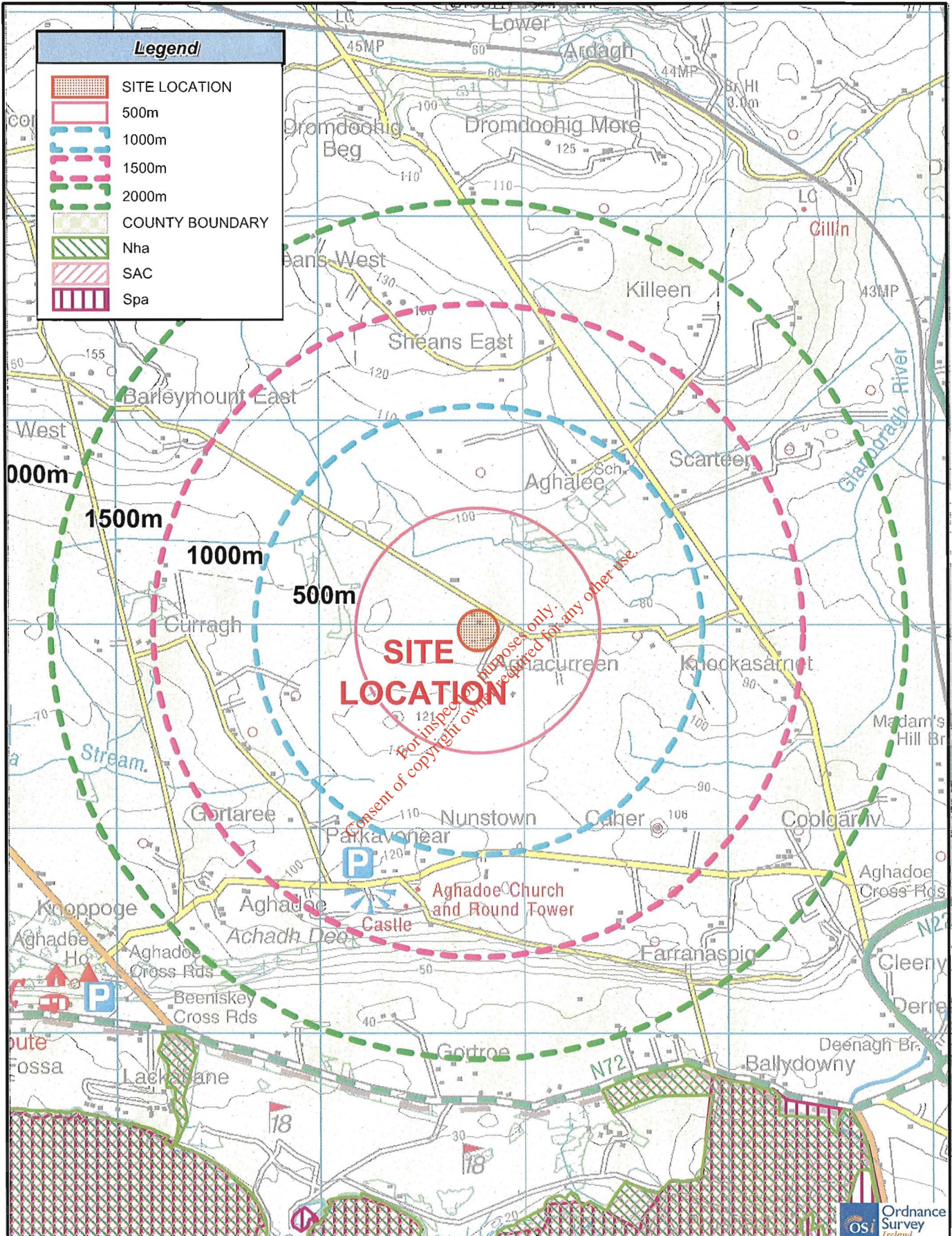

**Legend**

- SITE LOCATION
- 500m
- 1000m
- 1500m
- 2000m
- COUNTY BOUNDARY
- Nha
- SAC
- Spa

Project **KILLARNEY WASTE DISPOSAL WLA**

Figure **1.1**

Title **REGIONAL CONTEXT & SITE LOCATION**



Inishmore  
Ballymooling  
Co. Cork  
Phone 021-4872998  
Fax No. 021-4872997  
info@corp.rpsgroup.ie

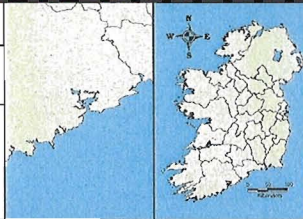

Issue Details			
Drawn: TB	Project No: MGE0031	Checked: FCO	File Ref.
Approved: SA	MGE0031RP0004	Scale: 1:25,000	Drawing No. Rev
Date: SEPT 2004	M10001		F01
<b>Notes</b> 1. This drawing is the property of the RPS Group. It is a confidential document and must not be copied, used, or its contents divulged without prior written consent. 2. All levels are referred to Ordnance Datum, Mean Sea Level. 3. NOT TO SCALE, use figured dimensions only, if in doubt ask. 4. Ordnance Survey Ireland Licence No. EN 0000904 Copyright Government of Ireland.			



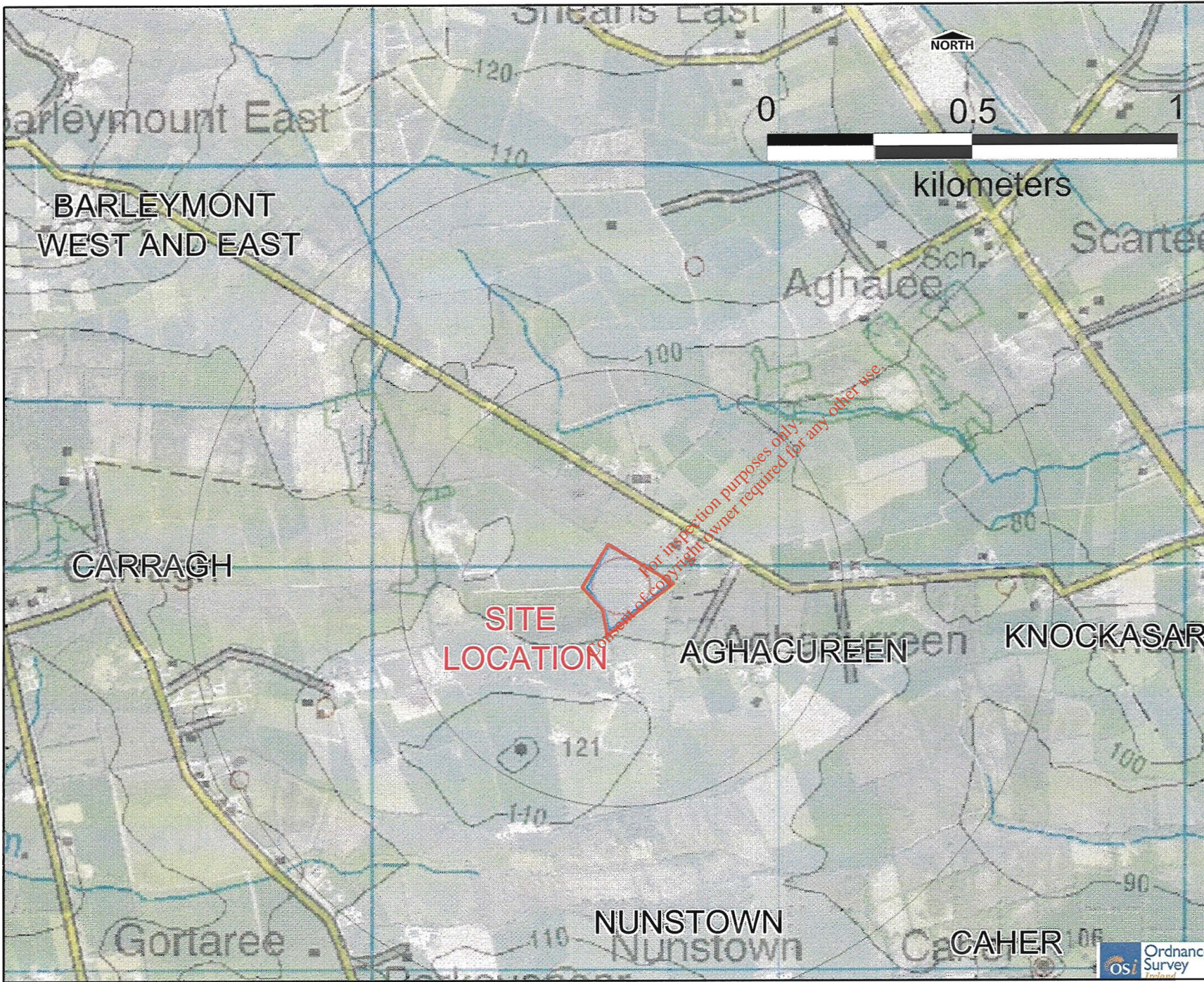

**Legend**

— SITE LOCATION

Project **KILLARNEY WASTE DISPOSAL WLA**

Title **LOCAL CONTEXT**

Figure 1.2

**RPS Group**

Innishmore  
Ballinaclogh  
Co. Cork  
Phone: 021-4872996  
Fax No: 021-4872997  
info@rps.co.uk

Issue Details			
Drawn	TGB	Project No.	MGE0031
Checked	FCO	File Ref	
Approved	SA	MGE003 IRP0004	
Scale	N/A	Drawing No	Rev
Date	SEPT 2004	M/0002	F01



**Notes**

1. This drawing is the property of the RPS Group. It is a confidential document and must not be copied, used, or its contents divulged without prior written consent.
2. All levels are referred to Ordnance Datum, Mean High.
3. NOT TO SCALE, use figured dimensions only, if in doubt ask.
4. Ordnance Survey Ireland Licence No. EN 0005004 Copyright Government of Ireland.

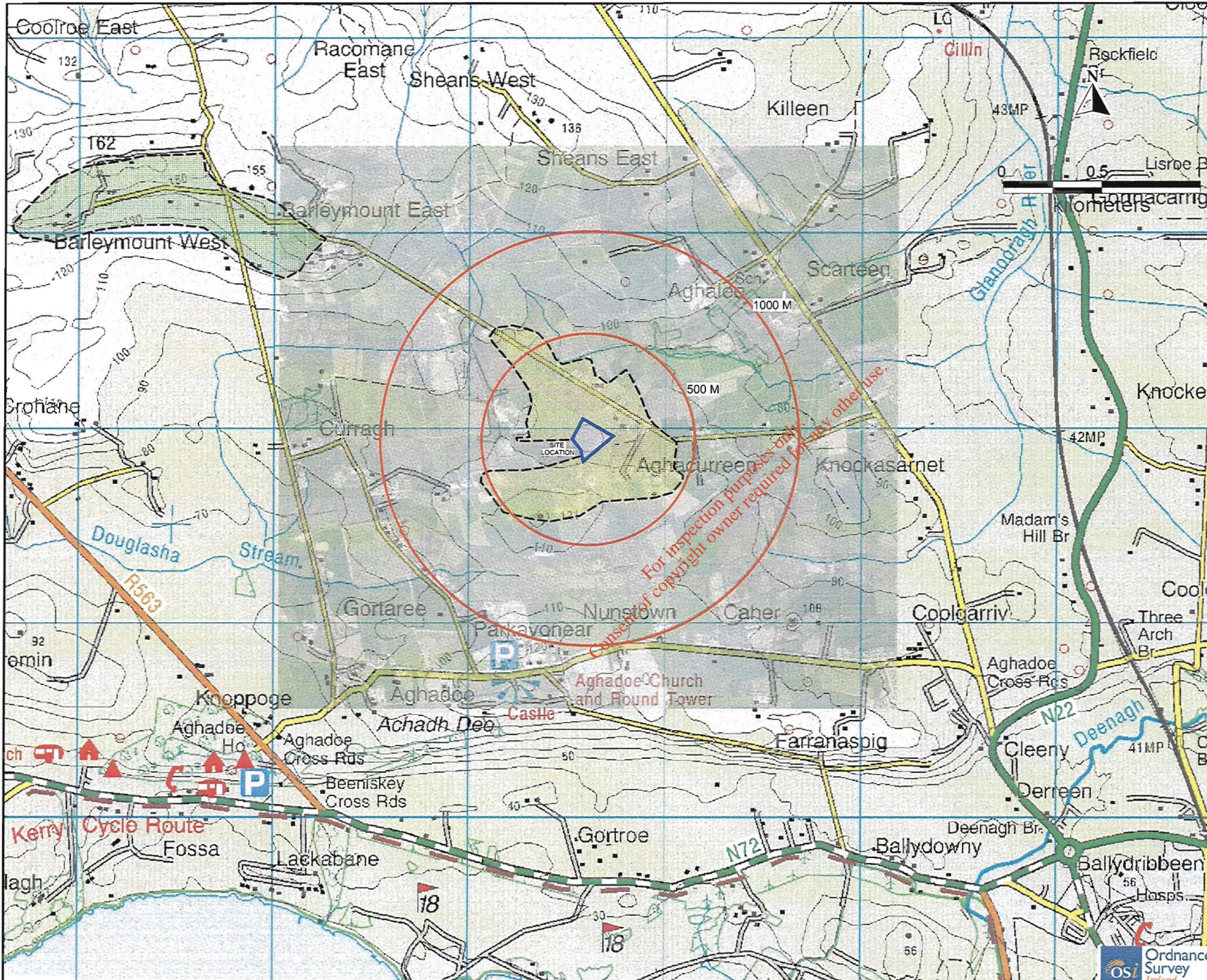



**Legend**

-  LONG RANGE VISIBILITY (MORE THAN 1500 METRES)
-  SHORT RANGE VISIBILITY (LESS THAN 500 METRES)
-  SITE BOUNDARY



Project **KILLARNEY WASTE DISPOSAL WLA**

**VISUAL ENVELOPE MAP**

Figure 1.4

**RPS Group**

Innismore  
Bainneog  
Co. Cork  
Phone: 021-4872996  
Fax No. 021-4872997  
info@rps-group.ie

Issue Details			
Drawn:	TGB	Project No.:	MSGE0031
Checked:	FOO	File Ref:	
Approved:	SA	MSGE0031:RFP0004	
Scale:	N/A	Drawing No.:	Rev
Date:	SEPT 2004	M0003	F01

**Notes**

- This drawing is the property of the RPS Group. It is a confidential document and must not be copied, used, or its contents divulged without prior written consent.
- All levels are referred to Ordnance Datum, Mean Head.
- NOT TO SCALE. Use figured dimensions only, if in doubt ask.
- Ordnance Survey Ireland Licence No. EN 0005004 Copyright Government of Ireland.





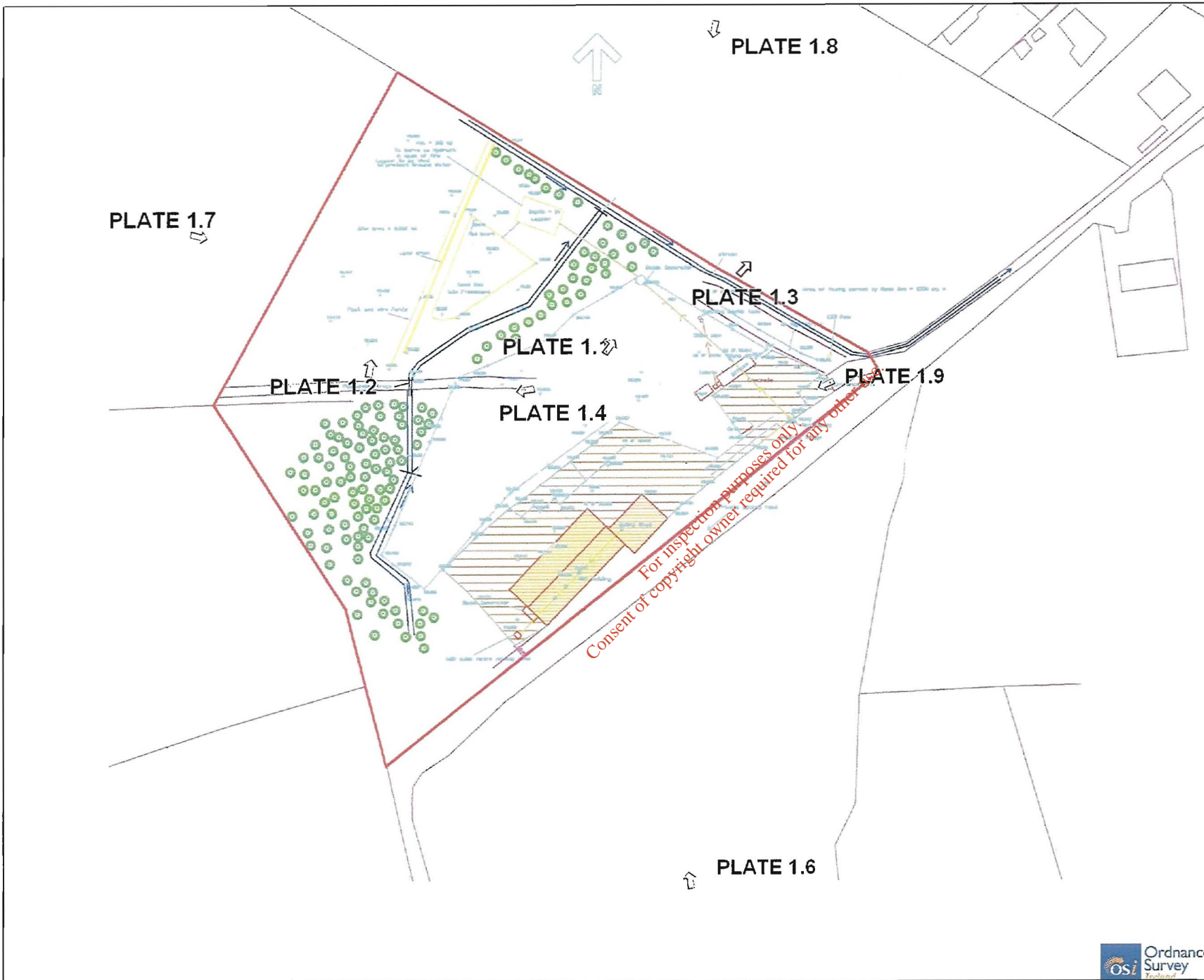

**Legend**

- ↖ VIEWS FROM SITE
- ↗ VIEWS TO SITE

Project **KILLARNEY WASTE DISPOSAL WLA**

Title **VIEW POINT LOCATION MAP**

Figure **1.5**

**RPS Group**  
 Inishmore  
 Ballinacilly  
 Co. Co. Wick  
 Phone: 021-4872000  
 Fax No. 021-4872997  
 info@co Wick.rps.ie

Issue Details		
Drawn: TGB	Project No.	M0E 0031
Checked: CD	File Ref.	M0E0031R0004
Approved: SA		
Scale: NOT TO SCALE	Drawing No.	Rev.
Date: JANUARY 2005	M0004	03

**Notes**

- This drawing is the property of RPS Group. It is to be used only for the project for which it was prepared. It is not to be used for any other purpose without the consent of RPS Group.
- All work is to be done in accordance with the current standards of the profession.
- Not to be used for any other purpose without the consent of RPS Group.
- Not to be used for any other purpose without the consent of RPS Group.

OSi Ordnance Survey





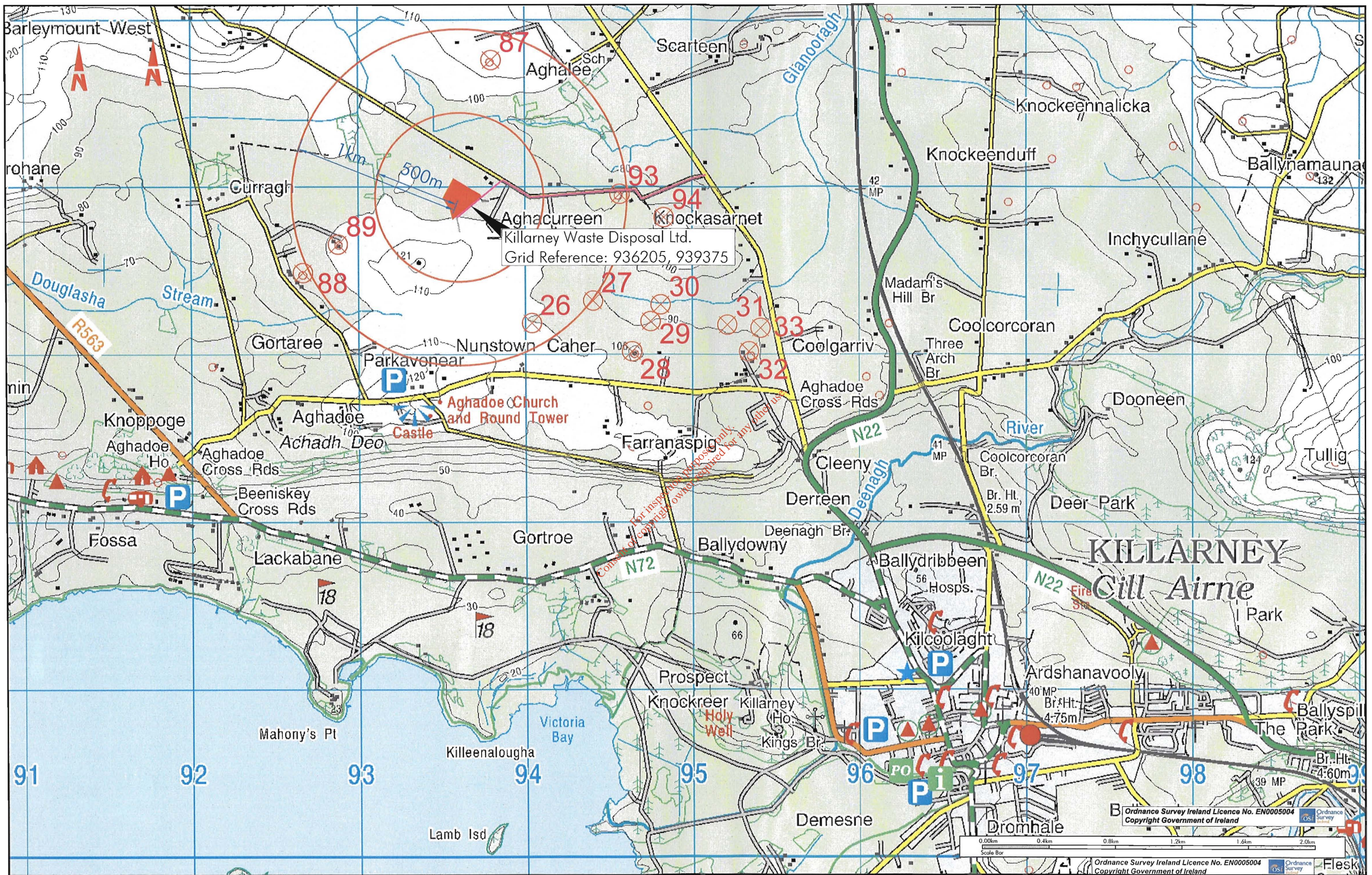

Killarney Waste Disposal Ltd.  
Grid Reference: 936205, 939375

Ordnance Survey Ireland Licence No. EN0005004  
Copyright Government of Ireland



### KWD RECYCLING

Killarney Waste Disposal Ltd.  
Aghacurreen, Killarney, Co. Kerry.  
Tel: Killarney 064-32458, Tralee 066-7128850 | Fax: 064-38661



RPS-MGOS Ltd., Lyrr Building, IDA Business & Technology Park, Mervue, Galway, Ireland.  
T: +353 91 534100 - F: +353 91 534199  
E: rpsmgos@rpsgroup.ie W: www.rpsmgos.ie

#### NOTES

- This drawing is the property of RPS-MGOS Ltd. It is a confidential document and must not be copied, used, or its content divulged without prior written consent.
- All Levels refer to Ordnance Survey Datum, Mean Head.
- DO NOT SCALE, use figured dimensions only. If in doubt ask.

No.	Date	Amendment / Issue	App.
F01	01/02/06	Final Issue	W.M.

Killarney Waste Disposal LTD.  
**Waste Licence Application**

Title: Sites & Monuments Record (SMR)

Drawn by:	C.N.	Job No:	MGE0031
Checked by:	S.A.	File No:	MGE0031DG0001
Approved by:	W.M.	Drg. No:	
Scale:	1:10,000 @ A1		
Date:	Jun '04		



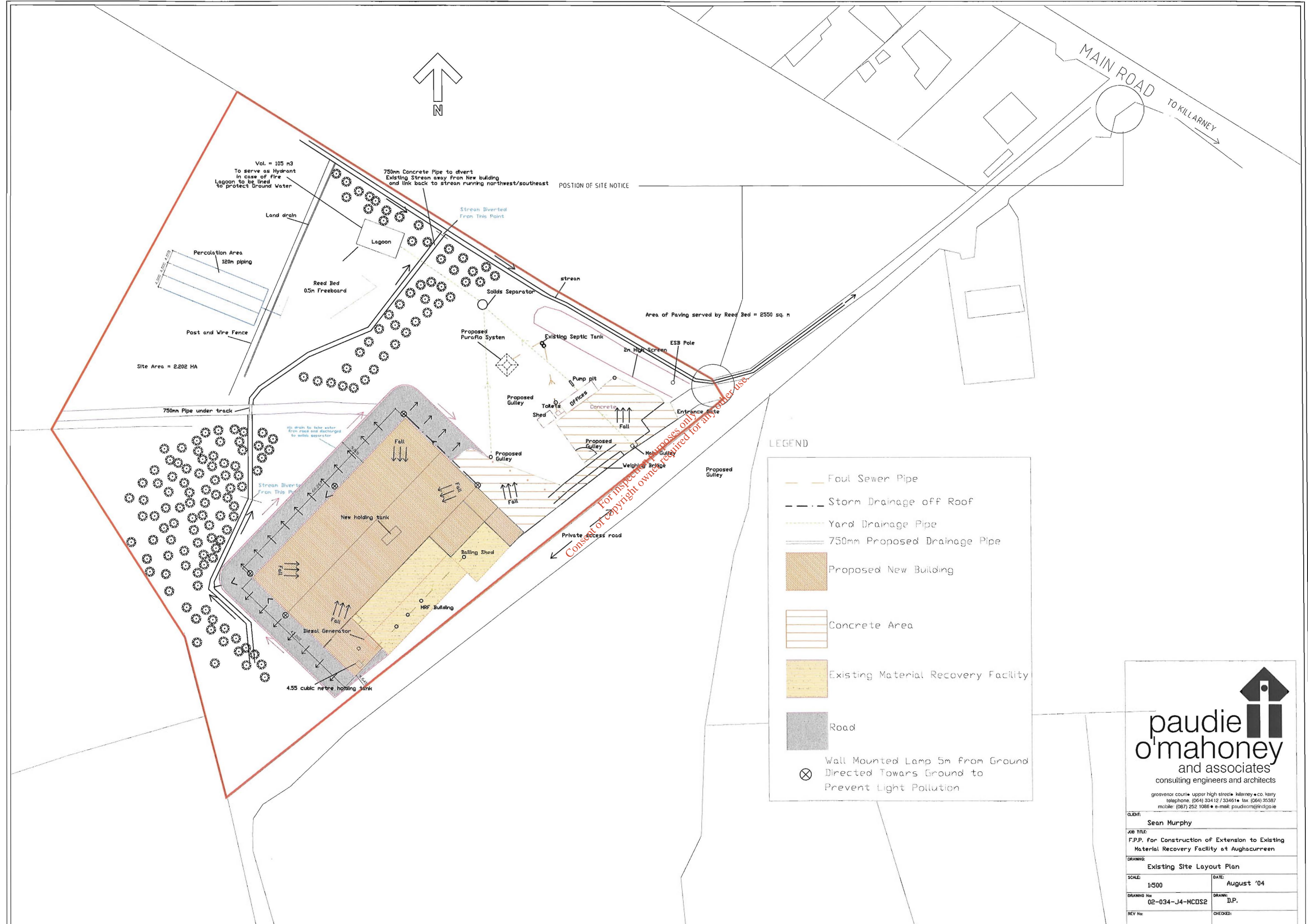

Vol. = 105 m<sup>3</sup>  
To serve as Hydrant  
in case of fire  
Lagoon to be lined  
to protect Ground Water

750mm Concrete Pipe to divert  
Existing Stream away from New building  
and link back to stream running northwest/southeast

POSITION OF SITE NOTICE

Stream Diverted  
From This Point

Land drain

Percolation Area  
120m piping

Post and Wire Fence

Site Area = 2.202 HA

Reed Bed  
0.5m Freeboard

Solids Separator

stream

Area of Paving served by Reed Bed = 2550 sq. m

Existing Septic Tank

ESB Pole

Zn High Screen

Pump pit

Proposed PuraFlo System

Proposed Guilty

Shed

Offices

Concrete

Fall

Entrance Gate

750mm Pipe under track

Stream Diverted  
From This Point

New holding tank

Fall

Balling Shed

HRF Building

Weighted Bridge

Proposed Guilty

Private access road

Proposed Guilty

4.55 cubic metre holding tank

Diesel Generator

Fall

**LEGEND**

- Foul Sewer Pipe
- Storm Drainage off Roof
- Yard Drainage Pipe
- 750mm Proposed Drainage Pipe
- Proposed New Building
- Concrete Area
- Existing Material Recovery Facility
- Road
- Wall Mounted Lamp 5m from Ground  
Directed Towards Ground to  
Prevent Light Pollution

**paudie o'mahoney**  
and associates  
consulting engineers and architects

grosvonor courtie upper high street killybegs co. Kerry  
telephone: (064) 33412 / 33461 fax: (064) 25387  
mobile: (087) 252 1086 e-mail: paudio@idigo.ie

CLIENT: <b>Sean Murphy</b>	
JOB TITLE: F.P.P. for Construction of Extension to Existing Material Recovery Facility at Aughacurreen	
DRAWING: <b>Existing Site Layout Plan</b>	
SCALE: <b>1:500</b>	DATE: <b>August '04</b>
DRAWING No: <b>02-034-J4-MCOS2</b>	DRAWN: <b>D.P.</b>
REV No:	CHECKED:

For inspection purposes only  
Consent of copyright owner required for any other use



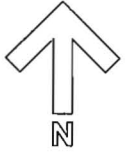



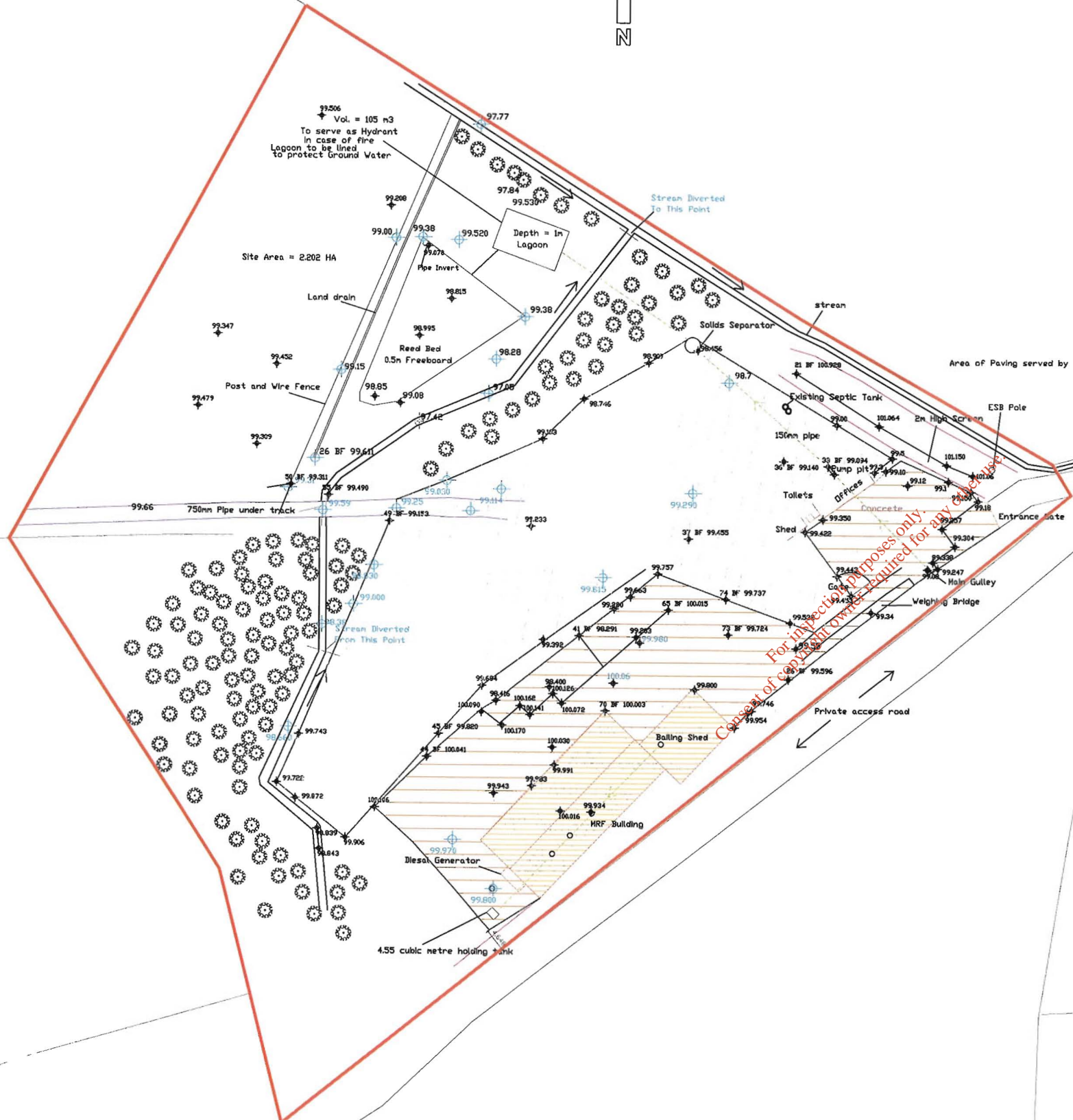

MAIN ROAD  
TO KILLARNEY



LEGEND

-  Existing Pipe
-  Concrete Area
-  Existing Materials Recovery Facility
-  Fill Area

For inspection purposes only  
Consent of copyright owner required for any other use

  
**paudie  
o'mahoney**  
and associates  
consulting engineers and architects

glasnevin court • upper high street • killarney • co. Kerry  
telephone: (064) 33412 / 33461 • fax: (064) 35387  
mobile: (087) 252 1088 • e-mail: paudie@indigo.ie

CLIENT: <b>Sean Murphy</b>	
JOB TITLE: <b>F.P.P. for Construction of Extension to Existing Materials Recovery Facility at Aughacurreen</b>	
DRAWING: <b>Proposed Site Layout Plan</b>	
SCALE: <b>1:500</b>	DATE: <b>April '04</b>
DRAWING No: <b>02-034-J4-MC051</b>	DRAWN: <b>D.P.</b>
REV No:	CHECKED:



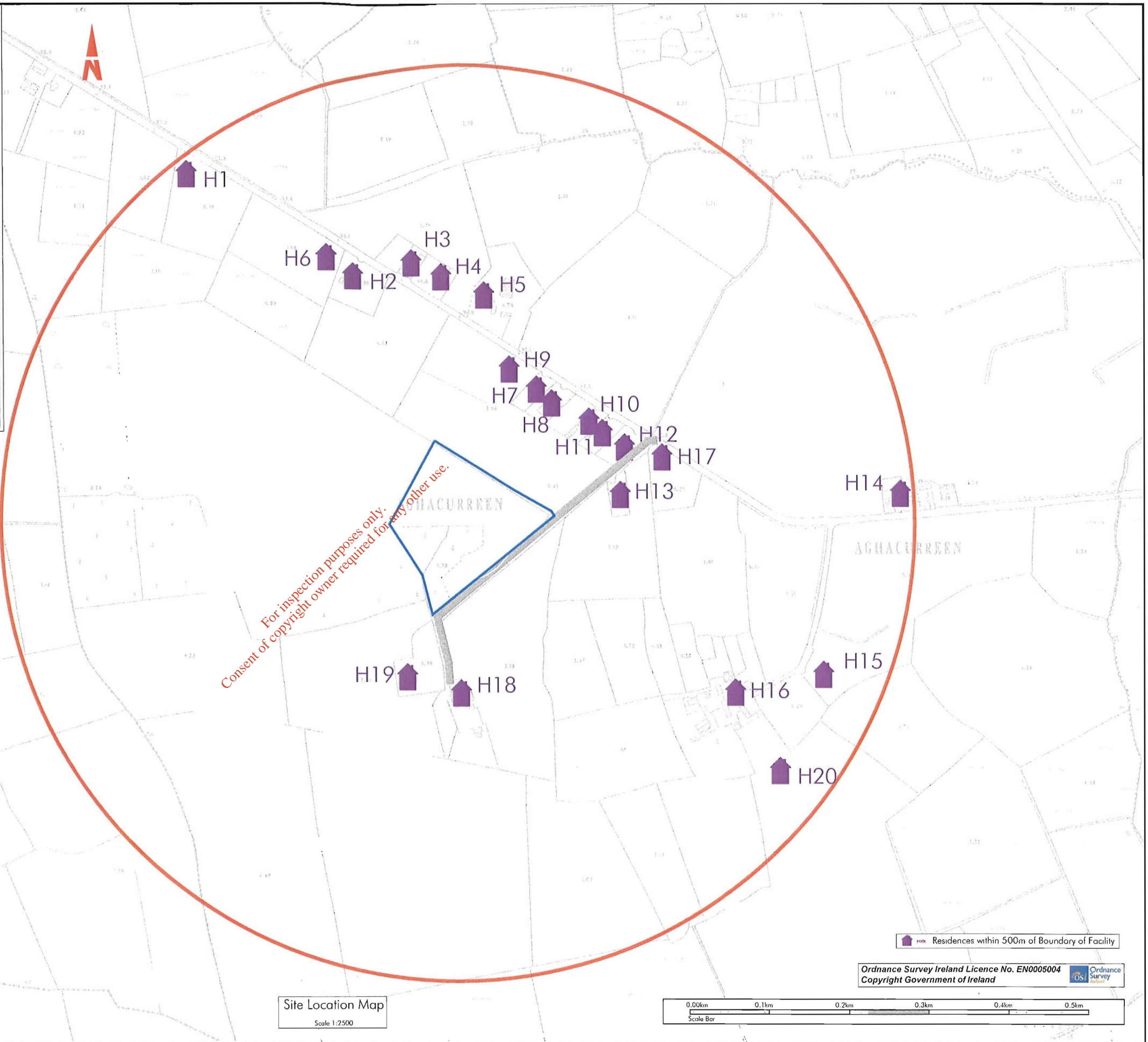
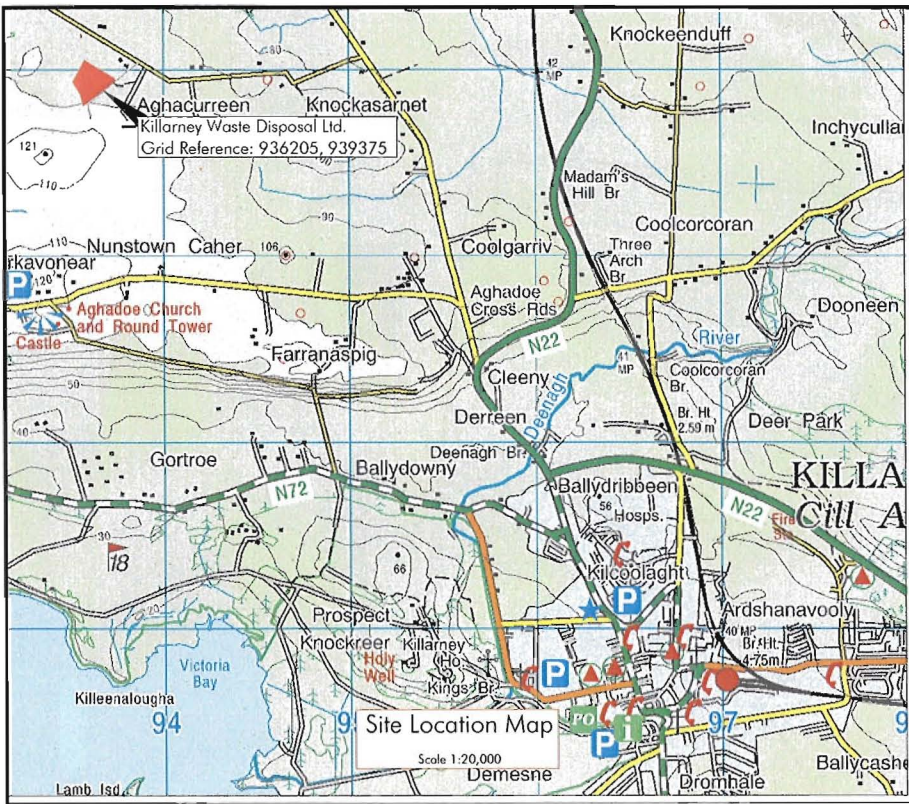

**KWD RECYCLING**

Killarney Waste Disposal Ltd.  
Aughacurreen, Killarney, Co. Kerry.  
Tel: Killarney 064-32458, Tralee 066-7128850 | Fax: 064-38661



RPS-MCOS Ltd., Lyrri Building, IDA Business & Technology Park, Mervue, Galway, Ireland.  
T: +353 91 534100 - F: +353 91 534199  
E: rpsmcos@rpsgroup.ie W: www.rpsmcos.ie

**NOTES**

- This drawing is the property of RPS-MCOS Ltd., it is a confidential document and must not be copied, used, or its content divulged without prior written consent.
- All Levels refer to Ordnance Survey Datum, Mean Head
- DO NOT SCALE, use figured dimensions only, if in doubt ask.

No.	Date	Rev.	Amendment / Issue	App.
F02	07/05/05	C.N.	Final Issue	W.M.
F01	17/09/04	C.N.	Final Issue	W.M.

Killarney Waste Disposal LTD.  
**Waste Licence Application**

Title  
**Proximity to Residences within 500m of Boundary of Facility**

Drawn by	C.N	Job No.	MGE0031
Checked by	S.A	File No.	MGE0031DG0001
Approved by	W.M	Drw. No.	Rev'
Scale:	1:2500 @ A1	DG0001-02	F02
Date:	Jun.'04		