

# Comhairle Contae Chorcaí Cork County Council

Halla an Chontae,  
Corcaigh, Éire.  
Fón: (021) 4276891 • Faisc: (021) 4276321  
Suíomh Gréasáin: [www.corkcoco.ie](http://www.corkcoco.ie)  
County Hall,  
Cork, Ireland.  
Tel: (021) 4276891 • Fax: (021) 4276321  
Web: [www.corkcoco.ie](http://www.corkcoco.ie)



Administration,  
Office of Climate, Licensing & Resource Use,  
Environmental Protection Agency,  
Headquarters,  
PO Box 3000,  
Johnstown Castle Estate,  
Co. Wexford

Direct Tel. No. (021) 4285304  
Direct Fax No. (021) 4343255  
e-mail: [patricia.power@corkcoco.ie](mailto:patricia.power@corkcoco.ie)

24<sup>th</sup> February 2010

**Re: Killeens Waste Water Discharge Licence Application – Ref D0329-01 - Response to Regulation 18(3)(b) Notice.**

Dear Sir,

We respond to Regulation 18(3)(b) Notice issued by Mr Stuart Huskisson of the EPA dated 14<sup>th</sup> December 2009 as follows:

## **Waste Water Works**

1. Updated map of agglomeration to include all aspects of the waste water works.

An updated drawing ref Reg. 18(3)(b) - Map 1 is enclosed. Drawings of the sewers in new housing estates are not available.

2. Clarify events that may lead to a discharge via emergency overflows SW02 and SW03

The secondary discharge point, **SW02** – Killeens, is a 225mm diameter overflow pipe from the sump pump at the WWTP. SW02 will therefore operate and discharge treated effluent if the final pumps (1 duty, 1 standby) fail to operate.

cont'd.../



The secondary discharge point, **SW03** – Killeens, is a 225mm diameter overflow pipe from the storm holding tank at the inlet works to the WWTP. The WWTP has been designed to treat a flow of 27m<sup>3</sup>/h (3DWF for 1,200 PE). Flows in excess of 3DWF are diverted to the storm holding tank, which has a volume of 36m<sup>3</sup>, providing 1.3 hours storage at 3DWF. SW03 will therefore operate if the flow into the plant exceeds 63m<sup>3</sup> in one hour.

3. Clarify frequency and duration of discharges from emergency overflows SW02 and SW03 over the past 12 months. Provide summary details of the reason for the operation of these overflows

Information in relation to frequency and duration of discharges from emergency overflows is not available at this time. In the period 21/11/09 to 18/02/10 the highest daily influent measurement was 387m<sup>3</sup>. The plant is designed to treat 3DWF or 648m<sup>3</sup>/day.

#### Independent Foul Sewer Network

4. Provide details of the independent foul sewer network that caters for c. 9 houses and public house located to the south-east area of Killeens.

A Design Review Report completed by Fehily Timoney & Associates in 2005 notes that:

“There is a separate foul sewer network (MH F24 – MH F29) to cater for approximately 8 houses and a public house located at the south-east part of the village. However, the sewer from MH F24 to MH F28 is not in use and manhole F28 is blanked off. Foul wastewater from the adjacent 4 houses is treated in individual septic tanks/soak pits. The foul waste water from approximately 4 houses and 1 public house at the extreme south-eastern part of the village is collected by the sewer MH F28 to MH F29, and treated in a communal septic tank and soak pit/percolation area located in a field just outside the Killeens development boundary.”

5. Clarify if this discharges is considered a secondary discharge

The sewer from MH F24 to MH F 28 is not in use. The Sewer from MH F 28 to MH F29 is in use and collects foul flows from 4 houses

cont'd.../

and 1 Public house. This flow discharges to a communal septic tank in an adjacent field. The sewer has not been taken in charge by Cork County Council and the septic tank is not the property of Cork County Council, therefore the discharge is not considered a secondary discharge.

6. If considered a secondary discharge, provide an assessment of the impact on the ground including any impact on the environmental media other than those into which the emissions are made.

Not Applicable – not considered a secondary discharge.

7. Clarify if this independent foul sewer network is to be connected to the upgraded WWTP. Provide details of connection date or reasons and justification for not connecting.

Cork County Council has submitted Contract Documents to the Department of the Environment, Heritage and Local Government (DEHLG) for extension of the collection system in Killeens to collect existing houses on individual septic tanks and incorporating a pumping station on the site of the septic tank for the independent foul sewer network.

DEHLG has confirmed that the proposed works cannot be included under the Water Services Investment Programme and can only be funded as a group scheme under the Rural Water Programme. Cork County Council does not propose to proceed with the extension of the collection system at this time.

### **Laboratory Monitoring and Analysis**

8. Provide additional information in relation to monitoring, sampling and analysis:
  - Clarify if composite sampling or continuous flow monitoring is in place at primary or other discharge points.

Automatic composite flow samplers and ultrasonic flow meters are installed at the inlet works and the final effluent pump sump.

cont'd.../

- Provide details of proposal and timeframe to provide composite sampling

Not Applicable – monitoring in place.

- Provide details of proposal and timeframe to provide continuous flow monitoring

Not Applicable – monitoring in place.

9. Update monitoring information entered via web based system for SW1 to include:

- Maximum daily average discharge concentrations and Kg/Day values for Ammonia (as N)

Updated

- Dangerous Substance Emissions - Maximum daily average discharge concentrations and Kg/Day values where information is available

Updated

### General Information

10. Provide an update with the current status in relation to the upgrade of the WWTP, details of any further work to be complete and likely timeframes for completion. Provide details on the funding in relation to any further works to be completed.

The upgrade of the WWTP at Killeens, as described in the original application is now complete.

Yours faithfully,

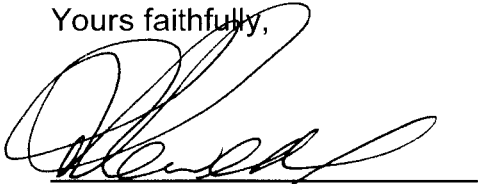





**PATRICIA POWER,  
DIRECTOR OF SERVICES,  
AREA OPERATIONS SOUTH,  
FLOOR 5.**

Encl.

**NOTES**

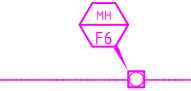
1. Dimensions are not to be scaled from drawing.
2. This drawing is to be read in conjunction with the WWDL Application.
3. This drawing is to be read in conjunction with all other application drawings.

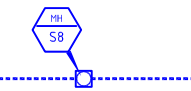
**LEGEND**

-  Existing Foul Sewer
-  Existing Pump Station & Rising Main
-  Existing Storm Sewer
-  Agglomeration Boundary

No.	Date	Drwn	Surv	Chkd	Revision Description

Cork County Council,  
Southern Division.



N. O'KEEFE, B.E.,  
COUNTY ENGINEER,  
COUNTY HALL,  
CORK.

Job Title:  
Killeens  
Wastewater Discharge  
Licence Application

Drawing Title:  
Response to Regulation 18(3)(b)  
Updated map of Agglomeration

Scales: 1:5,000 @ A3	Surveyed by: TOH	Drawn by: TOH
Designed by: T.O.H	Checked by: D.O.S	Date: February 2009
Drawing number: Reg. 18(3)(b) - Map 1	Rev:	-

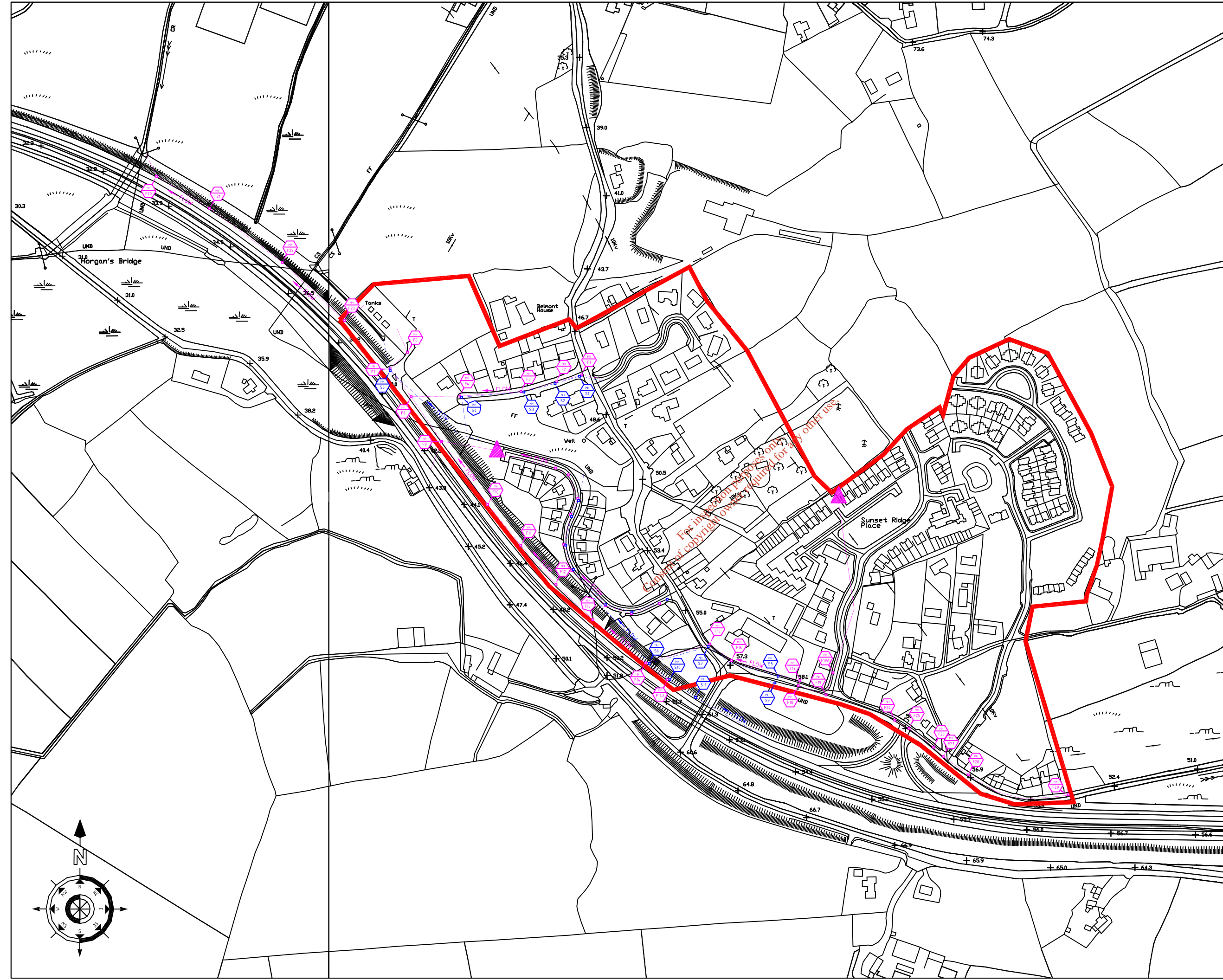

For information purposes only  
 Copyright reserved for all other uses