

LEGEND

- Landfill & Civic Waste Facility Boundary
- Gas Management System
- ◆ Gas Extraction Wells
- ◆ Valve

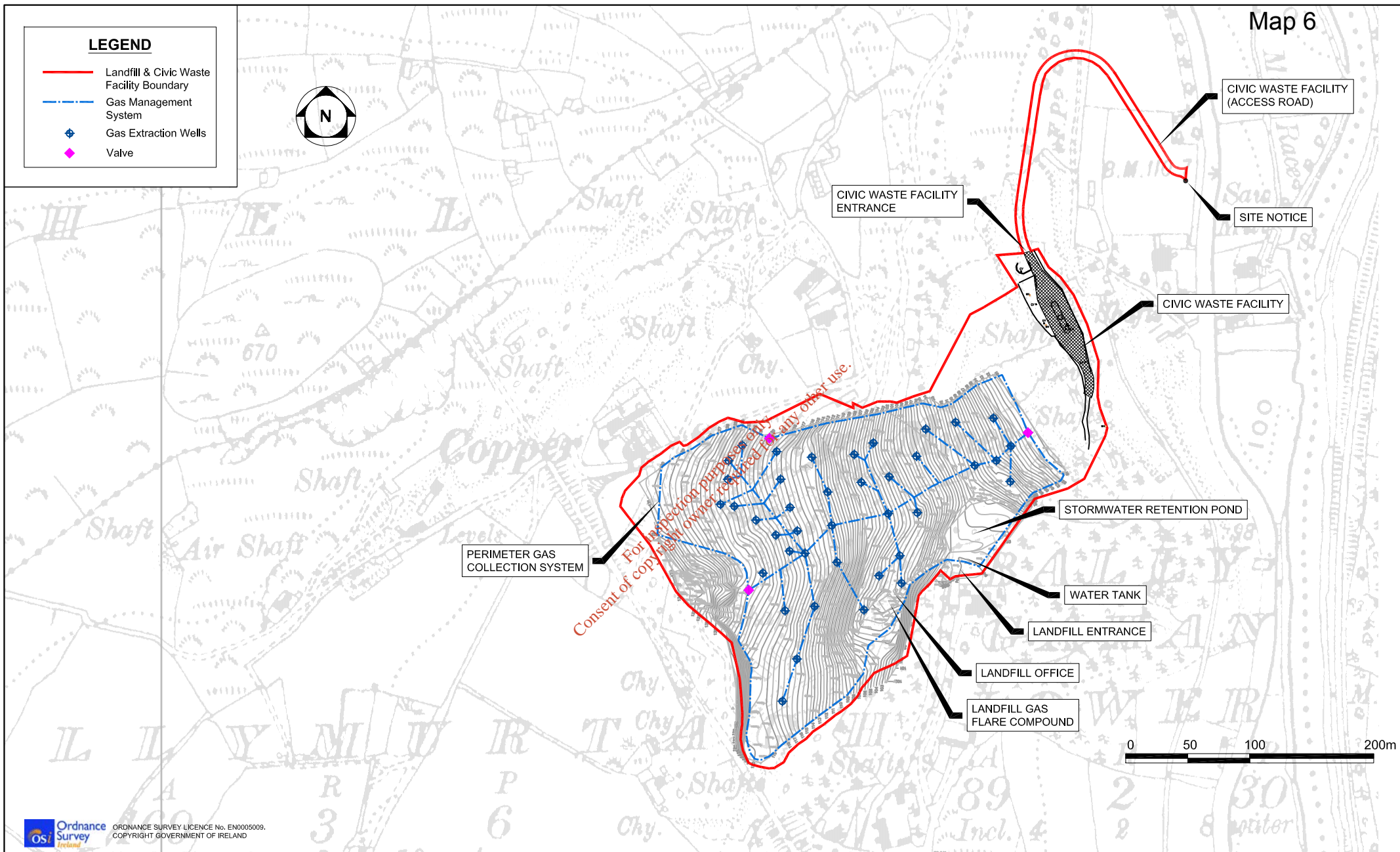

ORDNANCE SURVEY LICENCE No. EN0005009. COPYRIGHT GOVERNMENT OF IRELAND

NOTES

- Verifying Dimensions. The contractor shall verify dimensions against such other drawings or site conditions as pertain to this part of the work.
- Existing Services. Any information concerning the location of existing services indicated on this drawing is intended for general guidance only. It shall be the responsibility of the contractor to determine and verify the exact horizontal and vertical alignment of all cables, pipes, etc., (both underground and overhead) before work commences.
- Issue of Drawings. Hard copies, dxf and pdf will form a controlled issue of the drawing. All other formats (dwg, dxf etc.) are deemed to be an uncontrolled issue and any work carried out based on these files is at the recipient's own risk. RPS will not accept any responsibility for any errors arising from the use of these files, either by human error by the recipient, listing of un-dimensioned measurements, compatibility issues with the recipient's software, and any errors arising when these files are used to aid the recipient's drawing production, or setting out on site.
- Datum: Ordnance Survey Datum, Malin Head

No.	Date	By	App	Amendment / Issue
A01	Oct '09	RH/PL	✓	Issue for Approval

Client

Wicklow County Council
County Buildings,
Wicklow,
Co. Wicklow

Drawn By	Checked By	Approved By	Date
RH	PL	PL	Oct. '09

RPS

West Pier
Business Campus
Dun Laoghaire
Co. Dublin, Ireland

T +353 1 4882900
F +353 1 2835676
W www.rpsgroup.com/ireland
E ireland@rpsgroup.com

Project: **Ballymurtagh Landfill**

Drawing Status	Sheet Size	Scale
Approval	A4	NTS

Drawing Number	Rev
Title	
GAS MANAGEMENT SYSTEM PLAN	