

Waste Licence Review Application

MAPS

*For inspection purposes only.
Consent of copyright owner required for any other use.*

Map A General Location of KMK Recycling Ltd., Cappincur, Daingean R Tullamore, Co. Offaly

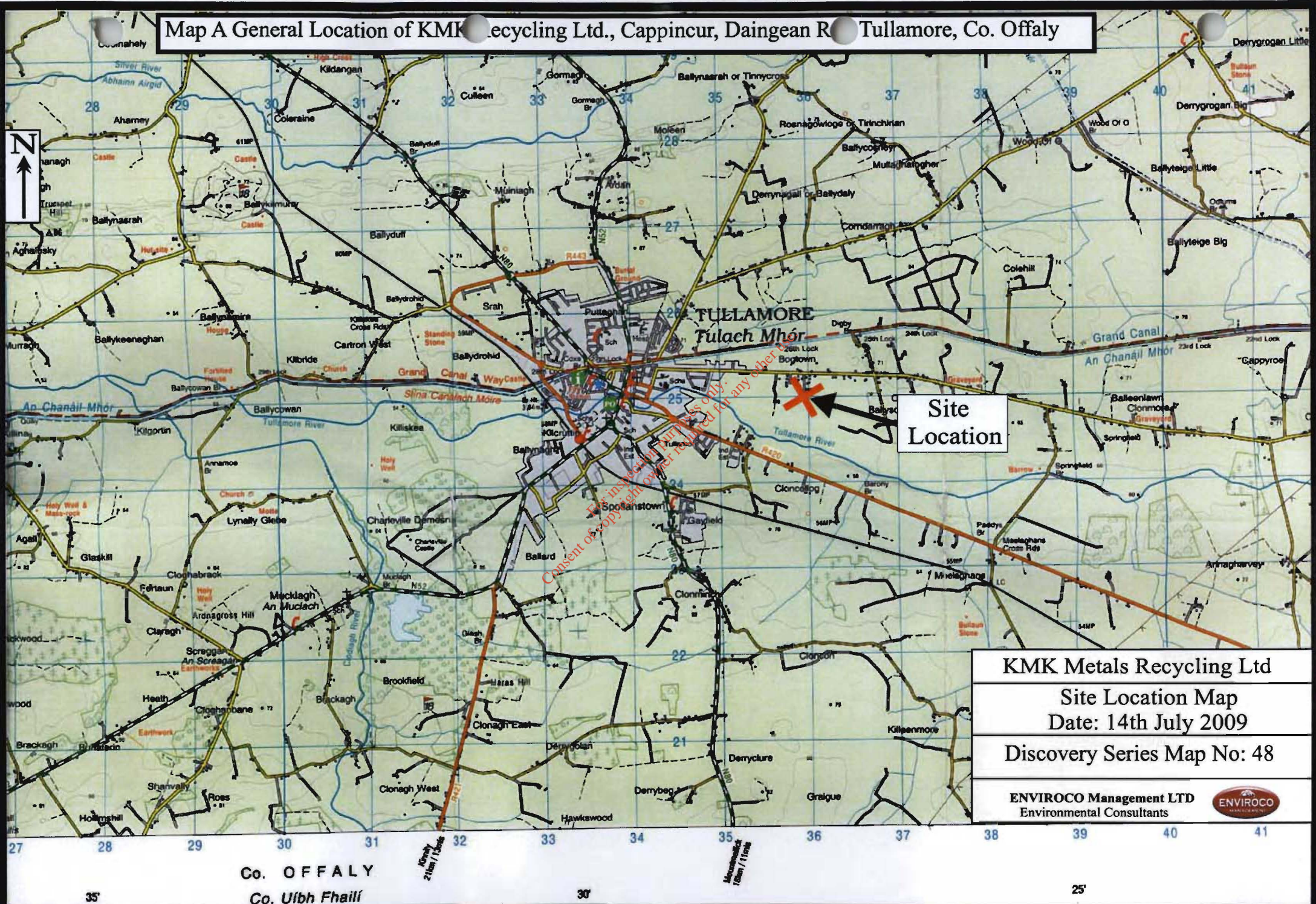

Site Location

KMK Metals Recycling Ltd
 Site Location Map
 Date: 14th July 2009
 Discovery Series Map No: 48

ENVIROCO Management LTD
 Environmental Consultants



Co. OFFALY
 Co. Uíbh Fhailí

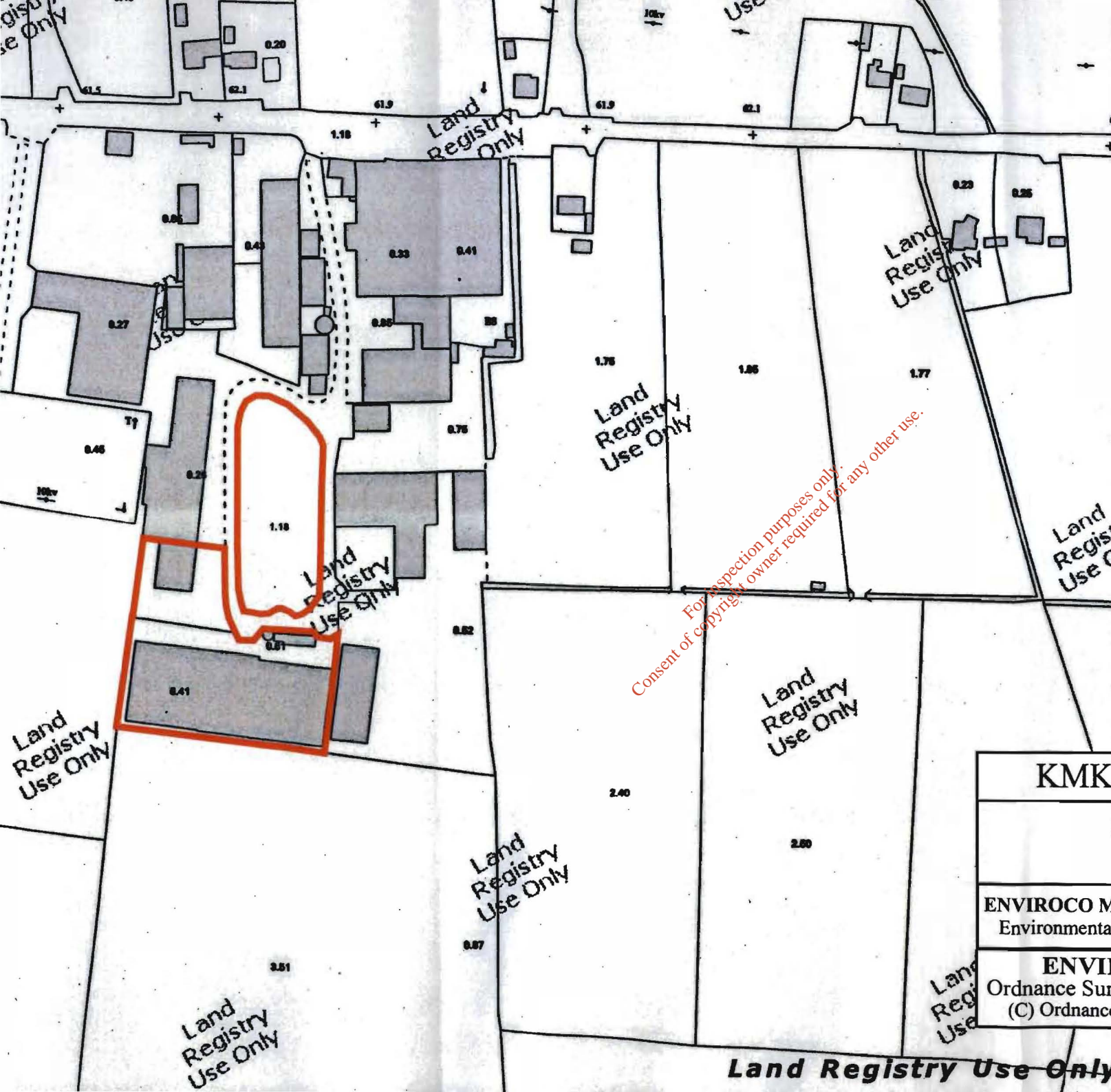

DESCRIPTION
MAP SHEETS
1:2500 3434-B 3435-A
 Authorised Internet Map
<small>Arna thionsú agus arna fhoilsiú ag Surbhéireacht Ordánais Éireann. Éilic an Éilicéilicé. Bailé Átha Cliath Compiled in Ireland, Ph...</small>

Legend

 = Site Boundary

KMK Metals Recycling Ltd	
Site Location Map September 2009	
ENVIROCO Management LTD Environmental Consultants	
ENVIROCO Management Ltd. Ordnance Survey Ireland Licence No EN 0039409 (C) Ordnance Survey Ireland Government of Ireland	





DESCRIPTION

MAP SHEETS

1:2500
3434-B 3435-A

Legend

-  = Site boundary
-  = land not in ownership of applicant (leased areas)



Arís Síomáil agus arís Shléibé ag Suirbhéireacht Ordánáil Éireann, Páirc an Phionnaisle, Balle Átha Cliath 8, Éire.
Compiled and published by Ordnance Survey Ireland, Phoenix Park, Dublin 8, Ireland.

Sáinnseán aithneacht aonáidreálaí aipéiréir Suirbhéireacht Ordánáil Éireann agus Síomáil na hÉireann.
Unauthorized reproduction infringes Ordnance Survey Ireland and Government of Ireland copyright.

Gach cead ar coisnáim. Ní coisnáimh aon chuid

KMK Metals Recycling Ltd

Site Ownership Map
August 2009

ENVIROCO Management LTD
Environmental Consultants



ENVIROCO Management Ltd.
Ordnance Survey Ireland Licence No 0039409
(C) Ordnance Survey Ireland Government of Ireland

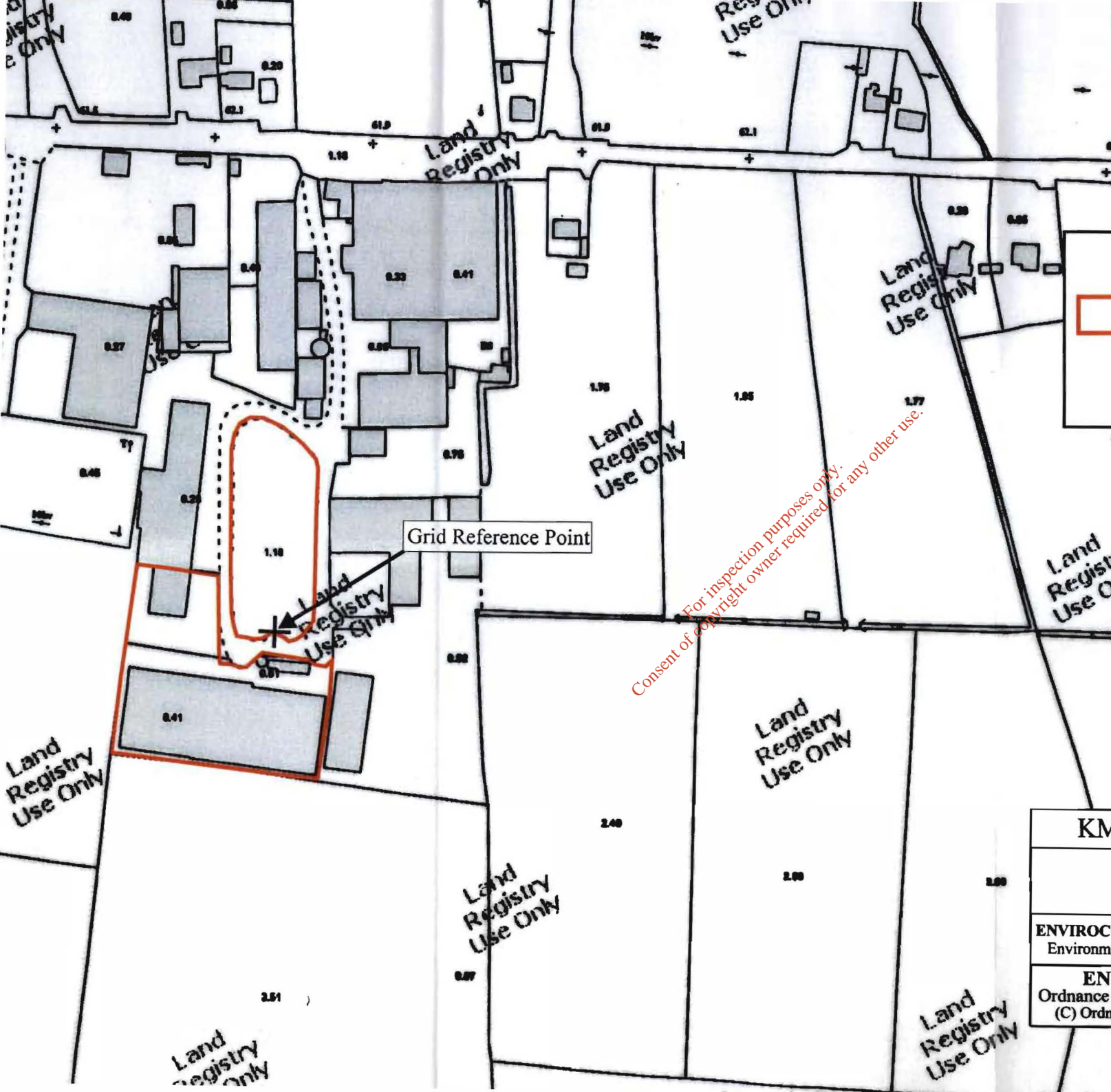

DESCRIPTION

MAP SHEETS

1:2500
3434-B 3435-A

Legend

- = Site boundary
- = Grid Reference Point (E635890 N725043)



Arna thionsá agus arna tholáil ag Suirbhíreacht Ordánis Éireann, Páirc an Phlannúisce, Balle Átha Cliath 8, Éire.
Compiled and published by Ordnance Survey Ireland, Phoenix Park, Dublin 8, Ireland.

Síolonn stáirgeadh neamhdarálta oipheacht Suirbhíreacht Ordánis Éireann agus Rialtas na hÉireann.
Unauthorized reproduction infringes Ordnance Survey Ireland and Government of Ireland copyright.

Gach cead ar eanáir. Ní ceodúch an chuid

KMK Metals Recycling Ltd

Site Location Map
August 2009

ENVIROCO Management LTD
Environmental Consultants

ENVIROCO Management Ltd.
Ordnance Survey Ireland Licence No EN 0039409
(C) Ordnance Survey Ireland Government of Ireland

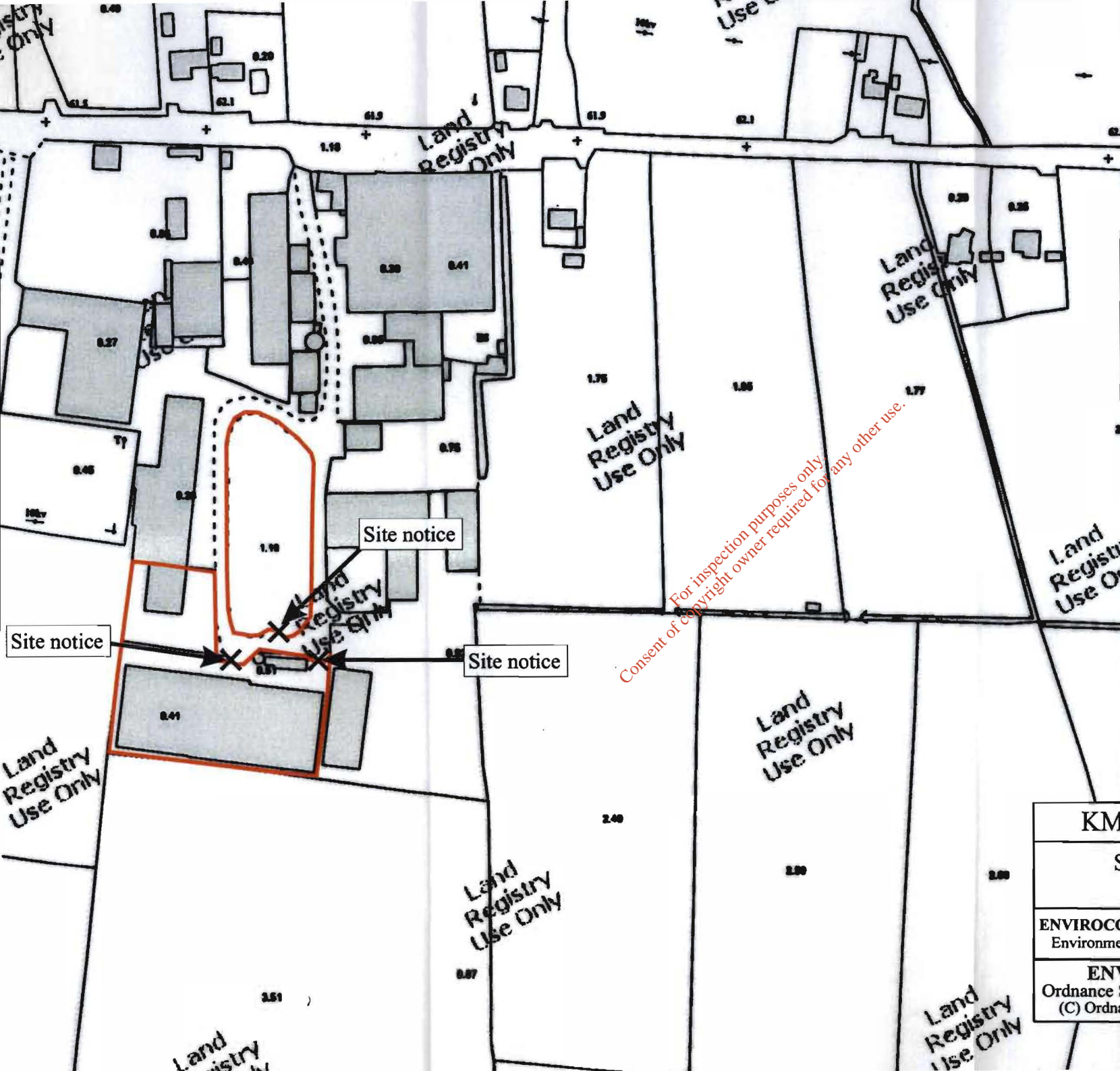

DESCRIPTION

MAP SHEETS

1:2500
3434-B 3435-A

Legend

 = Site boundary

 **Authorised Internet Map**

Arna dtionsaí agus arna fhoilsiú ag Suidhreachaí Ordánáil Éireann, Páirc an Fhionnulaice, Bala Átha Cliath 8, Éire.
Compiled and published by Ordnance Survey Ireland, Phoenix Park, Dublin 8, Ireland.

Sárleann aidiogach neamhdáiríthe aige/vear Shuidhreachaí Ordánáil Éireann agus Rialtas na hÉireann.
Unauthorized reproduction infringes Ordnance Survey Ireland and Government of Ireland copyright.

Gach cead ar cois/ná. Ní ead/néach aon shuid

KMK Metals Recycling Ltd

Site Notice Location Map
August 2009

ENVIROCO Management LTD
Environmental Consultants 

ENVIROCO Management Ltd.
Ordnance Survey Ireland Licence No EN 0039409
(C) Ordnance Survey Ireland Government of Ireland

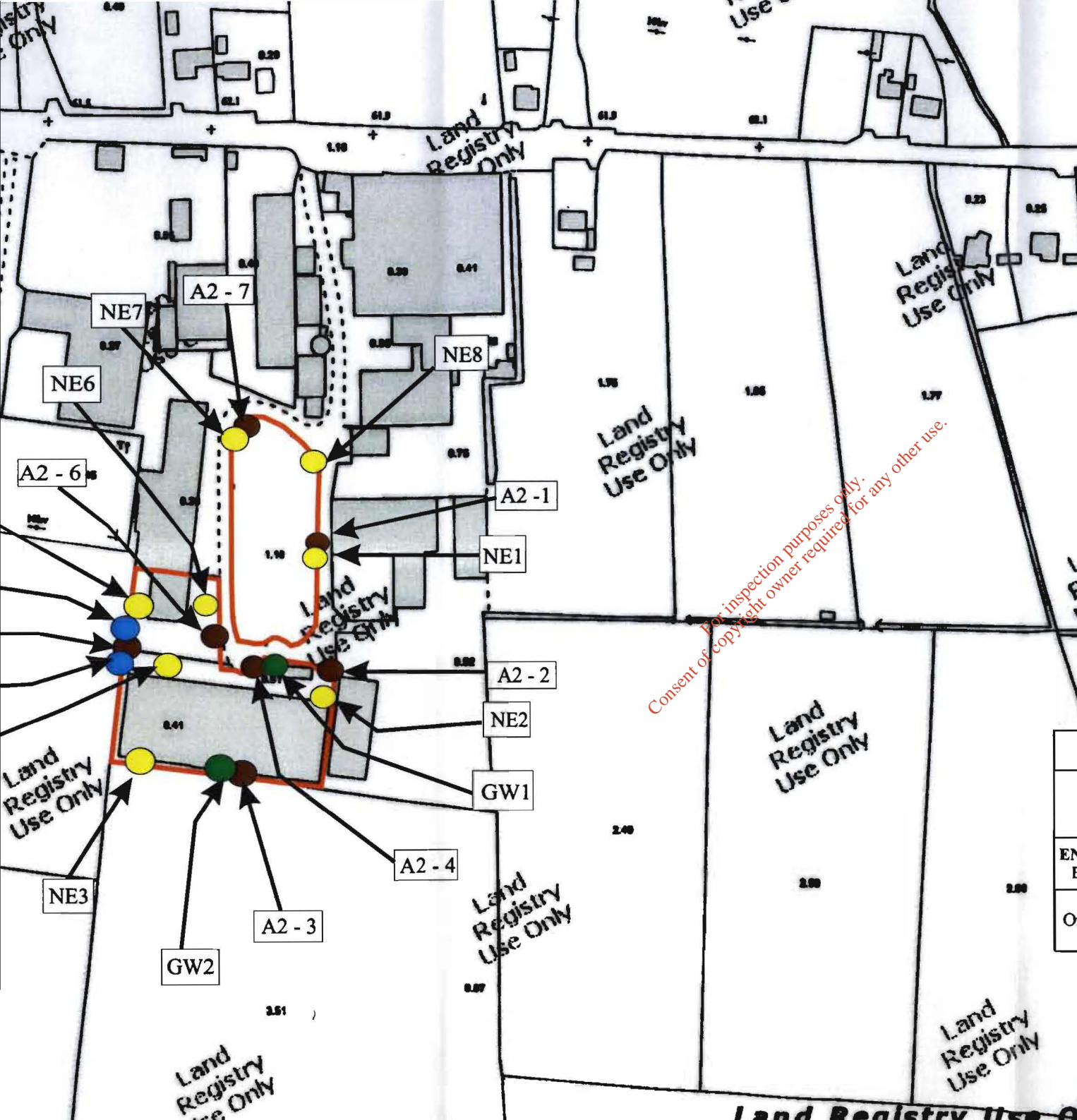

DESCRIPTION

Legend

- = Site Boundary
- = Dust Emission Points
- = Noise Emission Points
- = Surface Water Emission Points
- = Groundwater Emission Points

ITM Grid References

- A2-1 = E635955 N725044
- A2-2 = E635959 N725004
- A2-3 = E635882 N724955
- A2-4 = E635911 N724993
- A2-5 = E635866 N725002
- A2-6 = E635902 N725021
- A2-7 = E635911 N725118
- NE1 = E635950 N725047
- NE2 = E635956 N725002
- NE3 = E635863 N724963
- NE4 = E635872 N725008
- NE5 = E635862 N725032
- NE6 = E635906 N725043
- NE7 = E635908 N725115
- NE8 = E635951 N725114
- CX = E635772 N725046
- DX = E635772 N725036
- GW1 = E635847 N725032
- GW2 = E635812 N724986

Consent of copyright owner required for any other use.

KMK Metals Recycling Ltd

Environmental Emissions Map
August 2009

ENVIROCO Management LTD
Environmental Consultants



ENVIROCO Management Ltd.
Ordnance Survey Ireland Licence No EN 0039409
(C) Ordnance Survey Ireland Government of Ireland

The representation on this map of a road, track or footpath is not evidence of the existence of a right of way.

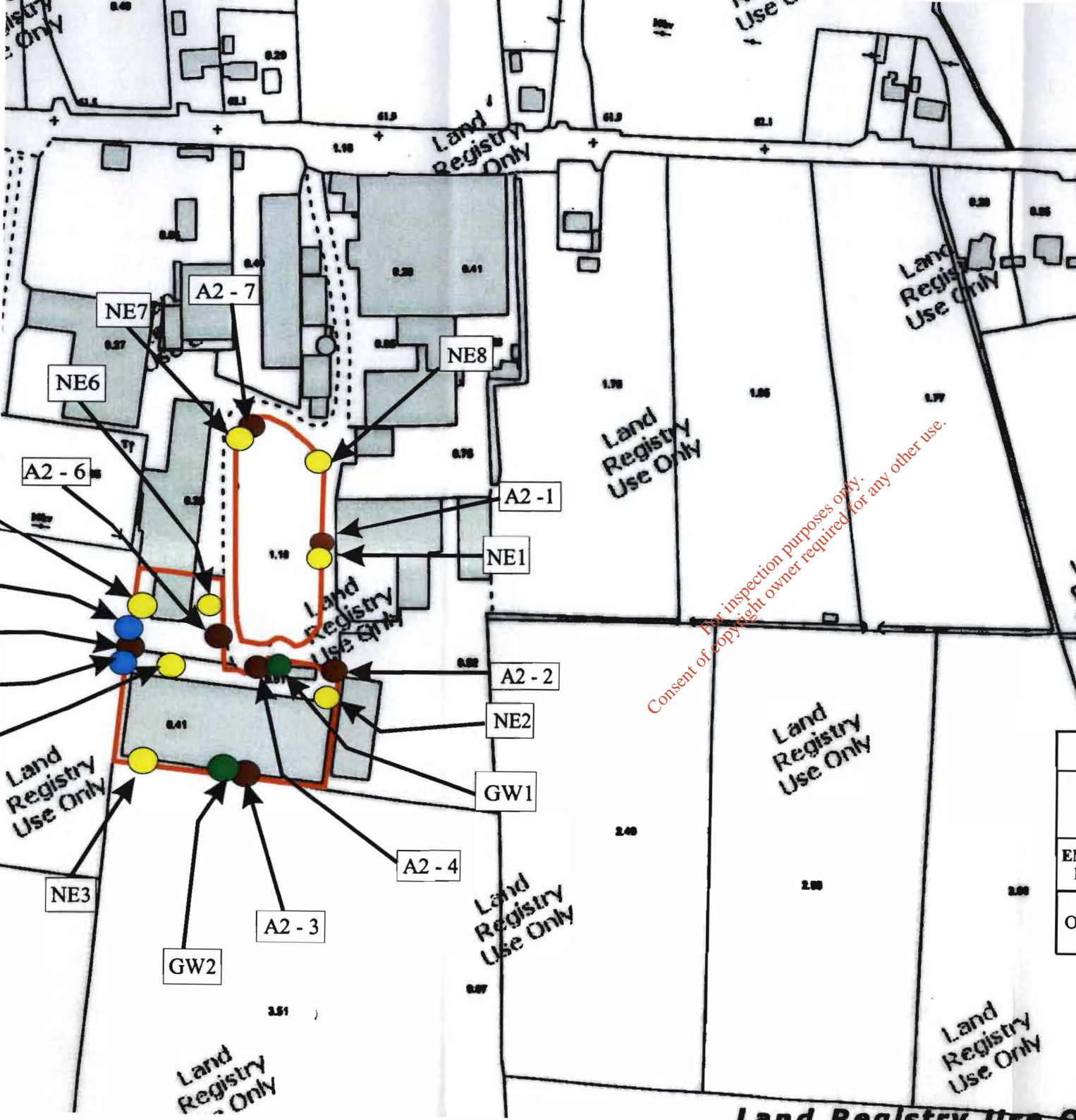

Legend

- = Site Boundary
- = Dust Emission Points
- = Noise Emission Points
- = Surface Water Emission Points
- = Groundwater Emission Points

ITM Grid References

- A2-1 = E635955 N725044
- A2-2 = E635959 N725004
- A2-3 = E635882 N724955
- A2-4 = E635911 N724993
- A2-5 = E635866 N725002
- A2-6 = E635902 N725021
- A2-7 = E635911 N725118
- NE1 = E635950 N725047
- NE2 = E635956 N725002
- NE3 = E635863 N724963
- NE4 = E635872 N725008
- NE5 = E635862 N725032
- NE6 = E635906 N725043
- NE7 = E635908 N725115
- NE8 = E635951 N725114
- CX = E635772 N725046
- DX = E635772 N725036
- E = to be agreed
- GW1 = E635847 N725032
- GW2 = E635812 N724986

Consent of copyright owner required for any other use.

KMK Metals Recycling Ltd

Environmental Monitoring Map
August 2009

ENVIROCO Management LTD
Environmental Consultants



ENVIROCO Management Ltd.
Ordnance Survey Ireland Licence No EN 0039409
(C) Ordnance Survey Ireland Government of Ireland

The representation on this map of a road, track or footpath is not evidence of the existence of a right of way.

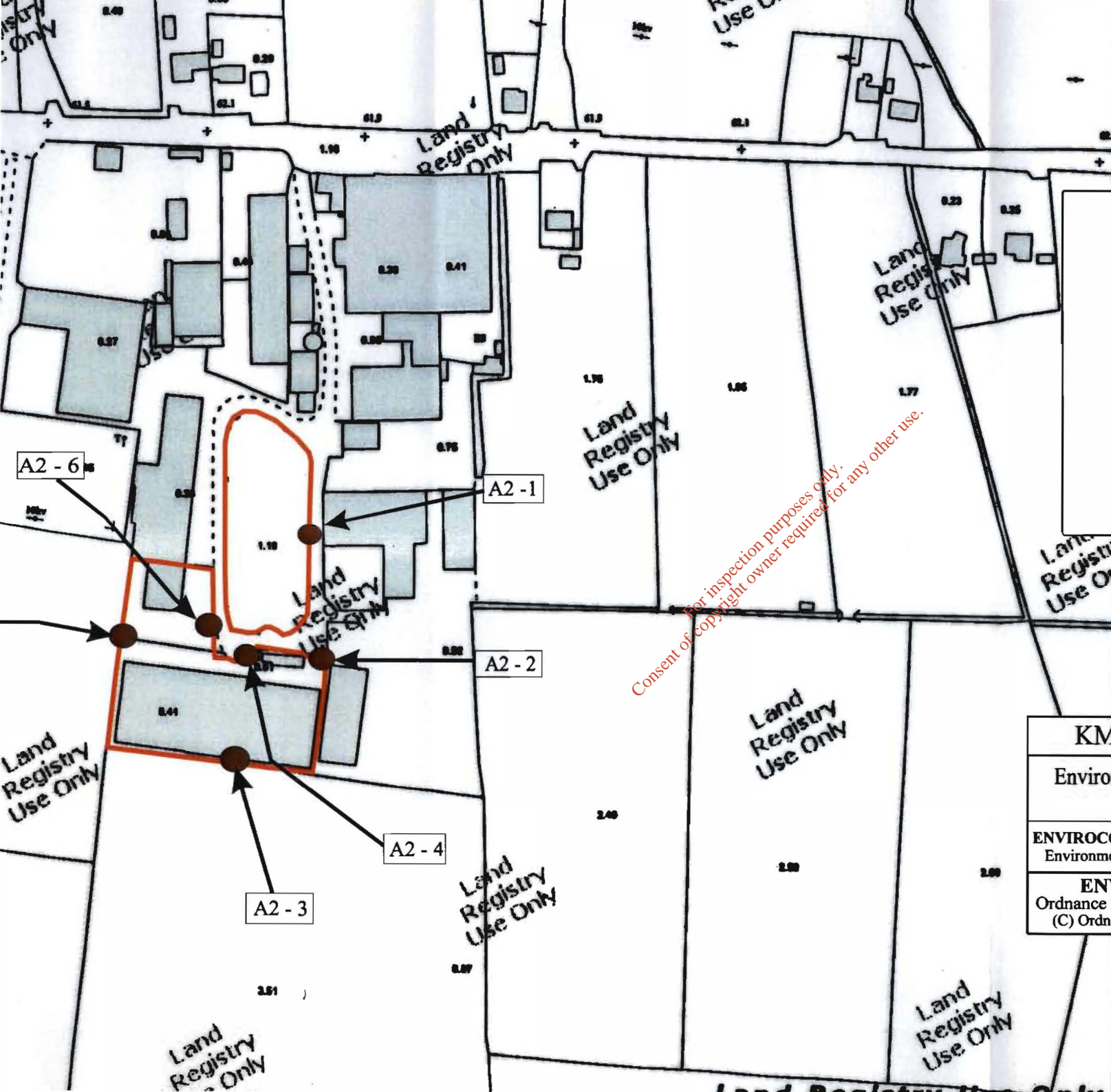

DESCRIPTION

MAP SHEETS

1:2500
3434-B 3435-A

Legend

- = Site Boundary
- = Dust Emission Points

ITM Grid References

- A2-1 = E635955 N725044
- A2-2 = E635959 N725004
- A2-3 = E635882 N724955
- A2-4 = E635911 N724993
- A2-5 = E635866 N725002
- A2-6 = E635902 N725021

Consent of copyright owner required for any other use.

Anna Ní Mháol agus an tArdáil ag Suirbhíreacht
Ordnála Éireann, Páirc an Pionnais, Baile Átha Cliath 8, Éire.
Compiled and published by Ordnance Survey
Ireland, Phoenix Park, Dublin 8, Ireland.

Sábháil an tairgeadh seo chomh maith leis an tairgeadh
Suirbhíreacht Ordnála Éireann agus
níl sé ar fáil.

KMK Metals Recycling Ltd

Environmental Dust Monitoring Map
August 2009

ENVIROCO Management LTD
Environmental Consultants

ENVIROCO Management Ltd.
Ordnance Survey Ireland Licence No EN 0039409
(C) Ordnance Survey Ireland Government of Ireland



The representation on this map of a road, track
or footpath is not evidence of the existence of
a right of way.

© Suirbhíreacht Ordnála Éireann, 2009
© Ordnance Survey Ireland, 2009

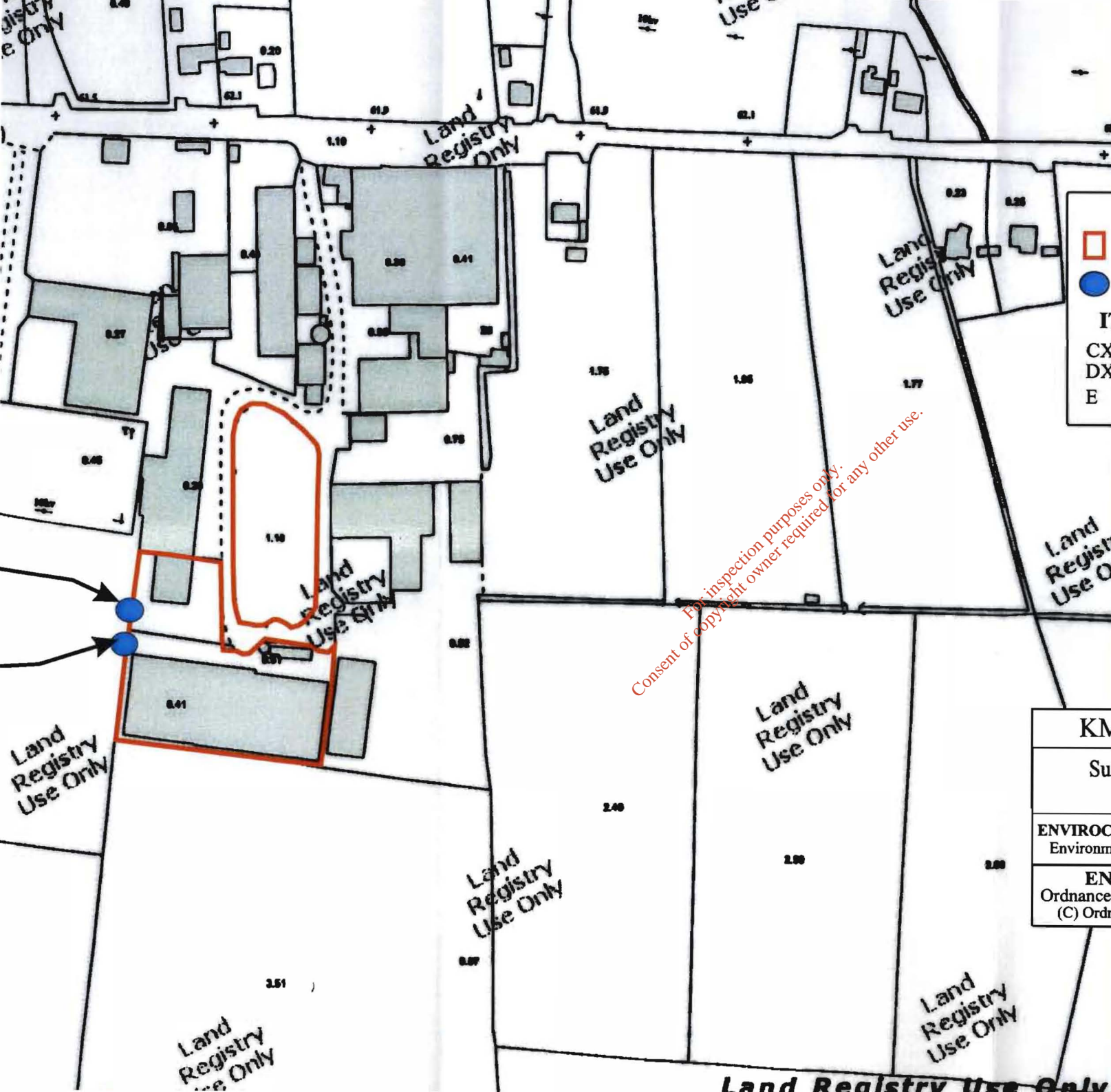



DESCRIPTION

MAP SHEETS

1:2500

3434-B 3435-A

Legend

-  = Site Boundary
-  = Surface Water Emission Points

ITM Grid References

- CX = E635772 N725046
- DX = E635772 N725036
- E = to be agreed



**Authorised
Internet Map**

Arna tháinig agus arna thailéad ag Suirbhíreacht
Ordnála Éireann, Páirc an Phionnaisce, Baile Átha Cliath 8, Éire.
Compiled and published by Ordnance Survey
Ireland, Phoenix Park, Dublin 8, Ireland.

Breilinn stáisiúnach naomhúdarthaí eileáireant
Suirbhíreacht Ordnála Éireann agus
Stáisiún na hÉireann

KMK Metals Recycling Ltd

Surface Water Monitoring Map
August 2009

ENVIROCO Management LTD
Environmental Consultants



ENVIROCO Management Ltd.
Ordnance Survey Ireland Licence No EN 0039409
(C) Ordnance Survey Ireland Government of Ireland

The representation on this map of a road, track
or footpath is not evidence of the existence of
a right of way.

© Suirbhíreacht Ordnála Éireann, 2009
© Ordnance Survey Ireland, 2009

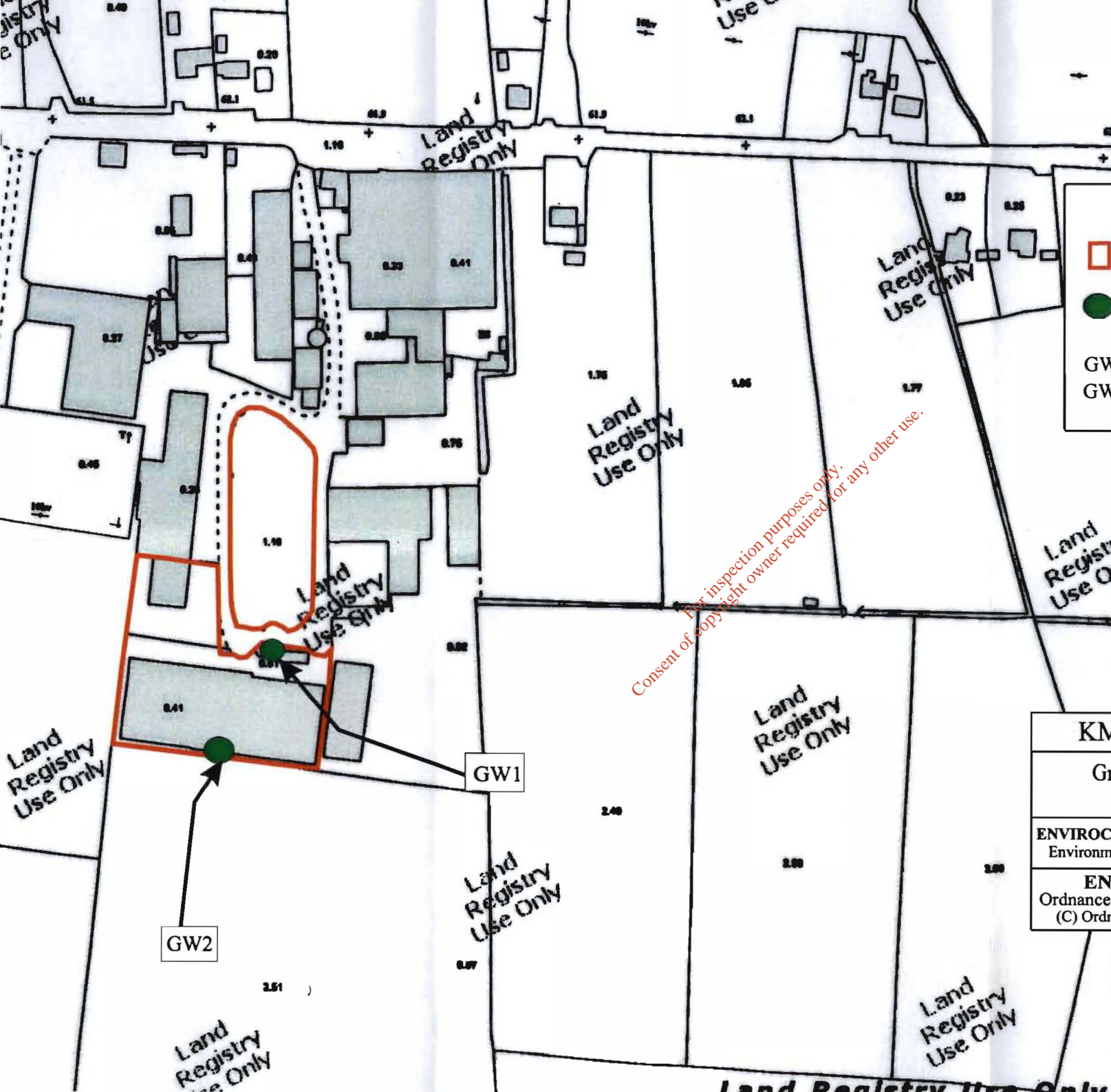



DESCRIPTION

MAP SHEETS

1:2500
3434-B 3435-A

Legend

-  = Site Boundary
 -  = Groundwater Emission Points
- ITM Grid References**
- GW1 = E635847 N725032
 - GW2 = E635812 N724986



*Ára Níomá agus ára Bholá ag Suirbhóirí Ordáná Éireann, Fáilín na Píoláin, Baile Átha Cliath 2, Éire.
Compiled and published by Ordnance Survey Ireland, Phoenix Park, Dublin 8, Ireland.*

Séalaín áirígeadh neamhdúlraí a chloíonn Suirbhóirí Ordáná Éireann agus Fáilínín na Píoláin.

KMK Metals Recycling Ltd	
Groundwater Monitoring Map August 2009	
ENVIROCO Management LTD Environmental Consultants	
ENVIROCO Management Ltd. Ordnance Survey Ireland Licence No EN 0039409 (C) Ordnance Survey Ireland Government of Ireland	

The representation on this map of a road, track or footpath is not evidence of the existence of a right of way.

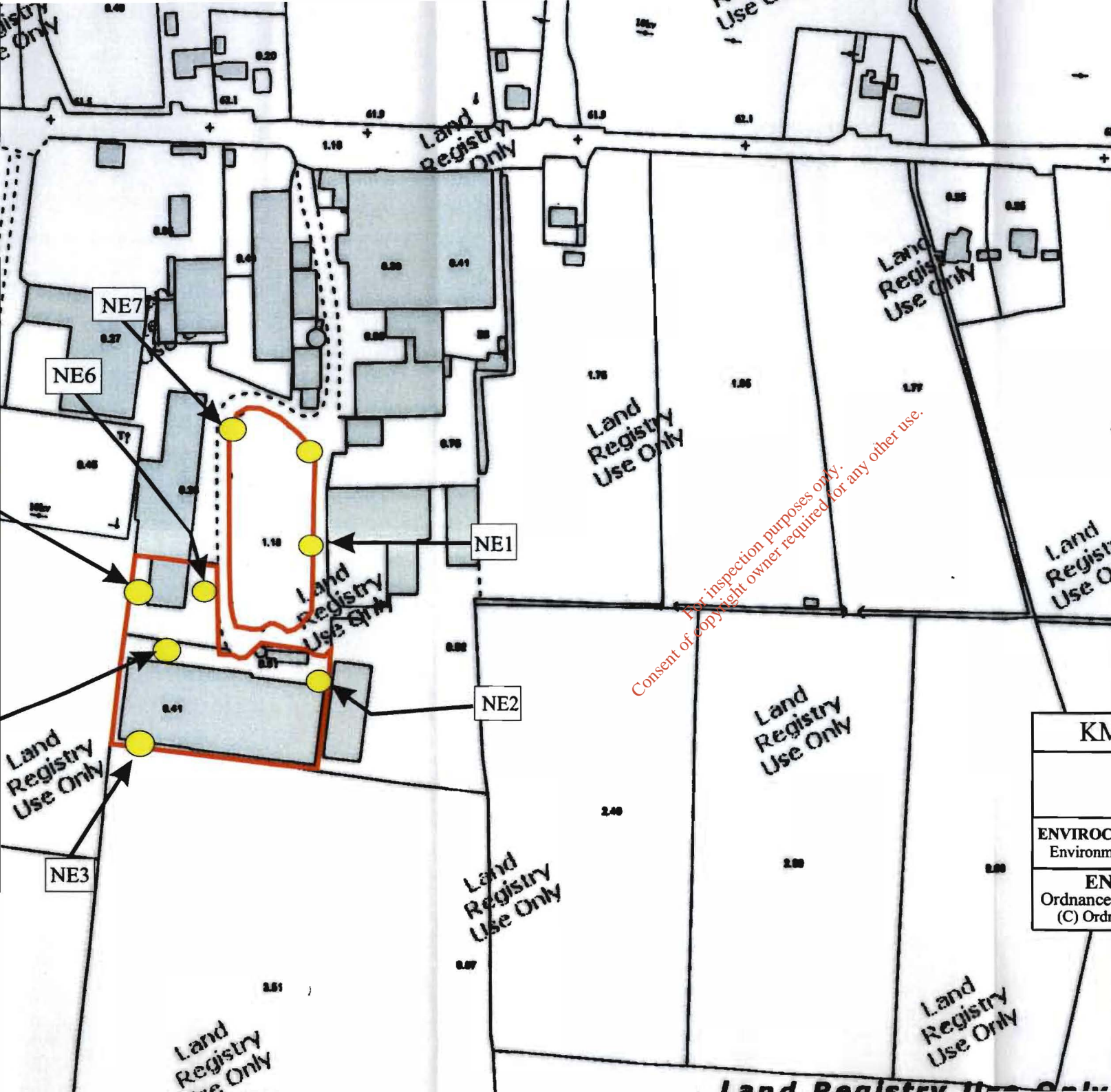

DESCRIPTION

MAP SHEETS

1:2500
3434-B 3435-A

Legend

- = Site Boundary
- = Noise Emission Points

ITM Grid References

- NE1 = E635950 N725047
- NE2 = E635956 N725002
- NE3 = E635863 N724963
- NE4 = E635872 N725008
- NE5 = E635862 N725032
- NE6 = E635906 N725043
- NE7 = E635908 N725115
- NE8 = E635951 N725114

Consent of copyright owner required for any other use.

Arna thionsú agus arna tholláil ag Suirbhíreacht Ordánis Éireann, Páirc an Fhionnuisce, Baile Átha Cliath 8, Éire.
Compiled and published by Ordnance Survey Ireland, Phoenix Park, Dublin 8, Ireland.

Séailteann stáisiúnaigh neamhdhírretha a bhfuil ag Suirbhíreacht Ordánis Éireann agus Stáisiúnaigh Áiríne.

KMK Metals Recycling Ltd

Noise Monitoring Map
August 2009

ENVIROCO Management LTD
Environmental Consultants



ENVIROCO Management Ltd.
Ordnance Survey Ireland Licence No EN 0039409
(C) Ordnance Survey Ireland Government of Ireland

The representation on this map of a road, track or footpath is not evidence of the existence of a right of way.



For inspection purposes only.
Consent of copyright owner required for any other use.

DESCRIPTION

MAP SHEETS

1:2500
 3434-B 3434-D
 3435-A 3435-C
 1:1000
 3434-09 3434-14



Produced by The Map Store,
 Westmeath County Council,
 Church Street, Mullingar, Co. Westmeath
 On behalf of Ordnance Survey Ireland,
 Phoenix Park, Dublin 8.

Sáiríonn an
 Shuirbhéireas
 Rialtas na h-
 Unauthorise
 Survey Irela
 copyright.

Gach cead d
 den fhóisea
 a thairchur in

Legend	
	= Site
	= Cappincur Ind estate
	= Residential Units
	= Garage
	= Offaly Co Co Dog Pound

KMK Metals Recycling Ltd

Site Location Map
 Date: 16th September 2009

ENVIROCO Management LTD
 Environmental Consultants

