

ATTACHMENT F7 – NOISE MONITORING

Details of the noise monitoring to be undertaken at the proposed waste recovery facility are provided in Section 2.6.8 of the Environmental Impact Statement.

Proposed noise monitoring locations are shown in Figure F7.1 and Figure 8.1 of the Environmental Impact Statement.

Monitoring Reference No.	Parameter	Monitoring Frequency	Location (Grid Co-ordinates)	Accessibility of Sampling Points
N1	Sound Level (dBA)	Quarterly	324673E 259162N	Easy : open ground
N2	Sound Level (dBA)	Quarterly	324611E 258865N	Easy : open ground
N3	Sound Level (dBA)	Quarterly	324616E 259054N	Easy : open ground

Table F7.1 Noise Monitoring Points

For inspection purposes only.
Consent of copyright owner required for any other use.

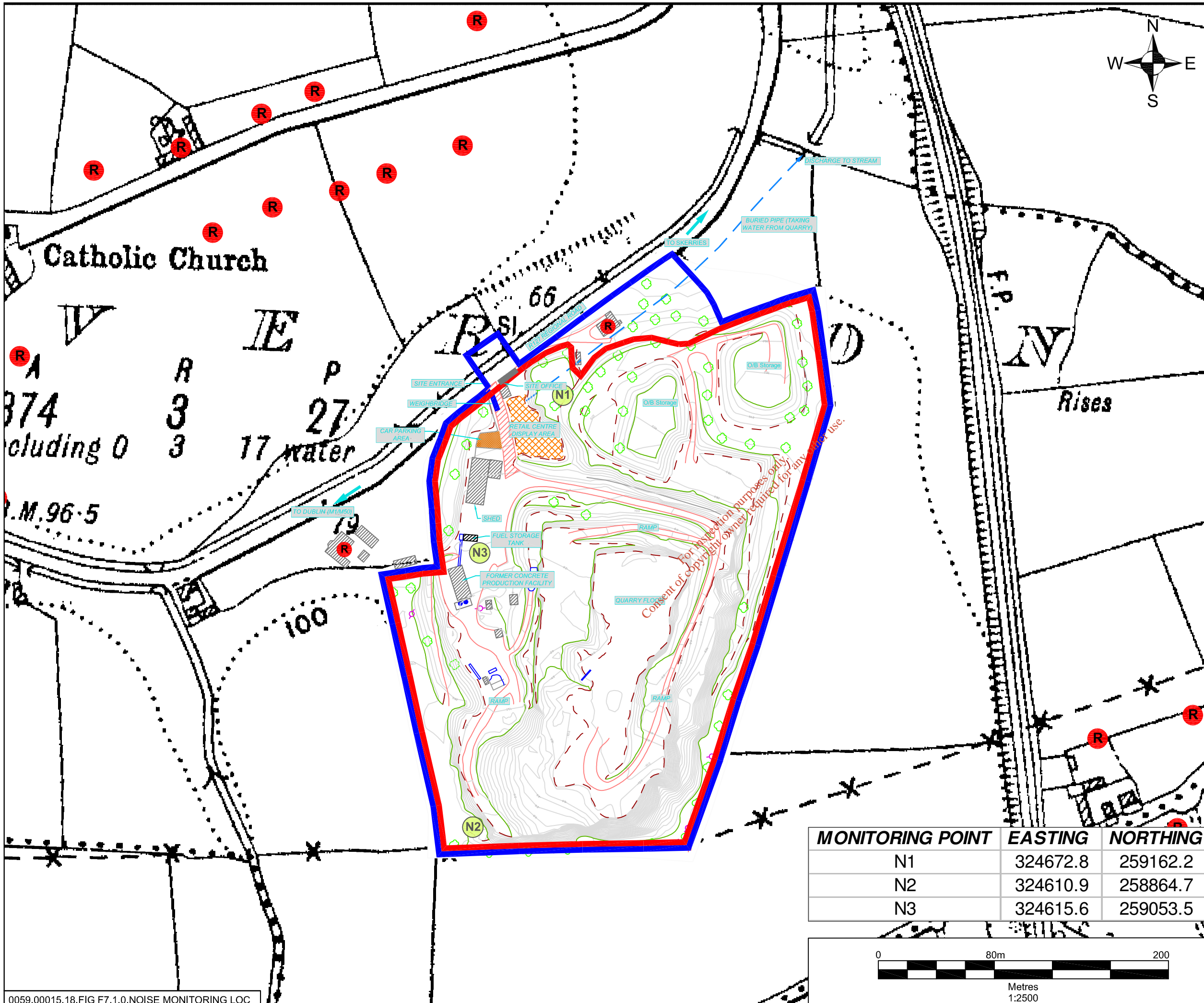

NOTES

- Based on OSi 25inch Dublin Sheet No. 5 & 5a
- Ordnance Survey of Ireland Licence No. SU 0000709 (c) Ordnance Survey of Ireland & Government of Ireland

- LEGEND**
- Applicant's Land Interest (c. 8.6ha)
 - Waste Licence Application Area (c. 7.9ha)
 - Noise Monitoring Locations
 - Buried Pipe
 - Top of Bank
 - Bottom of Bank
 - Road
 - Contour Line
 - Building
 - Internal Unpaved Road
 - Internal Paved Road
 - Location of Residence

roadstone
 ROADSTONE DUBLIN LTD.
 FORTUNESTOWN
 TALLAGHT
 DUBLIN 24

SLR
 SLR CONSULTING IRELAND
 7 DUNDRUM BUSINESS PARK
 WINDY ARBOUR
 DUBLIN 14
 T: +353-1-2964667
 F: +353-1-2964676
 www.slrconsulting.com

MONITORING POINT	EASTING	NORTHING
N1	324672.8	259162.2
N2	324610.9	258864.7
N3	324615.6	259053.5

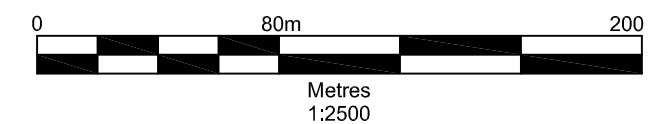

ROADSTONE DUBLIN LTD.
 WASTE LICENCE APPLICATION
 WASTE RECOVERY FACILITY,
 MILVERTON, SKERRIES, CO. DUBLIN
NOISE MONITORING LOCATIONS

FIGURE F7.1

Scale: 1:2,500 @ A3 Date: AUGUST 2009