

## **ATTACHMENT D1 – SITE INFRASTRUCTURE**

### **D1.a Site Security Arrangements**

Refer to Section 2.2.1 of Environmental Impact Statement

### **D1.b Design for Site Roads**

Refer to Section 2.2.2 of Environmental Impact Statement and Drawing No. D1.1

### **D1.c Design of Hardstanding Areas**

Refer to Section 2.2.3 of Environmental Impact Statement and Drawing No. D1.1

### **D1.d Plant**

Refer to Section 2.2.6 of Environmental Impact Statement and Drawing No. D1.1

### **D1.e Weighbridge**

Refer to Section 2.2.4 of Environmental Impact Statement and Drawing No. D1.1

### **D1.f Wheelwash**

Refer to Section 2.2.4 of Environmental Impact Statement and Drawing No. D1.1

### **D1.g Laboratory Facilities**

Refer to Section 2.2.5 of Environmental Impact Statement

### **D1.h Design and Location of Fuel Storage Areas**

Refer to Section 2.2.6 of Environmental Impact Statement

### **D1.i Waste Quarantine Areas**

Refer to Section 2.2.7 of Environmental Impact Statement and Drawing No. D1.1

### **D1.j Waste Inspection Areas**

Refer to Section 2.2.7 of Environmental Impact Statement and Drawing No. D1.1

### **D1.k Traffic Control**

Refer to Section 2.2.8 of Environmental Impact Statement

### **D1.l Sewerage and Surface Water Drainage Infrastructure**

Refer to Section 2.2.9 of Environmental Impact Statement and Drawing No. D1.1

### **D1.m All Other Services**

Refer to Section 2.2.10 of Environmental Impact Statement and Drawing No. D1.2

### **D1.n Plant Sheds, Garages and Equipment Compound**

Refer to Section 2.2.11 of Environmental Impact Statement and Drawing No. D1.1

### **D1.o Site Accommodation**

Refer to Section 2.2.12 of Environmental Impact Statement.

**D1.p Any Other Waste Recovery Infrastructure**

Refer to Section 2.2.13 of Environmental Impact Statement and Drawing No. D1.1

**D1.q Any Other Infrastructure**

Not Applicable

For inspection purposes only.  
Consent of copyright owner required for any other use.

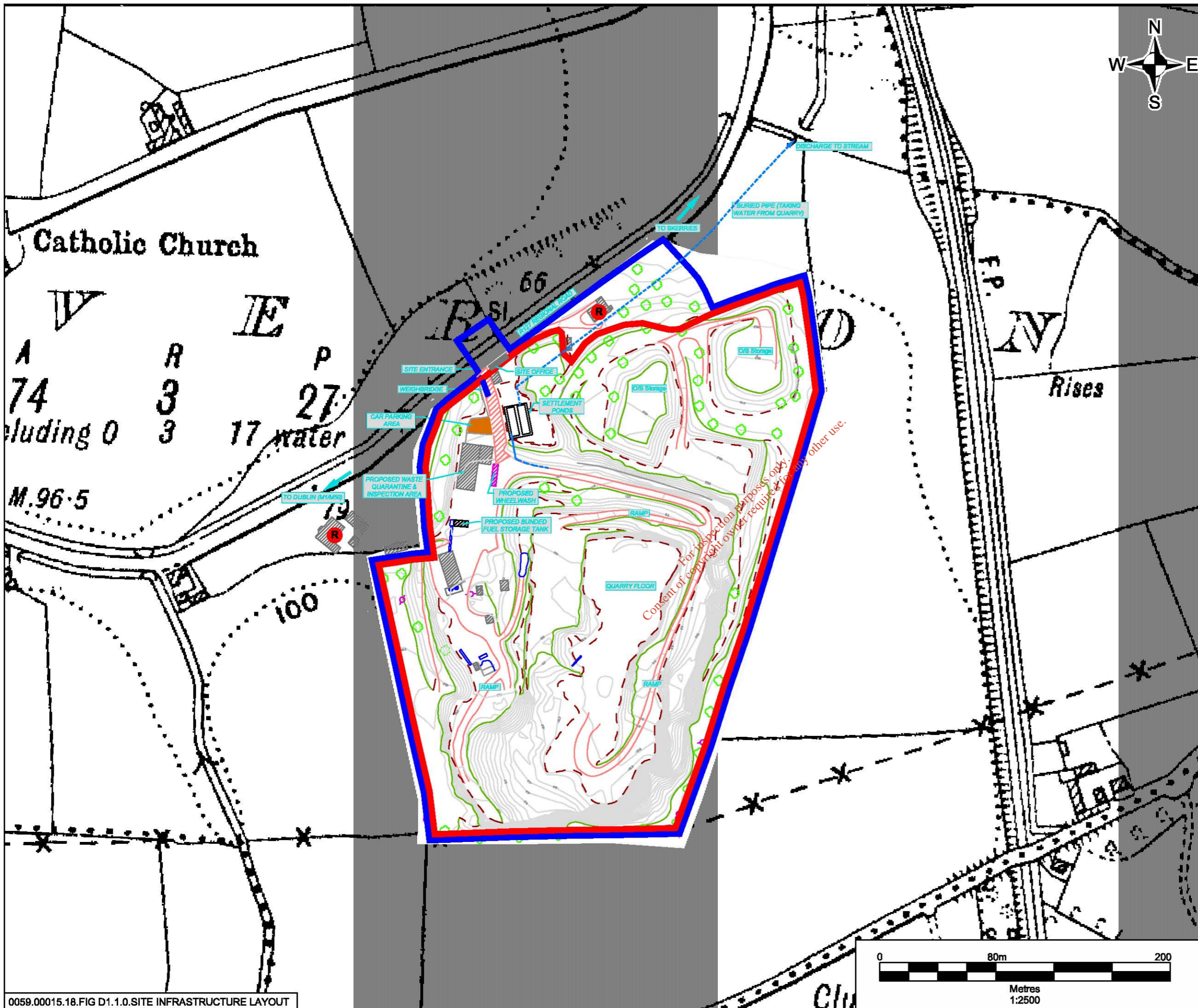

**NOTES**

- Based on OSI 25inch Dublin Sheet No. 5 & 5a
- Ordnance Survey of Ireland Licence No. SU 0000709 (c) Ordnance Survey of Ireland & Government of Ireland

**LEGEND**

|  |   |
|--|---|
|  | Applicant's Land Interest (c. 8.6ha)      |
|  | Waste Licence Application Area (c. 7.9ha) |
|  | Buried Pipe                               |
|  | Top of Bank                               |
|  | Bottom of Bank                            |
|  | Road                                      |
|  | Contour Line                              |
|  | Building                                  |
|  | Internal Unpaved Road                     |
|  | Internal Paved Road                       |
|  | Location of Residence                     |

**roadstone**  
 ROADSTONE DUBLIN LTD.  
 FORTUNESTOWN  
 TALLAGHT  
 DUBLIN 24

**SLR**  
 SLR CONSULTING IRELAND  
 7 DUNDRUM BUSINESS PARK  
 WINDY ARBOUR  
 DUBLIN 14  
 T: +353-1-2984667  
 F: +353-1-2984676  
 www.slrconsulting.com

**ROADSTONE DUBLIN LTD.**  
**WASTE LICENCE APPLICATION**  
**WASTE RECOVERY FACILITY,**  
**MILVERTON, SKERRIES, CO. DUBLIN**  
**SITE INFRASTRUCTURE LAYOUT**

**FIGURE D1.1**

Scale: 1:2,500 @ A3      Date: AUGUST 2009

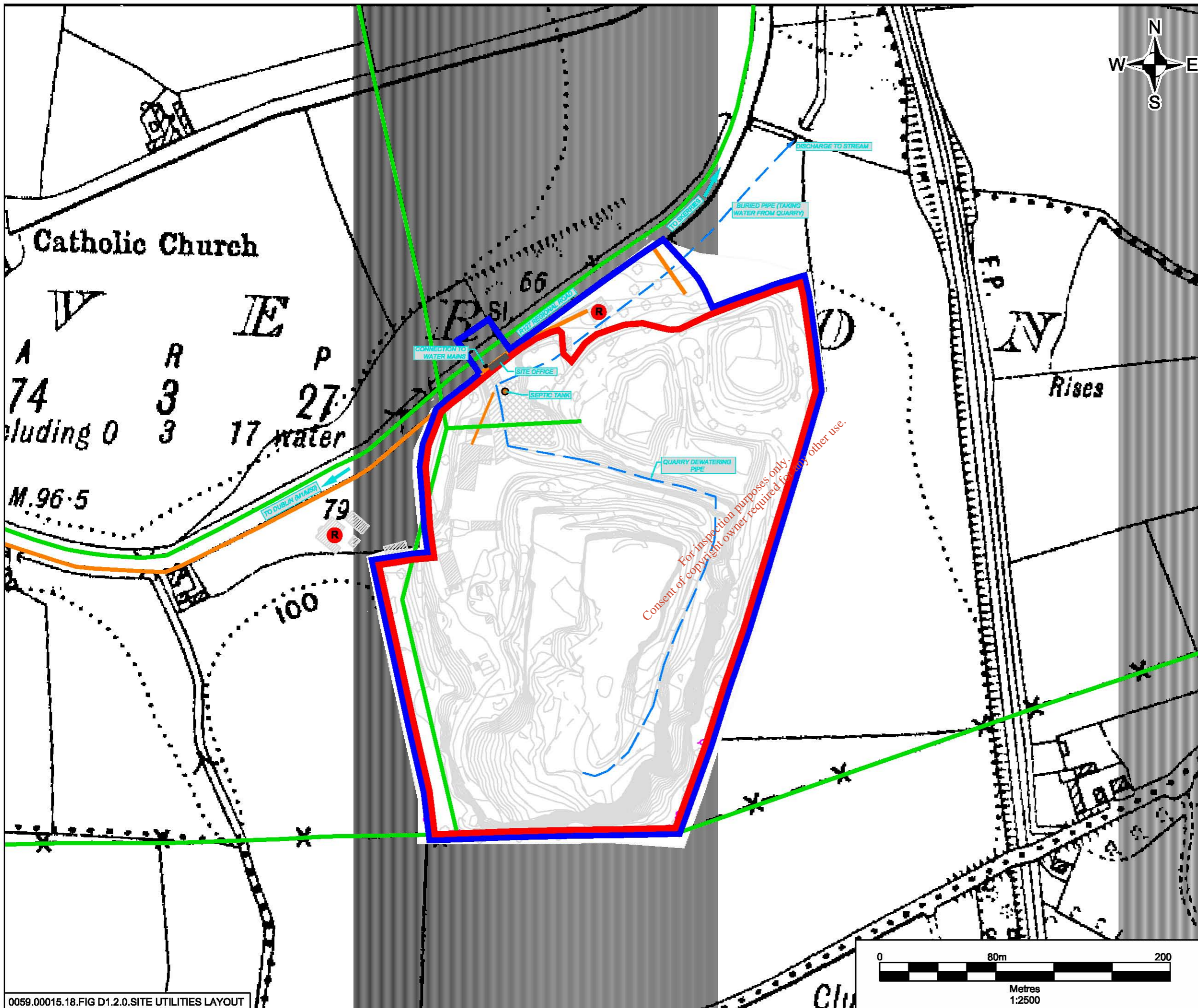

**NOTES**

1. Based on OSI 25inch Dublin Sheet No. 5 & 5a
2. Ordnance Survey of Ireland Licence No. SU 0000709 (c) Ordnance Survey of Ireland & Government of Ireland

**LEGEND**

|  |   |
|--|---|
|  | Applicant's Land Interest (c. 8.6ha)      |
|  | Waste Licence Application Area (c. 7.9ha) |
|  | Surface Water Drainage                    |
|  | Overhead Telephone Line                   |
|  | Overhead Electricity Line                 |
|  | Location of Residence                     |

**roadstone**  
 ROADSTONE DUBLIN LTD.  
 FORTUNESTOWN  
 TALLAGHT  
 DUBLIN 24

**SLR**  
 SLR CONSULTING IRELAND  
 7 DUNDRUM BUSINESS PARK  
 WINDY ARBOUR  
 DUBLIN 14  
 T: +353-1-2984667  
 F: +353-1-2984676  
 www.slrconsulting.com

**ROADSTONE DUBLIN LTD.**  
**WASTE LICENCE APPLICATION**  
**WASTE RECOVERY FACILITY,**  
**MILVERTON, SKERRIES, CO. DUBLIN**  
**SITE UTILITIES LAYOUT**

**FIGURE D1.2**

Scale: 1:2,500 @ A3      Date: AUGUST 2009