

Dripsey Waste Water Treatment Plant

NOTES

1. Dimensions are not to be scaled from drawing.
2. This drawing is to be read in conjunction with the WWDL Application.
3. This drawing is to be read in conjunction with all other application drawings.

Date	Drawn	Survey	Checked	Revision	Description

Cork County Council,
Southern Division.



PATRICIA POWER
DIRECTOR OF SERVICES
COUNTY HALL,
CORK.

Job Title:
**Dripsey
Wastewater Discharge
Licence Application**

Drawing Title:
**General Site Layout 1
A1 Map 1**

Scales: 1:25000 @ A3	Surveyed by: LL	Drawn by: LL & TH
Designed by:	Checked by: N.O'M	Date: June 2009
Drawing number: A1 Map 1	Rev:	

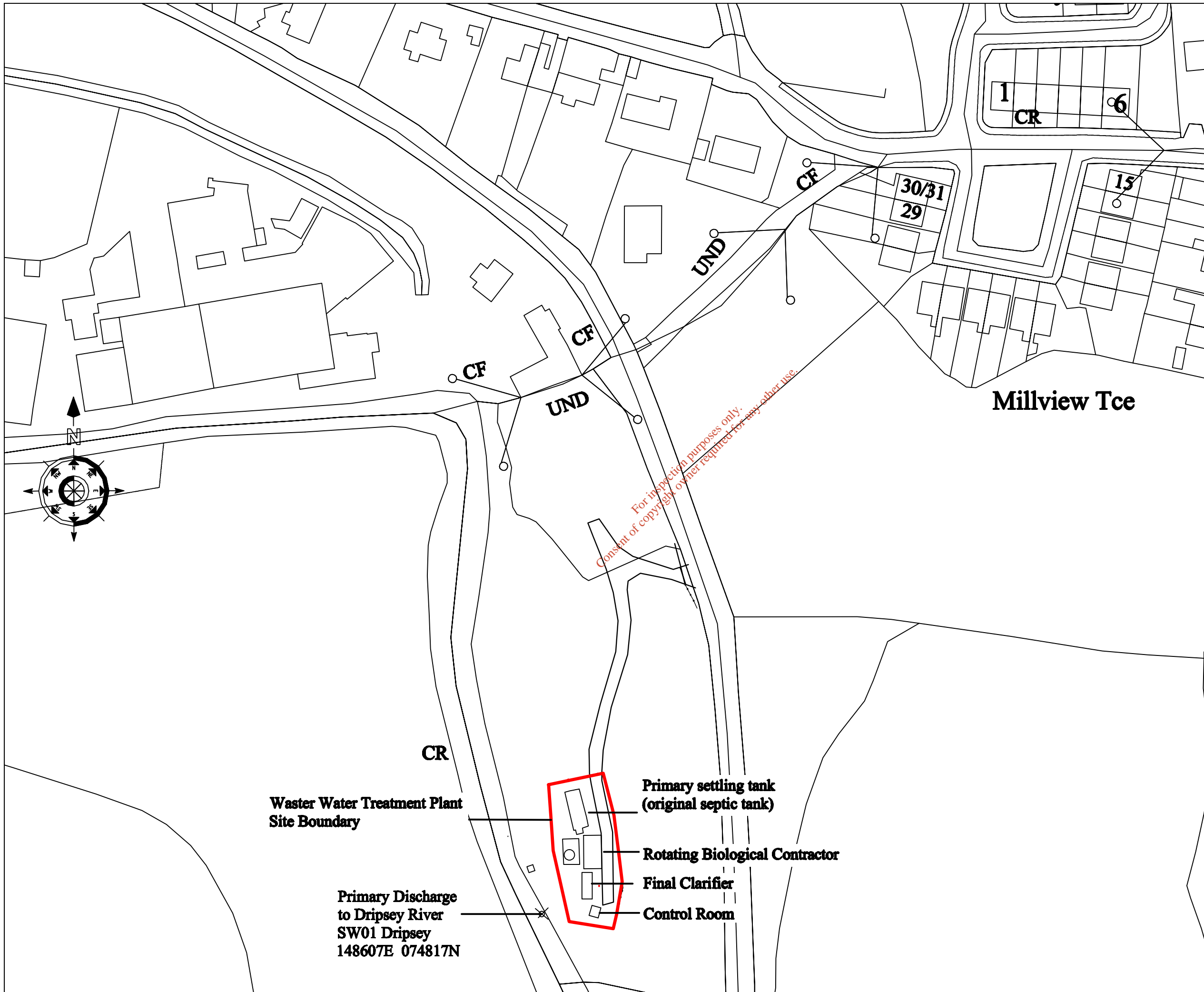

NOTES

1. Dimensions are not to be scaled from drawing.
2. This drawing is to be read in conjunction with the WWDL Application.
3. This drawing is to be read in conjunction with all other application drawings.

For inspection purposes only:
Consent of copyright owner required for any other use.

Drawn	Rev	Chk'd	Revision Description

Cork County Council,
Southern Division.



PATRICIA POWER,
DIRECTOR OF SERVICES,
COUNTY HALL,
CORK.

Job Title:
**Dripsey
Wastewater Discharge
Licence Application**

Drawing Title:
**Dripsey WWTW
General Site Layout 2
A1 Map 2**

Scales: 1:1000 @ A3	Surveyed by: LL	Drawn by: LL & T.H.
Designed by:	Checked by: N.O'M.	Date: June 2009
Drawing number: A1 Map 2	Rev:	

**Waster Water Treatment Plant
Site Boundary**

**Primary Discharge
to Dripsey River
SW01 Dripsey
148607E 074817N**

- Primary settling tank
(original septic tank)**
- Rotating Biological Contractor**
- Final Clarifier**
- Control Room**

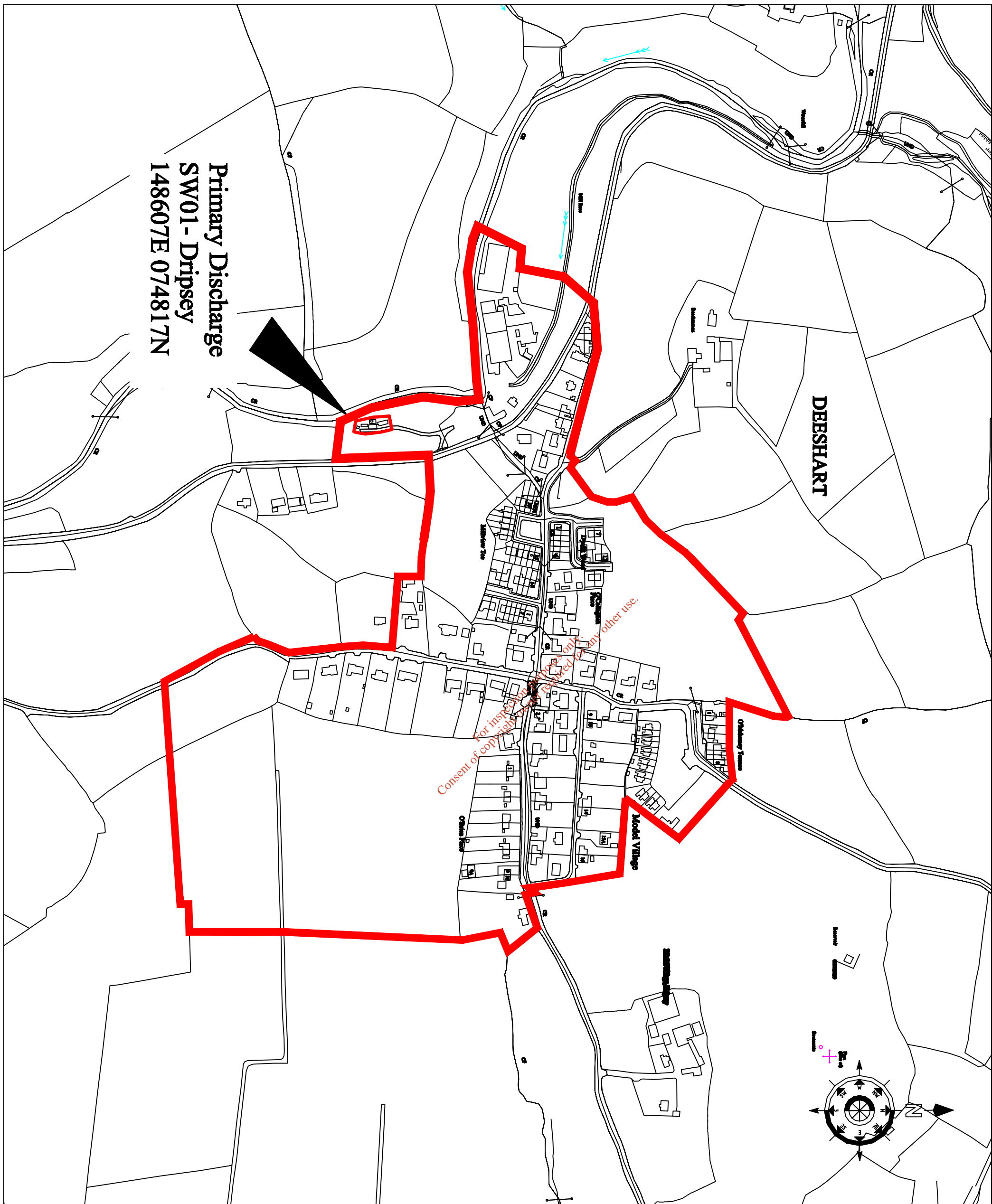

NOTES

1. Dimensions are not to be scaled from drawing.
2. This drawing is to be read in conjunction with the WWDL Application.
3. This drawing is to be read in conjunction with all other application drawings.



Cork County Council,
Southern Division.

PATRICIA POWER,
DIRECTOR OF SERVICES,
COUNTY HALL,
CORK.

Job Title:
**Dripsey
Wastewater Discharge
Licence Application**

Drawing Title:
**Dripsey W.W.T.P.
Agglomeration Map
B1 Map 3**

Scale:	1:2500 @ A3	Drawn by:	LL & TH
Designed by:	LL & TH	Checked by:	LL & TH
Drawing number:	N/A. /M	Date:	June 2009

Drawing number: **B1 Map 3**

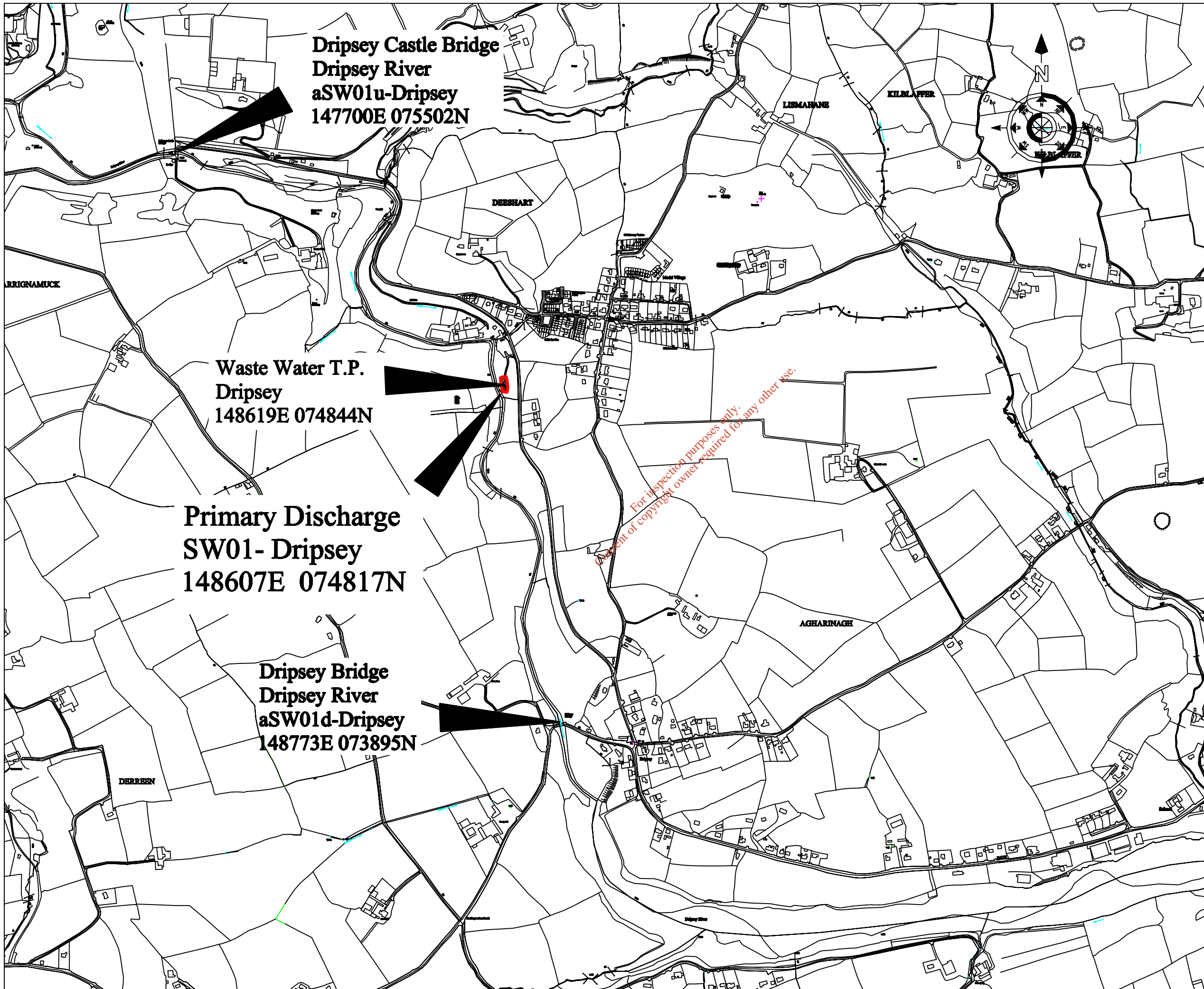

Dripsey Castle Bridge
Dripsey River
aSW01u-Dripsey
147700E 075502N

Waste Water T.P.
Dripsey
148619E 074844N

Primary Discharge
SW01- Dripsey
148607E 074817N

Dripsey Bridge
Dripsey River
aSW01d-Dripsey
148773E 073895N

*For inspection purposes only.
 Consent of copyright owner required for any other use.*

NOTES

1. Dimensions are not to be scaled from drawing.
2. This drawing is to be read in conjunction with the WWDL Application.
3. This drawing is to be read in conjunction with all other application drawings.

Drawn	Rev	Chk'd	Revision Description

Cork County Council,
 Southern Division.



PATRICIA POWER,
 DIRECTOR OF SERVICES
 COUNTY HALL,
 CORE.

Job Title:
**Dripsey
 Wastewater Discharge
 Licence Application**

Drawing Title:
**WWTP Site Location Map
 B2 Map 4**

Scales: 10000 @ A3	Surveyed by: L.L. & T.H.	Drawn by: L.L. & T.H.
Designed by:	Checked by: N.O'M.	Date: June 2009
Drawing number: B2 Map 4	Rev:	

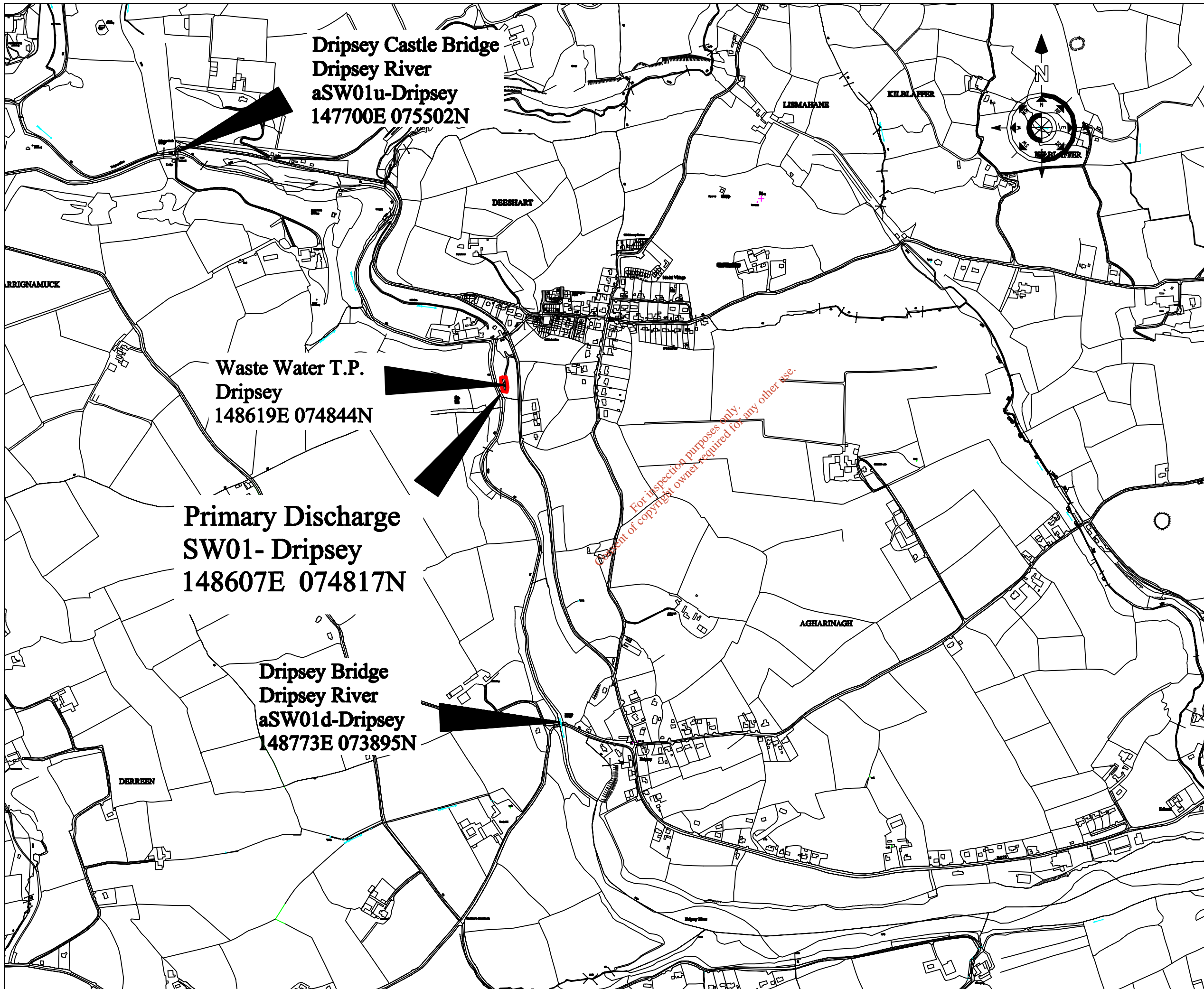

**Dripsey Castle Bridge
Dripsey River
aSW01u-Dripsey
147700E 075502N**

**Waste Water T.P.
Dripsey
148619E 074844N**

**Primary Discharge
SW01- Dripsey
148607E 074817N**

**Dripsey Bridge
Dripsey River
aSW01d-Dripsey
148773E 073895N**

NOTES

1. Dimensions are not to be scaled from drawing.
2. This drawing is to be read in conjunction with the WWDL Application.
3. This drawing is to be read in conjunction with all other application drawings.

Drawn	Rev	Client	Revision Description

Cork County Council,
Southern Division.



PATRICIA POWER,
DIRECTOR OF SERVICES
COUNTY HALL,
CORE.

Job Title:
**Dripsey
Wastewater Discharge
Licence Application**

Drawing Title:
**Primary Discharge Location
B3 Map 5**

Scales: 10000 @ A3	Surveyed by: L.L. & T.H.	Drawn by: L.L. & T.H.
Designed by:	Checked by: N.O'M.	Date: June 2009
Drawing number: B3 Map 5	Rev:	

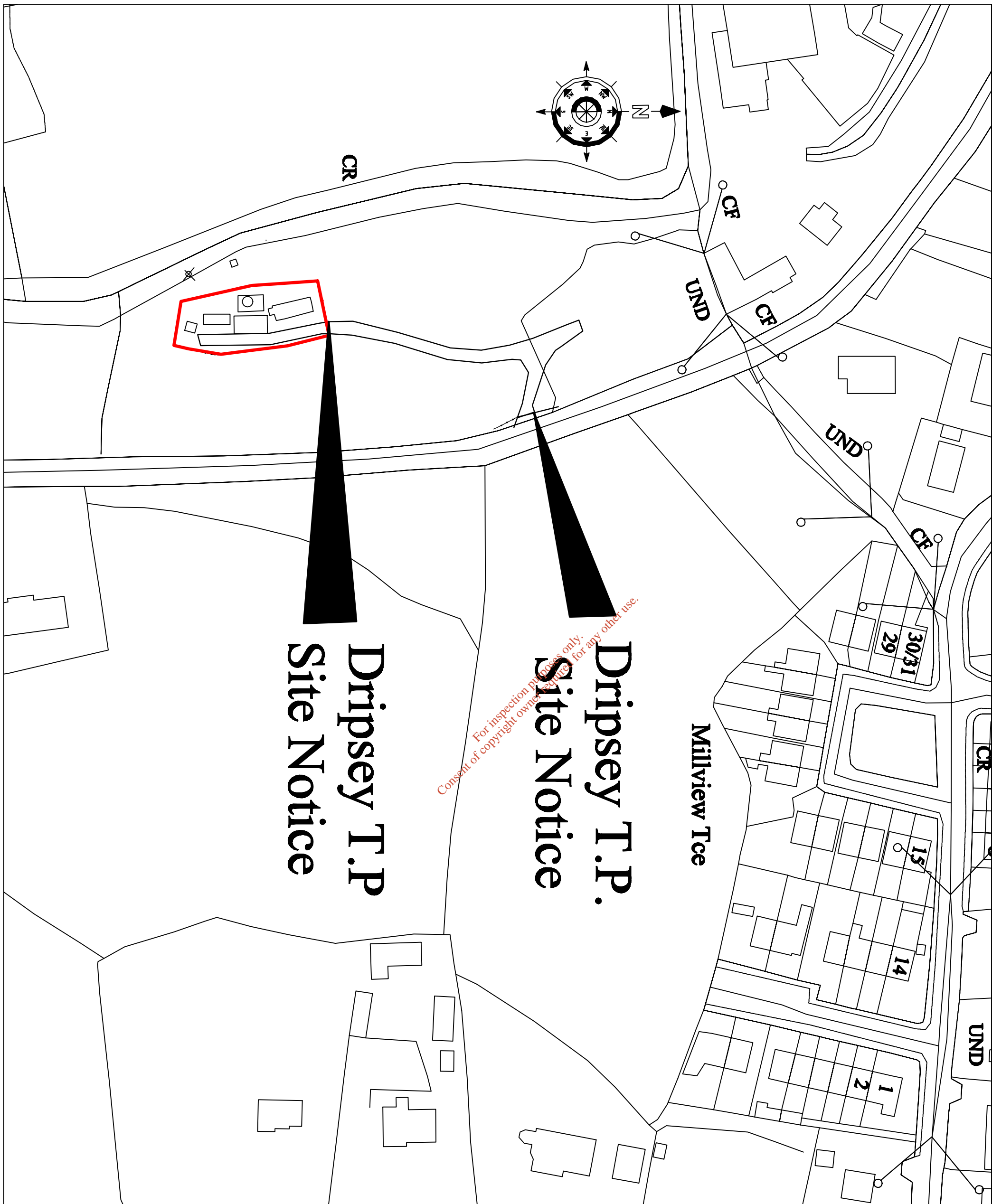

For inspection purposes only.
Consent of copyright owner required for any other use.

Dripsey T.P. Site Notice

Dripsey T.P. Site Notice

NOTES

1. Dimensions are not to be scaled from drawing.
2. This drawing is to be read in conjunction with the WWDL Application.
3. This drawing is to be read in conjunction with all other application drawings.



Cork County Council,
Southern Division.

PATRICIA POWER
DIRECTOR OF SERVICES
COUNTY HALL,
CORKE

Job Title:
**Dripsey
Wastewater Discharge
Licence Application**

Drawing Title:
**Dripsey W.W.T.P.
Site Notice Location
B8 Map 6**

Scale:	1:1000 @ A3	Drawn by:	LL & TFL
Designed by:	NCP/M	Checked by:	LL & TFL
Drawing number:	B8 Map 6	Date:	June 2009
		Rev:	-

Cork County Council Southern Division



CORK COUNTY COUNCIL

SITE NOTICE

APPLICATION TO THE ENVIRONMENTAL PROTECTION AGENCY FOR A WASTEWATER DISCHARGE LICENCE

In accordance with the Waste Water Discharge (Authorisation) Regulations 2007, Water Services Southern Division of Cork County Council, Carrigrohane Road, Cork is applying to the Environmental Protection Agency for a Waste Water Discharge Licence for the Agglomeration of Dripsey at the following locations:

Plant Name	Location	National Grid Ref.
Dripsey WWTP	Agharinagh, Dripsey	E 148619 N 074844

Discharge	Function	Townland	Receptor	Grid Reference
Primary	Main	Agharinagh	River Dripsey	E 148607 N 074817

A copy of the application for the Waste Water Discharge Licence and such further information relating to the application as may be furnished to the Agency in the course of the Agency's consideration of the Application shall as soon as is practicable after receipt by the Agency be available for inspection or purchase at the

- **Environmental Protection Agency, PO Box 3000, Johnstown Castle Estate, Co. Wexford, Lo Call 1890 335599 Telephone: 053-9160600 Fax: 053-9160699 Email: info@epa.ie**
and at

- **Cork County Council Offices, Water Services South, County Hall, Carrigrohane Road, Co. Cork, Telephone: 021 - 4276891 Fax: 021 - 4276321.**

Submissions in relation to the application may be made to the Environmental Protection Agency at its headquarters described above.

Cork County

Water Services Investment Programme 2007 - 2009

Schemes at Construction	W/S	Est. Cost	Schemes to start 2009 contd.	W/S	Est. Cost
Cork North			Cork South		
Mitchelstown Sewerage Scheme (Nutrient Removal)	S	221,000	Ballincollig Sewerage Scheme (Upgrade) (G)	S	22,248,000
Cork South			Cork Lower Harbour Sewerage Scheme (excl. Crosshaven SS)	S	73,542,000
Ballyvourney/ Ballymakeery Sewerage Scheme	S	3,049,000	Shannagarry/ Garryvoe/ Ballycotton Sewerage Scheme	S	3,780,000
Cobh/ Midleton/ Carrigtwohill Water Supply Scheme	W	10,135,000	Youghal Sewerage Scheme	S	14,420,000
Cork Lower Harbour Sewerage Scheme (Crosshaven SS) (G)	S	4,850,000	Cork West		
Cork Water Strategy Study (G)	W	941,000	Ballydehob Sewerage Scheme	S	683,000
Kinsale Sewerage Scheme	S	20,000,000	Bantry Water Supply Scheme	W	14,935,000
Midleton Sewerage Scheme (Infiltration Reduction) (G)	S	2,078,000	Clonakilty Sewerage Scheme (Plant Capacity Increase)	S	3,677,000
		41,274,000	Courtmacsherry/ Timoleague Sewerage Scheme	S	2,472,000
Schemes to start 2007			Dunmanway Regional Water Supply Scheme Stage 1	W	12,669,000
					164,629,000
Cork North			Serviced Land Initiative		
North Cork Grouped DBO Wastewater Treatment Plant (Buttevant, Doneraile & Kilbrin)	S	5,150,000	Cork North		
Cork West			Ballycough Water Supply Scheme	W	139,000
Skibbereen Sewerage Scheme	S	20,000,000	Ballyhooley Improvement Scheme	W/S	139,000
		25,150,000	Broghill-Rathgoggin Sewerage Scheme	S	406,000
Schemes to start 2008			Bweeng Water Supply Scheme	W	115,000
Cork North			Churchtown Sewerage Scheme (incl. Water)	W/S	543,000
Mallow/ Ballyvinitier Regional Water Supply Scheme (H) W		8,662,000	Clondulane Sewage Treatment Plant	S	417,000
Mallow Sewerage Scheme (H)	S	3,408,000	Freemount Sewerage Scheme	S	150,000
Cork South			Pike Road Sewerage Scheme (incl. Water)	W/S	2,080,000
Ballincollig Sewerage Scheme (Nutrient Removal) (G)	S	948,000	Rathcormac Sewerage Scheme (incl. Water)	W/S	555,000
Ballingeary Sewerage Scheme	S	1,296,000	Spa Glen Sewerage Scheme	S	736,000
Bandon Sewerage Scheme Stage 2	S	14,729,000	Uplands Fermoy Sewerage Scheme (incl. Water)	W/S	1,174,000
City Environs (CASP) Strategic Study (G)	S	153,000	Watergrasshill Water Supply Scheme (incl. Sewerage) (G)	W/S	4,151,000
Cloghroe Sewerage Scheme (Upgrade)	S	683,000	Cork South		
Coachford Water Supply Scheme	W	1,318,000	Ballincollig Sewerage Scheme (Barry's Rd Foul and Storm Drainage) (G)	S	1,164,000
Garretstown Sewerage Scheme	S	2,153,000	Belgooley, Water Supply Scheme (incl. Sewerage)	W/S	2,913,000
Inniscarra Water Treatment Plant Extension Phase 1	W	2,678,000	Blamey Water Supply Scheme (Ext. to Station Rd) (G)	W	416,000
Little Island Sewerage Scheme (G)	S	2,200,000	Carrigtwohill Sewerage Scheme (Treatment and Storm Drain) (G)	S	7,632,000
Cork West			Castlematyr Wastewater Treatment Plant Extension	S	1,200,000
Bantry Sewerage Scheme	S	7,148,000	Crookstown Sewerage Scheme (incl. Water)	W/S	1,200,000
Dunmanway Sewerage Scheme	S	2,153,000	Dripsey Water Supply Scheme (incl. Sewerage)	W/S	1,112,000
Leap/ Baltimore Water Supply Scheme	W	6,365,000	Glounthane Sewerage Scheme (G)	S	1,576,000
Schull Water Supply Scheme	W	5,253,000	Innishannon Sewerage Scheme	S	277,000
		61,137,000	Innishannon Wastewater Treatment Plant	S	694,000
Schemes to start 2009			Kerrypike Sewerage Scheme	S	832,000
Cork North			Kerrypike Water Supply Scheme	W	416,000
Banteer/Dromahane Regional Water Supply Scheme	W	1,576,000	Killeagh Wastewater Treatment Plant Extension	S	1,200,000
Conna Regional Water Supply Scheme Extension	W	2,627,000	Killeagh Water Supply Scheme (includes Sewerage)	W/S	485,000
Cork NE Water Supply Scheme	W	4,326,000	Killeens Sewerage Scheme	S	420,000
Cork NW Regional Water Supply Scheme	W	6,046,000	Kinagleary Sewerage Scheme	S	694,000
Millstreet Wastewater Treatment Plant (Upgrade)	S	1,628,000	Midleton Wastewater Treatment Plant Extension	S	4,050,000

Cork County contd.

Water Services Investment Programme 2007 - 2009

Serviced Land Initiative contd.	W/S	Est. Cost	Schemes to Advance through Planning cond.	W/S	Est. Cost
Cork South contd.			Cork South		
Mogeely, Castlemartyr & Ladysbridge Water Supply Scheme	W	2,566,000	Carrigtwohill Sewerage Scheme (G)	S	20,000,000
North Cobh Sewerage Scheme (G)	S	3,193,000	Cork Sludge Management (G)	S	14,420,000
Riverstick Water Supply Scheme (incl. Sewerage)	W/S	525,000	Cork Water Supply Scheme (Storage - Mount Emla, Ballincollig & Chetwind) (G)	W	8,500,000
Rochestown Water Supply Scheme	W	2,700,000	Inniscarra Water Treatment Plant (Sludge Treatment)(G)W		5,356,000
Saleen Sewerage Scheme	S	1,051,000	Macroom Sewerage Scheme	S	5,150,000
Youghal Water Supply Scheme	W	2,300,000	Minane Bridge Water Supply Scheme	W	1,421,000
Cork West			Cork West		
Castletownshend Sewerage Scheme	S	1,576,000	Bantry Regional Water Supply Scheme (Distribution)	W	9,455,000
		50,797,000	Cape Clear Water Supply Scheme	W	1,679,000
Rural Towns & Villages Initiative			Rural Towns & Villages Initiative		
Cork North			Cork North		
Buttevant Sewerage Scheme (Collection System)	S	2,446,000	Castletownbere Regional Water Supply Scheme	W	8,405,000
Doneraile Sewerage Scheme (Collection System)	S	1,738,000	Glengarriff Sewerage Scheme	S	2,500,000
			Roscarberry/Owenahincha Sewerage Scheme	S	1,576,000
			Skibbereen Regional Water Supply Scheme Stage 4	W	7,880,000
					95,646,000
Cork South			Water Conservation Allocation		
Innishannon (Ballinadee/ Ballinspittle/ Garrettstown) Water Supply Scheme	W	6,726,000	Asset Management Study		300,000
Cork West			South Western River Basin District (WFD) Project¹		
Ballylicky Sewerage Scheme	S	2,158,000			9,400,000
Baltimore Sewerage Scheme	S	3,162,000			
Castletownbere Sewerage Scheme	S	3,202,000			
Schull Sewerage Scheme	S	3,523,000			
		24,950,000	Programme Total		485,489,000
Schemes to Advance through Planning					
Cork North					
Mitchelstown North Galtees Water Supply Scheme	W	3,152,000			
Mitchelstown Sewerage Scheme	S	3,000,000			
Newmarket Sewerage Scheme	S	3,152,000			

¹ This project is being led by Cork County Council on behalf of other authorities in the River Basin District

(H) Refers to a Hub as designated in the National Spatial Strategy

(G) Refers to a Gateway as designated in the National Spatial Strategy