

C.1 Technical Competence and Site Management

The applicant's significant experience over the last ten (10) years has been in earthmoving and has two (2) years experience with the lining of landfill sites.

C.2 Environmental Management System

Water

The developer is very conscious of the obvious requirements to keep the site drained and streams flowing at all times throughout the project. This is summarized as follows with reference to *Drawing No.9 'Annual Work Schedule Outline', Drawing No. 10 'Site Survey', Drawing No. 11 'Proposed Levels', and Drawing No.12 'Sections'*.

Year 1:

- Free up the drainage running under the farm road currently crossing the site. This will allow water to flow southwards if required from the high area at the sources.
- Commence and continue to stone fill the low 'channel' of the Peastinagh feeding northwards. Start at Section DD and continue northwards to Section EE which is close to where it defines as a stream alongside the N20.
- During this maintain passage for flow from the Year 1 area to go both northward and southward. It will largely travel northwards with the existing bed level gradient.
- In the event of insufficient stone fill to complete the low 'channel' in Year 1 the portion unstoned will not be filled over. The low 'channel' will be filled working northwards from Section DD. This is done to utilize the existing gradient as much as practicable and avoid possibility of temporary low level backup. Nevertheless should such occur it will not have an adverse impact.
- At the end of Year 1 passage for trucks will be possible to the northern end of Year 2 work.

Year 2:

- Filling will progress southwards.
- Continue stoning the low 'channel' southwards when all of 'Year 1' channel stoning work is completed.
- Note the existing bed from Section DD to Section CC varies little. Hence there will be little backup if at all in respective of flow north or south. The bed falls in both directions from here.
- The surface water channel alongside the N20 will be cut to direct surface runoff northwards. There are a number of soiled water containment pits on this to clarify runoff.

Year 3:

- Filling will progress southwards.

- Continue stoning the low 'channel' southwards following on Year 2 stoning. Continue on to the definable stream bed of the R. Martin and continue to stone same.
- Backfill stoning working southwards to reach the outfall.
- Surface water runoff from this area will continue to the R. Martin via the bund at the south end. This facilitates soiled water containment.

Generally, as per above, the sequence minimizes interference with the existing flow regime while work is being carried out. It also ensures clean flows only will continue from the area.

Please refer to *Drawing No.13 'Sundry Details'*. This drawing gives detail of the following:

- 'Details of Soiled Water Containment Measures' – to roadside channel and to R. Martin.
- 'Proposed Filling of Existing Drain' – this refers to the low 'channel' and to the head of R. Martin.
- 'Bund at Southern End' – ensuring runoff at the southern end goes to soiled water containment.
- 'New Drainage Ditch Linking to Existing Stream (R. Peastinagh) beside N20' – this is the roadside channel above which will have soiled water containment measures.

Air

- All operations on-site are carried out in such a manner as to ensure that no odour, dust or noise nuisance occurs beyond the site boundary because of such operations.
- Dust deposition arising out of construction activities do not exceed 250mg/m³/day at the site boundary averaged over 30 days.
- The permit holder takes adequate steps to prevent dust generation in dry weather periods. *The permit holder sprays the current working area with clean water to minimise dust generation. The access road to the site is also sprayed during dry weather.*

Noise

Noise levels emanating from the proposed development when measured at the site boundaries do not exceed 55 dBA (15 minute L_{eq}) between 07.00 am and 10.00 pm except Sundays and Bank Holidays. If the noise contains a discrete, continuous note, or if there are distinct impulses in the noise, or if the noise is irregular enough in character to attract attention, a penalty of +5 dBA will be applied to the measured noise level.

Construction activities shall be carried out such that no noise nuisance is caused to adjoining residence.

The permit holder has ensured that hedgerows and mature trees are retained.

Noise from construction activities are as follows:

- Transport to and from the site
- Machinery operating within the site

- Both the above are truck and operational vehicle noises. These levels do not exceed the above stated 55 dBa inclusive of the 5 dBa penalty for tone and impulse.

Litter

- The permit holder inspects the site perimeter twice weekly for the presence of litter and removes all litter from the site and its environs without delay. A record is maintained of inspections and any action taken as a result of these inspections; refer to C.2 (2) *Register of Site Perimeter Inspection*.

C.3 Hours of Operation

(a) Proposed hours of operation are 7.00 am to 10.00 pm except Sundays and Bank Holidays.

(b) The permit holder ensures that waste is only accepted at the site between the hours of 8.00 am and 6.00 pm, Monday to Friday inclusive and 8.00 am to 2.00 pm Saturdays.

The Permit Holder shall ensure that no waste activities are carried out on Sundays or Bank Holidays.

(c) Proposed hrs of construction & development works at the facility and timeframes are 7.00 am to 10.00 pm except Sundays and Bank Holidays.

C.4 Conditioning Planning

When site filling is nearing its completion, appreciable stone is picked out by hand.

Topsoil is recovered and relayed on the surface to a depth of 225 mm.

Topsoil is then raked and grass seed is planted at a rate of 40 g/m². Grass seed planting is only done during the grass growing season.

For inspection purposes only
Consent of copyright owner required for all other uses

Template 7 Condition 6.5: Register of Site Perimeter Inspection

Date of Perimeter Inspection	Name of Person to Carry Out Inspection	Observations of Inspection	Actions Taken	Signature of Person who Carried Out Inspection

For inspection purposes only.
 Consent of copyright owner required for any other use.

CONSTRUCTION OF ROAD AT LARGEST POINT TO BE COMPLETED IN ADVANCE OF PERMITTING OF FILLING AND CONSTRUCTION OF CHANNEL. ROAD TO BE CONSTRUCTED AT ORIGINAL ELEVATION WITH ORIGINAL ANCHORS. LEVELS INDICATED ARE CORRECTIVE.

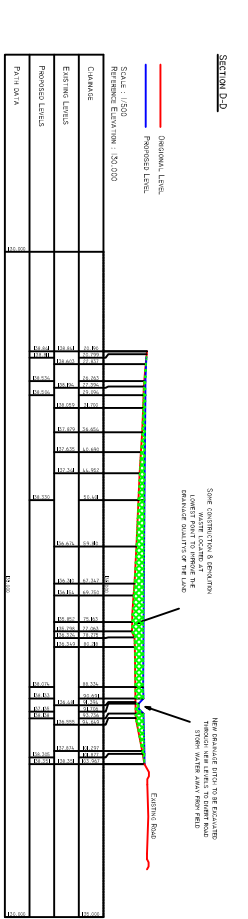
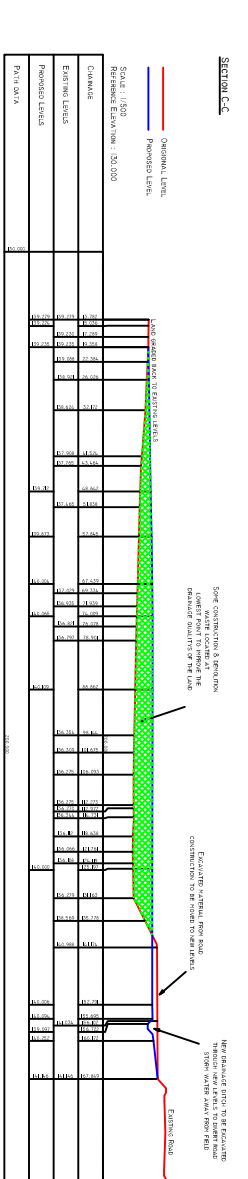
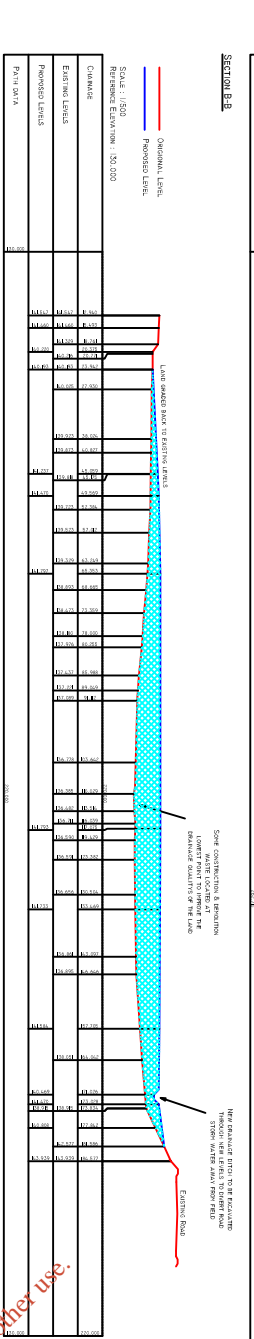
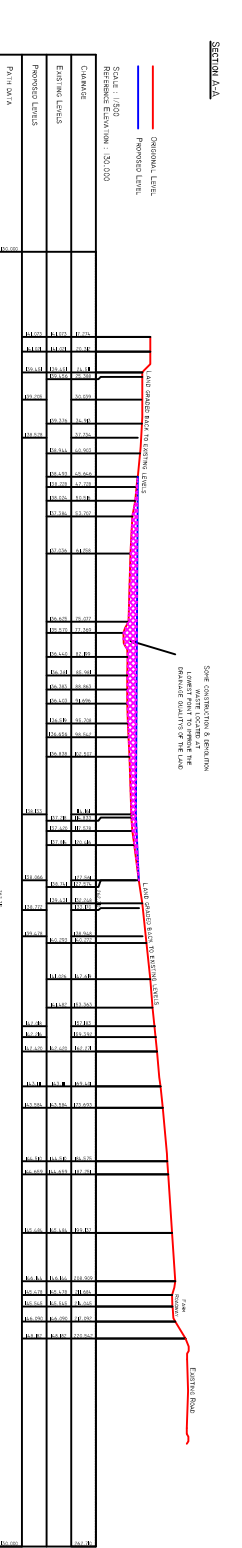
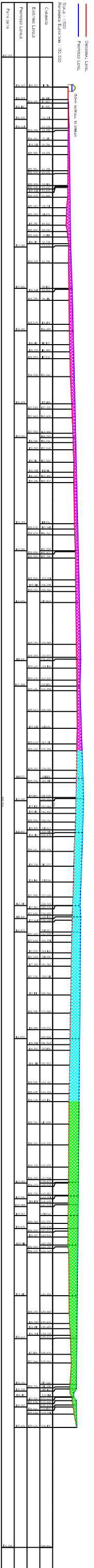

Scale: 1:500
Horizontal: 1:500
Vertical: 1:100

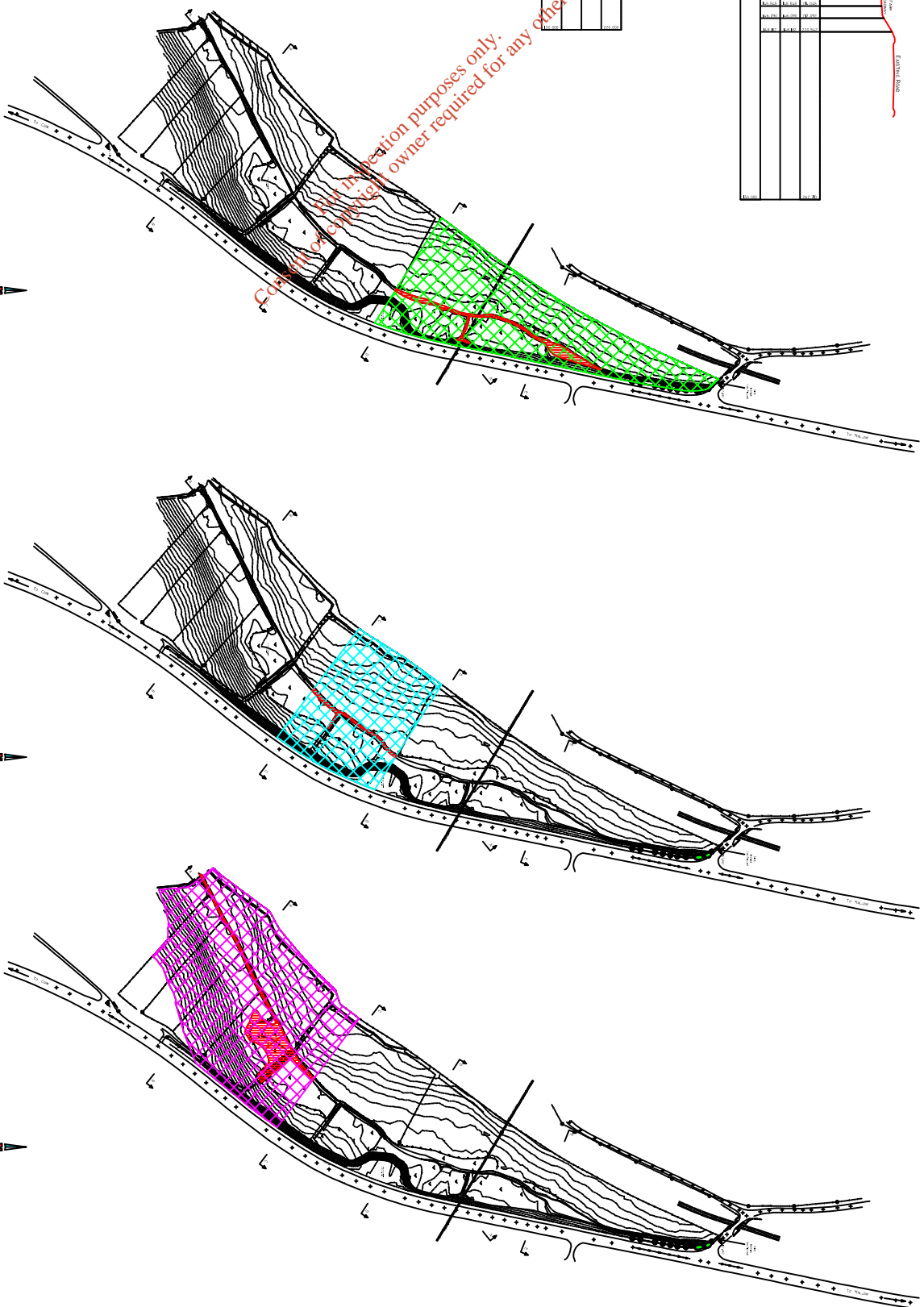

- YEAR ONE - APPX. 37,000 m³
- YEAR TWO - APPX. 37,000 m³
- YEAR THREE - APPX. 37,000 m³
- C & D CHANNEL WORK

NOTE :- EXISTING TOPSOIL STRIPPED IN ADVANCE OF FILLING AND REPLACED AFTER CONSOLIDATION OF FILL AT NEW ELEVATION

1	FOR PPC APPLICATION	12/01/06
0	INITIAL ISSUE	16/10/06
NO	REVISION	

client	MALLOWS CONTRACTS LTD.
project	APPLICATION FOR WASTE MANAGEMENT PERMIT
drawing	ANNUAL WORK SCHEDULE OUTLINE

CONSULTING ENGINEERS

 Enterprise House,
 Centre Park Road, Cork, Ireland.
 Tel: 021-4314388
 Fax: 021-4314385
 scale As Shown date OCTOBER 2006 job no 9 dfg no 9

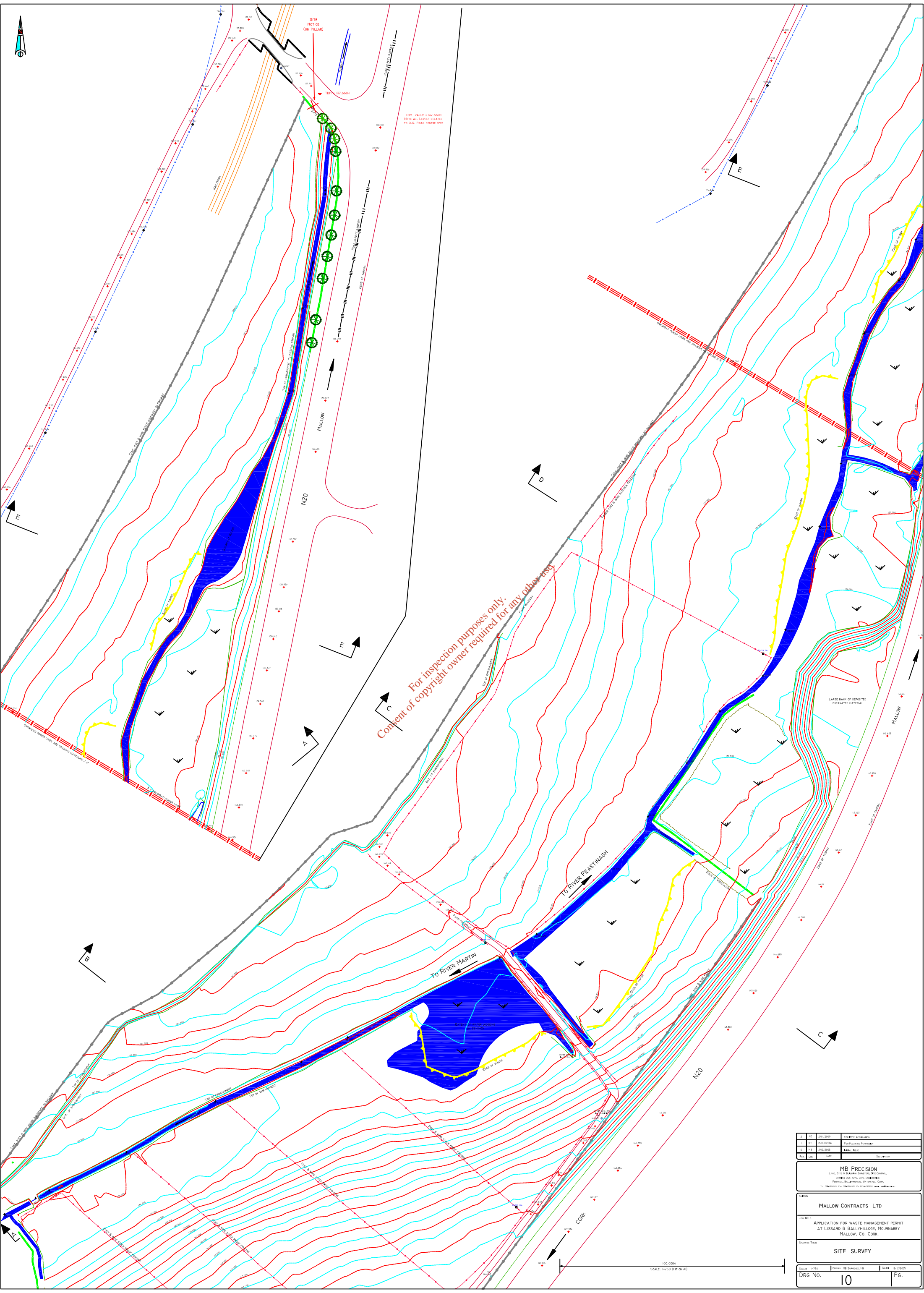

For inspection purposes only.
 Consent of copyright owner required for any other use.

1	01/10/2010	Final Approval
2	25/08/2008	Final Planning Permission
3	01/10/2005	Initial Survey
4	01/10/2005	Site Plan

MB PRECISION					
<small>LOCAL SURVEY & BUILDING SURVEYORS (S&BC) CONTROL SURVEYING & CIVIL ENGINEERING 10000, BALLYHILL, WATERFORD, CO. W.D. TEL: 051 853333 FAX: 051 853334 WWW: MBPRECISION.COM</small>					
Client:					
MALLOW CONTRACTS LTD					
Job Title:					
APPLICATION FOR WASTE MANAGEMENT PERMIT AT LISSARD & BALLYHILLCOSE, MOURNBABBY MALLOW, CO. CORK.					
Drawing Title:					
SITE SURVEY					
Scale:	1:750	Drawn:	J.B. Sullivan	Date:	01/10/2010
DRG No.	10	Page:			

NOTES:
 THE CAPACITY OF THE FACILITY IS APPROXIMATELY 10,000m³.
 IT IS PROPOSED SOME CONSTRUCTION AND DEMOLITION MATERIAL (APPROX 5000-2000m³) WOULD BE STRATEGICALLY PLACED TO INCREASE ITS DRAINAGE CAPACITY THEN THE LAND WOULD BE FILLED TO REQUIRED LEVEL WITH CLEAN SILVER SAND.
 A NEW DRAINAGE DITCH AS SHOWN, RUNNING PARALLEL WITH THE ROAD WOULD BE EXCAVATED AT THE LEVELS SHOWN. THIS WOULD ENSURE ALL SURFACE WATER RUNOFF WOULD BE DIRECTED TO THE STRAGAN.
 AFTER WHICH TOPSOIL WOULD BE LAD BACK ON TOP AND REDESIGNED WITH FINE.
 STOCK PROOF FENCINGS WOULD THEN BE ERRECTED TO ENSURE THE AREA WOULD BE PUT BACK INTO AGRICULTURAL USE.

NOTES:
 IT IS PROPOSED THE LAND WOULD BE ACCESSED FROM ONE AREA ONLY. THE IMPORTANCE OF KEEPING THE PUBLIC ROAD CLEAR AT ALL COSTS IS THE DESIRED OBJECTIVE. IT IS PROPOSED THAT WHEEL PATTERNS BE BUILT PLACED IF WOULD BE TYPED FROM THE ROAD GOING VEHICLE FROM A RAISED SURFACE. THIS KEEPING THE VEHICLES TYRES CLEAN. A FIELD BARRIAD (SAD) EXCAVATOR WOULD MOVE THE MATERIAL AS REQUIRED TO ALLOW A BULLDOZER TO PUSH THE FILL OVER THE FIELD CONTACTING THE IMPROVED MATERIAL TO THE REQUIRED LEVELS.
 A RAISED ACCESS ROAD WOULD BE MADE FROM SUITABLE STONE FILL AS REQUIRED. THE ROAD WOULD BE OF A SHAPE AND ELEVATION ABOVE THE FIELD LEVEL AS TO PREVENT WATER LOGGING AND ALLOW THE VEHICLE CLEAN AND SAFE PASSAGE.
 THE SITE WOULD BE SECURELY LOCKED AND A RESTRICTED ACCESS POLICY WOULD BE IN PLACE.

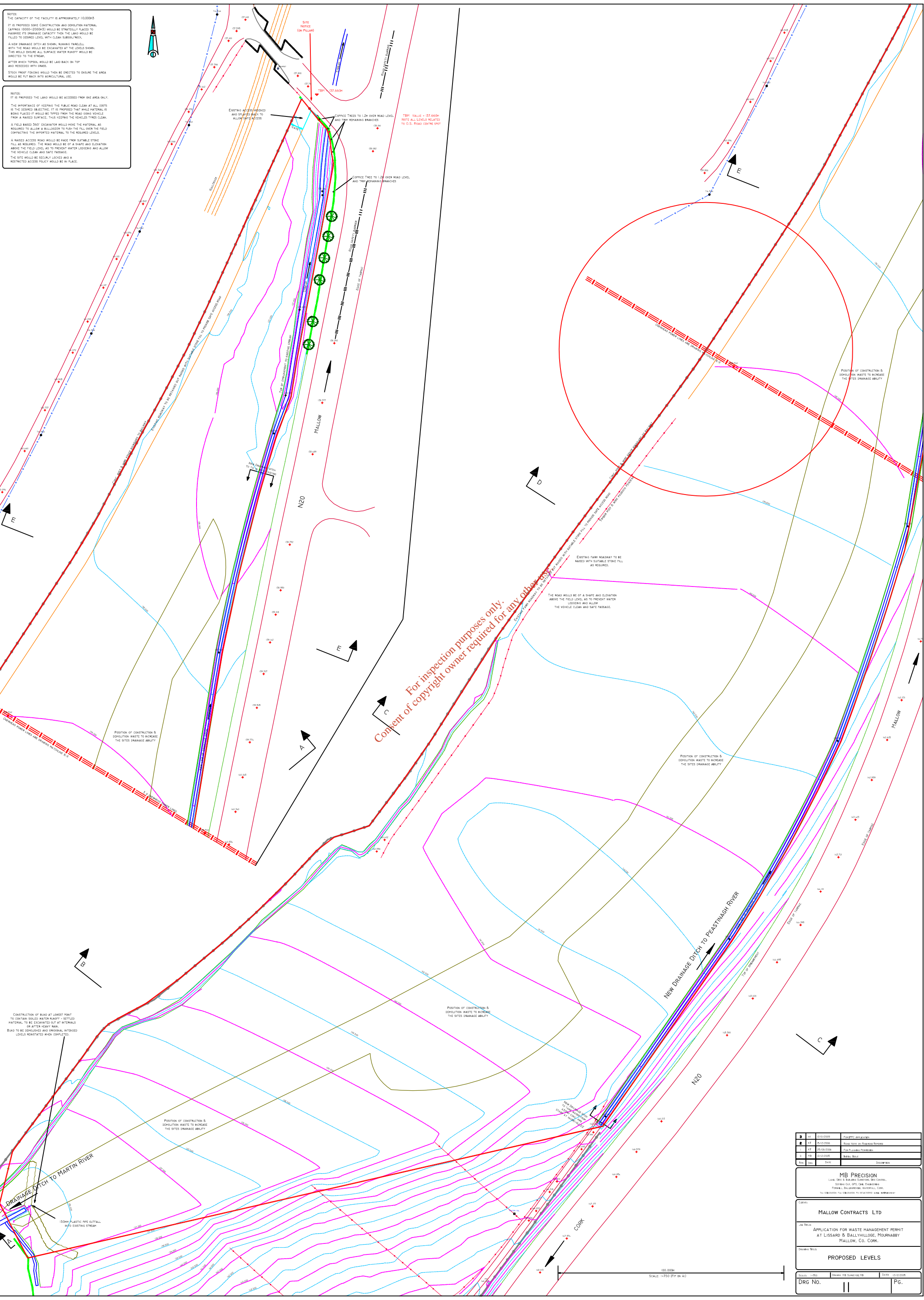

CONSTRUCTION OF ROAD AT LOWEST POINT TO CONTAIN WOULD WATER RUNOFF - SETTLED MATERIAL TO BE EXCAVATED OUT AT INTERVALS ON AFTER HEAVY RAIN. ROAD TO BE REDESIGNED AND ORIGINAL INTERSECTED LEVELS REINTEGRATED WHEN COMPLETED.

150mm PLASTIC PIPE DITCHFALL INTO EXISTING STRAGAN

For inspection purposes only.
 Content of copyright owner required for any other use.

1	20/08/2009	Engineering Approval
2	20/12/2009	Road Order on Ballymorrisk Road
3	25/08/2010	Final Planning Permission
4	20/10/2009	Material Report
5	20/10/2009	Siteplan

MB PRECISION
 Local, State & National Surveyors, 3811 Collins, Sydney NSW, 2122, Australia
 Phone: +61 (0)2 9614 1111, Fax: +61 (0)2 9614 1112, Website: www.mbp.com.au

Client: **MALLOW CONTRACTS LTD**

Job Title: **APPLICATION FOR WASTE MANAGEMENT PERMIT AT LISSARD & BALLYHILLOE, MOURNABBY MALLOW, CO. CORK.**

Drawing Title: **PROPOSED LEVELS**

Scale: 1:250
 Date: 20/10/2009
 Scale: 1:250 (PTW & A3)
 Date: 20/10/2009

DRG No.	11	Pg.	1
---------	----	-----	---

CONSTRUCTION OF THE PROPOSED
 CHANNELS SHALL BE IN ACCORDANCE WITH
 THE IRLANDS WATERWAYS ACT 2009
 AND THE IRLANDS WATERWAYS
 REGULATIONS 2010. THE CHANNELS
 SHALL BE CONSTRUCTED TO THE
 DIMENSIONS AND LEVELS SHOWN
 HEREON UNLESS OTHERWISE SPECIFIED.

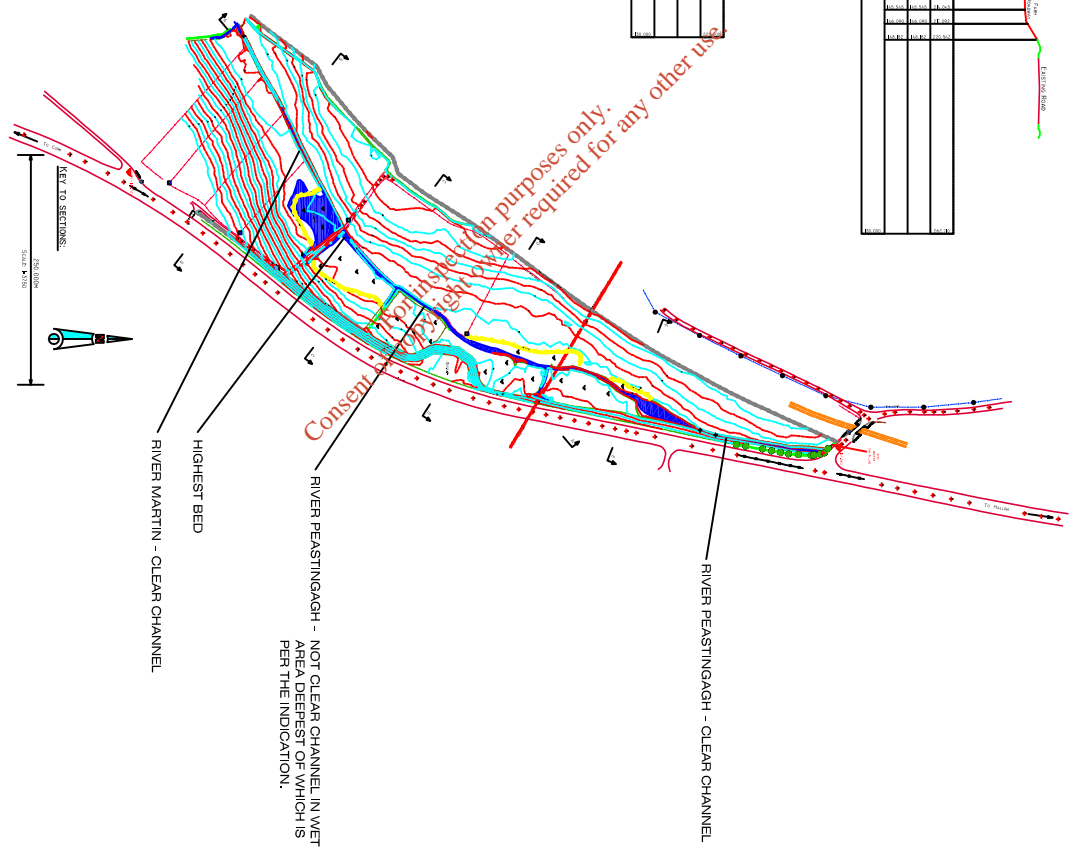
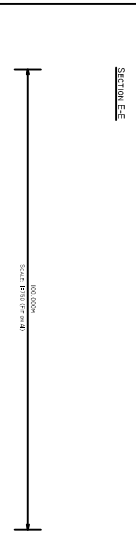
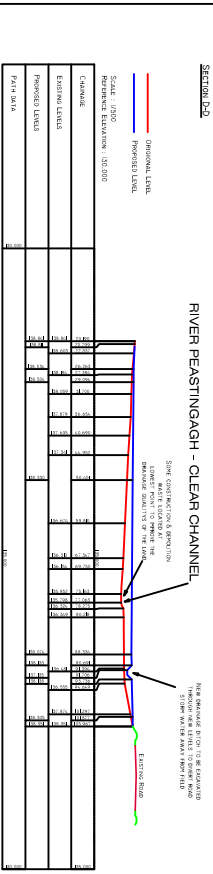
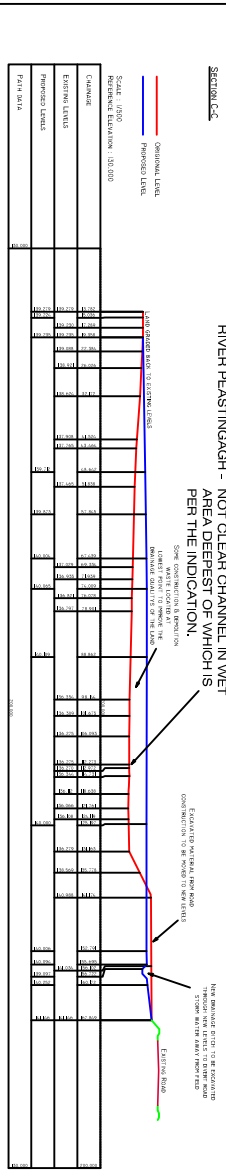
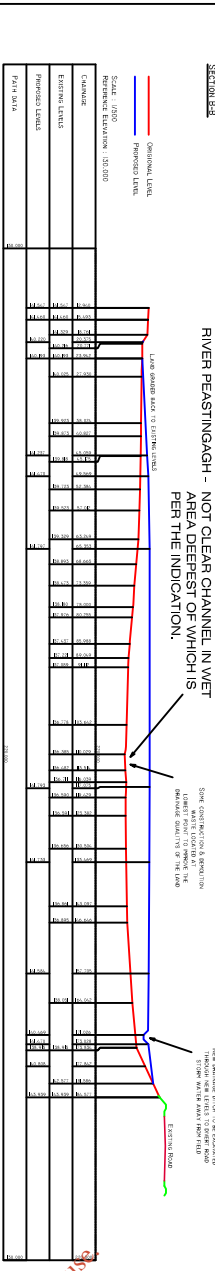
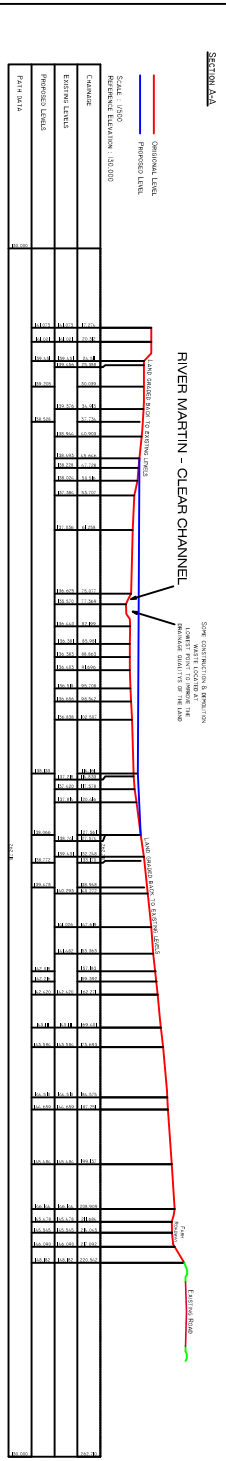

1	22	20/10/2009	7 PM APT. CONSTRUCTION
2	17	14/10/2009	WORKING CHANNEL DESIGN
3	16	14/10/2009	FOR MAINTENANCE PERMISSION
4	15	10/10/2009	INITIAL DESIGN
5	14	09/10/09	DESIGNING

MB PRECISION
 LAMB, SINE & BULLOCK SURVEYING SERVICES
 100, GERRARD ST. S. CO. DUBLIN 9
 TEL: 01 454 4000 FAX: 01 454 4001
 WWW.MBP.CO.UK

CLIENT
MALLOW CONTRACTS LTD

PROJECT
 APPLICATION FOR WASTE MANAGEMENT PERMIT
 AT LISSARD & BALLYHILLOE, MOURNABBY
 MALLOW, CO. CORR.

SECTIONS

DATE: 20/10/2009	SCALE: AS SHOWN	DATE: 20/10/2009
DWG NO. 12	FO.	

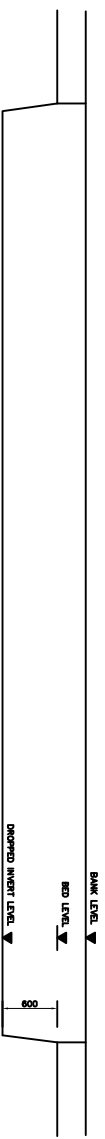
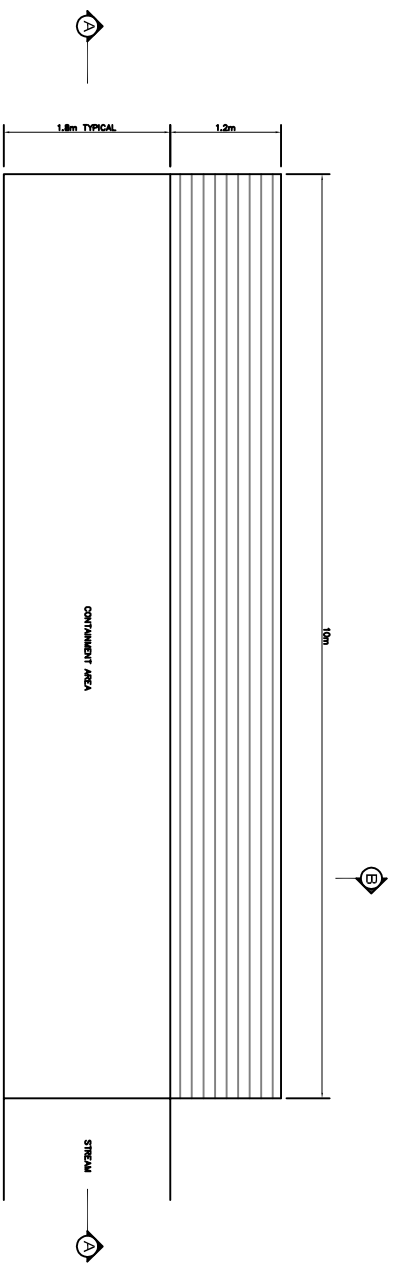

LONG SECTION A-A

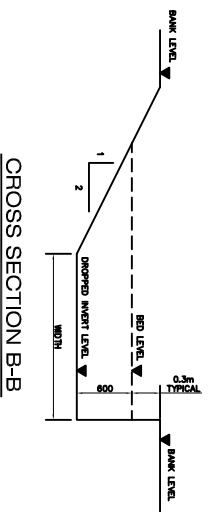

CROSS SECTION B-B

- NOTE:-
- 1 No. AT OUTFALL TO RIVER QUANTILY.
 - 1 No. AT OUTFALL TO RIVER PEASTINGAGH.

DETAILS OF SOILED WATER CONTAINMENT MEASURES NIS

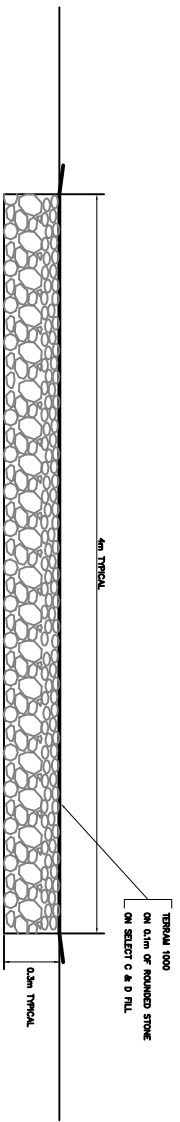

NOTE:- "TOWER" AT CENTRE POINT SHOWN PART YEAR 3 TO BE TREATED AS ABOVE OVER WIDTH OF "TOWER".

PROPOSED FILLING OF EXISTING DRAIN NIS

For inspection purposes only.
Consent of copyright owner required for any other use.

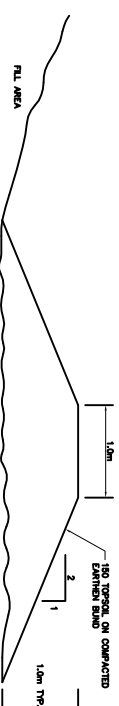

SECTION

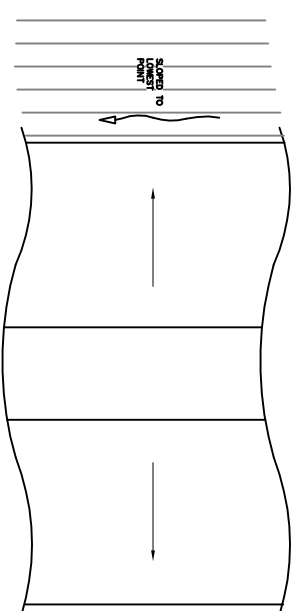

PLAN

BUND AT SOUTHERN END NIS

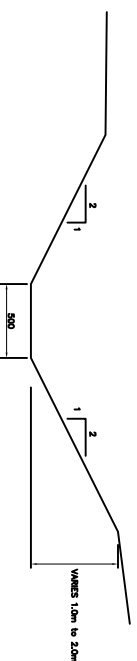

NEW DRAINAGE DITCH LINKING TO EXISTING STREAM (HEAD OF PEASTINGAGH RIVER) BESIDE N20 NIS

NO	REVISION	DATE
3	FOR RFP APPLICATION	12/01/09
2	MINOR CLARIFICATIONS TO DIMENSIONS	14/12/08
1	NEW DITCH BESIDE N20 SHOWN	09/11/08
0	INITIAL ISSUE	19/10/08

client	MALLOW CONTRACTS LTD.
project	APPLICATION OF WASTE MANAGEMENT PERMIT
drawing	SANITARY DETAILS

CONSULTING ENGINEERS

mescal & associates

Enterprise House,
Carrige Park Road,
Cork, Ireland.

tel 021-4314388
fax 021-4314389

As Shown

scale	date	job no	drw no
	OCTOBER 2008		13