

NEW CORANREE ROUNDABOUT

SITE NOTICE #1

SITE NOTICE #2

LANDS NOT INCLUDED IN THIS APPLICATION

LANDS NOT INCLUDED IN THIS APPLICATION

Conservation Area
Lands not included in this application where used for agriculture

- NOTES :**
1. SITE AREA = 28,967 Hectares (71,579 Acres)
 2. SURVEY INFORMATION TAKEN FROM MURPHY SURVEY'S DRAWING 08286C1 DATED 21-04-08
 3. INTERNAL LAND DRAINS TO BE FILLED WITH APPROVED FILL MATERIAL

LEGEND :

- EXISTING COMBINED SEWER
- EXISTING FOUL SEWER
- EXISTING STORM SEWER
- EXISTING RISING MAIN
- EXISTING WATERMAIN
- SITE BOUNDARY
- LANDHOLDING BOUNDARY
- LANDS TO BE FILLED TO LEVEL 3.50m MOD
- PROPOSED LAND DRAIN
- EXISTING OVERHEAD CABLE
- EXISTING UNDERGROUND CABLE

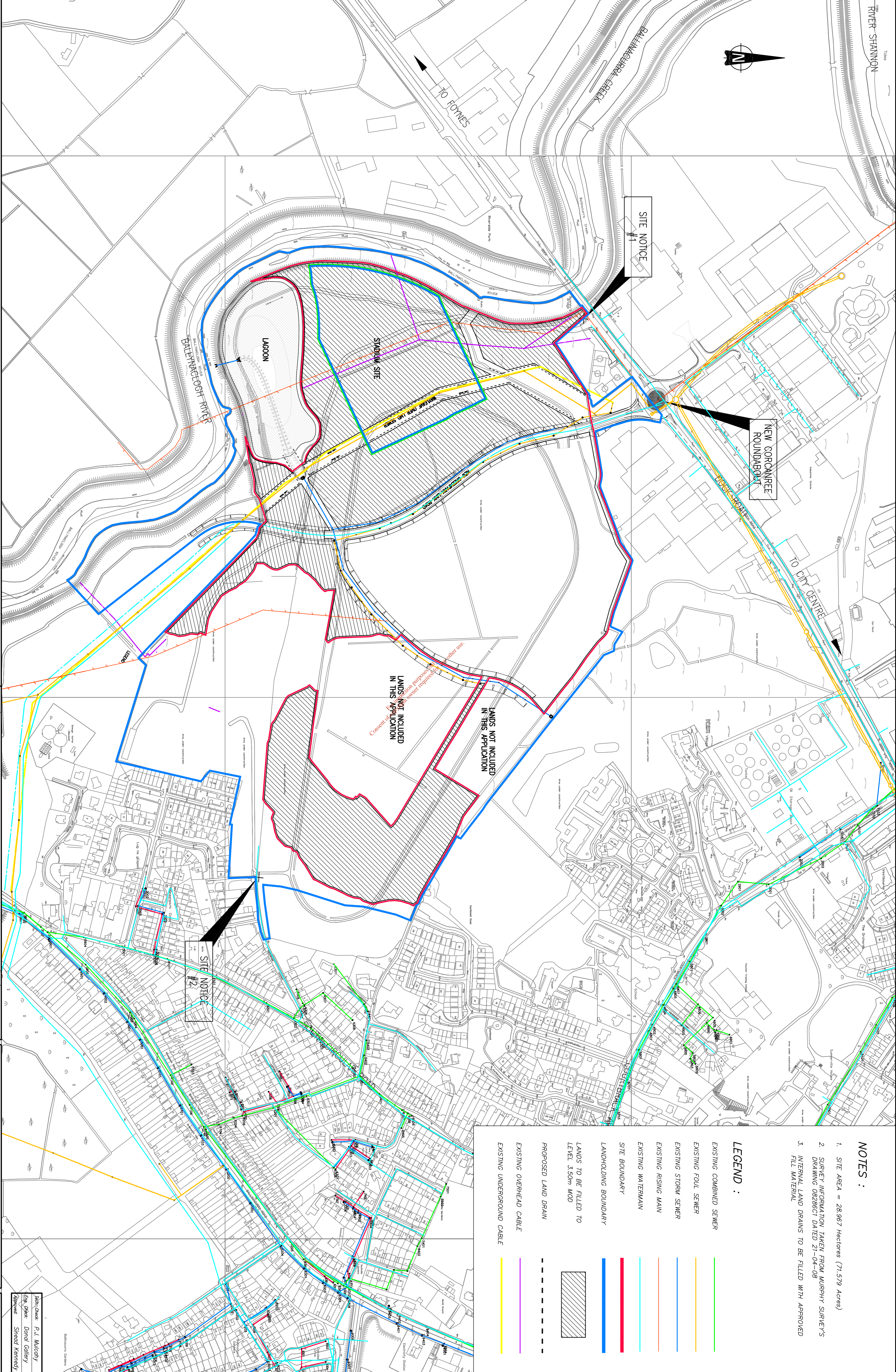

Michael Punch & Partners Ltd
 The office and any other person in the copyright of the
 Consultants and must not be reproduced without their written consent.
 All drawings remain the property of the Consultants.
 Figured dimensions only to be taken from this drawing.
 All dimensions to be checked on site.
 Responsibility of any
 discrepancies before work proceeds.

Ordnance Survey Ireland Licence No EN 0003709
 © Ordnance Survey Ireland and Government of Ireland

4742-10	4743-06	4743-07	4742-8
4742-15	4743-11	4743-12	4742-0
4742-20	4743-16	4743-17	

REV	DESCRIPTION	DATE

Michael Punch & Partners
 CONSULTING ENGINEERS

WASTE LICENCE APPLICATION - GREENPARK SERVICES PLAN

Scale: 1:2500
 Date: 2009-02-11
 Drawing No: 091-140-004 PO

Site: Planning
 Designer: P.J. Mulcahy
 Site: Donald Galley
 Approver: Sinead Kennedy

1st Floor, Greenpark, Limerick
 2nd Floor, Orange Island, Limerick
 3rd Floor, St. John's, Limerick
 4th Floor, St. John's, Limerick
 5th Floor, St. John's, Limerick
 6th Floor, St. John's, Limerick
 7th Floor, St. John's, Limerick
 8th Floor, St. John's, Limerick
 9th Floor, St. John's, Limerick
 10th Floor, St. John's, Limerick