

Monitoring Locations I.D.	
Air Emissions	Location
A2-1	Biofilter Bed
A2-2	Biomass Recovery Plant

- Pipeline to Percolation Area
- Eircom Ducting
- ESB Ducting
- Existing Storm water drainage
- County Council Storm water drainage
- Overhead powerline
- Sleeper boundary treatment
- Proposed Storm water drainage
- S Site Notice Locations

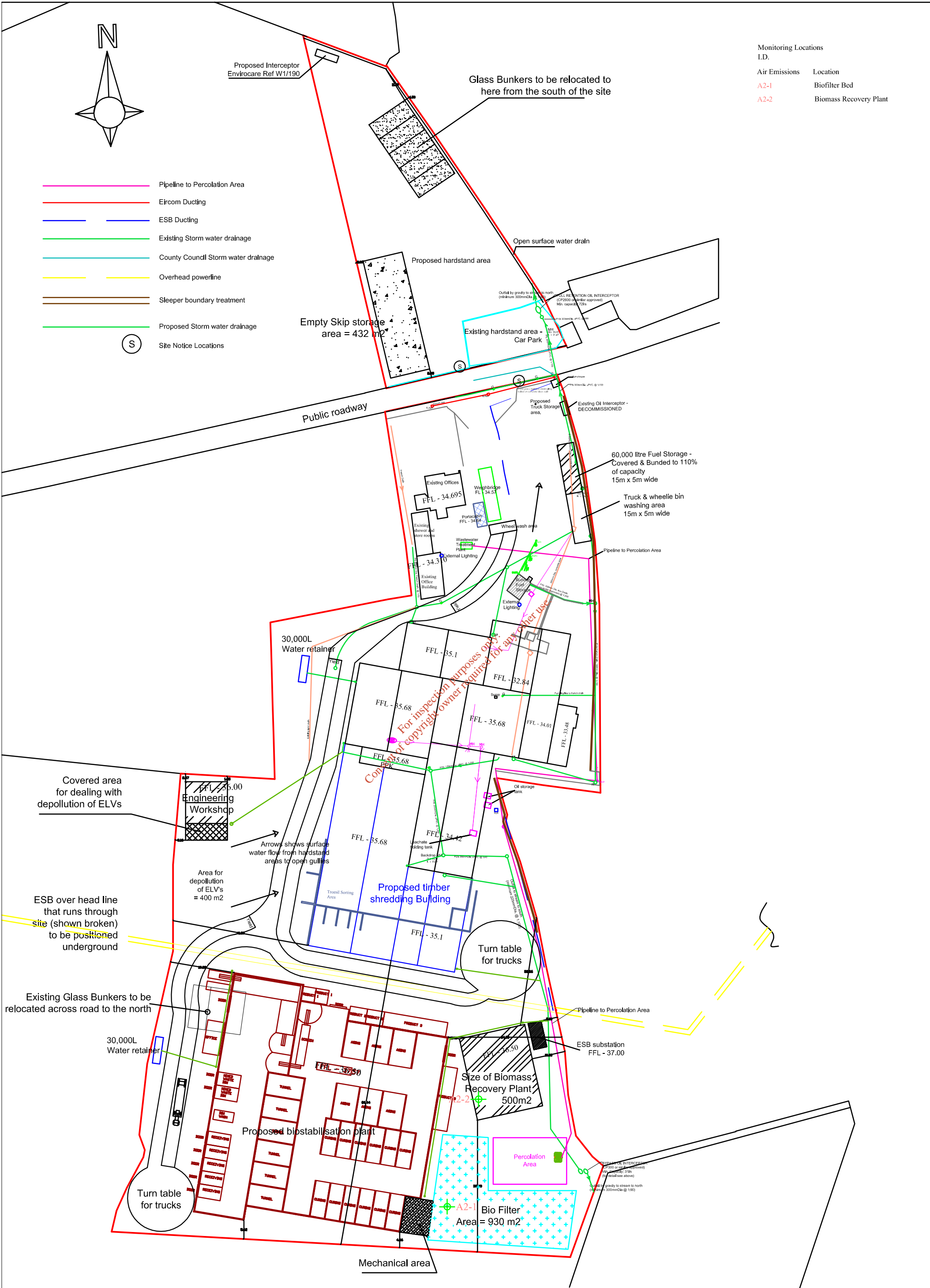

	Page Title: Emissions to Air Monitoring Locations	Project: Clean Ireland Waste Licence Application	Client: Clean Ireland Refuse Ltd, Cree, Co. Clare	Dr. No.: C(IRL)WL-10	Drawn by: Pádraig Neylon, B.Sc (Surveying) Benvoran, Cooraclare, Co. Clare.	Date: 12 / 12 / 08	Scale: A3 - 1: 1000	
--	---	--	---	--------------------------------	--	------------------------------	-------------------------------	--

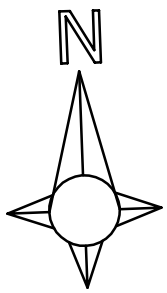

Proposed Interceptor
Envirocare Ref W1/190

Glass Bunkers to be relocated
here from the south of the site

Monitoring Locations	I.D.	Northing	Easting
Dust	D1	102716	166230
	D2	102794	166139
	D3	102679	166010
	D4	102731	165869
	D5	102804	166012

Proposed Boundary Layout

- Pipeline to Percolation Area
- Eircom Ducting
- ESB Ducting
- Existing Storm water drainage
- County Council Storm water drainage
- Overhead powerline
- Sleeper boundary treatment
- Proposed Storm water drainage
- S Site Notice Locations

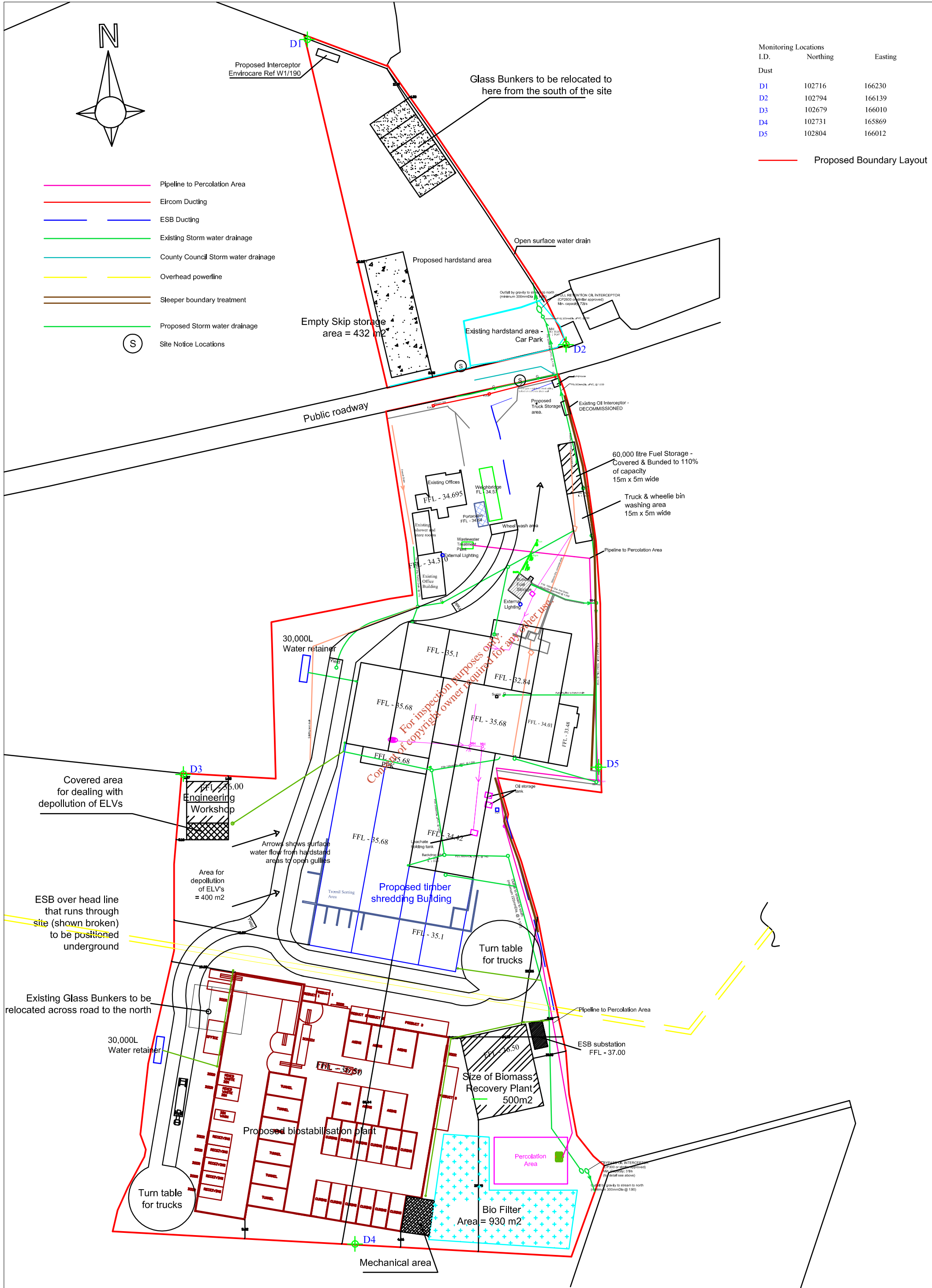

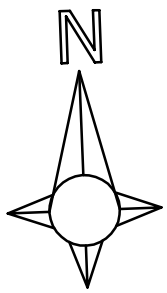

Monitoring Locations	I.D.	Northing	Easting
Surface water			
SW-1		102782.75	166157.35
SW-2		102800.64	165874.45

- Pipeline to Percolation Area
- Eircom Ducting
- ESB Ducting
- Existing Storm water drainage
- County Council Storm water drainage
- Overhead powerline
- Sleeper boundary treatment
- Proposed Storm water drainage
- S Site Notice Locations

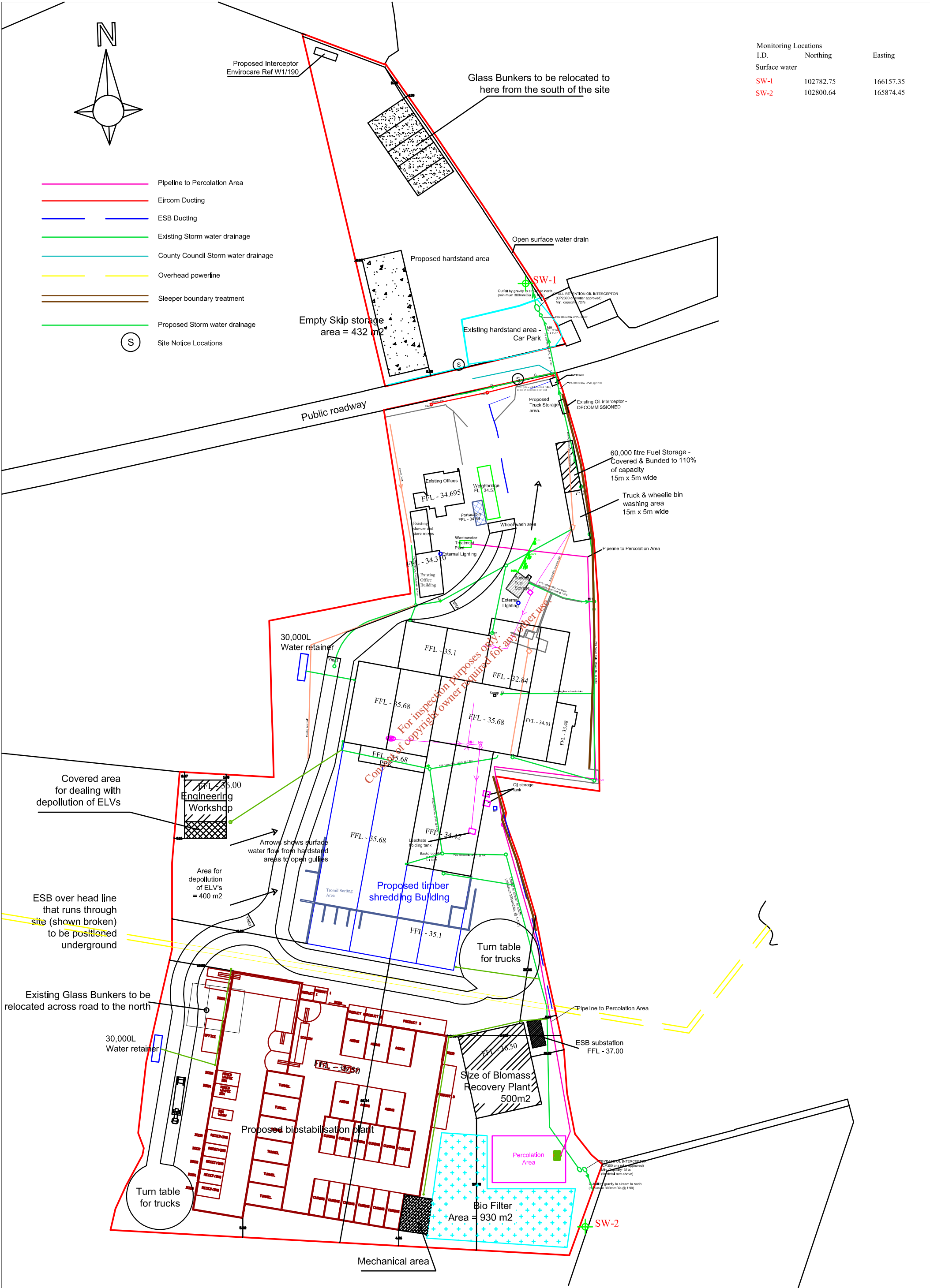

	Page Title: Emissions to Surface Waters	Project: Clean Ireland Waste Licence Application	Client: Clean Ireland Refuse Ltd, Cree, Co. Clare	Drng. No.: C(IREL)WL-08	Drawn by: Pádraig Neylon, B.Sc (Surveying) Benvoran, Cooraclare, Co. Clare.	Date: 12 / 12 / 08	Scale: A3 - 1: 1000	
--	---	--	---	-----------------------------------	--	------------------------------	-------------------------------	--

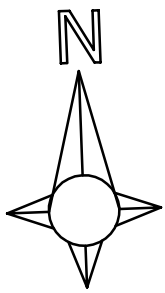

Monitoring Locations	I.D.	Northing	Easting
Groundwater			
GW-1		102776.80	165894.23
Bored Well		102785.92	166116.76

- Pipeline to Percolation Area
- Eircom Ducting
- ESB Ducting
- Existing Storm water drainage
- County Council Storm water drainage
- Overhead powerline
- Sleeper boundary treatment
- Proposed Storm water drainage
- S Site Notice Locations

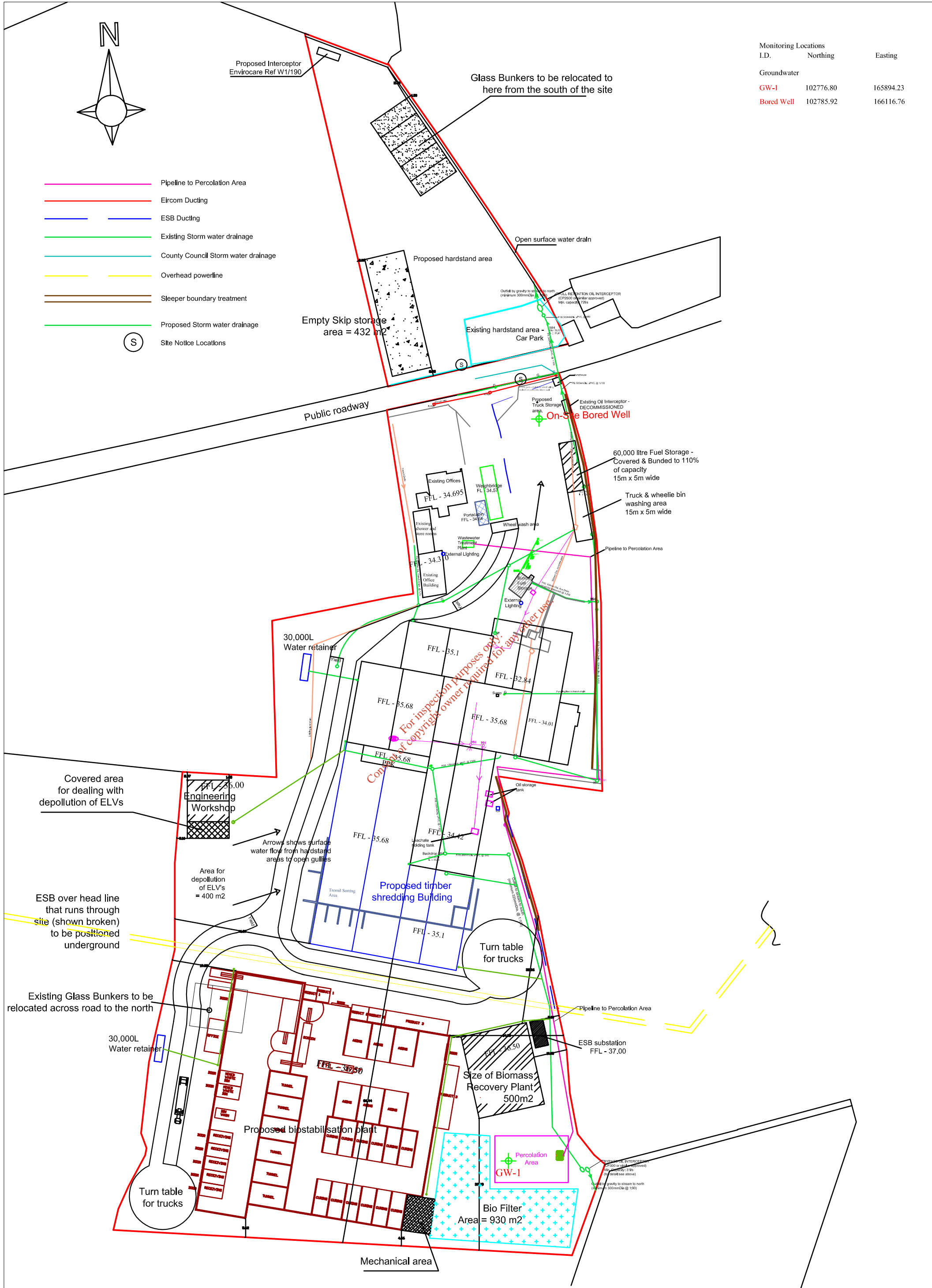

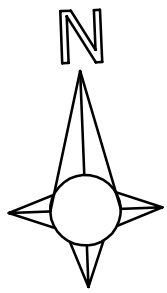

Monitoring Locations I.D.	Northing	Easting
Noise		
N1	102774	166146
N2	102720	166217
N3	102678	165872
N4	102794	165866
N5	102665	166078

Proposed Boundary Layout

- Pipeline to Percolation Area
- Eircom Ducting
- ESB Ducting
- Existing Storm water drainage
- County Council Storm water drainage
- Overhead powerline
- Sleeper boundary treatment
- Proposed Storm water drainage
- S Site Notice Locations

