

LEGEND:

- AGGLOMERATION BOUNDARY
- ▨ AREAS OF PENDING DEVELOPMENT

A ISSUE A MK 19/08/08

REV	DESCRIPTION	BY	CHK	APP	DATE

DRAWING TITLE:
APPLICATION FORM ATTACHMENT B1 - MAP 04
CASTLEMARTYR LAYOUT PLAN INDICATING
AGGLOMERATION

SCALE @ A3	DRAWN	DATE	CHECKED	DATE	APPROVED	DATE
1:5,000	MK	12/08/08	SL	12/08/08	KT	12/08/08
C006842	OFFICE	TYPE	ATTACHMENT No.	REVISION		
	1201	C	B1-MAP 04	A		

ENGINEERING MANAGEMENT ENVIRONMENTAL PLANNING

UNIT 2 UNIVERSITY TECHNOLOGY CENTRE CURAHEEN ROAD BISHOPTOWN CORK

TEL: +353 (0)21 4933200
e-mail: cork@wyg.com

White Young Green
Ireland

PROJECT:
CASTLEMARTYR WASTEWATER PLANT: WASTEWATER DISCHARGE LICENCE APPLICATION

CLIENT:
CORK COUNTY COUNCIL

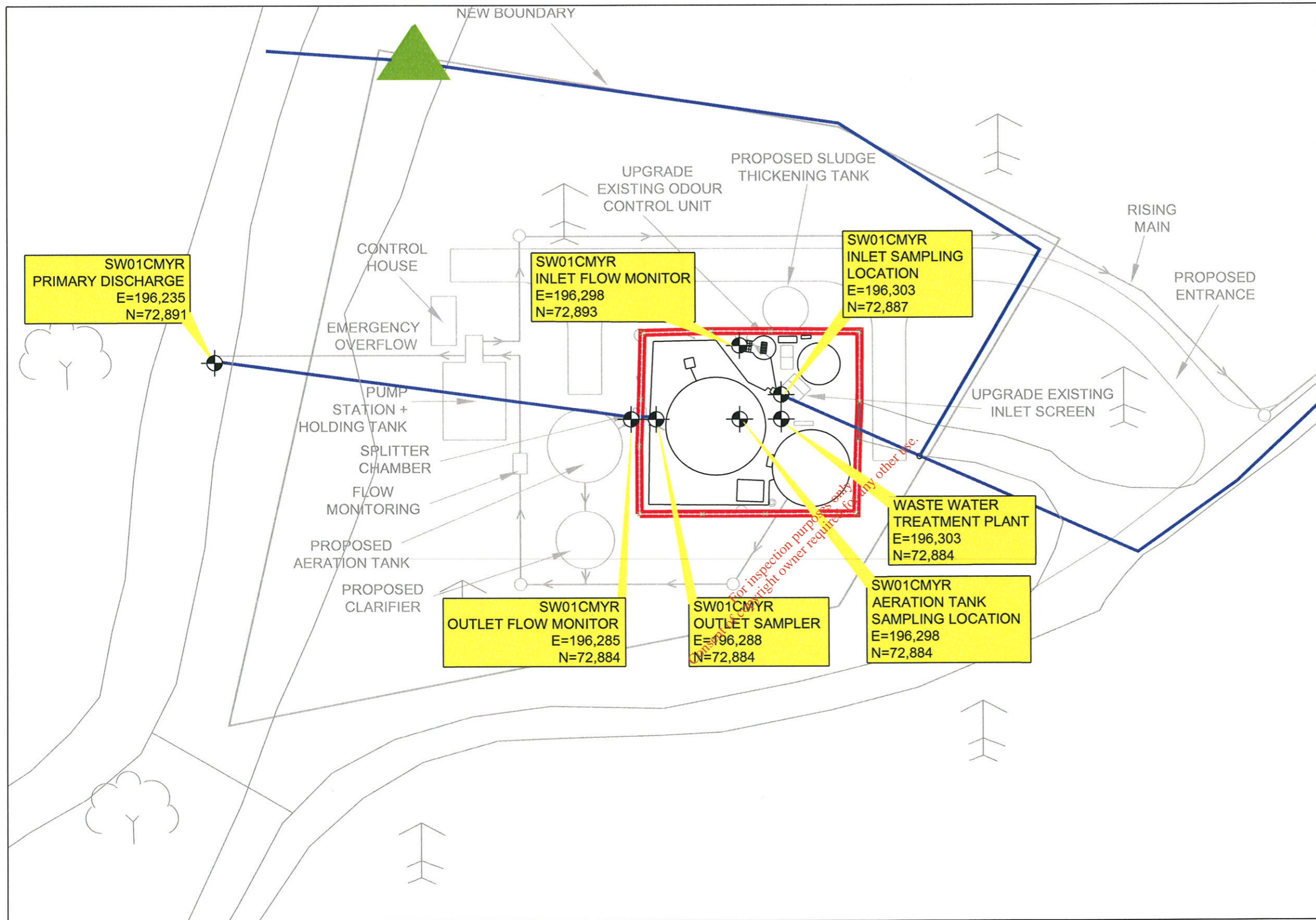

LEGEND:

- SITE BOUNDARY
- UPGRADE WORKS
- ▲ PRIVATE PUMP STATION

Copyright for inspection purposes only. All rights reserved. For any other use, contact the copyright owner.

A, ISSUE A MK 12/08/08

REV	DESCRIPTION	BY	CHK	APP	DATE

DRAWING TITLE:
 APPLICATION FORM ATTACHMENT B2 - MAP 05
 CASTLEMARTYR WASTE WATER TREATMENT PLANT
 SITE PLAN WITH UPGRADES AND MONITORING LCOATIONS

SCALE	@ A3	DRAWN	DATE	CHECKED	DATE	APPROVED	DATE
1:500		MK	12/08/08	SL	12/08/08	KT	12/08/08
C006842		OFFICE	1201	TYPE	C	ATTACHMENT No	B2-MAP 05
						REVISION	A

© White Young Green Ireland Ltd. SHEET SIZE : A3 LANDSCAPE

ENGINEERING MANAGEMENT ENVIRONMENTAL PLANNING
 UNIT 2 UNIVERSITY TECHNOLOGY CENTRE CURAHEEN ROAD BISHOPTOWN CORK
 White Young Green
 Ireland
 TEL: +353 (0)21 4933200
 e-mail: cork@wyg.com
 www.wyg.com

PROJECT:
 CASTLEMARTYR WASTE WATER PLANT: WASTE WATER DISCHARGE LICENCE APPLICATION
 CLIENT:
 CORK COUNTY COUNCIL

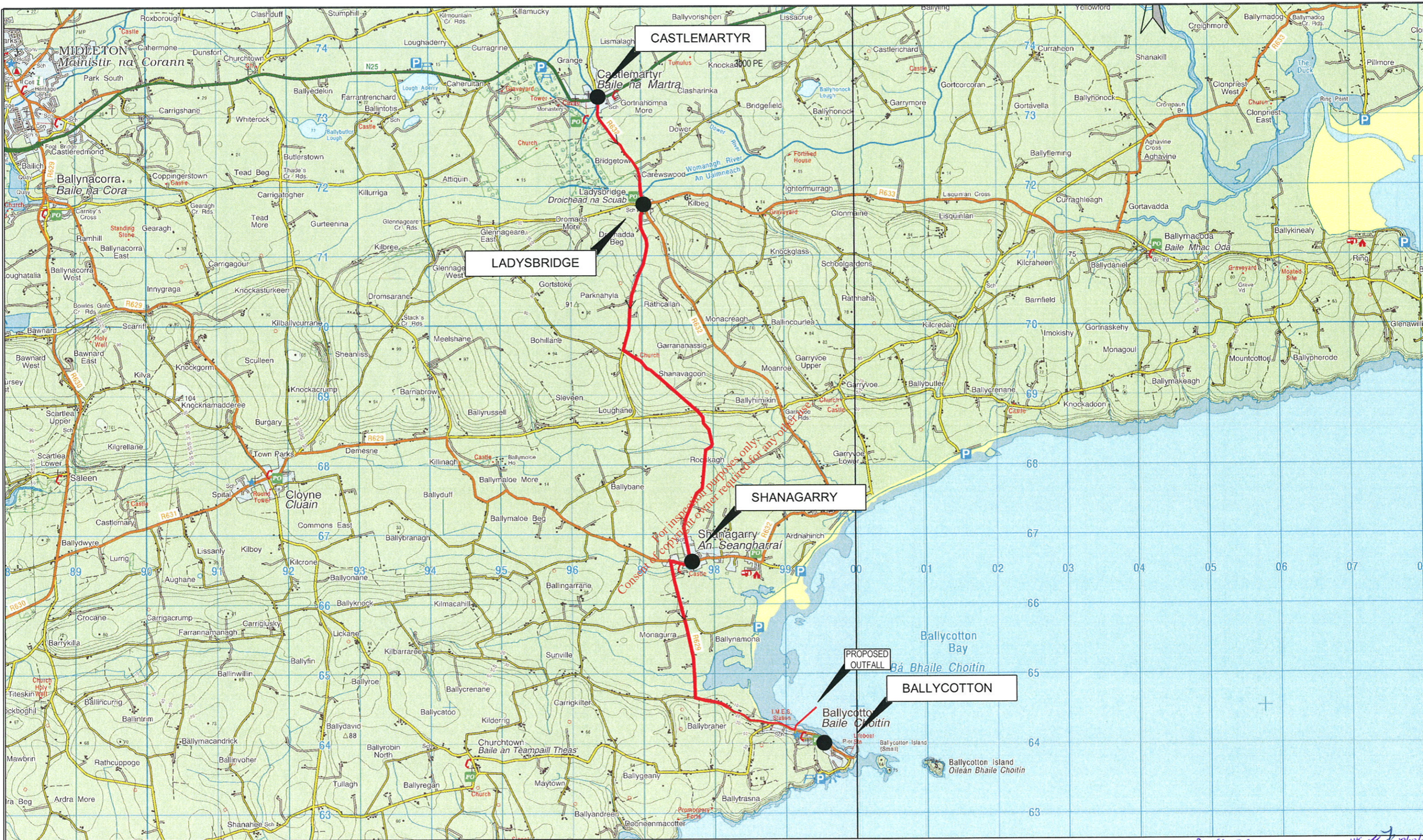

CASTLEMARTYR

LADYSBRIDGE

SHANAGARRY

BALLYCOTTON

PROPOSED
OUTFALL

ENGINEERING MANAGEMENT ENVIRONMENTAL PLANNING
 UNIT 2 UNIVERSITY TECHNOLOGY CENTRE CURAHEEN ROAD BISHOPTOWN CORK
 White Young Green
 Ireland
 TEL: +353 (0)21 4933200
 e-mail: cork@wyg.com
 www.wyg.com

PROJECT:
 CASTLEMARTYR WASTE WATER PLANT: WASTE WATER DISCHARGE LICENCE APPLICATION
 CLIENT:
 CORK COUNTY COUNCIL

A ISSUE A
 REV DESCRIPTION BY CHK APP DATE
 UK 19/08/08

DRAWING TITLE:
 APPLICATION FORM ATTACHMENT B2 - MAP 07
 CASTLEMARTYR WWTP PROPOSED DISCHARGE
 PROPOSED RISING MAIN ROUTE AND OUTFALL

SCALE @ A3	DRAWN	DATE	CHECKED	DATE	APPROVED	DATE
1:50,000	MK	12/08/08	SL	12/08/08	KT	12/08/08
C006842	OFFICE	TYPE	DRAWING No.	B2-MAP 07	REVISION	A

© White Young Green Ireland Ltd. SHEET SIZE : A3 LANDSCAPE

FILENAME: G:\C006842\05 PROJECT DEVELOPMENT\T03 CAS02 DRAWINGS-FIGURES\B2-MAP 07 DWG | PLOTTED BY: MICHAL KOLAR | PLOTTED DATE: 19 September 2008 15:28:30



LEGEND:

- SITE BOUNDARY
- ▲ PRIVATE PUMP STATION

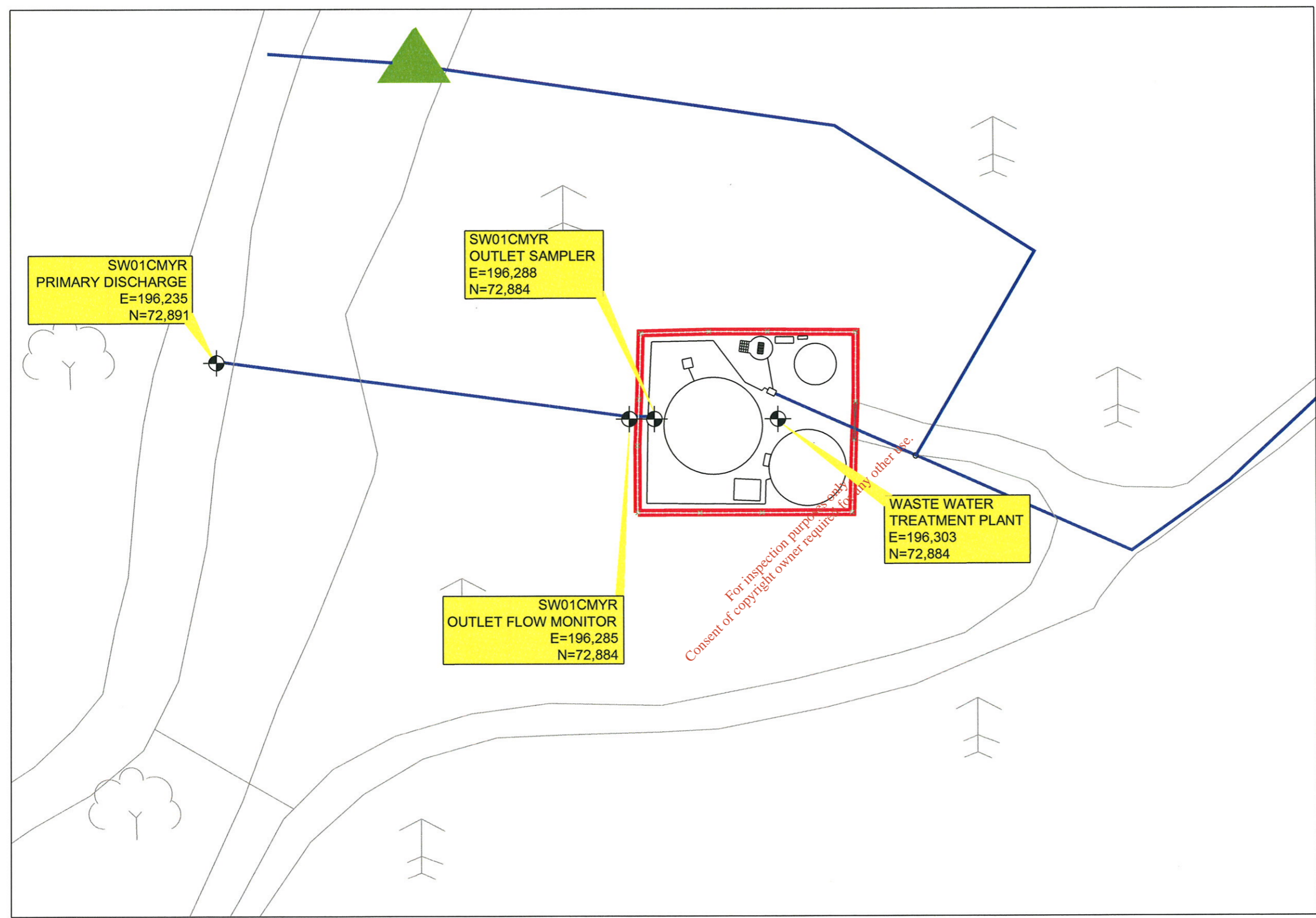

A ISSUE A		MK 19/08/08	
REV	DESCRIPTION	BY	DATE

DRAWING TITLE:
 APPLICATION FORM ATTACHMENT B3 - MAP 08
 CASTLEMARTYR WASTE WATER TREATMENT PLANT
 MONITORING LOCATIONS FOR THE PRIMARY DISCHARGE

SCALE @ A3 1:500	DRAWN MK	DATE 12/08/08	CHECKED SL	DATE 12/08/08	APPROVED KT	DATE 12/08/08
C006842	OFFICE 1201	TYPE C	ATTACHMENT No. B3-MAP 08	REVISION A		

© White Young Green Ireland Ltd. SHEET SIZE : A3 LANDSCAPE

PROJECT:
 CASTLEMARTYR WASTE WATER PLANT: WASTE WATER DISCHARGE LICENCE APPLICATION

CLIENT:
 CORK COUNTY COUNCIL

ENGINEERING MANAGEMENT ENVIRONMENTAL PLANNING

UNIT 2 UNIVERSITY TECHNOLOGY CENTRE CURAHEEN ROAD BISHOPTOWN CORK

White Young Green Ireland

TEL: +353 (0)21 4933200 e-mail: cork@wyg.com

www.wyg.com

FILENAME: G:\C006842\05 PROJECT DEVELOPMENT\03 CAS\02 DRAWINGS-FIGURES\B3-MAP 08.DWG | PLOTTED BY: MICHAL KOLAR | PLOTTED DATE: 19 September 2008 15:30:30

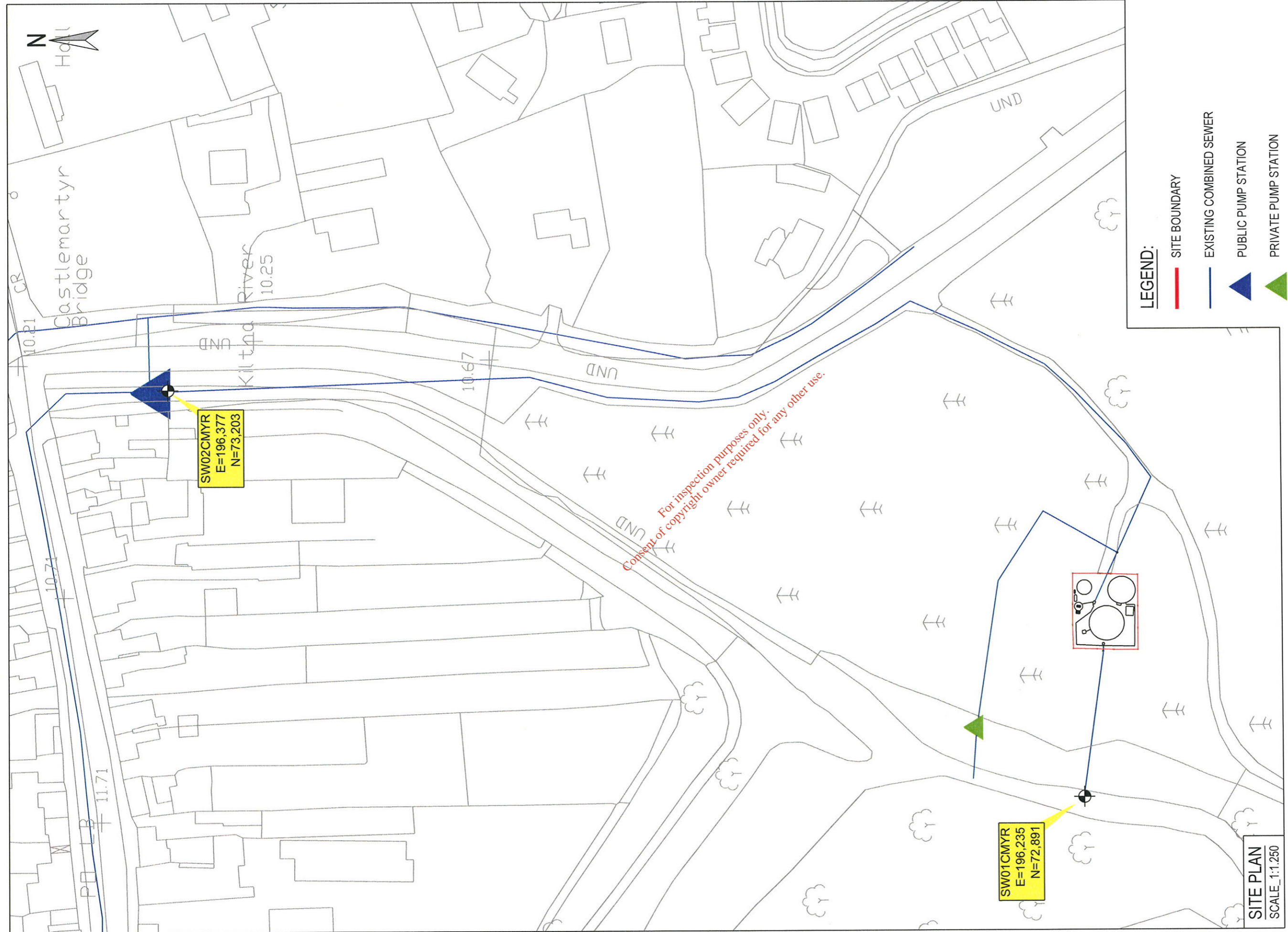

- LEGEND:**
- SITE BOUNDARY
 - EXISTING COMBINED SEWER
 - ▲ PUBLIC PUMP STATION
 - ▲ PRIVATE PUMP STATION

SW02CMYR
E=196,377
N=73,203

SW01CMYR
E=196,235
N=72,891

For inspection purposes only.
Consent of copyright owner required for any other use.

SITE PLAN
SCALE_1:1,250

REV	DESCRIPTION	BY	CHK	APP	DATE
A	ISSUE A	MT	MT	MT	12/08/08

SCALE @ A3	DRAWN	DATE	CHECKED	DATE	APPROVED	DATE
AS SHOWN	MT	12/08/08	SL	12/08/08	KT	12/08/08
OFFICE TYPE			ATTACHMENT No.		REVISION	
C006842			1201 C		B4-MAP 09 A	

DRAWING TITLE:
APPLICATION FORM ATTACHMENT B4 - MAP 09
CASTLEMARTYR WASTE WATER WORKS
SECONDARY DISCHARGE LOCATIONS

PROJECT:
CASTLEMARTYR WASTEWATER PLANT: WASTEWATER DISCHARGE LICENCE APPLICATION

CLIENT:
CORK COUNTY COUNCIL

ENGINEERING
MANAGEMENT
ENVIRONMENTAL
PLANNING

White
Young
Green
Ireland

UNIT 2
UNIVERSITY TECHNOLOGY CENTRE
CURAHEEN ROAD
BISHOPTOWN
CORK

TEL: +353 (0)21 4933200
e-mail: cork@wyg.com

www.wyg.com

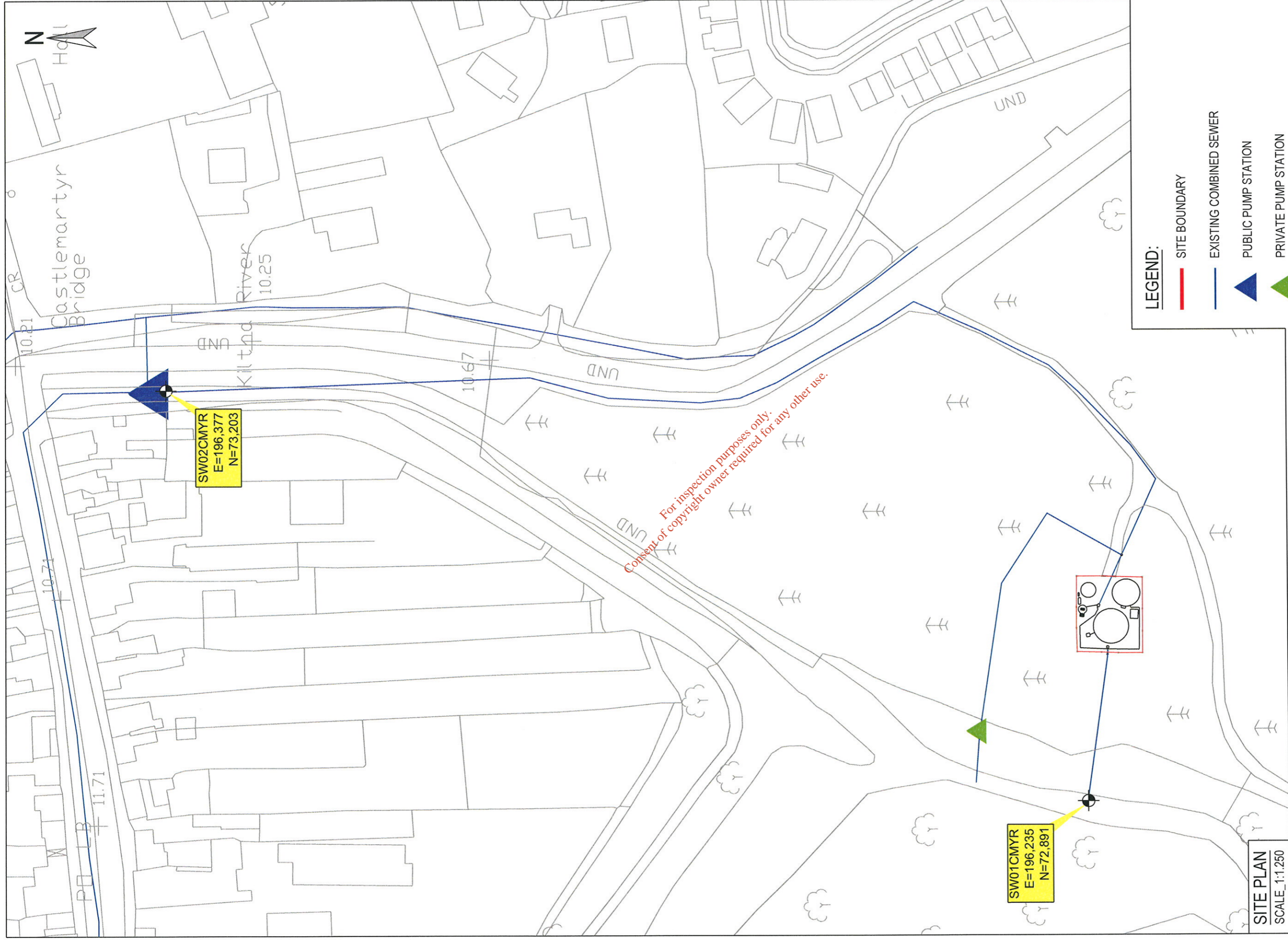

SITE PLAN
SCALE_1:1,250

- LEGEND:**
- SITE BOUNDARY
 - EXISTING COMBINED SEWER
 - ▲ PUBLIC PUMP STATION
 - ▲ PRIVATE PUMP STATION

A ISSUE A		BY	CHK	APP	DATE
REV	DESCRIPTION				

DRAWING TITLE:
APPLICATION FORM ATTACHMENT B5 - MAP 10
STORM WATER OVERFLOW DISCHARGE LOCATIONS

SCALE @ A3	DRAWN	DATE	CHECKED	DATE	APPROVED	DATE
AS SHOWN	MM	12/08/08	SL	12/08/08	KT	12/08/08
C006842	1201	C	B5-MAP 10	C	B5-MAP 10	A
						REVISION

© White Young Green Ireland Ltd. SHEET SIZE: A3 PORTRAIT

PROJECT:
CASTLEMARTYR WASTEWATER PLANT: WASTEWATER DISCHARGE LICENCE APPLICATION

CLIENT:
CORK COUNTY COUNCIL

ENGINEERING
 MANAGEMENT
 ENVIRONMENTAL
 PLANNING

UNIT 2
 UNIVERSITY TECHNOLOGY CENTRE
 CURAHEEN ROAD
 BISHOPTOWN
 CORK

TEL: +353 (0)21 493200
 e-mail: cork@wyg.com

www.wyg.com



CORK COUNTY COUNCIL

SITE NOTICE

APPLICATION TO THE ENVIRONMENTAL PROTECTION AGENCY FOR A WASTEWATER DISCHARGE LICENCE

In accordance with the Waste Water Discharge (Authorisation) Regulations 2007, Water Services Southern Division of Cork County Council, Carrigrohane Road, Cork is applying to the Environmental Protection Agency for a Waste Water Discharge Licence for the Agglomeration of Castlemartyr at the following locations:

Plant Name	Location	National Grid Ref.
Castlemartyr WWTP	Bridgetown, Castlemartyr	E196303 N72884

Discharge	Function	Townland	Receptor	Grid Reference
Primary	Main	Bridgetown	Kiltha River	E196235 N72891
Secondary	Emergency	Bridgetown	Kiltha River	E196235 N72891
Secondary	Emergency	Bridgetown	Kiltha River	E196377 N72203

A copy of the application for the Waste Water Discharge Licence and such further information relating to the application as may be furnished to the Agency in the course of the Agency's consideration of the Application shall as soon as is practicable after receipt by the Agency be available for inspection or purchase at the

- **Environmental Protection Agency, PO Box 3000, Johnstown Castle Estate, Co. Wexford, Lo Call 1890 335599 Telephone: 053-9160600 Fax: 053-9160699 Email:info@epa.ie**

and at

- **Cork County Council Offices, Water Services South, County Hall, Carrigrohane Road, Co. Cork, Telephone: 021 - 4276891 Fax: 021 - 4276321.**

Submissions in relation to the application may be made to the Environmental Protection Agency at its headquarters described above.

Newspaper Advertisement

Cork County Council Southern Division

**APPLICATION TO THE ENVIRONMENTAL
PROTECTION AGENCY FOR A WASTEWATER
DISCHARGE LICENCE**

In accordance with the Waste Water Discharge (Authorisation) Regulations 2007, Water Services Southern Division of Cork County Council, Carrigrohane Road, Cork is applying to the Environmental Protection Agency for a Waste Water Discharge Licence for the Agglomeration of Castlemartyr at the following locations:

Plant Name	Location	National Grid Ref.
Castlemartyr WWTP	Bridgetown, Castlemartyr	E196303 N72884

Discharge	Function	Townland	Receptor	Grid Reference
Primary	Main	Bridgetown	Kiltha River	E196235 N72891
Secondary	Emergency	Bridgetown	Kiltha River	E196235 N72891
Secondary	Emergency	Bridgetown	Kiltha River	E196377 N72203

A copy of the application for the Waste Water Discharge Licence and such further information relating to the application as may be furnished to the Agency in the course of the Agency's consideration of the Application shall as soon as is practicable after receipt by the Agency be available for inspection or purchase at the

- **Environmental Protection Agency, PO Box 3000, Johnstown Castle Estate, Co. Wexford, Co. Call 1890 335599 Telephone: 053-9160600 Fax: 053-9160699 Email:info@epa.ie**

and at

- **Cork County Council Offices, Water Services South, County Hall, Carrigrohane Road, Co. Cork, Telephone: 021 - 4276891 Fax: 021 - 4276321.**

Submissions in relation to the application may be made to the Environmental Protection Agency at its headquarters described above

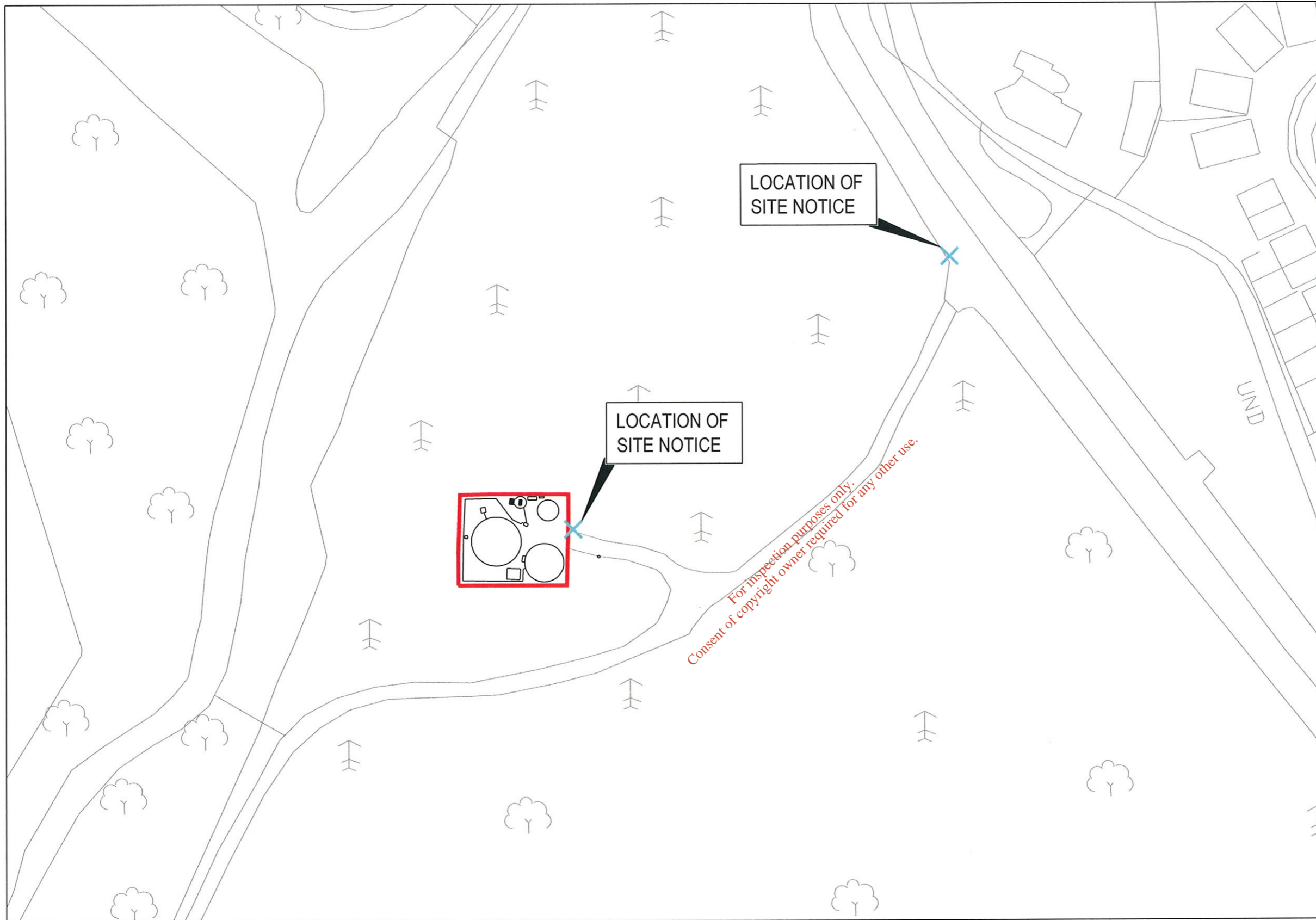

LEGEND:

— SITE BOUNDARY

*For inspection purposes only.
Consent of copyright owner required for any other use.*

A ISSUE A *19/07/08*

REV	DESCRIPTION	BY	CHK	APP	DATE

DRAWING TITLE:
APPLICATION FORM ATTACHMENT B8 - MAP 11
CASTLEMARTYR - SITE NOTICE LOCATIONS

SCALE	@ A3	DRAWN	DATE	CHECKED	DATE	APPROVED	DATE
1:1,000		MK	12/08/08	SL	12/08/08	KT	12/08/08
C006842		OFFICE	1201	TYPE	C	ATTACHMENT No.	B8-MAP 11
						REVISION	A

© White Young Green Ireland Ltd. SHEET SIZE : A3 LANDSCAPE

ENGINEERING MANAGEMENT ENVIRONMENTAL PLANNING
 UNIT 2 UNIVERSITY TECHNOLOGY CENTRE CURAHEEN ROAD BISHOPTOWN CORK
 TEL: +353 (0)21 4933200 e-mail: cork@wyg.com
 White Young Green Ireland

PROJECT:
CASTLEMARTYR WASTEWATER PLANT: WASTEWATER DISCHARGE LICENCE APPLICATION
 CLIENT:
CORK COUNTY COUNCIL

FILENAME: G:\C006842\05 PROJECT DEVELOPMENT\03 CAS\02 DRAWINGS-FIGURES\B8-MAP 11.DWG | PLOTTED BY: MICHAL KOJAR | PLOTTED DATE: 19 September 2008 15:37:05

11th December 2006

County Secretary,
Cork County Council,
County Hall,
Cork.

Send copy to R Kent of JB Barry 15/12/06

SOUTH CORK RURAL
14 DEC 2006
CORK COUNTY COUNCIL
COUNTY HALL - CORK

Re: Approvals under the Serviced Land Initiative Scheme.

A Chara,

(File)

I am directed by the Minister for the Environment and Local Government to inform you that the following schemes have been approved under the Serviced Land Initiative:

Scheme	Total Cost of Scheme*	Departments Contribution 40%	No. of Housing Units	Cost per Unit
Castlemartyr Wastewater Treatment Plant Upgrade	€1,210,595	€370,537	339	€2,414
Killeagh Wastewater Treatment Plant Upgrade	€1,229,192	€420,102	335	€2,771
Midleton Wastewater Treatment Plant Upgrade	€4,050,956	€1,371,866	1,191	€2,679
Total	€6,490,743	€2,162,505	1,865	€7,864

*The total cost of the schemes includes amounts attributable to non-domestic marginal cost. This is not eligible for Departmental funding

I am also to request the Council to progress these projects without delay.



Cork County

Water Services Investment Programme 2007 - 2009

Schemes at Construction	W/S	Est. Cost	Schemes to start 2009 contd.	W/S	Est. Cost
Cork North			Cork South		
Mitchelstown Sewerage Scheme (Nutrient Removal)	S	221,000	Ballincollig Sewerage Scheme (Upgrade) (G)	S	22,248,000
Cork South			Cork Lower Harbour Sewerage Scheme (excl. Crosshaven SS)	S	73,542,000
Ballyourney/ Ballymakeery Sewerage Scheme	S	3,049,000	Shannagary/ Garryvoe/ Ballycotton Sewerage Scheme	S	3,780,000
Cobh/ Midleton/ Carrigtwohill Water Supply Scheme	W	10,135,000	Youghal Sewerage Scheme	S	14,420,000
Cork Lower Harbour Sewerage Scheme (Crosshaven SS) (G)	S	4,850,000	Cork West		
Cork Water Strategy Study (G)	W	941,000	Ballydehob Sewerage Scheme	S	683,000
Kinsale Sewerage Scheme	S	20,000,000	Bantry Water Supply Scheme	W	14,935,000
Midleton Sewerage Scheme (Infiltration Reduction) (G)	S	2,078,000	Clonakilty Sewerage Scheme (Plant Capacity Increase)	S	3,677,000
		41,274,000	Courtmacsherry/ Timoleague Sewerage Scheme	S	2,472,000
Schemes to start 2007			Dunmanway Regional Water Supply Scheme Stage 1	W	12,669,000
					164,629,000
Cork North			Serviced Land Initiative		
North Cork Grouped DBO Wastewater Treatment Plant (Buttevant, Doneraile & Kilbrin)	S	5,150,000	Cork North		
Cork West			Ballycough Water Supply Scheme	W	139,000
Skibbereen Sewerage Scheme	S	20,000,000	Ballyhooey Improvement Scheme	W/S	139,000
		25,150,000	Brookmill/Rathgoggin Sewerage Scheme	S	406,000
Schemes to start 2008			Breeing Water Supply Scheme	W	115,000
Cork North			Churchtown Sewerage Scheme (incl. Water)	W/S	543,000
Mallow/ Ballyvinitier Regional Water Supply Scheme (H)	W	8,652,000	Clondulane Sewage Treatment Plant	S	417,000
Mallow Sewerage Scheme (H)	S	5,408,000	Freemount Sewerage Scheme	S	150,000
Cork South			Pike Road Sewerage Scheme (incl. Water)	W/S	2,080,000
Ballincollig Sewerage Scheme (Nutrient Removal) (G)	S	948,000	Rathcormac Sewerage Scheme (incl. Water)	W/S	555,000
Ballingeary Sewerage Scheme	S	1,296,000	Spa Glen Sewerage Scheme	S	736,000
Bandon Sewerage Scheme Stage 2	S	14,729,000	Uplands Fermoy Sewerage Scheme (incl. Water)	W/S	1,174,000
City Environs (CASP) Strategic Study (G)	S	153,000	Watergrasshill Water Supply Scheme (incl. Sewerage) (G)	W/S	4,151,000
Cloghroe Sewerage Scheme (Upgrade)	S	683,000	Cork South		
Coachford Water Supply Scheme	W	1,318,000	Ballincollig Sewerage Scheme (Barry's Rd Foul and Storm Drainage) (G)	S	1,164,000
Garretstown Sewerage Scheme	S	2,153,000	Belgooley, Water Supply Scheme (incl. Sewerage)	W/S	2,913,000
Inniscarra Water Treatment Plant Extension Phase 1	W	2,678,000	Blarney Water Supply Scheme (Ext. to Station Rd) (G)	W	416,000
Little Island Sewerage Scheme (G)	S	2,200,000	Carrigtwohill Sewerage Scheme (Treatment and Storm Drain) (G)	S	7,632,000
Cork West			Castlematyr Wastewater Treatment Plant Extension	S	1,200,000
Bantry Sewerage Scheme	S	7,148,000	Crookstown Sewerage Scheme (incl. Water)	W/S	1,200,000
Dunmanway Sewerage Scheme	S	2,153,000	Dripsey Water Supply Scheme (incl. Sewerage)	W/S	1,112,000
Leap/ Baltimore Water Supply Scheme	W	6,365,000	Glounthane Sewerage Scheme (G)	S	1,576,000
Schull Water Supply Scheme	W	5,253,000	Innishannon Sewerage Scheme	S	277,000
		61,137,000	Innishannon Wastewater Treatment Plant	S	694,000
Schemes to start 2009			Kerry Pike Sewerage Scheme	S	832,000
Cork North			Kerry Pike Water Supply Scheme	W	416,000
Banteer/Dromahane Regional Water Supply Scheme	W	1,576,000	Killeagh Wastewater Treatment Plant Extension	S	1,200,000
Conna Regional Water Supply Scheme Extension	W	2,627,000	Killeagh Water Supply Scheme (includes Sewerage)	W/S	485,000
Cork NE Water Supply Scheme	W	4,326,000	Killeens Sewerage Scheme	S	420,000
Cork NW Regional Water Supply Scheme	W	6,046,000	Kilnagleary Sewerage Scheme	S	694,000
Millstreet Wastewater Treatment Plant (Upgrade)	S	1,628,000	Midleton Wastewater Treatment Plant Extension	S	4,050,000