



Ms. Yvonne Furlong,
Inspector,
Office of Climate, Licensing & Resource Use,
Environmental Protection Agency,
Headquarters P.O. Box 3000,
Johnstown Castle Estate,
County Wexford

15th July 2008

RE: Application for Waste Licence Ref. No. W0241-01 Greenstar Ltd., Clavass, Eniscorthy,
County Wexford

Dear Ms. Furlong,

On behalf of Greenstar Ltd., I enclose a drawing showing the revised site layout. The revision to the southern site boundary and internal layout was required in response to queries from the planning authority. The southern boundary has moved approximately 5m to the south of the original line. The acoustic barrier has also moved to the south.

The minor alteration to the boundary does not change the conclusions of the noise impact assessment. I enclose a letter from the noise consultants (Dixon Brosnan), who prepared the assessment, confirming this. I also enclose a revised drawing showing the proposed monitoring locations, which have changed due to the alterations in the site layout; the revised Non-Technical Summary and three electronic copies of all of the information.

I confirm that the faulty pump in the pumping station to the south of the application area has been replaced and that the sanitary authority has been informed of this.

The additional information compiled in response of requests from the planning authority, included the completion of an archaeological and architectural heritage survey; changes to the surface water drainage system to provide an on-site percolation area; changes to the car parking layout; changes to the building height and revised landscape measures to screen the site; and changes to the planning application area to include the entire Greenstar landholding. The latter was solely required to give comfort to the planning authority in relation to the provision of proper sight lines and landscaping.

Cont'd

The changes have required the amendment to the Environmental Impact Statement (EIS) and I enclose three hard copies and 16 electronic copies of the EIS CD-ROM discs.

If you have any queries, please call me.

Yours sincerely,



Jim O'Callaghan

For inspection purposes only.
Consent of copyright owner required for any other use.

0704819/JOC/JC

Encl

c.c. Mr. Malcolm Dowling, Greenstar Ltd.

Michael Watson
O'Callaghan Moran & Associates
Granary House
Rutland Street
Cork

date	our ref	your ref	cc
21.05.08	07031		

Re: Proposed Greenstar facility at Enniscorthy, Co. Wexford.

Dear Michael,

I wish to confirm that I have received and reviewed drawing 1375-P-003 Rev-1 dated 10.04.08. The drawing shows a proposed relocation of the southern boundary of the site. It is now proposed to locate this boundary 3 m south of the original southern boundary. The proposed acoustic barrier will also be relocated.

I wish to confirm that the proposed relocation will not affect offsite propagation of noise emissions. A relocation of at least 20 m would be required before any change would arise.

Please contact me if you have any queries.

Yours sincerely,



Damian Brosnan

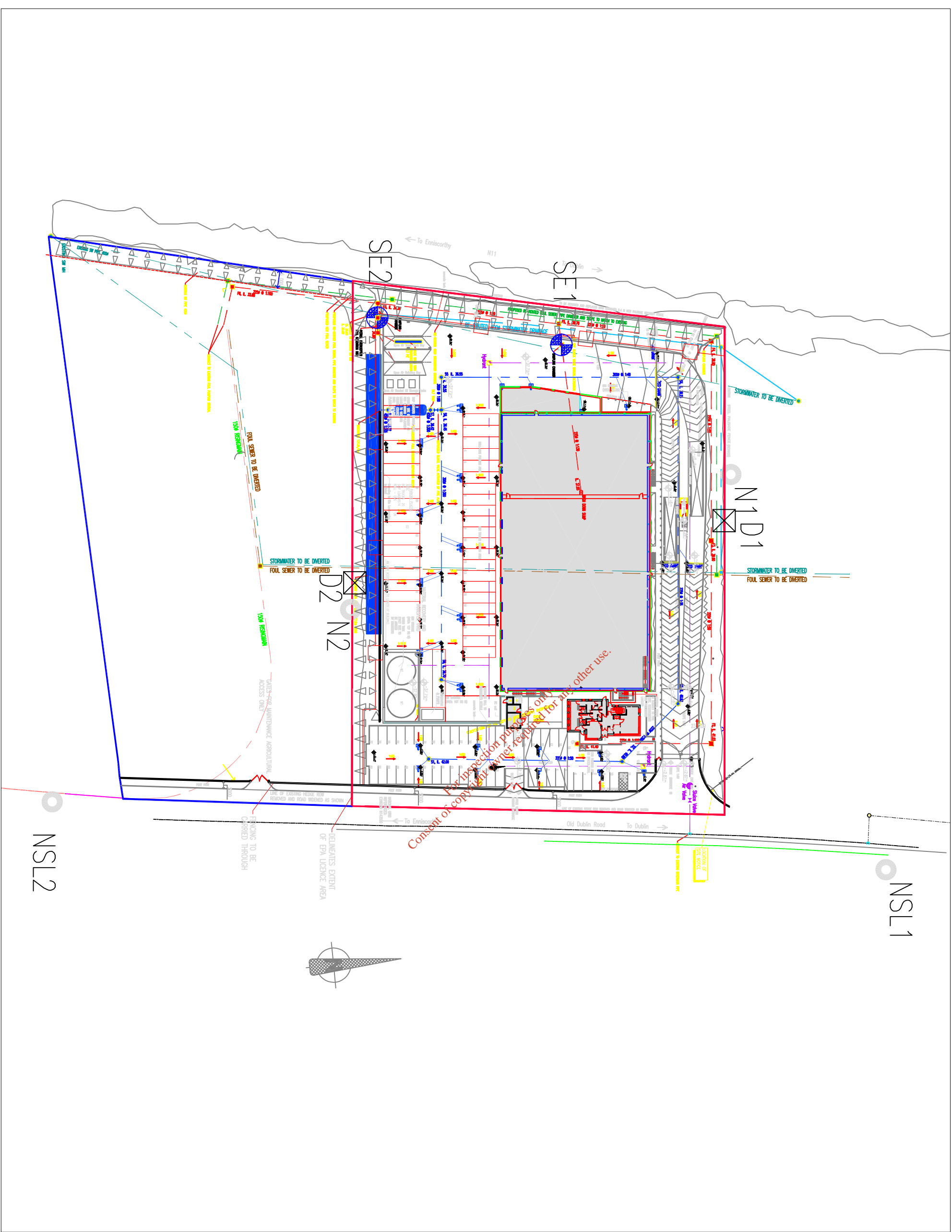

NOTES

- ☉ Denotes Sewer Monitoring Point
- ◐ Denotes Surfacewater Monitoring
- Denotes noise monitoring point
- ⊗ Denotes dust monitoring point

I.D.	EASTING	NORTHING
NSL1	298403	143634
NSL2	298382	143394
N1	298282	143574
N2	298302	143479
SE-1	298360	143420
SE-2	298251	143491
SW-1	298262	143487
D1	298283	143575
D2	298368	143478
D3	298368	143530

REV	DATE	DESCRIPTION	DRN	CHKD	APP
B	08/07/08	FI	MW	JOC	**
A	09/11/07	ISSUE	MW	JOC	**

O'Callaghan Moran & Associates,
 Granary House, Rutland Street,
 Cork, Ireland.
 Tel: (021) 4321821 Fax: (021) 4321822
 email: oca@indigo.ie

CLIENT
GREENSTAR LTD

TITLE
**MONITORING LOCATIONS
 ENNISCORTHY**

SCALE	DRAWING No.	REV.
1:1000	F1	B



ORIGINAL SITE AREA AS PER PLANNING APPLICATION LODGEMENT
 SITE AREA (13 511 SQ.M.)

PROPOSED SITE AREA TO ADDRESS RFI REQUIREMENTS
 SITE AREA (14 368 SQ.M.)

ADJACENT LANDHOLDING AREA
 (10 939 SQ.M.)

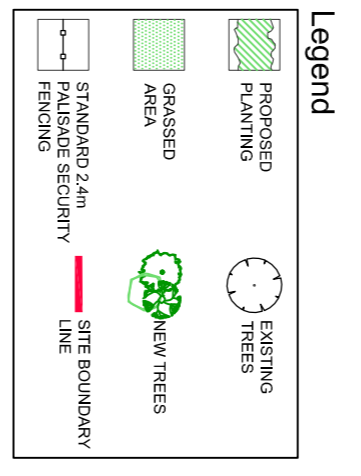

ORIGINAL SITE BOUNDARY AS PER PLANNING APPLICATION LODGED TO WEXFORD COUNTY COUNCIL
 DATE: 23.11.2007
 PLANNING No. 2007/161
 DELINEATES EXTENT OF EPA SUBMISSION SITE

FENCING TO BE CARRIED THROUGH

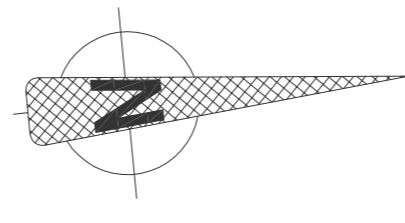

Revisions	description	date	issue
Rev. 01	Issued for Planning Permission	23 Nov 07	PI
	General Changes for RFI information	10 July 08	RFI

stage	date
Planning / RFI	10/07/2008

job title	job no.	drawing no.	rev.
Materials Recovery and Transfer Facility at Clavassa, Enniscorthy, County Wexford for Greenstar Ltd. (Greenstar)	1.375	P-003	Rev.-1

drawn by	scale	date
CO	1:500 (A1)	10.07.2008

drawing title	site Plan in context of OJA Greenstar Landholding
10 Parkmore Road Clavassa, Enniscorthy Co. Wexford Tel: 0906484844 Fax: 01 312 0001	Church Street Newcourt Dublin Road Tel: 045 898 222 Fax: 045 899 700