

DO NOT SCALE - IF IN DOUBT ASK
NOT FOR CONSTRUCTION UNLESS STAMPED ACCURACLY

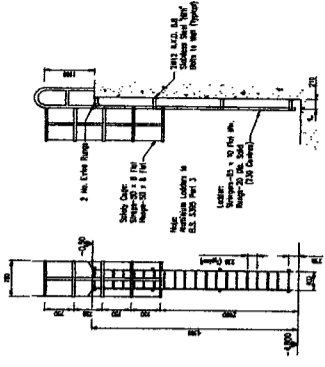

FRONT ELEVATION (SCALE = 1/80)
SIDE ELEVATION (SCALE = 1/80)
TYPICAL LADDER

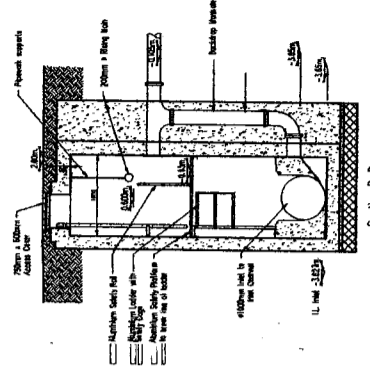
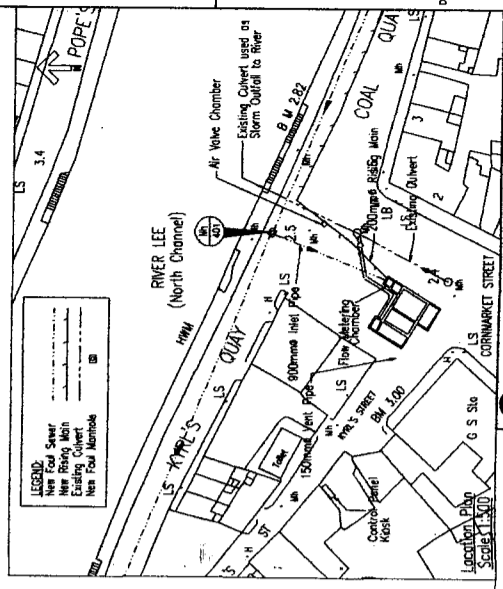
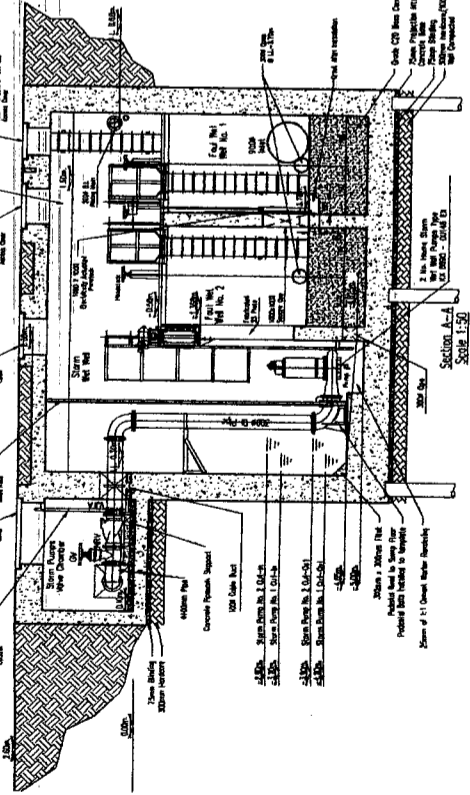
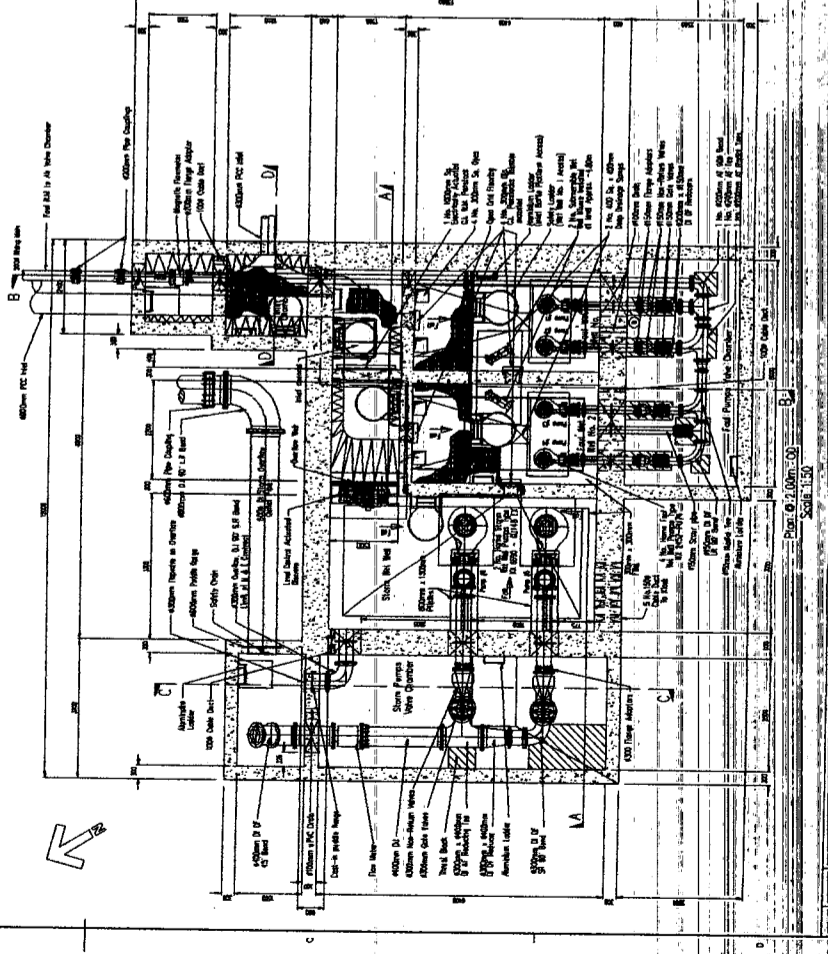
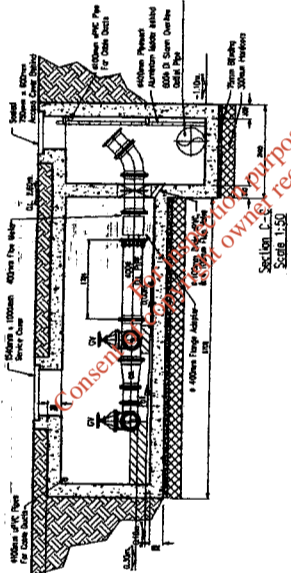
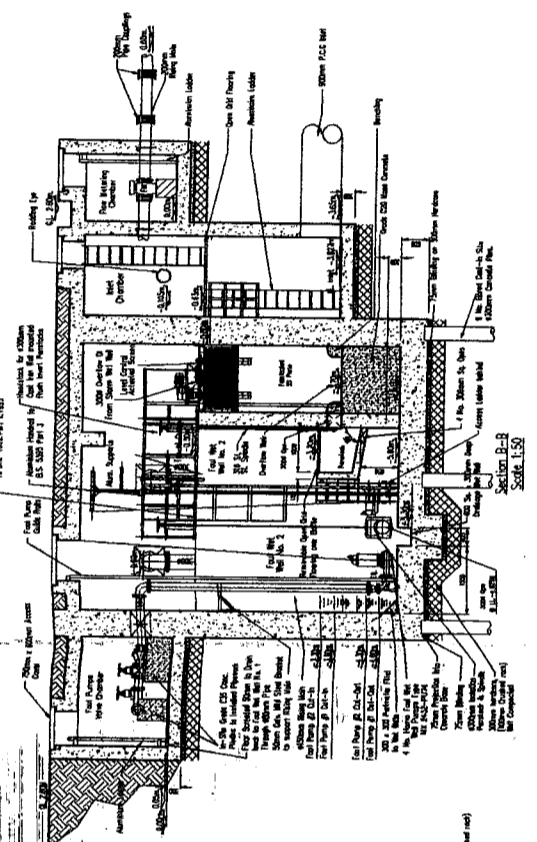

B.G. Peirce & Company
ENGINEERS & ARCHITECTS
11, 13 & 15, MARKET STREET, DUBLIN 1, IRELAND
TELEPHONE: 478, 479, 480, 481, 482, 483, 484, 485, 486, 487, 488, 489, 490, 491, 492, 493, 494, 495, 496, 497, 498, 499, 500
DRAWING TITLE
COAL QUAY PUMPING STATION
GENERAL ARRANGEMENT
CLIENT'S PROJECT
CENTRE ISLAND DRAINAGE
CONTRACT N.1
SCALE
As Shown
JOB NO. AS/SE
DIN. NO. AS/SE-1050-4
DIN. NO. AS/SE-1050-4
DIN. NO. AS/SE-1050-4

REV.	DATE	DESCRIPTION	APPROVED	CLIENT/APP.
1	10/1/50	As Shown	J.P.	B.G. Peirce & Co.
2	10/1/50	As Shown	J.P.	B.G. Peirce & Co.
3	10/1/50	As Shown	J.P.	B.G. Peirce & Co.
4	10/1/50	As Shown	J.P.	B.G. Peirce & Co.
5	10/1/50	As Shown	J.P.	B.G. Peirce & Co.
6	10/1/50	As Shown	J.P.	B.G. Peirce & Co.
7	10/1/50	As Shown	J.P.	B.G. Peirce & Co.
8	10/1/50	As Shown	J.P.	B.G. Peirce & Co.
9	10/1/50	As Shown	J.P.	B.G. Peirce & Co.
10	10/1/50	As Shown	J.P.	B.G. Peirce & Co.
11	10/1/50	As Shown	J.P.	B.G. Peirce & Co.
12	10/1/50	As Shown	J.P.	B.G. Peirce & Co.
13	10/1/50	As Shown	J.P.	B.G. Peirce & Co.
14	10/1/50	As Shown	J.P.	B.G. Peirce & Co.
15	10/1/50	As Shown	J.P.	B.G. Peirce & Co.
16	10/1/50	As Shown	J.P.	B.G. Peirce & Co.
17	10/1/50	As Shown	J.P.	B.G. Peirce & Co.
18	10/1/50	As Shown	J.P.	B.G. Peirce & Co.
19	10/1/50	As Shown	J.P.	B.G. Peirce & Co.
20	10/1/50	As Shown	J.P.	B.G. Peirce & Co.
21	10/1/50	As Shown	J.P.	B.G. Peirce & Co.
22	10/1/50	As Shown	J.P.	B.G. Peirce & Co.
23	10/1/50	As Shown	J.P.	B.G. Peirce & Co.
24	10/1/50	As Shown	J.P.	B.G. Peirce & Co.
25	10/1/50	As Shown	J.P.	B.G. Peirce & Co.

PS20

DO NOT SCALE - IF IN DOUBT ASK
NOT FOR CONSTRUCTION UNLESS STAMPED ACCORDINGLY

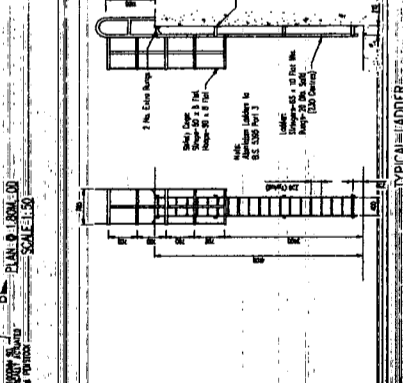
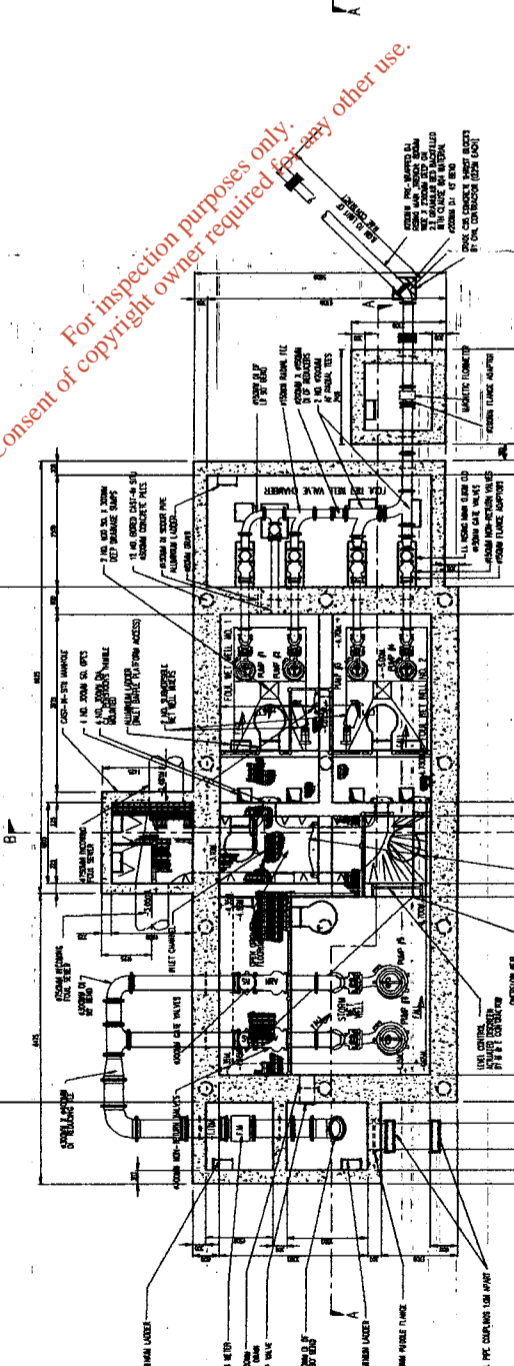
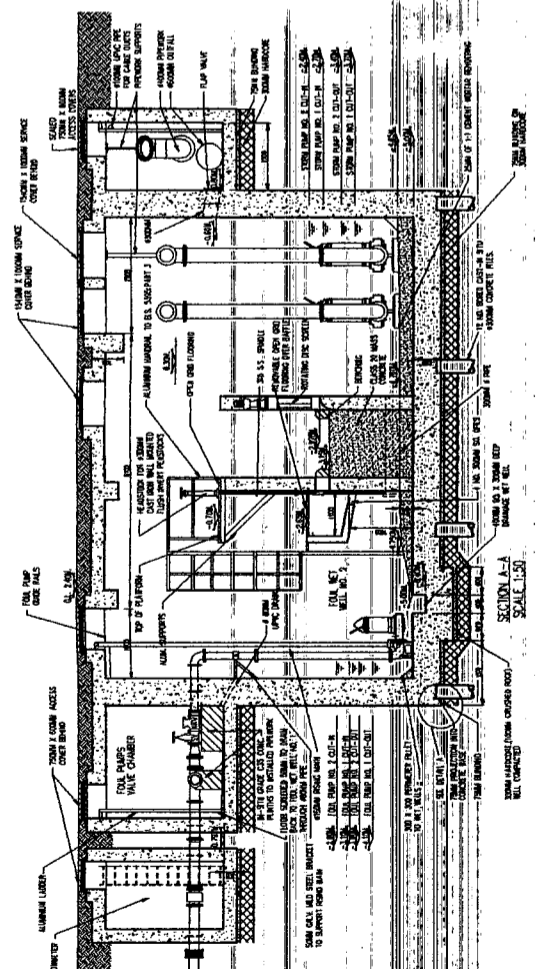
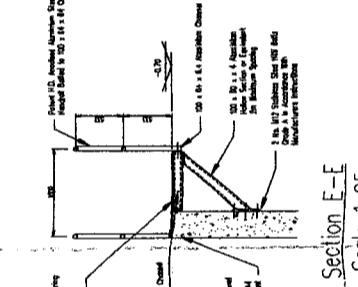
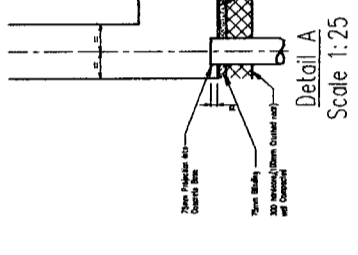
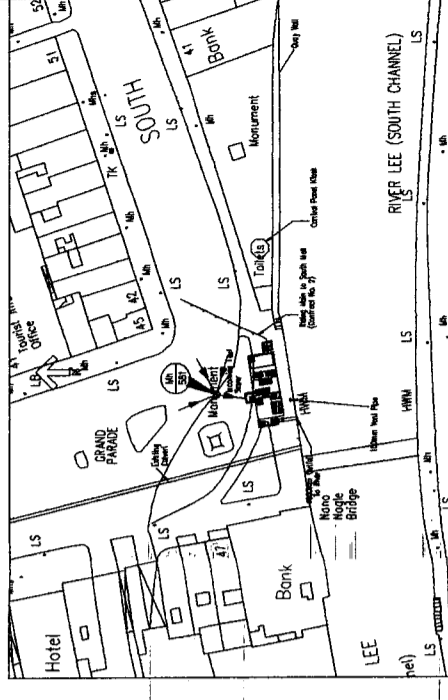
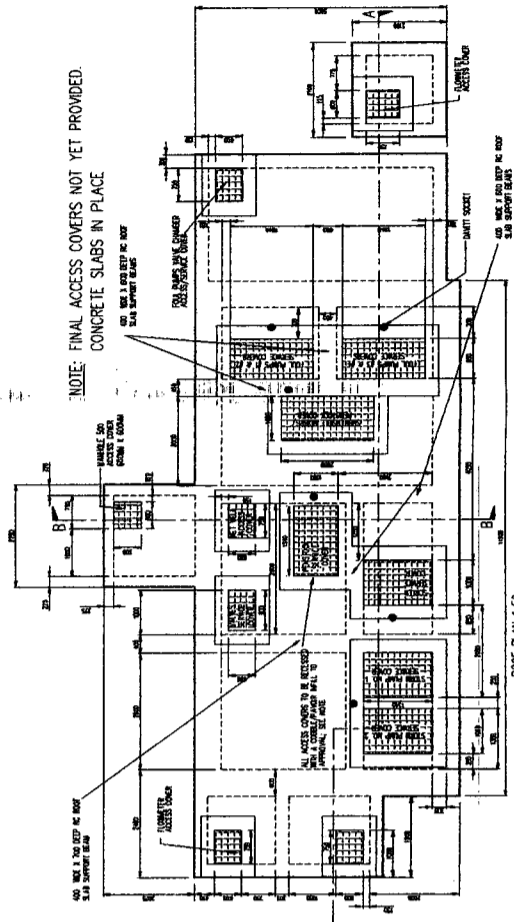
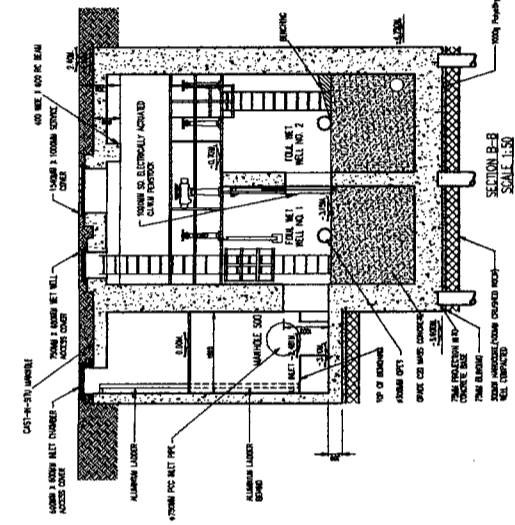
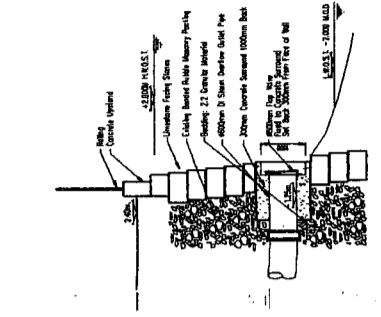

For inspection purposes only.
Consent of copyright owner required for any other use.

B. G. Pettit & Company
ENGINEERS & ARCHITECTS
1000 N. W. 10th St., Ft. Lauderdale, Fla. 33304
TELEPHONE: (305) 463-1111
FACSIMILE: (305) 463-1112

CLIENT & PROJECT
CORK CITY COUNCIL
CORK MAIN DRAINAGE SCHEME
CENTRE ISLAND DRAINAGE
CONTRACT NO. 1

SCALE: As Shown
JOB NO. 4463E
DRAWING TITLE
GENERAL ARRANGEMENT

DWG. NO. 4463E-NIS-2
DOCS. NO. 4630N1E3

NO.	DATE	DESCRIPTION	APPROVED	CHECKED	DESIGNED
1	10/1/79	PRELIMINARY DESIGN			
2	10/1/79	FINAL DESIGN			
3	10/1/79	CONSTRUCTION			
4	10/1/79	AS BUILT			

PS21

DO NOT SCALE - IF IN DOUBT ASK
NOT FOR CONSTRUCTION UNLESS STAMPED ACCORDINGLY

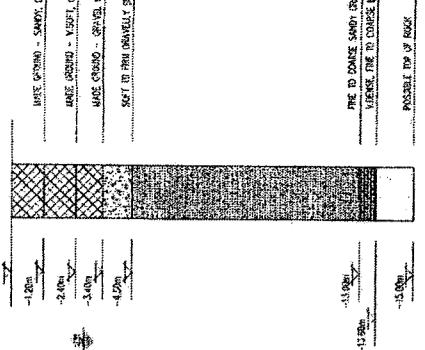

BH B
SHELL & AUGER BOREHOLE

BH C
SHELL & AUGER BOREHOLE

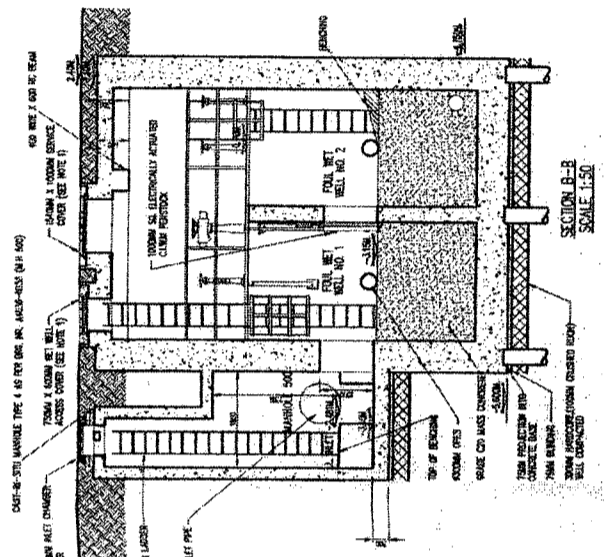

SECTION B-B
SCALE 1:50

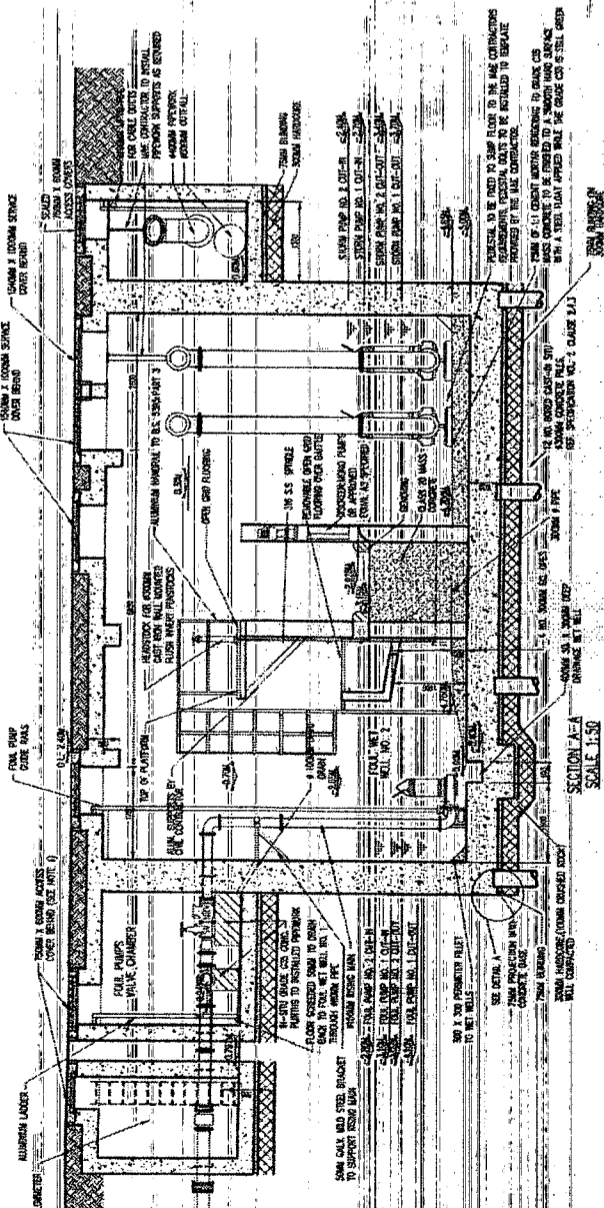

SECTION A-A
SCALE 1:50

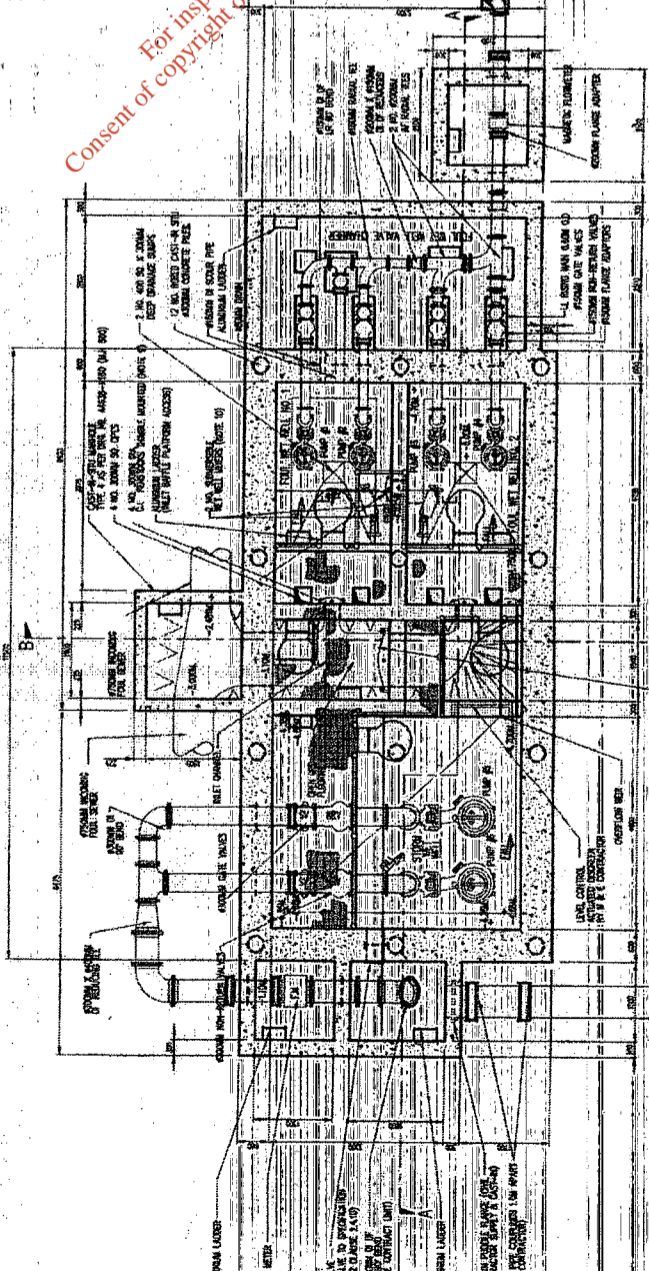

PLAN @ 1.80m (7'0")
SCALE 1:50

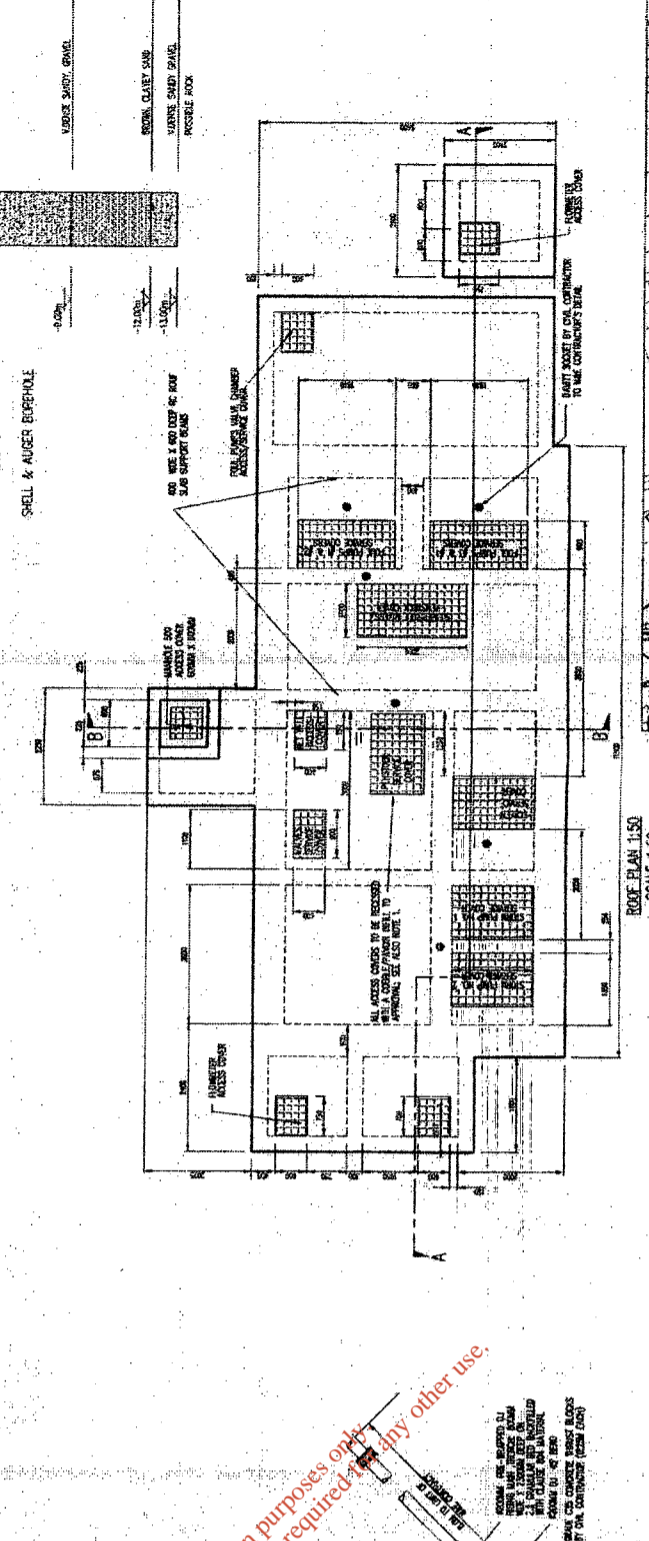

ROOF PLAN 1:50
SCALE 1:50

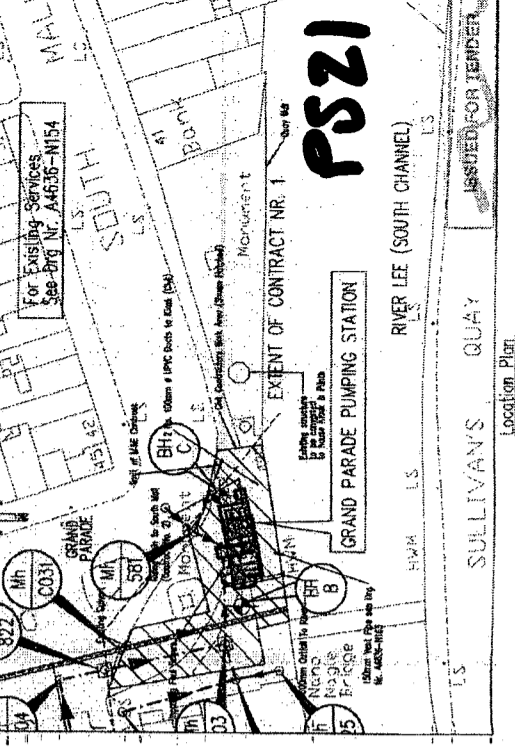

Location Plan
Scale 1:500

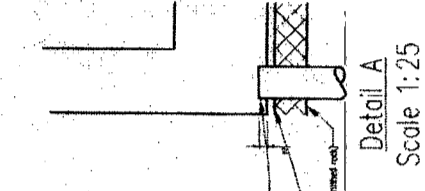

Detail A
Scale 1:25

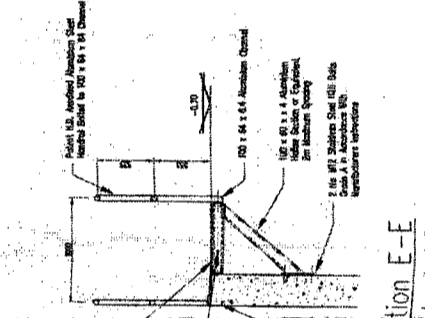

Section E-E
Scale 1:25

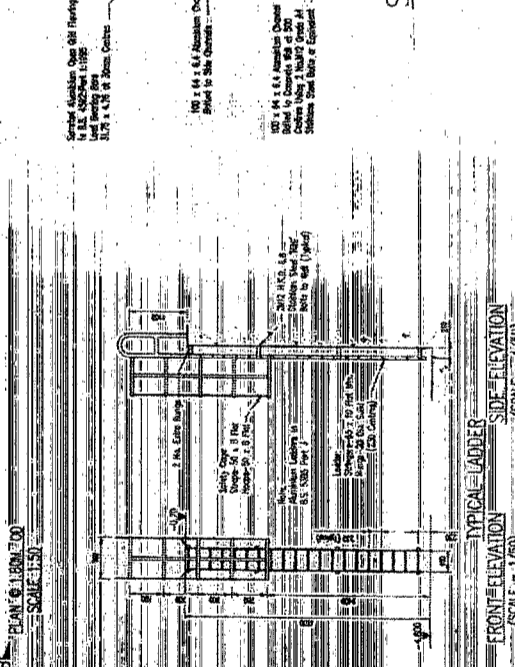

TYPICAL LADDER
SIDE ELEVATION
SCALE 1:25

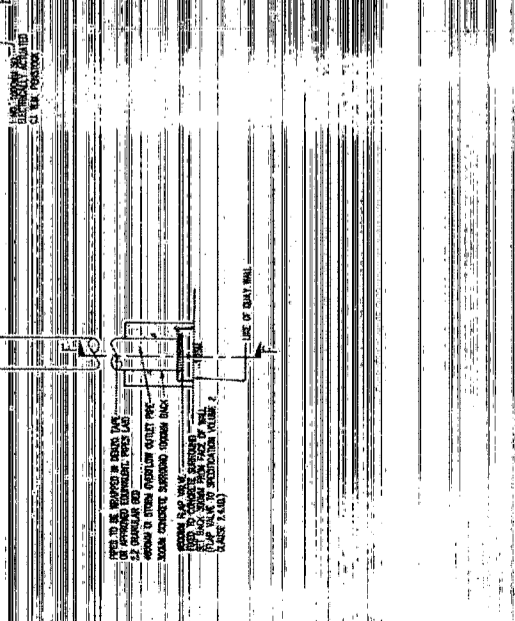

FRONT ELEVATION
SCALE 1:25

Consent of copyright owner required for any other use.
For inspection purposes only

E.G. Pettit & Company
ENGINEERS & ARCHITECTS
100, SOUTH BRIDGE STREET, DUBLIN 7, IRELAND
TEL: 01 454 4444 FAX: 01 454 4445

CLIENT: E.P.O. PROJECT
CAP: 1000 TONNES
CONTRACT NO: 1000

PROJECT: GRAND PARADE PUMPING STATION
GENERAL ARRANGEMENT

PS21

ISSUED FOR TENDER

REVISIONS

NO.	DATE	DESCRIPTION
1	10/01/00	ISSUED FOR TENDER
2	15/01/00	REVISIONS TO DRAWING
3	20/01/00	REVISIONS TO DRAWING
4	25/01/00	REVISIONS TO DRAWING
5	30/01/00	REVISIONS TO DRAWING
6	05/02/00	REVISIONS TO DRAWING
7	10/02/00	REVISIONS TO DRAWING
8	15/02/00	REVISIONS TO DRAWING
9	20/02/00	REVISIONS TO DRAWING
10	25/02/00	REVISIONS TO DRAWING
11	30/02/00	REVISIONS TO DRAWING
12	05/03/00	REVISIONS TO DRAWING
13	10/03/00	REVISIONS TO DRAWING
14	15/03/00	REVISIONS TO DRAWING
15	20/03/00	REVISIONS TO DRAWING
16	25/03/00	REVISIONS TO DRAWING
17	30/03/00	REVISIONS TO DRAWING
18	05/04/00	REVISIONS TO DRAWING
19	10/04/00	REVISIONS TO DRAWING
20	15/04/00	REVISIONS TO DRAWING
21	20/04/00	REVISIONS TO DRAWING
22	25/04/00	REVISIONS TO DRAWING
23	30/04/00	REVISIONS TO DRAWING
24	05/05/00	REVISIONS TO DRAWING
25	10/05/00	REVISIONS TO DRAWING
26	15/05/00	REVISIONS TO DRAWING
27	20/05/00	REVISIONS TO DRAWING
28	25/05/00	REVISIONS TO DRAWING
29	30/05/00	REVISIONS TO DRAWING
30	05/06/00	REVISIONS TO DRAWING
31	10/06/00	REVISIONS TO DRAWING
32	15/06/00	REVISIONS TO DRAWING
33	20/06/00	REVISIONS TO DRAWING
34	25/06/00	REVISIONS TO DRAWING
35	30/06/00	REVISIONS TO DRAWING
36	05/07/00	REVISIONS TO DRAWING
37	10/07/00	REVISIONS TO DRAWING
38	15/07/00	REVISIONS TO DRAWING
39	20/07/00	REVISIONS TO DRAWING
40	25/07/00	REVISIONS TO DRAWING
41	30/07/00	REVISIONS TO DRAWING
42	05/08/00	REVISIONS TO DRAWING
43	10/08/00	REVISIONS TO DRAWING
44	15/08/00	REVISIONS TO DRAWING
45	20/08/00	REVISIONS TO DRAWING
46	25/08/00	REVISIONS TO DRAWING
47	30/08/00	REVISIONS TO DRAWING
48	05/09/00	REVISIONS TO DRAWING
49	10/09/00	REVISIONS TO DRAWING
50	15/09/00	REVISIONS TO DRAWING
51	20/09/00	REVISIONS TO DRAWING
52	25/09/00	REVISIONS TO DRAWING
53	30/09/00	REVISIONS TO DRAWING
54	05/10/00	REVISIONS TO DRAWING
55	10/10/00	REVISIONS TO DRAWING
56	15/10/00	REVISIONS TO DRAWING
57	20/10/00	REVISIONS TO DRAWING
58	25/10/00	REVISIONS TO DRAWING
59	30/10/00	REVISIONS TO DRAWING
60	05/11/00	REVISIONS TO DRAWING
61	10/11/00	REVISIONS TO DRAWING
62	15/11/00	REVISIONS TO DRAWING
63	20/11/00	REVISIONS TO DRAWING
64	25/11/00	REVISIONS TO DRAWING
65	30/11/00	REVISIONS TO DRAWING
66	05/12/00	REVISIONS TO DRAWING
67	10/12/00	REVISIONS TO DRAWING
68	15/12/00	REVISIONS TO DRAWING
69	20/12/00	REVISIONS TO DRAWING
70	25/12/00	REVISIONS TO DRAWING
71	30/12/00	REVISIONS TO DRAWING
72	05/01/01	REVISIONS TO DRAWING
73	10/01/01	REVISIONS TO DRAWING
74	15/01/01	REVISIONS TO DRAWING
75	20/01/01	REVISIONS TO DRAWING
76	25/01/01	REVISIONS TO DRAWING
77	30/01/01	REVISIONS TO DRAWING
78	05/02/01	REVISIONS TO DRAWING
79	10/02/01	REVISIONS TO DRAWING
80	15/02/01	REVISIONS TO DRAWING
81	20/02/01	REVISIONS TO DRAWING
82	25/02/01	REVISIONS TO DRAWING
83	30/02/01	REVISIONS TO DRAWING
84	05/03/01	REVISIONS TO DRAWING
85	10/03/01	REVISIONS TO DRAWING
86	15/03/01	REVISIONS TO DRAWING
87	20/03/01	REVISIONS TO DRAWING
88	25/03/01	REVISIONS TO DRAWING
89	30/03/01	REVISIONS TO DRAWING
90	05/04/01	REVISIONS TO DRAWING
91	10/04/01	REVISIONS TO DRAWING
92	15/04/01	REVISIONS TO DRAWING
93	20/04/01	REVISIONS TO DRAWING
94	25/04/01	REVISIONS TO DRAWING
95	30/04/01	REVISIONS TO DRAWING
96	05/05/01	REVISIONS TO DRAWING
97	10/05/01	REVISIONS TO DRAWING
98	15/05/01	REVISIONS TO DRAWING
99	20/05/01	REVISIONS TO DRAWING
100	25/05/01	REVISIONS TO DRAWING

DO NOT SCALE - IF IN DOUBT ASK
NOT FOR CONSTRUCTION UNLESS STAMPED ACCORDINGLY

PS25

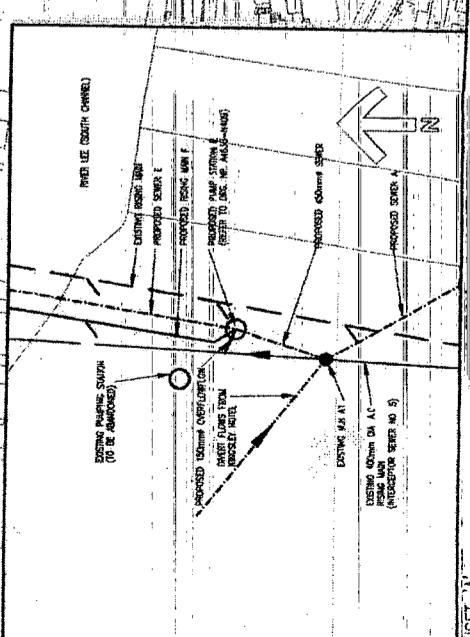
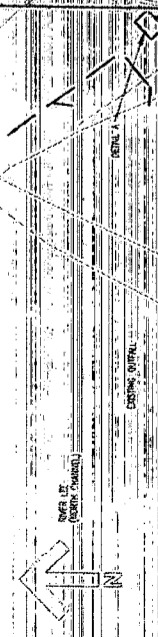

FOR INFORMATION

E. G. Pettit & Company
 ENGINEERS, ARCHITECTS, SURVEYORS, PHOTOGRAMMETRISTS, PLANNERS, COST ESTIMATORS & QUANTITY SURVEYORS
 100 RIVER STREET, MELBOURNE, VIC 3000
 TEL: 03 9412 3100 FAX: 03 9412 3101

CLIENT & PROJECT:
 COX & PARTNERS
 CENTRE ISLAND DRAINAGE
 CONTRACT NO. 2

DRAWING TITLE:
 VICTORIA CROSS
 LAYOUT PLAN

SCALE:
 1:1000
 1:500
 1:200
 1:100

DATE: 15/03/01
 DRAWN BY: [Signature]
 CHECKED: [Signature]
 APPROVED: [Signature]
 CLIENT APP: [Signature]

DESCRIPTION:

1. PRIOR TO THE EXECUTION OF ANY WORKS THE CONTRACTOR SHALL EXECUTE TEST HOLES TO DETERMINE THE PRECISE LOCATION OF THE EXISTING RISING MAIN IN A.C. RISING MAIN INTERSECTOR NO. 5, AND THE EXISTING 150 MM DIAMETER SEWER AND REPORT HIS FINDINGS TO THE ENGINEER. THE LOCATION OF THE EXISTING SEWER AND RISING MAIN SHALL BE RECORDED. ETC. SHALL BE RECORDED.

NOTES:
 1. ALL LEVELS TO MAIN HEAD DATUM
 2. SEE DPG. NO. MACH-10-14 FOR DETAIL A

LEGEND:
 - - - PROPOSED Foul SEWER & MAINS
 - - - EXISTING Foul SEWER
 - - - PROPOSED SURFACE WATER SEWER
 - - - EXISTING SURFACE WATER SEWER
 - - - PROPOSED RISING MAIN
 - - - EXISTING RISING MAIN