

## SECTION B: GENERAL

Advice on completing this section is provided in the accompanying Guidance Note.

### B.1 Applicant's Details\*

#### Name and Address for Correspondence

Only application documentation submitted by the applicant and by the nominated person will be deemed to have come from the applicant.

Provide a drawing detailing the agglomeration to which the licence application relates. It should have the boundary of the agglomeration to which the licence application relates clearly marked in red ink.

<b>Name**:</b>	Cork County Council
<b>Address:</b>	Northern Division
	Annabella
	Mallow
	Co. Cork.
<b>Tel:</b>	022 21123
<b>Fax:</b>	022 21983
<b>e-mail:</b>	frank.cronin@corkcoco.ie

\*This should be the name of the water services authority in whose ownership or control the waste water works is vested.

\*\*Where an application is being submitted on behalf of more than one water services authority the details provided in Section B.1 shall be that of the lead water services authority.

<b>Name*:</b>	Frank Cronin
<b>Address:</b>	Cork Co. Council
	Annabella
	Mallow
	Co. Cork.
<b>Tel:</b>	022 21123
<b>Fax:</b>	022 21983
<b>e-mail:</b>	frank.cronin@corkcoco.ie

\*This should be the name of person nominated by the water services authority for the purposes of the application.

#### Co-Applicant's Details

<b>Name*:</b>	Not Applicable
<b>Address:</b>	
<b>Tel:</b>	
<b>Fax:</b>	
<b>e-mail:</b>	

\*This should be the name of a water services authority, other than the lead authority, where multiple authorities are the subject of a waste water discharge (authorisation) licence application.

## Design, Build & Operate Contractor Details

<b>Name*:</b>	Roadbridge/EPS Ltd.
<b>Address:</b>	IDA Industrial Estate
	Quarertown
	Mallow
<b>Tel:</b>	022 31200
<b>Fax:</b>	022 31250
<b>e-mail:</b>	reception@epsireland.com

\*Where a design, build & operate contract is in place for the waste water works, or any part thereof, the details of the contractor should be provided.

**Attachment B.1** should contain appropriately scaled drawings / maps ( $\leq A3$ ) of the agglomeration served by the waste water works showing the boundary clearly marked in red ink. These drawings / maps should also be provided as geo-referenced digital drawing files (e.g., ESRI Shapefile, MapInfo Tab, AutoCAD or other upon agreement) in Irish National Grid Projection. These drawings should be provided to the Agency on a separate CD-Rom containing sections B.2, B.3, B.4, B.5, C.1, D.2, E.3 and F.2.

Attachment included	Yes	No
	✓	

### B.2 Location of Associated Waste Water Treatment Plant(s)

Give the location of the waste water treatment plant associated with the waste water works, if such a plant or plants exists.

<b>Name*:</b>	Flannan Groarke, Senior Executive Engineer
<b>Address:</b>	Cork Co. Council
	Courthouse Road
	Fermoy
	Co. Cork.
<b>Grid ref (6E, 6N)</b>	
<b>Level of Treatment</b>	TERTIARY
<b>Primary Telephone:</b>	025 31947
<b>Fax:</b>	025 32331
<b>e-mail:</b>	flannan.groarke@corkcoco.ie

\*This should be the name of the person responsible for the supervision of the waste water treatment plant.

**Attachment B.2** should contain appropriately scaled drawings / maps ( $\leq A3$ ) of the site boundary and overall site plan, including labelled discharge, monitoring and sampling points. These drawings / maps should also be provided as geo-referenced digital drawing files (e.g., ESRI Shapefile, MapInfo Tab, AutoCAD or other upon agreement) in Irish National Grid Projection. These drawings should be provided to the Agency on a separate CD-Rom containing sections B.1, B.3, B.4, B.5, C.1, D.2, E.3 and F.2.

Attachment included	Yes	No
	✓	

### B.3 Location of Primary Discharge Point

Give the location of the primary discharge point, as defined in the Waste Water Discharge (Authorisation) Regulation, associated with the waste water works.

<b>Type of Discharge</b>	Piped Discharge
<b>Unique Point Code</b>	SW 1 - Fermoy
<b>Location</b>	WWTP Site at Strawhall
<b>Grid ref (6E, 6N)</b>	E : 182331 N : 098819

**Attachment B.3** should contain appropriately scaled drawings / maps ( $\leq A3$ ) of the discharge point, including labelled monitoring and sampling points associated with the discharge point. These drawings / maps should also be provided as geo-referenced digital drawing files (e.g. ESRI Shapefile, MapInfo Tab, AutoCAD or other upon agreement) in Irish National Grid Projection. This data should be provided to the Agency on a separate CD-Rom containing the drawings and tabular data requested in sections B.1, B.2, B.4, B.5, C.1, D.2, E.3 and F.2.

Attachment included	Yes	No
	✓	

### B.4 Location of Secondary Discharge Point(s)

Give the location of **all** secondary discharge point(s) associated with the waste water works. Please refer to Guidance Note for information on Secondary discharge points.

<b>Type of Discharge</b>	EMERGENCY
<b>Unique Point Code</b>	SW 2 - Fermoy
<b>Location</b>	Pumping Station. WWTP Site, Strawhall
<b>Grid ref (6E, 6N)</b>	E : 182193 N : 098780

<b>Type of Discharge</b>	EMERGENCY
<b>Unique Point Code</b>	SW 3 - Fermoy
<b>Location</b>	Pumping Station at Rathealy Road
<b>Grid ref (6E, 6N)</b>	E : 181462 N : 098719

<b>Type of Discharge</b>	Piped SW including Trade Discharge from MICROBIO
<b>Unique Point Code</b>	SW 4 - Fermoy
<b>Location</b>	Fermoy Bridge North East
<b>Grid ref (6E, 6N)</b>	E : 181232 N : 098624

**Attachment B.4** should contain appropriately scaled drawings / maps ( $\leq A3$ ) of the discharge point(s), including labelled monitoring and sampling points associated with the discharge point(s). These drawings / maps should also be provided as geo-referenced digital drawing files (e.g. ESRI Shapefile, MapInfo Tab, AutoCAD or other upon agreement) in Irish National Grid Projection. This data should be provided to the Agency on a separate CD-Rom containing sections B.1, B.2, B.3, B.5, C.1, D.2, E.3 and F.2.

Attachment included	Yes	No
	√	

### B.5 Location of Storm Water Overflow Point(s)

Give the location of **all** storm water overflow point(s) associated with the waste water works.

<b>Type of Discharge</b>	EMERGENCY
<b>Unique Point Code</b>	SW 2 - Fermoy
<b>Location</b>	Outfall from Pumping Station at WWTP Site.
<b>Grid ref (6E, 6N)</b>	E : 182193 N : 098780

<b>Type of Discharge</b>	EMERGENCY
<b>Unique Point Code</b>	SW 3 - Fermoy
<b>Location</b>	Outfall from Rathealy Road Pumping Station
<b>Grid ref (6E, 6N)</b>	E : 181462 N : 098719

<b>Type of Discharge</b>	Piped Surface Water including Trade Discharge from MICRO BIO.
<b>Unique Point Code</b>	SW 4 - Fermoy
<b>Location</b>	Fermoy Bridge North East
<b>Grid ref (6E, 6N)</b>	E : 181232 N : 098624

<b>Type of Discharge</b>	EMERGENCY – Combined Storm Overflow
<b>Unique Point Code</b>	SW 5 - Fermoy
<b>Location</b>	Fermoy Bridge North East
<b>Grid ref (6E, 6N)</b>	E : 181191 N : 098622

<b>Type of Discharge</b>	EMERGENCY – Combined Storm Overflow
<b>Unique Point Code</b>	SW 6 - Fermoy

<b>Point Code</b>	
<b>Location</b>	Fitzgerald Place
<b>Grid ref (6E, 6N)</b>	E : 181400 N : 098557

<b>Type of Discharge</b>	EMERGENCY – Combined Storm Overflow
<b>Unique Point Code</b>	SW 7 - Fermoy
<b>Location</b>	Fermoy Bridge South East
<b>Grid ref (6E, 6N)</b>	E : 181217 N : 098500

<b>Type of Discharge</b>	EMERGENCY – Combined Storm Overflow
<b>Unique Point Code</b>	SW 8 - Fermoy
<b>Location</b>	Waterloo Lane
<b>Grid ref (6E, 6N)</b>	E : 180936 N : 098498

**Attachment B.5** should contain appropriately scaled drawings / maps ( $\leq A3$ ) of storm water overflow point(s) associated with the waste water works, including labelled monitoring and sampling points associated with the discharge point(s). These drawings / maps should also be provided as geo-referenced digital drawing files (e.g. ESRI Shapefile, MapInfo Tab, AutoCAD or other upon agreement) in Irish National Grid Projection. This data should be provided to the Agency on a separate CD-Rom containing sections B.1, B.2, B.3, B.4, C.1, D.2, E.3 and F.2.

<b>Attachment included</b>	<b>Yes</b>	<b>No</b>
	✓	

### B.6 Planning Authority

Give the name of the planning authority, or authorities, in whose functional area the discharge or discharges take place or are proposed to take place.

<b>Name:</b>	Cork County Council
<b>Address:</b>	Planning Department
	County Hall
	Carrigrohane Road
	Cork.
<b>Tel:</b>	021 4276891
<b>Fax:</b>	021 4867007
<b>e-mail:</b>	planninginfo@corkcoco.ie

Planning Permission relating to the waste water works which is the subject of this application:- (tick as appropriate)

<b>has been obtained</b>	✓	<b>is being processed</b>	
<b>is not yet applied for</b>		<b>is not required</b>	

<b>Local Authority Planning File Reference N<sup>o</sup>:</b>	
---	--

**Attachment B.6** should contain **the most recent** planning permission, including a copy of **all** conditions, and where an EIS was required, copies of any such EIS and any certification associated with the EIS, should also be enclosed. Where planning permission is not required for the development, provide reasons, relevant correspondence, etc.

<b>Attachment included</b>	<b>Yes</b>	<b>No</b>
	✓	

### B.7 Other Authorities

B.7 (i) Shannon Free Airport Development Company (SFADCo.) area

The applicant should tick the appropriate box below to identify whether the discharge or discharges are located within the Shannon Free Airport Development Company (SFADCo.) area.

**Attachment B.7(i)** should contain details of any or all discharges located within the SFADCo. area.

<b>Within the SFADCo Area</b>	<b>Yes</b>	<b>No</b>
		✓

B.7 (ii) Health Services Executive Region

The applicant should indicate the **Health Services Executive Region** where the discharge or discharges are or will be located.

<b>Name:</b>	Health Service Executive
<b>Address:</b>	North Cork Area Headquarters
	Gouldshill House
	Mallow
	Co. Cork.
<b>Tel:</b>	022 30200
<b>Fax:</b>	022 30211
<b>e-mail:</b>	None

B.7 (iii) Other Relevant Local Authorities

Regulation 13 of the Waste Water Discharge (Authorisation) Regulations, 2007 requires all applicants, not being the local authority in whose functional area the relevant waste water discharge or discharges, to which the relevant application relates, takes place or is to take place, to notify the relevant local authority of the said application.

<b>Name:</b>	Not Applicable
<b>Address:</b>	
<b>Tel:</b>	
<b>Fax:</b>	
<b>e-mail:</b>	

<b>Relevant Authority Notified</b>	<b>Yes</b>	<b>No</b>
		✓

**Attachment B.7(iii)** should contain a copy of the notice issued to the relevant local authority.

<b>Attachment included</b>	<b>Yes</b>	<b>No</b>
		✓

### B.8 Notices and Advertisements

Regulations 10 and 11 of the Waste Water Discharge (Authorisation) Regulations, 2007 require all applicants to advertise the application in a newspaper and by way of a site notice. See *Guidance Note*.

**Attachment B.8** should contain a copy of the site notice and an appropriately scaled drawing ( $\leq A3$ ) showing its location. **The original application must include the original page of the newspaper in which the advertisement was placed.** The relevant page of the newspaper containing the advertisement should be included with the original and two copies of the application.

<b>Attachment included</b>	<b>Yes</b>	<b>No</b>
	✓	

### B.9 (i) Population Equivalent of Agglomeration

**TABLE B.9.1 POPULATION EQUIVALENT OF AGGLOMERATION**

The population equivalent (p.e.) of the agglomeration to be, or being, served by the waste water works should be provided and the period in which the population equivalent data was compiled should be indicated.

<b>Population Equivalent</b>	<b>20,000</b>
<b>Data Compiled (Year)</b>	<b>2000</b>
<b>Method</b>	<b>Pollution Load Assessment</b>

### B.9 (ii) FEES

State the relevant Class of waste water discharge as per Column 1 of the Second Schedule, and the appropriate fee as per Columns 2 or 3 of the Third Schedule of the Waste Water Discharges (Authorisation) Regulations 2007, S.I. No. 684 of 2007.

<b>Class of waste water discharge</b>	<b>Fee (in €)</b>
	€30,000

<b>Appropriate Fee Included</b>	<b>Yes</b>	<b>No</b>
	✓	

### B.10 Capital Investment Programme

State whether a programme of works has been prioritised for the development of infrastructure to appropriately collect, convey, treat and discharge waste water from the relevant agglomeration. If a programme of works has been prioritised provide details on funding, (local or national), allocated to the capital project. Provide details on the extent and type of work to be undertaken and the likely timeframes for this work to be completed.

**Attachment B.10** should contain the most recent development programme, including a copy of any approved funding for the project and a timeframe for the completion of the necessary works to take place.

Attachment included	Yes	No
	✓	

### B.11 Significant Correspondence

Provide a summary of any correspondence resulting from a Section 63 notice issued by the Agency in relation to the waste water works under the Environmental Protection Agency Acts, 1992 and 2003, as amended by Section 13 of Protection of the Environment Act, 2003.

**Attachment B.11** should contain a summary of any relevant correspondence issued in relation to a Section 63 notice.

Attachment included	Yes	No
		NONE

### B.12 Foreshore Act Licences.

Provide a copy of the most recent Foreshore Act licence issued in relation to discharges from the waste water works issued under the Foreshore Act 1933.

**Attachment B.12** should contain the most recent licence issued under the Foreshore Act 1933, including a copy of **all** conditions attached to the licence and any monitoring returns for the previous 12-month period, if applicable.

Attachment included	Yes	No NONE

--



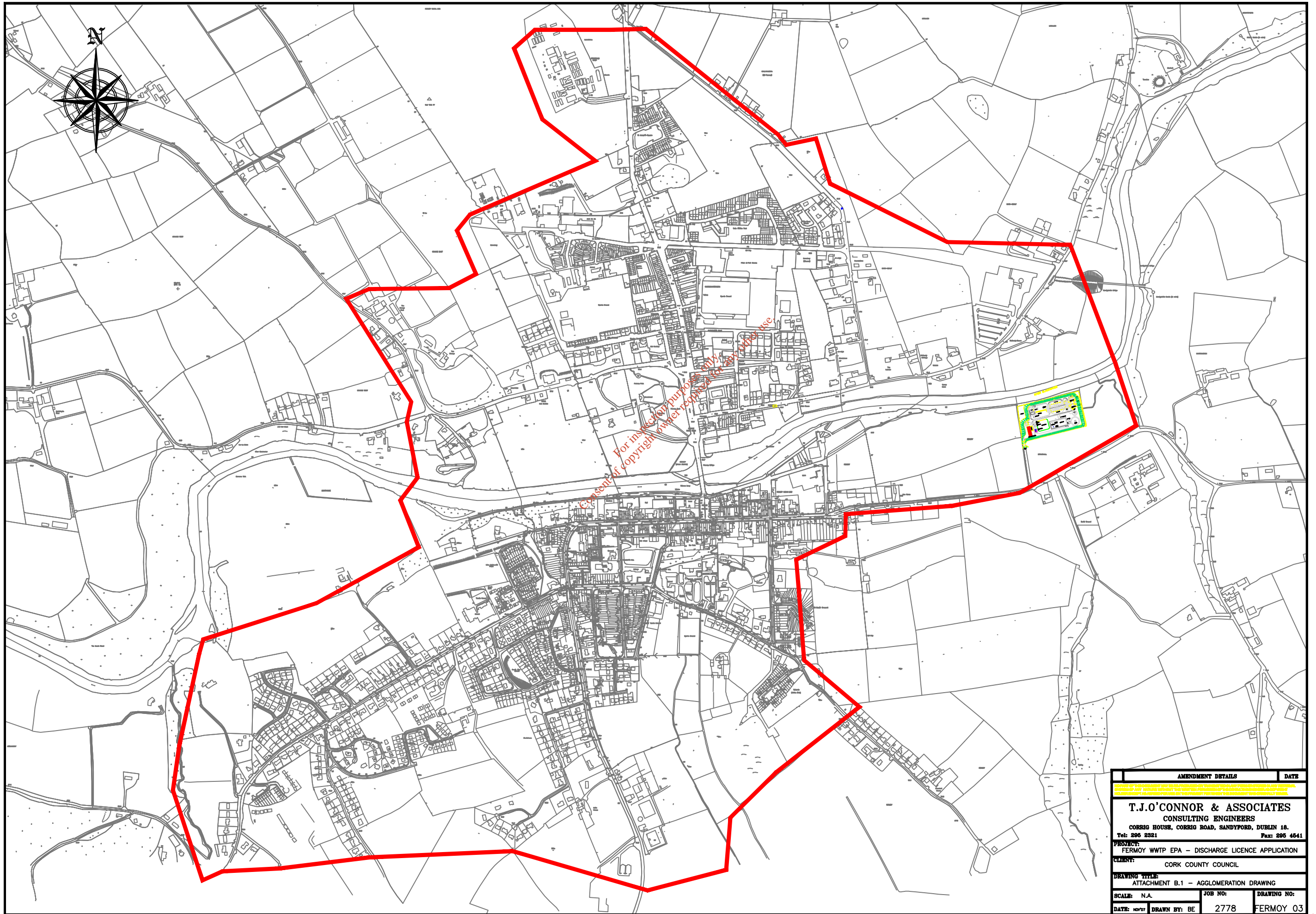

AMENDMENT DETAILS	DATE
T.J.O'CONNOR & ASSOCIATES CONSULTING ENGINEERS CORRIG HOUSE, CORRIG ROAD, SANDYFORD, DUBLIN 18. Tel: 296 2321 Fax: 296 4541	
PROJECT: FERMOY WWTP EPA - DISCHARGE LICENCE APPLICATION	
CLIENT: CORK COUNTY COUNCIL	
DRAWING TITLE: ATTACHMENT B.1 - AGGLOMERATION DRAWING	
SCALE: N.A.	JOB NO:
DATE: NOV'13	DRAWN BY: BE
	2778
	DRAWING NO: FERMOY_Q3



For inspection purposes only.  
Consent of copyright owner required for any other use.

**WASTE WATER  
TREATMENT PLANT  
BOUNDARY**

**WASTE WATER  
TREATMENT PLANT  
E: 182281  
N: 98748**

AMENDMENT DETAILS		DATE
<p><b>T.J.O'CONNOR &amp; ASSOCIATES</b> CONSULTING ENGINEERS CORRIG HOUSE, CORRIG ROAD, SANDYFORD, DUBLIN 18. Tel: 295 2321 Fax: 295 4541</p>		
<p>PROJECT: FERMOYLE WWTP EPA - DISCHARGE LICENCE APPLICATION</p>		
<p>CLIENT: CORK COUNTY COUNCIL</p>		
<p>DRAWING TITLE: ATTACHMENT B.2 - SITE BOUNDARY PLAN</p>		
SCALE: N.A.	JOB NO:	DRAWING NO:
DATE: 10/07	DRAWN BY: BE	2778 FERMOYLE 04

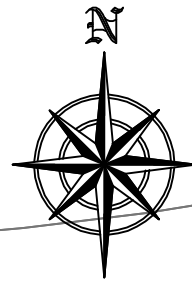

RIVER BLACKWATER

FINAL EFFLUENT SAMPLING POINT - 2  
E: 182201  
N: 98748

INFLUENT SAMPLING POINT-1  
E: 182210  
N: 98766

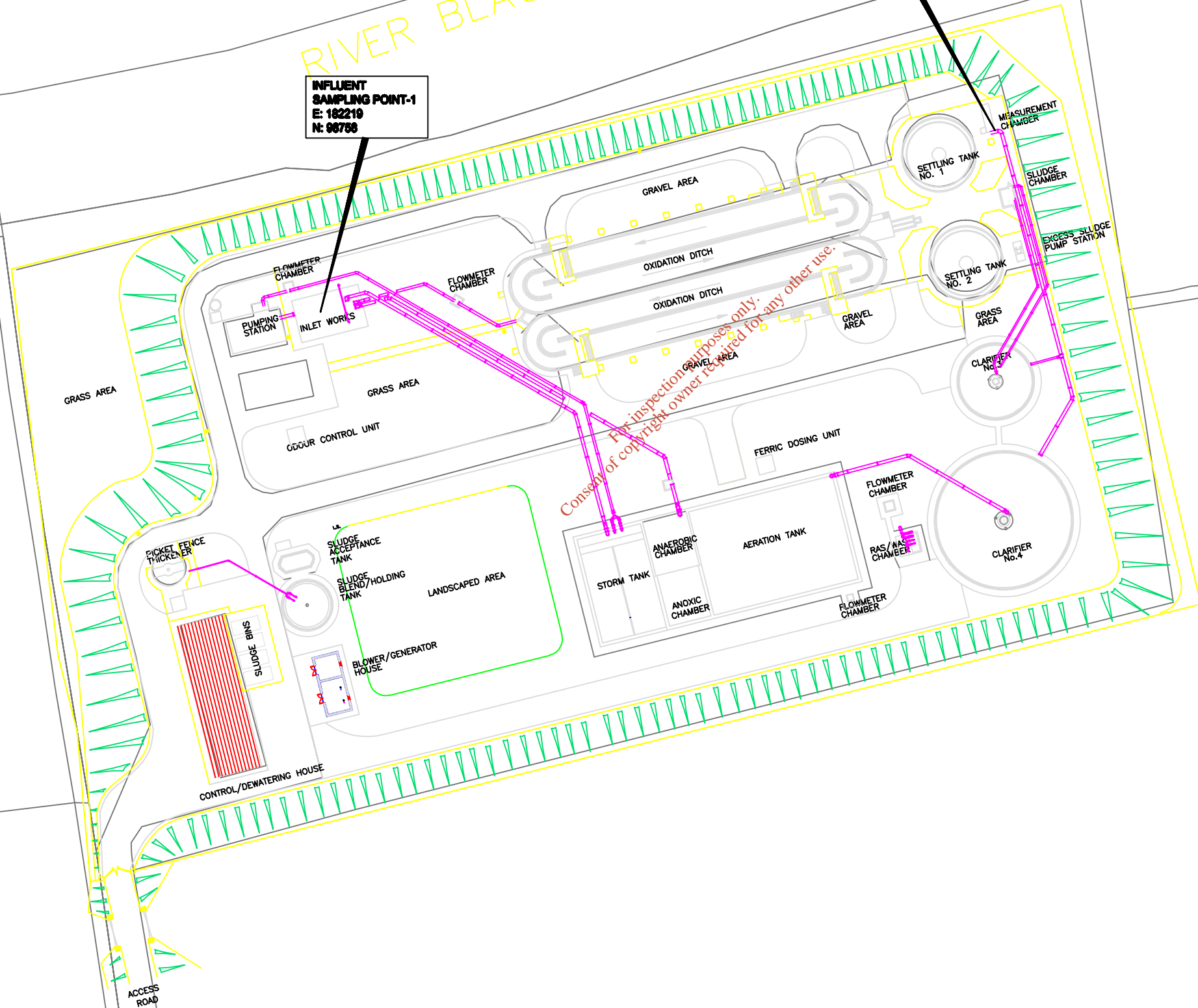

For inspection purposes only.  
Consent of copyright owner required for any other use.

AMENDMENT DETAILS	DATE
<p><b>T.J.O'CONNOR &amp; ASSOCIATES</b> CONSULTING ENGINEERS CORRIG HOUSE, CORRIG ROAD, SANDYFORD, DUBLIN 18. Tel: 296 2321 Fax: 296 4541</p>	
<p>PROJECT: FERMOY WWTP EPA - DISCHARGE LICENCE APPLICATION CLIENT: CORK COUNTY COUNCIL</p>	
<p>DRAWING TITLE: ATTACHMENT B.2 - OVERALL SITE PLAN</p>	
SCALE: N.A.	JOB NO: 2778
DATE: NOV'07	DRAWN BY: BE
	DRAWING NO: FERMOY_05

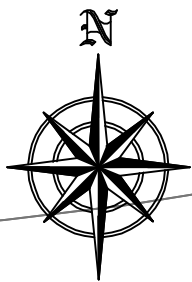

RIVER BLACKWATER

**SW1**  
**FERMOY WWTP**  
**EFFLUENT OUTFALL**  
**(Ø450mm PIPE)**  
**E: 182331**  
**N: 098819**  
**(PRIMARY DISCHARGE POINT)**

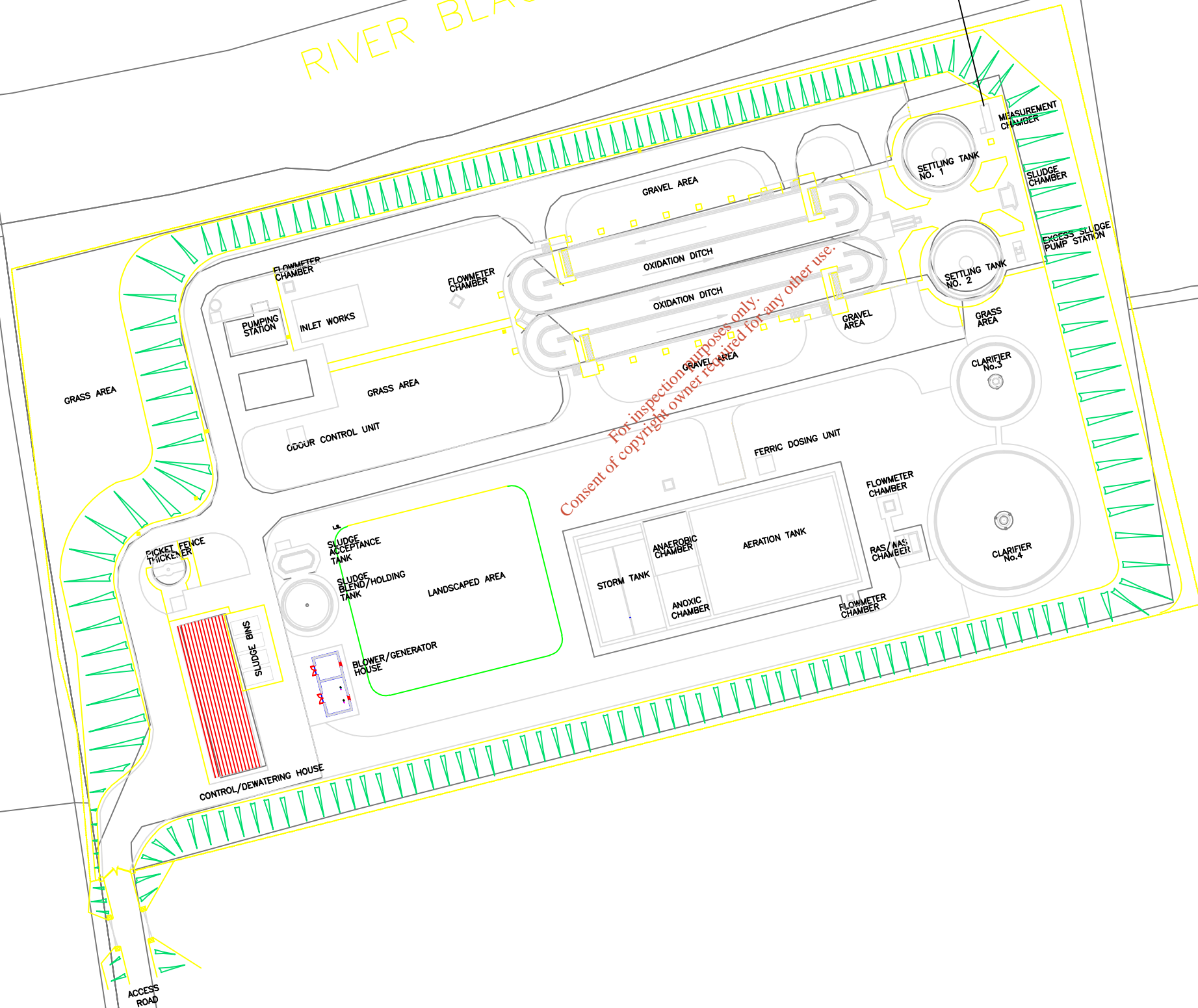

*For inspection purposes only.  
 Consent of copyright owner required for any other use.*

AMENDMENT DETAILS		DATE
<b>T.J.O'CONNOR &amp; ASSOCIATES</b> CONSULTING ENGINEERS		
CORRIG HOUSE, CORRIG ROAD, SANDYFORD, DUBLIN 18. Tel: 295 2321 Fax: 295 4541		
PROJECT: FERMOY WWTP EPA - DISCHARGE LICENCE APPLICATION		
CLIENT: CORK COUNTY COUNCIL		
DRAWING TITLE: ATTACHMENT B.3 - LOCATION OF PRIMARY DISCHARGE POINT		
SCALE: N.A.	JOB NO:	DRAWING NO:
DATE: 10/07	DRAWN BY: BE	2778 FERMOY_06

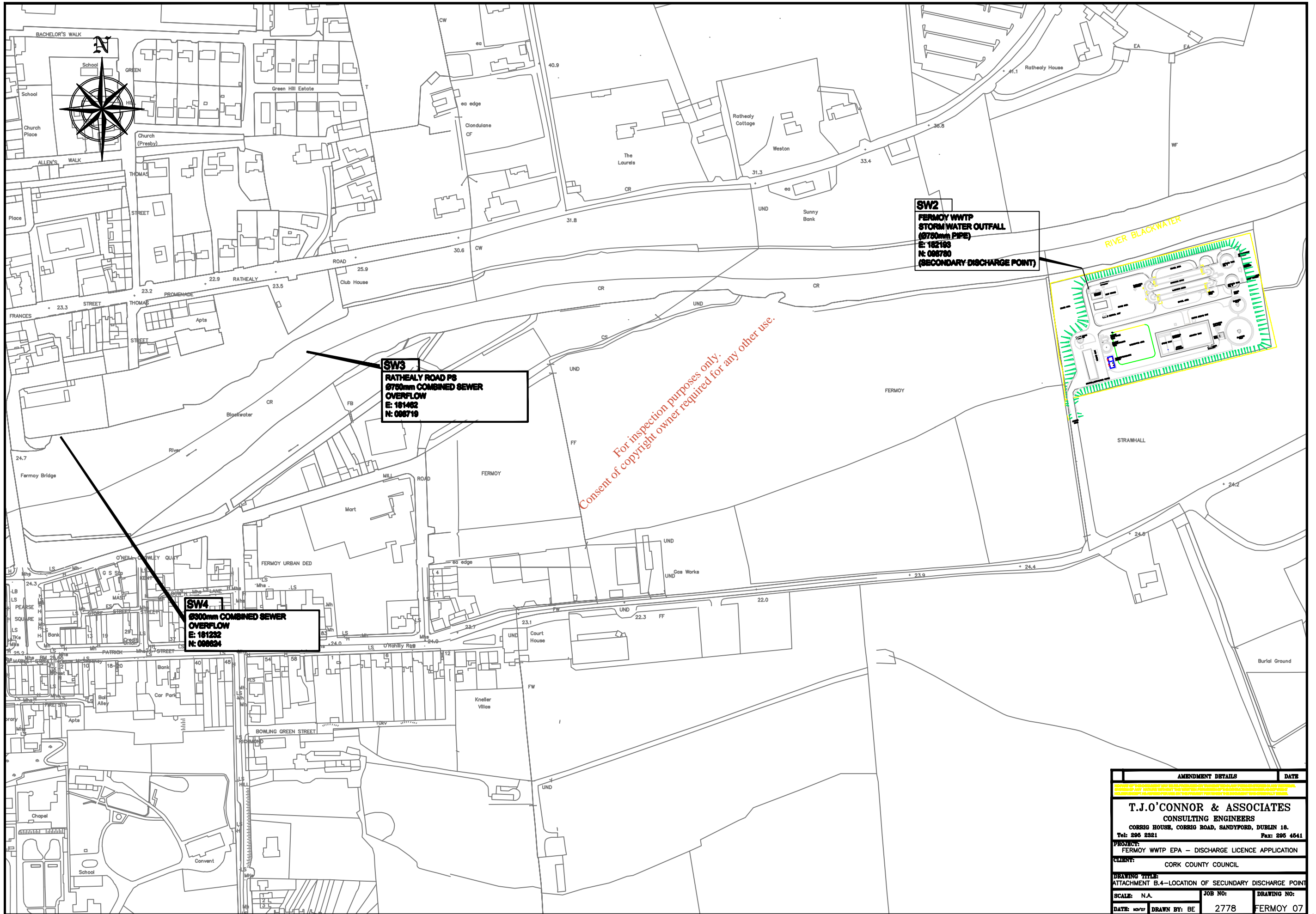

**SW2**  
**FERMOYLE WWTW**  
**STORM WATER OUTFALL**  
**(Ø750mm PIPE)**  
**E: 182193**  
**N: 088780**  
**(SECONDARY DISCHARGE POINT)**

**SW3**  
**RATHEALY ROAD PS**  
**Ø750mm COMBINED SEWER**  
**OVERFLOW**  
**E: 181462**  
**N: 088719**

**SW4**  
**Ø600mm COMBINED SEWER**  
**OVERFLOW**  
**E: 181232**  
**N: 088824**

*For inspection purposes only.  
 Consent of copyright owner required for any other use.*

AMENDMENT DETAILS		DATE
<b>T.J.O'CONNOR &amp; ASSOCIATES</b> CONSULTING ENGINEERS		
CORRIG HOUSE, CORRIG ROAD, SANDYFORD, DUBLIN 18.		
Tel: 295 2321		Fax: 295 4541
PROJECT: FERMOYLE WWTW EPA - DISCHARGE LICENCE APPLICATION		
CLIENT: CORK COUNTY COUNCIL		
DRAWING TITLE: ATTACHMENT B.4-LOCATION OF SECONDARY DISCHARGE POINT		
SCALE: N.A.	JOB NO:	DRAWING NO:
DATE: NOV/07	DRAWN BY: BE	2778 FERMOYLE 07

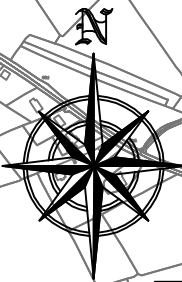

**SW8**  
Ø300mm COMBINED SEWER  
OVERFLOW  
E: 180936  
N: 098498

**SW2**  
FERMOY WWTP  
STORM WATER OUTFALL  
(Ø750mm PIPE)  
E: 182193  
N: 098780  
(SECONDARY DISCHARGE POINT)

**RATHEALY PS**

**SW3**  
RATHEALY ROAD PS  
Ø750mm COMBINED SEWER  
OVERFLOW  
E: 181462  
N: 098719

**SW6**  
Ø450mm COMBINED SEWER  
OVERFLOW  
E: 181400  
N: 098557

**SW4**  
Ø300mm COMBINED SEWER  
OVERFLOW  
E: 181232  
N: 098624

**SW5**  
Ø750mm COMBINED SEWER  
OVERFLOW  
E: 181191  
N: 098622

**SW7**  
Ø375mm COMBINED SEWER  
OVERFLOW  
E: 181217  
N: 098500

AMENDMENT DETAILS		DATE
T.J.O'CONNOR & ASSOCIATES CONSULTING ENGINEERS CORRIG HOUSE, CORRIG ROAD, SANDYPOND, DUBLIN 18. Tel: 295 2321 Fax: 295 4541		
PROJECT: FERMOY WWTP EPA - DISCHARGE LICENCE APPLICATION		
CLIENT: CORK COUNTY COUNCIL		
DRAWING TITLE: ATT. B.5 - COMBINED SEWER OVERFLOWS		
SCALE: N.A.	JOB NO:	DRAWING NO:
DATE: NOV/07	DRAWN BY: BE	2778 FERMOY_08

For inspection purposes only  
Copyright © 2007 T.J.O'Connor & Associates

**ATTACHMENT NO. B.6**  
**RECENT PLANNING PERMISSION & EIS**

*For inspection purposes only.  
Consent of copyright owner required for any other use.*

Fermoy W.W.T.P.

21 June, 2001

**COPY**



Secretary  
Cork County Council  
Annabella  
Mallow  
Co. Cork

Re: Fermoy Sewerage Treatment Plant  
Environmental Impact Statement

A Chara

I am directed by the Minister for the Environment and Local Government, to refer to the application by Cork County Council, Northern Division, to the Minister under Article 123 of the Local Government (Planning & Development) Regulations, 1994, S.I. No. 86 of 1994, for the certification of the expansion and upgrading of the Fermoy Sewage Treatment Works.

In accordance with Article 4(6) of the European Communities (Environmental Impact Assessment) Regulations this application was transferred to An Bord Pleanála. I am now to advise that An Bord Pleanála, has certified that the proposed development will embody the best practicable means to prevent or limit significant adverse effects on the environment, subject to the modification included in the attached Order.

A notice outlining the Board's decision on the application will be published by An Bord Pleanála in the *The Irish Times*, *The Irish Independent*, *The Examiner* and *The Star*.

Mise le meas

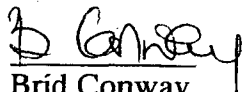
  
Brid Conway  
Water Services Section

Consent of Copyright owner required for reproduction or use.

22 JUN 2001



# An Bord Pleanála

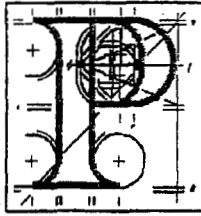

**Local Government (Planning and Development) Regulations, 1994**

**European Communities (Environmental Impact Assessment) Regulations, 2000**

**County Cork**

**WHEREAS** the Council of the County of Cork did, on 12<sup>th</sup> day of October, 2000, make application to the Minister for the Environment and Local Government pursuant to Article 123 of the Local Government (Planning and Development) Regulations, 1994, S.I. No. 86 of 1994, for the certification of the expansion and upgrading of the Fermoy Sewage Treatment Works.

**AND WHEREAS** Article 4(6) of the European Communities (Environmental Impact Assessment) Regulations, 2000, provides that any such application shall be transferred to An Bord Pleanála and the Board shall, in lieu of the Minister, determine the application in accordance with the Local Government (Planning and Development) Regulations, 1994.

**NOW THEREFORE** An Bord Pleanála, pursuant to Articles 119 and 127 of the said Local Government (Planning and Development) Regulations, 1994, hereby certifies that, subject to the modification set out in the schedule hereto, the proposed expansion and upgrading of the Fermoy Sewage Treatment Works will embody the best practicable means to prevent or limit significant adverse effects on the environment.

## SCHEDULE

The proposed extension of the wastewater treatment works shall include phosphorous removal facilities to ensure that the Total P concentration in the final effluent is in accordance with the standards set out in the Second Schedule, Part II, EPA Act, 1992 (Urban Waste Water Treatment) Regulations, 1994.



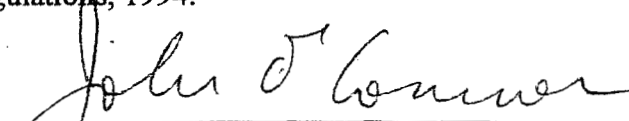

Member of An Bord Pleanála  
duly authorised to authenticate  
the seal of the Board.

Dated this 13<sup>th</sup> day of June 2001.

# CORK COUNTY COUNCIL

## Expansion & Upgrading of Fermoy Sewage Treatment Works

### Publication of Environmental Impact Statement

Notice in accordance with Part IX of the Local Government  
( Planning & Development ) Regulations, 1994

---

Notice is hereby given that Cork County Council, in pursuance of the above Regulations, has prepared an Environmental Impact Statement in respect of the **Expansion & Upgrading of Fermoy Sewage Treatment Works:**

- (a) The proposed development provides for the upgrading and expansion of the existing sewage treatment works located at **Courthouse Road, Fermoy, Co. Cork.**
- (b) (1) Cork County Council proposes to make an application to the Minister for the Environment & Local Government for certification of the proposed development.
- (2) An Environmental Impact Statement has been prepared in respect of the proposed development.
- (3) The Environmental Impact Statement will be available for inspection and for purchase, at **Cork County Council Offices, Annabella, Mallow, Co. Cork and at the offices of Fermoy U.D.C., Courthouse, Fermoy, Co. Cork between the hours of 09.00 – 13.00 and 14.00 – 17.00 during the period 16<sup>th</sup> August 2000 and 19<sup>th</sup> September 2000.**
- (4) Submissions or observations in relation to the effects on the environment of the proposed development may be made in writing to the Minister for the Environment & Local Government, O'Connell Bridge House, Dublin 2, before **16.00 hours on Wednesday 11<sup>th</sup> October 2000.**

**John O'Neill,  
County Secretary,  
Annabella,  
Mallow,  
Co. Cork.  
16<sup>th</sup> August 2000.**

#### **Advertisements:**

The Statutory Public Notices in relation to the publication of the Environmental Impact Statement herein were published in:

- (a) "Irish Examiner" on 16<sup>th</sup> August, 2000.  
(b) "The Avondhu" on 17<sup>th</sup> August, 2000.  
(c) "The Mallow Star" on 17<sup>th</sup> August, 2000.



# CORK COUNTY COUNCIL

## SITE NOTICE

### APPLICATION TO THE ENVIRONMENTAL PROTECTION AGENCY FOR A WASTEWATER DISCHARGE LICENCE

In accordance with the Waste Water Discharge (Authorisation) Regulations 2007, S.I. No. 684 of 2007, Water Services, Cork County Council, Annabella, Mallow is applying to the Environmental Protection Agency for a Waste Water Discharge Licence for Fermoy Waste Water Treatment Plant, Courthouse Road, Fermoy at the following locations:

Plant Name	Location	National Grid Ref.
Fermoy WWTP	Courthouse Road, Fermoy. Townland Of Strawhall	E182283 N098765

Discharge	Function	Townland	Receptor	Grid Reference
Primary	Main	Strawhall	Blackwater	E182331 N098819
Secondary	Emergency	Strawhall	Blackwater	E182193 N098780
Secondary	Emergency	Carrignagroghera	Blackwater	E181462 N098719
Secondary	SW+Trade	Carrignagroghera	Blackwater	E181232 N098624
Secondary	Emergency	Carrignagroghera	Blackwater	E181191 N098622
Secondary	Emergency	Fermoy	Blackwater	E181400 N098557
Secondary	Emergency	Fermoy	Blackwater	E181217 N098500
Secondary	Emergency	Fermoy	Blackwater	E180936 N098498

It is intended to submit the Environmental Impact Statement associated with the recently completed upgrading of the Waste Water Treatment Plant to the Agency along with the Application.

A copy of the application for the Waste Water Discharge Licence, the Environmental Impact Statement and such further information relating to the application as may be furnished to the Agency in the course of the Agency's consideration of the Application shall as soon as is practicable after receipt by the Agency be available for inspection or purchase at the

- Environmental Protection Agency, PO Box 3000, Johnstown Castle Estate, Co. Wexford, Lo Call 1890 335599 Telephone: 053-9160600 Fax: 053-9160699  
Email: info@epa.ie  
and at
- Cork County Council Offices, Annabella, Mallow, Co. Cork, Telephone: 022 21123 Fax: 022 21983.

Submissions in relation to the application may be made to the Environmental Protection Agency at its headquarters described above.

## Clarification of Newspaper Advertisement

Plant Name	Location	National Grid Ref.
Fermoy WWTP	Courthouse Road, Fermoy Townland Of Strawhall	E182283 N098765

Discharge	Function	Townland	Receptor	Grid Reference	Refers to
Primary	Main	Strawhall	Blackwater	E182331 N098819	SW1 in Section B3
Secondary	Emergency	Strawhall	Blackwater	E182193 N098780	SW2 in Section B4
Secondary	Emergency	Carrignagroghera	Blackwater	E181462 N098719	SW3 in Section B4
Secondary	SW+Trade	Carrignagroghera	Blackwater	E181232 N098624	SW4 in Section B4
Secondary	Emergency	Carrignagroghera	Blackwater	E181191 N098622	SW5 in Section B5
Secondary	Emergency	Fermoy	Blackwater	E181400 N098557	SW6 in Section B5
Secondary	Emergency	Fermoy	Blackwater	E181217 N098500	SW7 in Section B5
Secondary	Emergency	Fermoy	Blackwater	E180936 N098498	SW8 in Section B5

# **ATTACHMENT No B.9(iii)**

**FEE**

*For inspection purposes only.  
Consent of copyright owner required for any other use.*

Mr. Barry Doyle,  
A/Assistant Staff Officer,  
Finance Department.

27<sup>th</sup> November, 2007.

**Re: Request for Paying Order**  
**Environmental Protection Agency**

I would be obliged if you would draw down the following Paying Order.

Payee	Amount	Code	Reason
Environmental Protection Agency, Accounts Section, PO Box 3000, Johnstown Castle Estate, Co. Wexford.	€60,000	600 4086	Fee for EPA Licences - Mallow and Fermoy.

JW  
JUNE WHYTE,  
SENIOR STAFF OFFICER,  
WATER SERVICES DEPARTMENT,  
Tel. (022) 54806  
E-mail: [june.white@corkcoco.ic](mailto:june.white@corkcoco.ic)

**ATTACHMENT NO. B.10**  
**DEVELOPMENT PROGRAMME INCLUDING**  
**COPIES OF APPROVED FUNDING.**

**Note: UPGRADING WORKS COMPLETED**

*For inspection purposes only.  
Consent of copyright owner required for any other use.*

Fermoy W.W.T.P.

8<sup>th</sup> July, 2004.

Ms. Mary Kelly,  
Finance Department,  
Cork County Council,  
Annabella,  
Mallow,  
Co. Cork.

AN ROINN COMHSHAOIL

AGUS RIALTAIS AITIUIL

DEPARTMENT OF

THE ENVIRONMENT AND

LOCAL GOVERNMENT

BLOC 1, URLAR 2

FOIRGNIMH IRISH LIFE

SP. NA MAINISTREACH IOCHT.

BAILE ATHA CLIATH 1

BLOCK 1, FLOOR 2

IRISH LIFE CENTRE

LOWER ABBEY STREET

DUBLIN 1

Tel No: +353 1 888 2000

LoCall No: 1890 20 20 21

Fax No: +353 1 888 2687

**Re: Mallow/Blarney/Fermoy Sewage Treatment Works Imp. Scheme (SLI).**

A Chara,

I refer to your recent letter and enclosures in respect of the above scheme.

The Department has examined the Baseline Planning and Construction Costs outlined in the Form As for the works appropriate to the Exchequer element (i.e. "Other 43.74%") of the project and I am to convey approval to the budget outlined in the attached spreadsheet.

In accordance with Circular L11/01 recoupment by the Department will be limited to 60% of the approved costs, pending receipt and approval of a report on the application of the Polluter Pays Principle to this scheme.

Please note that the prior sanction of the Department is required if claiming payment for costs, which do not form part of the approved costs.

If you have any queries relating to the above, please contact the undersigned at (01) 888 2095.

Mise le meas,

  
Martina Gallagher,  
Water Services Section,  
Environment Infrastructure and  
Services Division.



**Mallow/Blarney/Fermoy Sewage Treatment Works Imp Scheme**

	Approved Cost	97.5% Approved Costs	Total Drawn to Date	Balance Outstanding	Payable	Date	Comment
<b>1. Planning and Design Costs</b>							
Preliminary Report	€0.00	n/a	€0.00	€0.00			
EIS	€43,740.00	n/a	€0.00	€43,740.00			
Contract Documents	€140,000.00	n/a	€0.00	€140,000.00			
Tender Preparation	€0.00	n/a	€0.00	€0.00			
Publicity & Advertising	€5,000.00	n/a	€0.00	€5,000.00			
Legal Expenses	€10,000.00	n/a	€0.00	€10,000.00			
Archaeological Costs	€0.00	n/a	€0.00	€0.00			
Licensing/Planning Application	€50,000.00	n/a	€0.00	€50,000.00			
Sub-total (1)	€248,740.00		€0.00	€248,740.00			
<b>2. Construction Costs</b>							
Contract 1 (Design/Build)	€4,414,572.00	€4,304,207.70	€220,728.00	€4,083,479.70			
Site Supervision							
Resident Engineer	€300,000.00	n/a	€0.00	€300,000.00			
Consultant (Supervision)	€100,000.00	n/a	€0.00	€100,000.00			
Project Management	€10,000.00	n/a	€0.00	€10,000.00			
Legal Expenses	€5,000.00	n/a	€0.00	€5,000.00			
Other (Specify) - Polluter Pays Policy Reports	€15,000.00	n/a	€0.00	€15,000.00			
Sub-total (2)	€4,844,572.00	€4,304,207.70	€220,728.00	€4,513,479.70			
Overall total (1+2)	€5,093,312.00		€220,728.00				
Minus 2.5% Final Account (Contract Costs only)	€110,364.30						
Minus Polluter Pays Principle - 40%	€2,037,324.80						
Total Approved Grant	€2,945,622.90		€220,728.00	€2,724,894.90			
Latest claim 03/12/03							
<b>Contract 1 - Total drawn to date includes 5% contract signing</b>							

Consent of contractor for any work to be carried out under the contract

# Cork

## Water Services Investment Programme 2004 - 2006

### Schemes at Construction

	W/S	Est. Cost.
Cork Main Drainage (Treatment)	S	99,400,000
Cork Water Strategy Study	W	1,340,000
		<b>100,740,000</b>

### Schemes to start 2004

Cobh/Midleton/Carrigtwohill Water Supply Scheme	W	9,650,000
Cork City (Tivoli) Water	W	2,000,000
Cork Lower Harbour Sewerage Scheme	S	70,000,000
Kinsale Sewerage Scheme	S	19,600,000
Little Island Sewerage Scheme	S	1,700,000
Midleton Sewerage Scheme (Nutrient Removal)	S	140,000
Mitchelstown Sewerage Scheme (Nutrient Removal)	S	210,000
		<b>103,300,000</b>

### Schemes to start 2005

Ballincollig Sewerage Scheme (Nutrient Removal)	S	900,000
Ballyvourney/Ballymakeery Sewerage Scheme	S	2,900,000
Bandon Sewerage Scheme Stage II	S	14,000,000
Bantry Sewerage Scheme	S	6,800,000
Bantry Water Supply Scheme	W	14,250,000
Cork NW Regional Water Supply Scheme	W	5,750,000
Dunmanway Sewerage Scheme	S	2,050,000
Inniscarra Water Treatment Plant Extension Phase 1	W	2,550,000
Lee Road Waterworks	W	15,000,000
Mallow Sewerage Scheme	S	5,150,000
Mallow/Ballyvinter Regional Water Supply Scheme	W	8,250,000
Schull Water Supply Scheme	W	5,000,000
Shanakiel Rising Main Replacement	W	1,700,000
Skibbereen Sewerage Scheme	S	13,100,000
		<b>97,400,000</b>

### Schemes to start 2006

Clonakilty Sewerage Scheme (Plant Capacity Increase)	S	3,500,000
Cork NE Water Supply Scheme	W	4,120,000
Courtmacsherry/Timoleague Sewerage Scheme	S	2,350,000
Dunmanway Regional Water Supply Scheme Stage 1	W	12,100,000
Leap Water Supply Scheme	W	3,500,000
Shanakiel Reservoir	W	4,400,000
Youghal Sewerage Scheme	S	13,700,000
		<b>43,670,000</b>

### Schemes approved to complete planning

Ballingeary Sewerage Scheme	S	850,000
Ballydehob Sewerage Scheme	S	650,000
Baltimore Water Supply Scheme	W	2,450,000
Cork Sludge Management	S	13,700,000
Docklands Surface Water Drainage	S	5,000,000
Docklands Water Supply Scheme	W	5,100,000
Garrettstown Sewerage Scheme	S	2,050,000
Inniscarra (Sludge Treatment) Water	W	5,100,000
Millstreet Wastewater Treatment Plant Upgrading	S	1,550,000
Minane Bridge Water Supply Scheme	W	1,350,000
Roscarberry/Owenahincha Sewerage	S	1,500,000
Shannagarry/Garryvoe/Ballycotton Sewerage Scheme	S	3,600,000
		<b>42,900,000</b>

### Serviced Land Initiative

Ballincollig, Barry's Rd Foul and Storm Drainage	S	1,109,300
Ballyclough Water	W	132,100
Ballyhooley Services Extension	W/S	132,100
Ballyvinter Water Stage 2	W	145,300
Belgooley Water and Sewerage	W/S	1,056,400
Blackrock Improvement in Services	S	158,100

	W/S	Est. Cost.
Blarney Water Supply Extension to Station Rd	W	396,100
Bweeng Water	W	105,700
Carrigtwohill Sewerage Treatment and Storm Drain	S	7,263,400
Castletownshend Sewerage Scheme	S	1,500,000
Churchtown Water/Sewerage	W/S	396,100
Clondulane Sewerage Treatment Plant	S	198,100
Dripsey Water and Sewerage	W/S	1,056,500
Enniskeane Sewerage Scheme	S	438,500
Freemount Sewerage	S	132,100
Glounthane Sewerage Scheme	S	1,500,000
Innishannon Sewerage	S	264,100
Innishannon Sewerage Treatment Plant	S	660,300
Kerryriple Sewage Disposal	S	792,300
Kerryriple Water Supply Scheme	W	396,200
Kildorrery Storm Water Drainage	S	132,100
Killeagh Water and Sewerage	W/S	462,200
Kilnagleary Sewerage	S	660,300
Kinsale Water Supply - Commoge	W	88,400
Mallow/Fermoy/Blarney STW - Stormwater Tanks Capacity Increase	S	10,092,800
Mid Glanmire Road Improvement in Services	S	158,500
Mitchelstown (Brigown Road) Services	S	132,100
Newmarket Sewerage Scheme Improvement	S	79,200
Rathoomac Services Extension	W/S	528,200
Sally's Cross Sewerage	S	105,700
Shanballymore Sewerage	S	264,100
Uplands Fermoy Servicing of Lands	W/S	396,100
Watergrasshill Water and Sewerage	W/S	3,952,000
		<b>34,884,400</b>

### Rural Towns & Villages Initiative

Ballylicky Sewerage Scheme	S	2,050,000
Baltimore Sewerage Scheme	S	3,650,000
Buttevant Sewerage Scheme	S	4,950,000
Castletownbere Sewerage Scheme	S	4,950,000
Doneraile Sewerage Scheme	S	2,480,000
Innishannon (Ballinadee/Ballinspittle/Garrettstown) Water Supply Scheme	W	6,400,000
Kilbrin Sewerage Scheme	S	1,410,000
Schull Sewerage Scheme	S	3,350,000
		<b>29,240,000</b>

### Water Conservation Allocation

**25,235,000**

### Existing Programme Total

**477,369,400**

### Schemes Approved to Enter Planning

Ballincollig Sewerage Scheme Upgrade	S	21,200,000
Banteer/Dromahane Regional Water Supply	W	1,500,000
Bantry Regional Water Supply (Distribution) Scheme	W	9,000,000
Cape Clear Water Supply Scheme	W	1,600,000
Castletownbere Regional Water Supply Scheme	W	8,000,000
City Environs (GASP) Drainage Study	S	150,000
Cloghroe Sewerage Scheme Upgrade	S	650,000
Coachford Water Supply Scheme	W	1,250,000
Conna Regional Water Supply Scheme Extension	W	2,500,000
Drainage Telemetry/Monitoring System (Cork City)	S	800,000
Intermediate Level Reservoir Augmentation (Cork City)	W	5,000,000
Mitchelstown North (Galtees) Water Supply Scheme	W	3,000,000
Newmarket Sewerage Scheme	S	3,000,000
Skibbereen Regional Water Supply Scheme Stage 4	W	7,500,000
		<b>65,150,000</b>

### Programme Total

**542,519,400**

**ATTACHMENT NO. B.11**  
**RELEVANT CORRESPONDENCE ISSUED**  
**IN RELATION TO A SECTION 63**  
**NOTICE – NOT APPLICABLE**

*For inspection purposes only.  
Consent of copyright owner required for any other use.*

**ATTACHMENT NO. B.12**  
**NOT APPLICABLE**

*For inspection purposes only.  
Consent of copyright owner required for any other use.*