

**For the Attention of**  
Waste Licensing Section  
Environmental Protection Agency  
PO Box 3000  
Johnstown Castle Estate  
Co. Wexford

Our Ref.: W0129-02/LOD/220108  
Direct Dial: 01 802 0523  
Direct Fax: 01 802 0525  
Mobile: 086 8333724  
e-mail: louise.odonnell@pateltonra.com  
Date: 22<sup>nd</sup> January 2008

Dear Sir/Madam,

Waste Licence:	W0129-02 Hollywood Great
Re.:	Your Letter of 4 <sup>th</sup> Jan 2008 - Objection to Proposed Decision, Licence Register W0129-02 submitted by Nevitt Lusk Action Group
Enclosed Docs:	Proposed new road layout (Source: Nevitt Landfill EIS)

Thank you for your letter of 4<sup>th</sup> January 2008, enclosing an objection received by the Agency in relation to the Proposed Decision for Hollywood, W0129-02. The signatory to the objection, received by the Agency on 2<sup>nd</sup> January 2008, was Mr John Shortt, for and on behalf of Nevitt Lusk Action Group. Murphy Environmental wishes to make the following observations in relation to Mr Shortt's submission:

#### **Fingal County Council Proposed Landfill**

1. Murphy Environmental acknowledges Fingal County Council's application for a *non-hazardous*, municipal waste landfill. The Murphy Environmental Hollywood facility is an *inert* waste facility and services an entirely different need in local and national waste infrastructure.

#### **A&P Tipper Facility, Baldarragh**

2. A&P Tipper operates a permitted facility in proximity to the Hollywood EPA-licensed facility. The A&P Tipper facility is regulated by Fingal County Council, and is wholly unrelated to the Murphy Environmental, Hollywood facility. The following information pertaining to the A&P Tipper Facility is recorded on the Fingal County Council website:
  - Planning Permission for the site was granted on the 01/02/2005 for:  
*'Carrying out a land recovery operation wherein inert soil and topsoil complying with class 10 of the fourth schedule of the Waste Management Act shall be imported and spread on site with a consequential benefit for agricultural activity on the lands. The works include for the provision of a entrance, access road, a temporary site hut and septic tank, a wheelwash and associated works'*
  - Waste permit number WPT 60 was granted on 30/06/2004 for 36 months
  - A second waste permit, WPT 123, was granted 09/05/2007 for 36 months
  - No further planning permission applications pertaining to the site are outlined in the Fingal County Council planning applications.
3. At the time of lodging the Murphy Environmental EIS (February 2007), the Baldarragh site was due for imminent closure.

### **Proposed Incoming Tonnages to Hollywood under W0129-02**

4. The proposed tonnage of incoming material is 500,000 tonnes per annum.
5. The proposed increase in tonnages has been driven by demand and the requirements for a strategic inert waste facility in the Dublin Region. The increased rate of filling will facilitate the restoration of the site in line with planning permission requirements.
6. Full details of predicted noise and air pollution impacts (all of which were in compliance with the relevant and appropriate national and/or international legislation and guidance) were discussed in the EIS (February 2007), with mitigation measures proposed, where appropriate.

### **Hedgestown National School**

7. No planning application for a new school has been lodged with Fingal County Council (as per www.fingalcoco.ie).
8. Planning permission was granted to Hedgestown National School (Planning Register Reference F07A/0697), on 05/09/07 for the following:

*'Retention of existing single classroom, pre-fabricated portable building and associated site works'*

### **Local Road Network**

9. A number of issues in relation to the local road network in the Hollywood region were raised in the letter of objection of 28<sup>th</sup> December, 2007. Murphy Environmental wishes to raise the following points, in relation to Murphy Environmental-related traffic and otherwise, as follows:
10. The sale of aggregate product on a commercial basis from Murphy Environmental/Murphy Concrete Manufacturing Ltd., Hollywood has ceased, effective from December 2007. This has positive implications in terms of reduced traffic volumes into and out of the facility. A parallel increase in the number of vehicle movements delivering inert materials into the site will result in no net overall increase of vehicle movements associated with site operations prior to the application for planning in February 2007.
11. The traffic arrangements and potential road/noise impacts associated with the Baldarragh site and the proposed Nevitt Landfill are outside the control of Murphy Environmental.
12. Should the Nevitt Landfill proceed, access to the site will not be via road LP01080, rather alternative superior road infrastructure will be put in place, as shown on the attached drawings extracted from the Nevitt Landfill EIS (the construction of this road is underway at the time of writing). Should the Nevitt Landfill not proceed, this road will presumably be available and greatly in excess of any infrastructure currently in use and fit for the purposes of this development.
13. Furthermore, the progression of the Nevitt Landfill will require the compulsory acquisition of a number of potential receptors in the vicinity of the site to facilitate the necessary boundary buffer zone, in addition to the land requirement.
14. The construction of a new roundabout at the Walshestown junction on the M1 motorway has already commenced, which will alleviate potential traffic issues at this location.

### **Archaeology**

15. A full archaeological survey was conducted for the 1999 Hollywood EIS and was repeated for the 2004 EIS. No significant issues were raised. There will be no overall change in traffic volumes, considering the cessation of quarry sales from Hollywood. Murphy Environmental is required, under the terms of Waste Licence W0129-01 (and under the PD, W0129-02), to undertake an archaeological assessment of undisturbed areas of the site.

### **Noise monitoring**

16. Hollywood is regulated by the EPA Waste Licence in terms of noise monitoring and noise emission limit values. All monitoring is done with reference to relevant standards and protocols and results reported to the Agency on a routine basis.
17. With reference to noise studies contained in the Hollywood EIS (February 2007), the use of 50kmph truck speed for the purpose of evaluating the noise levels, as opposed to 80kmph, gives a 'worse case' scenario, i.e. the noise levels are typically higher at 50kmph for HGVs than an 80kmph.

### **Murphy Environmental Communication Procedure**

18. Murphy Environmental is fully committed to open and transparent communication with neighbours, regulators and other interested parties. The company's website, [www.murphyenvironmental.ie](http://www.murphyenvironmental.ie) offers extensive access to the public to information on the site's operations, Annual Environmental Reports and monitoring results. Murphy Environmental is proud of its excellent relations with site neighbours during the course of the quarrying and restoration activities at the site. The General Manager of Murphy Environmental has been in direct correspondence with Mr Shortt, via telephone and letter in 2007, including copies of weighbridge records, with copies of correspondence retained on-site at Hollywood.

Murphy Environmental wishes to formally acknowledge the submission received by Mr Shortt and to assure neighbours of the facility that all concerns expressed by them are taken very seriously by the company. Murphy Environmental makes every effort to minimise potential impacts of its operations on site neighbours, including the non-acceptance of materials into the facility on Saturdays, except under exceptional circumstances.

The Hollywood Quarry has been in existence for over 50 years, and the site has been licensed by the EPA since 2002. The company is in full compliance with all conditions of planning and licensing and the EIS (February 2007) was completed with reference to all relevant regulation and guidance. Murphy Environmental is independently certified to ISO14001:2004, the International Standard for Environmental Management Systems; Hollywood was the first privately-operated landfill in Ireland to attain this Standard. The company has also been acknowledged by a number of awards, including an Environment Award from Fingal County Council in the Local Authority Greener Communities Awards Scheme.

We are available to clarify any of the information outlined in this document, or to provide additional information, if required. Please contact Louise O'Donnell (Patel Tonra Ltd.) on 01 8020523, or Patricia Rooney (Murphy Environmental) directly on 087 2539959, if we can be of assistance.

Yours sincerely  
on behalf of Murphy Environmental (a division of Murphy Concrete Manufacturing Ltd.)

**Louise O'Donnell**  
Director  
Patel Tonra Ltd.

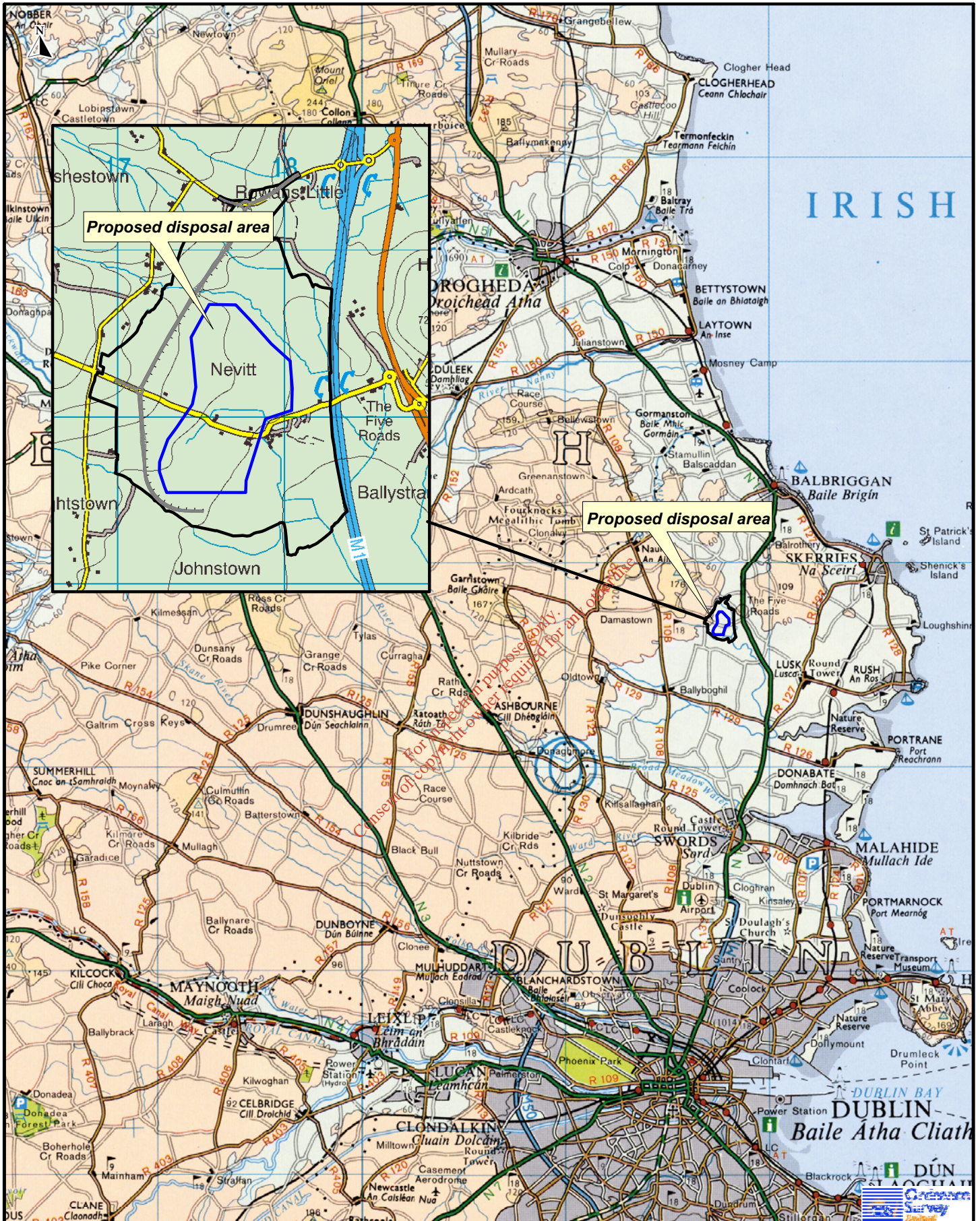

Project **Fingal Landfill Project**

Figure 6.1

Title **Location Map**



**RPS Consulting Engineers**

Carnegie House  
 Library Road  
 Dun Laoghaire  
 Co. Dublin, Ireland  
 T +353 (0)1 2020870  
 F +353 (0)1 2020707  
 E ireland@rpsgroup.com  
 W www.rpsgroup.com/ireland

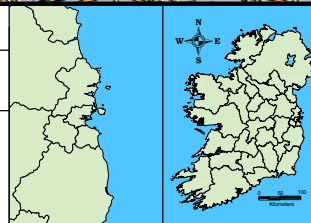

**Issue Details**

Drawn: CW	Project No. MDR0303
Checked: EB	File Ref.
Approved: KW	MDR0303MI0074
Scale: 1:250,000 @ A4	Drawing No. Rev.
Date: 10/03/06	MI0074 F01

**Notes**  
 1. This drawing is the property of RPS Consulting Engineers. It is a confidential document and must not be copied, used, or its contents divulged without prior written consent.  
 2. All levels are referred to Ordnance Datum, Mean Head.  
 3. Ordnance Survey Ireland Licence No. EN 0005005  
 Copyright Government of Ireland.

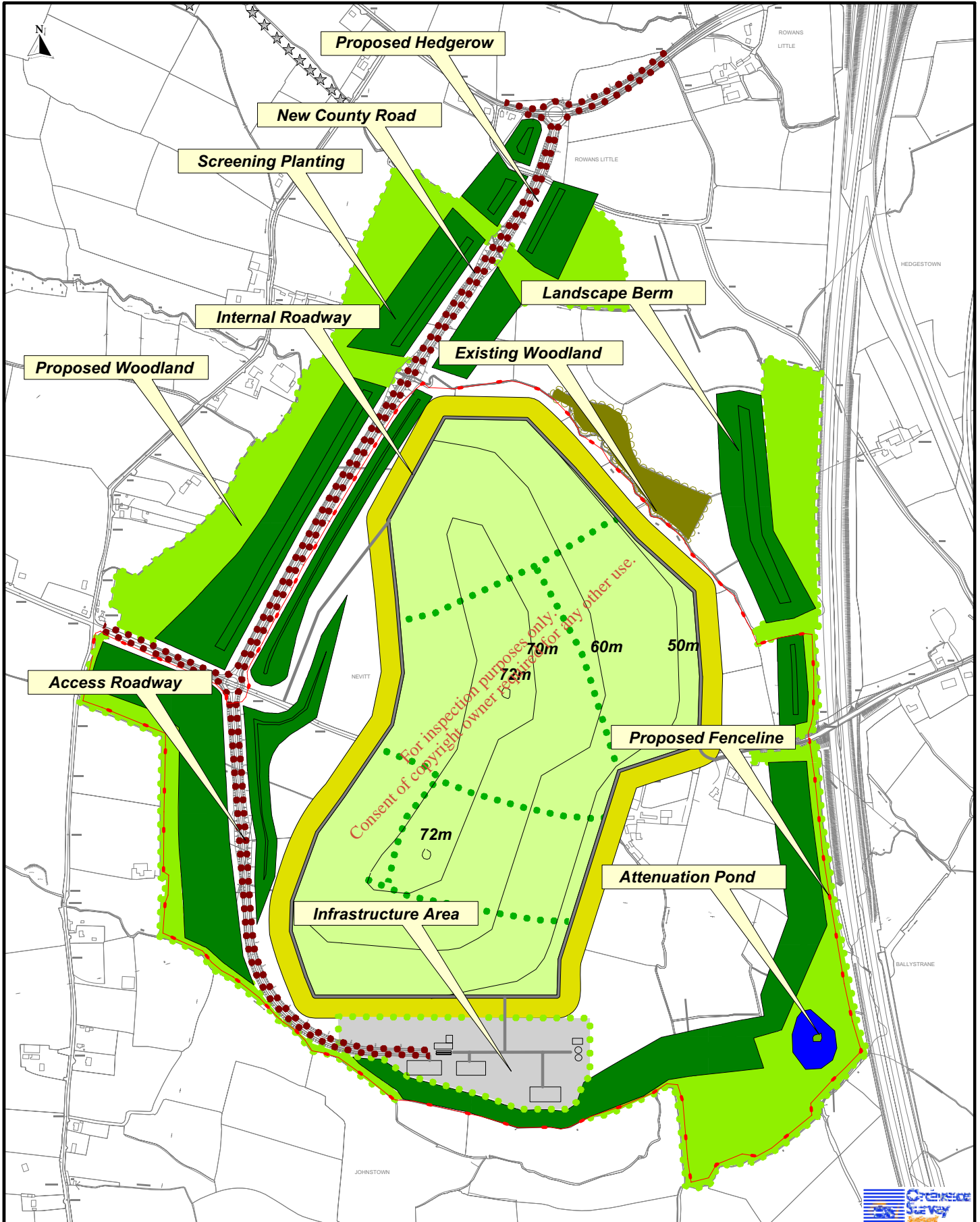

Project **Fingal Landfill Project**  
 Title **Proposed Development**

Figure 6.2

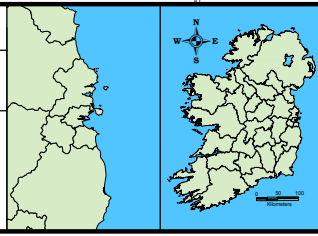

Issue Details	
Drawn: CW	Project No. MDR0303
Checked: RH	File Ref.
Approved: KW	MDR0303M0076
Scale: 10,000 @ A4	Drawing No. Rev.
Date: 10/03/06	M0076 F01

**Notes**

1. This drawing is the property of RPS Consulting Engineers. It is a confidential document and must not be copied, used, or its contents divulged without prior written consent.
2. All levels are referred to Ordnance Datum, Malin Head.
3. Ordnance Survey Ireland Licence No. EN 0005005 Copyright Government of Ireland.



**RPS Consulting Engineers**

Carnegie House  
 Library Road  
 Dun Laoghaire  
 Co. Dublin, Ireland

T +353 (0)1 2020870  
 F +353 (0)1 2020707  
 E ireland@rpsgroup.com  
 W www.rpsgroup.com/ireland