



# Waste Licence Application Form

For inspection purposes only.  
Copyright of copyright owner required for any other use.

<b>EPA Ref. N<sup>o</sup>:</b> <i>(Office use only)</i>	<input type="text"/>
--	----------------------

*This document does not purport to be and should not be considered a legal interpretation of the provisions and requirements of the Waste Management Acts 1996 to 2003.*

**Environmental Protection Agency**  
P.O.Box 5000, Johnstown Castle Estate, County Wexford  
Telephone: 053-60600 Fax: 053-60699

## INTRODUCTION

A valid application must contain the information prescribed in the Waste Management (Licensing) Regulations 2004 (SI No. 395 of 2004). The application should conform to the format set out in this application form and the relevant *Guidance Note*. Each page of the completed application form must be numbered, e.g. **page 5 of 45**, etc. **Wherever possible, information should be supplied in the spaces given in the application form. Additional information can be included in clearly identifiable, numbered attachments, which should be cross-referenced with the relevant sections in the application form. A contents list should be included with each volume.** The applicant should refer to the *Guidance Note* in order to ensure that the application includes all the information required. Consistent measurement units must be used throughout.

**It should be noted that it will not be possible to process or determine the application until the required documents have been provided in sufficient detail and to a satisfactory standard.**

For inspection purposes only.  
Consent of copyright owner required for any other use.

**CHECKLIST**

Articles 12 and 13 of the Waste Management (Licensing) Regulations, 2004 (S.I. No. 395 of 2004) set out the information which must, in all cases, accompany a waste licence application. In order to ensure that the application fully complies with the legal requirements of Articles 12 and 13 of the 2004 Regulations, all applicants should **complete** the following.

In each case, refer to the attachment number(s) of your application which contain(s) the information requested in the appropriate sub-article.

**Article 12(1)** In the case of an application for a waste licence, the application shall -

- (a) give the name, address and, where applicable, any telephone number and telefax of the applicant (and, if different, the operator of the facility concerned), the address to which correspondence relating to the application should be sent and, if the applicant or operator is a body corporate, the address of its registered office or principal office,

LOCATION	ATTACHMENT B	
CHECKED	Applicant <input checked="" type="checkbox"/>	Official <input type="checkbox"/>

- (b) give the name of the planning authority in whose functional area the relevant activity is or will be carried on,

LOCATION	ATTACHMENT B	
CHECKED	Applicant <input checked="" type="checkbox"/>	Official <input type="checkbox"/>

- (c) in the case of a discharge of any trade effluent or other matter (other than domestic sewage or storm water) to a sewer of a sanitary authority, give the name of the sanitary authority in which the sewer is vested or by which it is controlled,

LOCATION	ATTACHMENT B	
CHECKED	Applicant <input checked="" type="checkbox"/>	Official <input type="checkbox"/>

- (d) give the location or postal address (including where appropriate, the name of the townland or townlands) and the National Grid reference of the facility or premises to which the application relates,

LOCATION	ATTACHMENT B	
CHECKED	Applicant <input checked="" type="checkbox"/>	Official <input type="checkbox"/>

*WASTE Application Form*

(e) describe the nature of the facility or premises concerned, including the proposed capacity of the facility or premises, and in the case of application in respect of a landfill of waste, the requirements specified in Annex 1 of the Landfill Directive,

<b>LOCATION</b>	ATTACHMENT B	
<b>CHECKED</b>	<b>Applicant</b> <input checked="" type="checkbox"/>	<b>Official</b> <input type="checkbox"/>

(f) specify the class or classes of activity concerned, in accordance with the Third and Fourth Schedules of the Act, and in the case of an application in respect of the landfill of waste, specify the class of landfill in accordance with Article 4 of the Landfill Directive,

<b>LOCATION</b>	ATTACHMENT B	
<b>CHECKED</b>	<b>Applicant</b> <input checked="" type="checkbox"/>	<b>Official</b> <input type="checkbox"/>

(g) specify, by reference to the relevant European Waste Catalogue codes as presented by Commission Decision 2000/532/EC of 3 May 2000, the quantity and nature of the waste or wastes which will be treated, recovered or disposed of,

<b>LOCATION</b>	ATTACHMENT H	
<b>CHECKED</b>	<b>Applicant</b> <input checked="" type="checkbox"/>	<b>Official</b> <input type="checkbox"/>

(h) specify the raw and ancillary materials, substances, preparations, fuels and energy which will be utilised in or produced by the activity,

<b>LOCATION</b>	ATTACHMENT D	
<b>CHECKED</b>	<b>Applicant</b> <input checked="" type="checkbox"/>	<b>Official</b> <input type="checkbox"/>

(i) describe the plant, methods, processes, ancillary processes, abatement, recovery and treatment systems and operating procedures for the activity,

<b>LOCATION</b>	ATTACHMENT D, H	
<b>CHECKED</b>	<b>Applicant</b> <input checked="" type="checkbox"/>	<b>Official</b> <input type="checkbox"/>

(j) provide information for the purpose of enabling the Agency to make a determination in relation to the matters specified in paragraphs (a) to (g) of section 40(4) of the Act,

<b>LOCATION</b>	ATTACHMENT A	
<b>CHECKED</b>	<b>Applicant</b> <input checked="" type="checkbox"/>	<b>Official</b> <input type="checkbox"/>

WASTE Application Form

(k) give particulars of the source, location, nature, composition, quantity, level and rate of emissions arising from the activity and, where relevant, the period or periods during which such emissions are made or are to be made,

LOCATION	ATTACHMENT E	
CHECKED	Applicant <input checked="" type="checkbox"/>	Official <input type="checkbox"/>

(l) give details, and an assessment of the effects, of any existing or proposed emissions on the environment, including any environmental medium other than those into which the emissions are, or are to be made, and of proposed measures to prevent or eliminate or, where that is not practicable, to limit or abate such emissions,

LOCATION	ATTACHMENT E	
CHECKED	Applicant <input checked="" type="checkbox"/>	Official <input type="checkbox"/>

(m) identify monitoring and sampling points and indicate proposed arrangements for the monitoring of emissions and the environmental consequences of any such emissions,

LOCATION	ATTACHMENT F	
CHECKED	Applicant <input checked="" type="checkbox"/>	Official <input type="checkbox"/>

(n) describe any proposed arrangements for the prevention, minimisation and recovery of waste arising from the activity concerned,

LOCATION	ATTACHMENT D	
CHECKED	Applicant <input checked="" type="checkbox"/>	Official <input type="checkbox"/>

(o) describe any proposed arrangements for the off-site treatment or disposal of solid or liquid wastes,

LOCATION	ATTACHMENT B, D	
CHECKED	Applicant <input checked="" type="checkbox"/>	Official <input type="checkbox"/>

(p) describe the existing or proposed measures, including emergency procedures, to prevent unauthorised or unexpected emissions and minimise the impact on the environment of any such emission,

LOCATION	ATTACHMENT D	
CHECKED	Applicant <input checked="" type="checkbox"/>	Official <input type="checkbox"/>

WASTE Application Form

(q) describe the proposed measures for the closure, restoration, remediation or aftercare of the facility concerned, after the cessation of the activity in question,

LOCATION	ATTACHMENT K	
CHECKED	Applicant <input checked="" type="checkbox"/>	Official <input type="checkbox"/>

(r) in the case of an application in respect of the landfilling of waste, give particulars of –

(i) such financial provision as is proposed to be made by the applicant, having regard to the provisions of Articles (7)(i) and (8)(a)(iv) of the Landfill Directive and section 53(1) of the Act, and

LOCATION	NOT APPLICABLE	
CHECKED	Applicant <input type="checkbox"/>	Official <input type="checkbox"/>

(ii) such charges as are proposed or made, having regard to the requirements of section 53A of the Act,

LOCATION	NOT APPLICABLE	
CHECKED	Applicant <input type="checkbox"/>	Official <input type="checkbox"/>

(s) state whether the activity is for the purposes of an establishment to which the European Communities (Control of Major Accident Hazards involving Dangerous Substances) Regulations, 2000 (S.I. No. 476 of 2000) apply,

LOCATION	NOT APPLICABLE	
CHECKED	Applicant <input type="checkbox"/>	Official <input type="checkbox"/>

(t) in the case of an activity which gives rise or could give rise to an emission into an aquifer containing the List I and II substances specified in the Annex to Council Directive 80/68/EEC of 17 December 1979, describe the existing or proposed arrangements necessary to give effect to Articles 3,4,5,6,7,8,9 and 10 of the aforementioned Council Directive,

LOCATION	NOT APPLICABLE	
CHECKED	Applicant <input type="checkbox"/>	Official <input type="checkbox"/>

WASTE Application Form

(u) include a non-technical summary of information provided in relation to the matters specified in paragraphs (a) to (t) of this sub-article,

LOCATION	ATTACHMENT A	
CHECKED	Applicant <input checked="" type="checkbox"/>	Official <input type="checkbox"/>

**Article 12(4)** Without prejudice to Article 13(1) and (2), an application for a licence shall be accompanied by -

(a) a copy of the relevant page of the newspaper or newspapers in which the notice in accordance with article 6 has been published,

LOCATION	ATTACHMENT B	
CHECKED	Applicant <input checked="" type="checkbox"/>	Official <input type="checkbox"/>

(b) a copy of the text of the notice or notices erected or fixed in accordance with article 7,

LOCATION	ATTACHMENT B	
CHECKED	Applicant <input checked="" type="checkbox"/>	Official <input type="checkbox"/>

(c) where appropriate, a copy of the notice given to a local planning under article 9,

LOCATION	NOT APPLICABLE	
CHECKED	Applicant <input type="checkbox"/>	Official <input type="checkbox"/>

(d) a copy of such plans, including a site plan or plans and location map or maps, and such other particulars, reports and supporting documentation as are necessary to identify and describe, as appropriate -

(i) the position of the notice in accordance with article 7,

LOCATION	ATTACHMENT B	
CHECKED	Applicant <input checked="" type="checkbox"/>	Official <input type="checkbox"/>

(ii) the point or points from which emissions are made or are to be made, and

LOCATION	ATTACHMENT E	
CHECKED	Applicant <input checked="" type="checkbox"/>	Official <input type="checkbox"/>

(iii) the point or points at which monitoring and sampling are undertaken or are to be undertaken,

<b>LOCATION</b>	ATTACHMENT F	
<b>CHECKED</b>	<b>Applicant</b> X	<b>Official</b> <input type="checkbox"/>

(e) such fee as is appropriate having regard to the provisions of articles 40 and 41.

<b>INCLUDED Y/N</b>	Y	
<b>CHECKED</b>	<b>Applicant</b> X	<b>Official</b> <input type="checkbox"/>

**Article 12(5)(a)** An application by a local authority in respect of the carrying on of an activity at a facility within the functional area of the authority shall be accompanied by 2 copies of the application and of all accompanying documents and particulars as required under sub-article (4).

<b>PROVIDED Y/N</b>	NOT APPLICABLE	
<b>CHECKED</b>	<b>Applicant</b> <input type="checkbox"/>	<b>Official</b> <input type="checkbox"/>

**Article 12(5)(b)** An application other than one to which paragraph (a) refers shall be accompanied by 3 copies of the application or such other number of copies as the Agency shall determine and of all accompanying documents and particulars as required under sub-article (4).

<b>PROVIDED Y/N</b>	YES	
<b>CHECKED</b>	<b>Applicant</b> X	<b>Official</b> <input type="checkbox"/>

**Article 12(5)(c)** For the purposes of paragraphs (a) and (b), all or part of the necessary copies of the said application and associated documents and particulars may, with the agreement of the Agency, be submitted in a computer or other non-legible format specified by the Agency.

<b>CD version as PDF files PROVIDED? Y/N</b>	Y	
<b>CHECKED</b>	<b>Applicant</b> X	<b>Official</b> <input type="checkbox"/>



**Article 13** Where a development requires an Environmental Impact Assessment to be carried out, 3 copies of the environmental impact statement plus 11 copies on CD should accompany this application.

<b>EIA REQUIRED ? Y/N</b>	NO	
<b>CHECKED</b>	<b>Applicant</b> <input type="checkbox"/>	<b>Official</b> <input type="checkbox"/>
<b>3 HARD COPIES OF EIS INCLUDED ? Y/N</b>		
<b>CHECKED</b>	<b>Applicant</b> <input type="checkbox"/>	<b>Official</b> <input type="checkbox"/>
<b>11 CD versions of EIS, as PDF files, PROVIDED? Y/N</b>		
<b>CHECKED</b>	<b>Applicant</b> <input type="checkbox"/>	<b>Official</b> <input type="checkbox"/>

**Article 13 (6)** Notwithstanding the requirements of sub-articles (1) and (2), all or part of 3 copies of the environmental impact statement may, with the agreement of the Agency, be submitted in a computer or other non-legible format specified by the Agency.

<b>CD version PROVIDED? Y/N</b>	NOT APPLICABLE	
<b>CHECKED</b>	<b>Applicant</b> <input type="checkbox"/>	<b>Official</b> <input type="checkbox"/>

For inspection purposes only. Consent of copyright owner required for any other use.

## PROCEDURES

**It is recommended that pre-application consultations with the Agency are undertaken before a formal submission of the waste licence application.**

The procedure for making and processing of applications for waste licences, and for the processing of reviews of such licences, appear in the Waste Management (Licensing) Regulations 2004 (S.I. No.395 of 2004) and are summarised below. The application fees that shall accompany an application are listed in the Second Schedule to the Regulations.

Prior to submitting an application the applicant must publish in a local newspaper, and erect on site, a notice of intention to apply. An applicant, other than a local authority in whose functional area the development is located, must also notify the Local Planning Authority, in writing, of their intention to apply.

An application for a licence must be submitted on the appropriate form (available from the Agency) with the correct fee, and should contain relevant supporting documentation as attachments. The application should be based on responses to the form, supporting written text and the appropriate use of tables and drawings. Where point source emissions occur, a system of unique reference numbers should be used to denote each emission point. These should be simple, logical, and traceable throughout the application.

The application form is divided into a number of sections of related information. The purpose of these divisions being to facilitate both the applicant and the Agency in the provision of the information and its assessment. Attachments should be clearly numbered, titled and paginated and must contain the required information as set out in the application form. Additional attachments may be included to supply any further information supporting the application. Any references made should be supported by a bibliography.

**All questions should be answered.** No waste management facility is exactly the same and hence each application will require different information. It is therefore possible that some of the sections of this application form may not be relevant to the activity concerned. **Where information is requested in the application form, which is not relevant to the application, the words “not applicable” should be clearly written on the form. The abbreviation “N/A” should not be used.**

Additional information may need to be submitted beyond that which is explicitly requested on this form. Any references made should be supported by a bibliography. The Agency may request further information if it considers that its provision is material to the assessment of the application. Advice should be sought from the Agency where there is doubt about the type of information required or the level of detail.

Information supplied in this application, including supporting documentation will be put on public display and be open to inspection by any person. **Should the applicant**

consider information to be confidential, then the nature of this information, and the reasons why it is considered confidential should be clearly stated in an attachment to the Application Form. This information should be submitted in a separate enclosure bearing the legend “In the event that this information is deemed not to be held as confidential, it must be returned to (representative of the applicant)”.

Applicants should be aware that a contravention of the conditions of a waste licence is an offence under Section 39 of the Waste Management Acts 1996 to 2003.

**The provision of information in an application for a waste licence which is false or misleading is an offence under Section 45 of the Waste Management Acts 1996 to 2003.**

*Note: Drawings. The following guidelines are included to assist applicants:*

- All drawings submitted should be titled and dated.
- They should have a **unique reference number** and should be signed by a clearly identifiable person.
- They should indicate a scale and the **direction of north**.
- All drawings should, generally, be to a scale of between 1:20 to 1:500, depending upon the degree of detail needed to be shown and the size of the facility. Drawings delineating the boundary can be to a smaller scale of up between 1:1000 to 1:10560, but must clearly and accurately present the required level of detail. Drawings showing the site location can be to a scale of between 1:50 000 to 1:126 720. Provide legends on all drawings and maps as appropriate.

*Applicants must submit a signed original of the completed application, plus three copies (two copies where the application is by a local authority in respect of the carrying on of an activity located within the functional area of the authority)<sup>1</sup>. In cases where an Environmental Impact Statement (EIS) is required then the Agency must be supplied with three copies of the EIS. In addition the applicant must submit one copy of the complete application on a CD-ROM, and eleven CD-ROM copies of the EIS to the Agency. The e-files should be saved as a ‘pdf’ file, read only status.*

**The provision of information in an application for a waste licence, which is false or misleading, is an offence under s45 of the Acts.**

---

<sup>1</sup> Article 12(5) of the Regulations

---

**SECTION A NON-TECHNICAL SUMMARY**

---

A Non-Technical Summary is to be submitted. The summary should include information on those aspects outlined in the Guidance Note and must comply with the requirements of Article 12 (1) (u) of the Waste Management (Licensing) Regulations, S.I. 395 of 2004.

The Non-Technical Summary should form **Attachment A.1**.

*For inspection purposes only.  
Consent of copyright owner required for any other use.*

**SECTION B GENERAL****B.1 Applicant's Details****Name\*:** KMK Metals Recycling Ltd**Address:** Cappincur Industrial Estate

Daingean Road

Tullamore

Co. Offaly

**Tel:** 057 93 41634**Fax:** 057 93 22729**e-mail:** info@metalsrecyclin.ie

\* This should be the name of the applicant which is current on the date this Waste Licence Application is lodged with the Agency. It should be the name of the legal entity (which can be a limited company or a sole trader). A trading/business name is not acceptable.

**Name and Address for Correspondence**

Only application documentation submitted by the applicant and by the nominated person will be deemed to have come from the applicant.

**Name:** KMK Metals Recycling Ltd**Address:** Cappincur Industrial Estate

Daingean Road

Tullamore

Co. Offaly

**Tel:** 057 93 41634**Fax:** 057 93 22729**e-mail:** info@metalsrecyclin.ie**Address of registered or principal office of Body Corporate (if applicable)****Address:** Cappincur Industrial Estate

Daingean Road

Tullamore

Co. Offaly

**Tel:** 057 93 41634**Fax:** 057 93 22729**e-mail:** info@metalsrecyclin.ie

If the applicant is a body corporate, the following information must be attached as **Attachment B1**:

- a Certified Copy of the Certificate of Incorporation or Memorandum and Article of Association;
- the Company's Registration Number from the Companies Registry Office; and
- a list of the Company Directors.

State the interest of the applicant in the land which is subject to the application. The applicant is (please check):

Landowner	<input checked="" type="checkbox"/>
Lessee	<input checked="" type="checkbox"/>
Prospective Purchaser	<input type="checkbox"/>
Other (please specify)	

Name and address of all occupiers of the land on which the Activity is situated (if different from applicant named above).

Name: **KMK Metals Recycling Ltd**

Address: **as above**

Tel:

Fax:

e-mail:

Name and address of the current\* owner(s) and lessees of the land, buildings and ancillary plant on which the activity is or will be situated (if different from applicant named above). A drawing showing the above details should be included in Attachment B1.

Name: **Mr Paddy McDermott**

**Mr Damien Donaghy**

Address: **C/O Midland Farm Machinery** **Clara Road**  
**Cappincur Industrial Estate** **Kilbeggan**  
**Daingean Road** **Co Offaly**  
**Tullamore**

Tel:

Fax:

e-mail:

\*Current at the time the application is submitted

**B.2 Location of Activity**

Name: **KMK Metals Recycling Ltd**

Address\*: **Cappincur Industrial Estate**  
**Daingean Road**  
**Tullamore**

**Co. Offaly**

Tel: **057 93 41634**

Fax: **057 93 22729**

e-mail: **info@metalsrecycling.ie**

\* Include any townland

<b>National Grid Reference (8 digit 4E,4N)</b>	3595E 2500N
--	-------------

Location maps with grid references should be enclosed in **Attachment B.2**. The site boundary must be outlined on the map in colour.

Original maps of the relevant area, such as maps from the Ordnance Discovery Series, from which the site grid reference can be read and confirmed, must be included in **Attachment B.2**.

**B.3 Planning Authority**

Give the name of the planning authority in whose functional area the activity is or will be carried out.

**Name:** Offaly County Council,

**Address:** County Hall,  
Charleville Road  
Tullamore  
Co Offaly

**Tel:** 057 93 46881

**Fax:** \_\_\_\_\_

Has the Planning Authority received written notification from the applicant of the application to The Environmental Protection Agency for a Waste Licence under Article 9 of the Waste Management (Licensing) Regulations?

<b>Planning Authority notified</b>	<b>Yes</b> <input checked="" type="checkbox"/>
	<b>No</b> <input type="checkbox"/>

Planning Permission relating to this application:-

<i>has been obtained</i>	<input checked="" type="checkbox"/>
<i>is being processed</i>	<input type="checkbox"/>
<i>is not yet applied for</i>	<input type="checkbox"/>
<i>is not required</i>	<input type="checkbox"/>

<b>Local Authority Planning File Reference N<sup>o</sup>:</b>	Not applicable.
---	-----------------

**Attachment B.3** should contain *the most recent* planning permission, including a copy of *all* conditions, and the required copies of any EIS should also be enclosed. For existing activities, **Attachment B.3** should also contain copies of the most recent waste licence and any permits in force at the time of submission. Where planning permission is not required for the development, provide reasons, relevant correspondence, etc.

**B.4 Sanitary Authority**

In the case of a discharge of any trade effluent or other matter (other than domestic sewage or storm water) to a sewer of a sanitary authority or other body, give the name of the sanitary authority in which the sewer is vested or by which it is controlled and the waste water treatment plant (if any) to which the sewer discharges.

**Name:** NOT APPLICABLE

---

**Address:**

---



---



---

**Tel:**

---

**Fax:**

---

The applicant must enclose, as **Attachment B.4**, a copy of any effluent discharge licence and/or agreement between the applicant and the body with responsibility for the sewer.

**B.5 Other Authorities**

The applicant should tick the appropriate box below to identify whether the activity is located within the Shannon Free Airport Development Company (SFADCo.) area

<b>Within SFADCo. Area</b>	<b>Yes</b> <input type="checkbox"/>	<b>No</b> <input checked="" type="checkbox"/>
----------------------------	-------------------------------------	---

The applicant should indicate the **Health Board Region** where the activity is or will be located.

**Name:** HSE Midlands

---

**Address:** Sragh Industrial Estate

---

Tullamore

---

Co Offaly

---

**Tel:**

---

**Fax:**

---

**B.6 Notices and Advertisements**

Articles 6 and 7 of the Waste Management (Licensing) Regulations 2004 requires all applicants to advertise the application in a newspaper and by way of a site notice. See *Guidance Note*.

**Attachment B.6** should contain a copy of the site notice and a drawing showing its location on site. **The original application must include the complete newspaper in which the advertisement was placed.** The relevant page of the newspaper containing the advertisement should be included with the original and three copies of the application.



## B.7 Type of Waste Activity, Tonnages & Fees

**B.7.1 Specify the class or classes of activity in Table B.7.1, in accordance with the Third Schedule or Fourth Schedule to the Waste Management Acts 1996 to 2003, to which the application relates (check the relevant box(es) and mark the principal activity with a 'P').**

**Attachment B.7** should identify the principle activity and include a brief technical description of each of the other activities specified. **There can only be one principal activity.**

**TABLE B.7.1 THIRD AND FOURTH SCHEDULES OF THE WASTE MANAGEMENT ACTS 1996 TO 2003**

<b>Waste Management Acts 1996 to 2003</b>			
<b>THIRD SCHEDULE Waste Disposal Activities</b>	<b>Y/N</b>	<b>FOURTH SCHEDULE Waste Recovery Activities</b>	<b>Y/N</b>
1. Deposit on, in or under land (including landfill).		1. Solvent reclamation or regeneration.	
2. Land treatment, including biodegradation of liquid or sludge discards in soils.		2. Recycling or reclamation of organic substances which are not used as solvents (including composting and other biological transformation processes).	
3. Deep injection of the soil, including injection of pumpable discards into wells, salt domes or naturally occurring repositories.		3. Recycling or reclamation of metals and metal compounds.	X
4. Surface impoundment, including placement of liquid or sludge discards into pits, ponds or lagoons.		4. Recycling or reclamation of other inorganic materials.	X
5. Specially engineered landfill, including placement into lined discrete cells which are capped and isolated from one another and the environment.		5. Regeneration of acids or bases.	
6. Biological treatment not referred to elsewhere in this Schedule which results in final compounds or mixtures which are disposed of by means of any activity referred to in paragraphs 1 to 5 or paragraphs 7 to 10 of this Schedule.		6. Recovery of components used for pollution abatement.	X
7. Physico-chemical treatment not referred to elsewhere in this Schedule which results in final compounds or mixtures which are disposed of by means of any activity referred to in paragraphs 1 to 5 or paragraphs 8 to 10 of this Schedule (including evaporation, drying and calcination).		7. Recovery of components from catalysts.	X
8. Incineration on land or at sea.		8. Oil re-refining or other re-uses of oil.	
9. Permanent storage, including emplacement of containers in a mine.		9. Use of any waste principally as a fuel or other means to generate energy.	
10. Release of waste into a water body (including a seabed insertion).		10. The treatment of any waste on land with a consequential benefit for an agricultural activity or ecological system.	
11. Blending or mixture prior to submission to any activity referred to in a preceding paragraph of this Schedule.		11. Use of waste obtained from any activity referred to in a preceding paragraph of this Schedule.	X
12. Repackaging prior to submission to any activity referred to in a preceding paragraph of this Schedule.		12. Exchange of waste for submission to any activity referred to in a preceding paragraph of this Schedule.	X
13. Storage prior to submission to any activity referred to in a preceding paragraph of this Schedule, other than temporary storage, pending collection, on the premises where the waste concerned is produced.		13. Storage of waste intended for submission to any activity referred to in a preceding paragraph of this Schedule, other than temporary storage, pending collection, on the premises where such waste is produced.	X

**TABLE B.7.2 MAXIMUM ANNUAL TONNAGE**

The maximum annual tonnage of waste to be handled at the site should be indicated and the year to which the quantity relates indicated.

<b>Maximum Annual Tonnage (tpa)</b>	20,000
<b>Year</b>	2007

**B.7.3 FEES**

State each class of activity for which a fee is being submitted as per Part I of the Second Schedule of the Waste Management (Licensing) Regulations 2004, S.I. No. 395 of 2004. Note: two fees are required if disposal and recovery are to occur.

<b>Waste Activity</b>	<b>Fee (in €)</b>
Recovery of Waste (4)	6,000

**TABLE B.7.4 (FOR A LANDFILL APPLICATION)**

STATE WHICH OF THE FOLLOWING IS RELEVANT TO THE CURRENT APPLICATION.

(a) landfill for hazardous waste	<input type="checkbox"/>
(b) landfill for non-hazardous waste	<input type="checkbox"/>
(c) landfill for inert waste	<input type="checkbox"/>

**B.8 SEVESO II DIRECTIVE**

State whether the activity is for the purposes of an establishment to which the European Communities (Control of Major Accident Hazards involving Dangerous substances) Regulations, 2000 (S.I. No. 476 of 2000), apply.

<b>Regulations Apply</b>	Yes <input type="checkbox"/>	No <input checked="" type="checkbox"/>
--------------------------	------------------------------	--

If yes, **Attachment B.8** should include the relevant details. Supporting information, as well as copies of any Hazardous Operation Studies (HAZOP) carried out for the site, should also be included in the attachment.

## SECTION C MANAGEMENT OF THE FACILITY

Advice on completing this section is provided in the *Guidance Note*.

### ***C.1 Technical Competence and Site Management***

This information should form **Attachment C 1**.

Details of the applicant's experience and qualifications, along with that of other relevant employees, should be summarised as shown below. Statements of duties, responsibilities, experience and qualifications should be submitted for each position named below. Additional information, including the management structure and an organisational chart, should be included in **Attachment C 1**.

### ***C.2 Environmental Management System***

**Attachment C 2** should contain the Environmental Management System (EMS) details required.

### ***C.3 Hours of Operation***

**Attachment C 3** should contain details of hours of operation for the waste facility, civic waste facilities and other facilities.

- (a) Proposed hours of operation.
- (b) Proposed hours of waste acceptance/handling.
- (c) Proposed hours of any construction and development works at the facility and timeframes (required for landfill facilities).
- (d) Any other relevant hours of operation expected.

### ***C.4 Conditioning Plan***

Address as **Attachment C 4**, in the case of a LANDFILL Application, and only for the review of a Landfill Waste Licence.

For inspection purposes only.  
Copyright owner required for any other use.

## SECTION D INFRASTRUCTURE & OPERATION

### *D.1 Infrastructure*

Complete the following table detailing the site infrastructure. **Attachment D 1** should contain the appropriate documentation. Information provided should follow the sequence, and use the headings, established in Table D.1. Additional advice on completing this section is provided in the application *Guidance Note*.

<b>Table D.1. Infrastructure</b>		<b>y/n</b>	<b>Comments</b>
<b>D.1.a</b>	<b>Site security arrangements including gates and fencing</b>	Y	See Attachment D
<b>D.1.b</b>	<b>Designs for site roads</b>	N	See Attachment D
<b>D.1.c</b>	<b>Design of hardstanding areas</b>	N	See Attachment D
<b>D.1.d</b>	<b>Plant</b>	N	See Attachment D
<b>D.1.e</b>	<b>Wheel-wash</b>	N	See Attachment D
<b>D.1.f</b>	<b>Laboratory facilities</b>	N	See Attachment D
<b>D.1.g</b>	<b>Design and location of fuel storage areas</b>	N	See Attachment D
<b>D.1.h</b>	<b>Waste quarantine areas</b>	Y	See Attachment D
<b>D.1.i</b>	<b>Waste inspection areas</b>	Y	See Attachment D
<b>D.1.j</b>	<b>Traffic control</b>	N	See Attachment D
<b>D.1.k</b>	<b>Sewerage and surface water drainage infrastructure</b>	Y	See Attachment D
<b>D.1.l</b>	<b>All other services</b>	Y	See Attachment D
<b>D.1.m</b>	<b>Plant sheds, garages and equipment compound</b>	Y	See Attachment D
<b>D.1.n</b>	<b>Site accommodation</b>	N	See Attachment D
<b>D.1.o</b>	<b>A fire control system, including water supply</b>	N	See Attachment D
<b>D.1.p</b>	<b>Civic amenity facilities</b>	N	See Attachment D
<b>D.1.q</b>	<b>Any other waste recovery infrastructure</b>	N	See Attachment D
<b>D.1.r</b>	<b>Composting infrastructure</b>		Not Applicable
<b>D.1.s</b>	<b>Construction and Demolition waste infrastructure</b>		Not Applicable
<b>D.1.t</b>	<b>Incineration infrastructure (if applicable). Provide information to fulfil Article 4 (2) &amp; (3) of the Incineration of Waste Directive</b>		Not Applicable
<b>D.1.u</b>	<b>Any other infrastructure</b>		Not Applicable

## D.2 Facility Operation

In **Attachment D 2** describe the plant, methods, processes and operations of the waste facility, as required by the *Guidance Note*.

Attachment included	yes <input checked="" type="checkbox"/>	no <input type="checkbox"/>	not applicable <input type="checkbox"/>
---------------------	---	-----------------------------	---

## LANDFILLS

The following Sections D3 to D7 should only be completed for Landfill Applications. Reference should be made to the Agency landfill manual 'Landfill Site Design (2000)' when completing this section.

### D.3 Liner System

Complete the following table regarding the liner system to be used for the landfill/landfill extension and detail the information requested as **Attachment D.3. Items D3c to D3g should only be completed for immediate projects only (ie Years 1 & 2)**. A schedule of Liner construction activities for the medium to long term need only be listed in item D3a below, since Condition 3 of any licences granted will provide reporting requirements for any future projects.

**TABLE D.3 LINER SYSTEM**

		y/n	Comments
D.3.a	Provide information to fulfil Annex 1 of the Landfill Directive		
D.3.b	What type of liner system is specified?		
D.3.c	Has a Quality Control Plan been specified?		
D.3.d	Has a Quality Assurance Plan been specified?		
D.3.e	Have independent, third-party supervision, testing and controls been specified?		
D.3.f	Have basal gradients for all cells and access ramps to the cells been designed?		
D.3.g	Has a leak detection survey been specified?		

#### D.4 Leachate Management

Complete the following table detailing leachate management arrangements. Further information should be included in **Attachment D.4**.

**TABLE D.4.1 LEACHATE MANAGEMENT ARRANGEMENTS**

		y/n	Comments
D.4.a	Is there a Leachate Management Plan?		
D.4.b	Have annual quantities of leachate been calculated?		
D.4.c	Has the total quantity of leachate been calculated?		
D.4.d	Have the size of the cells been specified taking account of the water balance calculations?		
D.4.e	Has a leachate collection system been specified?		
D.4.f	Has a leachate storage system been specified?		
D.4.g	Has a system for monitoring the level of leachate in the waste been designed?		
D.4.h	Is leachate recirculation proposed/practised?		
D.4.i	Has leachate treatment on-site been specified?		
D.4.j	Has leachate removal been specified?		

#### D 5 Landfill Gas Management

All landfill sites should have suitable arrangements for the management of landfill gas. **Attachment D.5** should contain the appropriate documentation. Information provided should follow the sequence, and use the headings, established in Table D.5. **Items D5g to D5m should only be completed for immediate or current gas collection projects only (ie Years 1 & 2)**. A schedule of gas management aspects for the medium to long term need only be listed in item D5f below, since Condition 3 of any proposed decision/licence will provide reporting requirements for any future projects.

**Table D.5. Landfill Gas Management**

		y/n	Comments
D.5a	<p><b>Is there a Landfill Gas Management Plan?</b></p> <p>Provide estimates of the volumes of landfill gas which will be produced by the waste disposed of in the site for the next 20 years, and compare to the EPER list for methane:</p>		
D.5b	<b>Is there a passive venting system?</b>		
D.5c	<b>Does the passive system cover all of the filled area?</b>		
D.5d	<b>Have gas alarm systems been installed in the site buildings?</b>		
D.5e	<b>Have measures been installed to prevent landfill gas migration (e.g. barriers)?</b>		
D.5f	<b>Has a time-scale been proposed for the installation of landfill gas infrastructure?</b>		
D.5g	<b>Is gas flaring undertaken at the site?</b>		
D.5h	<b>Is there an active (i.e., pumped) landfill gas extraction system?</b>		
D.5i	<b>Does the active system cover all of the filled area?</b>		
D.5j	<b>Is landfill gas used to generate energy at the site?</b>		
D.5k	<b>Have emissions from the flarestack and utilisation plant been assessed for source, composition, quantity and level and rate?</b>		
D.5l	<b>Has a maintenance programme for the control system been specified?</b>		
D.5m	<b>Has a condensate removal system been designed?</b>		

### D.6 Capping System

Complete the following table detailing the design of the capping system. **Attachment D.6** should contain the appropriate documentation. **Items D6e to D6k should only be completed for immediate projects only (ie Years 1 & 2).** Condition 10 of any proposed decision/licence will provide reporting requirements for capping requirements beyond this timeframe.

**Table D.6 Capping System**

		y/n	Comments
D.6a	Has the daily cover been specified?		
D.6b	Has the intermediate cover been specified?		
D.6c	Has the temporary capping been specified?		
D.6d	Has the Capping System been designed and does it meet the requirements of the Landfill Directive Annex 1 (3.3)?		
D.6e	Does the Capping System include a flexible membrane liner?		
D.6f	Have all capping materials been specified?		
D.6g	Has a Method Statement for construction been produced?		
D.6h	Has a Quality Control Plan been produced?		
D.6i	Has a Quality Assurance Plan been produced?		
D.6j	Has a programme for monitoring landfill stability been developed?		
D.6k	Has a programme for monitoring landfill settlement been developed?		



## SECTION E EMISSIONS

Give particulars of the source, location, nature, composition, quantity, level and rate of emissions arising from the activity and, where relevant, the period or periods during which such emissions are made or are to be made.

*The applicant should address in particular any emission point where the substances listed in the Schedule of S.I. 394 of 2004 are emitted.*

### *E.1 Emissions to Atmosphere*

Details of all point emissions to atmosphere should be supplied. Table E.1.(i) (for Landfill Gas Flare emissions) must be completed for all landfills with a flare. Complete Table E.1(ii) and E.1(iii) for all other main emission points, including stack sources (incinerator stacks, landfill gas utilisation plants, air handling unit emissions etc.). Complete Table E.1(iv) for minor/fugitive/ground emission points.

### *E.2 Emissions to Surface Waters*

**Attachment E.2** Tables E.2(i) and E.2(ii) should be completed where relevant.

### *E.3 Emissions to Sewer*

**Attachment E.3** Tables E.3(i) and E.3(ii) should be completed, where relevant.

### *E.4 Emissions to Groundwater*

Describe the existing or proposed arrangements necessary to give effect to Articles 3,4,5,6, and 7 of Council Directive 80/68/EEC of 17 December 1979 on the protection of groundwater against pollution by certain dangerous substances.

Table E.4(i) should be completed, as relevant, for each source.

Supporting information should form **Attachment E.4**

### *E.5 Noise Emissions*

Give particulars of the source, location, nature, level, and the period or periods during which the noise emissions are made or are to be made.

Table E.5(i) should be completed, as relevant, for each source.

Supporting information should form **Attachment E.5**

**E.6 Environmental Nuisances**

**Attachment E.6** should contain the appropriate documentation. Information provided should follow the sequence, and use the headings as relevant established in Table D.6. Additional advice on completing this section is provided in the *Guidance Note*.

**TABLE D.6 ENVIRONMENTAL NUISANCES**

Bird Control	Control method specified	yes <input type="checkbox"/>	no <input type="checkbox"/>	not applicable X
	Attachment included	yes <input type="checkbox"/>	no <input type="checkbox"/>	not applicable X
Dust Control	Control method specified	yes X	no <input type="checkbox"/>	not applicable <input type="checkbox"/>
	Attachment included	yes X	no <input type="checkbox"/>	not applicable <input type="checkbox"/>
Fire Control	Control method specified	yes <input type="checkbox"/>	no <input type="checkbox"/>	not applicable X
	Attachment included	yes <input type="checkbox"/>	no <input type="checkbox"/>	not applicable X
Litter Control	Control method specified	yes <input type="checkbox"/>	no <input type="checkbox"/>	not applicable X
	Attachment included	yes <input type="checkbox"/>	no <input type="checkbox"/>	not applicable X
Traffic Control	Control method specified	yes <input type="checkbox"/>	no <input type="checkbox"/>	not applicable X
	Attachment included	yes <input type="checkbox"/>	no <input type="checkbox"/>	not applicable X
Vermin Control	Control method specified	yes <input type="checkbox"/>	no <input type="checkbox"/>	not applicable X
	Attachment included	yes <input type="checkbox"/>	no <input type="checkbox"/>	not applicable X
Road Cleansing	Control method specified	yes <input type="checkbox"/>	no <input type="checkbox"/>	not applicable X
	Attachment included	yes <input type="checkbox"/>	no <input type="checkbox"/>	not applicable X

For inspection purposes only. Consent of copyright owner required for any other use.

## SECTION F CONTROL & MONITORING

### *F.1: Treatment, Abatement and Control Systems*

Describe the proposed technology and other techniques for preventing or, where this is not possible, reducing emissions from the installation/facility. Details of treatment/abatement systems (air and effluent emissions) should be included, together with schematics as appropriate.

For each Emission Point identified complete Table F.1 of the Annex, and include detailed descriptions and schematics of all abatement systems.

**Attachment F.1** should contain any supporting information.

### **F.2- F. 9. Monitoring and Sampling Points**

Programmes for environmental monitoring should be submitted as part of the application. These programmes should be provided as **Attachments F.2 to F.6** and meet the advice published by the Agency in the relevant BAT Note. For Landfills the additional **Attachments F.7 to F.8** should be completed. Furthermore for a landfill application the applicant must refer to the Agency *Landfill Monitoring Manual (2003)* for further details on monitoring requirements for proposed facilities.

Include details of monitoring/sampling locations and methods.

#### **F.2 Air**

**- to include Dust, Odour**

<b>Monitoring Arrangements specified</b>	yes X	no <input type="checkbox"/>	not applicable <input type="checkbox"/>
<b>Monitoring points identified, (plus 12-figure grid references)</b>	yes X	no <input type="checkbox"/>	not applicable <input type="checkbox"/>
<b>Attachment included</b>	yes X	no <input type="checkbox"/>	not applicable <input type="checkbox"/>

#### **F.3 Surface Water**

Monitoring of surface water shall be carried out at not less than two points, one upstream from the waste facility and one downstream.

<b>Monitoring Arrangements specified</b>	yes X	no <input type="checkbox"/>	not applicable <input type="checkbox"/>
<b>Monitoring points identified, (plus 12-figure grid references)</b>	yes X	no <input type="checkbox"/>	not applicable <input type="checkbox"/>
<b>Attachment included</b>	yes X	no <input type="checkbox"/>	not applicable <input type="checkbox"/>

**F.4 Sewer Discharge**

Monitoring of sewer discharge shall be carried out at the point specified by the local authority/Agency.

<b>Monitoring Arrangements specified</b>	yes <input type="checkbox"/>	no <input type="checkbox"/>	not applicable X
<b>Monitoring points identified, (plus 12-figure grid references)</b>	yes <input type="checkbox"/>	no <input type="checkbox"/>	not applicable X
<b>Attachment included</b>	yes <input type="checkbox"/>	no <input type="checkbox"/>	not applicable X

**F.5 Groundwater**

Groundwater monitoring is required at all landfill facilities; and certain other waste facilities depending on waste activities and the underlying aquifer vulnerability.

<b>Monitoring Arrangements specified</b>	yes X	no <input type="checkbox"/>	not applicable <input type="checkbox"/>
<b>Monitoring points identified, (plus 12-figure grid references)</b>	yes X	no <input type="checkbox"/>	not applicable <input type="checkbox"/>
<b>Attachment included</b>	yes X	no <input type="checkbox"/>	not applicable <input type="checkbox"/>

**F.6 Noise**

<b>Monitoring Arrangements specified</b>	yes X	no <input type="checkbox"/>	not applicable <input type="checkbox"/>
<b>Monitoring points identified, (plus 12-figure grid references)</b>	yes X	no <input type="checkbox"/>	not applicable <input type="checkbox"/>
<b>Attachment included</b>	yes X	no <input type="checkbox"/>	not applicable <input type="checkbox"/>

**F.7 Meteorological Data**

<b>Monitoring Arrangements specified</b>	yes <input type="checkbox"/>	no <input type="checkbox"/>	not applicable X
<b>Monitoring points identified, (plus 12-figure grid references)</b>	yes <input type="checkbox"/>	no <input type="checkbox"/>	not applicable X
<b>Attachment included</b>	yes <input type="checkbox"/>	no <input type="checkbox"/>	not applicable X

*Application for Landfills require the additional Attachments F.7 to F.8, to be completed:*

**F.8 Leachate**

<b>Monitoring Arrangements specified</b>	yes <input type="checkbox"/>	no <input type="checkbox"/>	not applicable <input type="checkbox"/>
<b>Monitoring points identified, (plus 12-figure grid references)</b>	yes <input type="checkbox"/>	no <input type="checkbox"/>	not applicable <input type="checkbox"/>
<b>Attachment included</b>	yes <input type="checkbox"/>	no <input type="checkbox"/>	not applicable <input type="checkbox"/>

### F.9 Landfill Gas

Complete each of the following tables to show whether information has been included on aspects of landfill gas monitoring. **Attachment F.9** should also contain information to show whether the data given in Tables F.9.(a) and F.9(b) below represents actual or anticipated data. Complete Table F.9 as follows:

Table F.9 (a) Landfill Gas Monitoring for existing landfill gas flares / utilisation plants

Parameter	Concentration (mg/Nm <sup>3</sup> )	Proposed Frequency of Analysis	Information Included Y/N	Method of Analysis	Information Included Y/N
<b>Inlet</b>					
Methane (CH <sub>4</sub> ) % v/v					
Carbon dioxide (CO <sub>2</sub> ) %v/v					
Oxygen (O <sub>2</sub> ) % v/v					
<b>Outlet</b>					
Volumetric Flow Rate					
SO <sub>2</sub>					
Nox					
CO					
Particulates					
TA Luft Class I, II, III organics					
Hydrochloric acid					
Hydrogen Fluoride					

Table F.9(b) Landfill Gas Monitoring

Parameter	Proposed Frequency of Analysis		Information Included Y/N	Method of Analysis	Information Included Y/N
	Gas boreholes / vents/ wells/ perimeter locations	Facility Office			
Methane (CH <sub>4</sub> ) % v/v					
Carbon Dioxide (CO <sub>2</sub> ) % v/v					
Oxygen (O <sub>2</sub> ) % v/v					
Atmospheric Pressure					
Temperature					

Table F.9 (c) Landfill Gas Infrastructure

Equipment	Monitoring Frequency	Information Included Y/N	Monitoring Action	Information Included Y/N
Gas Collection System				
Gas Control System				

<b>Monitoring Arrangements specified</b>	yes <input type="checkbox"/>	no <input type="checkbox"/>	not applicable <input type="checkbox"/>
<b>Monitoring points identified, (plus 12-figure grid references)</b>	yes <input type="checkbox"/>	no <input type="checkbox"/>	not applicable <input type="checkbox"/>
<b>Attachment included</b>	yes <input type="checkbox"/>	no <input type="checkbox"/>	not applicable <input type="checkbox"/>

**SECTION G RESOURCES USE & ENERGY EFFICIENCY**

**G.1 Raw Materials, Substances, Preparations and Energy**

**Attachment G.1** should contain a list of all raw, product and ancillary materials, substances, preparations, fuels and energy which will be utilised in or produced by the activity. Information on any insecticides, herbicides or rat poisons etc. should also be provided with their respective data and safety sheets. The Standard Forms, provided in Annex 1, should be used in the description of these materials, substances, etc., where relevant. Additional advice on completing this section is provided in the *Guidance Note*.

<b>Attachment included</b>	yes <b>X</b> no <input type="checkbox"/> not applicable <input type="checkbox"/>
----------------------------	--

**G.2 Energy Efficiency**

A description of the energy used in or generated by the activity must be provided in **Attachment G.2**.

<b>Attachment included</b>	yes <b>X</b> no <input type="checkbox"/> not applicable <input type="checkbox"/>
----------------------------	--

For inspection purposes only. Consent of copyright owner required for any other use.

## SECTION H MATERIALS HANDLING

### H.1 Waste Types and Quantities – Existing & Proposed

Provide an estimation of the quantity of waste likely to be handled in relation to each class of activity applied for. This information should be included in Table H.1(a).

**TABLE H.1(A). QUANTITIES OF WASTE IN RELATION TO EACH CLASS OF ACTIVITY APPLIED FOR**

Waste Management Act 4 <sup>th</sup> Schedule (Recovery) Activities	
Class of Activity Applied For	Quantity (tpa)
Class 1	Please refer to the attachment
Class 2	
Class 3	
Class 4	
Class 5	
Class 6	
Class 7	
Class 8	
Class 9	
Class 10	
Class 11	
Class 12	
Class 13	

For inspection purposes only. Consent of copyright owner required for any other use.

In Table H. 1 (B) provide the annual amount of waste handled/to be handled at the facility. Additional information should be included in **Attachment H.1**. The tonnage per annum should be given of that expected for the life of the licence, with at least the next five years tonnages provided. For Landfill Review applications provide an estimate of the quantity of waste already deposited in (i) lined cells; (ii) unlined cells.

**TABLE H.1(B) ANNUAL QUANTITIES AND NATURE OF WASTE**

Year	Non-hazardous waste (tonnes per annum)	Hazardous waste (tonnes per annum)	Total annual quantity of waste (tonnes per annum)
2006	8,716	4,839	13, 556
2007	10,023	5,565	15,589
2008	11,528	6,400	17,928
2009	13,257	7,360	20,000

\* 2007-2009 Figures are based on 15% projected increase in waste acceptance at the site and effectively levelling off to 20,000 tonnes (dependant on contracts secured by KMK Metals).

A detailed inventory of the types and quantities of wastes currently handled at the site and proposed to be handled should be submitted as Table H.1 (C).

**TABLE H.1 (C) WASTE TYPES AND QUANTITIES**

WASTE TYPE	TONNES PER ANNUM (existing)	TONNES PER ANNUM (proposed)	TOTAL (over life of site) tonnes
Household			
Commercial			
Sewage Sludge			
Construction and Demolition			
Industrial Non-Hazardous Sludges			
Industrial Non-Hazardous Solids			
Hazardous *(Specify detail in Table H 1.2)			
Inert Waste imported for restoration purposes	COMPLETE FOR LANDFILL & CONTAMINATED LAND FACILITIES ONLY		

**\* TABLE H.1.2 HAZARDOUS WASTE TYPES AND QUANTITIES**

HAZARDOUS WASTE	DETAILED DESCRIPTION * REFERENCE SHOULD BE MADE TO THE RELEVANT EUROPEAN WASTE CATALOGUE CODES AS PRESENTED BY COMMISSION DECISION 2000/532/EC	Tonnes Per Annum (Existing)	(Tonnes Per Annum Proposed)
Waste Oil			
Oil filters			
Asbestos			
Paint and Ink			
Batteries			
Fluorescent Light Bulbs			
Contaminated Soils			
<b>OTHER HAZARDOUS WASTE (APPLICANT TO SPECIFY)</b>			
See waste acceptance sheets attached for year ending 2006 taken from the most recent annual environmental report (AER).			



## ***Waste Received in 2006***

For inspection purposes only.  
Consent of copyright owner required for any other use.

**Table 1: Total Amenity waste received in 2006 at KMK Metals Recycling Ltd.**

<b>Point of Collection</b>	<b>Description Of Waste</b>	<b>EWC Code</b>	<b>Qty Tonnes</b>
Civic Amenity	Paper and cardboard	15 01 01	2.487
Civic Amenity	Discarded equipment containing chlorofluorocarbons, HCFC, HFC	16 02 11*	1223.653
Civic Amenity	Discarded equipment containing hazardous components other than those mentioned in 16 02 09 to 16 02 12	16 02 13*	430.305
Civic Amenity	Discarded equipment other than those mentioned in 16 02 09 to 16 02 13	16 02 14	508.535
Civic Amenity	Components removed from discarded equipment other than those mentioned in 16 02 15	16 02 16	237.514
Civic Amenity	Lead batteries	16 06 01*	8.26
Civic Amenity	Alkaline batteries (except 16 06 03)	16 06 04	1.3
Civic Amenity	Discarded equipment containing chlorofluorocarbons	20 01 23*	12.565
Civic Amenity	Discarded electrical and electronic equipment other than those mentioned in 20 01 21 and 20 01 23 containing hazardous components	20 01 35*	18.49
Civic Amenity	Discarded electrical and electric equipment other than those mentioned in 20 01 21, 20 01 23 and 20 01 35	20 01 36	4928.64
<b>TOTAL</b>			<b>7371.749</b>

For inspection purposes only.  
Consent of copyright owner required for any other use.

**Table 2: Total Commercial waste received in 2006 at KMK Metals Recycling Ltd.**

<b>Point of Collection</b>	<b>Description Of Waste</b>	<b>EWC Code</b>	<b>Qty Tonnes</b>
Commercial	Wastes not otherwise specified	06 04 99	30.695
Commercial	Ferrous metal filings and turnings	12 01 01	18.514
Commercial	Ferrous metal dust and particles	12 01 02	0.635
Commercial	Non-ferrous metal filings and turnings	12 01 03	3.512
Commercial	Non-ferrous metal dust and particles	12 01 04	0.684
Commercial	Welding wastes	12 01 13	4.295
Commercial	Wood other than mentioned in 20 01 37	15 01 03	2.96
Commercial	Mixed packaging	15 01 06	0.388
Commercial	Wastes not otherwise specified	15 02 01	0.025
Commercial	Absorbents, filter materials, wiping cloths and protective clothing other than those mentioned in 15 02 02	15 02 03	0.413
Commercial	Discarded equipment containing chlorofluorocarbons, HCFC, HFC	16 02 11*	1472.852
Commercial	Discarded equipment containing hazardous components other than those mentioned in 16 02 09 to 16 02 12	16 02 13*	592.18
Commercial	Discarded equipment other than those mentioned in 16 02 09 to 16 02 13	16 02 14	1022.533
Commercial	Hazardous components removed from discarded equipment(capacitors)	16 02 15*	2.18
Commercial	Components removed from discarded equipment other than those mentioned in 16 02 15	16 02 16	131.541
Commercial	Lead batteries	16 06 01*	148.983
Commercial	Ni-Cd batteries	16 06 02*	0.17
Commercial	Alkaline batteries	16 06 04	13.689
Commercial	Other batteries and accumulators	16 06 05	0.71
Commercial	Glass	20 01 02	0.323
Commercial	Fluorescent tubes and other mercury-containing waste	20 01 21*	1.455
Commercial	Discarded equipment containing chlorofluorocarbons	20 01 23*	0.752
Commercial	Discarded electrical and electronic equipment other than those mentioned in 20 01 21 and 20 01 23 containing hazardous components	20 01 35*	39.962
Commercial	Discarded electrical and electric equipment other than those mentioned in 20 01 21, 20 01 23 and 20 01 35	20 01 36	0
<b>TOTAL</b>			<b>3489.450</b>

**Table 3: Total Industrial waste received in 2006 at KMK Metals Recycling Ltd.**

<b>Point of Collection</b>	<b>Description Of Waste</b>	<b>EWC Code</b>	<b>Qty Tonnes</b>
Industrial	Wastes not otherwise specified	06 04 99	210.098
Industrial	Sludges from on-site effluent treatment containing dangerous solutions	06 05 02*	31.19
Industrial	Wastes not otherwise specified	06 13 99	56.939
Industrial	Photographic film and paper containing silver or silver compounds	09 01 07	0.344
Industrial	Dross and skimmings from primary and secondary production	10 04 02*	8.663
Industrial	Sludges and filter cakes containing dangerous substances	11 01 09*	186.402
Industrial	Ferrous metal filings and turnings	12 01 01	42.113
Industrial	Ferrous metal dust and particles	12 01 02	124.649
Industrial	Non-ferrous metal filings and turnings	12 01 03	139.459
Industrial	Non-ferrous metal dust and particles	12 01 04	61.747
Industrial	Welding wastes	12 01 13	19.757
Industrial	Waste blasting material other than those mentioned in 12 01 16	12 01 17	13.088
Industrial	Spent grinding bodies and grinding materials containing dangerous substances	12 01 20*	19.991
Industrial	Paper and cardboard	15 01 01	7.022
Industrial	Wood other than mentioned in 20 01 37	15 01 03	12.043
Industrial	Mixed packaging	15 01 06	30.638
Industrial	Absorbents, filter materials, wiping cloths and protective clothing other than those mentioned in 15 02 02	15 02 03	2.395
Industrial	Discarded equipment containing chlorofluorocarbons, HCFC, HFC	16 02 11*	29.636
Industrial	Discarded equipment containing hazardous components other than those mentioned in 16 02 09 to 16 02 12	16 02 13*	66.3762
Industrial	Discarded equipment other than those mentioned in 16 02 09 to 16 02 13	16 02 14	289.353
Industrial	Hazardous components removed from discarded equipment (capacitors)	16 02 15*	17.758
Industrial	Components removed from discarded equipment other than those mentioned in 16 02 15	16 02 16	244.172
Industrial	Lead batteries	16 06 01*	56.365
Industrial	Ni-Cd batteries	16 06 02*	0.843
Industrial	Alkaline batteries	16 06 04	1.316
Industrial	Lead	17 04 03	1.9205
Industrial	Sludges from physico/chemical treatment containing dangerous substances	19 02 05*	237.484
Industrial	Glass	20 01 02	0.481
Industrial	Fluorescent tubes and other mercury-containing waste	20 01 21*	0.415
Industrial	Discarded electrical and electronic equipment other than those mentioned in 20 01 21 and 20 01 23 containing hazardous components	20 01 35*	16.721
Industrial	Discarded electrical and electric equipment other than those mentioned in 20 01 21, 20 01 23 and 20 01 35	20 01 36	0
<b>TOTAL</b>			<b>1929.377</b>

**Table 4: Total waste received at the Transfer Station in 2006 at KMK Metals Recycling Ltd.**

<b>Point of Collection</b>	<b>Description Of Waste</b>	<b>EWC Code</b>	<b>Qty Tonnes</b>
Transfer Station	Ferrous metal filings and turnings	12 01 01	44.701
Transfer Station	Ferrous metal dust and particles	12 01 02	11.363
Transfer Station	Non-ferrous metal filings and turnings	12 01 03	2.925
Transfer Station	Discarded equipment containing chloroflouorocarbons, HCFC, HFC	16 02 11*	84.101
Transfer Station	Discarded equipment containing hazardous components other than those mentioned in 16 02 09 to 16 02 12	16 02 13*	43.923
Transfer Station	Discarded equipment other than those mentioned in 16 02 09 to 16 02 13	16 02 14	52.314
Transfer Station	Components removed from discarded equipment other than those mentioned in 16 02 15	16 02 16	269.391
Transfer Station	Lead batteries	16 06 01*	87.57
Transfer Station	Alkaline batteries	16 06 04	2.287
Transfer Station	Glass	20 01 02	0.421
Transfer Station	Fluorescent tubes and other mercury-containing waste	20 01 21*	0.171
Transfer Station	Discarded electrical and electric equipment other than those mentioned in 20 01 21, 20 01 23 and 20 01 35	20 01 36	166.141
<b>TOTAL</b>			<b>765.308</b>

For inspection purposes only. Consent of copyright owner required for any reuse.

**Attachment H.1** should contain any relevant additional information.

**It should be noted that an applicant may be issued with a licence which restricts the type of wastes which may be deposited.**

### ***H.2 Waste Acceptance Procedures***

Procedures for checking waste loads as they arrive at the facility must be included. These should follow the requirements of the Agency's Waste Acceptance Manual. A copy of these procedures and other associated documentation should be included as **Attachment H.2**.

### ***H.3 Waste Handling***

Waste handling and the operating procedures used at the facility including waste treatment processes should be described in **Attachment H.3**. Included in the attachment should be information on the plant used on site and on the methods and processes for handling waste on-site. Special requirements hold for contaminated soil facilities, see *Guidance Note*.

**In addition, an application for a Landfill requires Section H.3.a to be completed:**

#### ***H.3a Waste Handling at the Landfill Facility***

State whether all waste will be subject to treatment prior to landfilling. Provide information as to the quantities of biodegradable municipal waste and how the targets of the Landfill Directive (1999/31/EC) relating to that waste type are to be achieved. In particular describe how the following will be achieved:

- (a) a reduction by 16/07/06 to 75% by weight of the total amount of biodegradable municipal waste produced in 1995 or the latest year before 1995 for which standardised Eurostat data is available;
- (b) a reduction by 16/07/09 to 50% by weight of the total amount of biodegradable municipal waste produced in 1995 or the latest year before 1995 for which standardised Eurostat data is available;
- (c) a reduction by 16/07/16 to 35% by weight of the total amount of biodegradable municipal waste produced in 1995 or the latest year before 1995 for which standardised Eurostat data is available;
- (d) Evidence should be provided to show that energy will be used efficiently.

### **H.4 Waste Arisings**

Waste Arisings should be considered for all contaminated soil applications. Details of all waste materials generated on the site including, name, description and nature

as well as the source(s) should be identified. The quantities of each type of waste generated on an annual/monthly basis should be calculated and stated in Tables H.1(i) and H. 1(ii) of the application form. Applicants should also provide conversion factors used to relate volume (m<sup>3</sup>) and tonnage (t) for their waste stream.

## **SECTION I EXISTING ENVIRONMENT & IMPACT OF THE FACILITY**

Detailed information is required to enable the Agency to assess the existing environment. This section requires the provision of information on the ambient environmental conditions at the site prior to the commencement of waste management activities or prior to the receipt of a review application.

Where development is proposed to be carried out, being development which is of a class for the time being specified under Article 24 (First Schedule) of the Environmental Impact Assessment Regulations, the information on the state of the existing environment should be addressed in the EIS. **In such cases, it will suffice for the purposes of this section to provide adequate cross-references to the relevant sections in the EIS.**

### I.1. Assessment of atmospheric emissions

Describe the existing environment in terms of air quality with particular reference to ambient air quality standards.

Provide a statement whether or not emissions of main polluting substances (as defined in the Schedule of S.I. 394 of 2004) to the atmosphere are likely to impair the environment.

Give summary details and an assessment of the impacts of any existing or proposed emissions on the environment, including environmental media other than those into which the emissions are to be made.

**Attachment I.1** should also contain full details of any dispersion modelling of atmospheric emissions from the activity, where required.

### I.2. Assessment of Impact on Receiving Surface Water

Describe the existing environment in terms of water quality with particular reference to environmental quality standards or other legislative standards. Table I.2(i) should be completed

Provide a statement whether or not emissions of main polluting substances (as defined in the Schedule of S.I. 394 of 2004) to water are likely to impair the environment.

Give summary details and an assessment of the impacts of any existing or proposed emissions on the environment, including environmental media other than those into which the emissions are to be made.

Full details of the assessment and any other relevant information on the receiving environment should be submitted as **Attachment I.2**.

### I.3. Assessment of Impact of Sewage Discharge.

Give summary details and an assessment of the impacts of any existing or proposed emissions on the environment, including environmental media other than those into which the emissions are to be made.

Full details of the assessment and any other supporting information should form **Attachment I.3**.

### I.4 Assessment of impact of ground/groundwater emissions

The scope and detail of this assessment will depend to a large extent on the extent and type of ground emissions at any site, which in turn are related to the risk. Details should be included in **Attachment I.4**. Comprehensive guidelines are contained in the *Application Guidance Note*, and include particular requirements for landfill and brownfield facilities.

Describe the existing groundwater quality. Tables I.4(i) should be completed.

### I.5 Ground and/or groundwater contamination

Summary details of known ground and/or groundwater contamination, historical or current, on or under the site must be given.

Full details including all relevant investigative studies, assessments, or reports, monitoring results, location and design of monitoring installations, plans, drawings, documentation, including containment engineering, remedial works, and any other supporting information should be included in **Attachment I.5**.

### I.6 Noise Impact.

Give details and an assessment of the impacts of any existing or proposed emissions on the environment, including environmental media other than those into which the emissions are to be made.

Ambient noise measurements

Complete Table I.6(i) in relation to the information required below:

- (i) State the maximum Sound Pressure Levels which will be experienced at typical points on the boundary of the operation. (State sampling interval and duration)



- (ii) State the maximum Sound Pressure Levels which will be experienced at typical noise sensitive locations, outside the boundary of the operation.
- (iii) Give details of the background noise levels experienced at the site in the absence of noise from this operation.

Prediction models, maps, diagrams and supporting documents, including details of noise attenuation and noise proposed control measures to be employed, should form **Attachment I.6.**

I.7 Assessment of Ecological Impacts & Mitigation Measures

The ecology of the site and the surrounding area should be assessed in the vicinity of the largescale waste facilities such as landfill or incinerator developments. An assessment of the ecology should form **Attachment I.7.** Comprehensive guidelines are contained in the *Application Guidance Note*

**SECTION J ACCIDENT PREVENTION & EMERGENCY RESPONSE**

Describe the existing or proposed measures, including emergency procedures, to minimise the impact on the environment of an accidental emission or spillage.

Also outline what provisions have been made for response to emergency situations outside of normal working hours, i.e. during night-time, weekends and holiday periods.

Describe the arrangements for abnormal operating conditions including start-up, leaks, malfunctions or momentary stoppages.

Supporting information should form **Attachment J.**

<b>Attachment included</b>	yes <input checked="" type="checkbox"/>	no <input type="checkbox"/>	not applicable <input type="checkbox"/>
----------------------------	---	-----------------------------	---

**SECTION K REMEDIATION, DECOMMISSIONING, RESTORATION  
AND AFTERCARE**

Describe the existing or proposed measures to minimise the impact on the environment after the activity or part of the activity ceases operation, including provision for post-closure care of any potentially polluting residuals.

For Landfill Applications, capping proposals are required, and reference should be made to the *Landfill Manual on 'Restoration and Aftercare'* published by the Agency, when completing this section.

<b>Attachment included</b>	<b>yes</b> <input checked="" type="checkbox"/>	<b>no</b> <input type="checkbox"/>	<b>not applicable</b> <input type="checkbox"/>
----------------------------	--	------------------------------------	--

**SECTION L STATUTORY REQUIREMENTS**

**L. 1 Section 40(4) WMA**

Indicate how all the requirements of Section 40(4)[(a) to (f)] of the Waste Management Acts 1996 to 2003 will be met.

Applicants should also describe how the proposed facility will comply with the requirements of BAT. In particular reference should be made to the considerations referred to in Annex IV of Council Directive 96/61/EC concerning integrated pollution prevention and control.

**Attachment L.1** should contain the documentation requested above, along any relevant additional information.

<b>Attachment included</b>	<b>yes</b> <input type="checkbox"/>	<b>no</b> <input type="checkbox"/>	<b>not applicable</b> <input type="checkbox"/>
----------------------------	-------------------------------------	------------------------------------	--

**L.2 Fit and Proper Person**

The WMA in Section 40(4)(d) specifies that the Agency shall not grant a licence unless it is satisfied that the applicant (if the applicant is not a local authority) is a fit and proper person. Section 40(7) of the WMA specifies the information required to enable a determination to be made by the Agency.

- Indicate whether the applicant or other relevant person has been convicted under the Waste Management Acts 1996 to 2003, the EPA Act 1992 and 2003, the Local Government (Water Pollution) Acts 1977 and 1990 or the Air Pollution Act 1987.

- Provide details of the applicant’s technical knowledge and/or qualifications, along with that of other relevant employees (Link to Section C.1 of the application).
- Provide information to show that the person is likely to be in a position to meet any financial commitments or liabilities that may have been or will be entered into or incurred in carrying on the activity to which the application relates or in consequence of ceasing to carry out that activity (Link to Section K of the application).

Supporting information should be included as **Attachment L 2** with reference to where the information can be found in the application.

<b>Attachment included</b>	<b>yes</b> <input type="checkbox"/>	<b>no</b> <input type="checkbox"/>	<b>not applicable</b> <input type="checkbox"/>
----------------------------	-------------------------------------	------------------------------------	--

For inspection purposes only.  
 Consent of copyright owner required for any other use.

**SECTION M DECLARATION**

**Declaration**

I hereby make application for a licence / revised licence, pursuant to the provisions of the Waste Management Acts 1996 to 2003 and Regulations made thereunder.

I certify that the information given in this application is truthful, accurate and complete.

I have no objection to the provision by the Agency or local authority of a copy of the application or parts thereof to any person.

**Signed by :** \_\_\_\_\_  
*(on behalf of the organisation)*

**Date :** \_\_\_\_\_

**Print signature name:** \_\_\_\_\_

**Position in organisation :** \_\_\_\_\_

For inspection purposes only.  
Consent of copyright owner required for any other use.

*Company stamp or seal:*

## ANNEX 1 STANDARD FORMS

Standard forms are provided in this section for the recording and presentation of environmental monitoring and site investigation results

**TABLE E.1(i) LANDFILL GAS FLARE EMISSIONS TO ATMOSPHERE**  
**Emission Point:**

Emission Point Ref. N <sup>o</sup> :	
Location :	
Grid Ref. (12 digit, 6E,6N):	
<b>Vent Details</b>  Diameter:  Height above Ground(m):	
Date of commencement of emission:	

**Characteristics of Emission:**

CO	mg/m <sup>3</sup>
Total organic carbon (TOC)	mg/m <sup>3</sup>
NO <sub>x</sub>	mg/Nm <sup>3</sup> 0°C. 3% O <sub>2</sub> (Liquid or Gas), 6% O <sub>2</sub> (Solid Fuel)
Maximum volume of emission	m <sup>3</sup> /hr
Temperature	°C(max)      °C(min)      °C(avg)

- (i) Period or periods during which emissions are made, or are to be made, including daily or seasonal variations (*start-up/shutdown to be included*):

Periods of Emission (avg)	_____min/hr    _____hr/day    _____day/yr
---------------------------	---

**TABLE E.1(ii) MAIN EMISSIONS TO ATMOSPHERE** (1 Page for each emission point)

**SEE ATTACHMENTS E AND F**

Emission Point Ref. N <sup>o</sup> :	
Source of Emission:	
Location :	
Grid Ref. (12 digit, 6E,6N):	
Vent Details Diameter:	
Height above Ground(m):	
Date of commencement:	

**Characteristics of Emission :**

(i) Volume to be emitted:			
Average/day	m <sup>3</sup> /d	Maximum/day	m <sup>3</sup> /d
Maximum rate/hour	m <sup>3</sup> /h	Min efflux velocity	m.sec <sup>-1</sup>
(ii) Other factors			
Temperature	°C(max)	°C(min)	°C(avg)
For Combustion Sources:			
Volume terms expressed as : <input type="checkbox"/> wet. <input type="checkbox"/> dry. _____%O <sub>2</sub>			

(iii) Period or periods during which emissions are made, or are to be made, including daily or seasonal variations (*start-up /shutdown to be included*):

Periods of Emission (avg)	_____ min/hr _____ hr/day _____ day/yr
---------------------------	--

**TABLE E.1(iii): MAIN EMISSIONS TO ATMOSPHERE - Chemical characteristics of the emission** (1 table per emission point)

*Emission Point Reference Number:* \_\_\_\_\_

Parameter	Prior to treatment <sup>(1)</sup>			Brief description of treatment	As discharged <sup>(1)</sup>										
	mg/Nm <sup>3</sup>		kg/h		mg/Nm <sup>3</sup>		kg/h.		kg/year						
	Avg	Max	Avg		Max	Avg	Max	Avg	Max						

Consent of copyright owner required for any other use.  
For inspection purposes only.

1. Concentrations should be based on Normal conditions of temperature and pressure, (i.e. 0°C,101.3kPa). Wet/dry should be the same as given in Table E.1(ii) unless clearly stated otherwise.

**TABLE E.1(iv): EMISSIONS TO ATMOSPHERE - Minor /Fugitive**

**SEE ATTACHMENTS E AND F**

Emission point Reference Numbers	Description	Emission details <sup>1</sup>			Abatement system employed
		material	mg/Nm <sup>3(2)</sup>	kg/h.	

Consent of copyright owner required for any other use.  
For inspection purposes only.

- 1 The maximum emission should be stated for each material emitted, the concentration should be based on the maximum 30 minute mean.
- 2 Concentrations should be based on Normal conditions of temperature and pressure, (i.e. 0°C/101.3kPa). Wet/dry should be clearly stated. Include reference oxygen conditions for combustion sources.



**SEE ATTACHMENTS E AND F**

**TABLE E.2(i): EMISSIONS TO SURFACE WATERS**  
(One page for each emission)

**Emission Point:**

Emission Point Ref. N <sup>o</sup> :	
Source of Emission:	
Location :	
Grid Ref. (10 digit, 5E,5N):	
Name of receiving waters:	
Flow rate in receiving waters:	_____ m <sup>3</sup> .sec <sup>-1</sup> Dry Weather Flow _____ m <sup>3</sup> .sec <sup>-1</sup> 95%ile flow
Available waste assimilative capacity:	kg/day

Consent of copyright owner required for any other use.  
For inspection purposes only.

**Emission Details:**

(i) Volume to be emitted		
Normal/day	m <sup>3</sup>	Maximum/day
Maximum rate/hour	m <sup>3</sup>	

(ii) Period or periods during which emissions are made, or are to be made, including daily or seasonal variations (*start-up /shutdown to be included*):

Periods of Emission (avg)	_____min/hr	_____hr/day	_____day/yr
---------------------------	-------------	-------------	-------------

For inspection purposes only. Consent of copyright owner required for any other use.

**TABLE E.2(ii): EMISSIONS TO SURFACE WATERS - Characteristics of the emission** (1 table per emission point)

**Emission point reference number :** \_\_\_\_\_

Parameter	Prior to treatment			As discharged			% Efficiency	
	Max. hourly average (mg/l)	Max. daily average (mg/l)	kg/day	kg/year	Max. hourly average (mg/l)	Max. daily average (mg/l)		kg/day

For inspection purposes only. Consent of copyright owner required for any other use.

**TABLE E.3(i): EMISSIONS TO SEWER**(One page for each emission)

**NOT APPLICABLE**

**Emission Point:**

Emission Point Ref. N <sup>o</sup> :	
Location of connection to sewer :	
Grid Ref. (10 digit, 5E,5N):	
Name of sewage undertaker:	

**Emission Details:**

(i) Volume to be emitted			
Normal/day	m <sup>3</sup>	Maximum/day	m <sup>3</sup>
Maximum rate/hour	m <sup>3</sup>		

(ii) Period or periods during which emissions are made, or are to be made, including daily or seasonal variations (*start-up /shutdown to be included*):

Periods of Emission (avg)	_____ min/hr _____ hr/day _____ day/yr
---------------------------	--

**TABLE E.3(ii): EMISSIONS TO SEWER - Characteristics of the emission** (1 table per emission point)

**Emission point reference number :** \_\_\_\_\_

Parameter	Prior to treatment			As discharged			% Efficiency	
	Max. hourly average (mg/l)	Max. daily average (mg/l)	kg/day	kg/year	Max. hourly average (mg/l)	Max. daily average (mg/l)		kg/day

Consent of copyright owner required for any other use.  
For inspection purposes only.

For inspection purposes only.  
Consent of copyright owner required for any other use.

**SEE ATTACHMENTS E AND F**

**TABLE E.4(i): EMISSIONS TO GROUNDWATER** (1 Page for each emission point)

**Emission Point or Area:**

Emission Point/Area Ref. N°:	
Emission Pathway: (borehole, well, percolation area, soakaway, landspreading, etc.)	
Location :	
Grid Ref. (10 digit, 5E,5N):	
Elevation of discharge: (relative to Ordnance Datum)	
Aquifer classification for receiving groundwater body:	
Groundwater vulnerability assessment (including vulnerability rating):	
Identity and proximity of groundwater sources at risk (wells, springs, etc):	
Identity and proximity of surface water bodies at risk:	

Consent of copyright owner required for any other use.  
For inspection purposes only.

--	--

**Emission Details:**

(i) Volume to be emitted		
Normal/day	m <sup>3</sup>	Maximum/day
Maximum rate/hour	m <sup>3</sup>	

(ii) Period or periods during which emissions are made, or are to be made, including daily or seasonal variations (*start-up /shutdown to be included*):

Periods of Emission (avg)	_____min/hr	_____hr/day	_____day/yr
---------------------------	-------------	-------------	-------------

For inspection purposes only.  
Consent of copyright owner required for any other use.



**Table E.5(6): NOISE EMISSIONS - Noise sources summary sheet**

Source	Emission point Ref. No	Equipment Ref. No	Sound Pressure <sup>1</sup> dBA at reference distance	Octave bands (Hz)								Impulsive or tonal qualities	Periods of Emission			
				31.5	63	125	250	500	1K	2K	4K			8K		

Consent of copyright owner required for any other use.  
For inspection purposes only.

1. For items of plant sound power levels may be used.

**TABLE F.1: ABATEMENT / TREATMENT CONTROL**

*Emission point reference number* : \_\_\_\_\_

Control <sup>1</sup> parameter	Equipment <sup>2</sup>	Equipment maintenance	Equipment calibration	Equipment back-up

Control <sup>1</sup> parameter	Monitoring to be carried out <sup>3</sup>	Monitoring equipment	Monitoring equipment calibration

<sup>1</sup> List the operating parameters of the treatment / abatement system which control its function.

<sup>2</sup> List the equipment necessary for the proper function of the abatement / treatment system.

<sup>3</sup> List the monitoring of the control parameter to be carried out.

Copyright reserved. For inspection purposes only. Owner required for any other use.

SEE ATTACHMENTS E AND F

**TABLE F.2 to F.8 : EMISSIONS MONITORING AND SAMPLING POINTS - ( 1 table per media)**

*Emission Point Reference No(s)* : \_\_\_\_\_

Parameter	Monitoring frequency	Accessibility of Sampling Points

Copyright of copyright owner required for any other use.  
For inspection purposes only.

**TABLE Ff: Fugitive ENVIRONMENT MONITORING AND SAMPLING LOCATIONS ( 1 table per media)**

*Monitoring Point Reference No* : \_\_\_\_\_

Parameter	Monitoring frequency	Accessibility of Sampling point

*For inspection purposes only.  
Consent of copyright owner required for any other use.*

**NO DEVIATIONS FROM EXISTING LICENCE SEE ATTACHMENT G**

**Table G.1 Details of Process related Raw Materials, Intermediates, Products, etc., used or generated on the site**

Ref. N° or Code	Material/ Substance <sup>(1)</sup>	CAS Number	Danger <sup>(2)</sup> Category	Amount Stored (tonnes)	Annual Usage (tonnes)	Nature of Use	R <sup>(3)</sup> - Phrase	S <sup>(3)</sup> - Phrase

For inspection purposes only.  
Consent of copyright owner required for any other use.

- Notes:
1. In cases where a material comprises a number of distinct and available dangerous substances, please give details for each component substance.
  2. c.f. Article 2(2) of SI N° 77/94
  3. c.f. Schedules 2 and 3 of SI N° 77/94

**NO DEVIATIONS FROM EXISTING LICENCE SEE ATTACHMENT H**

**TABLE H.1(i): WASTE - Hazardous Waste Recovery/Disposal**

Waste material	EWC Code	Main source <sup>1</sup>	Quantity		On-site Recovery/Disposal (Method & Location )	Off-site Recovery, reuse or recycling (Method, Location & Undertaker)	Off-site Disposal (Method, Location & Undertaker)
			Tonnes / month	m <sup>3</sup> / month			

*Consent of copyright owner required for any other use.  
For inspection purposes only.*

<sup>1</sup> A reference should be made to the main activity / process for each waste.

For inspection purposes only.  
Consent of copyright owner required for any other use.

**TABLE H.1(ii) WASTE - Other Waste Recovery/Disposal**

Waste material	EWC Code	Main source <sup>1</sup>	Quantity		On-site recovery/disposal <sup>2</sup> (Method & Location)	Off-site Recovery, reuse or recycling (Method, Location & Undertaker)	Off-site Disposal (Method, Location & Undertaker)
			Tonnes / month	m <sup>3</sup> / month			

Consent of copyright owner required for any other use.  
For inspection purposes only.

- 1 A reference should be made to the main activity/ process for each waste.
- 2 The method of disposal or recovery should be clearly described and referenced to Attachment H.1



SEE ATTACHMENTS E AND F

**Table I.2(i) SURFACE WATER QUALITY**

(Sheet 1 of 2) Monitoring Point/ Grid Reference: \_\_\_\_\_

Parameter	Results (mg/l)			Sampling method <sup>2</sup> (grab, drift etc.)	Normal Analytical Range <sup>2</sup>	Analysis method / technique
	Date	Date	Date			
pH						
Temperature						
Electrical conductivity EC						
Ammoniacal nitrogen NH <sub>4</sub> -N						
Chemical oxygen demand						
Biochemical oxygen demand						
Dissolved oxygen DO						
Calcium Ca						
Cadmium Cd						
Chromium Cr						
Chloride Cl						
Copper Cu						
Iron Fe						
Lead Pb						
Magnesium Mg						
Manganese Mn						
Mercury Hg						

Consent of copyright owner required for any other use.  
For inspection purposes only.

SEE ATTACHMENTS E AND F

Surface Water Quality (Sheet 2 of 2)

Parameter	Results (mg/l)				Sampling method (grab, drift etc.)	Normal Analytical Range	Analysis method / technique
	Date	Date	Date	Date			
Nickel Ni							
Potassium K							
Sodium Na							
Sulphate SO <sub>4</sub>							
Zinc Zn							
Total alkalinity (as CaCO <sub>3</sub> )							
Total organic carbon TOC							
Total oxidised nitrogen TON							
Nitrite NO <sub>2</sub>							
Nitrate NO <sub>3</sub>							
Faecal coliforms ( /100mls)							
Total coliforms ( /100mls)							
Phosphate PO <sub>4</sub>							

Consent of copyright owner required for any other use.  
For inspection purposes only.

SEE ATTACHMENTS E AND F

**Table I.4(i) GROUNDWATER QUALITY**

(Sheet 1 of 2) Monitoring Point/ Grid Reference:

Parameter	Results (mg/l)				Sampling method (composite etc.)	Normal Analytical Range	Analysis method / technique
	Date	Date	Date	Date			
pH							
Temperature							
Electrical conductivity EC							
Ammoniacal nitrogen NH <sub>4</sub> -N							
Dissolved oxygen DO							
Residue on evaporation (180°C)							
Calcium Ca							
Cadmium Cd							
Chromium Cr							
Chloride Cl							
Copper Cu							
Cyanide Cn, total							
Iron Fe							
Lead Pb							
Magnesium Mg							
Manganese Mn							
Mercury Hg							
Nickel Ni							
Potassium K							
Sodium Na							

Consent of copyright owner required for any other use.  
For inspection purposes only.

**GROUNDWATER QUALITY (SHEET 2 OF 2)**

Parameter	Results (mg/l)				Sampling method (composite, dipper etc.)	Normal Analytical Range	Analysis method / technique
	Date	Date	Date	Date			
Phosphate PO <sub>4</sub>							
Sulphate SO <sub>4</sub>							
Zinc Zn							
Total alkalinity (as CaCO <sub>3</sub> )							
Total organic carbon TOC							
Total oxidised nitrogen TON							
Arsenic As							
Barium Ba							
Boron B							
Fluoride F							
Phenol							
Phosphorus P							
Selenium Se							
Silver Ag							
Nitrite NO <sub>2</sub>							
Nitrate NO <sub>3</sub>							
Faecal coliforms ( /100mls)							
Total coliforms ( /100mls)							
Water level (m OD)							

Consent of copyright owner required for any other use.  
For inspection purposes only.

SEE ATTACHMENTS E AND F

**Table I.6(i) Ambient Noise Assessment**

*Third Octave analysis for noise emissions should be used to determine tonal noises*

	National Grid Reference	Sound Pressure Levels		
	(5N, 5E)	L(A) <sub>eq</sub>	L(A) <sub>10</sub>	L(A) <sub>90</sub>
<b>1. SITE BOUNDARY</b>				
Location 1:				
Location 2:				
Location 3:				
Location 4:				
<b>2. NOISE SENSITIVE LOCATIONS</b>				
Location 1:				
Location 2:				
Location 3:				
Location 4:				

NOTE: All locations should be identified on accompanying drawings.

For inspection purposes only.  
Consent of copyright owner required for any other use.

**ATTACHMENT K.1**  
**REMEDATION, DECOMMISSIONING, RESTORATION AND AFTERCARE**

*For inspection purposes only.  
Consent of copyright owner required for any other use.*

No changes planned from the existing waste licence W0113-02.

In the event of decommissioning the facility, KMK Metals Recycling Ltd will follow the procedures as defined under the granted licence. To financially underwrite the decommissioning of the activities on the site KMK Metals Recycling Ltd has a closure bond with Offaly County Council for €63,500 for these eventualities. This bond will be re-assessed in the near future by means of an environmental liabilities risk assessment and subsequently will be arranged with the EPA as the appointed site regulator.

*For inspection purposes only.  
Consent of copyright owner required for any other use.*

**ATTACHMENT C  
MANAGEMENT OF THE INSTALLATION**

*For inspection purposes only.  
Consent of copyright owner required for any other use.*



## C.1 Site Management

### C.1.1 Management Responsibility

KMK Metals Recycling Ltd operates an existing efficient waste management business in accordance with proper practices and the existing waste licence (W0113-02). KMK Metals Recycling Ltd also has an Environmental Management System (EMS) accredited to ISO 14001.

All issues relating to the management responsibility and duties of all employees will remain unchanged from the existing waste licence W0113-02.

There will only be additional yard operatives working in D4 and D5 areas only.

### C.1.2 Staff

No changes planned, please refer to existing waste licence (W0113-02). A most recent summary and company organisation chart is detailed below for KMK Metals Recycling Ltd.

For inspection purposes only.  
Consent of copyright owner required for any other use.

C.1.3 Company Organisation - the management structure at KMK Metals Recycling Ltd is outlined below.

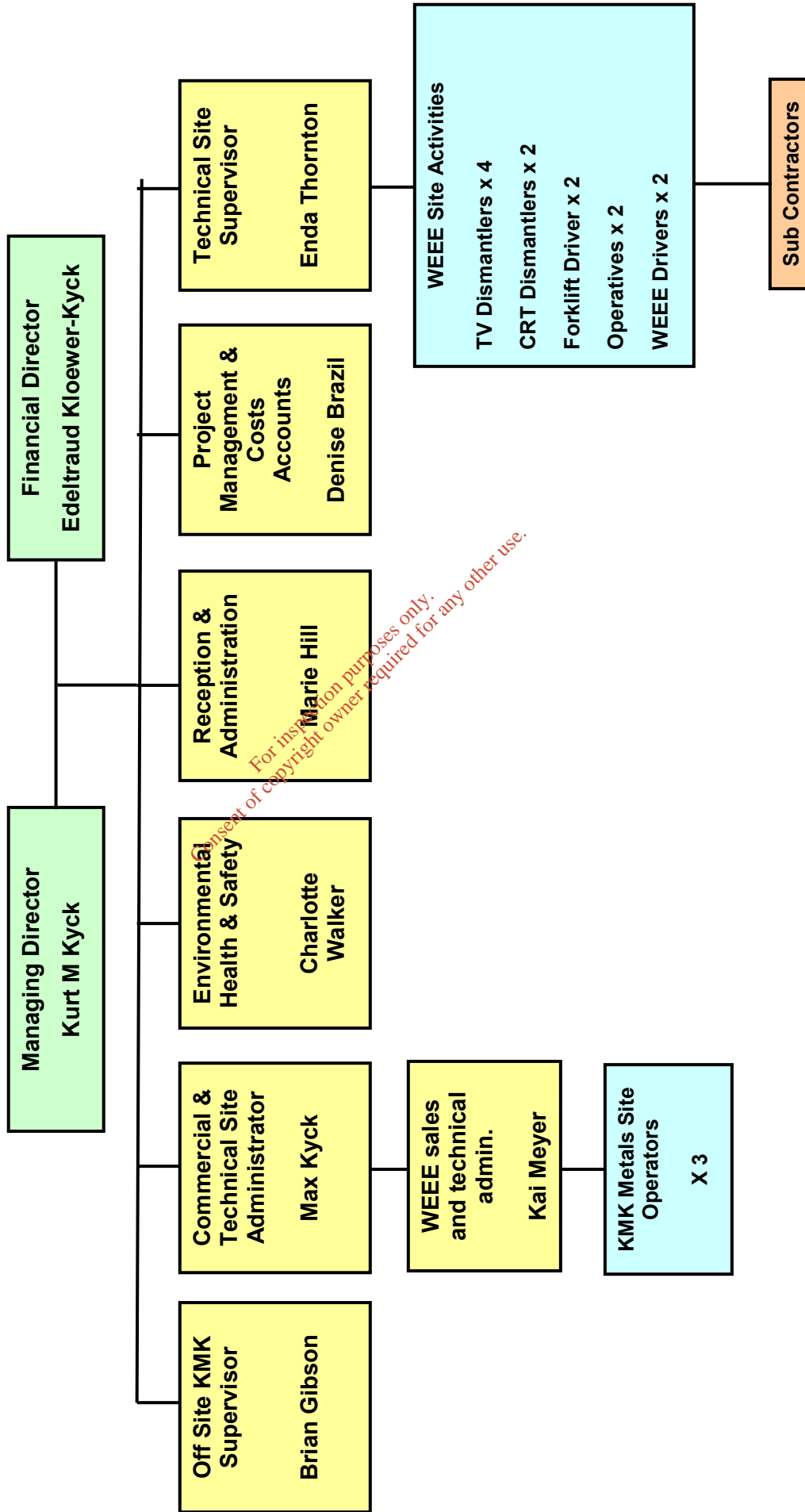

## **C.2 Environmental Management System**

There are no changes planned from the existing waste licence W0113-02 with the exception of the inclusion of D4 and D5 areas within the structure of the environmental management system.

## **C.3 Hours of Operation**

### **C.3.1 Proposed Hours of Operation**

The proposed hours of operation are 06:00 to 22:00 Monday to Friday inclusive and 06:00 to 13:00 on Saturdays.

### **C.3.2 Proposed Hours of Waste Acceptance / Handling**

As stated above, the proposed hours will be 06:00 to 22:00 Monday to Friday inclusive and 06:00 to 13:00 on Saturdays.

### **C.3.3 Proposed Hours of any Construction and Development Works at the Facility and Timeframes**

The proposed hours of construction and development works at the facility will take place during normal working hours.

### **C.3.4. Any other relevant Hours of Operation Expected**

None expected. The proposed hours as detailed in C.3.1 and C.3.2 above will provide for adequate flexibility of activities in the event of any contingency plans at the site where additional time is required for specific waste handling projects.

## **C.4. Conditioning Plan**

No changes required.

**ATTACHMENT D  
INFRASTRUCTURE & OPERATION**

*For inspection purposes only.  
Consent of copyright owner required for any other use.*

**D.1 Infrastructure****D.1.a Site security arrangements including gates and fencing**

No changes from the existing waste licence W0113-02 with only the inclusion of D4 and D5 areas. It is also proposed to install a roof cover over the yard area outside D area as per layout plan attached to this application.

Both D4 and D5 areas will be fully secure and separate from any other activity other than that of KMK Metals Recycling Ltd operations.

There will be CCTV installed for the facility with a central control and administration point inside the site management office.

**D.1.b Design for Site Roads**

No changes from the existing waste licence W0113-02 with only the inclusion of D4 and D5 areas. D5 area will be used for staff and visitor vehicle parking with scope for installation of a weighbridge when appropriate to the size and scale of activities at the facility as per condition 8.8.3 of the existing waste licence W0113-02.

**D.1.c Design of Hardstanding Areas**

No changes from the existing waste licence W0113-02 with only the inclusion of D4 and D5 areas.

D4 area comprises of a fully concrete surfaced yard area and warehouse type building with a roller shutter door. This building can be fully closed if required.

D5 area will be surfaced with an impervious base as per planning permission ref: 07/132 where only vehicle parking will occur on a regular basis. In addition, permission is granted for the installation of a weighbridge when appropriate to the size and scale of activities at the facility as per condition 8.8.3 of the existing waste licence W0113-02. No waste storage or handling will occur at this area.

**D.1.d Plant**

No changes planned – please refer to existing waste licence W0113-02

**D.1.e Wheel Wash**

No changes planned – please refer to existing waste licence W0113-02

**D.1.f Laboratory Facilities**

No changes planned – please refer to existing waste licence W0113-02

**D.1.g Design and location of Fuel Storage areas**

No changes planned – please refer to existing waste licence W0113-02.

**D.1.h Waste Quarantine Areas**

No changes planned – please refer to existing waste licence W0113-02.

D4 area will be used for acceptance of Large Household Appliances (LHAs).  
The building at D4 area will be used for the acceptance and storage of Small Household Appliances (SHAs)

D5 area - no waste acceptance or processing and will be operated in accordance with planning permission ref: 07/132 where only vehicle parking will occur on a regular basis.

**D.1.i Waste Inspection Areas**

No changes planned – please refer to existing waste licence W0113-02.

**D.1.j Traffic Control**

No changes planned – please refer to existing waste licence W0113-02.

All employees and site visitors/contractors will park in D5 area prior to carrying out their duties.

**D.1.K Sewerage and Surface Water Drainage Infrastructure**

In relation to sewerage generation, there are no changes planned – please refer to existing waste licence W0113-02.

In relation to surface water drainage, the following additions will be made:

- Clean rainwater (uncontaminated) from building roofed areas (D4 area) is discharged directly to the existing land drain along the west boundary of the site.
- Surface water runoff from the concreted site yard at D4 currently flows to an existing open land drain passing along the west boundary of the site. It is proposed to install a Class II interceptor for this surface water run-off.

- Surface water run-off from the D5 area will flow into an existing storm drain which in turn flows to the existing land drain along the west boundary of the site. The storm drain in D5 is a shared drain with other businesses in the industrial estate and serves to remove surface water run-off from many commercial properties in the estate.
- Planning permission has been applied for the coverage of the yard at D area of the site. This will increase the volume of roof rain water generation (uncontaminated) being discharged to the land drain at the west boundary of the site. Similarly it will significantly reduce yard water run-off generation which potentially can be contaminated with activities related to waste storage and handling at the site. This will be an environmental improvement for the facility by way of reduction in yard water emissions to land drain.
- KMK Metals Ltd wishes to bring to the notice of the Agency that a sewer mains is proposed by Offaly County Council as part of infrastructure developments at the Cappincur industrial estate within the next 2 years. The proposed route of the sewer line will be adjacent to D5 area and parallel with the existing facility entrance. There will be an option to avail of this proposed sewer mains in the future.

In summary, the maximum volume of surface water that will be discharged from D4 area has been calculated based on site area and annual rainfall.

The following tables show an estimated breakdown of the quantities of surface water run-off that may be discharged from D4 area.

**Table D.1a Estimated Quantities of surface water run-off generated at D4 area.**

Source	Estimated Volume/yr.	Make Up	Treatment	Destination
Roof rainwater run-off	510m <sup>3</sup> note 1 (600m <sup>2</sup> x 0.85m)	Uncontaminated rainwater	None	Existing land drain along west boundary
Yard surface water run off	1,211m <sup>3</sup> note 1 (1425m <sup>2</sup> x 0.85m)	Potentially contaminated rainwater run-off	Drainage gullies, and interceptor unit proposed for concrete yard areas	Existing land drain along west boundary

note 1 : The volume and rate of surface water to be discharged from the site is dependent on rainfall. The annual rainfall in the area is approximately 850 mm (mean rainfall scenario for 2005 and 2006). Assuming 100% run-off, the maximum quantity of surface water to drain from the site will be 1,721m<sup>3</sup>/annum or 4.71m<sup>3</sup>/day.

**Table D.1b Estimated Quantities of surface water run-off generated at D5 area.**

Source	Estimated Volume/yr.	Make Up	Treatment	Destination
Yard surface water run off	1,462m <sup>3</sup> note 1 (1720m <sup>2</sup> x 0.85m)	Rainwater run-off	Shared storm drain servicing commercial businesses in estate	Existing land drain along west boundary

note 1 : The volume and rate of surface water to be discharged from the site is dependent on rainfall. The annual rainfall in the area is approximately 850 mm (mean rainfall scenario for 2005 and 2006). Assuming 100% run-off, the maximum quantity of surface water to drain from the site will be 1,462m<sup>3</sup>/annum or 4.00m<sup>3</sup>/day.

KMK Metals Ltd wishes to notify the Agency that the storm drain in D5 area discharges to a shared surface water drainage system which serves many commercial businesses in the industrial estate. Therefore there is a number of discharges to this drainage system prior to the KMK facility discharge and prior to final discharge to the existing land drain along the western boundary of the D4 area. Also it is proposed by KMK Metals Ltd to use D5 area for car parking only with a provision for a weighbridge if required. There will be no waste handling or storage at D5 area.

#### **D.1.L All Other Services**

No changes planned – please refer to existing waste licence W0113-02.

#### **D.1.m Plant Sheds, Garages and Equipment Compound**

No changes planned – please refer to existing waste licence W0113-02.

#### **D.1.n Site Accommodation**

No changes planned – please refer to existing waste licence W0113-02.

#### **D.1.o Fire Control System and Water Supply**

No changes planned – please refer to existing waste licence W0113-02.

#### **D.1.p Civic Amenity Sites**

No changes planned – please refer to existing waste licence W0113-02.



**D.1.q Any Other Waste Recovery Infrastructure**

Future planned site buildings, equipment and infrastructure includes the following;

- Inclusion of D4 area within the site boundary – this includes a fully concrete surfaced yard area and commercial type warehouse building.
- Inclusion of D5 area within the site boundary – as agreed in recent planning permission granted.
- A roof structure to cover the yard area outside D1, D2 and D3 – as applied for in planning permission.
- A new office and canteen building to be situated in outside C area at the facility as applied for in planning permission.

**D.1.r Composting Infrastructure**

Not applicable to this facility.

**D.1.s Construction and Demolition Waste Infrastructure**

Not applicable to this facility.

**D.1.t Incineration Infrastructure**

Not applicable to this facility.

**D.1.u Any other Infrastructure**

None proposed

**D.2 Facility Operation****D.2.a Development and Operational History**

Please refer to existing waste licence W0113-02.

**D.2.b Processes**

Please refer to existing waste licence W0113-02.

The following changes will be incorporated into the new waste licence:

D4 area will be used for acceptance of Large Household Appliances (LHAs).

The building at D4 area will be used for the acceptance and storage of Small Household Appliances (SHAs)

For inspection purposes only.  
Content of copyright owner required for any other use.

There may be a requirement on occasion for special WEEE dismantling projects inside D4 building e.g. dismantling of items into components prior to off-site removal.

D5 area - no waste acceptance or processing and will be operated in accordance with planning permission ref: 07/132 where only vehicle parking will occur on a regular basis.

*For inspection purposes only.  
Consent of copyright owner required for any other use.*

**ATTACHMENT E  
EMISSIONS**

*For inspection purposes only.  
Consent of copyright owner required for any other use.*

## E.1 Emissions to Atmosphere

There will be no emissions to air of environmental significance - please refer to existing waste licence W0113-02.

### E.1.1 Fugitive Dusts Emissions

These are currently measured as part of the existing waste licence W0113-02.

The changes proposed for the facility are:

- Inclusion of D4 area within the facility boundary.
- Inclusion of D5 area within the facility boundary.
- The installation of a roof structure to cover over the yard area outside D1, D2 and D3 buildings.

Therefore, a revised dust emissions map (Figure E1.1) is included showing the revised locations to reflect the proposed changes above.

**Table E.1.1 Dust Emissions**

Emission Ref	Location	Composition	Frequency	Sampling proposed
A2-1 A2-2 A2-3 A2-4 A2-5 A2-6	Site boundaries	Windblown particulates	Refer to Schedule C.6 of W0113-02	Refer to Schedule C.6 of W0113-02

It is expected that dust emissions from the site will be effectively controlled by proposed control measures described in section F.1.1.

### E.1.2 Fugitive Odour Emissions

There will be no odour emissions of environmental significance - please refer to existing waste licence W0113-02.

## E.2 Emissions to Surface Water

These are currently measured as part of the existing waste licence W0113-02.

The changes proposed for the facility are:

- Inclusion of D4 area within the facility boundary.
- Inclusion of D5 area within the facility boundary.
- The installation of a roof structure to cover over the yard area outside D1, D2 and D3 buildings.

Therefore, a revised surface water emissions map (Figure E1.1) is included showing the revised locations to reflect the proposed changes above.

**Table E.2 Surface Water Emissions**

<b>Emission Ref</b>	<b>Location</b>	<b>Composition</b>	<b>Frequency</b>	<b>Sampling proposed</b>
CX	Outlet to land drain	Treated surface water run-off	Refer to Schedule C.2.3 of W0113-02	Refer to Schedule C.2.3 of W0113-02
DX	Outlet to land drain	Treated surface water run-off	Refer to Schedule C.2.3 of W0113-02	Refer to Schedule C.2.3 of W0113-02
D4	Outlet to land drain	Treated surface water run-off	Refer to Schedule C of W0113-02	Refer to Schedule C of W0113-02

Please note that it is not proposed to monitor emissions from the storm drain in D5 due to the reason that this drain is connected to a shared storm water drainage system for other commercial units at the industrial estate. Therefore any sample taken from the outlet to the land drain from D5 would be reflective of emissions to surface water from D5 and also from other commercial units in the industrial estate. In addition, the outlet location from D5 to the land drain is to be confirmed through further area investigations.

It is expected that surface water emissions from the site will be effectively controlled by proposed control measures described in section F.1.1.

### **E.3 Emissions to Sewer**

There are no emissions to sewer.

### **E.4 Emissions to Groundwater**

These are currently monitored as part of the existing waste licence W0113-02.

The changes proposed for the facility are:

- Inclusion of D4 area within the facility boundary. This area is served by a concrete surfaced yard and warehouse type building. Only WEEE processing will occur inside this building and there will be no waste liquids accepted here.
- Inclusion of D5 area within the facility boundary, this area will be covered in concrete/tarmac and there will be no waste handling or processing at this area.
- The installation of a roof structure to cover over the yard area outside D1, D2 and D3 buildings.
- The addition of a canteen and administration building at the facility outside C area.

Therefore, there will be no significant changes or otherwise to the existing impacts to groundwater from the license review. Hence, please refer to the existing waste licence W0113-02 for emissions to groundwater information.

### E.5 Noise Emissions

These are currently measured as part of the existing waste licence W0113-02.

The changes proposed for the facility are:

- Inclusion of D4 area within the facility boundary.
- Inclusion of D5 area within the facility boundary.
- The installation of a roof structure to cover over the yard area outside D1, D2 and D3 buildings.
- The addition of a canteen and administration building at the facility outside C area.

Therefore, a revised noise emissions map (Figure E1.1) is included showing the revised locations to reflect the proposed changes above.

**Table E.5 Noise Emissions**

Emission Ref	Location	Composition	Frequency	Sampling proposed
NE1 NE2 NE3 NE4 NE5 NE6	Site boundary locations	Noise from site activities	Refer to Schedule C.4 of W0113-02	Refer to Schedule C.4 of W0113-02

As stated in F.1.3 the overall noise output from the site is minimal due to the control measures specified in F.1.3. There will be no significant changes or otherwise to the existing impacts to noise from the license review.

A summary of all environmental emission locations are shown on the attached Figure E.1.1.

**E.6 Environmental Nuisances****E.6.1 Vermin/birds/flies**

The KMK Metals facility accepts and handles inorganic waste and not organic or biological type wastes. Therefore, there will be no impacts to vermin/birds/flies of environmental significance - please refer to existing waste licence W0113-02.

**E.6.2 Litter**

There are no impacts expected - please refer to existing waste licence W0113-02.

**E.7 Emissions to Humans**

There are no impacts expected - please refer to existing waste licence W0113-02.

*For inspection purposes only.  
Consent of copyright owner required for any other use.*

**ATTACHMENT F  
CONTROL & MONITORING**

*For inspection purposes only.  
Consent of copyright owner required for any other use.*



## F.1 Treatment, Abatement and Control Systems

There will be no potential environmentally significant air and effluent emissions from the facility - please refer to existing waste licence W0113-02.

### F.1.1 Dust

This is monitored as part of the existing waste licence W0113-02.

#### *Control measures*

As part of this review application it is proposed to cover the yard area outside D1, D2 and D3 area thereby further controlling dust emissions from the site to site boundaries.

Further control measures may be adopted should the need arise and should on-going monitoring data show dust levels to be problematic or outside of the licence levels. These may include:

- Sprinkling water or applying a fine water mist over all outside areas at the site.
- Sweeping the building floors regularly and washing down the floors on a regular basis.
- Regularly washing down waste collection vehicles.
- Using a road sweeper on the facility yard during dry weather conditions.
- Other mitigation measures suggested by the EPA.

Site staff regularly clean and sweep the yard throughout the day (as needed). Waste collection vehicles are also regularly washed to remove mud from the tyres/undercarriage. Other mitigation measures suggested by the EPA will be considered.

### F.1.2 Odour

There will be no odour emissions of any significance from the facility – please refer to the existing waste licence W0113-02.

#### *Control measures*

Not applicable to this waste licence review.

### F.1.3 Noise

This is monitored as part of the existing waste licence W0113-02.

Noise emissions from site operations (including D4 area during 2006) were **not** deemed to have a nuisance effect on the surrounding environment. Furthermore, the nature and future scale of site operations is not expected to have an overall increase in noise emissions in the area.

**Control measures**

- All processing of WEEE and waste materials inside the various buildings at the facility.
- No outside dismantling of waste materials.
- All fork lift trucks to drive and operate at low speeds.
- Any other mitigation measures proposed by the EPA or the Planning Authority will be considered.

**F.1.4 Discharge to Surface Water**

This is monitored as part of the existing waste licence W0113-02.

In summary, the changes to the existing site will be:

- Inclusion of D4 area and D5 areas as previously described.
- Installation of a cover for the yard areas outside D1, D2 and D3 area.

***Control measures.***

Please refer to the existing waste licence W0113-02.

In addition, the coverage of the yard at D area will decrease the volume of potentially contaminated surface water run-off and increase the volume of clean roof water run-off being discharged to land drain.

**F.1.5 Discharges to Sewer**

There will be no discharge to sewer from the facility.

**F.1.6 Climate**

There is no impact to climate expected – please refer to the existing waste licence W0113-02.

**F.1.7 Cultural Heritage**

There is no impact to cultural heritage expected – please refer to the existing waste licence W0113-02.

**F.1.8 Ecology**

There is no impact to ecology expected – please refer to the existing waste licence W0113-02.

### F.1.9 Human Beings

Traffic movements to the site do not have a negative impact on the traffic volume in the surrounding area. Noise monitoring has shown that noise emissions from the facility do not have a negative impact on the surrounding area especially at the nearest dwellings/businesses to the site. Consequently, KMK Metals Recycling Ltd operations do not have a negative impact on the local community.

A recent WEEE status report (The National Compliance Scheme for electrical recycling – Annual Report 2005/2006) has been issued by WEEE Ireland and details the success in the implementation of the WEEE Directive nationwide. The public response in recycling of their WEEE has exceeded the initial expectation with the effect of increased WEEE quantities on the market for recovery/recycling. Therefore it is for this reason that KMK Metals Recycling Ltd is moving with the current trend and requires permission for an increase in waste acceptance tonnages to the facility to 20,000 tonnes per year.

The proposed increase in tonnages and increased facility space will mean that KMK Metals Recycling Ltd will manage and recycle much of this waste. Therefore KMK Metals Recycling Ltd will have an overall positive impact on the national population and implementation of the WEEE Directive. The proposed site operations will also have a positive contribution to the WEEE Management Plan.

#### *Control measures.*

The KMK Metals Recycling Ltd facility has an overall significant positive human impact. These include the provision of jobs, the collection, removal, recovery and recycling of up to 20,000 tonnes/year of waste nationwide.

Potential adverse impacts on neighbours, close businesses and the environment include dust, litter and noise. These have been addressed in this application.

These impacts will be managed and controlled by KMK Metals Recycling Ltd to reduce the impact on local residents and surrounding environment. Litter will be controlled by ensuring good house keeping measures at the site, handling waste inside buildings, covering waste areas and daily litter patrols at the site boundary.

KMK Metals Recycling Ltd wishes to notify the EPA that Offaly County Council proposes a north-south ring road for Tullamore town (see Map F.1.9 attached). As part of this road design a roundabout will be established on the Cappincur road close to the entrance to the industrial estate. This proposed road will serve the KMK Metals facility with improved access to north, east and south directions of the country and will result in less KMK Metals Ltd traffic passing through Tullamore town. Furthermore, the Council also proposes a drainage scheme for the industrial estate in conjunction with the north-south ring road and this will have the effect of creating a fully serviced industrial estate in Cappincur which KMK Metals will benefit from. It is envisaged that this infrastructural work will take approximately two years to complete.

### F.1.10 Hydrogeology

No significant impacts expected from the review licence, please refer to the existing waste licence W0113-02

#### *Control measures*

- D4 area is completely surfaced in concrete and has an existing building. There will be no discharges to ground from this area.
- D5 area will be surfaced with an impervious base as per planning permission ref: 07/132, similarly there will be no discharges to ground.

These site developments will further help to reduce the potential impact of the activity on ground and groundwater quality. There are no further mitigation measures planned.

### F.1.11 Landscape

KMK Metals Recycling Ltd is situated in an industrial estate. Please refer to the existing waste licence W0113-02.

The changes planned will be the inclusion of D4 and D5 area (see photo F.1.11 below) and the proposed canteen and office building outside C building. These proposed additions will not have any negative effect on the landscape or general locality.



#### *Control measures.*

D4 and D5 areas will be incorporated into the site boundary and as can be seen from the above photo are keeping to the style and nature of the existing waste licence site. The existing building in D4 area is similar to the warehouse buildings that are located in the existing site and visually typical of the units in the industrial estate.

## F.2 Air Monitoring

### F.2.1 Dust

This is monitored as part of the existing waste licence W0113-02.

The following table outlines the proposed dust monitoring programme for KMK Metals Recycling Ltd. Monitoring points are shown on the attached Map F.1.1

**Table F.2.1 Proposed Dust Monitoring Programme**

Ref	Monitoring Location	Parameter	Proposed Frequency	Sampling Equipment/Analysis
A2-1 A2-2 A2-3 A2-4 A2-5 A2-6	Site boundaries	Refer to Schedule C.6 of W0113-02	Refer to Schedule C.6 of W0113-02	Refer to Schedule C.6 of W0113-02

It is expected that dust emissions from the site will be effectively controlled by proposed control measures described in section F.1.1.

### F.2.2 Odours

This is not applicable to the facility and therefore odour monitoring is not proposed.

## F.3 Surface Water Monitoring

This is monitored as part of the existing waste licence W0113-02.

The following table outlines the KMK Metals Recycling Ltd proposed surface water monitoring programme. Monitoring points are shown on the attached Map F1.1

**Table F.3 Proposed Surface Water Monitoring Programme**

Ref	Monitoring Location	Parameter	Proposed Frequency	Sampling Equipment/Analysis
CX DX	Outlet to land drain	Refer to Schedule C.2.3 of W0113-02	Refer to Schedule C.2.3 of W0113-02	Refer to Schedule C.2.3 of W0113-02
D4	As above	As above	As above	As above

#### F.4 Sewer Discharge Monitoring

There will be no discharge to sewer – please refer to existing waste licence W0113-02

#### F.5 Groundwater Monitoring

This is currently monitored as part of the existing waste licence W0113-02.

Therefore, there will be no significant changes or otherwise to the existing impacts to groundwater from the license review. Hence, please refer to the existing waste licence W0113-02 for emissions to groundwater information.

#### F.6 Noise Monitoring

This is monitored as part of the existing waste licence W0113-02.

The following table outlines KMK Metals Recycling Ltd's proposed noise monitoring programme. Monitoring points are shown on the attached Map F1.1

**Table F.6 Proposed Noise Monitoring Programme**

Ref	Monitoring Location	Parameter	Proposed Frequency	Sampling Equipment/Analysis
NE1 NE2 NE3 NE4 NE5 NE6	Site boundary locations	Refer to Schedule C.4 of W0113-02	Refer to Schedule C.4 of W0113-02	Refer to Schedule C.4 of W0113-02

Noise monitoring and analysis will be carried out by a suitably qualified external consultant and laboratory. Monitoring results will be recorded and submitted in a format that is to the satisfaction of the EPA. The report will highlight any breaches of trigger levels or other limit emission values. In the case of any breach of emission limit, KMK Metals Recycling Ltd will investigate the cause of the breach and strive to rectify the situation.

It is expected that noise emissions from the site will be effectively controlled by existing and proposed measures described in section F.1.3 of this application.

#### F.7 Meteorological Data Monitoring

The KMK Metals Recycling Ltd facility is not expected to have an impact on the local climate – please refer to the existing waste licence W0113-02.

### F.8 Ecological Monitoring

The KMK Metals Recycling Ltd facility is not expected to have an impact on the local ecology – please refer to the existing waste licence W0113-02.

The KMK Metals Recycling Ltd proposed monitoring programme, location points and grid references are summarised below.

Monitoring Point	Description	Grid Reference
A2-1	Dust	E235940 N225118
A2-2	Dust	E235955 N225001
A2-3	Dust	E235895 N224955
A2-4	Dust	E235908 N225004
A2-5	Dust	E235858 N225028
A2-6	Dust	E235893 N225103
NE1	Noise	E235940 N225123
NE2	Noise	E235955 N224992
NE3	Noise	E235852 N224958
NE4	Noise	E235858 N225013
NE5	Noise	E235865 N225103
NE6	Noise	E235895 N225103
CX	Surface water emission to drain	E235853 N225018
DX	Surface water emission to drain	E235853 N225008
D4	Surface water emission to drain	E235855 N225024
GW1	Groundwater	E235928 N225004
GW2	Groundwater	E235893 N224958

A summary of all proposed monitoring locations are shown on the attached Map F.1.1

**ATTACHMENT G**  
**RESOURCE USE & ENERGY EFFICIENCY**

*For inspection purposes only.  
Consent of copyright owner required for any other use.*



## G.1 Raw Materials, Substances, Preparations and Energy

No changes planned - please refer to existing waste licence W0113-02.

## G.2 Energy Efficiency

KMK Metals Recycling Ltd energy performance was calculated as a part of the energy audit carried out at the facility in February 2006. The following flow chart summarises the energy consumption areas of the facility.

Flow Chart of Energy Consumption

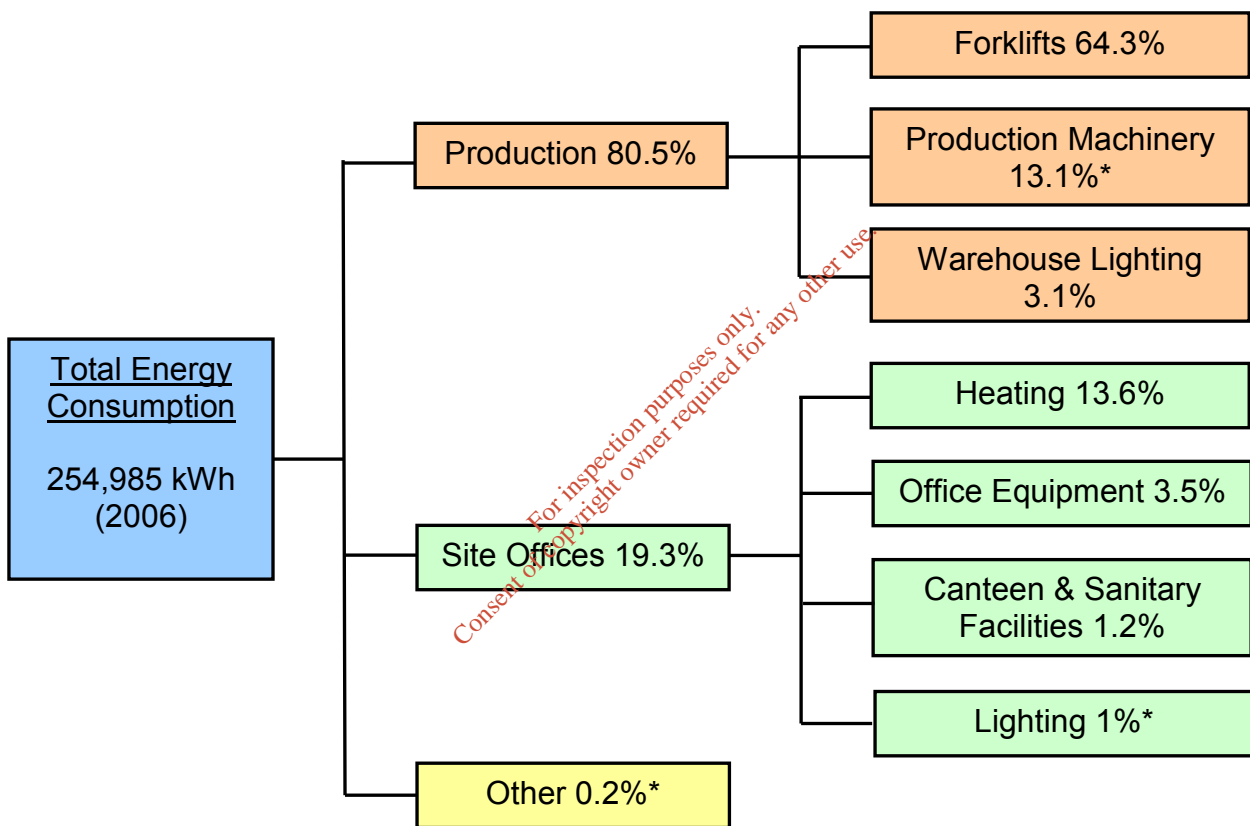

\* This is an estimate; this was not included in the site survey

## 5.2 Energy Performance

KMK Metals Recycling Ltd energy performance was calculated as a part of the energy audit to allow comparisons to be made of the energy efficiency of the company between years of operation. The energy performance for the company in years 2004 – 2006 was as follows:

- 2004: Energy consumption 31.6 kWh/tonne of waste handled  
Energy cost €3.0/tonne of waste handled
- 2005: Energy consumption 18.0 kWh/tonne of waste handled  
Energy cost €1.7/tonne of waste handled
- 2006: Energy consumption 18.8 kWh/tonne of waste handled  
Energy cost €1.8/tonne of waste handled

The figures above show that the company has reduced its energy consumption and cost per tonne of waste handled and thus improved its energy performance from 2004. However, the energy consumption and cost per tonne of waste handled increased slightly from 2005 to 2006 (by 0.8 kWh or €0.1 per tonne of waste handled). This is not thought to be a significant change in the energy performance. However, if the energy consumption and cost per tonne of waste handled increases further, the reasons behind the increase have to be studied in more detail.

*For inspection purposes only.  
Consent of copyright owner required for any other use.*

**ATTACHMENT H  
MATERIALS HANDLING**

*For inspection purposes only.  
Consent of copyright owner required for any other use.*

## H1 Waste Types and Quantities – Existing & Proposed

Table H.1(A). No changes planned in the classes of activities applied for as indicated in the Waste Licence Application form.

### H1 (b) Annual Quantities and Nature of Waste

Please refer to Schedule A, Table A.1 of the existing waste licence W0113-02 for nature of wastes.

It is proposed to increase the waste acceptance total to 20,000 tonnes per year for reasons given in section F.1.9 of this licence review application.

### H1 (c) Waste Types and Quantities

Please refer to Schedule A, Table A.1 of the existing waste licence W0113-02 for types of wastes.

It is proposed to increase the waste acceptance total to 20,000 tonnes per year.

Furthermore, it is proposed to add the following waste types on the waste licence:

- EWC Code: 08 03 17\* - waste printing toner containing dangerous substances
- EWC Code: 08 03 18 - waste printing toner other than those mentioned in 08 03 17\*
- EWC Code : 16 05 04\* - gases in pressure containers (including halons) containing dangerous substances e.g. old fire extinguishers.
- EWC Code : 16 05 05 - gases in pressure containers other than those mentioned in 16 05 04\*

## H.2 Waste Acceptance Procedures

No changes planned - please refer to existing waste licence W0113-02.

## H.3 Waste Handling

No changes planned - please refer to existing waste licence W0113-02.

**ATTACHMENT I.1  
EXISTING ENVIRONMENT & IMPACT OF THE ACTIVITY – ATMOSPHERIC  
EMISSIONS**

*For inspection purposes only.  
Consent of copyright owner required for any other use.*

## **I.1 Assessment of Atmospheric Emissions**

The only potential environmentally significant effects on air quality from KMK Recycling Ltd's proposed operations are dust and noise. Existing dust emissions at the site are dealt with below. Existing noise emissions are dealt with in section I.6 of this licence application.

### **I.1.1 Dust**

Due to the quantity and nature of waste that is proposed to be handled at the site, there is the potential for dust generation, especially in dry weather through waste unloading, sorting and vehicle movements. Dust deposition monitoring is carried out as part of the licence W0113-02 and reported in the annual environmental reports (AERs).

The addition of D4 and D5 areas to the site will not result and any significant rise in dust emissions or impact from the activity.

Proposed dust mitigation measures and dust monitoring programmes are discussed in Sections F.1 of this application.

*For inspection purposes only.  
Consent of copyright owner required for any other use.*

**ATTACHMENT I.2**  
**EXISTING ENVIRONMENT & IMPACT OF THE ACTIVITY – SURFACE WATER**

*For inspection purposes only.  
Consent of copyright owner required for any other use.*

### **I.2.1 Assessment of Impacts of Surface Water Discharges on the Receiving Water**

In relation to surface water drainage, the following additions will be made:

- Clean rainwater (uncontaminated) from building roofed areas (D4 area) is discharged directly to the existing land drain along the west boundary of the site.
- Surface water runoff from the concreted site yard at D4 currently flows to an existing open land drain passing along the west boundary of the site. It is proposed to install a Class II interceptor for this surface water run-off.
- Surface water run-off from the D5 area will flow into an existing storm drain which in turn flows to the existing land drain along the west boundary of the site. The storm drain in D5 is a shared drain with other businesses in the industrial estate and serves to remove surface water run-off from many commercial properties in the estate.
- Planning permission has been applied for the coverage of the yard at D area of the site. This will increase the volume of roof rain water generation (uncontaminated) being discharged to the land drain at the west boundary of the site. Similarly it will significantly reduce yard water run-off generation which potentially can be contaminated with activities related to waste storage and handling at the site. This will be an environmental improvement for the facility by way of reduction in yard water emissions to land drain.
- KMK Metals Ltd wishes to bring to the notice of the Agency that a sewer mains is proposed by Offaly County Council as part of infrastructure developments at the Cappincur industrial estate. The proposed route of the sewer line will be adjacent to D5 area and parallel with the existing facility entrance. There will be an option to avail of this proposed sewer mains in the future.

### **I.2.2 Surface Water Drainage from Site (outside concrete areas only)**

As described above.

### **I.2.3 Water Quality Management Plan**

Not applicable – please refer to Schedule C of waste licence W0113-02.

### **I.2.4 Surface Water Monitoring Survey**

This is carried out as per section C.2.3 of the existing waste licence W0113-02 and is reported in the annual environmental report (AER) for the site.

Proposed surface water mitigation measures and monitoring programmes are discussed in Sections F.1.4 of this application.



**ATTACHMENT I.3  
EXISTING ENVIRONMENT & IMPACT OF THE ACTIVITY – RECEIVING  
SEWER**

*For inspection purposes only.  
Consent of copyright owner required for any other use.*

### **I.3.1 Assessment of Impact on Receiving Sewer.**

There will be no discharge from the facility to any sewerage works and hence this section of the waste licence application does not require any further details.

In addition, KMK Metals Ltd wishes to bring to the notice of the Agency that a sewer mains is proposed by Offaly County Council as part of infrastructure developments at the Cappincur industrial estate. The proposed route of the sewer line will be adjacent to D5 area and parallel with the existing facility entrance. There will be an option to avail of this proposed sewer mains in the future.

*For inspection purposes only.  
Consent of copyright owner required for any other use.*

**ATTACHMENT I.4**  
**EXISTING ENVIRONMENT & IMPACT OF THE ACTIVITY – GROUNDWATER**  
**AND SOILS**

*For inspection purposes only.  
Consent of copyright owner required for any other use.*

## I.4 Hydrogeology

There have been no detailed site investigations necessary at the site as part of this waste licence review application. Furthermore, there are no significant impacts expected from the review licence, please refer to the existing waste licence W0113-02

### I.4.1 Geology

No significant impacts expected from the review licence, please refer to the existing waste licence W0113-02

### I.4.2 Hydrogeology

No significant impacts expected from the review licence, please refer to the existing waste licence W0113-02

As part of the future site developments, the new facility will also include:

- D4, an area that is completely surfaced in concrete and has an existing building. There will be no discharges to ground from this area.
- D5, an area that will be surfaced with an impervious base as per planning permission ref: 07/132, similarly there will be no discharges to ground.
- The yard at D area (within the boundary of the existing waste licence) is proposed to be roofed thereby further minimising potentially contaminated surface water run-off.

These site developments will further help to reduce the potential impact of the activity on ground and groundwater quality.

Groundwater monitoring is carried out at 2 locations as per Schedule C of the existing waste licence W0113-02 and is reported in the annual environmental report (AER) for the site. In general, all groundwater monitoring is found to be in compliance with the waste licence. Furthermore there are no additional groundwater monitoring well locations proposed as part of this licence review at D4 or D5 area due to the fact that these proposed areas pose a very low risk to ground contamination.

**ATTACHMENT I.5**  
**EXISTING ENVIRONMENT & IMPACT OF THE ACTIVITY – GROUND AND/OR**  
**GROUNDWATER CONTAMINATION**

*For inspection purposes only.  
Consent of copyright owner required for any other use.*

**I.5.1 Ground Contamination**

There have been no detailed site investigations carried out as part of this waste licence review application. There are no further changes planned - please refer to W0113-02 .

**I.5.2 Groundwater Contamination**

This section has been adequately covered in Attachment I.4 of this waste licence application.

*For inspection purposes only.  
Consent of copyright owner required for any other use.*

**ATTACHMENT I.6**  
**EXISTING ENVIRONMENT & IMPACT OF THE ACTIVITY – NOISE**

*For inspection purposes only.  
Consent of copyright owner required for any other use.*

## I.6 Existing Environment – Noise

Due to the quantity and nature of waste that is proposed to be handled at the site, there is the potential for noise generation, especially through waste unloading, sorting and vehicle movements. Noise monitoring is carried out as part of the licence W0113-02 and reported in the annual environmental reports (AERs).

To date, there has been no nuisance noise emissions or complaints at the facility.

The addition of D4 and D5 areas to the site will not result and any significant rise in noise emissions or impact from the activity.

Proposed noise mitigation measures and noise monitoring programmes are discussed in Sections F.1.3 of this application.

*For inspection purposes only.  
Consent of copyright owner required for any other use.*



**ATTACHMENT J**  
**ACCIDENT PREVENTION & EMERGENCY RESPONSE**

*For inspection purposes only.  
Consent of copyright owner required for any other use.*

## **J. Contingency Arrangements**

### **1. Fire**

There are no changes planned to the existing waste licence site W0113-02.

KMK Recycling Ltd propose the following fire preventative and action measures for D4 area:

- Current and future electrical installations are to be flame proof and installed and tested to the highest international standards.
- An inventory of fire extinguishers will be located at strategic points throughout the site. These fire extinguishers will be serviced and checked on a scheduled basis.
- D4 will be served by water supply from the existing site and there will be fire hydrants located around the site where required.
- The existing emergency response procedure will apply to D4 area also.
- Emergency contact numbers (including after hours numbers) are to be posted at locations throughout the building in the event of an emergency situation.

In the event of a small localised fire outbreak during working hours, KMK Recycling Ltd staff would attempt to put out the fire. Should the fire become uncontrollable, staff will call out the fire brigade and evacuate the building.

There will be no fire risk to D5 area as this location will be used for car parking only.

#### **1.1 Firewater run-off**

The water used to extinguish a fire (fire-water), will contain dilute quantities of chemicals affected by the fire. Unless the contaminated fire-water can be retained on site, it can cause pollution to surface water, sewers, soil and groundwater. If a significant risk exists for fire-water to leave a site and cause pollution, then a Risk Management Programme must be implemented. This programme will outline the actions that must be taken in order to reduce the risk of fire-water polluting the environment.

A Risk Management Programme will typically include the implementation of management systems and engineering controls to reduce or eliminate potential hazards or sources of pollution. Engineering techniques to help minimise the spread of fire-water contamination include;

- Underground storage tanks
- Above ground storage tanks
- Mixture of 1 & 2 above

- Cut off valves on sumps
- Absorbent booms and materials

There are no changes planned to the existing waste licence site W0113-02.

However for D4 area the environmentally best and most practical option for potential fire-water handling is to contain the liquid inside the building where the fire may occur. This will be achieved with the help of raised concrete/steel ramps and/or absorbent booms where necessary to be created at the entrances to the buildings and in particular the garage area where chemicals will be stored for routine vehicle maintenance. Therefore in the unlikely event of a fire break out, all associated fire-water will be contained locally inside the respective buildings. However, very little flammable materials are stored here. It is very unlikely that a fire break out in any building would spread to other buildings due to the fact that very little flammable substances are stored at the site.

## **2. Spillages**

These contingency events will be handled as per the existing waste licence W0113-02.

## **3. Emergency Equipment Breakdown**

These contingency events will be handled as per the existing waste licence W0113-02.

## **4. Emergency Contact Numbers**

No changes planned – please refer to existing waste licence W0113-02.

For inspection purposes only.  
Consent of copyright owner required for any other use.

Map F.1.9 Proposed N-S Ringroad for Tullamore by Offaly County Council

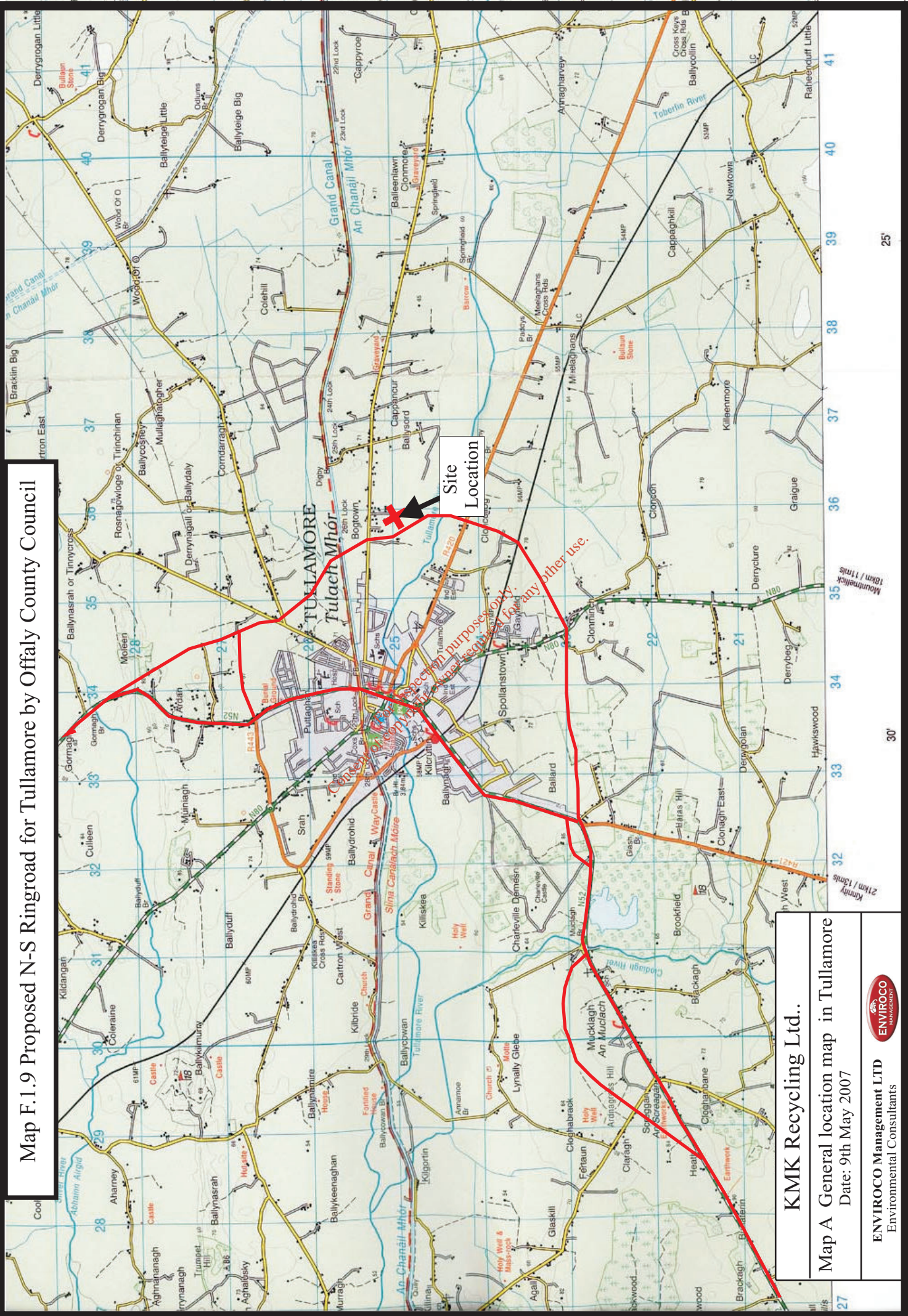

KMK Recycling Ltd..

Map A General location map in Tullamore  
Date: 9th May 2007



ENVIROCO Management LTD  
Environmental Consultants

Map B2.1 Site location map for KMK Metals Recycling Ltd  
 Cappincur Industrial Estate, Daingean Road, Tullamore, Co Offaly

Attachment A.1  
 Environmental  
 monitoring

Surveyed 1984 - 1996  
 Revised 0  
 Landed 1982

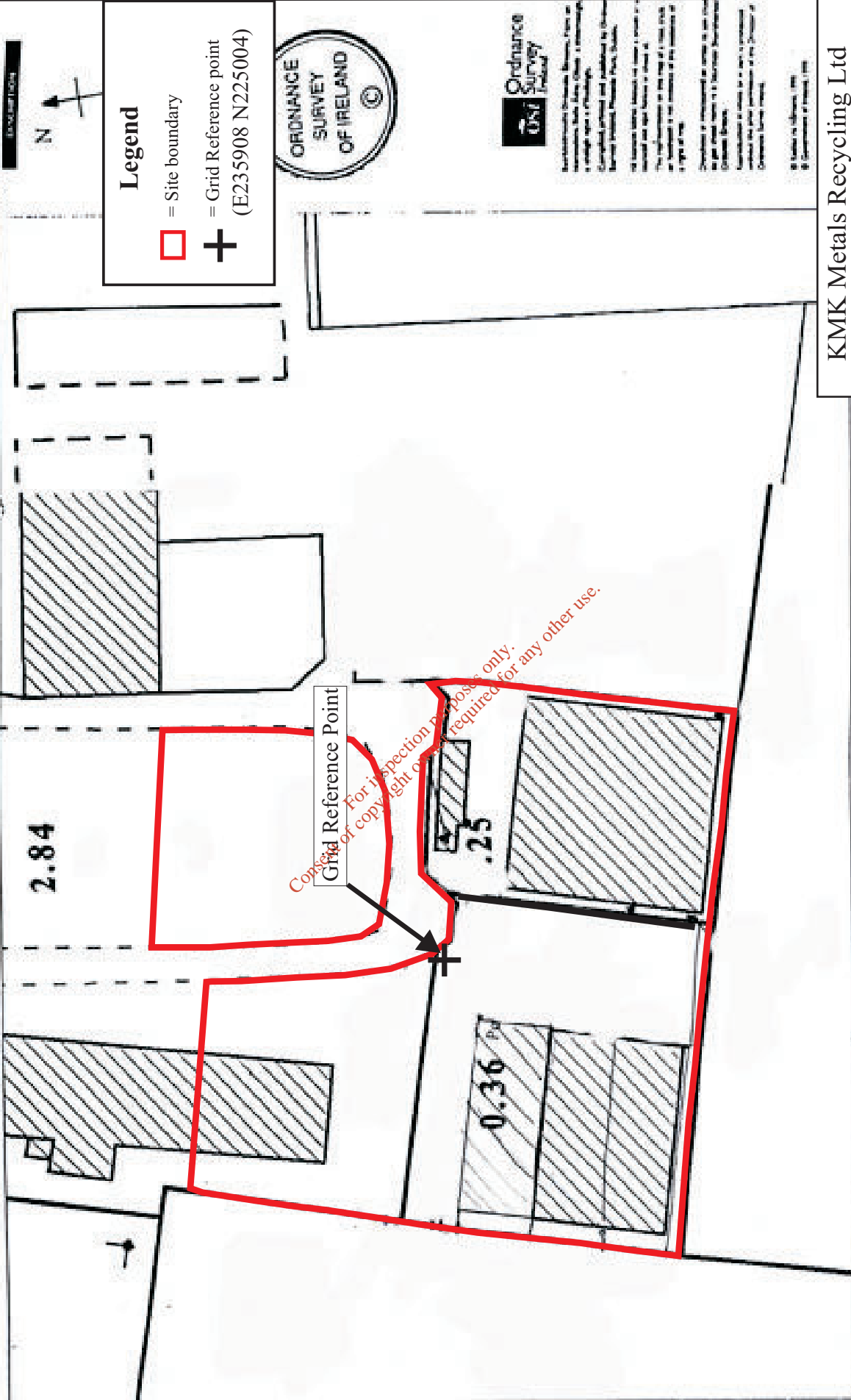

**Legend**

- = Site boundary
- + = Grid Reference point (E235908 N225004)



Ordnance Survey  
 The Ordnance Survey is the national mapping agency for Great Britain and Ireland. It is a non-departmental public body, sponsored by the Department for Communities and Local Government. It was formed by the merger of the Ordnance Survey and the Ordnance Survey of Ireland in 1976. It is a member of the International Geographical Union (IGU) and the International Association of Agricultural Geographers (IAAG).

KMK Metals Recycling Ltd

Site location map  
 Date: 9th May 2007

ENVIROCO Management LTD  
 Environmental Consultants



Scale: - 1:1000  
 Scale: - 1:1000  
 Plot Ref. 50 Metres 100 Feet  
 Plot Date

Map B.6.1 Site notice location map for KMK Metals Recycling Ltd  
Cappincur Industrial Estate, Daingean Road, Tullamore, Co Offaly

Attachment A.1  
Environmental  
monitoring

Surveyed 1984 - 1998  
Revised 0  
Landed 1982



ENVIROCO LTD



ENVIROCO LTD

1:2500  
3433-A 5434-B

**Legend**  
□ = Site boundary

Site notice

Consent of copyright owner required for any other use.  
For inspection purposes only.

Ordnance  
Survey  
Produced

Information shown on this map is derived from Ordnance Survey data, which is a Crown Copyright. It is reproduced here by permission of Ordnance Survey. The Ordnance Survey data is not to be used for any other purpose without the prior permission of the Director of Ordnance Survey.

© Crown Copyright 1998  
© Ordnance Survey 1998

**KMK Metals Recycling Ltd**  
Site notice location map  
Date: 9th May 2007

Plot Ref.  
Plot Date

50 Metres

100 Feet



Scale: - 1:1000  
Scale: - 1:1000



**ENVIROCO Management LTD**  
Environmental Consultants

# Map E.1.1 Environmental Emissions locations at the KMK Metals Recycling Ltd Site

Surveyed 1984 - 1  
 Revised 0  
 Licensed 1982

## KMK METALS RECYCLING LTD

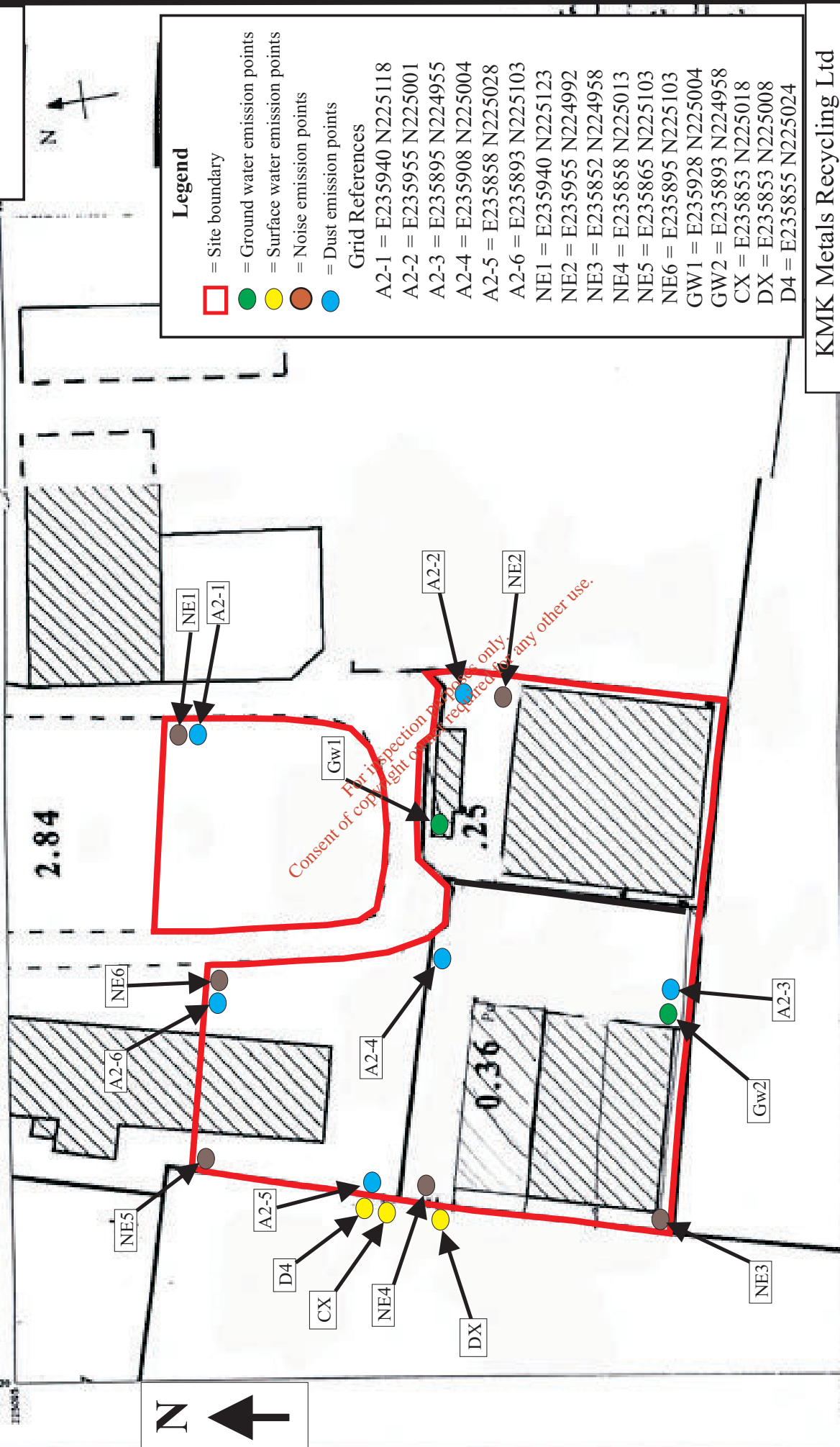

2.84

0.36

For inspection purposes only.  
 Consent of copyright owner required for any other use.

### Legend

□ = Site boundary



### Legend

- = Site boundary
- = Ground water emission points
- = Surface water emission points
- = Noise emission points
- = Dust emission points

### Grid References

- A2-1 = E235940 N225118
- A2-2 = E235955 N225001
- A2-3 = E235895 N224955
- A2-4 = E235908 N225004
- A2-5 = E235858 N225028
- A2-6 = E235893 N225103
- NE1 = E235940 N225123
- NE2 = E235955 N224992
- NE3 = E235852 N224958
- NE4 = E235858 N225013
- NE5 = E235865 N225103
- NE6 = E235895 N225103
- GW1 = E235928 N225004
- GW2 = E235893 N224958
- CX = E235853 N225018
- DX = E235853 N225008
- D4 = E235855 N225024

KMK Metals Recycling Ltd

Environmental emissions map  
 Date: 9th May 2007

ENVIROCO Management LTD  
 Environmental Consultants



Plot Ref.  
 Plot Date

50 Metres

100 Feet

0 50 100

0 50 100

Scale: 1:1000

Scale: 1:1000

# Map F1.1 Environmental Monitoring locations at the KMK Metals Recycling Ltd Site

Surveyed  
Revised  
Licensed  
1984 - 1  
0  
1982

KMK METALS RECYCLING LTD

Legend  
= Site boundary

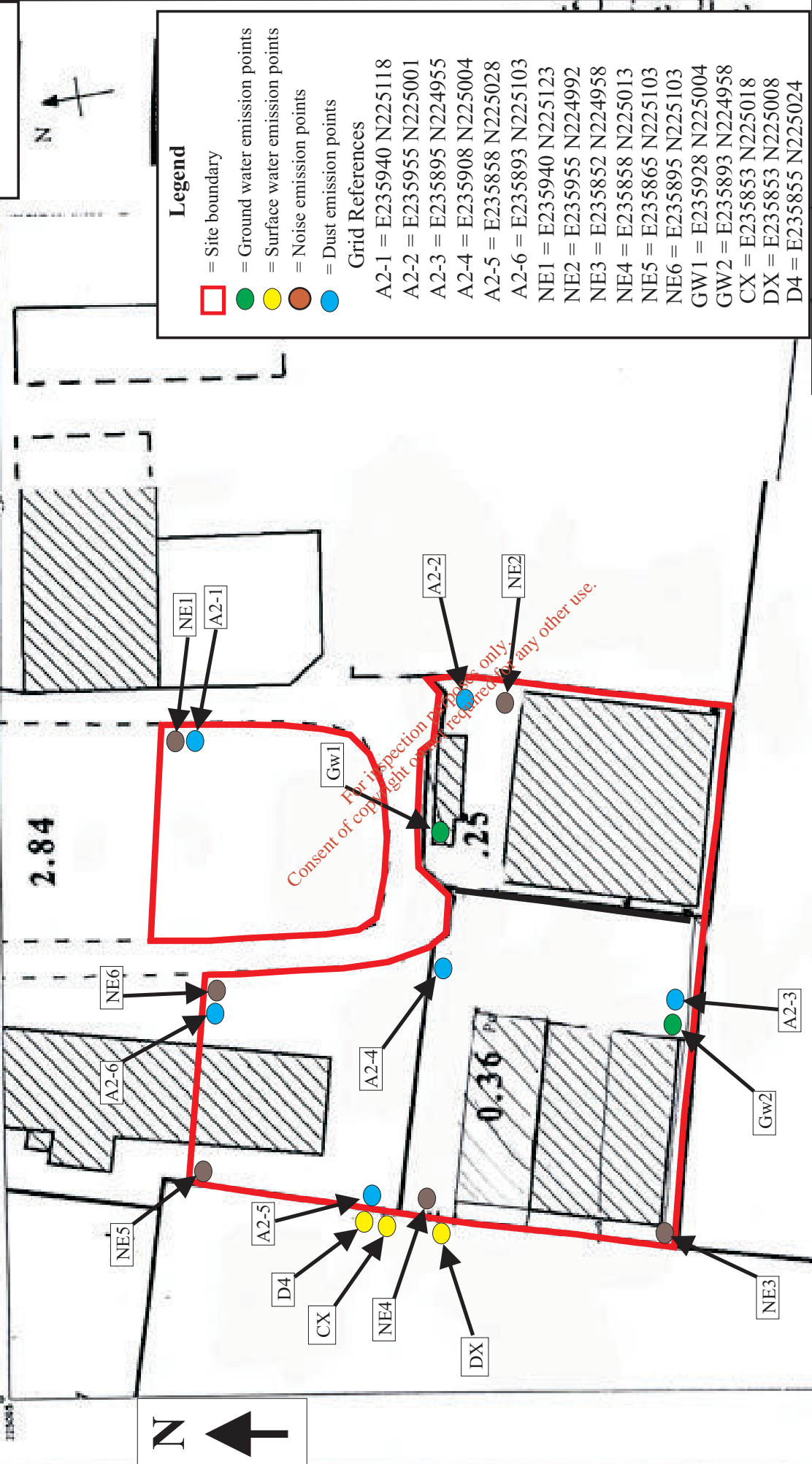

KMK Metals Recycling Ltd

Environmental monitoring map  
Date: 9th May 2007



Plot Ref.  
Plot Date

50 Metres

100 Feet

0 10 20 30 40 50

0 50 100

Scale: - 1:1000  
Scale: - 1:1000



Map I.1.1 Dust Monitoring locations at the KMK Metals Recycling Ltd Site

Surveyed  
Revised  
Landed

1984  
0  
1982

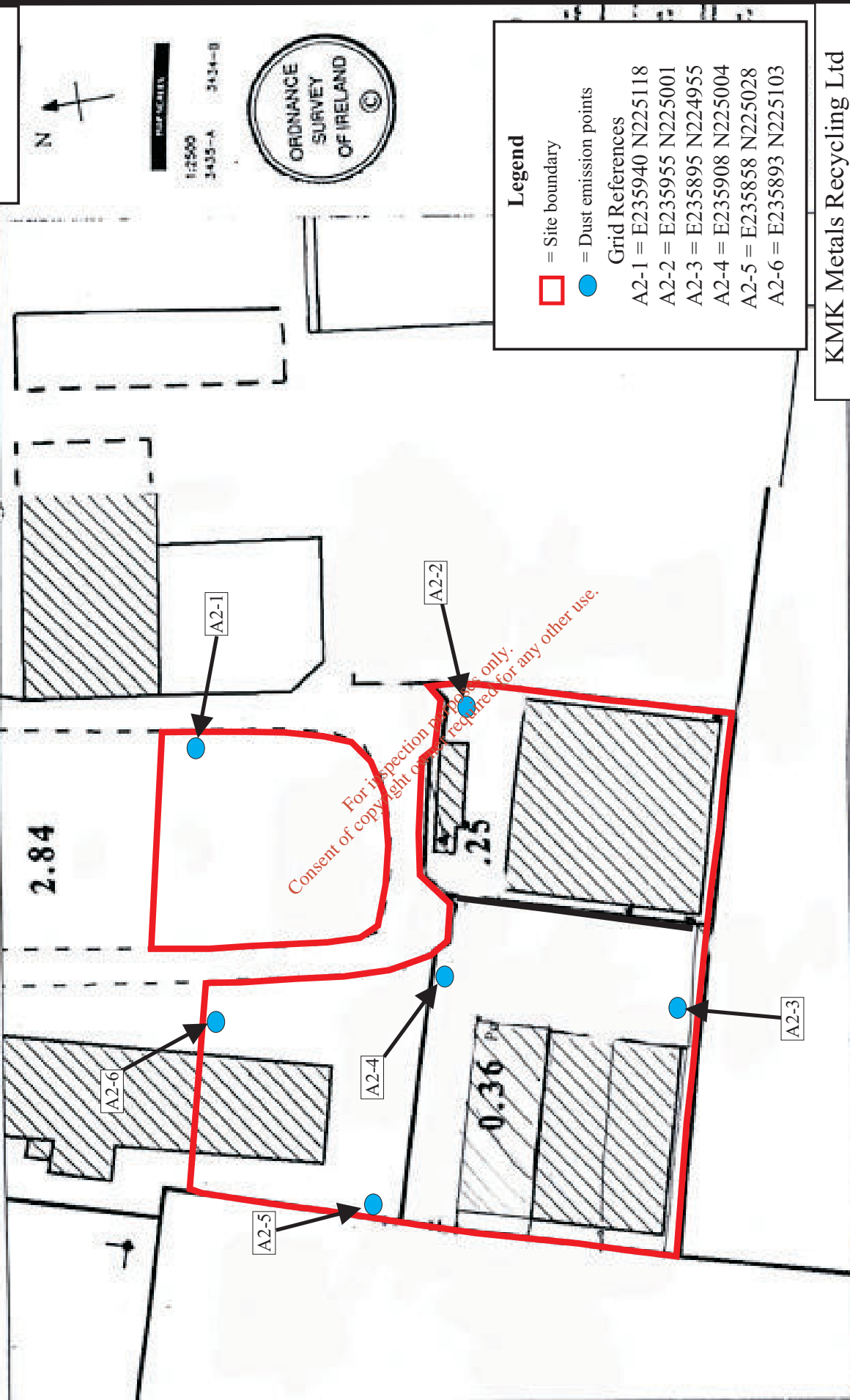

Consent of copyright owner is required for any other use.

**Legend**  
 = Site boundary

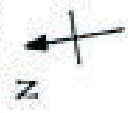

1:2500  
3433-A 3434-B



**Legend**  
 = Site boundary  
● = Dust emission points

**Grid References**  
 A2-1 = E235940 N225118  
 A2-2 = E235955 N225001  
 A2-3 = E235895 N224955  
 A2-4 = E235908 N225004  
 A2-5 = E235858 N225028  
 A2-6 = E235893 N225103

**KMK Metals Recycling Ltd**

Environmental monitoring map  
 Date: 9th May 2007



**ENVIROCO Management LTD**  
 Environmental Consultants

Plot Ref.  
 Plot Date

50 Metres

100 Feet

0 10 20 30 40 50

0 50 100

Scale: - 1:1000  
 Scale: - 1:1000

Map I.2.1 Surface Water Monitoring locations at the KMK Metals Recycling Ltd Site

**Legend**

 = Site boundary



1:2500  
3433-A 3434-B



**Legend**

 = Site boundary

 = Surface water emission points

Grid References

CX = E235853 N225018

DX = E235853 N225008

D4 = E235855 N225024

**KMK Metals Recycling Ltd**

Environmental monitoring map  
Date: 9th May 2007



Surveyed 1984  
Revised 0  
Licensed 1982



D4

CX

DX

Consent of copyright owner required for any other use.

2.84

0.36

0.25

Scale: - 1:1000  
Scale: - 1:1000



Plot Ref.  
Plot Date

Map I.5.1 Groundwater Monitoring locations at the KMK Metals Recycling Ltd Site

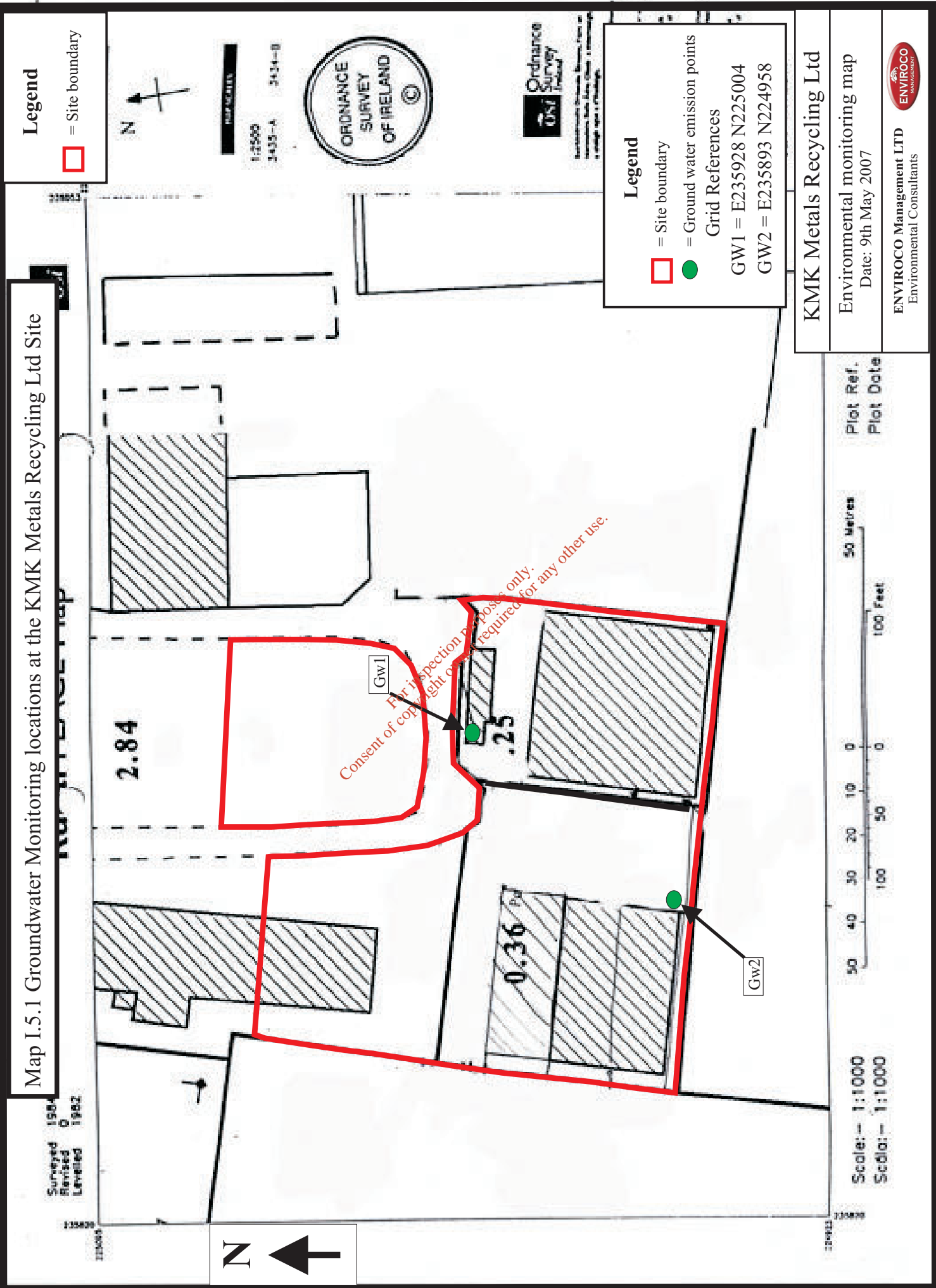

**Legend**

□ = Site boundary



ORDNANCE SURVEY  
1:2500  
3433-A 3434-B

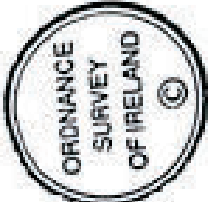

Ordnance Survey  
OSi  
The National Mapping Agency  
The Ordnance Survey, Dublin, Ireland  
© Crown Copyright 1998

**Legend**

□ = Site boundary  
● = Ground water emission points  
Grid References  
GW1 = E235928 N225004  
GW2 = E235893 N224958

**KMK Metals Recycling Ltd**

Environmental monitoring map  
Date: 9th May 2007



**ENVIROCO Management LTD**  
Environmental Consultants

Plot Ref.  
Plot Date

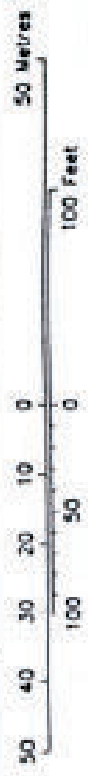

Scale: - 1:1000  
Scale: - 1:1000



Map I.6.1 Noise Monitoring locations at the KMK Metals Recycling Ltd Site

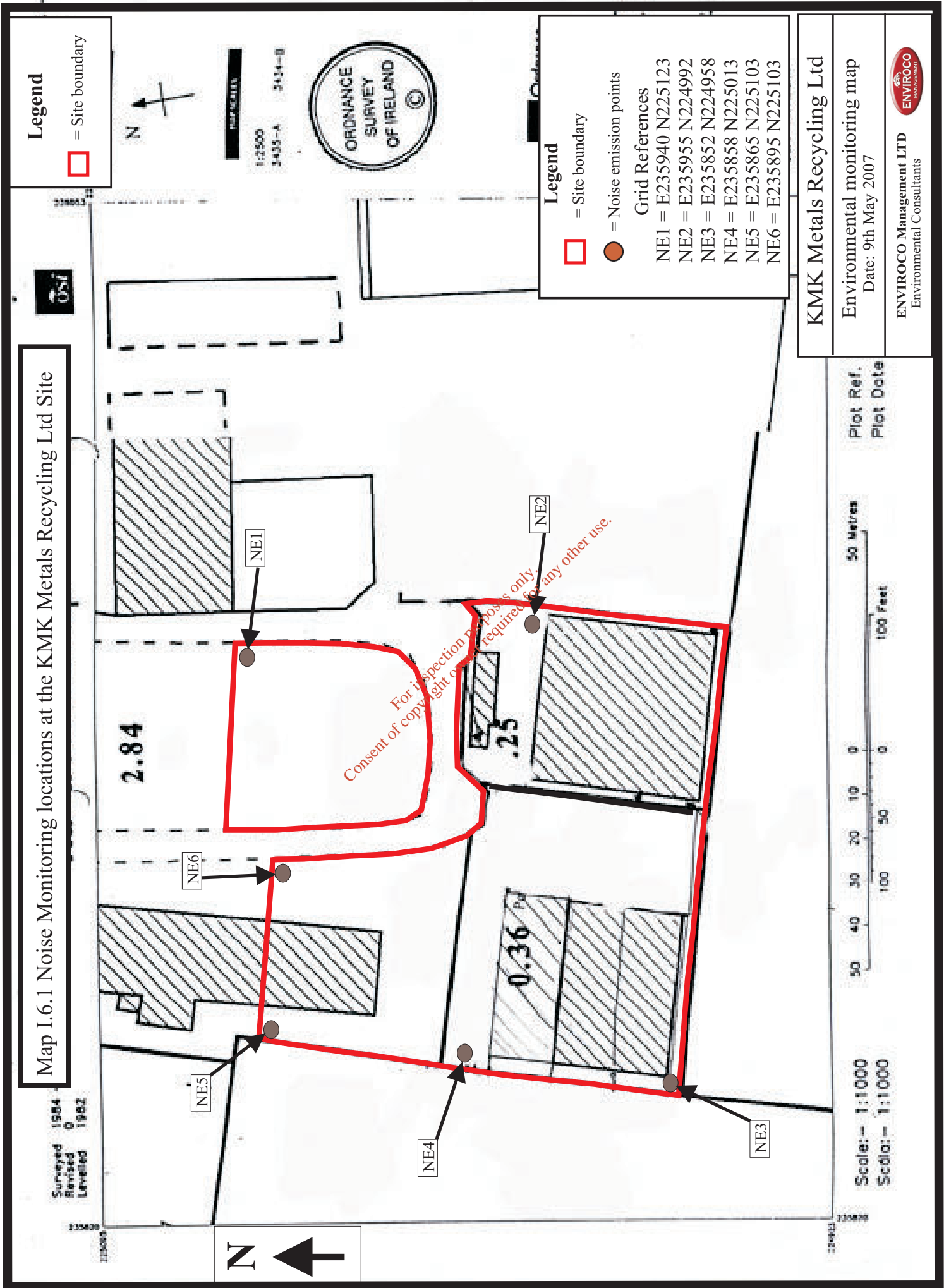

**Legend**

□ = Site boundary

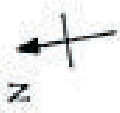

1:2500  
3435-A 3434-B



**Legend**

□ = Site boundary  
● = Noise emission points

**Grid References**

- NE1 = E235940 N225123
- NE2 = E235955 N224992
- NE3 = E235852 N224958
- NE4 = E235858 N225013
- NE5 = E235865 N225103
- NE6 = E235895 N225103

**KMK Metals Recycling Ltd**

Environmental monitoring map  
Date: 9th May 2007



**ENVIROCO Management LTD**  
Environmental Consultants

Plot Ref.  
Plot Date

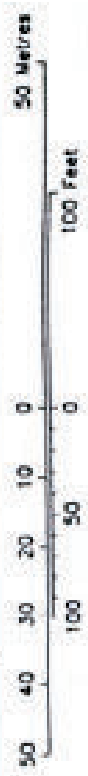

Scale:- 1:1000  
Scale:- 1:1000

Surveyed 1984  
Revised 0  
Levelled 1982



Map A General Location of KMK Recycling Ltd., Cappincur, Daingean Rd., Tullamore, Co. Offaly

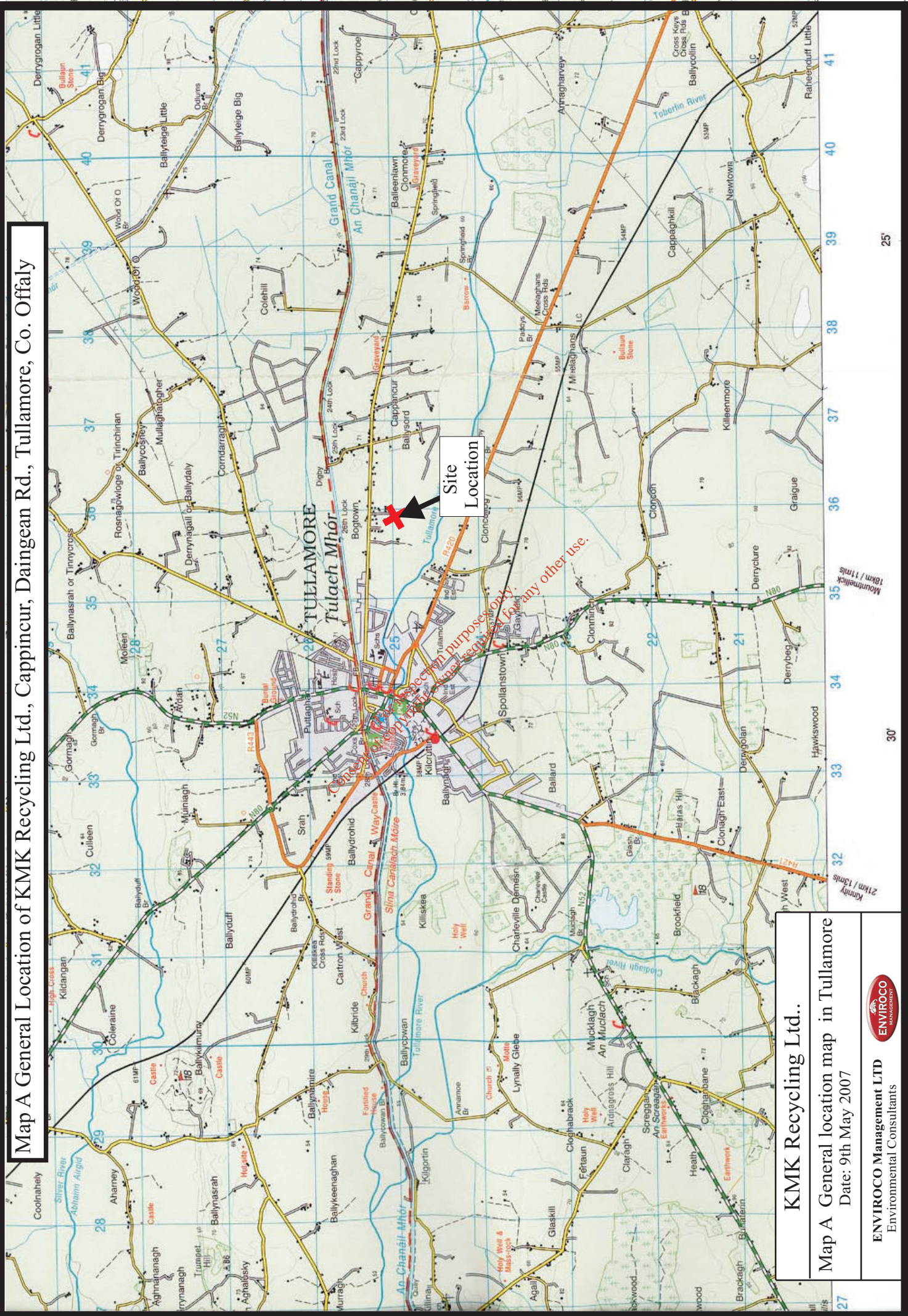

Site Location

Specific purpose only. No other use.

KMK Recycling Ltd..

Map A General location map in Tullamore  
Date: 9th May 2007



ENVIROCO Management LTD  
Environmental Consultants

Map A General Location of KMK Recycling Ltd., Cappincur, Daingean Rd., Tullamore, Co. Offaly

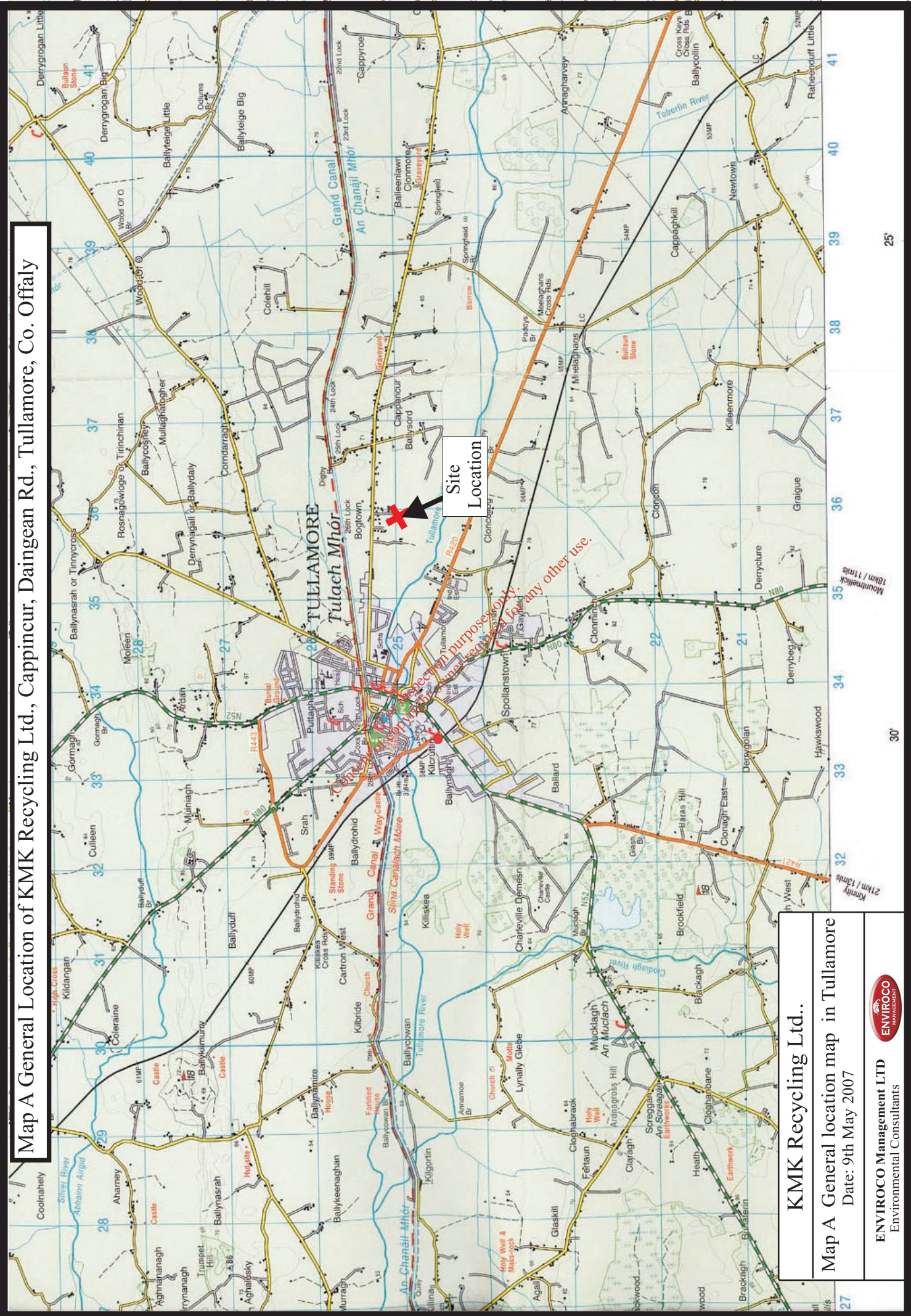

Site Location

Specific purpose only. No other use.

KMK Recycling Ltd..

Map A General location map in Tullamore  
Date: 9th May 2007



ENVIROCO Management LTD  
Environmental Consultants

PLANNING AND DEVELOPMENT ACT 2000 - 2006  
 PLANNING AND DEVELOPMENT REGULATIONS 2001 - 2007

**NOTIFICATION OF DECISION TO GRANT**

Planning Section  
 Aras an Chontae  
 Charleville Road  
 Tullamore  
 Phone No: (057) 9346800

**TO:** KMK METALS RECYCLING LTD  
 C/O MALACHI CULLEN & PARTNERS  
 OLD BRIDGE HOUSE  
 STRAND STREET  
 ATHLONE

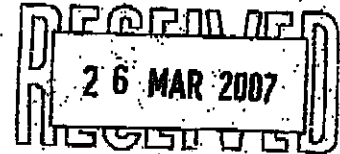

**Planning Register Number:** 07/132 -  
**Application Receipt Date:** 30/01/2007  
**Further Information Received Date:**

Notice is hereby given that in pursuance of the powers conferred upon them by the above-mentioned Acts, Offaly County Council has by order dated 23/3/07 decided to GRANT PERMISSION to the above named for development of land, in accordance with the documents lodged, namely:-

CONSTRUCTION OF CAR PARK COMPRISING 40 SPACES AND A SURFACE MOUNTED MOVABLE TRUCK WEIGHBRIDGE, WITHIN A TOTAL SITE AREA 1720 SQUARE METERS, WITH ASSOCIATED SITE WORKS. GRANTED EPA WASTE LICENCE NO. 113-2 IS SUBMITTED WITH THIS APPLICATION AT CAPPINCUR INDUSTRIAL ESTATE DAINGEAN ROAD TULLAMORE

Subject to the 5 conditions set out in the attached schedule.

In deciding the planning application the planning authority had regard to submissions or observations received in accordance with the Regulations.

Signed on behalf of said Co. Council

**DATE:**

23/3/07

*P. Hays*  
 SENIOR EXECUTIVE OFFICER

Provided there is no appeal against this DECISION a grant of planning permission will issue at the end of four weeks.

**THIS NOTICE IS NOT A GRANT OF PERMISSION AND WORK SHOULD NOT COMMENCE UNTIL PLANNING PERMISSION IS ISSUED.**

**NOTE:**

Any appeal made to An Bord Pleanála, 64 Marlborough Street, Dublin 1 must be in accordance with Section 127 of the Planning and Development Act 2000. The appeal must be received by the Board within the statutory appeal period - Four weeks beginning on the date of decision (N.B. Not the date on which decision is sent or received). See attached leaflets entitled "A Guide to Making a Planning Appeal" and "Planning Appeal Form/Check List".

In accordance with Section 130 of the Planning and Development Act 2000 any person other than a party to an appeal may make submissions or observations in writing to the Board in relation to an appeal. The fees are set out in the attached schedule entitled "Fees Payable to the Board".

**File Reference: PL2/07/132**

Application for permission for construction of car park comprising 40 spaces and a surface mounted movable truck weighbridge, within a total site area 1720 square meters, with associated site works. Granted EPA Waste Licence no. 113-2 is submitted with this application at Cappincur Industrial Estate, Daingean Road, Tullamore – KMK Metals Recycling Ltd.

**FIRST SCHEDULE**

Having regard to the zoning of the site as Industrial in the 2004 Tullamore and Environs Development Plan, the intended use of the proposed land/building, the policies of the current Development Plan and the pattern of development in the area, it is considered that, subject to conditions, the proposed development would not seriously injure the amenities of the area or of property in the vicinity and will be in accordance with the proper planning and sustainable development of the area.

**SECOND SCHEDULE**

1. The development shall be carried out in accordance with plans and particulars submitted to the Planning Authority on 30<sup>th</sup> January 2007, except where altered or amended by conditions in this permission.

**Reason:** To define the scope of permission, in the interest of orderly development

2. The development shall be used solely for the provision of a weighbridge and car parking. No change of use shall occur from this use without the prior approval of the Council (notwithstanding the exempted development provisions of the Local Government Planning and Development Regulations 2001 as amended).

**Reason:** To define the scope of the permission, because it is considered that any change of use would warrant the grant of a new planning permission, in the interest of orderly development.

3.
  - (a) The main access to the site on eastern site boundary as indicated on the site layout plan submitted to the Planning Authority on 30<sup>th</sup> January 2007 shall be used.
  - (b) All car parking spaces on site shall be clearly delineated.
  - (c) All internal roads shall be completed to meet the requirements of the Department of the Environment, "Specification for Road Works" and flexible road surfaces shall be finished in 2 layers (40mm each) of dense bituminous macadam surface dressed once. Concrete roads shall have a minimum concrete dept of 200mm.

*Contd...../*



Contd...../

**File Reference:** PL2/07/132

- (d) The developer shall provide and lay underground all telephone, electricity and piped television cables at the time of construction. Details to be agreed with ESB and telecommunications provider.
- (e) All footpaths shall be concrete bayed, slabbed or tiled. They shall be dished at all road junctions and at all entrances and shall be level with the carriageway at such points.
- (f) All works shall comply with An Foras Forbatha Recommendations for Site Development Works.
- (g) All relocation of services is to be funded by the developer

**Reason:** In the interests of traffic safety and public safety and to facilitate the proposed development, to define the scope of permission.

- 4. (a) Attenuation shall be provided on surface water to green field run-off rates. Details shall be submitted for approval prior to the development commencing.
- (b) Offaly County Council propose to lay a new foul sewer from east to west between the proposed car parking and the existing office and require a wayleave to lay this sewer. The applicant shall liaise and enter into an agreement with the water services section prior to the commencement of development at this location.

**Reason:** In the interest of protecting public health and orderly development

- 5. Prior to the commencement of development at this location the applicant shall submit details of the boundary treatment to be erected on, in or around the subject for the site for the written agreement of the Planning Authority.

**Reason:** In the interests of orderly development, visual amenity and traffic safety

\*\*\*\*\*

OFFALY COUNTY COUNCIL

PLANNING AND DEVELOPMENT ACT 2000 - 2006  
PLANNING AND DEVELOPMENT REGULATIONS 2001 - 2007

**NOTIFICATION OF DECISION TO GRANT**

Planning Section  
Aras an Chontae  
Charleville Road  
Tullamore  
Phone No: (057) 9346800

TO: K.M.K. METALS RECYCLING LTD  
C/O MALACHI CULLEN & PARTNERS  
OLD BRIDGE HOUSE  
STRAND STREET  
ATHLONE, CO. WESTMEATH

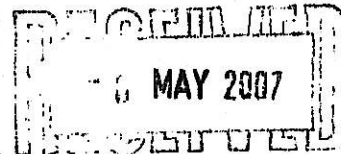

Planning Register Number: 07/78  
Application Receipt Date: 22/01/2007  
Further Information Received Date: 10/04/2007

Notice is hereby given that in pursuance of the powers conferred upon them by the above-mentioned Acts, Offaly County Council has by order dated 3 / 5 / 07 decided to **GRANT PERMISSION** to the above named for development of land, in accordance with the documents lodged, namely:-

CONSTRUCTION OF (A) A ROOF OVER THE EXISTING TRUCKING YARD IN 2 SEPARATE AREAS WITH A TOTAL COVERED AREA OF 1379 SQ.M. AND A MAXIMUM HEIGHT OF 11.13M (B) CONSTRUCTION OF A 2 STOREY PORTACABIN TYPE OFFICE AND CANTEEN WITH A TOTAL FLOOR AREA OF 157 SQ.M. AND AN OVERALL HEIGHT OF 6.50M, TOGETHER WITH ASSOCIATED SITE WORKS ON THEIR PREMISES AT CAPPINCUR INDUSTRIAL ESTATE DAINGEAN ROAD TULLAMORE

Subject to the 7 conditions set out in the attached schedule.

In deciding the planning application the planning authority had regard to submissions or observations received in accordance with the Regulations

Signed on behalf of said Co. Council

DATE: 3/5/2007

  
SENIOR EXECUTIVE OFFICER

Provided there is no appeal against this **DECISION** a grant of planning permission will issue at the end of four weeks.

**THIS NOTICE IS NOT A GRANT OF PERMISSION AND WORK SHOULD NOT COMMENCE UNTIL PLANNING PERMISSION IS ISSUED.**

**NOTE:**

Any appeal made to An Bord Pleanála, 64 Marlborough Street, Dublin 1 must be in accordance with Section 127 of the Planning and Development Act 2000. The appeal must be received by the Board within the statutory appeal period – Four weeks beginning on the date of decision (N.B. Not the date on which decision is sent or received). See attached leaflets entitled “A Guide to Making a Planning Appeal” and “Planning Appeal Form/Check List”.

In accordance with Section 130 of the Planning and Development Act 2000 any person other than a party to an appeal may make submissions or observations in writing to the Board in relation to an appeal. The fees are set out in the attached schedule entitled “Fees Payable to the Board”.

**File Reference:** PL2/07/78

Application for permission for construction of (a) a roof over the existing trucking yard in 2 separate areas with a total covered area of 1379 sq.m. and a maximum height of 11.13m (b) construction of a 2 storey portacabin type office and canteen with a total floor area of 157 sq.m. and an overall height of 6.50m, together with associated site works on their premises at Cappincur Industrial Estate, Daingean Road, Tullamore – KMK Metals Recycling Ltd.

### FIRST SCHEDULE

Having regard to the intended use of the proposed land/building, the policies of the 2004 Tullamore and Environs Plan relating to the Zoning of the Site as Industrial, and the pattern of development in the area, it is considered that, subject to conditions, the proposed development would not seriously injure the amenities of the area or of property in the vicinity, will be in accordance with the proper planning and sustainable development of the area.

### SECOND SCHEDULE

1. The development shall be carried out in accordance with plans and particulars received by the Planning Authority on 22<sup>nd</sup> January 2007, as amended by the particulars submitted to the Planning Authority by means of Further Information on 10<sup>th</sup> April 2007, except where altered or amended by conditions in this permission.

**Reason:** To define the scope of permission, in the interest of orderly development.

2. The external wall finishes of the proposed structures to be erected on the yard areas shall harmonise with the existing structures on site.

**Reason:** In the interest of visual amenity.

3. All surface water run off from the roofs, entrance and yard areas shall be collected and disposed of within the site to soakpits or adjacent watercourse. In particular, no such surface water run off shall be allowed to flow onto the public roadway or other adjoining properties.

**Reason:** In the interest of amenity and public health.

4. Prior to commencement of development on this site, a contribution shall be payable to Offaly County Council, in accordance with the Council's Development Contribution Scheme, in respect of public infrastructure and facilities benefiting development in Offaly County Council area, that is provided or that is intended will be provided by, or on behalf of, the Council.

*Contd...../*

Contd...../

**File Reference:** PL2/07/78

The contribution payable will be based on the contribution rate applicable at the time of payment and not the rate in existence when permission is granted. The amount of the development contribution is set out below and is subject to annual revision with reference to the Wholesale Price Index (Building and Construction), and interest for late payment, in accordance with the terms of the Council's Development Contribution Scheme:-

Floor area as stated for proposed development - 1,379 sq.m.

<b>Class of Infrastructure</b>	<b>Amount of Contribution</b>
<b><i>Class F Storage and Warehousing (not used for retailing)</i></b>	<b>€17.80 per sq.m.</b>
<b>Total 1,379sq.m. x €17.80</b>	<b>= €24,546.20</b>

**Total for development €24,546.20**

**Reason:** It is considered reasonable that the developer should contribute towards the expenditure incurred or proposed to be incurred by Offaly County Council in respect of the provision/improvement of public services/infrastructure benefiting development in the area of the Planning Authority.

5. During the course of construction work the developer shall provide on site a covered skip or other suitable receptacle for the deposit therein of all rubbish, litter; paper, packaging, rubble and other such materials arising from the works and shall ensure that the site and its environs are maintained at all times in a clean and tidy condition.

**Reason:** To protect the amenities of adjoining properties, in the interest of orderly development.

6. All office use of the proposed development shall be ancillary to the main industrial/ ware housing function of the proposed unit.

**Reason:** In the interests of orderly development and to prevent over development of the proposed site.

Contd...../

Contd...../

**File Reference:** PL2/07/78

7. The development shall be so constructed and operated that there will be no emission of malodorous, fumes, gas, dust or other deleterious materials, no industrial effluent and no noise vibration or electrical interference generated on the site such as would give reasonable cause for annoyance to any person in any residence or public place in the vicinity.

**Reason:** In the interest of surrounding amenity and of the proper planning and development of the area.

\*\*\*\*\*

For inspection purposes only.  
Consent of copyright owner required for any other use.



ENVIRONMENTAL CONSULTANTS

Director of Services  
Planning Section  
Offaly County Council  
County Buildings  
Charleville Road  
Tullamore  
Co Offaly

16<sup>th</sup> May 2007

**RE: Waste licence REVIEW application by KMK Metals Recycling Ltd,  
Cappincur Industrial Estate, Daingean Road, Tullamore, Co Offaly.**

Dear Sir/Madam

My client, KMK Metals Recycling Ltd wishes to inform you that they will be making a waste licence review application to the Environmental Protection Agency (EPA) in the coming week and as such are confirming the same to your office under Article 9 of the Waste Management (Licensing) Regulations 2004.

The waste licence review application is for the existing facility located at Cappincur Industrial Estate, Daingean Road, Tullamore which is presently licensed by the EPA (ref: W0113-02).

Yours Sincerely

Niall Nally  
Environmental Consultant

CC. Mr Kurt M Kyck, KMK Metals, Cappincur Ind Estate, Tullamore.



**BOW HOUSE O'MOORE STREET TULLAMORE CO. OFFALY**  
T/F: 057 935 2200 • email: [info@enviroco.ie](mailto:info@enviroco.ie) • [www.enviroco.ie](http://www.enviroco.ie)

Registered in Ireland, Number 297801 • Directors: A. Fahey. D. Fahey





ENVIRONMENTAL CONSULTANTS

Director of Services  
Planning Section  
Offaly County Council  
County Buildings  
Charleville Road  
Tullamore  
Co Offaly

16<sup>th</sup> May 2007

**RE: Waste licence REVIEW application by KMK Metals Recycling Ltd,  
Cappincur Industrial Estate, Daingean Road, Tullamore, Co Offaly.**

Dear Sir/Madam

My client, KMK Metals Recycling Ltd wishes to inform you that they will be making a waste licence review application to the Environmental Protection Agency (EPA) in the coming week and as such are confirming the same to your office under Article 9 of the Waste Management (Licensing) Regulations 2004.

The waste licence review application is for the existing facility located at Cappincur Industrial Estate, Daingean Road, Tullamore which is presently licensed by the EPA (ref: W0113-02).

Yours Sincerely

Niall Nally  
Environmental Consultant

CC. Mr Kurt M Kyck, KMK Metals, Cappincur Ind Estate, Tullamore.



**BOW HOUSE O'MOORE STREET TULLAMORE CO. OFFALY**  
T/F: 057 935 2200 • email: [info@enviroco.ie](mailto:info@enviroco.ie) • [www.enviroco.ie](http://www.enviroco.ie)

Registered in Ireland, Number 297801 • Directors: A. Fahey. D. Fahey



**St Sheelan's Community Childcare Services Limited**

Completed application forms should be returned to the above address not later than 4.30 p.m. on Thursday 31st May 2007

St Sheelan's Community Childcare Services Ltd is an equal opportunities employer



Funded by the Irish Government under the National Childcare Investment Programme 2006-2010

**Company Accountant Required**

We currently have a vacancy for a Company Accountant dealing with the full financial control of businesses in the following areas:

- Estate Agency
- Property Developers
- Hotel Development
- Hotel Operations
- Retail Outlets Equestrian
- Mortgage Brokers

The ideal candidate will be a Part/Fully Qualified Accountant (ACCA, CPA, ACA) with a minimum of 3 years experience. Experience in any of the above areas would be a distinct advantage. Apply with C.V. and Two Written References to: **Human Resource Manager, The Killally Group, Property House, Edenderry, Co. Offaly. 046 9733333 (t) 046 9732929 (f) "mailto:hr@gerardkillally.com"**

Closing Date 24th May 2007

**Chef / Cook Required**

Full time position  
Tullamore area  
Reply to Box No. 298

**AUDIT SENIOR**

Audit Senior required to service and manage corporate client base. Candidate should have excellent computer skills using Microsoft Office and Sage Apex or similar practice software. Please apply to: **Michael Kinsella & Company, Registered auditors & Certified Public Accountants, McFadden House, Patrick Street, Tullamore, Co. Offaly.**

**MICHAEL KINSELLA & COMPANY**  
REGISTERED AUDITORS & CERTIFIED PUBLIC ACCOUNTANTS  
Our client based in Edenderry invites applications for the following position:  
**PART TIME FINANCIAL**

**CANVASSERS REQUIRED**

for Midlands area.  
€10 per appointment made.  
**Call Sinead on 086 3203990**

**WANTED HAIRDRESSER**

full or part-time for hair salon in Roscrea.  
Phone after 7pm  
**086 1627529.**

**Weekend Cook Required**

Sat-Sun 8-12am. Plus Bank Holidays with some experience of HACCP.  
Contact Sabrina  
**05793 27262**

**BAR STAFF Required**

For busy Tullamore Pub  
Apply to Box No. 296

**Cut'n' Curl, Birr - Requires - Fully-qualified stylist, full time / part-time.**

Apply with CV in writing to: Ediel McNamara, Cut'n' Curl, Johns Place, Birr.

**Staff Wanted**  
for Shop in Tullamore Town.  
Must have experience.

**FULL TIME GYM INSTRUCTOR REQUIRED**

SALARY: D.O.E.

Closing date 28th May '07

Please forward C.V. and letter of application to **The Manager, Birr Swimming Pool, Riverside, Birr, Co. Offaly.**

**Birr Swimming Pool and Gymnasium are now recruiting the following Staff:**

- Lifeguards (NPLQ) IWS/ILAM Qualifications
- Swim Teachers
- Aqua Aerobics Instructors

Full and part-time positions male/female

- Must have excellent communication skills
- Must speak fluent English
- Have a flexible approach to working hours
- Work as part of a team, or of their own initiative

Closing date: 28th may 2007

Panels may be formed on the basis of interviews held for these posts.

Please forward CV and letter of application to The Manager, Birr Swimming Pool, Riverside, Birr, Co. Offaly.



**Full time receptionist**  
Salary Negotiable

Experience desirable but NOT essential. Accommodation Staff fluent English essential. Contact Sinead Byrne or Robert Fleming on **057 9360034** or send CV to Sinead Byrne or Robert Fleming, **Days Hotel, Main St., Tullamore, Co. Offaly.**

Due to high volume of CV's only suitable Candidates will be replied to.

**Templemore Local Development Project**

Roscrea 2000 Ltd in Partnership with the Templemore Local Development Project are now recruiting for the

33942, 086 1709984 for interview.

FT PLUMBER/FITTER REQUIRED for busy Water Treatment managers to service our established clientele and service existing files. Experience is not essential. An excellent remuneration package is provided with ote of 50-80k per annum. If you are a car owner with a good standard of education and ready to commence work immediately please contact our recruitment manager on 087 9928505 or John on 087 1238412.

EXPERIENCED PERSON OFFERS Job skills such as • cleaning in general • Clothes Ironing • Babysitter. Irish References available. Please contact 087 7949158.

WOMAN FROM POLAND looking for job, will take care of kids, cleaning. Tel 087 6643989, 085 7384134.

WANTED TRADESMEN & LABOURERS for construction work in Midlands. Experienced men only please. Phone 087 3224659 or Email: builders.eire@btinternet.com. CHILD MINDER AVAILABLE Durrow, Tullamore area. Contact 087 7675018 after 6pm.

KIND, RELIABLE LADY AVAILABLE to mind children for the school holidays in her own home. Non-smoker. Roscrea area. Contact 087 7740538.

EXPERIENCED BAR STAFF REQUIRED. Tullamore town. Reply to Box no. 294.

VERY NICE GIRL AVAILABLE for cleaning, housekeeping, childminding, also social care for disabled person in Tullamore area. Got own transport. Contact Martin 087 9727050.

KIND, RELIABLE flexible childminder required. Phone 087 2589298.

CHEF REQUIRED for busy restaurant. Apply to Box No. 637.

APPLICATIONS ARE INVITED for part-time work. Suitable for refined lady with transport (where necessary). Tullamore town, could suit retired person, excellent conditions. References required, full details on applications. Contact Teresa after 7pm 087 9486965 Monday to Friday after 7pm or reply to Box No. 295.

PART-TIME MACHINIST WANTED Experience in alterations necessary. Reply with

**PUBLIC NOTICE**

Voters who are wheelchair users may apply to me, in writing, to transfer his or her vote to an alternative suitable polling station, provided that such applications are received by me no later than seven (7) days before polling day.

VERONA LAMBE,  
RETURNING OFFICER,  
COURTHOUSE,  
TULLAMORE,  
CO. OFFALY.

**Application To The Environmental Protection Agency For The Review Of A Waste Licence**

Notice is hereby given in accordance with the provision of the Waste Management Acts, 1996 to 2005, and the Waste Management (licensing) Regulations 2004 that KMK Metals Recycling Ltd., Cappincur Industrial Estate, Daingean Road, Tullamore, Co. Offaly will apply to the Environmental Protection Agency (EPA) Johnstown Castle Estate County Wexford for a review of their Waste Licence. The licence review application relates to the operation of a hazardous and non hazardous waste transfer facility located at Cappincur Industrial Estate, Daingean Road, Tullamore, Co. Offaly (National Grid Reference 3595E, 2500N)

The principal class of activity to be carried out by KMK Metals Recycling Ltd as defined by the Waste Management Act 1996 to 2005 is:-

Class 13 of the Fourth Schedule: Storage of waste intended for submission to any activity referred to in a preceding paragraph of this schedule other than temporary storage, pending collection, on the premises where the waste concerned is produced.

Other activities to be carried out on site include:-

Class 3 of the Fourth Schedule: Recycling or reclamation of metals and metal compounds.

Class 4 of the Fourth Schedule: Recycling or reclamation of other inorganic materials

Class 6 of the Fourth Schedule: Recovery of components used for pollution abatement

Class 7 of the Fourth Schedule: Recovery of components from catalysts

Class 11 of the Fourth Schedule: Use of waste obtained from any activity referred to in a preceding paragraph of this schedule.

Class 12 of the Fourth Schedule: Exchange of waste for submission to any activity referred to in a preceding paragraph of this schedule.

A copy of the waste licence review application and further information relating to the review as may be furnished by the Agency in the course of the Agency's consideration of the application, will as soon as is practicable after receipt by the Agency, be available for inspection or purchase, at the offices of the Environmental Protection Agency. P. O. Box 3000, Johnstown Castle Estate, Co. Wexford during office hours.

Comhairle Contae Thiobraid Árann Thuaidh  
North Tipperary County Council



**PLANNING NOTICE**

Pursuant to Part B of the Planning & Development Regulations, 2001 to 2006 North Tipperary County Council hereby gives notice of its intention to:

(A) construct the following houses, and associated site development



## SITE NOTICE

### APPLICATION TO THE ENVIRONMENTAL PROTECTION AGENCY FOR THE REVIEW OF A WASTE LICENCE

Notice is hereby given in accordance with the provisions of the Waste Management Acts 1996 to 2005, and the Waste Management (licensing) Regulations, 2004 that KMK Metals Recycling Ltd, Cappincur Industrial Estate, Daingean Road, Tullamore, Co. Offaly will apply to the Environmental Protection Agency (EPA), Johnstown Castle Estate, County Wexford for a review of their Waste Licence. The licence review application relates to the operation of a hazardous and non hazardous waste transfer facility located at Cappincur Industrial Estate, Daingean Road, Tullamore, Co Offaly (National Grid Reference: 3595E, 2500N).

**The principal class of activity to be carried out by KMK Metals Recycling Ltd as defined by the Waste Management Act 1996 to 2005 is;**

*Class 13 of the Fourth Schedule: Storage of waste intended for submission to any activity referred to in a preceding paragraph of this Schedule, other than temporary storage, pending collection, on the premises where the waste concerned is produced.*

Other activities to be carried out on site include;

*Class 3 of the Fourth Schedule: Recycling or reclamation of metals and metal compounds.*

*Class 4 of the Fourth Schedule: Recycling or reclamation of other inorganic materials.*

*Class 6 of the Fourth Schedule: Recovery of components used for pollution abatement.*

*Class 7 of the Fourth Schedule: Recovery of components from catalysts*

*Class 11 of the Fourth Schedule: Use of waste obtained from any activity referred to in a preceding paragraph of this schedule.*

*Class 12 of the Fourth Schedule: Exchange of waste for submission to any activity referred to in a preceding paragraph of this schedule.*

A copy of the waste licence review application and further information relating to the review as may be furnished by the Agency in the course of the Agency's consideration of the application, will, as soon as is practicable after receipt by the Agency, be available for inspection or purchase, at the offices of the Environmental Protection Agency, PO Box 3000, Johnstown Castle Estate, Co. Wexford during office hours.

Signed:

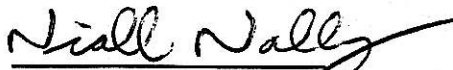

**Niall Nally (Agent), ENVIROCO Management Ltd, O'Moore St,  
Tullamore, Co Offaly**

Date:

**18<sup>th</sup> May 2007**