

EPA Licence No: 163 - 1
Waste Collection Permit No: CW 028
VAT No: IE 8288637F

*Industrial Estate
Ballaghaderreen,
Co Roscommon*

TEL: 094 9860807 FAX: 094 9860814
Email: bwd@eircom.net

Johnathon Derham
Licensing & Guidance
Environmental Protection Agency
PO Box 3000
Johnstown Castle Estate
Co. Wexford

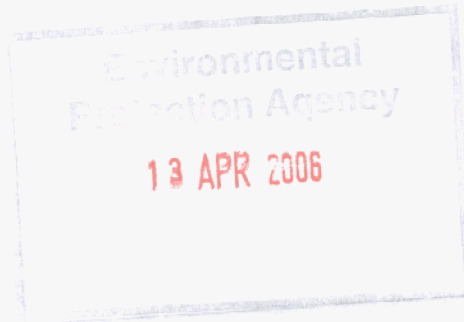

12/4/06

RE: Application for a Technical Amendment to an existing waste licence, (ref. no. 163-1)

Dear Mr. Derham,

Further to my phonecall to EPA inspector for Bergin Waste (Kealan Reynolds) today, he advised me to get in contact with you.

I have enclosed an application for a technical amendment of Bergin's Waste Licence existing waste licence 163-1, to extend the boundary to include land adjacent to Bergin's current waste licensed facility. The application comprises of a description of the proposed changes, plus a site plan detailing the existing site boundary, and the new site boundary.

I hope this information is to your satisfaction. If you have further queries, please don't hesitate to contact me directly at (086) 0533700

Yours sincerely,

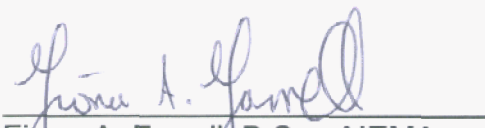
Fiona A. Farrell, B.Sc., AIEMA
For & on behalf of Bergin Waste Disposal Ltd.



Application for a Technical Amendment to Bergin Waste
Disposal's existing waste licensed facility 163-1

Date: 12/4/06

Nature of Request:

Bergin Waste Disposal Ltd. hereby request that a technical amendment be made to Bergin's waste licence (ref. no. 163-1), to extend the site's boundaries.

Description of Site:

In 2005 Bergin's acquired approximately 2.5 acres of land immediately adjoining their existing facility.

Location of Site:

The additional site is located immediately adjacent to the existing facility, and is located in an Industrial Estate. An outline of the existing site (in red) and proposed new site (in blue) is included in the two site plans attached.

Reason for Site Expansion:

Bergin's Facility is an important facility in terms of complying with the requirements of the Connaught Waste Management Plan. It is one of only 5 waste transfer facilities in the region. Bergin provided waste and recycling services to most of Roscommon, & Sligo, as well as parts of Leitrim, Mayo, and Galway. The Review of the Connaught Waste Management Plan, prepared in 2004 states that "an adequate network of facilities for recovery and transfer of waste will be provided. This will be achieved by encouraging the private sector to provide and expand such facilities".

Bergin's have been continually updating and improving their waste and recycling handling capacity (in line with the Connaught Waste Management Plan) through the introduction of new plant, infrastructure and buildings. Using the adjacent facility for the storage of skips, waste & private vehicles will improve capacity and facilitate better utilisation of the existing facility for waste management and recycling.

Plans for New Site:

The new site will be utilised for the storage of skips, waste vehicles and private vehicles. In addition, at a later stage (6 months – one year) this facility is expected to be utilised for construction of additional buildings, to improve recycling infrastructure and storage. Additional information will be submitted to the EPA, when this arises.

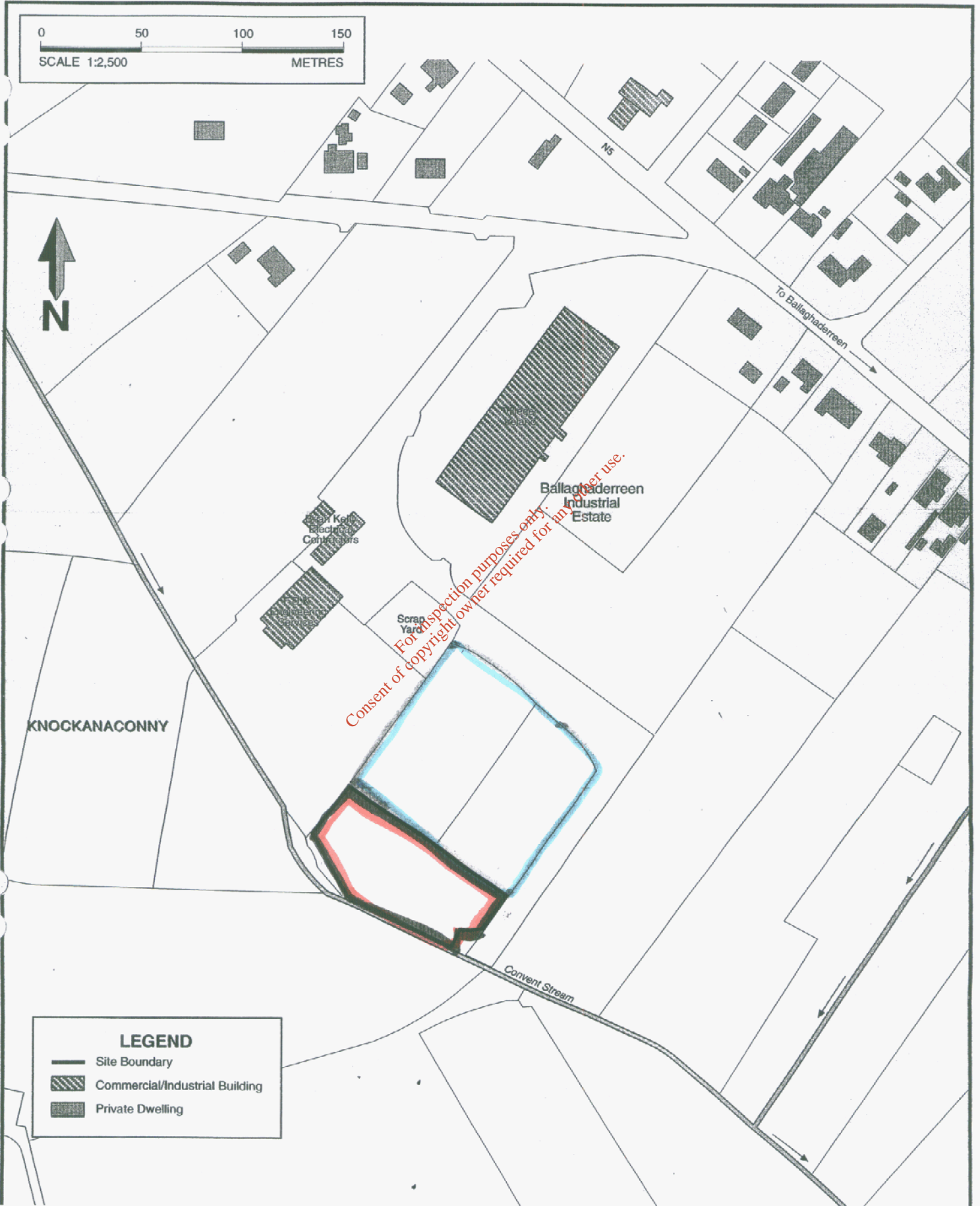

For inspection purposes only.
 Consent of copyright owner required for any other use.

LEGEND	
	Site Boundary
	Commercial/Industrial Building
	Private Dwelling

Surveyed 1994
 Revised 1999
 Levelled 1987

Rural PLACE Map

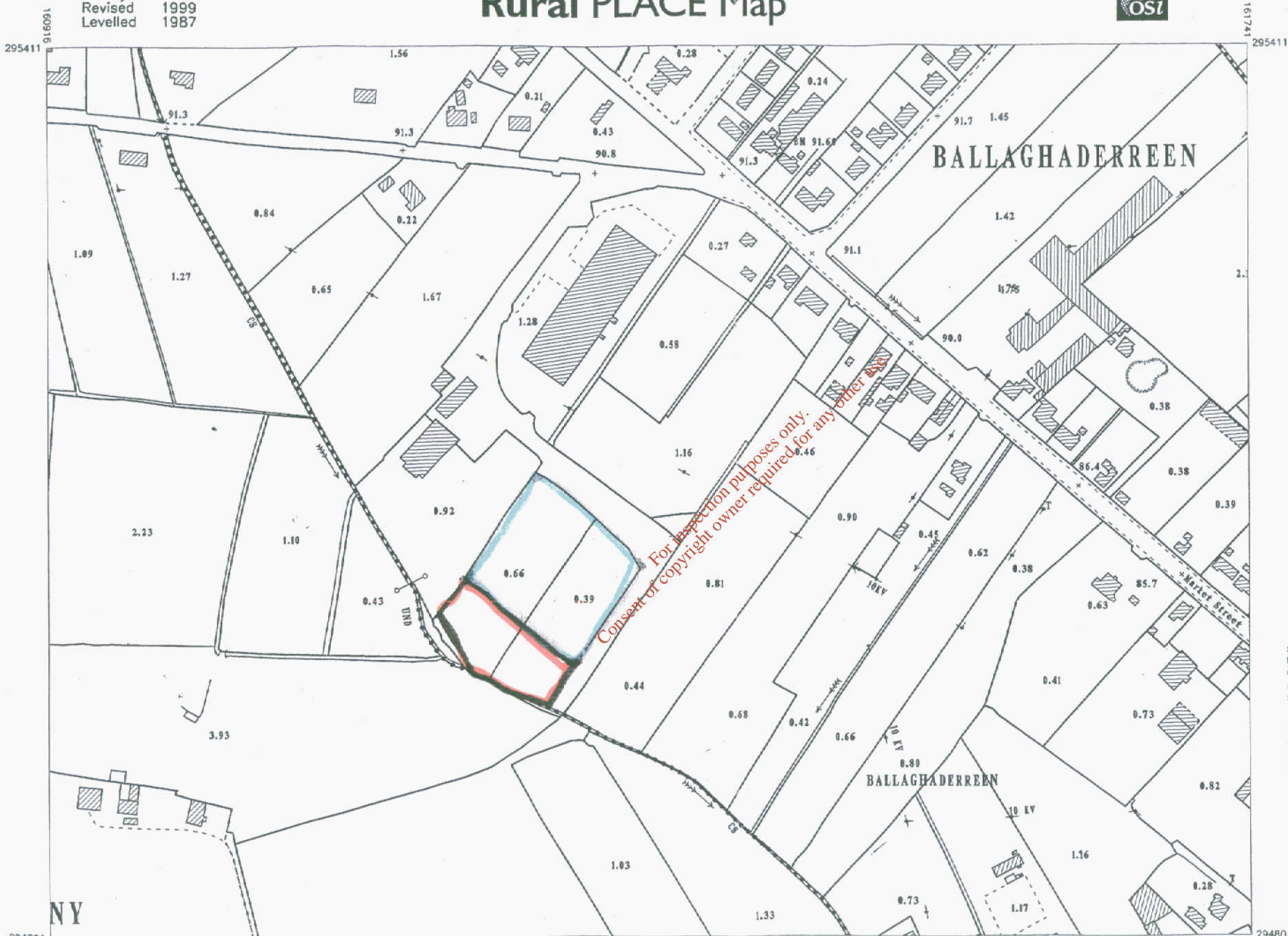

DESCRIPTION

MAP SCALES

1:2500
 1857-C 1917-A



Suirbhéireacht Ordánais Éireann, Páirc an hIonnuisce, Baile Átha Cliath a thionsaigh, a chéigh agus a d'holáigh.
 Compiled, printed and published by Ordnance Survey Ireland, Phoenix Park, Dublin.

Ní hionann bóthar, béalach nó cosán a bheith ar an léarscáil seo agus fianaise ar chosd áil.
 The representation on this map of a road, track or footpath is not evidence of the existence of a right of way.

Dianhosca ar mhacasamhíl an iomláin ná aon chuid de gan chead roimh ré ó Súirbhéir Shuirbhéireacht Ordánais Éireann.
 Reproduction in whole or in part is prohibited without the prior permission of the Director of Ordnance Survey Ireland.

© Réaltas na hÉireann, 2000
 © Government of Ireland, 2000

NY

294801 160691 161741 295411

Scale: - 1:2500
 Scála: - 1:2500

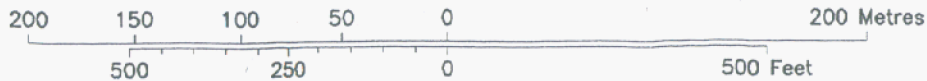

Plot Ref. No. 156633_1_2
 Plot Date 20-NOV-2000