

Viewpoint 30 – Howth Road Killbarrack



As existing

Description:

View from alongside Howth Road at Killbarrack approximately 6,5 km from the proposed site.



As proposed

Visual Impact:

The existing Poolbeg Station and associated Stacks dominate the view of the background of the Dublin Mountains. The proposed WtE Facility is view against the upland background and avoids impact on the skyline. The proposed development will give rise to slight landscape and moderate visual impact.

Viewpoint 31 – Cliff Walk, Howth Head



As existing

Description:

View west from the cliff walk on Howth Head over 10 km from the proposed site.



As proposed

Visual Impact:

While the existing Poolbeg Station and Stacks are visible in the distance the proposed WtE Facility lies directly behind and as such is barely visible from this distance. The proposed development will have a slight to imperceptible landscape and visual impact.

Viewpoint 32 – Sandymount Strand (Roslin Park College) Day-time



As existing

Description:
Day-time view from Sandymount Strand approximately 1 km from the proposed site.



As proposed

Visual Impact:
While the existing stacks on the peninsula remain prominent, the proposed WtE Facility forms an imposing visual element on the peninsula. The architectural styling and form of the landmark building can be fully appreciated. The proposed development will give rise to significant landscape and visual impact

Viewpoint 33 – Irishtown Nature Park



As existing

Description:
View from Irishtown Nature Park less than 0.5 km from the proposed site.



As proposed

Visual Impact:
The scale of the proposed WtE Facility is fully appreciated within the view. However, the architectural quality and form is also obvious as is the landmark aspect of the imposing development. The proposed development will give rise to significant landscape and visual impact.

For inspection purposes only.
Content of copyright owner required for any other use.

Viewpoint 34 – Mount Annville Road



As existing

Description:

View from elevated vantage on Mount Annville Road approximately 5 km from the proposed site.



As proposed

Visual Impact:

Views are often obscured by development and vegetation. However, where views exist they can be expansive and panoramic due to the elevated vantage of the location. The existing stacks at Poolbeg are prominent while the proposed WtE Facility is generally viewed against a city background with only the upper aspects of the stacks above the horizon. The proposed development will give rise to slight landscape and visual impact.

Viewpoint 35 – Blackrock Park



As existing

Description:

View north from Blackrock Park over 4km from the proposed site.



As proposed

Visual Impact:

The view is across open water to the visually prominent existing stacks at Poolbeg. Where views exist, the proposed WtE Facility is also prominently located on peninsula. The proposed development will give rise to slight landscape and moderate visual impact.

Viewpoint 36 – Ferry terminal Dublin Port



As existing

Description:

Day-time view from Dublin Port Ferry Terminal less than 1km north of the proposed site.



As proposed

Visual Impact:

The proposed WtE Facility is openly viewed as part of the port-related development on the peninsula. In keeping with surrounding development the proposed development rises prominently over the background horizon. The proposed development will result in moderate landscape and significant visual impact.

Viewpoint 37 – Ferry terminal Dublin Port (Night-time)



As existing

Description:
Night-time view from Dublin Port Ferry Terminal less than 1km north of the proposed site.



As proposed

Visual Impact:
The peninsula is a highly illuminated city environment. The glazing in the north elevation of the proposed WtE Facility adds visual interest to the otherwise dark shape of the development. The proposed development gives rise to slight landscape and visual impact.

Viewpoint 38 – Sandymount Strand (Roslin Park College) night-time



As existing

Description:
Night-time view from Sandymount Strand approximately 1 km from the proposed site.



As proposed

Visual Impact:
The peninsula is part of a highly illuminated city environment. Within this context the proposed WtE Facility does not add to this effect and has only slight to imperceptible landscape and visual impact.

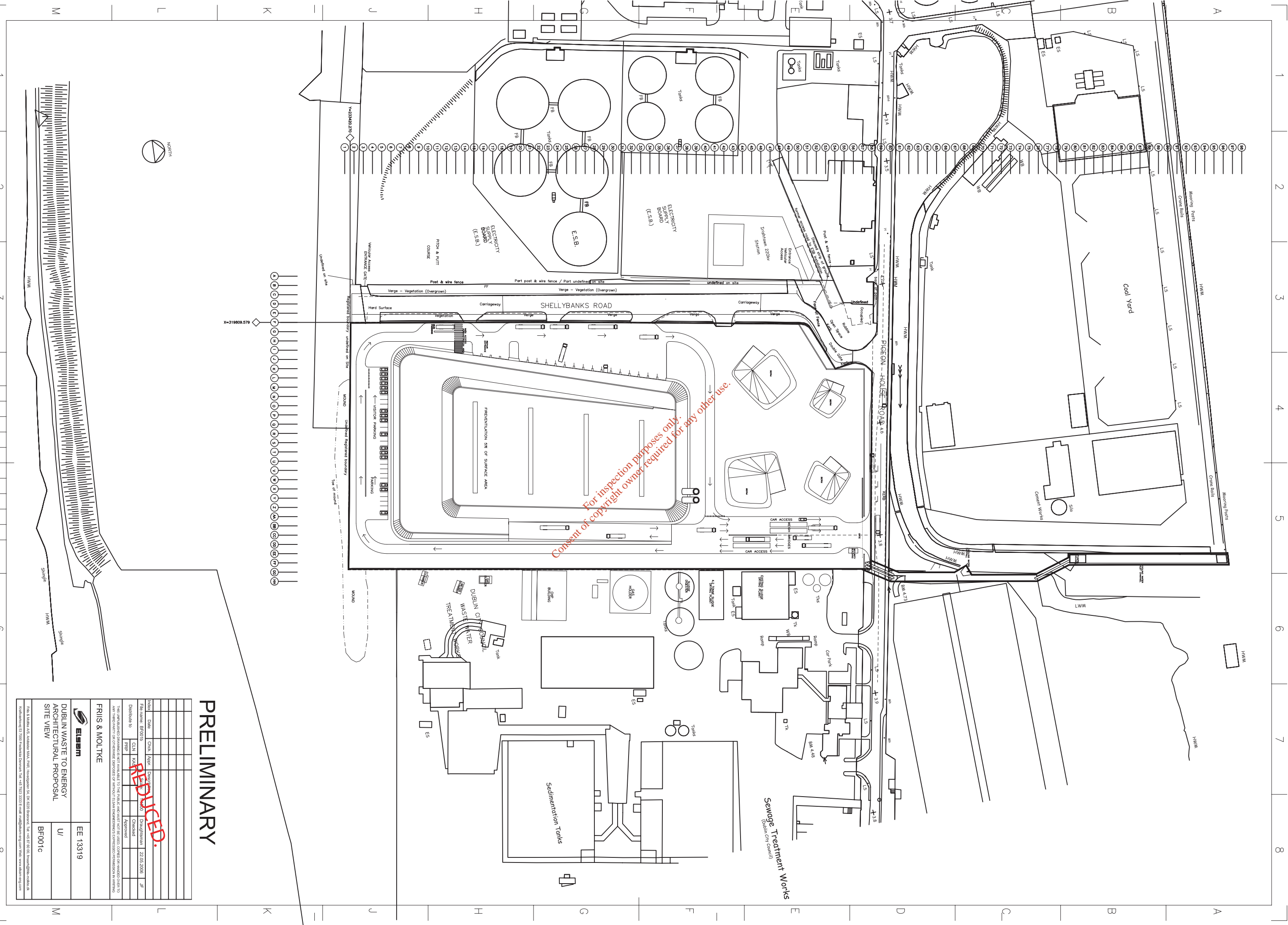

For inspection purposes only.
Consent of copyright owner required for any other use.

PRELIMINARY



Issue	Date	Check	Appr.	Design	Checked	Approved
Final name: BF001b	22.05.2006	CLN	ICL	DF	DF	DF
Distributed to:	FRP	ICL	DF	DF	DF	DF

FRIS & MOLTKE

EE 13319

DUBLIN WASTE TO ENERGY ARCHITECTURAL PROPOSAL SITE VIEW

BF001c

FRIS & MOLTKE A/S, Skovvej 1A, DK-2205 Brøndby, Tel: +45 77 20 00, Email: info@fris-moltke.dk
Kontaktperson: Stig Torslev, Telefon: +45 77 20 3333, E-mail: stigt@fris-moltke.dk, Web: www.fris-moltke.com

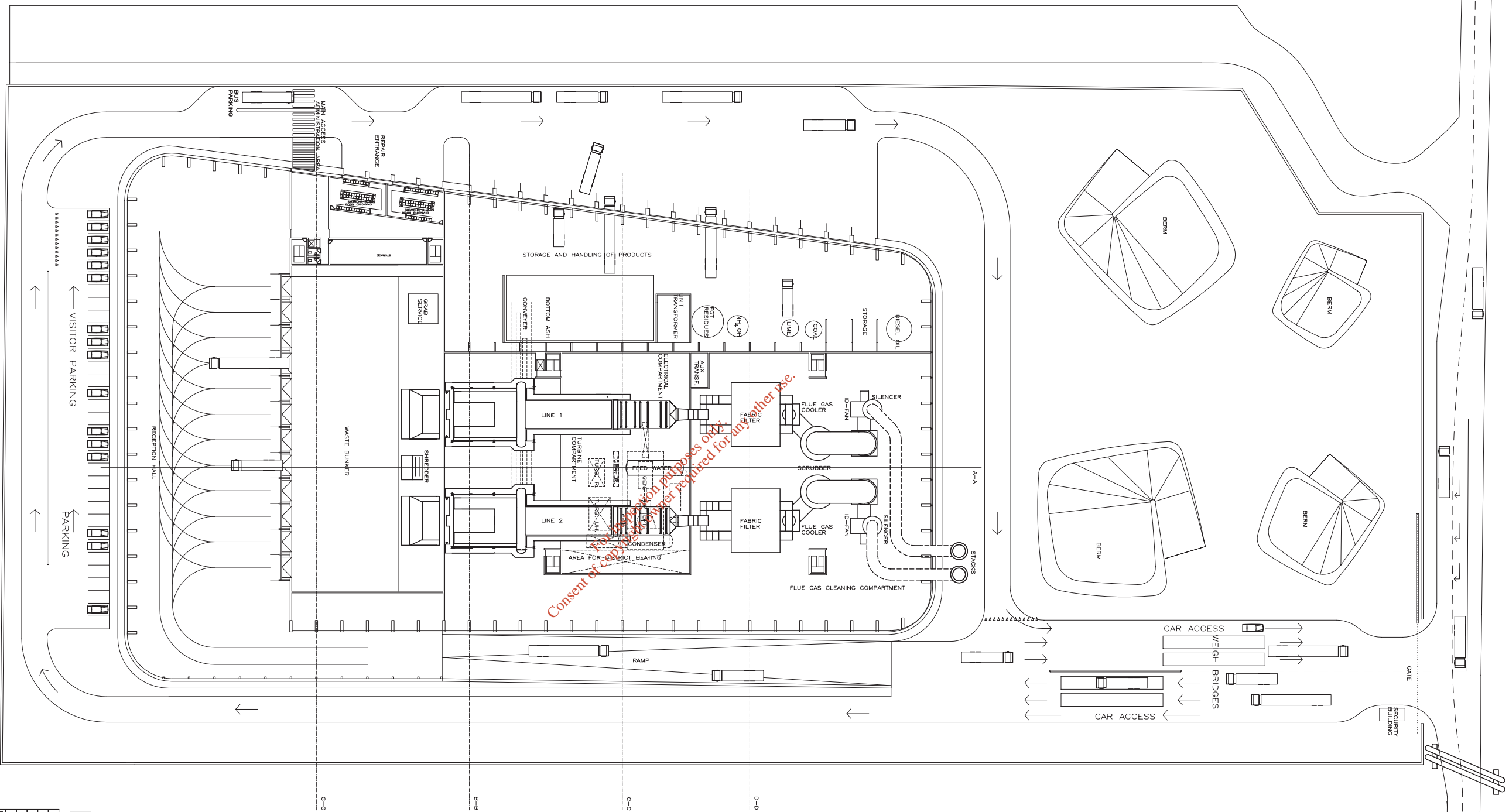

This drawing is for your eyes only.
 Consent of copyright holder required for any other use.



PRELIMINARY

Issue	Date	Check	Appr.	Discipline	Drawn by	Checked	Approved
1	22.05.2006	CLN	KAS	PP	JF		
This drawing is for your eyes only. Consent of copyright holder required for any other use.							
FRIS & MOLTKE				EE 13319			
DUBLIN WASTE TO ENERGY ARCHITECTURAL PROPOSAL PLAN VIEW				U/			
BF002c				BF002c			

File: & Model: A35_Architectural_Plan_View.dwg
 Project: Dublin Waste to Energy
 Date: 22.05.2006
 Drawn by: JF
 Checked: CLN
 Approved: KAS

1 2 3 4 5 6 7 8

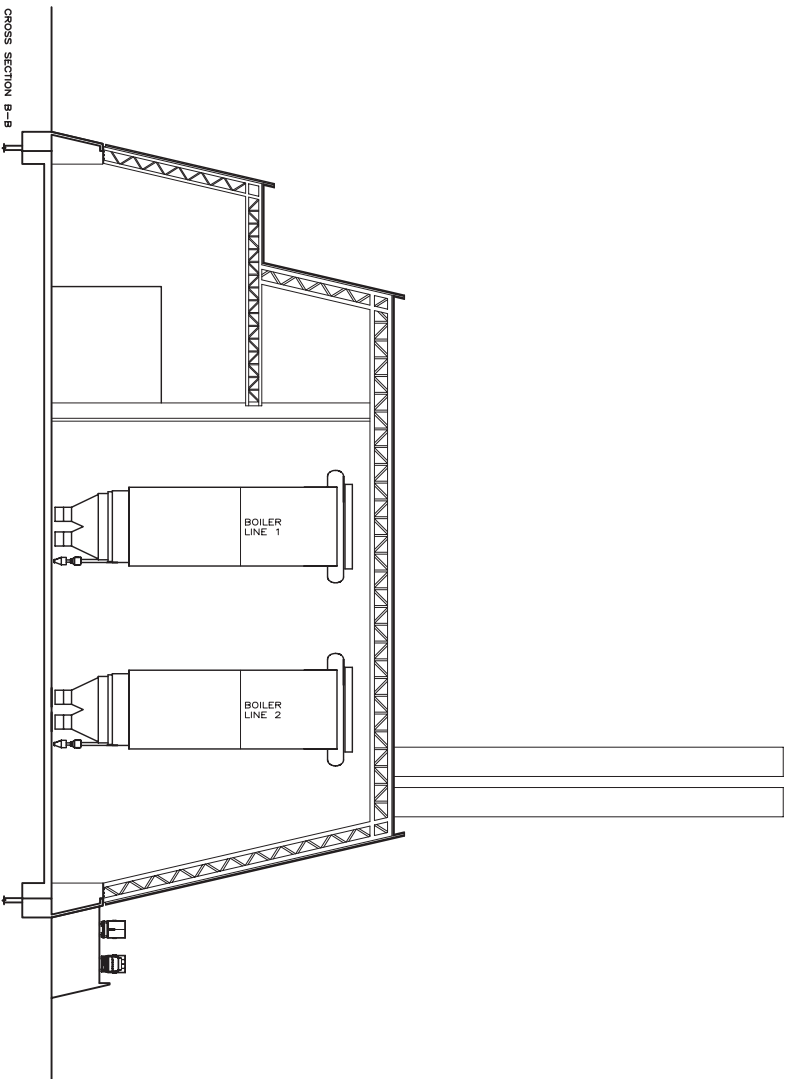

J K L M N O P Q R S T U V W X Y Z AA BB CC DD EE

For inspection purposes only.
 Copyright of copyright owner required for any other use.

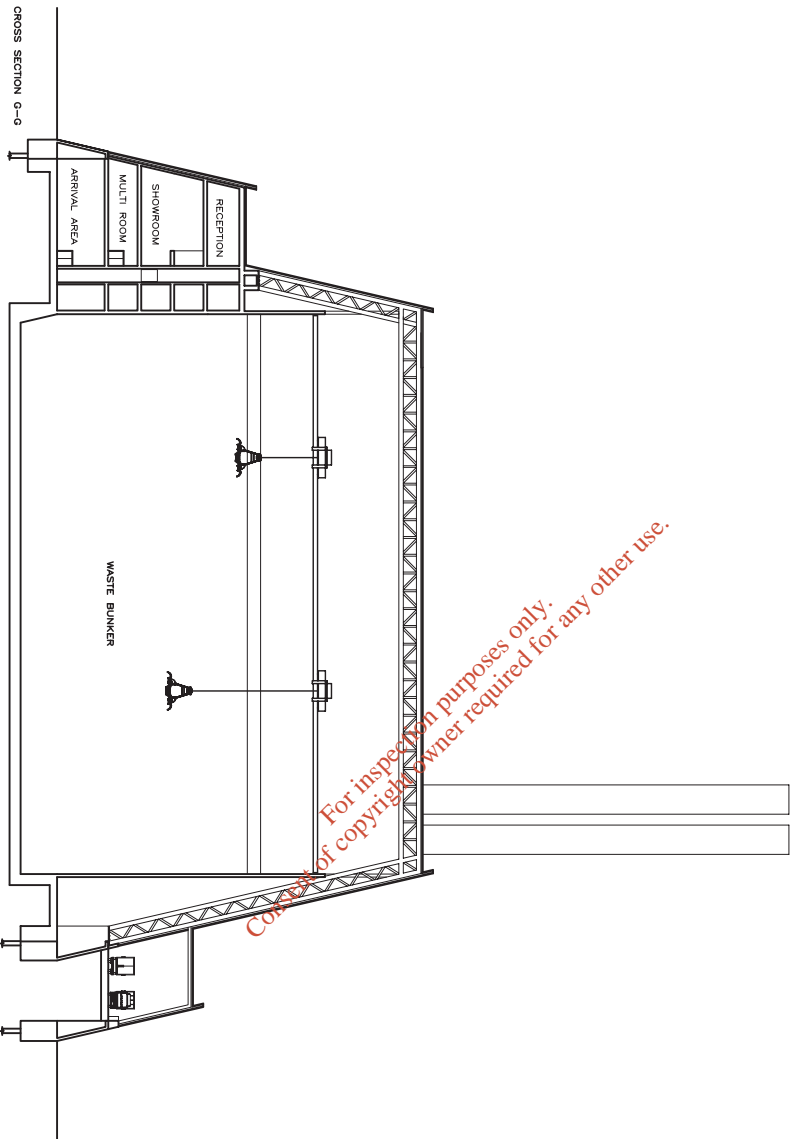

J K L M N O P Q R S T U V W X Y Z AA BB CC DD EE

20
19
18
17
16
15
14
13
12
11

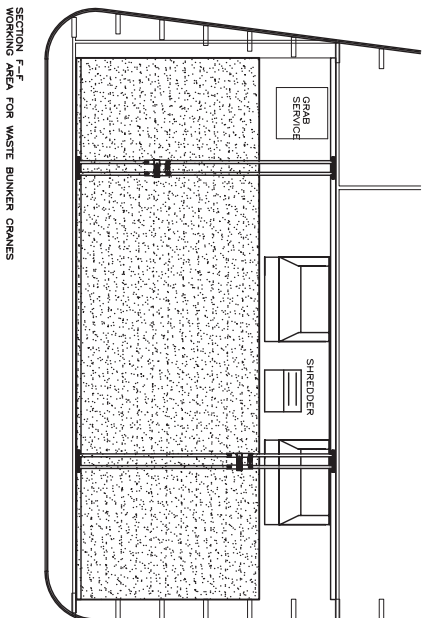

L M N O P Q R S T U V W X Y Z AA

PRELIMINARY

Index	Date	Check	Author	Description
File Name	BP003a	CLM	KAS	22.06.2006
Distributed to	PRB			
<p>NOT TO BE USED FOR CONSTRUCTION WITHOUT THE SIGNATURE OF THE DESIGNER. THE DESIGNER'S SIGNATURE IS REQUIRED FOR ALL WORKS. THE DESIGNER'S SIGNATURE IS REQUIRED FOR ALL WORKS. THE DESIGNER'S SIGNATURE IS REQUIRED FOR ALL WORKS.</p>				

REDUCED

FRIS & MOLTKE		ELSBM
DUBLIN WASTE TO ENERGY ARCHITECTURAL PROPOSAL CROSS SECTION A-A B-B C-C D-D		EE 13319
U /		BF003a
<small>FRIS & MOLTKE AG, Alsterufer 10A, 20451 Hamburg, Germany. Tel: +49 40 700 33 33 33. Email: info@fris-moltke.com ELSBM AG, Alsterufer 10A, 20451 Hamburg, Germany. Tel: +49 40 700 33 33 33. Email: info@elsbm.com</small>		