

**LEGEND**

- APPLICATION SITE BOUNDARY
- STREAM
- POST AND WIRE FENCE
- LEACHATE LINE
- ESB LINE
- TELEPHONE LINE
- cSAC BOUNDARY
- HEDGE
- ~ ACOUSTIC BARRIER 2.0m HIGH
- - - SILT FENCE
- 148 PROVISIONAL DESIGN LEVEL
- DIRECTION OF SURFACE WATER FLOW
- LINED AREA READY FOR DISPOSAL OF RESIDUAL WASTE
- AREA PARTLY FILLED WITH RESIDUAL WASTE
- AREA WITH INTERIM CAPPING LAYER
- AREA WITH FINAL CAPPING LAYER

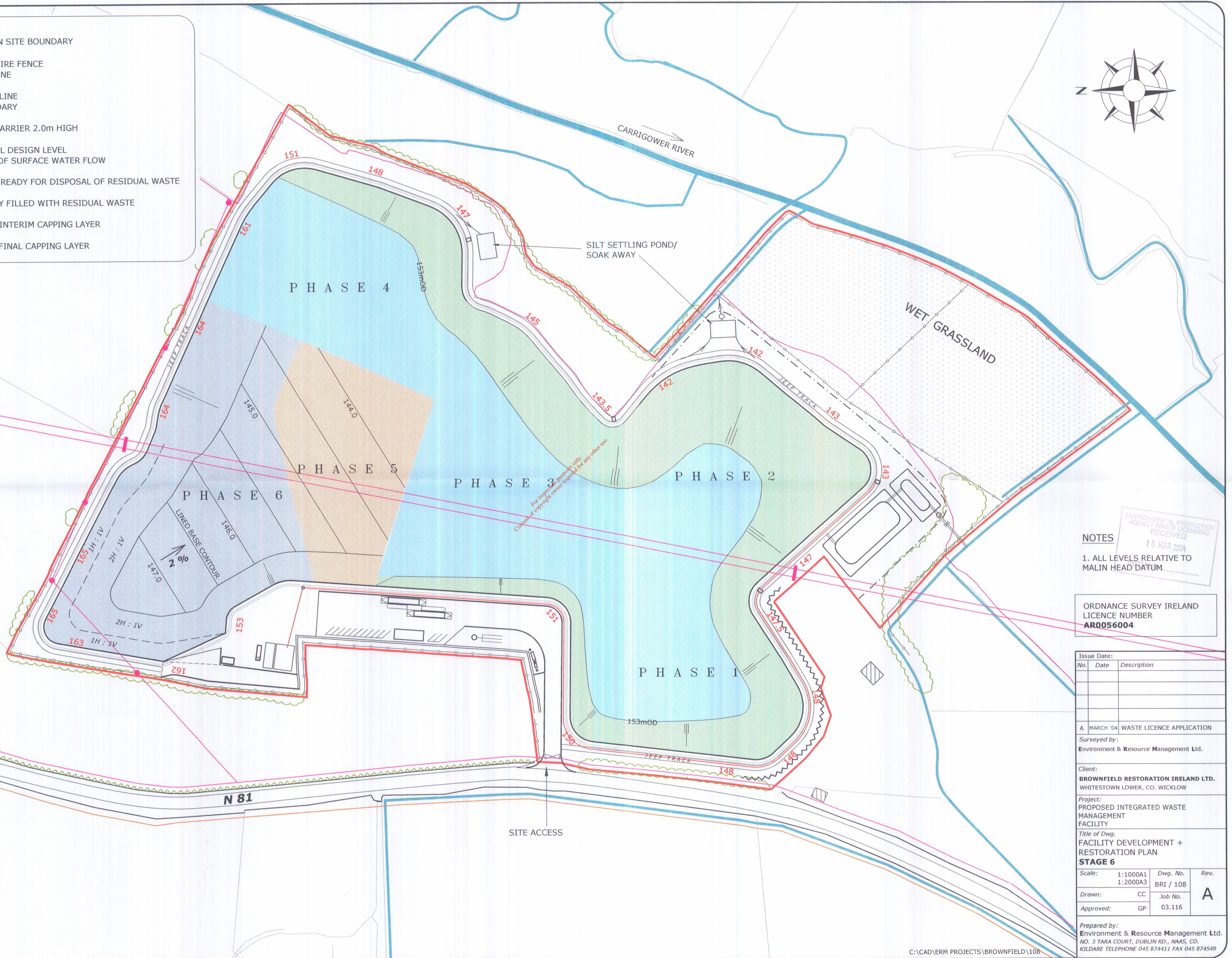
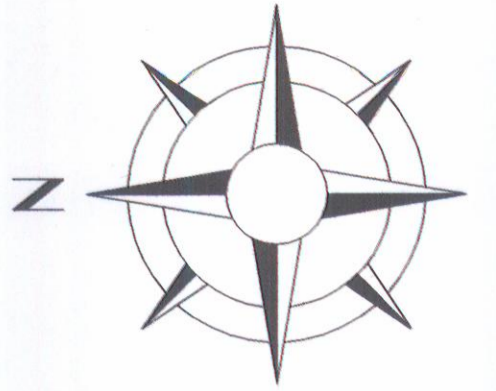

**NOTES**

1. ALL LEVELS RELATIVE TO MALIN HEAD DATUM.

ENVIRONMENTAL PROTECTION  
AGENCY WASTE LICENSING  
RECEIVED  
18 MAR 2004

ORDNANCE SURVEY IRELAND  
LICENCE NUMBER  
**AR0056004**

Issue Date:			
No.	Date	Description	
A	MARCH '04	WASTE LICENCE APPLICATION	
Surveyed by: Environment & Resource Management Ltd.			
Client: <b>BROWNFIELD RESTORATION IRELAND LTD.</b> WHITESTOWN LOWER, CO. WICKLOW			
Project: PROPOSED INTEGRATED WASTE MANAGEMENT FACILITY			
Title of Dwg. <b>FACILITY DEVELOPMENT + RESTORATION PLAN STAGE 6</b>			
Scale:	1:1000A1 1:2000A3	Dwg. No. BRI / 108	Rev. <b>A</b>
Drawn:	CC	Job No.	
Approved:	GP	03.116	
Prepared by: Environment & Resource Management Ltd. NO. 3 TARA COURT, DUBLIN RD., NAAS, CO. KILDARE TELEPHONE 045 874411 FAX 045 874549			