

217-1

# Environmental Impact Statement for Killarney Waste Disposal



ENVIRONMENTAL PROTECTION  
AGENCY WASTE LICENSING  
RECEIVED  
- 3 FEB 2005  
INITIALS..... *K*

*For inspection purposes only.  
Consent of copyright owner required for any other use.*

## Volume II : Main Report

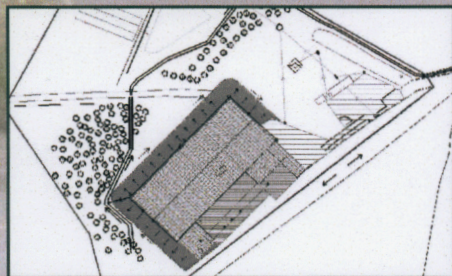

**January 2005**





# DOCUMENT CONTROL SHEET

Client	Killarney Waste Disposal					
Project Title	Killarney Waste Disposal Waste Licence Application					
Document Title	Environmental Impact Statement – Vol. II, Main Report					
Document No.	MGE0031RP0005GAL					
This Document Comprises	DCS	TOC	Text	List of Tables	List of Figures	No. of Appendices
	1	1	47	1	1	-

Rev.	Status	Author(s)	Reviewed By	Approved By	Office of Origin	Issue Date
F01	Final	S. Aherne	W. Madden	W. Madden	Galway	31/01/05

# ENVIRONMENTAL IMPACT STATEMENT

for

**Killarney Waste Disposal Ltd**

**January 2005**

*For inspection purposes only.  
Consent of copyright owner required for any other use.*

**VOLUME I    NON-TECHNICAL SUMMARY**

**VOLUME II    MAIN REPORT**

**VOLUME III    TECHNICAL APPENDICES**

Volume II  
Main Report

*For inspection purposes only.  
Consent of copyright owner required for any other use.*

## TABLE OF CONTENTS

<b>1. INTRODUCTION</b>	<b>1</b>
1.1 PROPOSED DEVELOPMENT	1
1.2 STRUCTURE OF THE REPORT	1
Human Beings	2
Natural Environment	2
1.3 THE PROJECT	2
1.3.1 Existing Facility	2
1.3.2 Proposed Development	5
1.4 THE NEED FOR THE PROJECT	5
1.5 ALTERNATIVES	5
1.6 LEGISLATIVE REQUIREMENTS	5
1.6.1 Environmental Impact Assessment	5
1.6.2 Waste Licence	6
1.7 CONSULTATION PROCESS	6
1.9 DIFFICULTIES ENCOUNTERED DURING THE ASSESSMENT	7
<b>2. PROPOSED DEVELOPMENT</b>	<b>8</b>
<b>3. EXISTING ENVIRONMENT</b>	<b>11</b>
HUMAN BEINGS	11
3.1 COMMUNITY EFFECTS & MATERIAL ASSETS	11
3.2 TRAFFIC	12
3.3 AIR QUALITY	13
3.4 NOISE	13
NATURAL ENVIRONMENT	14
3.5 GEOLOGY & HYDROGEOLOGY	14
3.5.1 Bedrock Geology	14
3.5.2 Soils and Subsoils	14
3.5.2 Hydrogeology	14
3.5.4 Vulnerability	14
3.6 WATER QUALITY	15
3.6.1 Surface Water Quality	15
3.6.2 Fish Assessment	16
3.7 TERRESTRIAL FLORA & FAUNA	19
3.7.1 Habitats and Vegetation	19
3.7.2 Fauna	21
3.8 ARCHAEOLOGY & CULTURAL HERITAGE	21
3.9 LANDSCAPE	22
3.9.1 Site Context	22
3.9.2 Landscape Character	22
3.9.3 Landscape Quality	23
3.9.4 Significance	23
3.9.5 Site Visibility	23
<b>4. ENVIRONMENTAL IMPACTS AND MITIGATION MEASURES</b>	<b>25</b>
HUMAN BEINGS	25
4.1 COMMUNITY EFFECTS & MATERIAL ASSETS	25
4.2 TRAFFIC	25
4.2.1 Potential Impacts	25
4.2.2 Mitigation Measures	26
4.3 AIR QUALITY	26
4.3.1 Potential Impacts	26

4.3.2	Mitigation Measures .....	27
4.4	NOISE & VIBRATIONS .....	27
	NATURAL ENVIRONMENT .....	28
4.5	GROUNDWATER .....	28
4.5.1	Impacts .....	28
4.5.2	Mitigation Measures .....	29
4.6	SURFACE WATER QUALITY .....	30
4.6.1	Potential Impacts During the Construction Period .....	30
4.6.1	Potential Impacts During the Operation Period .....	31
4.6.3	Mitigation Measures .....	33
4.6.3	Residual Impacts .....	34
4.7	TERRESTRIAL FLORA & FAUNA .....	34
4.7.1	Impacts .....	34
4.7.2	Mitigation Measures .....	35
4.8	ARCHAEOLOGY & CULTURAL HERITAGE .....	35
4.9	LANDSCAPE .....	35
4.9.1	Potential Impacts .....	36
4.9.2	Mitigation Measures .....	37
4.9.3	Predicted Impacts .....	38
<b>5.</b>	<b>INTERACTION OF EFFECTS .....</b>	<b>39</b>
5.1	SIGNIFICANCE OF POTENTIAL IMPACTS .....	39
5.2	INTERACTION OF PREDICTED RESIDUAL IMPACTS .....	43
<b>6.</b>	<b>CONCLUSION .....</b>	<b>45</b>
6.1	COMMUNITY EFFECTS & MATERIAL ASSETS .....	45
6.2	TRAFFIC .....	45
6.3	AIR QUALITY .....	46
6.4	NOISE & VIBRATIONS .....	46
6.5	WATER QUALITY .....	46
6.6	TERRESTRIAL FLORA & FAUNA .....	46
6.7	ARCHAEOLOGY .....	47
6.8	LANDSCAPE .....	47
6.9	FINAL CONCLUSIONS AND RECOMMENDATIONS .....	47

## LIST OF TABLES

**Table 1.1: Types/Quantities of Waste Accepted at KWD (as per Waste Permit WP/23/03).**

**Table 2.1: Proposed Types/Quantities of Waste to be Accepted at KWD.**

**Table 3.1: Biological Assessment of Aughacureen drain.**

**Table 3.2: Chemical monitoring results for Aughacureen drain.**

**Table 4.1: Visual impact (without mitigation).**

**Table 5.1: EPA Classification Criteria.**

**Table 5.2: Summary of Potential Environmental Effects.**

**Table 5.3: Summary of Potential Interactions Resulting from the Facility.**

*For inspection purposes only.  
Consent of copyright owner required for any other use.*

## LIST OF FIGURES

Figure 1.1: Site Location Map.

Figure 2.1: Waste Processing Activities.

Figure 2.2: Outgoing Waste Shipment.

Figure 2.3: Existing MRF

Figure 3.1: Station 3: Local Road/Access Road junction at Aughacurreen.

## LIST OF DRAWINGS

Drawing No. 02-034-J4-MCOS1 Existing Site Layout Plan

Drawing No. 02-034-J4-MCOS2 Proposed Site Layout Plan

Drawing No. DG0002-01 Typical Layout for Proposed MRF Building

Drawing No. DG0001-02 Proximity to Residences within 500m of Boundary of Facility

Drawing No. DG0001-05 Monitoring Locations Dust, Air and Noise