

LOCATION MAP (Scale 1/100,000)

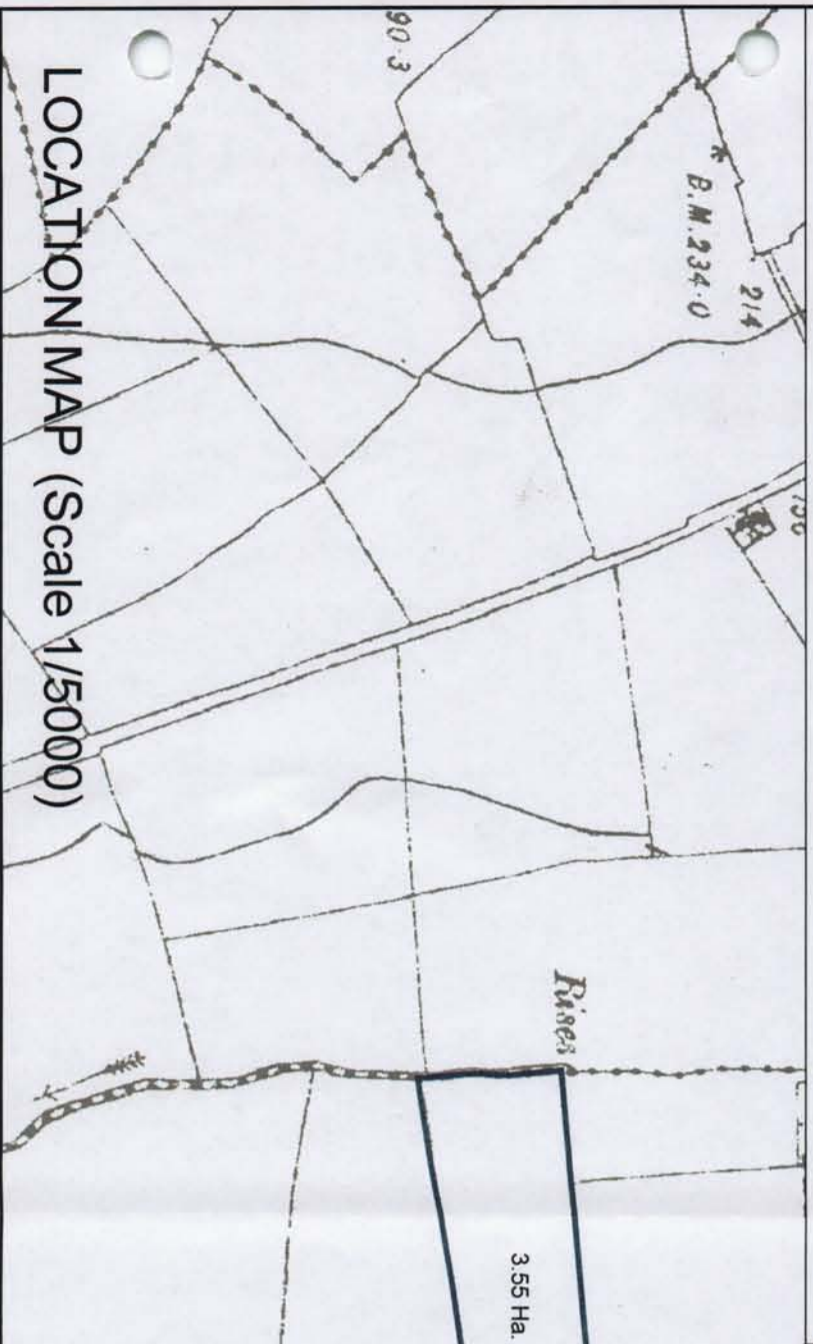

LOCATION MAP (Scale 1/5000)

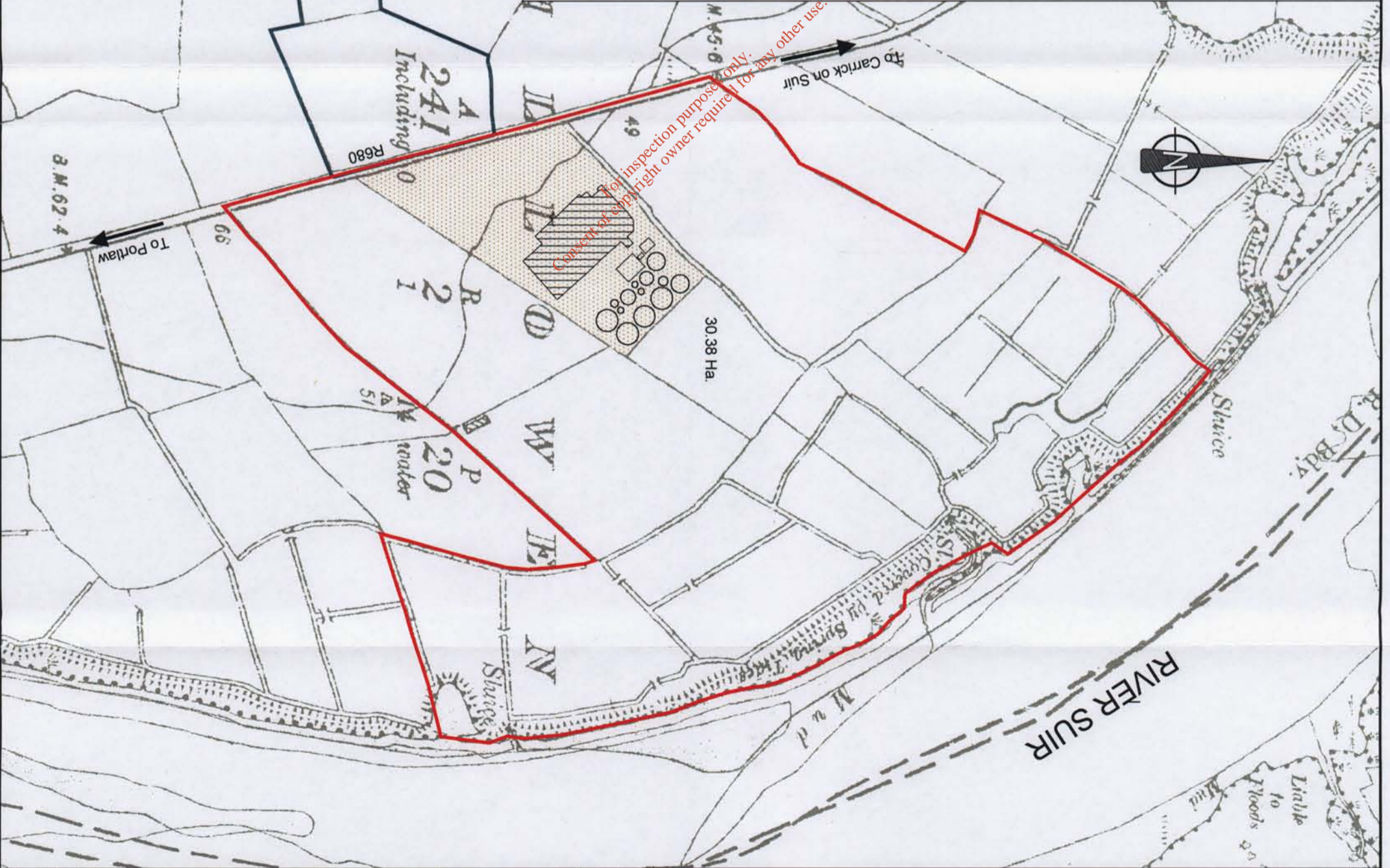

NOTES

1. This drawing is the property of RPS/MGOS Ltd. It is a confidential document and should not be used, or its content divulged without prior written consent.
2. All Levels refer to Ordnance Survey Datum, Mean Head.
3. DO NOT SCALE. Use figured dimensions only, if in doubt ask.

- Proposed Site Boundary
 - Additional Lands Leased
 - Location of Facility within Site
- OSI Map Reference:
Waterford 5497-D & 5562-B



Client:	AES Ltd.
Project:	WASTE LICENCE APPLICATION AT KILLOWEN, PORTLAW, CO. WATERFORD (NON-TECHNICAL SUMMARY)
Drawn by:	PHI
Checked by:	MC
Approved by:	TJM
Scale:	As Shown
Date:	04/2004

RPS MGOS
 RPS/MGOS Ltd. West Pier Business Campus,
 Don Loghinna, Co. Dublin, Ireland.
 T: +353 1 288 4488 F: +353 1 283 5876
 E: rpsmos@rpsgroup.ie W: www.rpsmos.ie

WASTE LICENCE APPLICATION
 AT KILLOWEN, PORTLAW,
 CO. WATERFORD
 (NON-TECHNICAL SUMMARY)

LOCATION MAP
 Figure A.1