

B.2 - Location of Activity

- The Site Plan is illustrated on Drawing 023045-102, at a scale of 1:500. The boundary of the Site to which the license application relates is outlined in red.
- The location of the site is shown on Figure B.2.1. at a scale of 1:10560. The boundary of the Site to which the license application relates is outlined in red.
- The attached Ordnance Discovery Series Map No. 43 has the site location marked as a red X. The grid reference can be read from this map.
- Postal Address: Greenclean Waste Management Ltd.
Coldwinters,
Blakes Cross,
Lusk,
Co. Dublin
- Grid Reference: E3199;N2519

*For inspection purposes only.
Consent of copyright owner required for any other use.*

Placeholder

This page has been inserted to indicate that content has been extracted from this location in the document and has been stored in a separate file.
(This is due to file size issues.)

The extracted content can be found in the following electronic pdf file:

Application Form-Drawing-1

For inspection purposes only.
Consent of copyright owner required for any other use.
Licence: W0222-01

LEGEND

— Site Boundary

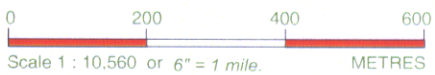
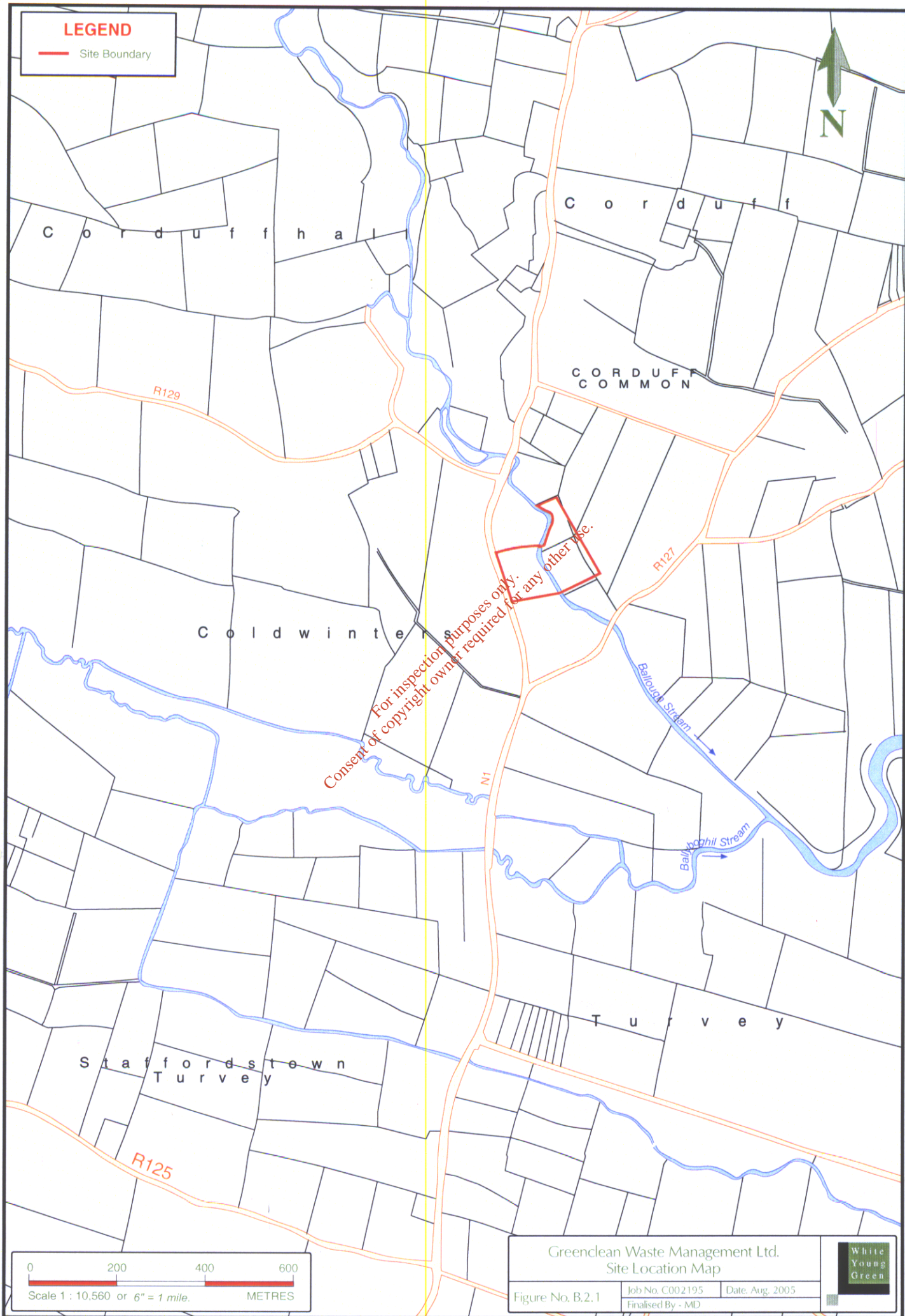

Greenclean Waste Management Ltd.
Site Location Map



Figure No. B.2.1

Job No. C002195 Date. Aug. 2005
Finalised By - MD

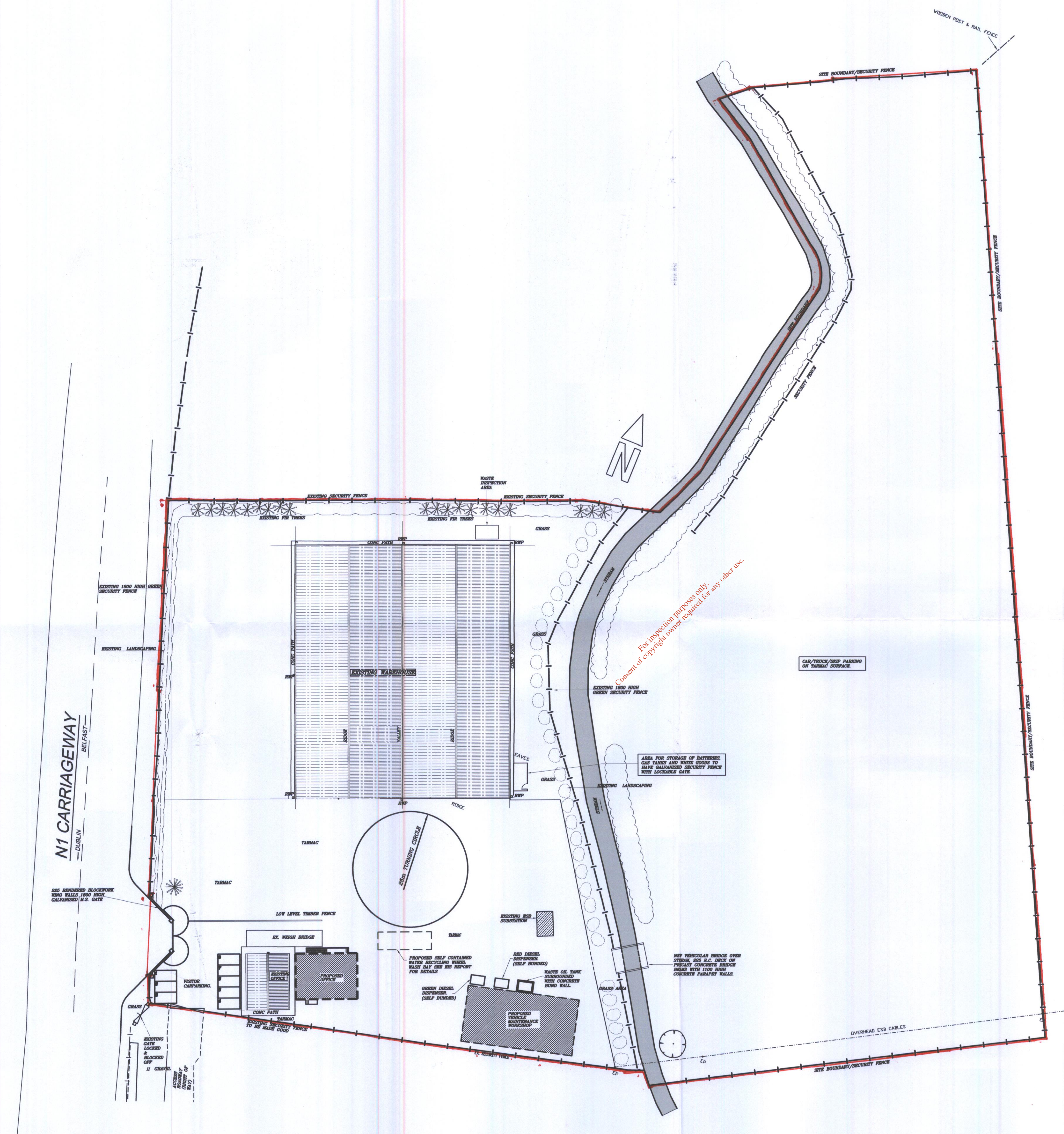

ENVIRONMENTAL PROTECTION
AGENCY WASTE LICENSING
RECEIVED
- 2 SEP 2005
INITIALS.....

WYG 29 AUG 2005
NO. 0002145
ACT
INFO
UNIT 6/1

19 AUG 2005 - Issued for
Waste Licence Application

project PROPOSED WORKSHOP
BLAKES CROSS
LUSK, CO. DUBLIN
FOR GREENCLEAN LTD
dwg title EXISTING
SITE PLAN

consulting civil & structural
DBFL
engineers
herbert house harmony row
dublin 2
telephone: 4004000
facsimile: 4004050
email: info@dbfl.ie

rev.	date	description	by	chkd
A	19.08.05	ADDITIONAL LANDS ADDED.	JD	DJ
none	SEPT. 03	first issue ISSUED FOR PLANNING PERMISSION	JD	DJ

architect GREENCLEAN WASTE
MANAGEMENT LTD.

scale 1:500	dwg. no. 023045-102	A
-------------	---------------------	---