

**Appendix C**  
**Visual Impact Assessment**  
**by**  
**Mitchell & Associates**  
**Landscape Architects**

Consent to publish for inspection purposes only.  
Consent to copyright transfer required for any other use.

## Ballaghveny Landfill – Cell Height Increase Visual Assessment

### Impact and Mitigation

The further extension of the landfill at Ballaghveny Landfill will increase the height from 114m O. D., as permitted by the waste licence, to a final capped height of 120m O.D. This further extension will form a mound shaped so as to mimic a natural landform and running in a south to north direction from the existing landfill.

The increase in height of 6.0 metres over that currently permitted to a finished level of 120m O.D. will have a slight neutral visual impact in the landscape. Given the scale and swoop of the surrounding agricultural landscape, an increase of this amount will not be discernible to the eye.

The grading and re-vegetating of the resulting landform will constitute a significant improvement, in environmental terms, on the existing situation. ( see Fig. 2 )

Views No's. 1, 2 and 3 looking north west from house No. 1 and house no. 2 indicate the existing and future condition of the landfill site when raised to a final level of 120m O.D.

In the case of all three viewpoints the overall visual impact is significant and neutral, in that the capped landfill will be rehabilitated as a grassland, and will be visually integrated with the surrounding agricultural landscape.

The 6 metre increase in height will not be discernible from these viewpoints – therefore the visual impact of this new extension will be slight and neutral. The landfill is totally screened from views in from Bessborough House.





Existing View:

Project:

BALLAGHVENY LANDFILL

Visual Assessment:

View 1;

Date:

02/9/03





Proposed View

Project:	BALLAGHVENY LANDFILL	Visual Assessment:	View 1;	Date:	19/9/03
----------	----------------------	--------------------	---------	-------	---------





Existing View:

Project:

BALLAGHVENY LANDFILL

Visual Assessment:

View 2;

Date:

02/9/03



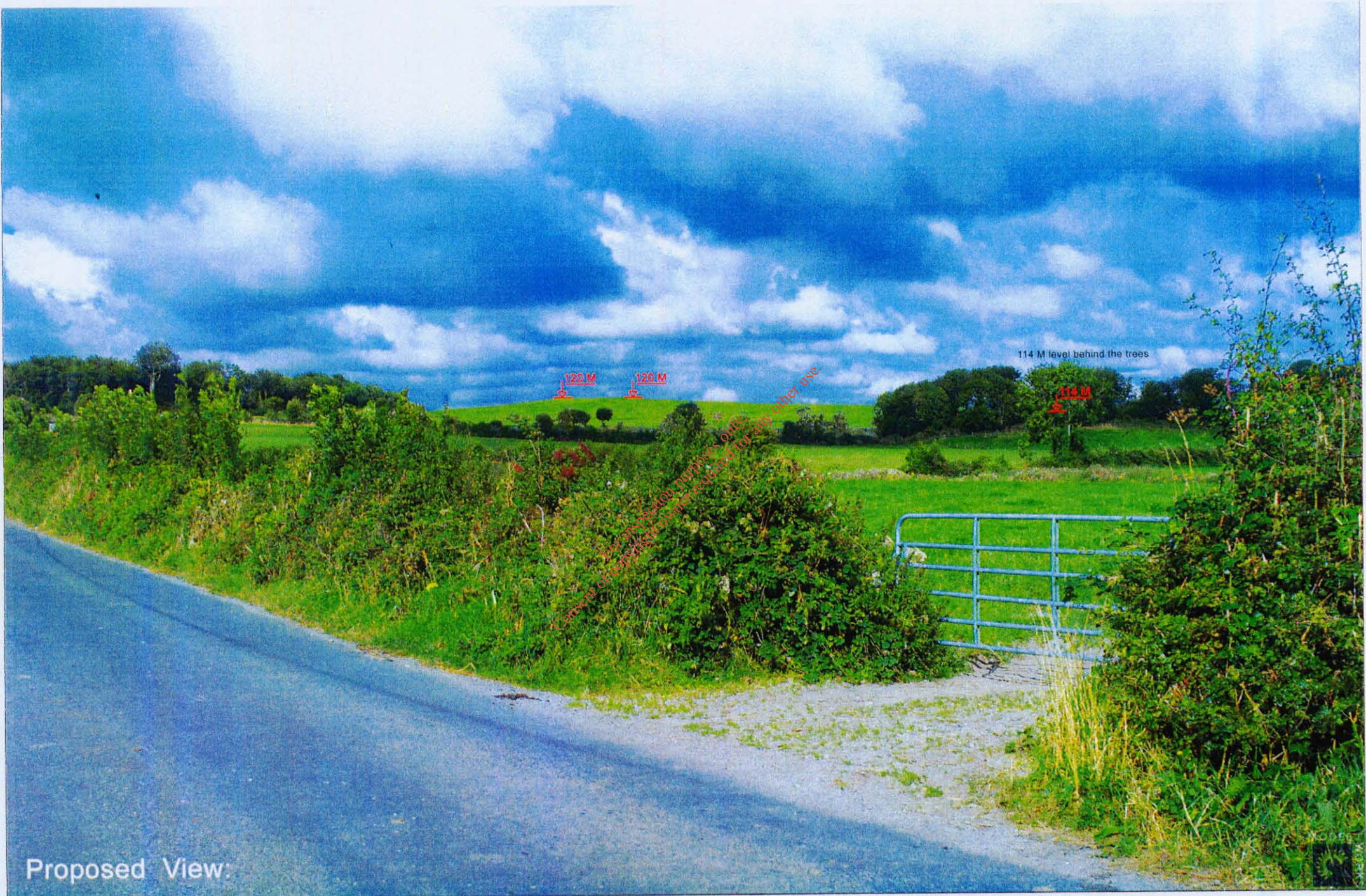

Proposed View:

Project:	BALLAGHVENY LANDFILL	Visual Assessment:	View 2;	Date:	19/9/03
----------	----------------------	--------------------	---------	-------	---------





Existing View:

Project:

BALLAGHVENY LANDFILL

Visual Assessment:

View 3;

Date:

02/9/03





Proposed View

Project:	BALLAGHVENY LANDFILL	Visual Assessment:	View 3;
			Date: 19/9/03



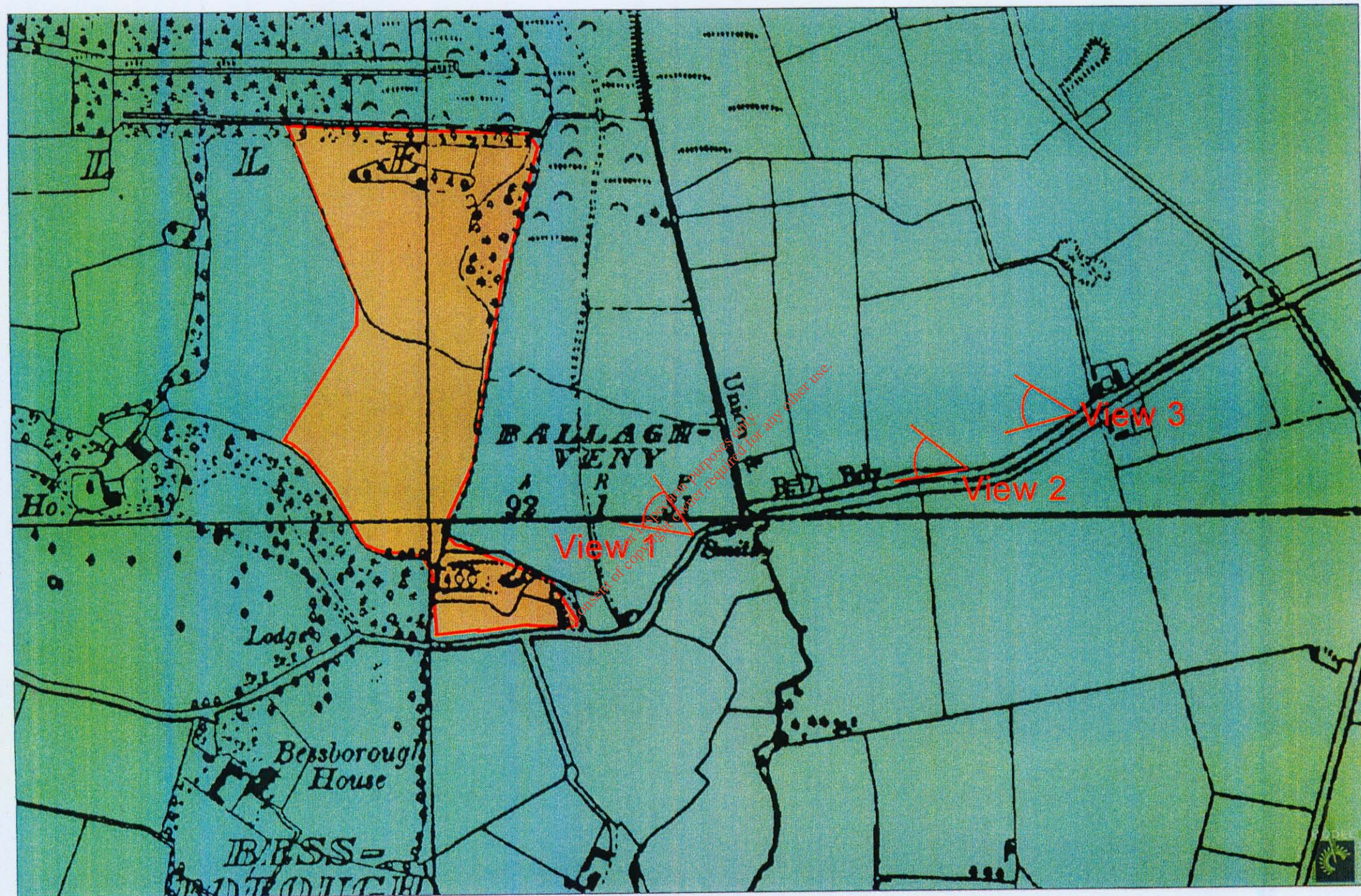

Project:

BALLAGHVENY LANDFILL

Visual Assessment:

Camera Location Map

Date:

02/9/03





View 1 view towards landfill from house 1

For inspection purposes only  
Consent of copyright owner required for any other use



View 2 view towards landfill from house 2





View 3 - view towards landfill from road to the east

For inspection purposes only.  
Consent of copyright owner required for any other use.



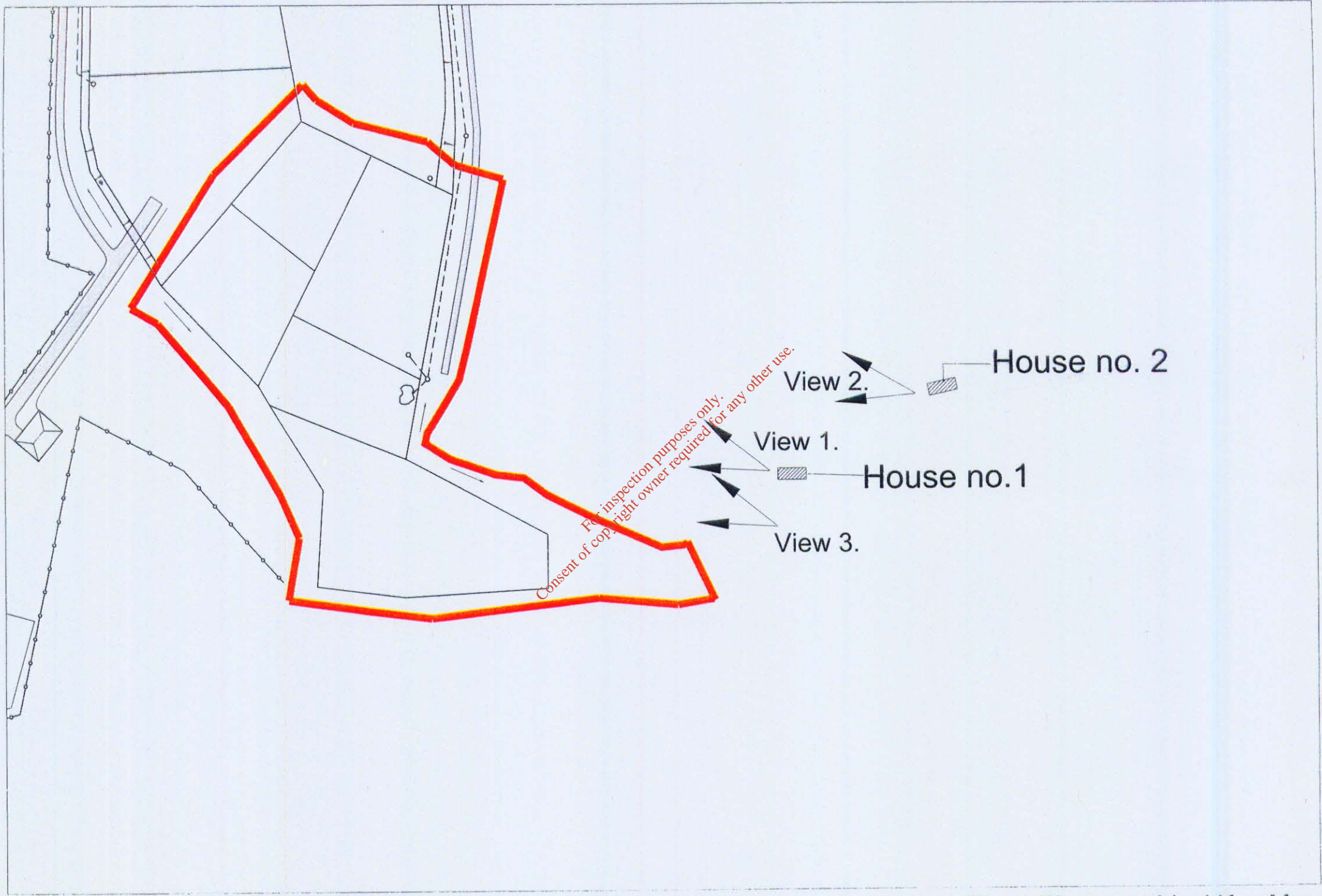

 site shown thus

Fig. 4 Photographical Key Map



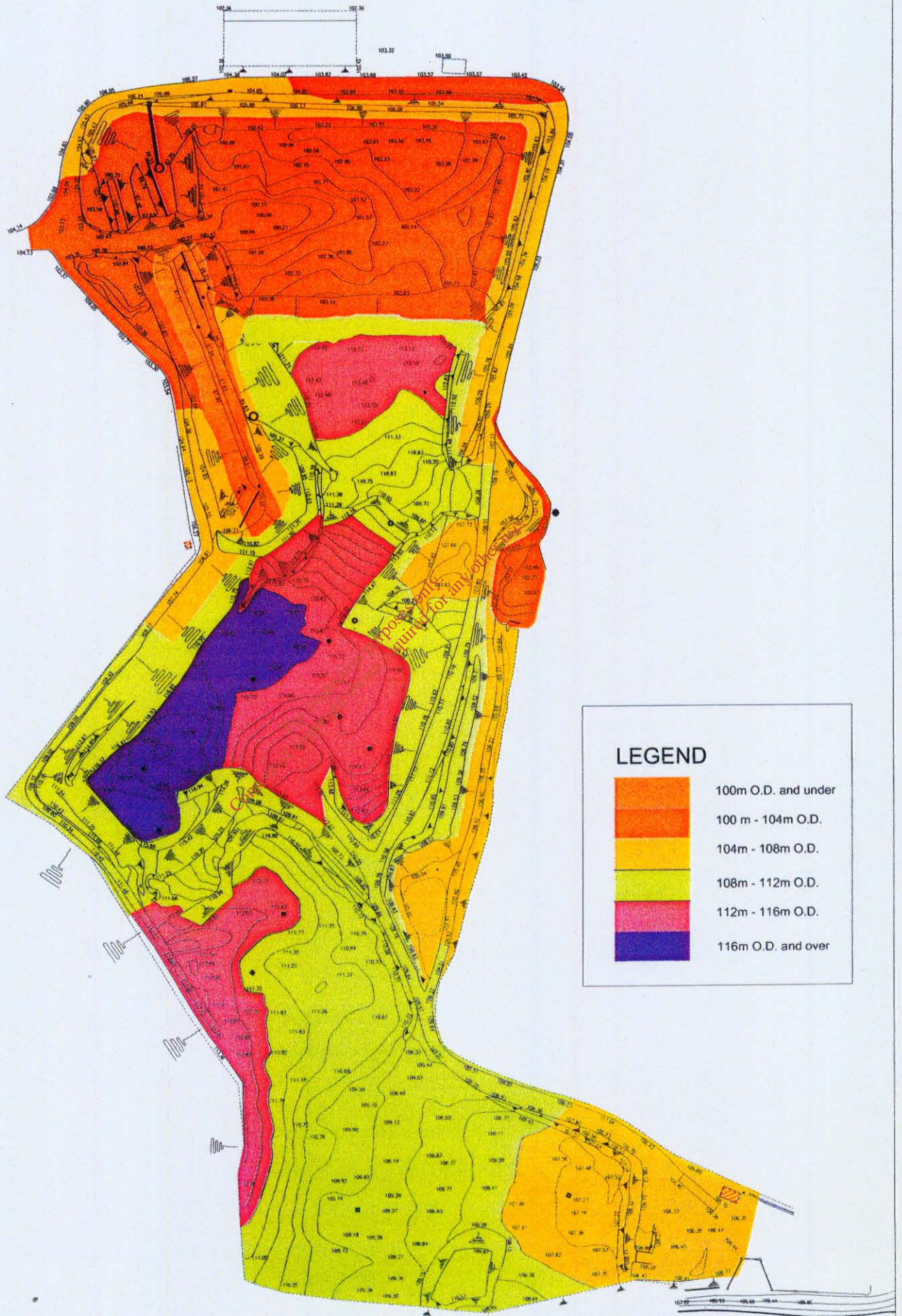



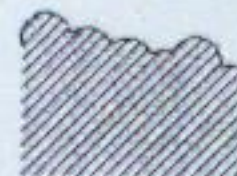

Fig. 1 EXISTING TOPOGRAPHY MAP





Legend:

-  woodland / screen planting
-  scrub woodland planting
-  grass seeding
-  wildflower mix
-  existing woodland planting

SPECIES LIST

**Trees**

**Woodland Screen Planting**

Botanical Name	Common Name
<i>Alnus glutinosa</i>	"Black Alder"
<i>Betula pubescens</i>	"Downy Birch"
<i>Crataegus monogyna</i>	"Common Hawthorn"
<i>Fagus sylvatica</i>	"Common Beech"
<i>Fraxinus excelsior</i>	"Common Ash"
<i>Larix decidua</i>	"European Larch"
<i>Pinus sylvestris</i>	"Scot's Pine"
<i>Prunus avium</i>	"Gean"
<i>Quercus rubra</i>	"Red Oak"
<i>Sorbus aucuparia</i>	"Mountain Ash"

**Woodland Understorey**

Botanical Name	Common Name
<i>Sambucus nigra</i>	"Elder"
<i>Ilex aquifolium</i>	"Common Holly"

**Scrub woodland planting**

Botanical Name	Common Name
<i>Ulex europaeus</i>	Gorse
<i>Sambucus nigra</i>	Elder
<i>Crataegus monogyna</i>	Hawthorn
<i>Corylus avellana</i>	Hazel
<i>Euonymus europaeus</i>	Spindle
<i>Ilex aquifolium</i>	Common Holly

**Wildflower mix**

Botanical Name	Common Name
<i>Hypericum perforatum</i>	St John's wort
<i>Ranunculus bulbosus</i>	Buttercup
<i>Galium verum</i>	Lady's bedstraw
<i>Chrysanthemum segetum</i>	Ox-eye Daisy
<i>Primula veris</i>	Cowslip



Fig. 2 LANDSCAPE LAYOUT



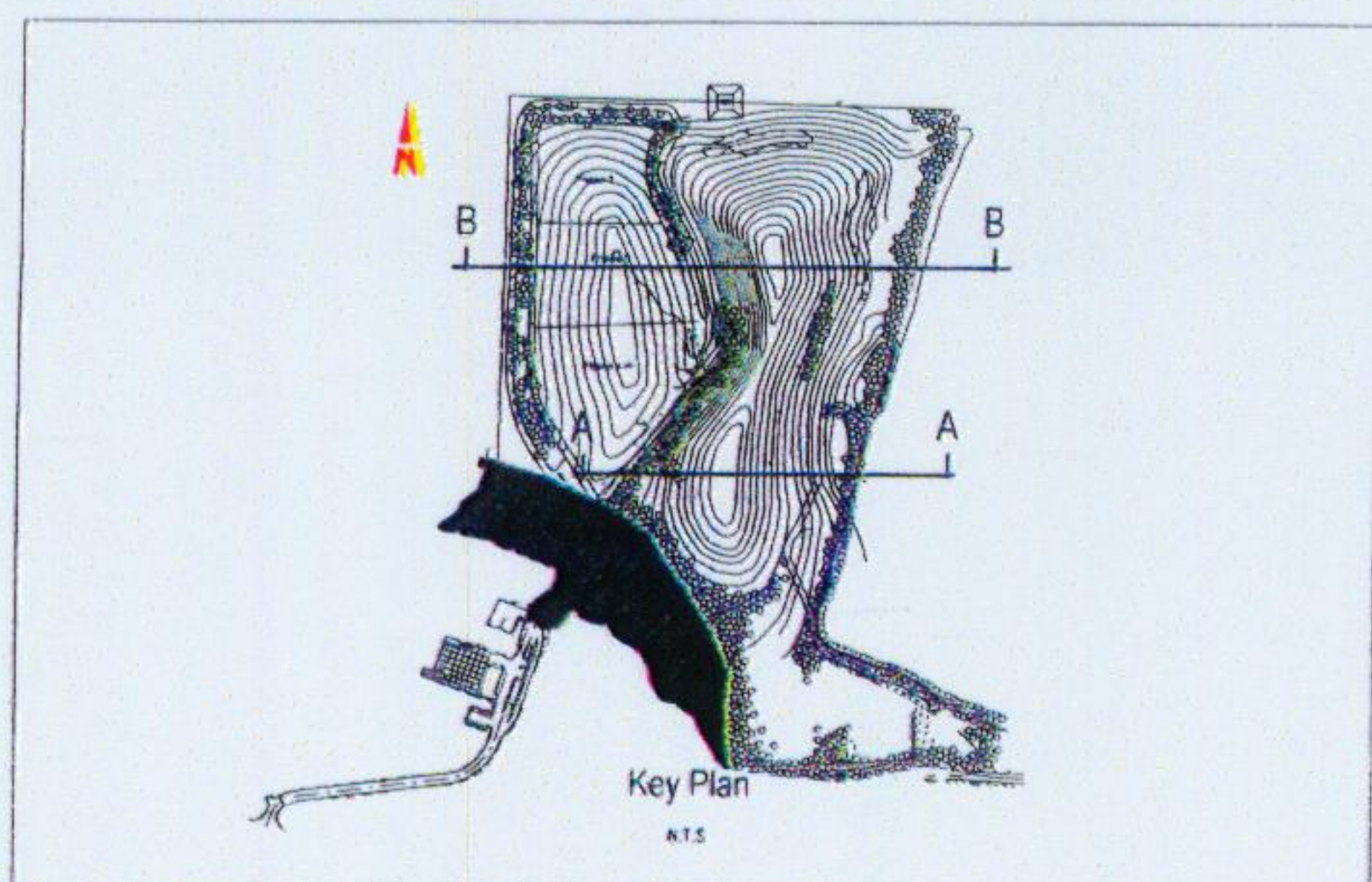
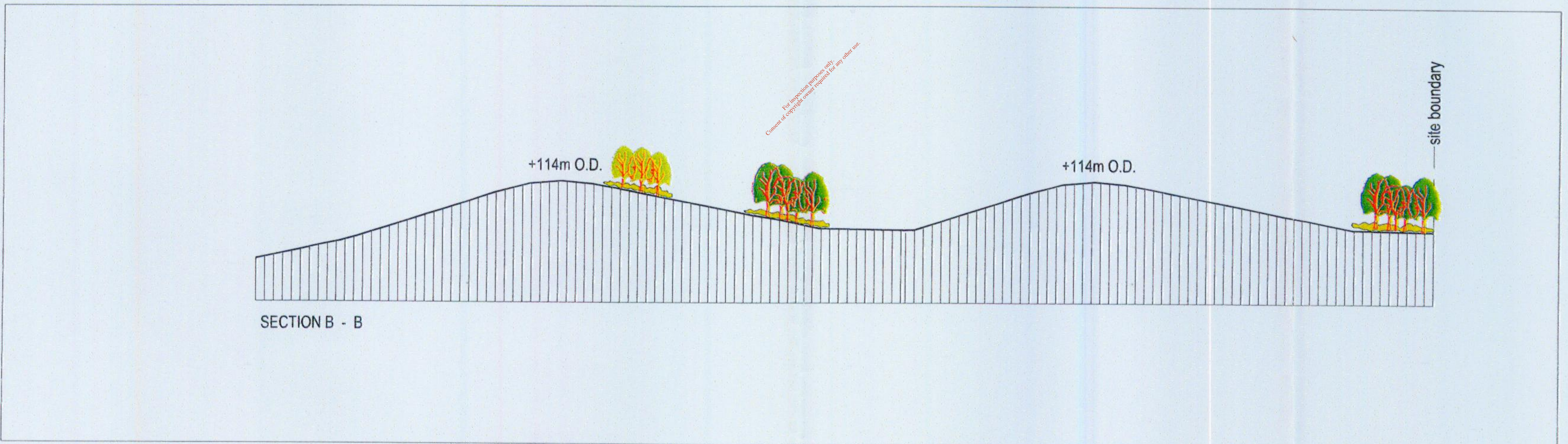
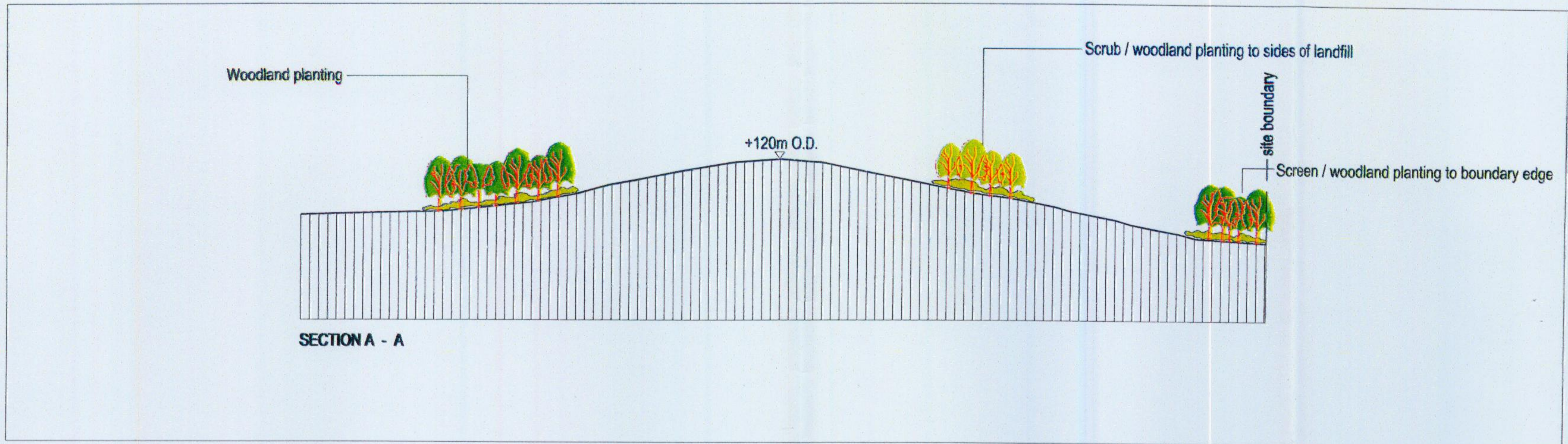

Note:  
levels shown are before compaction

Fig. 3 SITE TRANSECTS