

APPENDIX J

For inspection purposes only.
Consent of copyright owner required for any other use.

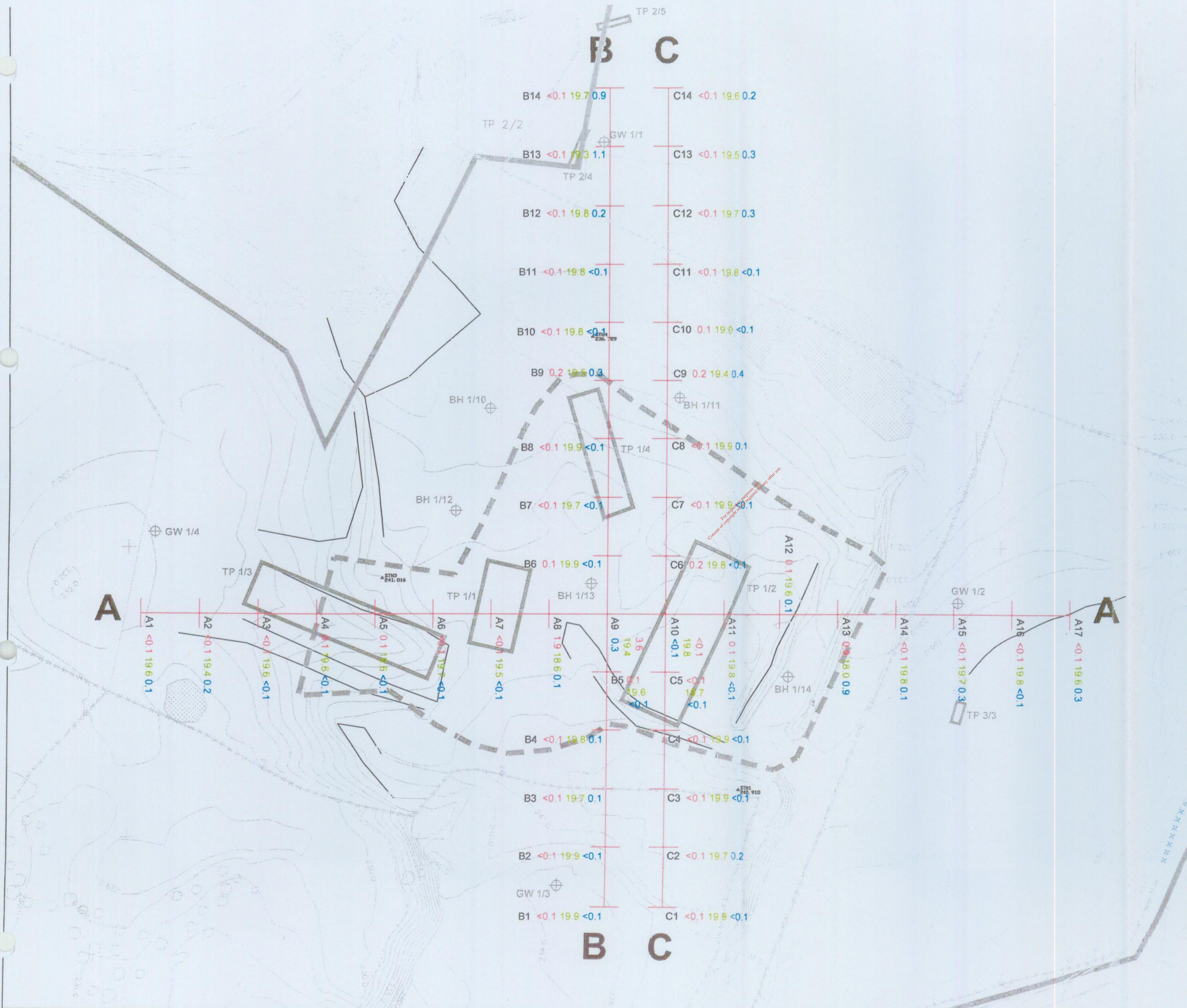

LEGEND

Approximate Locations and Dimensions of WCC Investigative Trial Pits

Approximate Extent of Domestic & Commercial Waste

1. Gas survey carried out on 6th March 2003
2. Spike method used with GA2000 Landfill Gas Analyser
3. 0.0 : methane CH₄ (%)
19.3: oxygen O₂ (%)
0.2 : carbon dioxide CO₂ (%)
4. Atmospheric pressure : 1014.5 mbar
Weather : Dry, breezy and sunny
Temperature : 9c - 10c

No.	DATE	DESCRIPTION	Chk'd	App'd
1	10 / 03 / 03	FINAL DRAFT FOR REVIEW		TP

REVISIONS / STATUS

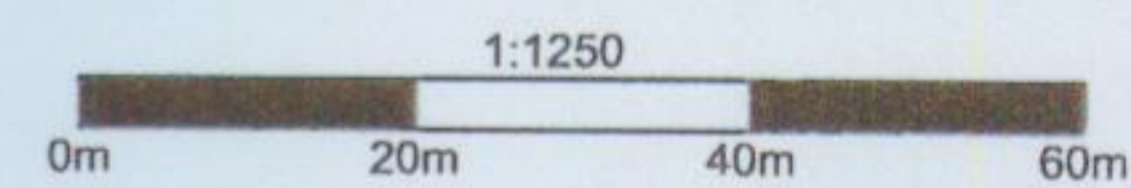

Based on 1:1000 scale digital map provided by Ordnance Survey Ireland

Ordnance Survey Ireland Licence No. SU 0000703 (c) Government of Ireland

JBA John Barnett & Associates
Chartered Minerals Surveyors
Environmental, Planning & Geotechnical Consultants

CSA House:
Unit 7, Dundrum Business Park,
Windy Arbour, Dublin 14, Ireland
Telephone +353 - 1 - 296 4667
Facsimile +353 - 1 - 296 4676
e-mail: jba@jba.ie
website: www.jba.ie

Project:
Roadstone Dublin Ltd.
Investigation of Lands at
Dillonsdown, Co. Wicklow

Title:
SITE 1 - Gas Survey Results

Figure 3

Author: smcd/fv/dl	Ref: 2901/07
Date: Mar 2003	

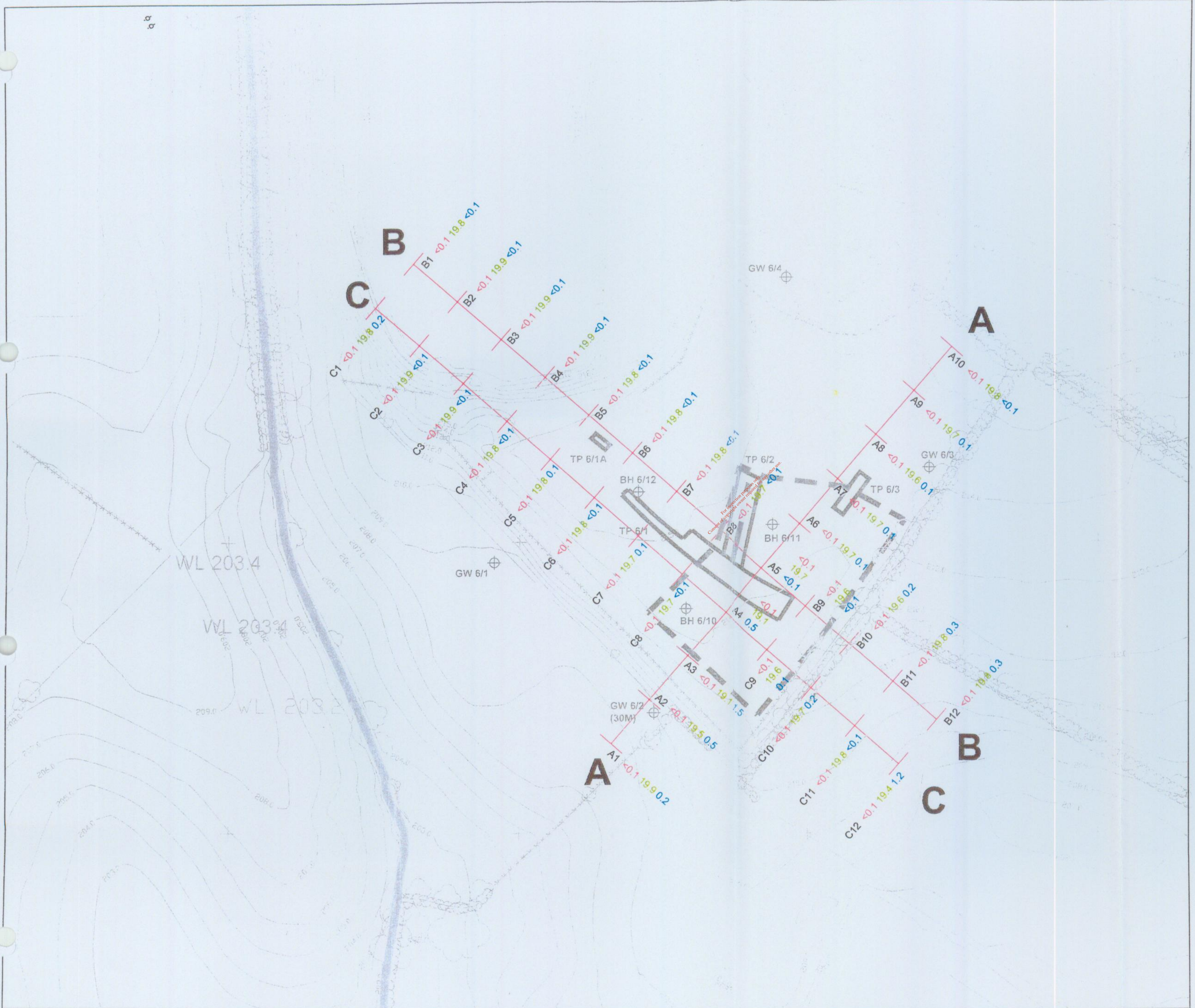

NOTES & LEGEND

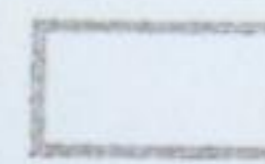
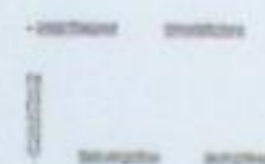
-  Approximate Locations and Dimensions of WCC Investigative Trial Pits
-  Approximate Extent of Domestic & Commercial Waste

1. Gas survey carried out on 6th March 2003
2. Spike method used with GA2000 Landfill Gas Analyser
3. 0.0 : methane CH₄ (%)
19.3 : oxygen O₂ (%)
0.2 : carbon dioxide CO₂ (%)
4. Atmospheric pressure : 1014.5 mbar
Weather : Dry, breezy and sunny
Temperature : 9c - 10c

No.	DATE	DESCRIPTION	Chk'd	App'd
1	10 / 03 / 03	FINAL DRAFT FOR REVIEW		TP

REVISIONS / STATUS

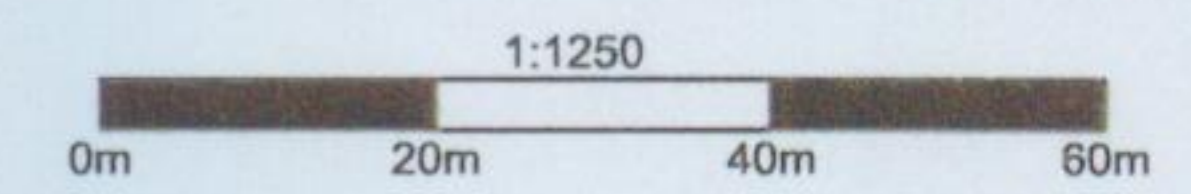

Based on 1:1000 scale digital map provided by Ordnance Survey Ireland

Ordnance Survey Ireland Licence No. SU 0000703 (c) Government of Ireland



JBA

John Barnett & Associates
Chartered Minerals Surveyors
Environmental, Planning &
Geotechnical Consultants

CSA House
Unit 7, Dundrum Business Park
Windy Arbour, Dublin 14, Ireland
Telephone: +353-1-296 4667
Facsimile: +353-1-296 4676
e-mail: jba@csa.ie
website: www.csa.ie

Project:
Roadstone Dublin Ltd.
Investigation of Lands at
Dillonsdown, Co. Wicklow

Title:
SITE 6 - Gas Survey Results

Figure 4

Author: smcd/fv/dl	Ref: 2901/07
Date: Mar 2003	