



AM BUIH/PLEANÁLA	
TIME 16:35 BY Carur	
LIR-DATED 17 MAY 2004	FROM
PL	

Report

Request for Additional Information to Determine the Locations of Third Party Wells in the Vicinity of a Proposed Quarry at Carbury, Co. Kildare

May 2004

PROJECT NUMBER 270401 :

7, South Main Street, Naas, Co. Kildare.
tel : 045 895668 fax : 045 881705 mobile : 087 2300933
email : info@groundwatereng.ie
Registered Office as above. Registered No. 354725. VAT No. 3900664V



For inspection purposes only.
Consent of copyright owner required for any other use.



REPORT ISSUE FORM

Version No.:	CI
Document Title:	Request for Additional Information to Determine the Locations of Third Party Wells in the Vicinity of a Proposed Quarry at Carbury, Co. Kildare
Comments:	Three Copies : Declan Brassil and Co. Ltd. One Copy: OGE Ltd.
List Of Authors :	Client: Good Concrete Ltd.
Orla O'Connell	Client Contact Ref : Declan Brassil
Signature : <i>Orla O'Connell</i>	Approved For Issue : EurGeol Shane O'Neill P.Geo Dip. CECLA
Signature : <i>Chawein</i>	Verified/ Reviewed By : EurGeol Shane O'Neill P.Geo Dip. CECLA
	Issue Date : Friday 14 th May, 2004

Version Codes:

- A Draft
- B Final Draft (may be submitted to client).
- C Final Report

The numbering starts at 1, and each version is raised by 1.

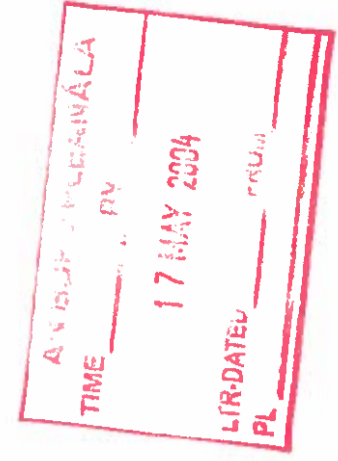

For inspection purposes only.
Consent of copyright owner required for any other use.

7, South Main Street, Naas, Co. Kildare
 T:045-895668 F:045-881705 M:087-2300933
 Email: info@groundwatereng.ie
 Directors: S O'Neill (Managing) O O'Neill
 Registered Office as above. Registered No. 354725. VAT No. 3900664V



**RE: REQUEST FOR ADDITIONAL INFORMATION TO DETERMINE THE LOCATIONS OF
THIRD PARTY WELLS IN THE VICINITY OF A PROPOSED QUARRY SITE AT CARBURY,
CO. KILDARE (ABP PL 09.205039).**

1.0 Introduction

1.1 O'Neill Ground Water Engineering (OGE) were contacted by Declan Brassil & Co. Ltd. to address a request by An Boin Pleanala to locate all third party wells in the vicinity of a proposed quarry outside Carbury in Co. Kildare.

2.0 Scope of Work

2.1 A well survey was carried out on 14th May 2004. All household and businesses within an approximate 500m radius of the proposed quarry were visited in order to determine the exact location of their private well supply and any other pertinent information regarding the well.

2.2 Given that the mains water supply is not yet available in the area, it was assumed that all residents have their own private well. Limited access and information was available.

3.0 Well Survey

3.1 The locations of all private wells within approximately 500m of the proposed quarry site are displayed on Figure No. 1. The details of the well survey are presented in Table No. 1.

*For inspection purposes only.
Consent of copyright owner required for any other use.*

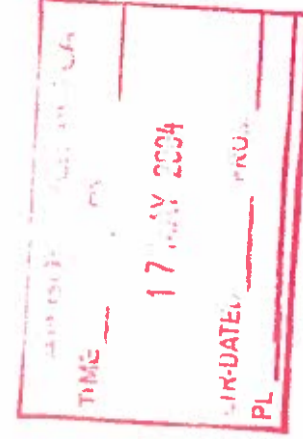

7, South Main Street, Naas, Co. Kildare
T:045-895668 F:045-881705 M:087-2300983
Email: info@groundwatereng.ie
Directors: S O'Neill (Managing) O O'Neill
Registered Office as above. Registered No. 354725. VAT No. 3900664V

Table No. 1: Details of Well Survey

Well Number	Name of Owner	Well Location	Additional Information
1	Peter & Mary Farrell Ted Quinn	E269103 N239356	Supplies two households; Lime in water; Well covered over.
2	Paddy Swan	E269080 N239375	Lime in water; No access to pump house, Approximately 20m deep.
3	Kildare Co. Council	E269083 N239412	Hand Pump; Still operational
4	Louis Robinson	E268735 N239642	Supplies Kilglass House and Lodge, No access to pump house
5	Michael Beregan	E270100 N238829	Supplies private residence and Abattoir, sealed cover to well. Well covered over.
6	Mr. and Mrs. Myles	E269712 N239197	Lime in water; No access to well; Approximately 6m deep.
7	John Berregan Joseph Gorman	E269630 N239225	Supplies two households; Limited access to pump house.
8	Maguire	E269631 N239364	
9	Natasha & Declan O' Reilly	E269641 N239428	Supplies two houses; Covered over.
10	Maguire	E269609 N239458	
11	Padraic Graven	Only approx. location known	Supplies farm house.
12	John and Linda O' Connor	E269993 N239674	Well covered over.
13	Rob Sheehan	E269631 N239744	Well covered over.
14	Seamus and Cathleen O' Connor	E269535 N240112	Supplies farm house and farm; No access to well
15	Alan Cox	E269270 N238996	Supplies farm; Uncooperative with regard to survey.
16	Tommy Knowles	E269545 N238510	Supplies two households. No access to pump house.
17	Charlie Tyrell	E269448 N238247	Large Diameter Well; Covered over.
18	Theresa Brogan	E268727 N238464	Well covered over
19	-	E268789 N238452	Large Diameter
20	Owen Conroy	E269622 N239809	Well covered over
21	Tom O' Connor	E269654 N239765	Well covered over
22	David and Margaret Miller	Only approx. location known	Approx. 23m deep; supplies house and paddock

For inspection purposes only.
Consent of copyright owner required for any other use.

ANGUS CLEANALLS
TIME BY
17 MAY 2004
LTR-DATED FROM
PL

EIS Ballinderry Townland, Carbury, Co. Kildare.

Recent planning history for new dwellings along the road to the east and south of the subject site:

- 273/99:** Permission granted on the 05/01/2000 for a dormer bungalow and biodisc effluent treatment system (Mooney).
- 570/99:** Permission granted on the 20/10/99 for a bungalow, a garage and puraflo treatment system (Jones).
- 255/00:** Permission granted on the 13/09/2000 for a dormer bungalow and septic tank (McCabe).
- 1517/01:** Permission sought for a bungalow and septic tank. Further Information requested on the 24/01/2002 (Moore).
- 151/04:** Permission granted on the 06/04/2004 for a single storey dwelling and septic tank (Farrell).

For inspection purposes only.
Consent of copyright owner required for any other use.

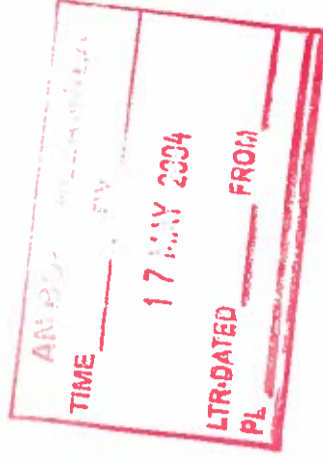

Declan Brassill & Company Ltd

Chartered Planning Consultants

Malt House Sq, Smithfield Village,
Bow Street, Dublin 7

Tel: 01 8746153 Fax: 018746163

Title: Location of dwellings

Scale: Not to scale

Client: Goode Concrete

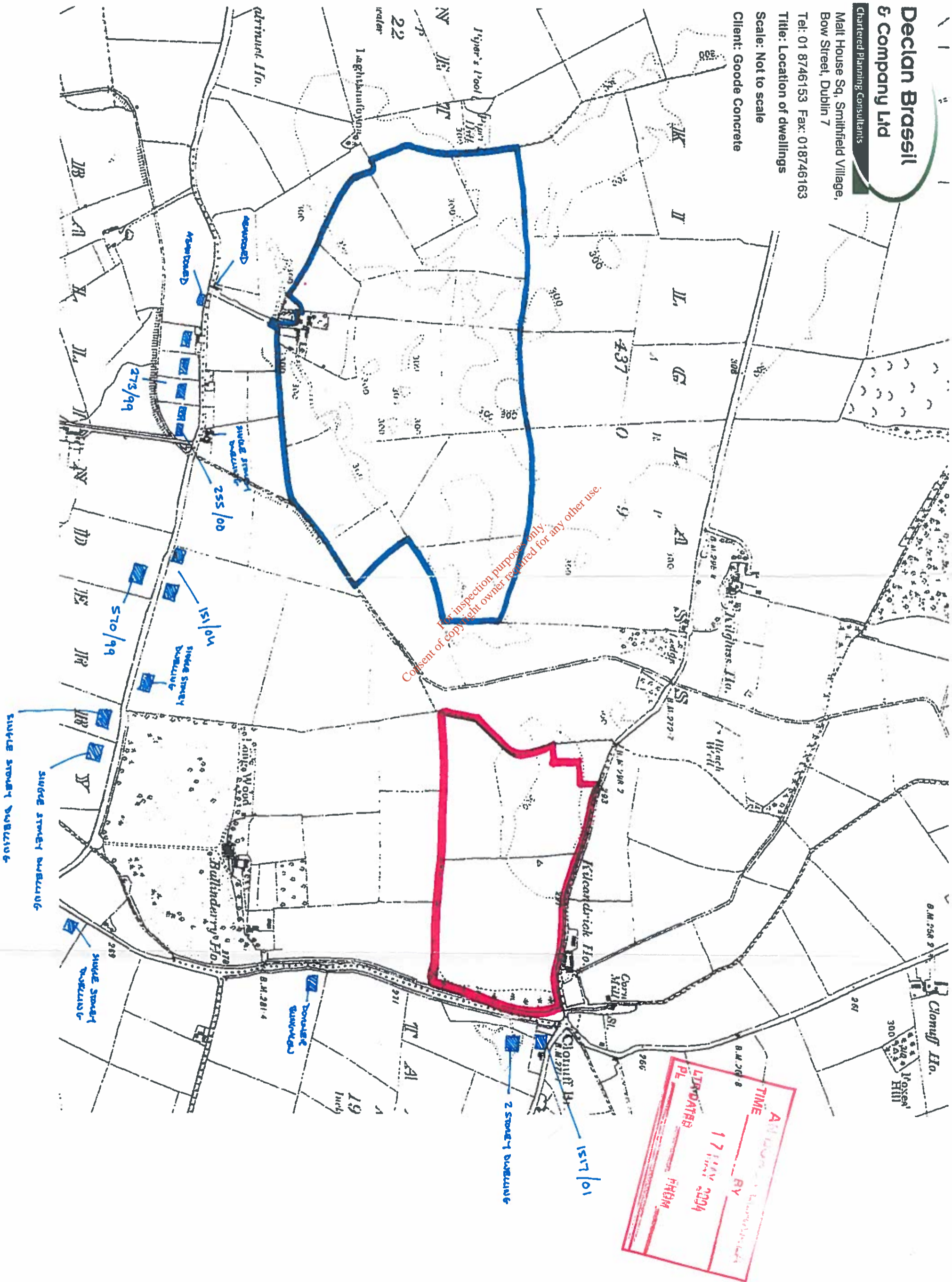

ALL INFORMATION CONTAINED
HEREIN IS UNCLASSIFIED
DATE 17 MAY 2004 BY FHEM

Rural PLACE Map

Surveyed 0
 Revised 1990
 Levelled 0



DESCRIPTION



Declan Brassill & Co. Ltd.
 Chartered Planning Consultants
 4 Cloncourt, Main St., Clonoe, Co Me;
 Tel 01 8013944 Fax 01 801 3945

Figure 2.2: Site Context Map
 Ordnance Survey Nos. KE003-10

Scale: 1:2500
 Client: Goode Concrete Ltd.



Sulbhreacht Ordnáis Éireann, Páirc an Fhionnaisce, Baile Átha Cliath a thionsaí a d'fhóilligh.
 Completed, printed and published by Ordnance Survey Ireland, Phoenix Park, Dublin.

Ní thabann bódair bealach nó cósán, a bhfaigh ar leasraíl seo agus fainise ar chuid sll.
 The representation on this map of a road, track or footpath is not evidence of the existence of a right of way.

Dianchoic ar mhacasamhl an iomláin ná aon chuid de gan chuid roimh ré ó Sulbhóir Shulbhreacht Ordnáis Éireann.
 Reproduction in whole or in part is prohibited without the prior permission of the Director of Ordnance Survey, Ireland.

ORDNÁIS ÉIREANNÁLA
 © Réilias na hÉireann, 2001
 © Government of Ireland, 2001

2 DEC 2003
 LTR-DATED FROM
 PL 08-2005-039

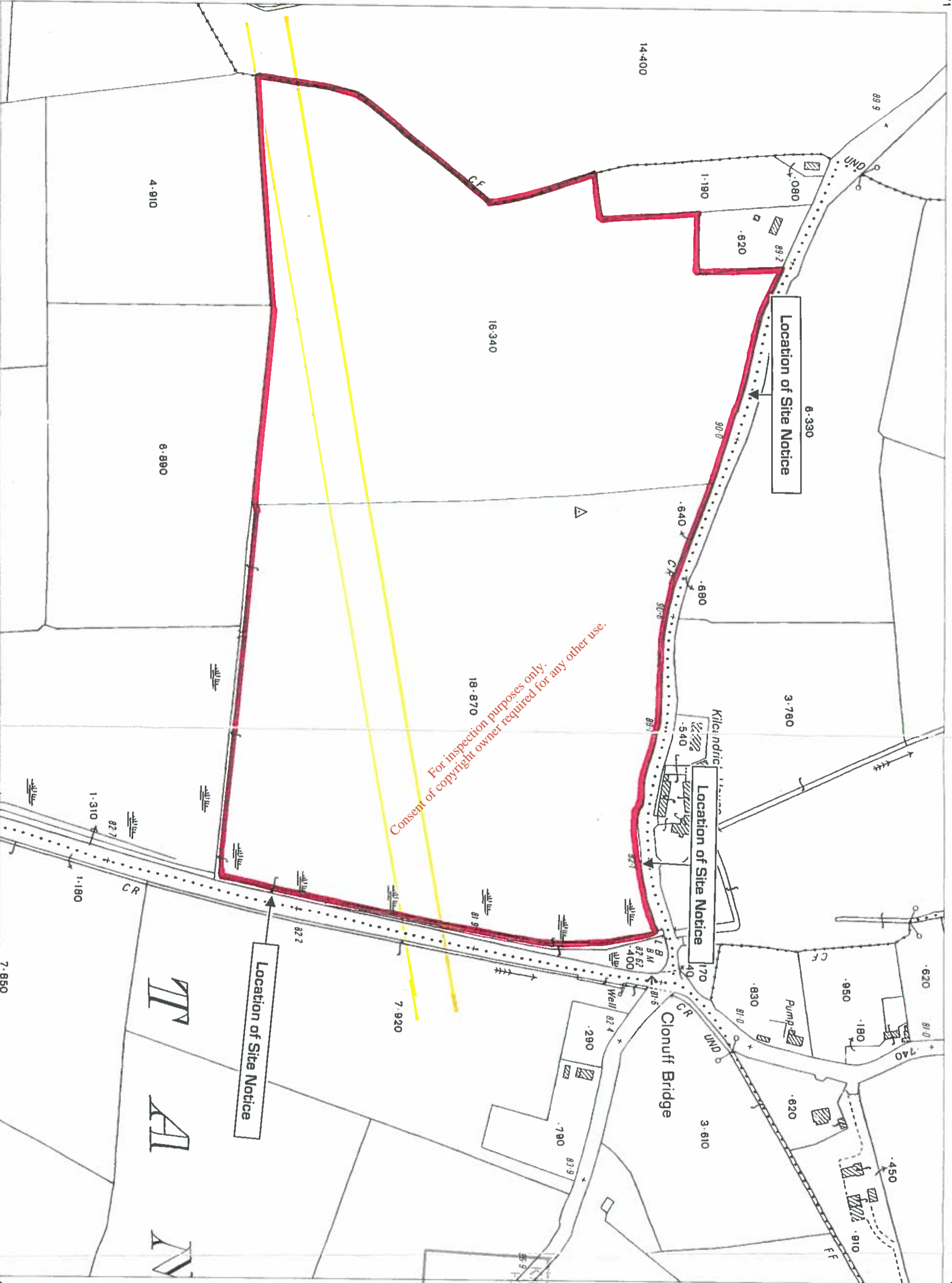

For inspection purposes only.
 Consent of copyright owner required for any other use.

239471 268972

Scale: 1:2500
 Scale: 1:2500

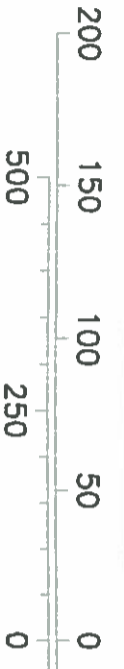

Plot Ref. No. 177170_1
 Plot Date 08-AUG-2001

239471

268972



Existing view from access track northeast of Ballinderry House. Photographed with a 50mm lens.



Photomontage view on completion.



Computer model of Extracted Quarry from the same viewpoint (with no screening features shown).

This drawing is for information only.
 It is not to be used for any other purpose.
 Copyright © 2004 David Jarvis Associates Ltd.

DRAWN BY: M.A.L.A.
 17 MAY 2004
 LTR: DAT3D FROM

DAVID JARVIS ASSOCIATES
 PLANNING DEVELOPMENT LANDSCAPE ENVIRONMENT
 David Jarvis Associates Ltd.
 1 Terryson Street
 SWINDON Wiltshire SN1 5DT
 United Kingdom
 Tel: 0044 1793 612173 Fax: 0044 1793 613625
 Email: mail@davidjarvis.biz

Client
GOODE CONCRETE LTD
 Project
**BALLINDERRY, CARBURY
 Co. KILDARE**

Drawing Title
**PHOTOMONTAGE VIEWS FROM
 BALLINDERRY HOUSE:
 VIEWPOINT C**
 Scale **N.T.S** Date **MAY 2004**
 Drawing No. **1424/011**

AN BORD PLEANÁLA
 TIME BY
 17 MAY 2004
 LTR-DATED FROM
 PL 09.20000339



PHASE 1 WORKS TO FORM NEW ROAD, SITE ACCESS & FIRST EXCAVATED VOID

For inspection purposes only.
 Copyright of copyright holder required for any other use.



- KEY**
- APPEAL SITE BOUNDARY
 - ② PHASE NUMBERS
 - PHASE BOUNDARIES
 - CUT SLOPE
 - FILL SLOPE
 - WATER (LEVELS APPROXIMATE)
 - GRASSSED SURFACE
 - EXPOSED MINERAL
 - ② EXISTING 10.5m INTERVALS

DAVID JARVIS ASSOCIATES
 PLANNING DEVELOPMENT LANDSCAPE ENVIRONMENT
 David Jarvis Associates Ltd.
 1 Fenwick Street
 SWINDON Wiltshire SN1 5DT, UK
 Tel: 0044 1793 613173 Fax: 0044 1793 613825
 Email: mail@davidjarvis.biz

Client
 GOODE CONCRETE LTD
 Project
 BALLINDERRY, CARBURY
 CO. KILDARE

Drawing Title
 PLAN SHOWING
 PHASE 1/2 WORKING
 Scale 1:2000 @ A3 Date MAY 2004
 Drawing No 1424 / 005



PERMANENT SLOPES ABOVE & BELOW W.L. AT 1:3 GRADIENT

TEMPORARY SLOPES WITHIN EXCAVATION AREA AT 1:2 GRADIENT

AN BORD PLEANAINA
 TIME BY
 17 MAY 2004
 LTR-DATED FROM
 PL 09 205039

PROCESSING PLANT ERECTED DURING PHASE 2
 EXCAVATION BELOW INITIAL DRY PLATFORM BY DRAGLINE

For inspection purposes only
 Consent of copyright holder required for any other use

PHASE 1 WORKS TO FORM NEW ROAD, SITE ACCESS & FIRST EXCAVATED VOID

COUNTY ROAD DIVERTED AT START OF PHASE 1

CULVERT BRIDGE

SITE ENTRANCE

SITE OFFICE

WEIGHBRIDGE
 WHEEL WASH



KEY
 — APPEAL SITE BOUNDARY
 ② PHASE NUMBERS
 - - - PHASE BOUNDARIES
 I I CUT SLOPE
 I I FILL SLOPE
 [Blue Area] WATER (LEVELS APPROXIMATE)
 [Green Area] GRASSED SURFACE
 [Orange Area] EXPOSED MINERAL

① EXISTING CONTOURS (0.5m INTERVAL)



DAVID JARVIS ASSOCIATES
 PLANNING DEVELOPMENT LANDSCAPE ENVIRONMENT
 David Jarvis Associates Ltd.
 1 Thompson Street
 SWINDON Wiltshire SN1 5DT, UK
 Tel: 0044 1793 613173 Fax: 0044 1793 613625
 Email: mail@davidjarvis.biz

Client
 GOODE CONCRETE LTD
 Project
 BALLINDERRY, CARBURY CO. KILDARE

Drawing Title
 PLAN SHOWING PHASE 3 WORKING
 Scale 1:2000 @ A3 Date MAY 2004
 Drawing No 1424 / 006

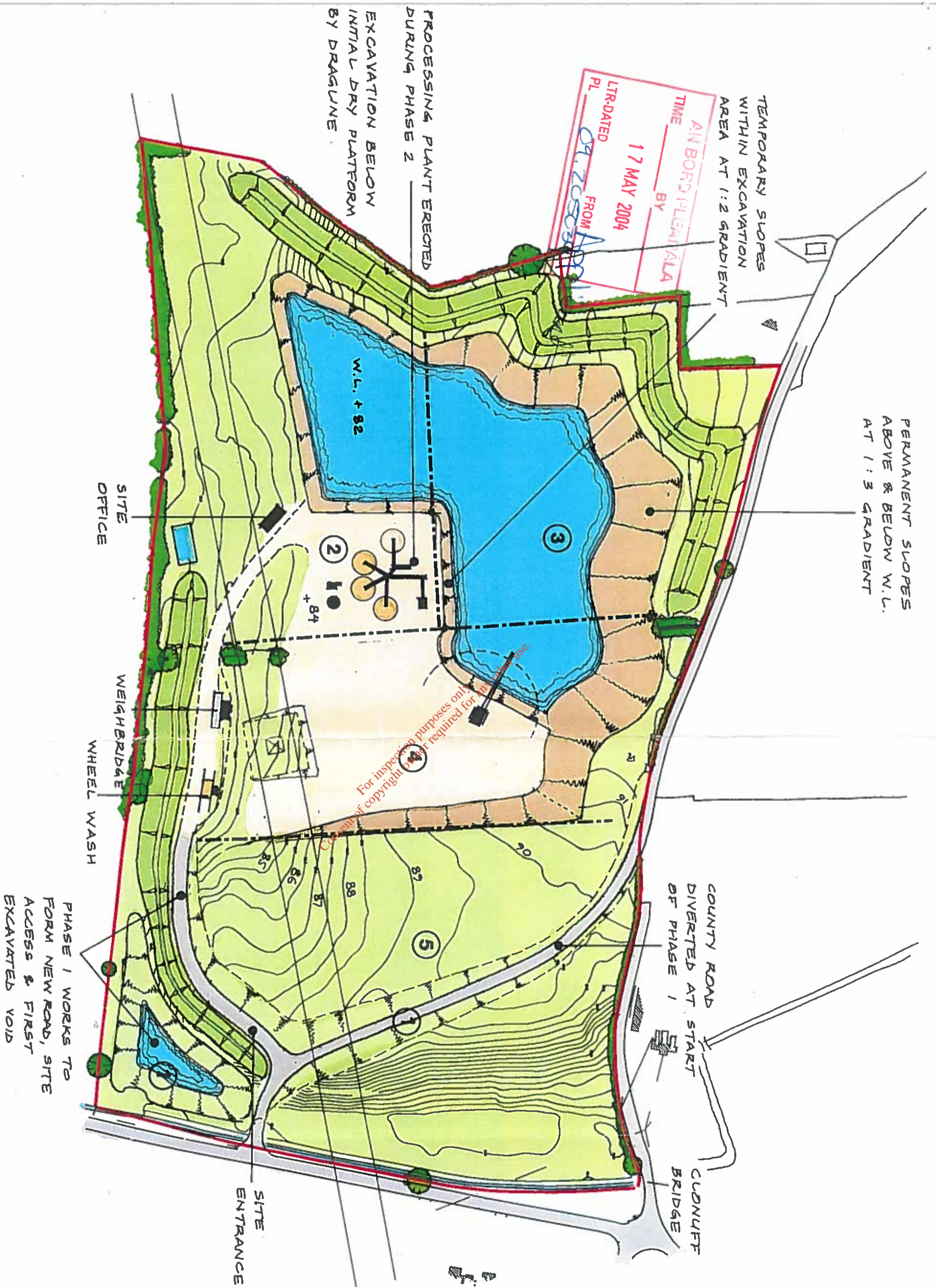

KEY

- APPEAL SITE BOUNDARY
- ② PHASE NUMBERS
- PHASE BOUNDARIES
- ▬ CUT SLOPE
- ▬ FILL SLOPE
- ▬ WATER (LEVELS APPROXIMATE)
- ▬ GRASSSED SURFACE
- ▬ EXPOSED MINERAL
- ▬ EXISTING CONTOURS (0.5m INTERVAL)



DAVID JARVIS ASSOCIATES
 PLANNING DEVELOPMENT LANDSCAPE ENVIRONMENT

David Jarvis Associates Ltd.
 1 Terryson Street
 SWINDON Wiltshire SN1 5DT, UK
 Tel: 0044 1793 812173 Fax: 0044 1793 813025
 Email: mail@davidjarvis.biz

Client:
GOODE CONCRETE LTD

Project:
BALLINDERRY, CARBURY CO. KILDARE

Drawing Title:
PLAN SHOWING PHASE 4 WORKING

Scale:
 1:2000 @ A3

Date:
 MAY 2004

Drawing No:
 1424 / 007



APP. TIME
17 MAY 2004
LTR-DATED
PL. FROM
APPLICANT



PERMANENT SLOPES
ABOVE & BELOW W.L.
AT 1:3 GRADIENT

VOID WATER LEVEL
FALLS IN LATER
PHASES AS GROUND
WATER LEVELS DROP

EXCAVATION BELOW
INITIAL DRY PLATFORM
BY DRAGLINE

COUNTY ROAD
DIVERTED AT START
OF PHASE 1

CULVERT
BRIDGE

PHASE 1 WORKS TO
FORM NEW ROAD, SITE
ACCESS & FIRST
EXCAVATED VOID

<p>DAVID JARVIS ASSOCIATES PLANNING DEVELOPMENT LANDSCAPE ENVIRONMENT</p> <p>David Jarvis Associates Ltd. 1 Tennyson Street SWINDON Wiltshire SN1 5DT, UK Tel: 0044 1793 612173 Fax: 0044 1793 613625 Email: mail@davidjarvis.biz</p>	<p>Client GOODE CONCRETE LTD</p> <p>Project BALLINDERRY, CARBURY CO. KILDARE</p>	<p>Scale 1:2000 @ A3</p> <p>Date MAY 2004</p> <p>Drawing No. 1424 / 008</p>	<p>KEY</p> <ul style="list-style-type: none"> — APPEAL SITE BOUNDARY ② PHASE NUMBERS --- PHASE BOUNDARIES ∩ CUT SLOPE ∪ FILL SLOPE ■ WATER (LEVELS APPROXIMATE) ■ GRASSES SURFACE ■ EXPOSED MINERAL ~ EXISTING CONTOURS (0.5m INTERVAL)