

21/10/03

Mr Kevin Kelly
Senior Executive Officer
Planning Department
Kildare County Council
St. Mary's
Naas
Co. Kildare

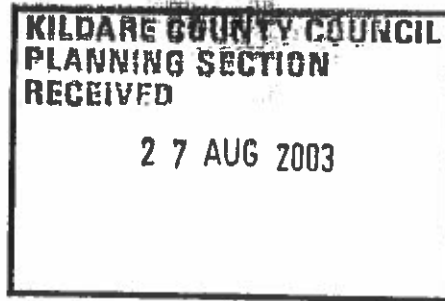

J.R. Kelly
A.

25 August 2003

Re: Response to Further Information requested by Kildare County Council in relation to planning application for the extraction of sand and gravel over an area of 7.8 hectares, associated washing and screening plant, new access and access road, shipping office, site office, weighbridge, wheelwash, surface water settlement lagoon, staff facilities etc. at Ballinderry, Carbury, Co. Kildare.

Kildare County Council Register Reference: 02/1475

Dear Mr Kelly

This submission is made on behalf of Goode Concrete Ltd, 7th Lock, Killeen Road, Ballyfermot, Dublin 10 in response to a Request for Clarification of Additional Information issued by Kildare County Council on 30 June 2003.

Item No. 1.

The applicant undertakes to construct the entire road generally as shown on Drawing No. 33791-DR-100 as submitted, in accordance with the requirements of the Planning Authority. It is proposed that the construction of the roads will be undertaken concurrently with the commencement of development on site, and that the exportation of extracted sand and gravel will not commence until the road has been completed.

Having regard to the significant cost associated with the construction of the road, and the quantity of recoverable resource sterilised by the re-alignment, it is envisaged that the cost of the road will be off-set against contributions and contributions on potential future applications with the administrative area of Kildare County Council.

~~Declan Brassil~~
1 Mahomed Husein
Declan ARDU



ACS

ARCHAEOLOGICAL
CONSULTANCY
SERVICES LIMITED
*Development Consultant
& Cultural Resource
Management*

Our Ref. 02_05

The Planning Officer,
The Heritage Council,
Rothe House,
Kilkenny,
Co. Kilkenny.

KILDARE COUNTY COUNCIL
PLANNING SECTION
RECEIVED
27 AUG 2003

21st August 2003.

Re: Ballinderry Quarry, Carbury, Co. Kildare. (Planning Ref 02/1475)

Dear Sir,

With regard to item 2 of a further information request made by Kildare County Council for the above development issued 30.06.03. I have been in contact with Mr. Declan Brassil who has forwarded the attached drawing (Figure 3). The new road layout and quarry entrance as shown have been requested by Kildare County Council.

Consequently this has pushed the proposed quarry development further to the southwest than originally planned. The area to the northeast of the new road layout, immediately adjacent to the former millpond, will not be disturbed as no extraction can take place or is proposed to take place within this area. No earthen bunds or other similar landscaping are proposed.

If you have any queries or require further clarification, please do not hesitate to contact me.

Yours sincerely,

Ian R. Russell
Ian R. Russell.

HEAD OFFICE
Unit 21
Boyne Business Park
Greenhills, Drogheda
Co. Louth
Tel: 041 9835422
Tel: 041 9835513
Fax: 041 9842131
enquiries@acsltd.ie
www.acsltd.ie

NEWRY OFFICE
61, Dominick Street
Newry, Co. Down
BT35 8BW
Tel: 028 30256008
Fax: 028 30256009

DUBLIN OFFICE
Mespil House
Sussex Road
Dublin 14
Tel: 01 6672914

DIRECTORS
Donald Murphy
S.A., M.I.A.P.A.
Deirdre Murphy

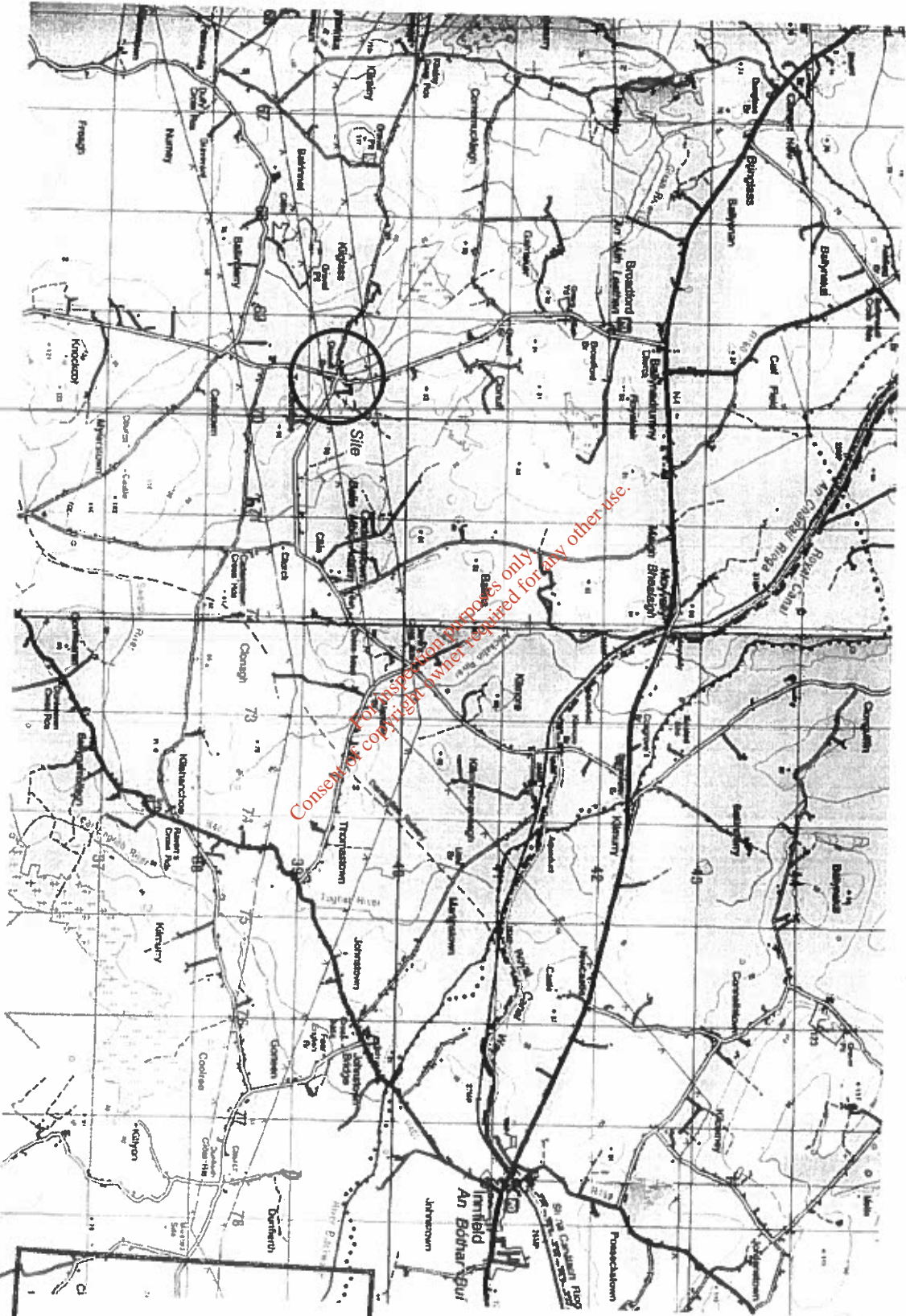

PLANNING SECTION
RECEIVED
27 AUG 2003

Archaeological Consultancy Services Ltd.

Unit 21, Boyne Business Park,
Greenhills, Drogheda, Co. Louth

Site: Ballindery Quarry,
Carbury, Co. Kildare

Issued for: Request for further information
Client: Declan Brassill & Co. Ltd.

Scale: 1: 60,000 A4
Date: 15 August 03
Origin: Discovery Series No. 49
Drawing no.: 02 05 C04

Figure 1: Location of site

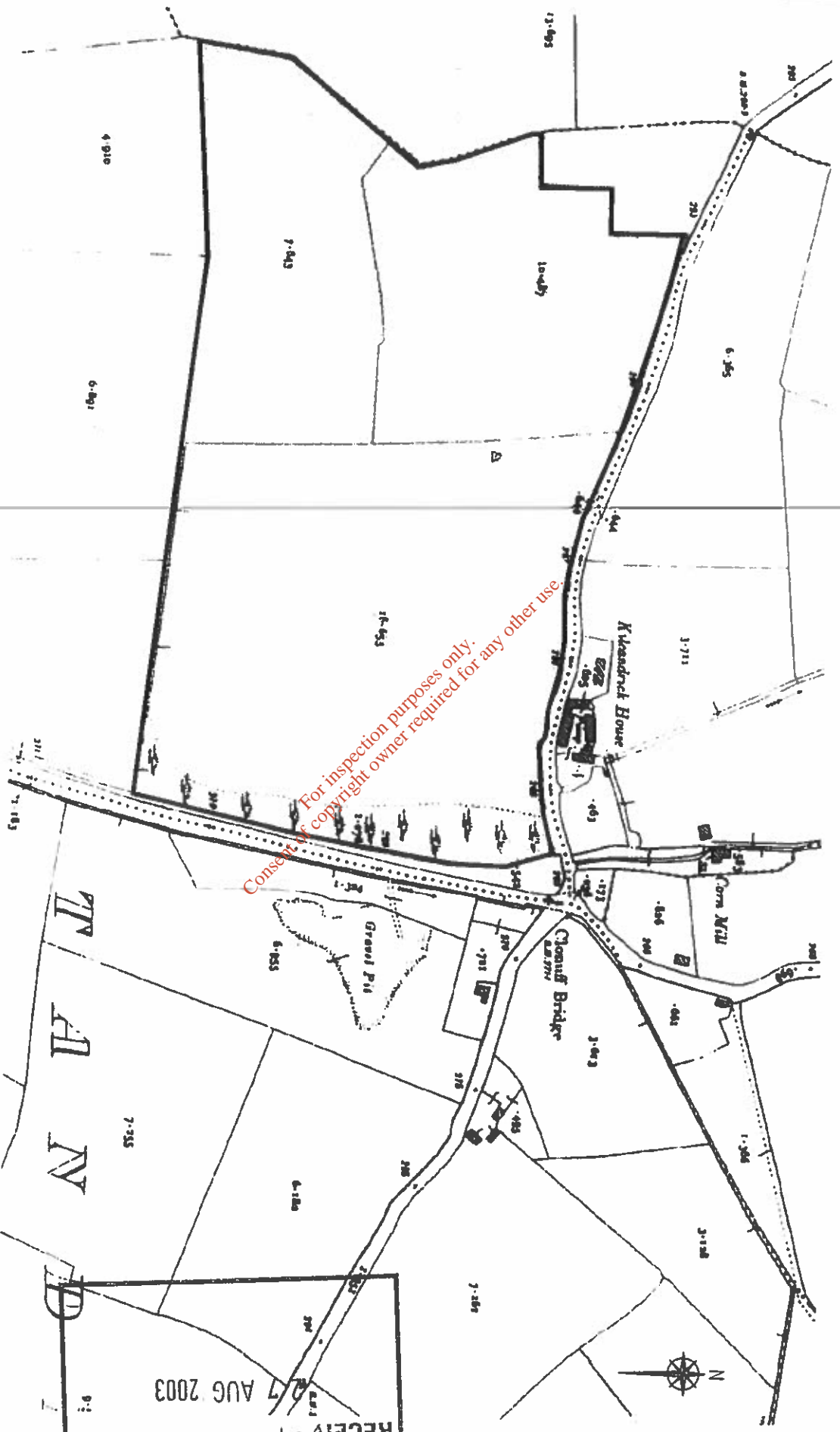

Consent is required for any other use.
 For inspection purposes only.

KILDARE COUNTY COUNCIL
 PLANNING SECTION
 RECEIVED
 27 AUG 2003

Archaeological Consultancy Services Ltd.
 Unit 21, Boyne Business Park,
 Greenhills, Drogheda, Co. Louth
 Client: Declan Brassil & Co. Ltd.
 Site: Ballinderry Quarry,
 Carbury, Co. Kildare
 Issued for: Request for further information
 Scale: 1: 4,000 A4
 Date: 15 August '03
 Origin: Kildare sheet 3-10 (1909-10)
 Drawing no.: 02 05 C11

Figure 2: OS 25" to 1 mile map, Kildare sheet 3-10 (1909-10) showing detail of site

50 metres

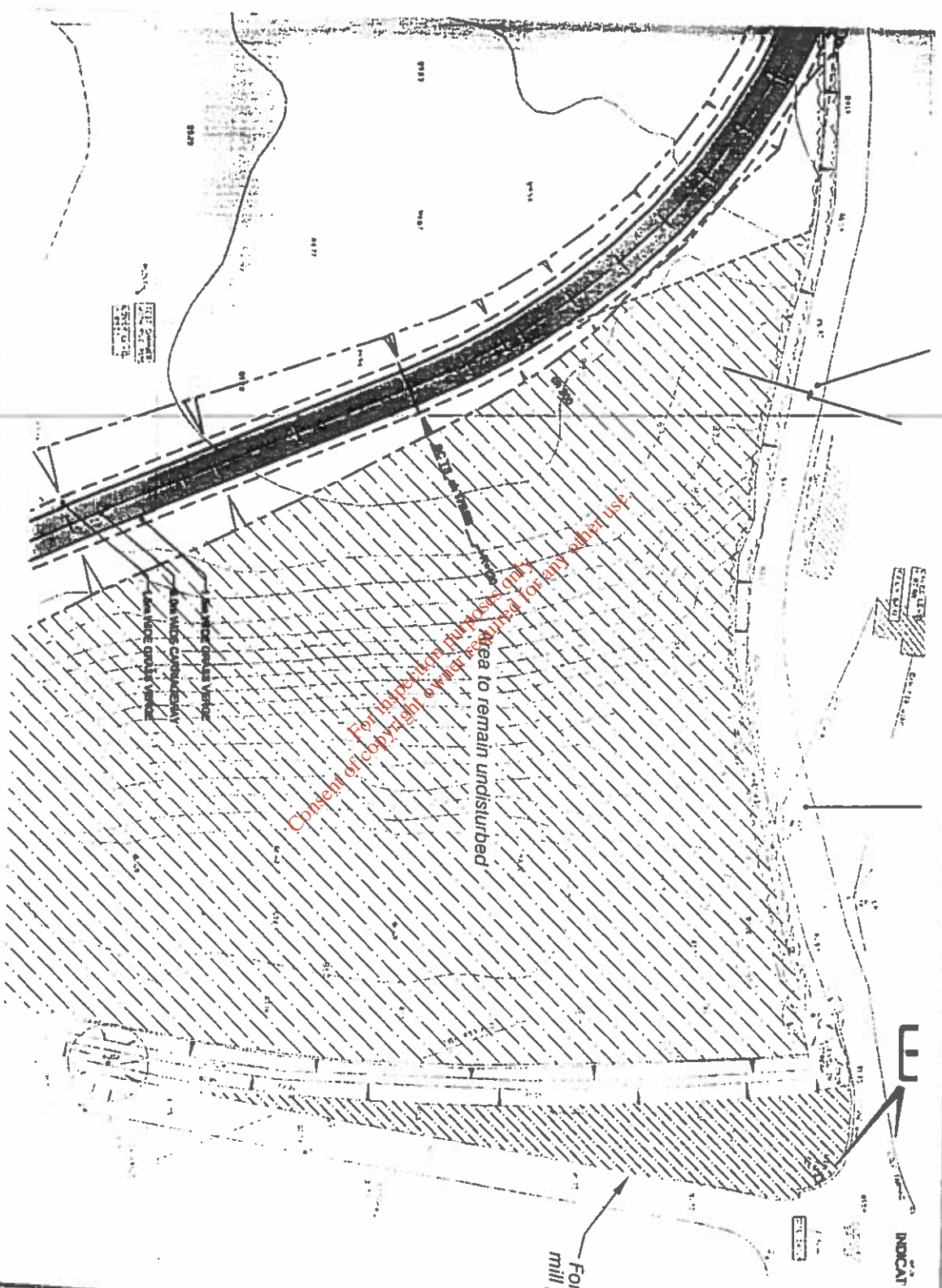

Archaeological Consultancy Services Ltd.

Unit 21, Boynes Business Park,
Greenhills, Drogheda, Co. Louth

Site: Ballinaderny Quarry,
Carbury, Co. Kildare
Issued for: Request for further information
Client: Declan Brassill & Co. Ltd.

Scale: 1:1,000 A4
Date: 15 August '03
Origin: c/o Faber Maunsell
Drawing no.: 02_05_C09

RECEIVED
27 AUG 2003

Figure 3: Detail of proposed new road layout showing location of former mill pond & undisturbed area

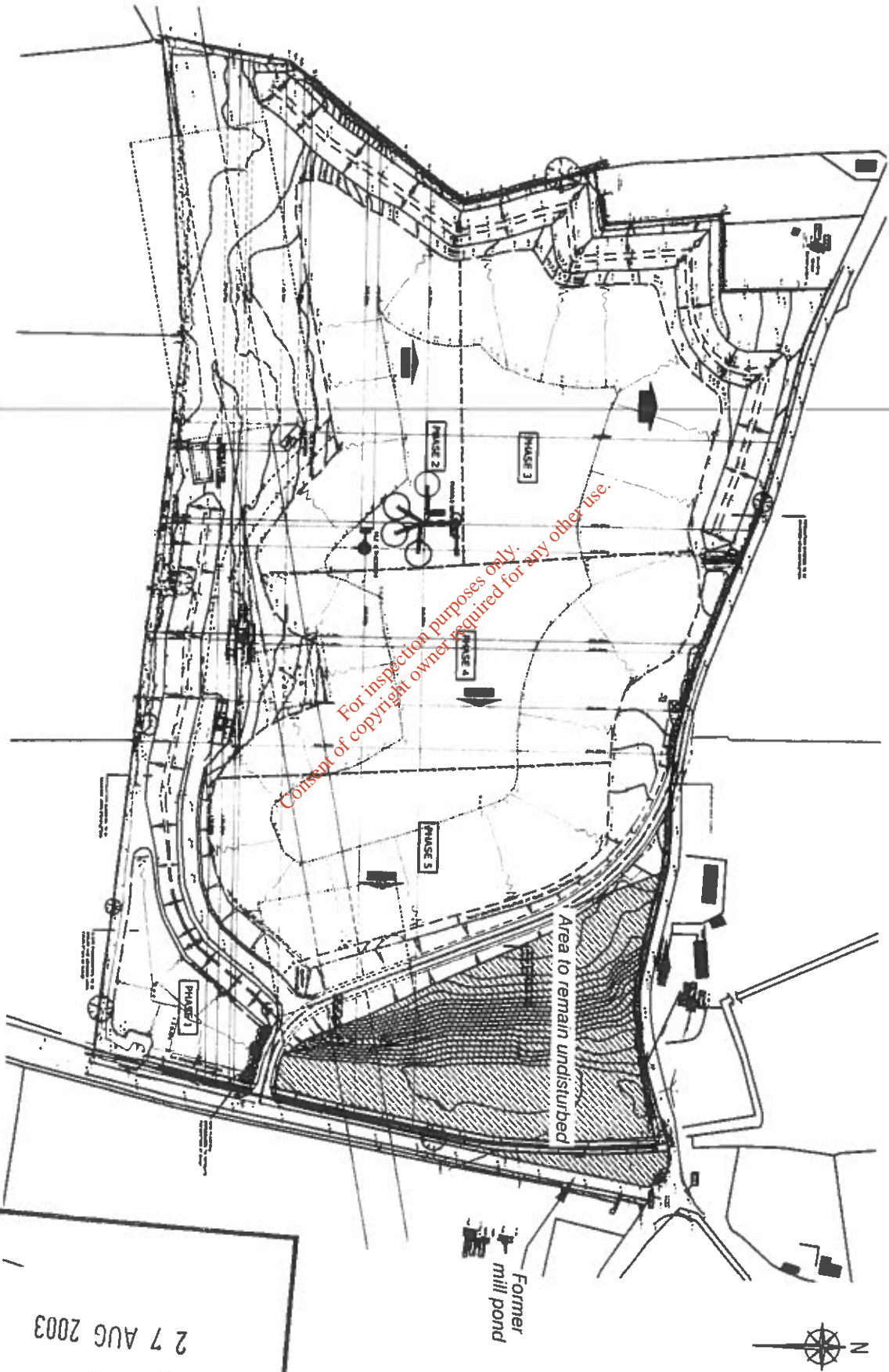

Archaeological Consultancy Services Ltd.

Unit 21, Boyne Business Park,
Greenhills, Drogheda, Co. Louth

Site: Ballinderry Quarry,
Carbury, Co. Kildare

Issued for: Request for further information

Client: Declan Brassil & Co. Ltd.

Scale: 1:3,000 A4

Date: 15 August 03

Origin: c/o Faber Maunsell

Drawing no.: 02 05 C12

PLANNING SECTION
RECEIVED
27 AUG 2003

Figure 4: Detail of proposed quarry showing location of former mill pond

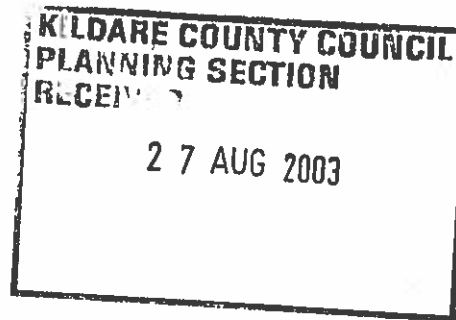

ACS

ARCHAEOLOGICAL
CONSULTANCY
SERVICES LIMITED

Development Consultant
& Cultural Resource
Management

Our Ref. 02_05

Mr. Martin Reid,
Department of the Environment, Heritage and Local Government,
6 Ely Place Upper,
DUBLIN 2.

15th August 2003.

Re: Ballinderry Quarry, Carbury, Co. Kildare. (Planning Ref 02/1475)

Dear Martin,

I have been in contact with Mr. Declan Brassil who has forwarded the attached drawing (Figure 3). The new road layout and quarry entrance as shown have been requested by Kildare County Council.

Consequently this has pushed the proposed quarry development further to the west than originally planned (Figure 4). The area to the northeast of the new road layout, immediately adjacent to the former millpond, will not be disturbed as no extraction can take place or is proposed to take place within this area. No earthen bunds or other similar landscaping are proposed. Therefore, the former millpond will not be impacted upon.

If you have any queries or require further clarification, please do not hesitate to contact me.

Yours sincerely,

Ian R. Russell

HEAD OFFICE
Unit 21
Boyne Business Park
Greenhills, Drogheda
Co. Louth
Tel: 041 9835422
Tel: 041 9835513
Fax: 041 9842131
enquiries@acsltd.ie
www.acsltd.ie

NEWRY OFFICE
61, Dominick Street
Newry, Co. Down
BT35 8BW
Tel: 028 30256008
Fax: 028 30256009

DUBLIN OFFICE
Mespil House
Sussex Road
Dublin 14
Tel: 01 6672914

DIRECTORS
Donald Murphy
M.A., M.I.A.P.A.
Deirdre Murphy

CC: Declan Brassil & Co.

27 AUG 2003



INDICAT

Former mill pond

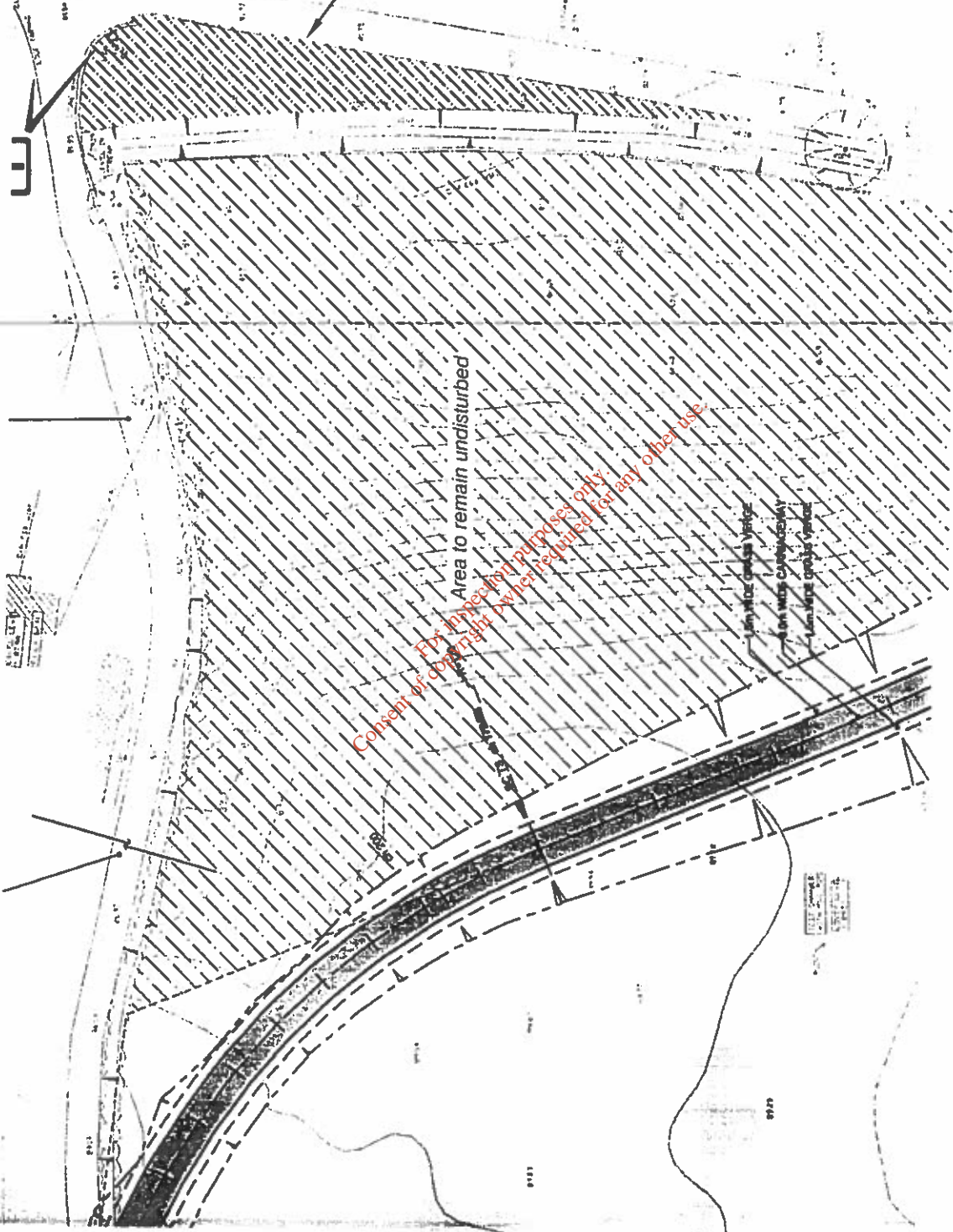

Scale: 1:1,000 A4	Site: Bailinderry Quarry, Carbury, Co. Kildare
Date: 15 August '03	issued for: Request for further information
Origin: c/o Faber Maunsell	Client: Declan Brassil & Co. Ltd.
Drawing no.: 02_05_C09	

Archaeological Consultancy Services Ltd.
 Unit 21, Boyne Business Park,
 Greenhills, Drogheda, Co. Louth

Figure 3: Detail of proposed new road layout showing location of former mill pond & undisturbed area

50 metres

KILDARE COUNTY COUNCIL
PLANNING SECTION
RECEIVED

27 AUG 2003

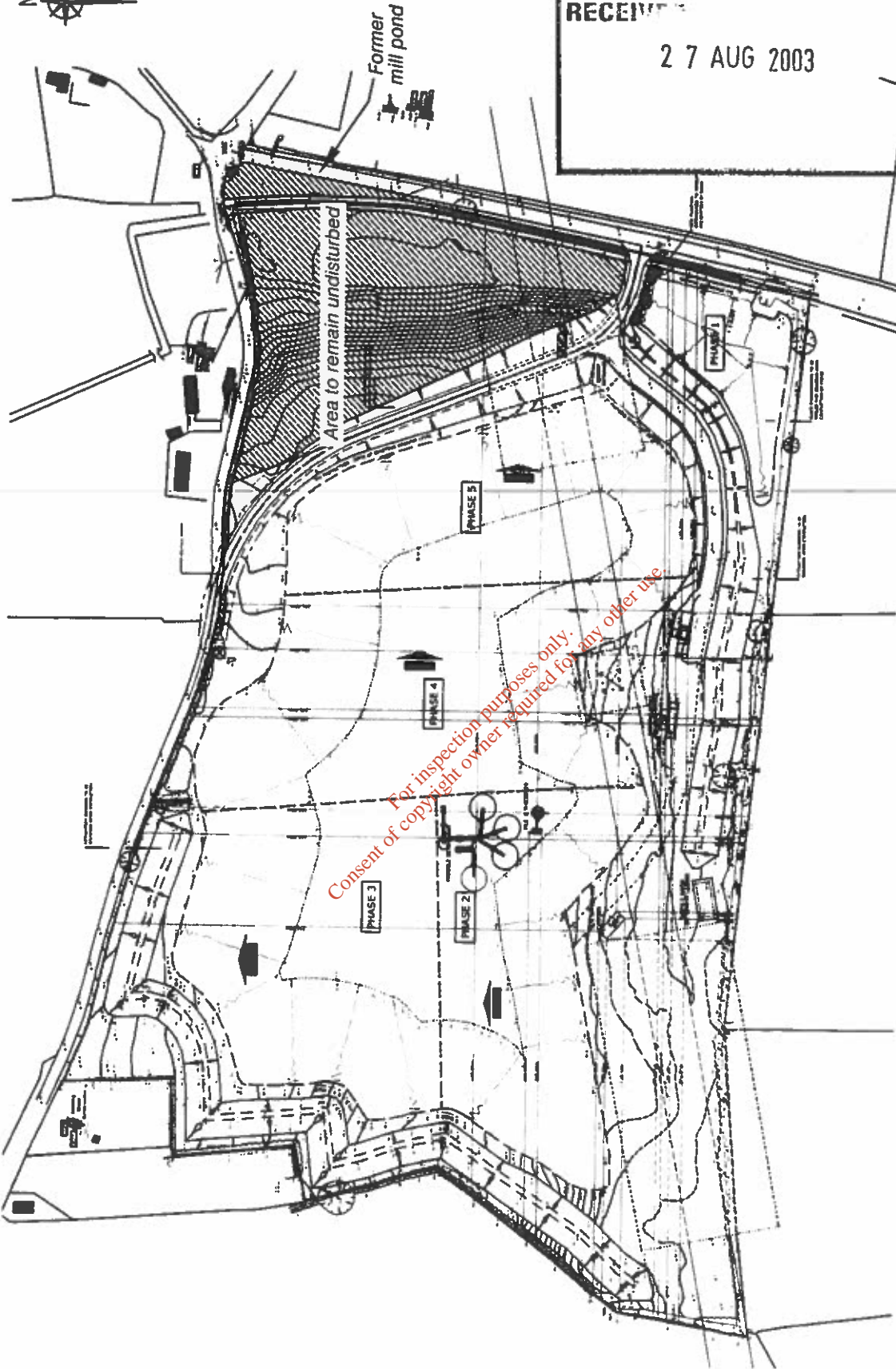

For inspection purposes only.
Consent of copyright owner required for any other use

100 metres

**Archaeological Consultancy
Services Ltd.**
Unit 21, Boyne Business Park,
Greenhills, Drogheda, Co. Louth

Site: Bellinbery Quarry,
Carbury, Co. Kildare
Issued by: Request for further information
Client: Declan Brassil & Co. Ltd.

Scale: 1:3,000 A4
Date: 15 August '03
Origin: c/o Faber Maunsel
Drawing no.: 02_05_C12

Figure 4: Detail of proposed quarry showing location of former mill pond

KILDARE COUNTY COUNCIL
PLANNING SECTION
RECEIVED

27 AUG 2003

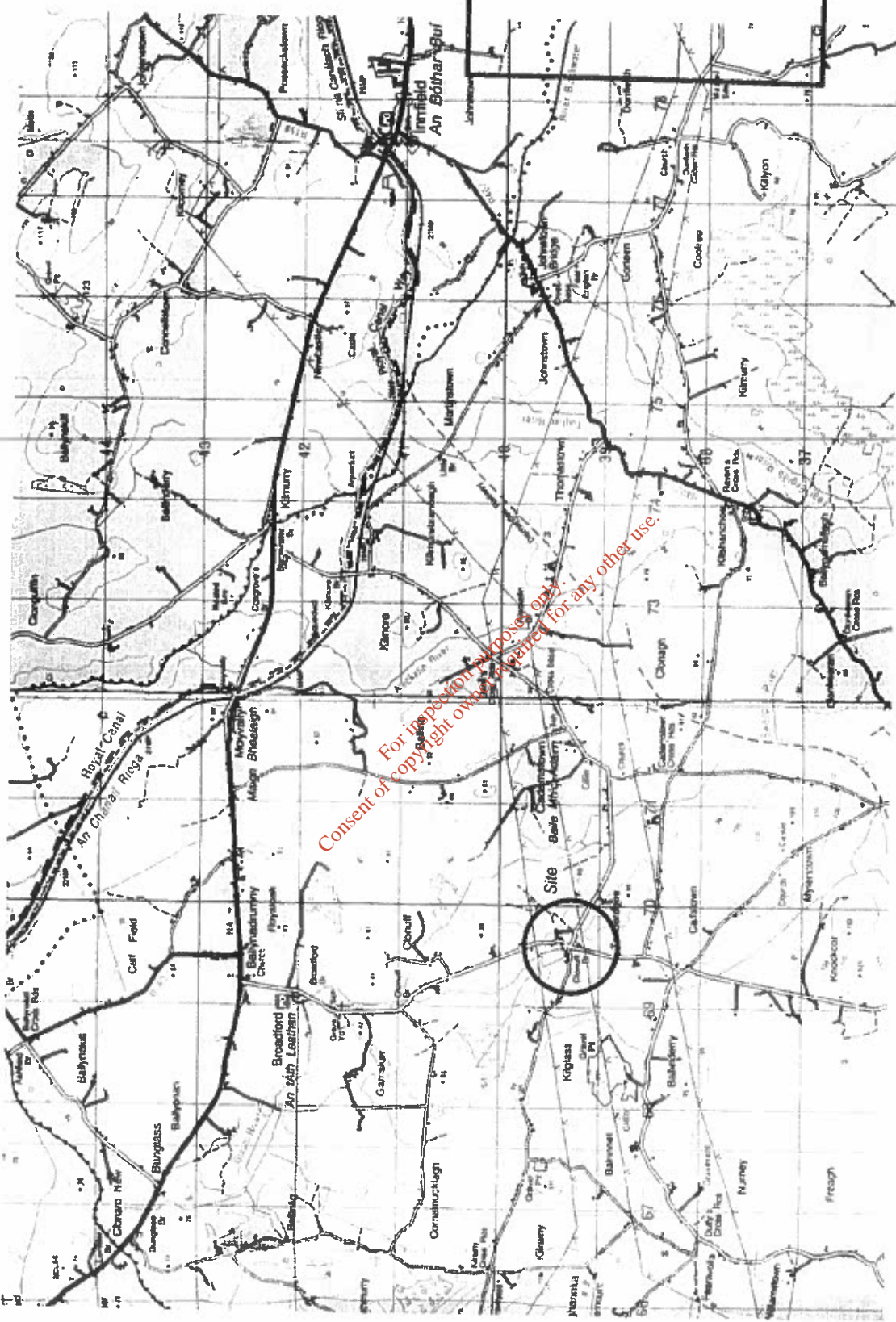

Scale: 1:60,000 A4
Date: 15 August '03
Origin: Discovery Series No. 49
Drawing no.: 02_05 C04

Site: Ballinery Quarry,
Carbury, Co. Kildare
Issued for: Request for further information
Client: Declan Brassill & Co. Ltd.

**Archaeological Consultancy
Services Ltd.**
Unit 21, Boyne Business Park,
Greenhills, Drogheda, Co. Louth



Figure 1: Location of site

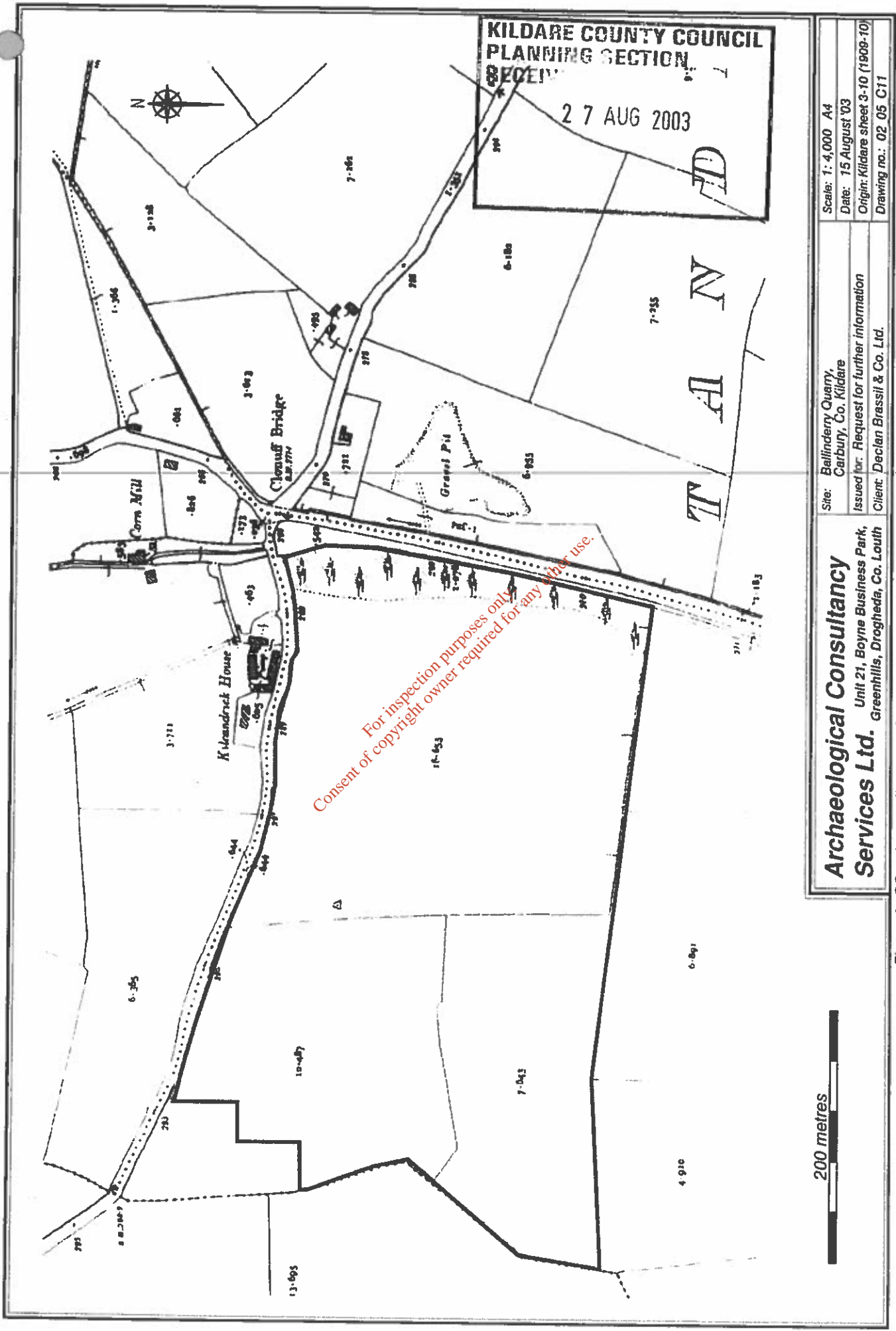

**KILDARE COUNTY COUNCIL
PLANNING SECTION**
RECEIVED
27 AUG 2003

Archaeological Consultancy Services Ltd. Unit 21, Boyne Business Park, Greenhills, Drogheda, Co. Louth	Scale: 1:4,000 A4 Date: 15 August '03 Origin: Kildare sheet 3-10 (1909-10) Drawing no.: 02_05_C11
Site: Bellinerry Quarry, Carbury, Co. Kildare	Issued for: Request for further information Client: Declan Brassil & Co. Ltd.

Figure 2: OS 25' to 1 mile map, Kildare sheet 3-10 (1909-10) showing detail of site

Item Nos. 2 and 4.

The matters raised in Item Nos. 2 and 4 have been addressed by Archaeological Consultancy Services Ltd. (ACSL), and are detailed in the attached correspondence. ACSL has consulted with Mr Brian Duffy and Mr Martin Reid in the Department of the Environment, Heritage and Local Government, and have confirmed the basis of the consultation in the attached correspondence. ACSL have also consulted with the Planning Officer at the Heritage Council and the basis of the consultations are detailed in the attached correspondence.

Item No. 3

O'Neill Groundwater Engineering has consulted with the Eastern Regional Fisheries Board in respect of the matters raised under Item 3. A report on these consultations is submitted herewith.

It is noted that the information submitted does not alter the detail of the planning application in any manner. As such, it is not considered necessary to publish revised public notices.

I trust that the information submitted will facilitate the Planning Authority in issuing an early and favourable decision on this matter.

Yours sincerely

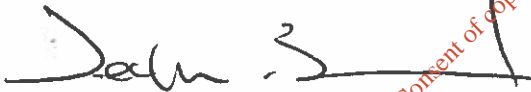

Declan Brassil

Encl.

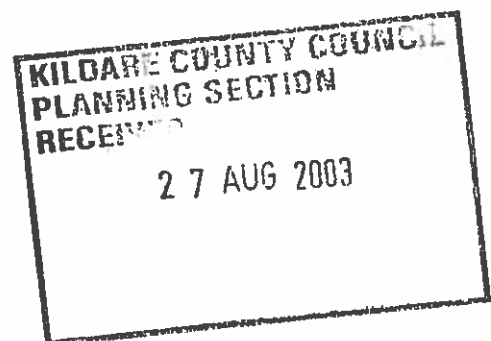

For inspection purposes only.
Consent of copyright owner required for any other use.