

EXIT ROUTE FOR CRUISE COACHES FROM
CRUISE AREA TO DUBLIN CITY CENTRE

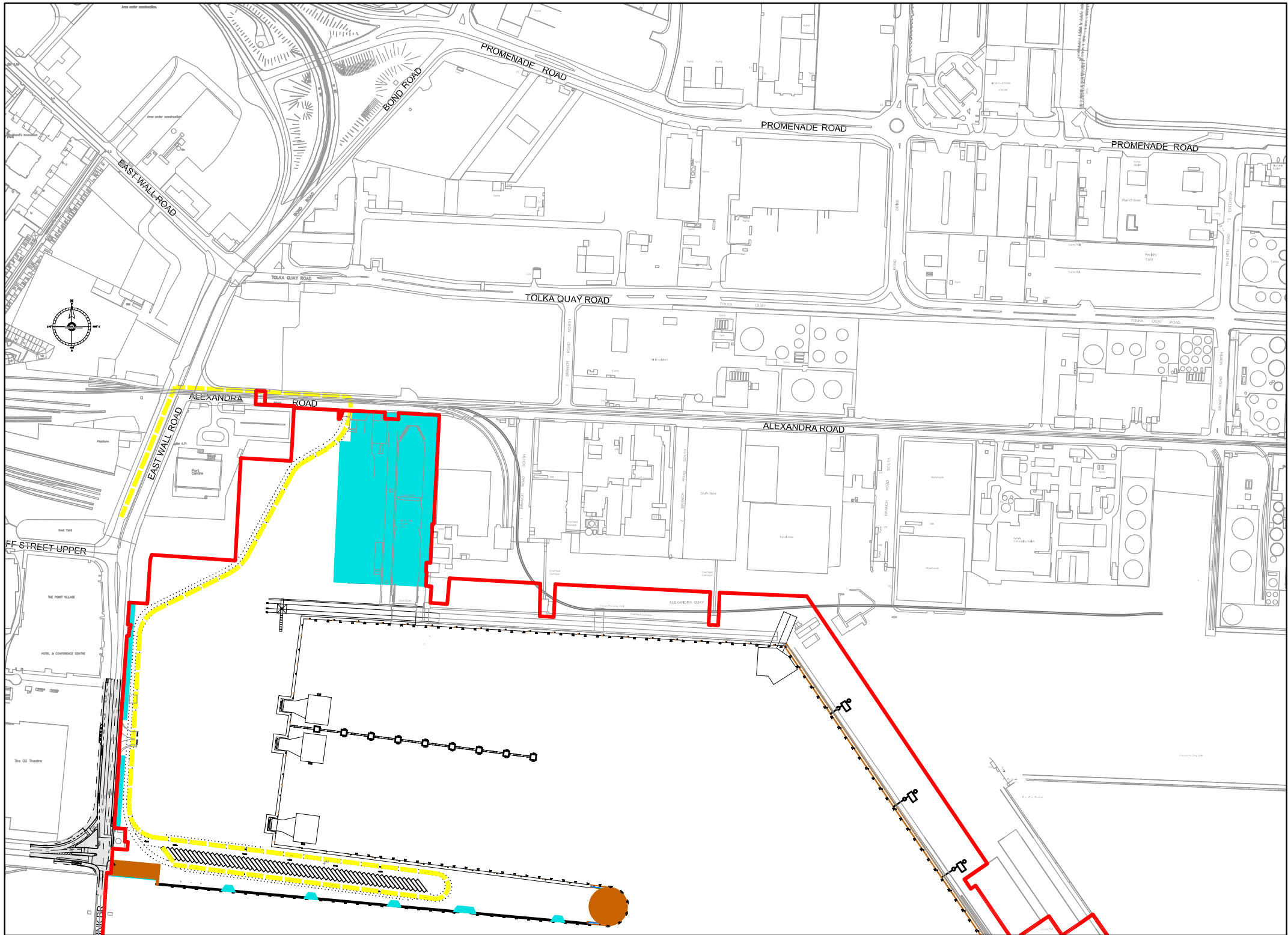

ENTRY ROUTE FOR CRUISE COACHES FROM
DUBLIN CITY CENTRE TO CRUISE AREA

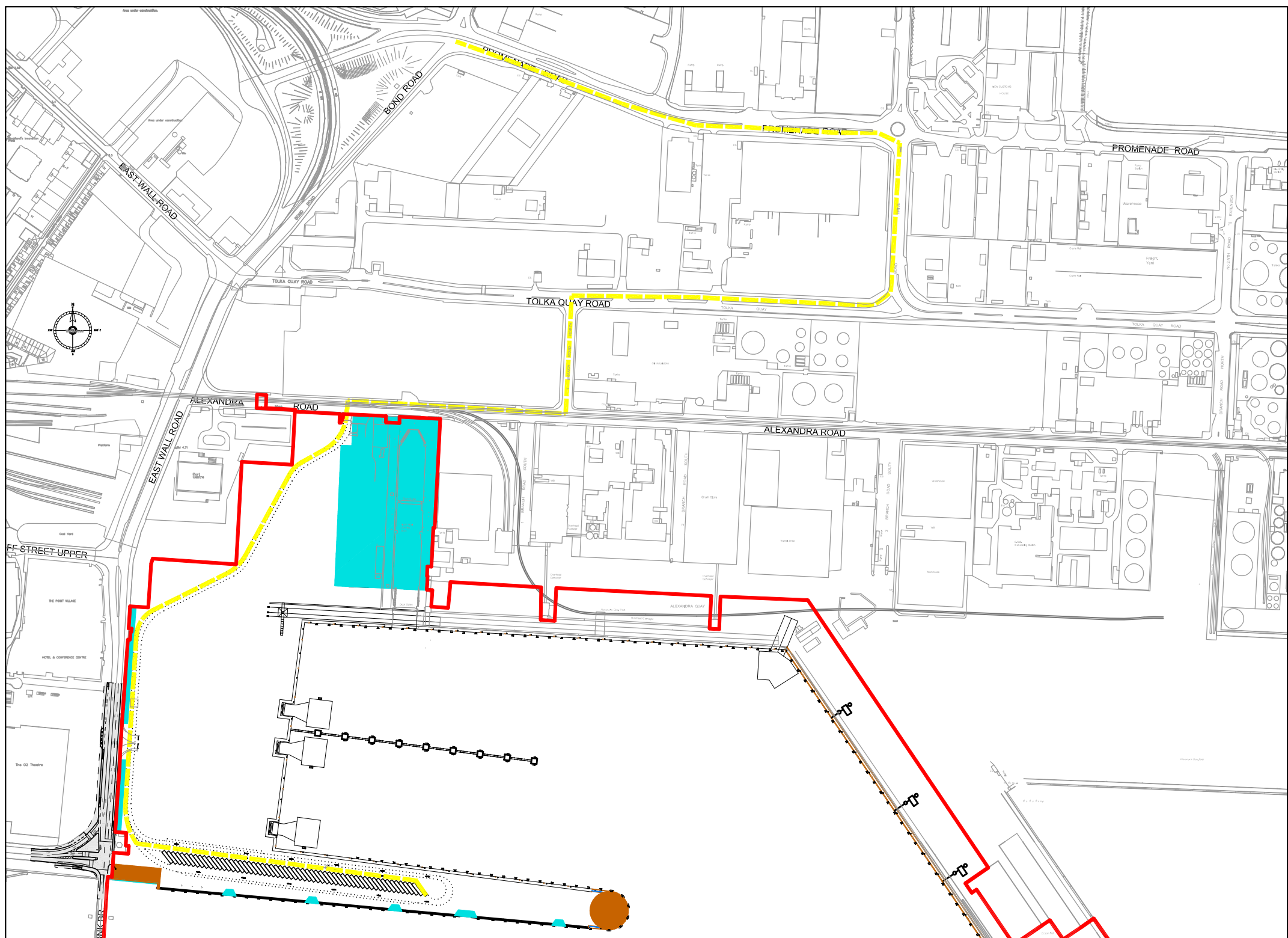

EXIT ROUTE FOR CRUISE COACHES FROM
CRUISE AREA TO NORTHBOUND/TUNNEL

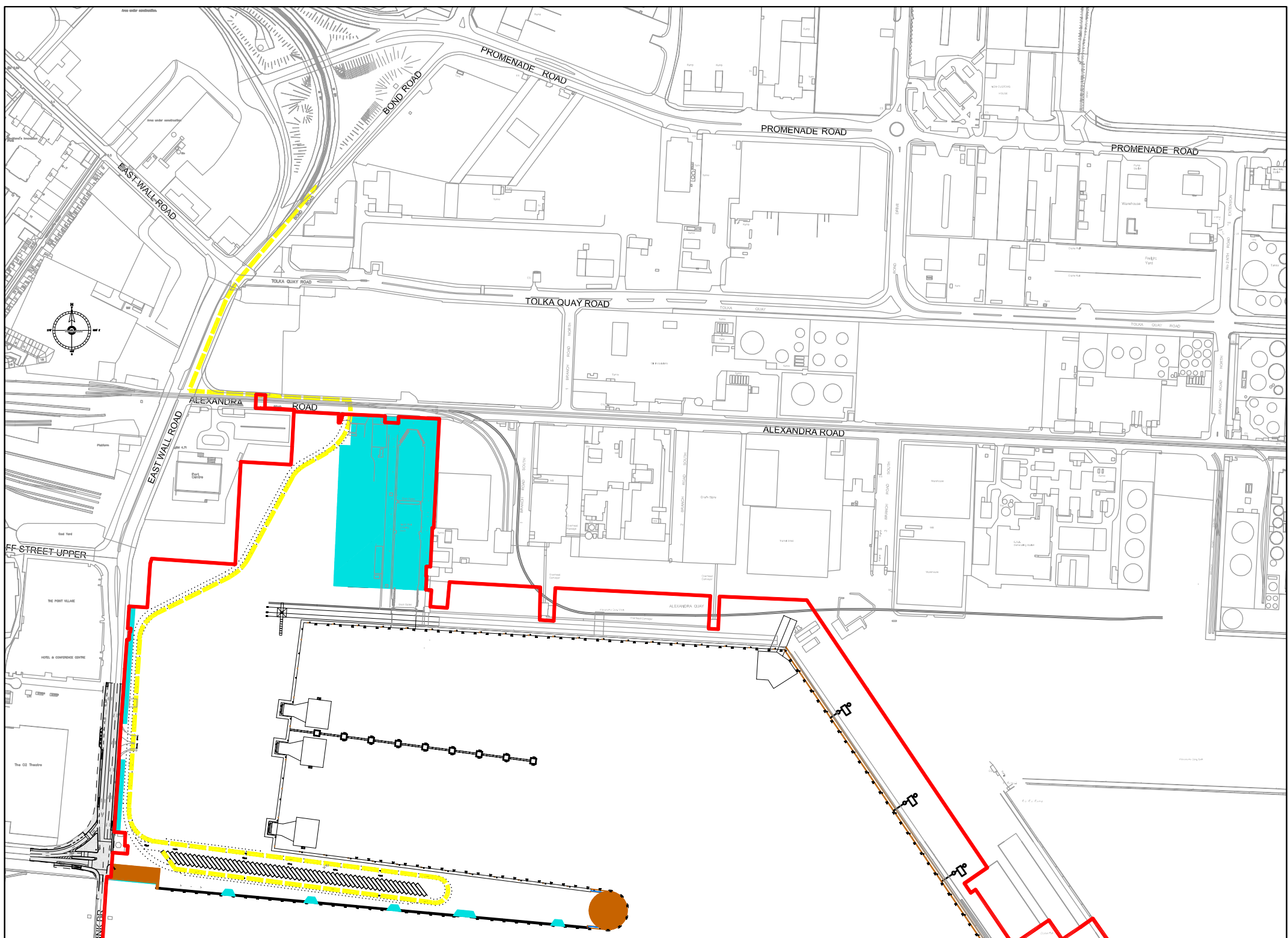

ENTRY ROUTE FOR CRUISE COACHES FROM
NORTH/TUNNEL TO CRUISE AREA

For inspection purposes only.
Consent of copyright owner required for any other use.

NOTES

1. Verifying Dimensions.
The contractor shall verify dimensions against such other drawings or site conditions as pertain to this part of the work.
2. Existing Services.
Any information concerning the location of existing services indicated on this drawing is intended for general guidance only. It shall be the responsibility of the contractor to determine and verify the exact horizontal and vertical alignment of all cables, pipes, etc. (both underground and overhead) before work commences.
3. Issue of Drawings.
Hard copies, dwf and pdf will form a controlled issue of the drawing. All other formats (dwg, dxf etc.) are deemed to be an uncontrolled issue and any work carried out based on these files is at the recipient's own risk. RPS will not accept any responsibility for any errors arising from the use of these files, either by human error by the recipient, listing of un-dimensioned measurements, compatibility issues with the recipient's software, and any errors arising when these files are used to aid the recipient's drawing production, or setting out on site.
4. DATUM: Ordnance Datum Malin (Unless Noted Otherwise)

- INDICATION OF SECTION OF DCCNTA
HIGHWAY IMPROVEMENT SCHEME
- CONSERVATION ZONE
(REFER TO MOLA DRAWINGS FOR DETAILS)
- INTERPRETATIVE ZONE
(REFER TO MOLA DRAWINGS FOR DETAILS)
- PLANNING BOUNDARY
UNDER THIS APPLICATION
- TOTAL
BOUNDARY AREA: 5348426 m²
(534.843ha)

PROPOSED MARSHALLING DELINEATION
FOR CRUISE TRAFFIC

rev	amendments	drawn	date
-----	------------	-------	------

RPS Elmwood House
74 Boucher Road
Belfast
BT12 6RZ

T +44 (0) 28 90 667914
F +44 (0) 28 90 668286
W www.rpsgroup.com/ireland
E ireland@rpsgroup.com

Client
**COMHLACHT CHALAFORT
ÁTHA CLIATH
DUBLIN PORT COMPANY**

Project
Alexandra Basin Redevelopment

Title
**Proposed Routing for Cruise
Vehicular Traffic - Sheet 1 of 2**

Architect
-

Drawing Status Planning	Sheet Size A1	Drawing Scale 1:5000
----------------------------	------------------	-------------------------

Drawing Number IBH0362-RF12-03	Rev -
--	----------

Project Leader BD	Drawn By TN	Date MAR 2015	Initial Review CD
----------------------	----------------	------------------	----------------------

100m SCALE 1:5000